

Mobil Producing Texas & New Mexico Inc.

September 26, 1984

By JPP
RECEIVED
OCT - 1 1984
OIL CONSERVATION DIVISION
SANTA FE

NINE GREENWAY PLAZA—SUITE 2700
HOUSTON, TEXAS 77046

State of New Mexico
Energy and Minerals Department (3)
Oil Conservation Division
State Land Office Building
P. O. Box 2088
Santa Fe, New Mexico 87501

Attention: Mr. R. L. Stamets

NSL - 1907
RULE 104 FI
RELEASE OCT. 20, 1984

For lease

7.01
B-1520

UNORTHODOX WELL LOCATIONS

MOBIL PRODUCING TX. & N.M. INC.

BRIDGES STATE, WELL #189, (190), 191 & 192

VACUUM (GRAYBURG-SAN ANDRES) FIELD POOL
LEA COUNTY, TEXAS 1310' FNL & 110' FEL,

Sec. 23, T17S, R34E, Lea

NE/4 NE/4 OF Sec. 23 Dedicated

Gentlemen:

Mobil Producing TX. & N.M. Inc., (MPTM), respectively requests authority to drill the subject wells at an unorthodox location under the provisions of Rule 104 (F). The wells are located closer than 330 feet from the quarter-quarter line but more than 330 feet from the lease line. These wells will be completed in the Vacuum (Grayburg-San Andres) Pool, which is a secondary recovery project.

In order to develop a 20 acre spacing program, these wells are needed at these locations to improve the recovery pattern and recover hydrocarbons that might otherwise be left in place.

In support of this request, the following items are submitted in triplicate:

1. Form C-101 -- Application for Permit to Drill, Deepen or Plug Back.
2. Form C-102 -- Well location and acreage dedication plat.
3. Certified plat showing all well locations and offset operators.

MPTM is the operator of all land surrounding the 40 acre proration units.

Yours truly,

A. O. Bond

for J. A. Morris
Regulatory Engineering Supervisor

WHEvans/dt
Attachments

cc: NM Energy & Minerals Dept.
-Hobbs District office

STATE OF NEW MEXICO
ENERGY AND MINERALS DEPARTMENT

OIL CONSERVATION DIVISION

P. O. BOX 2088

SANTA FE, NEW MEXICO 87501

Form C-101
Revised 10-1-78

NO. OF COPIES RECEIVED	
DISTRIBUTION	
SANTA FE	
FILE	
U.S.G.S.	
LAND OFFICE	
OPERATOR	

5A. Indicate Type of Lease
STATE ☒ FEE ☐
5. State Oil & Gas Lease No.
B-1520

APPLICATION FOR PERMIT TO DRILL, DEEPEN, OR PLUG BACK

1a. Type of Work DRILL <input checked="" type="checkbox"/> DEEPEN <input type="checkbox"/> PLUG BACK <input type="checkbox"/>				7. Unit Agreement Name	
b. Type of Well OIL WELL <input checked="" type="checkbox"/> GAS WELL <input type="checkbox"/> OTHER <input type="checkbox"/> SINGLE ZONE <input checked="" type="checkbox"/> MULTIPLE ZONE <input type="checkbox"/>				8. Farm or Lease Name Bridges-State	
2. Name of Operator Mobil Producing Texas & New Mexico Inc.				9. Well No. 190	
3. Address of Operator 9 Greenway Plaza, Suite 2700 Houston, TX 77046				10. Field and Pool, or Wildcat Vacuum	
4. Location of Well UNIT LETTER <u>A</u> LOCATED <u>1310</u> FEET FROM THE <u>North</u> LINE AND <u>110</u> FEET FROM THE <u>East</u> LINE OF SEC. <u>23</u> TWP. <u>17S</u> RGE. <u>34E</u> NMPM				12. County Lea	
19. Proposed Depth 5000'				19A. Formation Grayburg-San Andres	
20. Rotary or C.T. Rotary					
21. Elevations (Show whether DF, RT, etc.) 4025' Ground		21A. Kind & Status Plug. Bond Blanket-on file		21B. Drilling Contractor unknown	
				22. Approx. Date Work will start As soon as possible	

23.

PROPOSED CASING AND CEMENT PROGRAM

SIZE OF HOLE	SIZE OF CASING	WEIGHT PER FOOT	SETTING DEPTH	SACKS OF CEMENT	EST. TOP
12 1/4"	8 5/8"	24#	0 - 350'	1. Circulate	Surface
7 7/8"	5 1/2"	14#	0 - 4800'	2. Circulate	Surface

1. Class C + 2% CaCl₂ + 1/4 #/sx FC
2. Lead -Class C + 4% gel + 15 #/sx salt + 1/4 #/sx FC
Tail -Class C + 2% CaCl₂ + 1/4 #/sx FC

BLOWOUT PREVENTOR PROGRAM

Casing String	Equip., Size & series	No. & Type	Test Pressure (psi)
Surface	13 5/8" X 3000#	1 Pipe Ram & 1-MG	3000
Intermediate	9 - 11" X 5000#	1 Pipe Ram & 1-MG	5000

IN ABOVE SPACE DESCRIBE PROPOSED PROGRAM; IF PROPOSAL IS TO DEEPEN OR PLUG BACK, GIVE DATA ON PRESENT PRODUCTIVE ZONE AND PROPOSED NEW PRODUCTIVE ZONE. GIVE BLOWOUT PREVENTOR PROGRAM, IF ANY.

I hereby certify that the information above is true and complete to the best of my knowledge and belief.

Signed A. D. Bond A. D. Bond Title Regulatory Technician Supervisor Date September 26, 1984

(This space for State Use)

APPROVED BY _____ TITLE _____ DATE _____

CONDITIONS OF APPROVAL, IF ANY:

All distances must be from the outer boundaries of the Section.

Operator Mobil Producing Texas & New Mexico Inc.		Lease Bridges-State		Well No. 190
Unit Letter A	Section 23	Township 17-S	Range 34-E	County Lea
Actual Footage Location of Well: 1310 feet from the North line and 110 feet from the East line				
Ground Level Elev. 4025'	Producing Formation Grayburg-San Andres	Pool Vacuum	Dedicated Acreage: 40 AC (2wells) Acres	

- Outline the acreage dedicated to the subject well by colored pencil or hatchure marks on the plat below.
- If more than one lease is dedicated to the well, outline each and identify the ownership thereof (both as to working interest and royalty).
- If more than one lease of different ownership is dedicated to the well, have the interests of all owners been consolidated by communitization, unitization, force-pooling, etc?

☐ Yes ☐ No If answer is "yes," type of consolidation _____

If answer is "no," list the owners and tract descriptions which have actually been consolidated. (Use reverse side of this form if necessary.) _____

No allowable will be assigned to the well until all interests have been consolidated (by communitization, unitization, forced-pooling, or otherwise) or until a non-standard unit, eliminating such interests, has been approved by the Division.

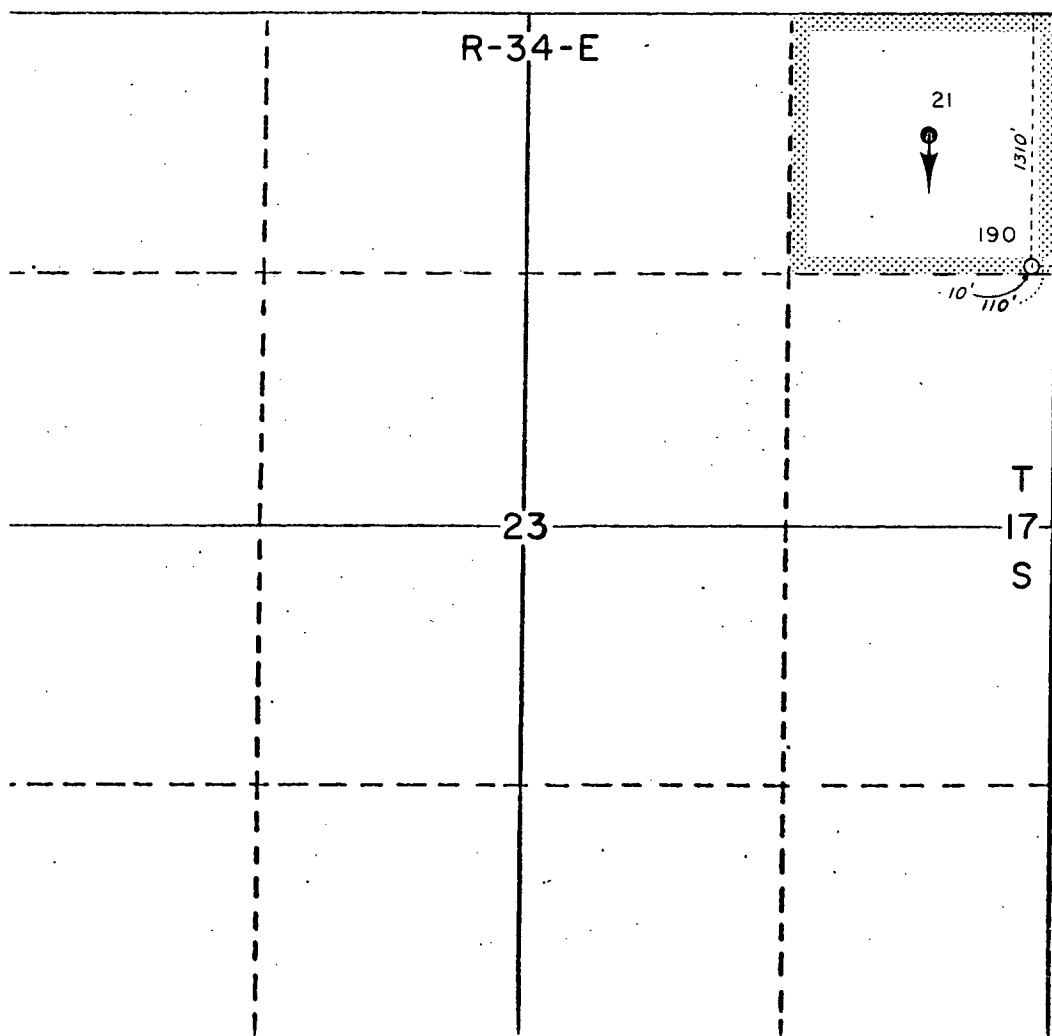

CERTIFICATION

I hereby certify that the information contained herein is true and complete to the best of my knowledge and belief.

Name A. D. Bond
Position Regulatory Technician Supv.
Company Mobil Producing Texas & New Mexico Inc.
Date September 26, 1984

I hereby certify that the well location shown on this plat was plotted from field notes of actual surveys made by me or under my supervision and that the same is true and correct to the best of my knowledge and belief.

Date Surveyed
H. A. Carson, Jr.
Registered Professional Engineer
and/or Land Surveyor

5063

Certificate No.

