

*No offset operations  
Release November 27, 1984*

*By Dec.*

*N5C-1948  
RULE-104*



**Amoco Production Company**

Petroleum Center Building  
501 Airport Drive  
Farmington, New Mexico 87401  
505-325-8841

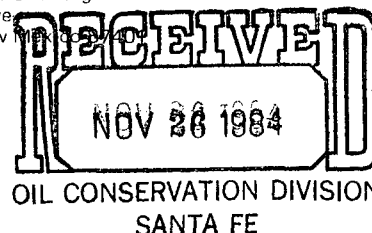

W. J. Holcomb  
District Manager

November 20, 1984

Mr. Gilbert Quintana  
New Mexico Oil Conservation Division  
P. O. Box 2088  
Santa Fe, NM 87501

File: DDL-1141-400.1

Application for Unorthodox Location  
Gallegos Canyon Unit No. 230E  
Simpson Gallup Field  
San Juan County, New Mexico

Amoco Production Company hereby requests approval of an unorthodox well location for the Gallegos Canyon Unit No. 230E. The location is 1070' FSL x 1630' FEL of Section 23, T28N, R12W, San Juan County, New Mexico.

This well was originally staked orthodox for the Basin Dakota Field, but after more geologic study, it was decided that a dual completion in the shallow formation would be feasible.

There are no offset lease holders of Simpson Gallup wells as indicated on the attached nine-section plat.

Sincerely,

A handwritten signature in cursive script, appearing to read "W. J. Holcomb", with a small "201" written below it.

KRJ/ct

Attachments

cc: Mr. Ernie Bush  
New Mexico Oil Conservation Division  
1000 Rio Brazos Road  
Aztec, NM 87410

AM18



STATE OF NEW MEXICO  
ENERGY AND MINERALS DEPARTMENT  
OIL CONSERVATION DIVISION  
AZTEC DISTRICT OFFICE

1000 RIO BRAZOS ROAD  
AZTEC, NEW MEXICO 87410  
(505) 334-6178

OIL CONSERVATION DIVISION  
BOX 2088  
SANTA FE, NEW MEXICO 87501

DATE 11-27-84

RE: Proposed MC \_\_\_\_\_  
Proposed DHC \_\_\_\_\_  
Proposed NSL X \_\_\_\_\_  
Proposed SWD \_\_\_\_\_  
Proposed WFX \_\_\_\_\_  
Proposed PMX \_\_\_\_\_

Gentlemen:

I have examined the application dated 11-26-84  
for the Amoco Gallegos Canyon Unit # 230E 0-23-28N-12W  
Operator Lease and Well No. - Unit, S-T-R

and my recommendations are as follows:

Approve:  
\_\_\_\_\_  
\_\_\_\_\_  
\_\_\_\_\_  
\_\_\_\_\_  
\_\_\_\_\_

Yours truly,

Eric Thumel

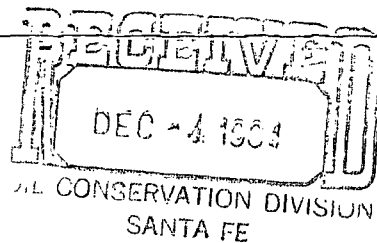

R12W

15	SCU # 209E ▲ SCU # 208E ▲ SCU # 209 ▲ SCU # 208E ▲	14	SCU # 207E ▲ SCU # 207 ▲ SCU # 216E ▲ SCU # 216E ▲	13	SCU # 217E ▲ SCU # 203 ▲ SCU # 217 ▲ SCU # 203E ▲
22	▲ SCU # 218E SCU # 218 ▲	23	▲ SCU # 219E SCU # 219 ▲	24	SCU # 243 ▲ SCU # 242 ▲
	SCU # 8 ▲		▲ SCU # 230 ▲ ▲		SCU # 242E SCU # 243E ▲
27	▲ SCU # 231	26	SCU # 83 ▲	25	SCU # 265 ▲
	SCU # 233 ▲		SCU # 232 ▲		

T  
28  
N

- ▲ BASIN DAKOTA WELLS
- SIMPSON GALLUP WELLS

OIL CONSERVATION DIVISION

P. O. BOX 2088  
SANTA FE, NEW MEXICO 87501

Form C-107  
Revised 10-1-78

All distances must be from the outer boundaries of the Section.

Operator <b>AMOCO PRODUCTION COMPANY</b>			Lease <b>GALLEGOS CANYON UNIT</b>		Well No. <b>230E</b>
Unit Letter <b>0</b>	Section <b>23</b>	Township <b>28N</b>	Range <b>12W</b>	County <b>San Juan</b>	
Actual Footage Location of Well: <b>1070</b> feet from the <b>South</b> line and <b>1630</b> feet from the <b>East</b> line					
Ground Level Elev. <b>5771</b>	Producing Formation <b>Dakota + Gallup</b>		Pool <b>Basin Dakota + Simpson Gallup</b>		Dedicated Acreage: <b>320/40</b> Acres

1. Outline the acreage dedicated to the subject well by colored pencil or hachure marks on the plat below.
2. If more than one lease is dedicated to the well, outline each and identify the ownership thereof (both as to working interest and royalty).
3. If more than one lease of different ownership is dedicated to the well, have the interests of all owners been consolidated by communitization, unitization, force-pooling, etc?

☒ Yes ☐ No If answer is "yes," type of consolidation Unitized

If answer is "no," list the owners and tract descriptions which have actually been consolidated. (Use reverse side of this form if necessary.)

No allowable will be assigned to the well until all interests have been consolidated (by communitization, unitization, forced-pooling, or otherwise) or until a non-standard unit, eliminating such interests, has been approved by the Commission.

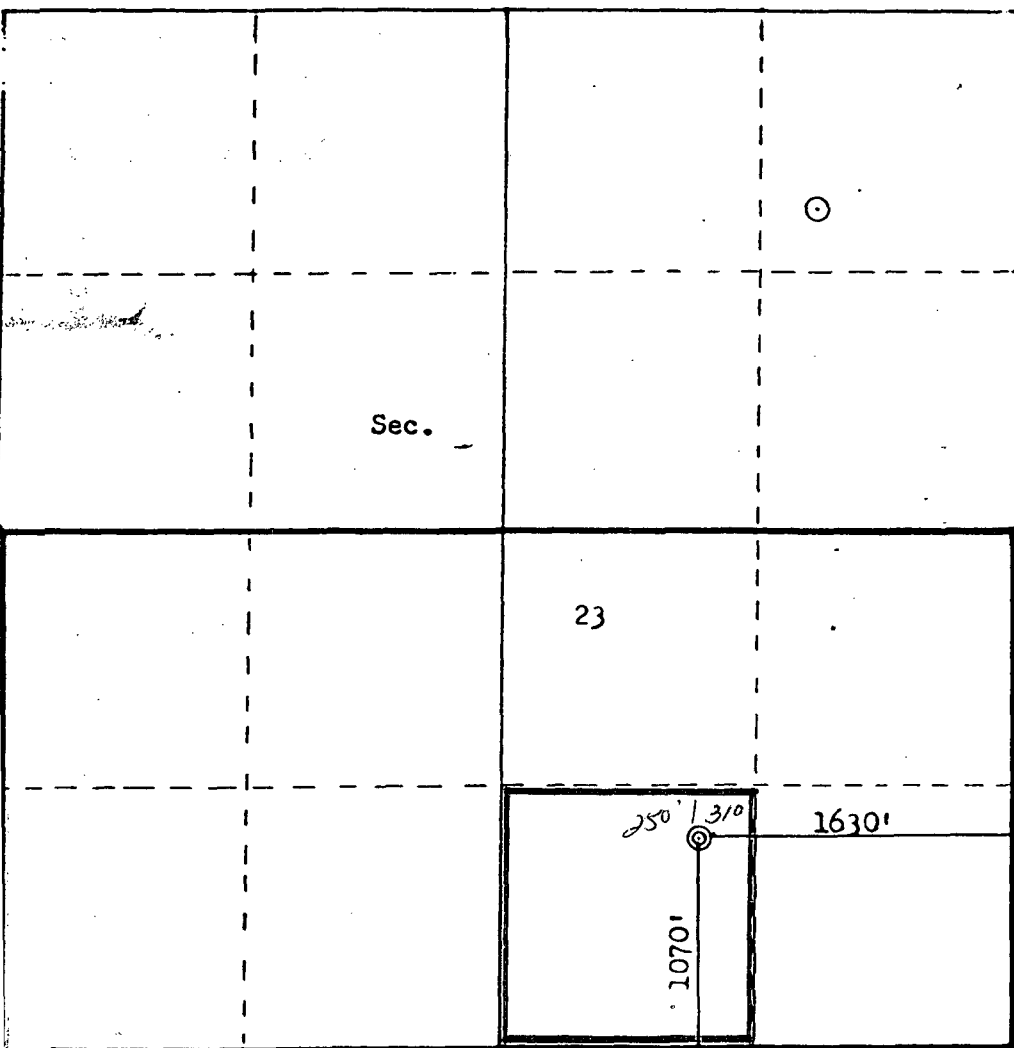

Scale: 1"=1000'

CERTIFICATION

I hereby certify that the information contained herein is true and complete to the best of my knowledge and belief.

**Original Signed By**  
**B. D. Shaw**

Name  
**B. D. Shaw**  
Position  
**Administrative Supervisor**  
Company  
**Amoco Production Company**  
Date  
**May 31, 1984**

I hereby certify that the well location shown on this plat was plotted from field notes of actual surveys made by me or under my supervision, and that the same is true and correct to the best of my knowledge and belief.

Date Surveyed  
**April 15, 1983**  
Registered Professional Engineer and Land Surveyor  
**Fred B. Kerr Jr.**  
Certificate No. **4222**  
**3950**