

Release 6-26-85

By Dec

CURTIS J. LITTLE  
OIL AND GAS

TELEPHONE (505) 327-6176  
PETROLEUM PLAZA SUITE 175  
POST OFFICE BOX 1258  
FARMINGTON, NEW MEXICO 87499

June 4, 1985

NSL-2070  
RULE-104 FE

RECEIVED

160 acres  
NE 1/4 Sect 21

JUN 6 1985

OIL CONSERVATION DIVISION

State of New Mexico Energy & Minerals Dept.  
Oil Conservation Division  
P.O. Box 2088  
Santa Fe NM 87501

Attention: Mr. R. L. Stamets

Sters Chacra  
Dual

Re: Application for Administrative Approval  
UNORTHODOX LOCATION - #12 Salazar  
515 FNL - 875 FEL Ballard Pictured Cliffs Gas Field  
Section 21-T25N-R6W Rio Arriba County, N.M.

Dear Sir:

Enclosed are plats in triplicate showing ownership of all leases and Pictured Cliffs and Chacra wells offsetting the subject unorthodox location which was staked unorthodox from the northline to avoid the main channel of Largo (see enclosed topo sheet).

All offset operators have been notified with waiver request to be sent to your office.

Very truly yours,

  
CURTIS J. LITTLE

CJL/sfl

cc: Meridian Oil, Inc.  
cc: Merriion Oil & Gas Co.  
cc: Minel, Inc.  
cc: O.C.D. - Aztec

R-6-W

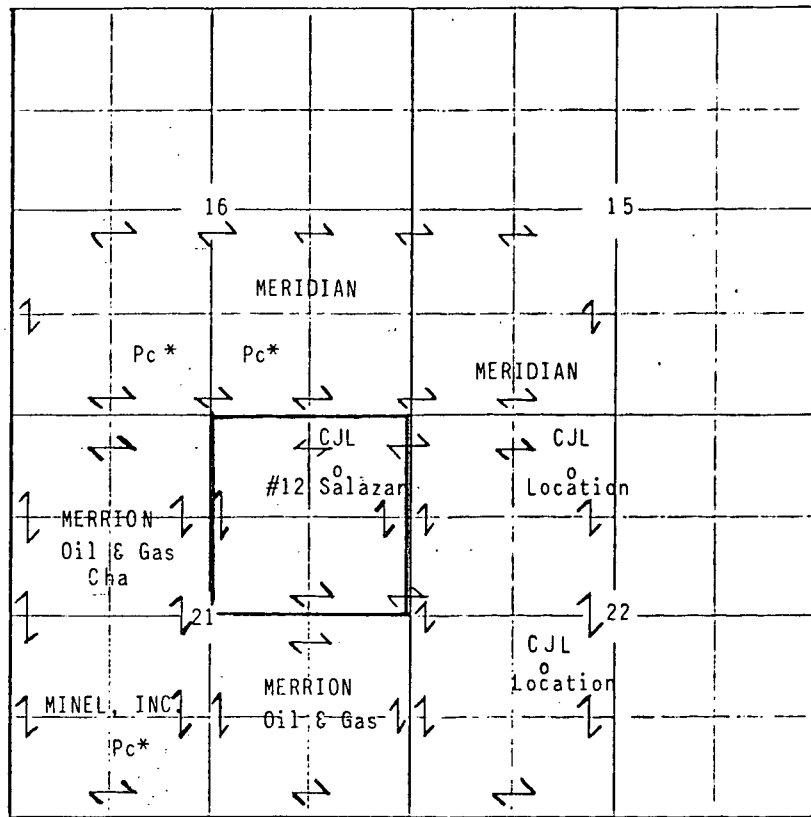

T-25-N

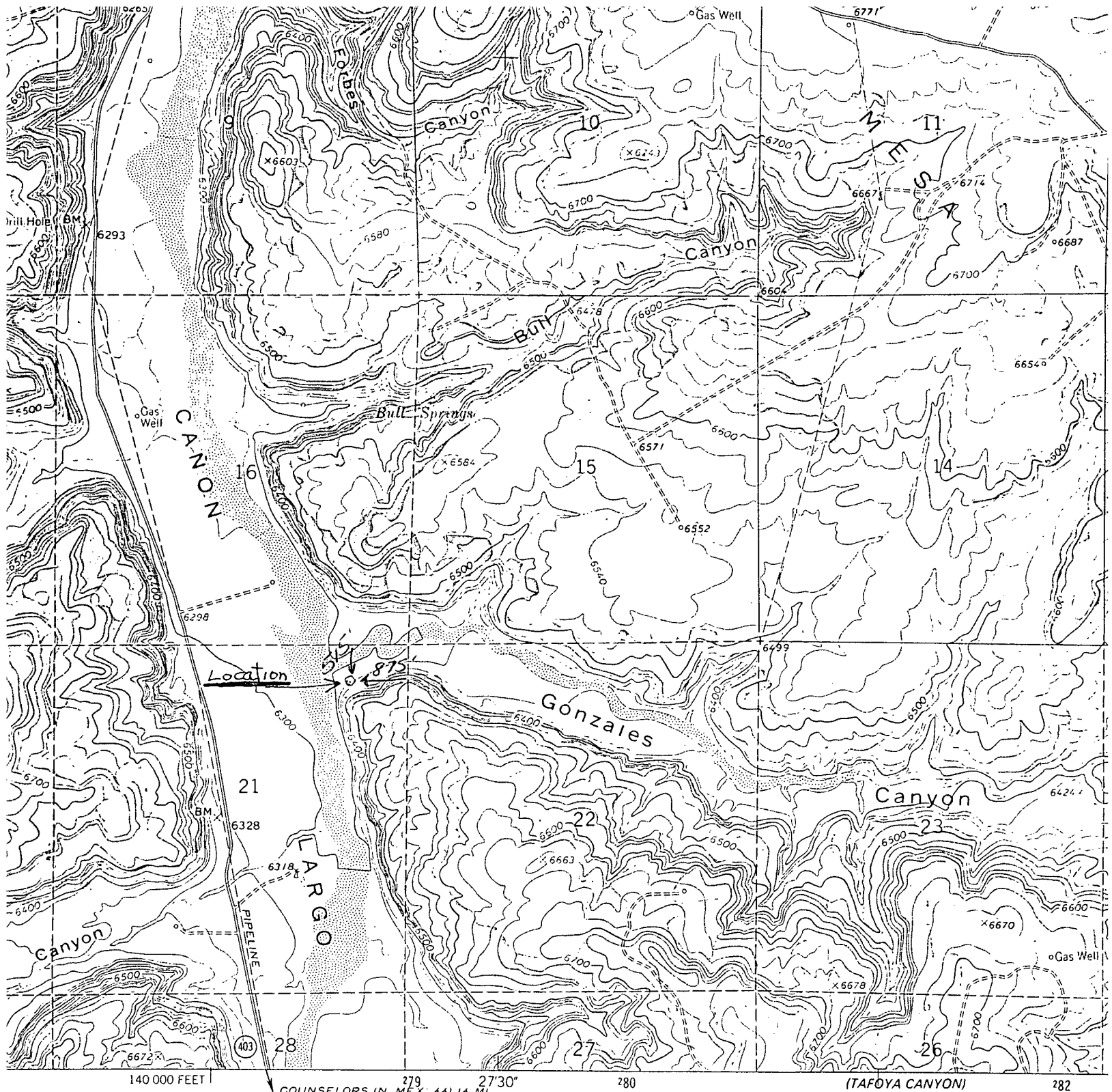

Geological Survey

ed 1963

stem, central zone

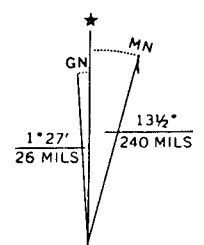

UTM GRID AND 1963 MAGNETIC NORTH DECLINATION AT CENTER OF SHEET

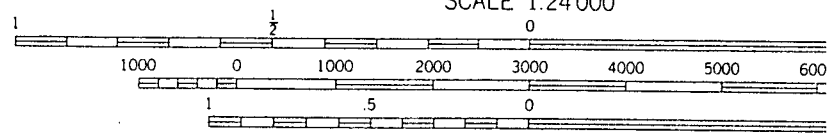

CONTOUR INTERVAL 20 FEET  
NATIONAL GEODETIC VERTICAL DATUM OF 1929

THIS MAP COMPLIES WITH NATIONAL MAP ACCURACY STANDARD  
FOR SALE BY U. S. GEOLOGICAL SURVEY, DENVER, COLORADO 80225, OR RE  
A FOLDER DESCRIBING TOPOGRAPHIC MAPS AND SYMBOLS IS AVAILABLE

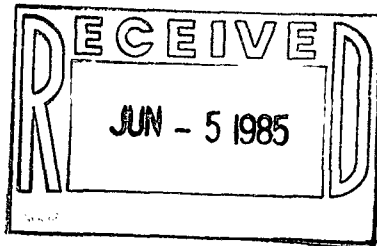

CURTIS J. LITTLE  
OIL AND GAS  
TELEPHONE (505) 327-6176  
PETROLEUM PLAZA SUITE 175  
POST OFFICE BOX 1258  
FARMINGTON, NEW MEXICO 87499

June 4, 1985

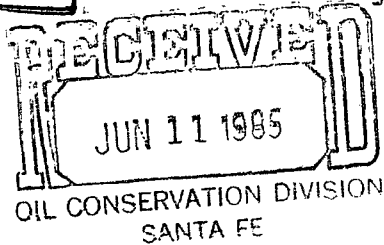

Meridian Oil, Inc.  
P. O. Box 4289  
Farmington NM 87499

Merrion Oil & Gas Co.  
P. O. Box 840  
Farmington NM 87499

Minel, Inc.  
457-C Washington SE  
Albuquerque NM 87108

Re: Application for UNORTHODOX LOCATION APPROVAL  
#12 Salazar, Sec. 21-T25N-R6W, Rio Arriba NM  
515'FNL 875'FEL Ballard Pictured Cliffs Gas Field

Gentlemen:

Please find enclosed copies of our Application for Administrative Approval for Unorthodox Location, which we are submitting to the New Mexico Oil Conservation Division. If you as an offset operator have no objection to the drilling of this well, please sign the waiver at the bottom of this page and send to:

New Mexico Oil Conservation Division  
P. O. Box 2088  
Santa Fe NM 87501

It would be appreciated if you would return a copy of the executed waiver to the undersigned, also. Thank you.

Very truly yours,

CURTIS J. LITTLE

W A I V E R

We hereby waive any objections to Curtis J. Little's Application for Unorthodox Location as set forth above.

6-5-85  
date

signature

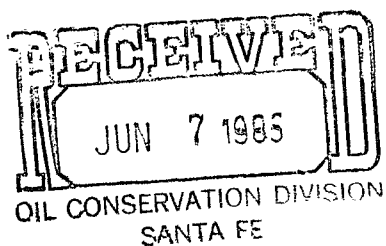

CURTIS J. LITTLE  
OIL AND GAS  
TELEPHONE (505) 327-6176  
PETROLEUM PLAZA SUITE 175  
POST OFFICE BOX 1258  
FARMINGTON, NEW MEXICO 87499

June 4, 1985

Meridian Oil, Inc.  
P. O. Box 4289  
Farmington NM 87499

Merrion Oil & Gas Co.  
P. O. Box 840  
Farmington NM 87499

Minel, Inc. ✓  
457-C Washington SE  
Albuquerque NM 87108

Re: Application for UNORTHODOX LOCATION APPROVAL  
#12 Salazar, Sec. 21-T25N-R6W, Rio Arriba NM  
515'FNL 875'FEL Ballard Pictured Cliffs Gas Field

Gentlemen:

Please find enclosed copies of our Application for Administrative Approval for Unorthodox Location, which we are submitting to the New Mexico Oil Conservation Division. If you as an offset operator have no objection to the drilling of this well, please sign the waiver at the bottom of this page and send to:

New Mexico Oil Conservation Division  
P. O. Box 2088  
Santa Fe NM 87501

It would be appreciated if you would return a copy of the executed waiver to the undersigned, also. Thank you.

Very truly yours,

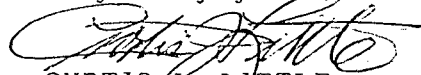
  
CURTIS J. LITTLE

W A I V E R

We hereby waive any objections to Curtis J. Little's Application for Unorthodox Location as set forth above.

6-4-85  
date

MINEL, INC. BY R.G. Seab  
signature REST- SEC

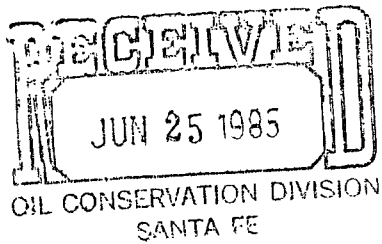

CURTIS J. LITTLE  
OIL AND GAS  
TELEPHONE (505) 327-6176  
PETROLEUM PLAZA SUITE 175  
POST OFFICE BOX 1258  
FARMINGTON, NEW MEXICO 87499

June 4, 1985

Meridian Oil, Inc.  
P. O. Box 4289  
Farmington NM 87499

Merrion Oil & Gas Co.  
P. O. Box 840  
Farmington NM 87499

Minel, Inc.  
457-C Washington SE  
Albuquerque NM 87108

Re: Application for UNORTHODOX LOCATION APPROVAL  
#12 Salazar, Sec. 21-T25N-R6W, Rio Arriba NM  
515'FNL 875'FEL Ballard Pictured Cliffs Gas Field

Gentlemen:

Please find enclosed copies of our Application for Administrative Approval for Unorthodox Location, which we are submitting to the New Mexico Oil Conservation Division. If you as an offset operator have no objection to the drilling of this well, please sign the waiver at the bottom of this page and send to:

New Mexico Oil Conservation Division  
P. O. Box 2088  
Santa Fe NM 87501

It would be appreciated if you would return a copy of the executed waiver to the undersigned, also. Thank you.

Very truly yours,

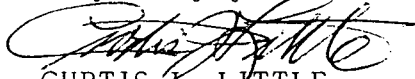
  
CURTIS J. LITTLE

W A I V E R

We hereby waive any objections to Curtis J. Little's Application for Unorthodox Location as set forth above.

June 20, 1985  
date

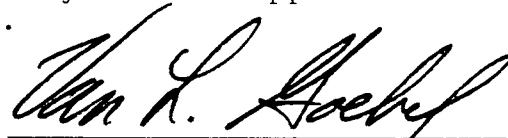
  
signature

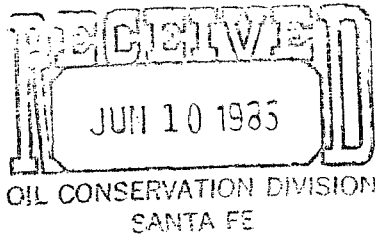

CURTIS J. LITTLE  
OIL AND GAS

TELEPHONE (505) 327-6176  
PETROLEUM PLAZA SUITE 175  
POST OFFICE BOX 1258  
FARMINGTON, NEW MEXICO 87499

June 4, 1985

Meridian Oil, Inc.  
P. O. Box 4289  
Farmington NM 87499

Merrion Oil & Gas Co.  
P. O. Box 840  
Farmington NM 87499

Minel, Inc.  
457-C Washington SE  
Albuquerque NM 87108

Re: Application for UNORTHODOX LOCATION APPROVAL  
#12 Salazar, Sec. 21-T25N-R6W, Rio Arriba NM  
515'FNL 875'FEL Ballard Pictured Cliffs Gas Field

Gentlemen:

Please find enclosed copies of our Application for Administrative Approval for Unorthodox Location, which we are submitting to the New Mexico Oil Conservation Division. If you as an offset operator have no objection to the drilling of this well, please sign the waiver at the bottom of this page and send to:

New Mexico Oil Conservation Division  
P. O. Box 2088  
Santa Fe NM 87501

It would be appreciated if you would return a copy of the executed waiver to the undersigned, also. Thank you.

Very truly yours,

CURTIS J. LITTLE

W A I V E R

We hereby waive any objections to Curtis J. Little's Application for Unorthodox Location as set forth above.

6.5.85

date

signature

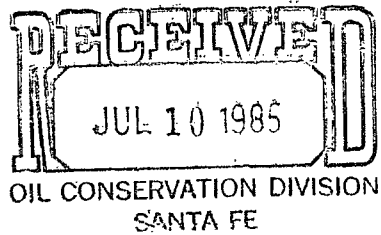

CURTIS J. LITTLE  
OIL AND GAS

TELEPHONE (505) 327-6176  
PETROLEUM PLAZA SUITE 175  
POST OFFICE BOX 1258  
FARMINGTON, NEW MEXICO 87499

July 8, 1985

State of N.M. Energy & Minerals Department  
P. O. Box 2088  
Santa Fe, New Mexico 87501

Attn: Mr. R. L. Stamets

Dear Mr. Stamets:

Please refer to Curtis J. Little's letter dated June 4, 1985, concerning an application for Administrative Approval for an unorthodox location on his Salazar #12 located 515' FNL and 875' FEL of Section 21, T25N, R6W in Rio Arriba County, N.M.

This well will be a dual well in the Ballard Pictured Cliffs gas field and the Otera Chacra gas field.

The original application indicated the Ballard Pictured Cliffs formation only.

I apologize for any inconvenience this has caused your office.

Sincerely,

A handwritten signature in cursive script, appearing to read "Joe Elledge".

Joe Elledge

JE/mw

cc: NMOCC  
1000 Rio Brazos Road  
Aztec, N.M. 87410



All distances must be from the outer boundaries of the Section.

Operator <b>CURTIS J. LITTLE</b>		Lease <b>SALAZAR</b>		Well No. <b>12</b>	
Unit Letter <b>A</b>	Section <b>21</b>	Township <b>25N</b>	Range <b>6W</b>	County <b>Rio Arriba</b>	
Actual Footage Location of Well:					
<b>515</b> feet from the <b>North</b> line and		<b>875</b> feet from the <b>East</b> line			
Ground Level Elev. <b>6318</b>	Producing Formation <b>Chacra</b>	Pool <b>Otero Chacra Extension</b>		Dedicated Acreage: <b>160</b> Acres	

1. Outline the acreage dedicated to the subject well by colored pencil or hatchure marks on the plat below.
2. If more than one lease is dedicated to the well, outline each and identify the ownership thereof (both as to working interest and royalty).
3. If more than one lease of different ownership is dedicated to the well, have the interests of all owners been consolidated by communitization, unitization, force-pooling, etc?

☐ Yes ☐ No If answer is "yes," type of consolidation \_\_\_\_\_

If answer is "no," list the owners and tract descriptions which have actually been consolidated. (Use reverse side of this form if necessary.) \_\_\_\_\_

No allowable will be assigned to the well until all interests have been consolidated (by communitization, unitization, forced-pooling, or otherwise) or until a non-standard unit, eliminating such interests, has been approved by the Commission.

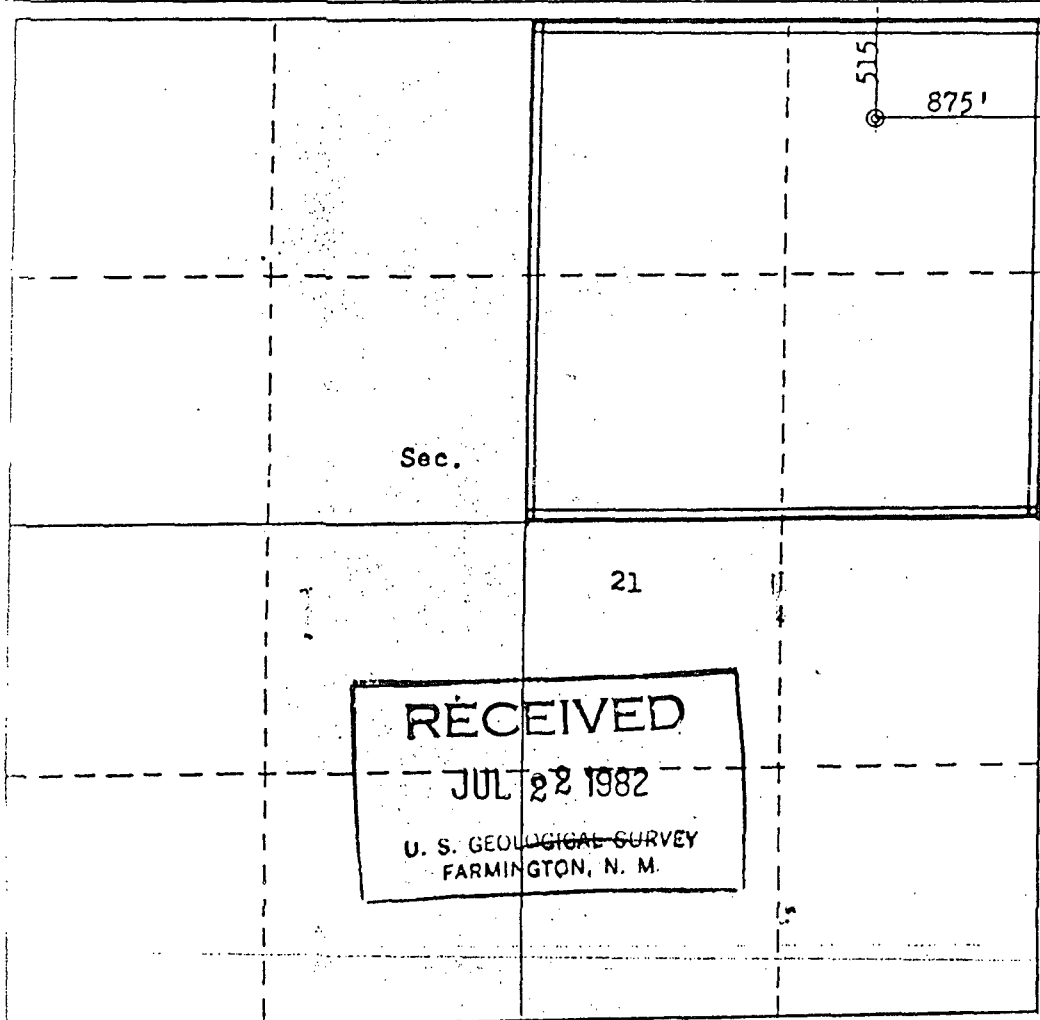

CERTIFICATION

I hereby certify that the information contained herein is true and complete to the best of my knowledge and belief.

Name *[Signature]*  
Position *Agent for Curtis J. Little*  
Company **Curtis J. Little**

Date  
**10 July 1982**

I hereby certify that the well location shown on this plat was plotted from field notes of actual surveys made by me or under my supervision, and that the same is true and correct to the best of my knowledge and belief.

Date Surveyed

**June 2, 1982**  
Registered Professional Engineer and/or Land Surveyor

*[Signature]*  
**Fred B. Kern, Jr.**

Certificate No.

**3950**

330 440 550 660 770 880 990 1100 1210 1320 1430 1540 1650 1760 1870 1980 2090 2200 2310 2420 2530 2640 2750 2860 2970 3080 3190 3300

## OIL CONSERVATION DIVISION

STATE OF NEW MEXICO  
ENERGY AND MINERALS DEPARTMENTP. O. BOX 2088  
SANTA FE, NEW MEXICO 87501Form C-102  
Revised 10-1-78

All distances must be from the outer boundaries of the Section.

Operator <b>CURTIS J. LITTLE</b>			Lease <b>SALAZAR</b>		Well No. <b>12</b>
Unit Letter <b>A</b>	Section <b>21</b>	Township <b>25N</b>	Range <b>6W</b>	County <b>Rio Arriba</b>	
Actual Footage Location of Well: <b>515</b> feet from the <b>North</b> line and <b>875</b> feet from the <b>East</b> line					
Ground Level elev. <b>6318</b>	Producing Formation <b>Pictured Cliffs</b>		Pool <b>Ballard PC Extension</b>		Dedicated Acreage: <b>160</b> Acres

1. Outline the acreage dedicated to the subject well by colored pencil or hachure marks on the plat below.
2. If more than one lease is dedicated to the well, outline each and identify the ownership thereof (both as to working interest and royalty).
3. If more than one lease of different ownership is dedicated to the well, have the interests of all owners been consolidated by communitization, unitization, force-pooling, etc?

☐ Yes ☐ No If answer is "yes," type of consolidation \_\_\_\_\_

If answer is "no," list the owners and tract descriptions which have actually been consolidated. (Use reverse side of this form if necessary.) \_\_\_\_\_

No allowable will be assigned to the well until all interests have been consolidated (by communitization, unitization, forced-pooling, or otherwise) or until a non-standard unit, eliminating such interests, has been approved by the Commission.

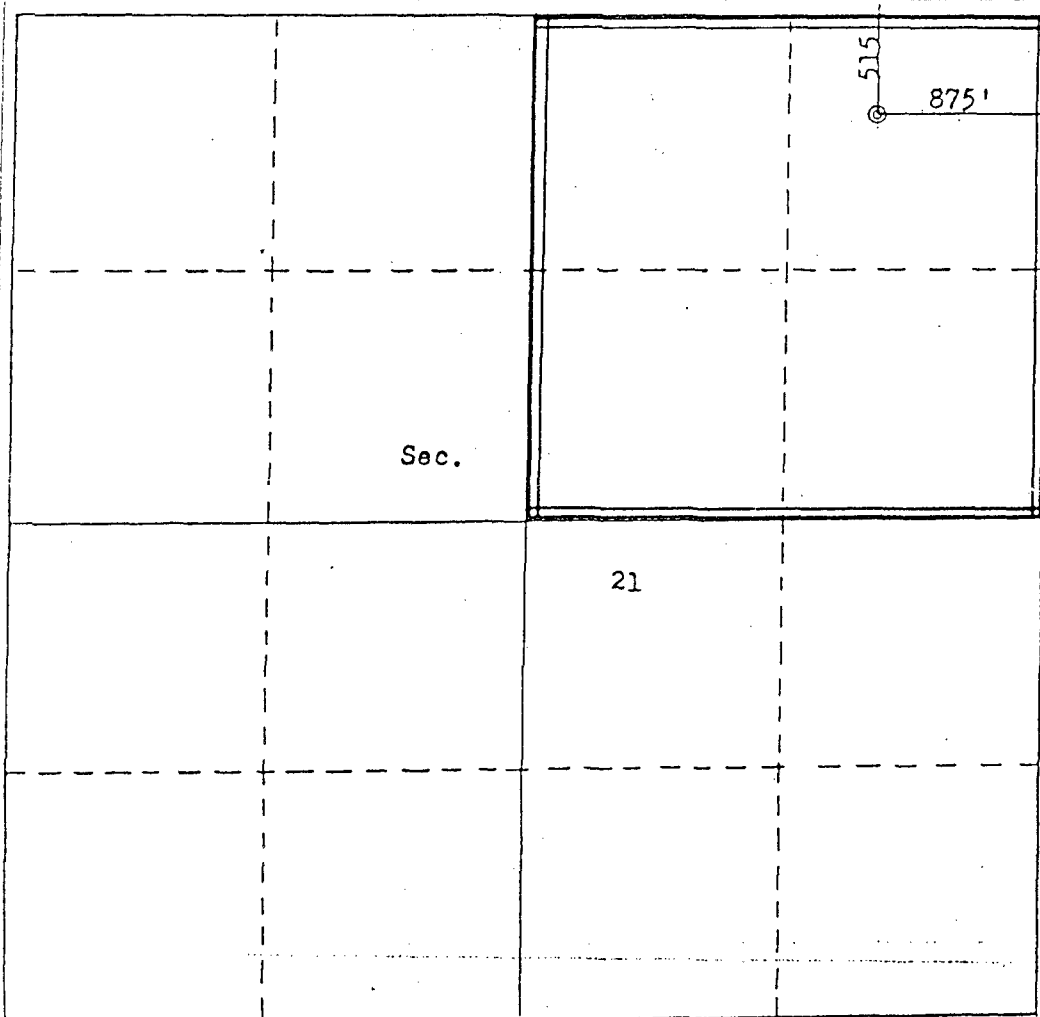

## CERTIFICATION

I hereby certify that the information contained herein is true and complete to the best of my knowledge and belief.

Name *Curtis J. Little*  
 Position *Agent for Curtis J. Little*  
 Company **Curtis J. Little**  
 Date **10 July 1982**

I hereby certify that the well location shown on this plat was plotted from field notes of actual surveys made by me or under my supervision, and that the same is true and correct to the best of my knowledge and belief.

Date Surveyed

**June 2, 1982**Registered Professional Engineer  
and/or Land Surveyor*Fred B. Kerr, Jr.*  
**Fred B. Kerr, Jr.**

Certificate No.

**3950**

0 330 660 990 1320 1650 1980 2310 2640 2000 1500 1000 500 0



STATE OF NEW MEXICO  
ENERGY AND MINERALS DEPARTMENT  
OIL CONSERVATION DIVISION  
AZTEC DISTRICT OFFICE

1000 RIO BRAZOS ROAD  
AZTEC, NEW MEXICO 87410  
(505) 334-6178

OIL CONSERVATION DIVISION  
BOX 2088  
SANTA FE, NEW MEXICO 87501

DATE 6-21-85

RE: Proposed MC \_\_\_\_\_  
Proposed DHC \_\_\_\_\_  
Proposed NSL X \_\_\_\_\_  
Proposed SWD \_\_\_\_\_  
Proposed WFX \_\_\_\_\_  
Proposed PMX \_\_\_\_\_

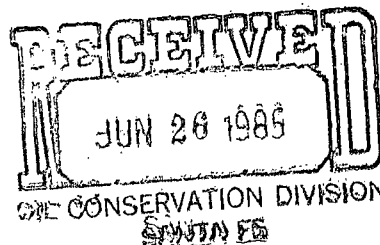

Gentlemen:

I have examined the application dated 6-10-85  
for the Curtis T. Little Oil & Gas Co. Salazar #12 A-21-25N-6W  
Operator Lease and Well No. Unit, S-T-R

and my recommendations are as follows:

Approve  
\_\_\_\_\_  
\_\_\_\_\_  
\_\_\_\_\_  
\_\_\_\_\_

Yours truly,

[Signature]