

Release July 15, 1985

By Dec

**Tenneco Oil  
Exploration and Production**  
A Tenneco Company

6162 South Willow Drive  
P.O. Box 3249  
Englewood, Colorado 80155  
(303) 740-4800



Western Rocky Mountain Division

NSL-2084  
RULE-104(FI)

Rec. 6-24-85

June 21, 1985

CERTIFIED MAIL  
Return Receipt Requested

Deal -  
E/2 { 320 Acres - Blanco Mesaverde A.1  
320 Acres - Basin Dakota A.1

New Mexico Oil Conservation Commission  
P. O. Box 2088  
Santa Fe, NM 87501  
Attn: R. L. Stamets

Blanco Mesaverde and  
Basin-Dakota Pools,

New Mexico Oil Conservation Commission  
1000 Rio Brazos Rd.  
Aztec, NM 87410  
Attn: Frank Chavez

RE: Schwedtfeger, A LS 20M  
2020' FSL, 1520' FEL  
Sec. 8, T27N R8W  
San Juan County, NM

Aztec  
District  
Office

Gentlemen:

Attached in duplicate (to each office) are a well location plat (C-102) with an ownership plat for the above referenced well.

Due to steep topography and sandstone cliffs to the south and east and a well on the south, this location does not meet state spacing requirements. This is the only geologic and topographic site acceptable.

Pursuant to the authority of Rule 104-F, we respectfully request your approval of an exemption to the standard well location requirements.

Very truly yours,

TENNECO OIL COMPANY

Scott McKinney  
Sr. Regulatory Analyst

SMc:rmn

Attachments

Page 2  
Application for Unorthodox Location  
June 21, 1985

WAIVER

\_\_\_\_\_ hereby waives objection to Tenneco Oil  
Company's application for unorthodox location for their Tenneco  
Schwedtfeger, A LS 20M, proposed above.

BY: \_\_\_\_\_

DATE: \_\_\_\_\_

SMc:srp  
Attachments

cc: Offset Operators:

El Paso Natural Gas  
Post Office Box 4990  
Farmington, NM 87401  
Attention: Don Reed

Southern Union Exploration Company  
Post Office Box 2179  
Farmington, NM 87499  
Attention: Michael Davies

## OIL CONSERVATION DIVISION

STATE OF NEW MEXICO  
ENERGY AND MINERALS DEPARTMENT

P. O. BOX 2088

SANTA FE, NEW MEXICO 87501

Form C-107  
Revised 10-1

All distances must be from the outer boundaries of the Section.

Operator <b>TENNECO OIL COMPANY</b>			Lease <b>SCHWERTFEGER A 1S</b>		Well No. <b>20M</b>
Unit Letter <b>J</b>	Section <b>8</b>	Township <b>27N</b>	Range <b>8W</b>	County <b>San Juan</b>	
Actual Footage Location of Well: <b>2020</b> feet from the <b>South</b> line and <b>1520</b> feet from the <b>East</b> line					
Ground Level Elev: <b>6733</b>	Producing Formation <b>Mesaverde/Dakota</b>		Pool <b>Blanco MV/Basin DK</b>		Dedicated Acreage: <b>320</b> Acres

1. Outline the acreage dedicated to the subject well by colored pencil or hachure marks on the plat below.
2. If more than one lease is dedicated to the well, outline each and identify the ownership thereof (both as to working interest and royalty).
3. If more than one lease of different ownership is dedicated to the well, have the interests of all owners been consolidated by communitization, unitization, force-pooling, etc?

☐ Yes ☒ No If answer is "yes," type of consolidation \_\_\_\_\_

If answer is "no," list the owners and tract descriptions which have actually been consolidated. (Use reverse side of this form if necessary.) \_\_\_\_\_

No allowable will be assigned to the well until all interests have been consolidated (by communitization, unitization, forced-pooling, or otherwise) or until a non-standard unit, eliminating such interests, has been approved by the Commission.

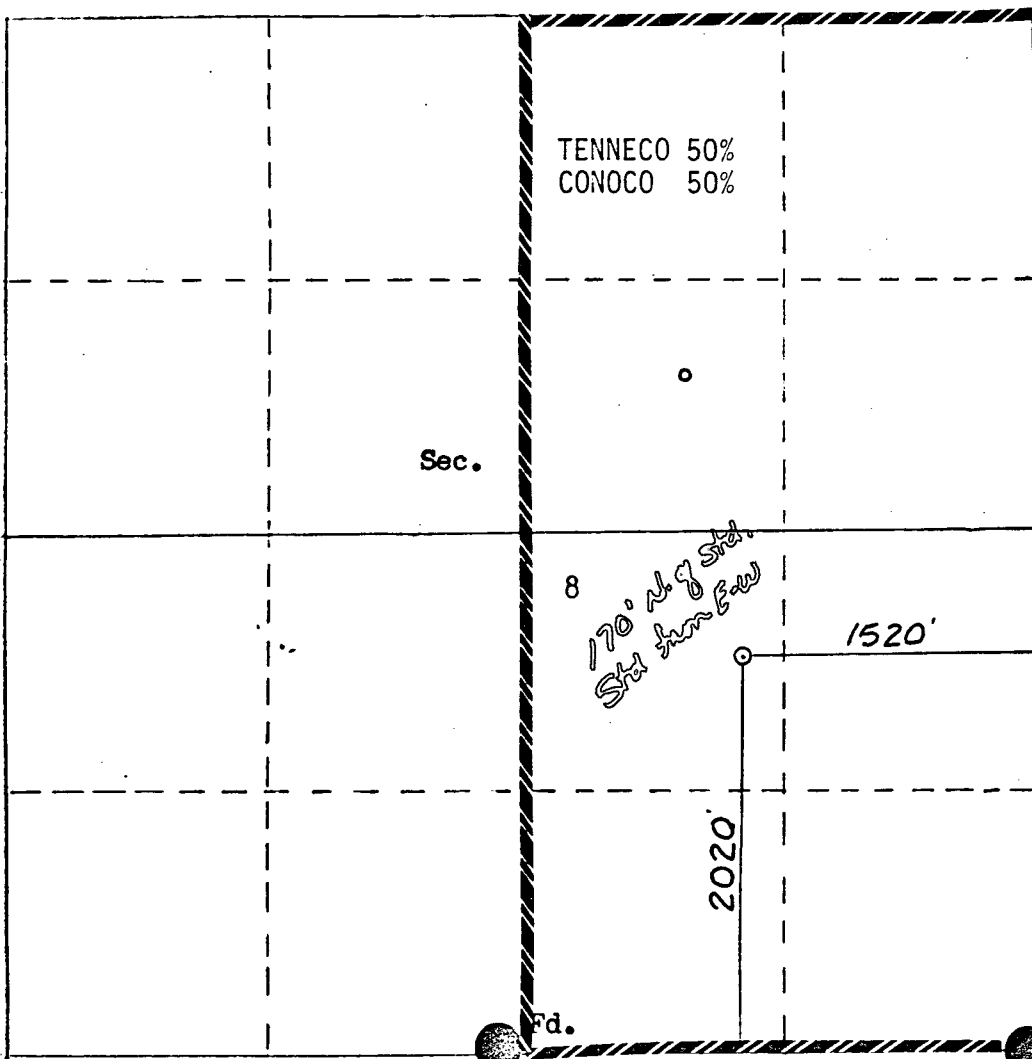

Scale: 1"=1000'

## CERTIFICATION

I hereby certify that the information contained herein is true and complete to the best of my knowledge and belief.

*Scott McKinney*

Name

Scott McKinney

Position

Sr. Regulatory Analyst

Company

Tenneco Oil Co.

Date

June 20, 1985

I hereby certify that the well location shown on this plat was plotted from field notes of actual surveys made by me or under my supervision, and that the same is true and correct to the best of my knowledge and belief.

Date Surveyed

4-19-85

Registered Professional Engineer  
and  
Surveyor

Certificate No.

8466

R. 8 W.

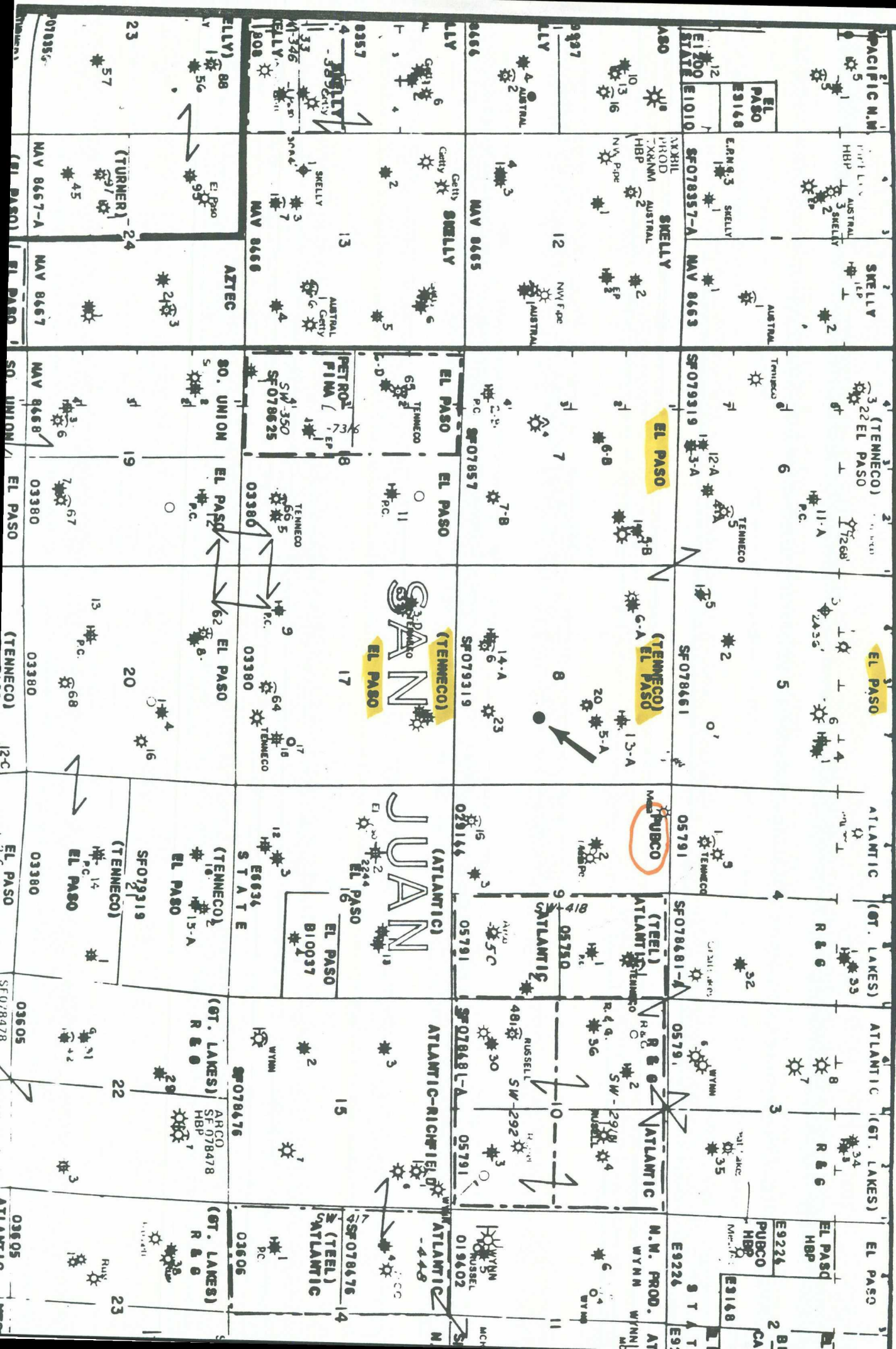

TENNECO OIL COMPANY  
#20M SCHWERTFEGER A LS  
2020FS & 1520FE  
S8 T27N R8W  
San Juan Co., N.M.

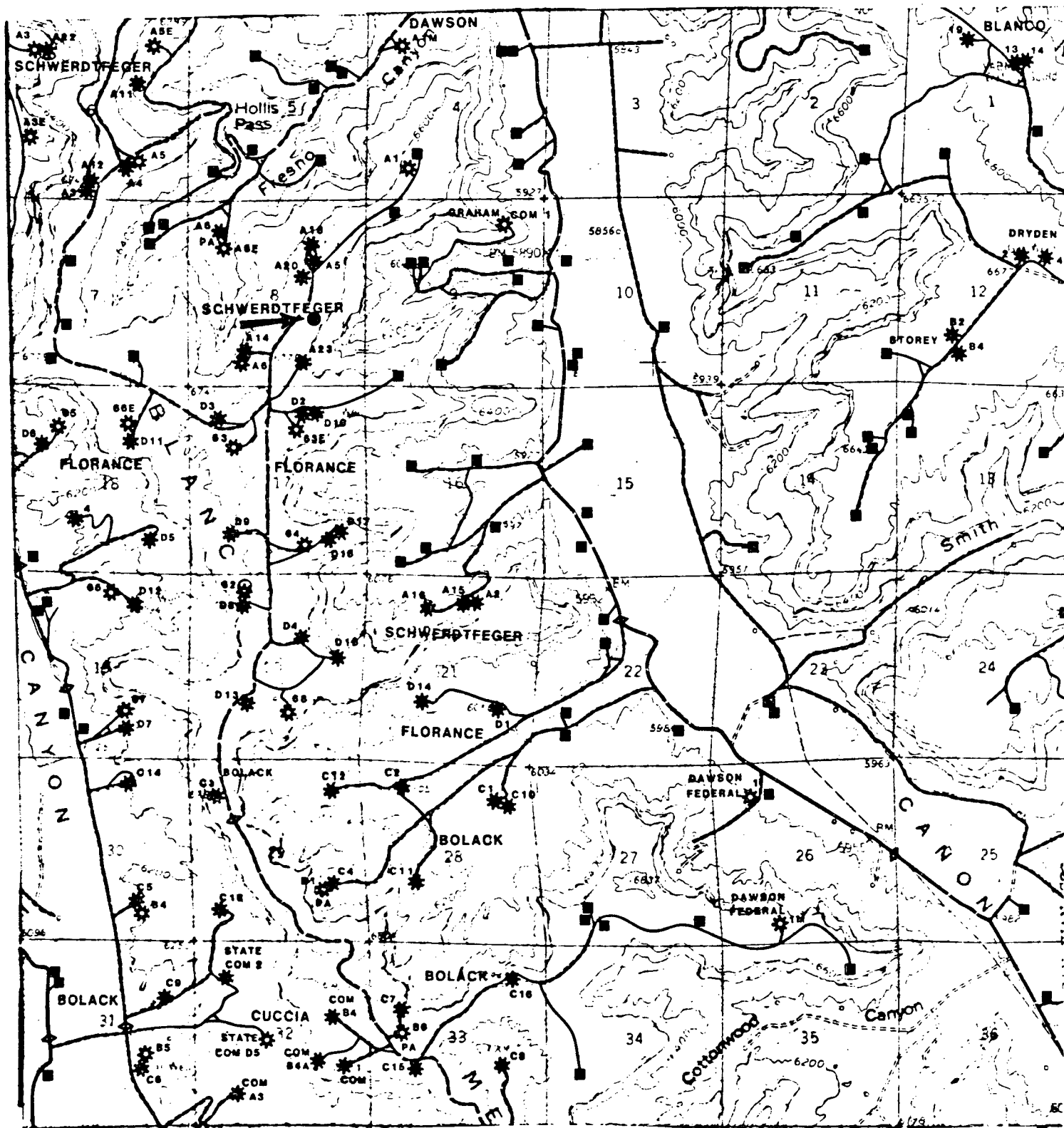

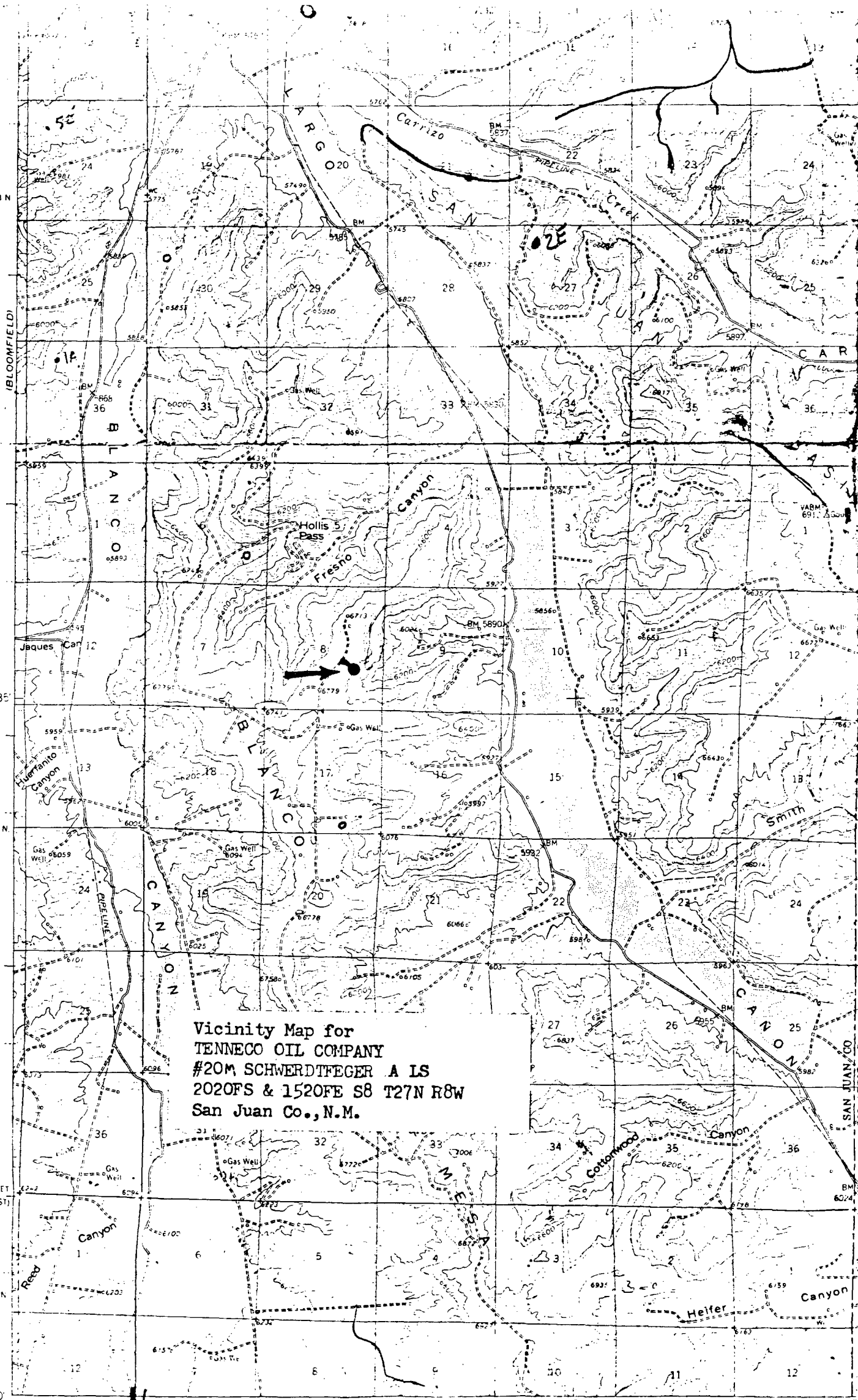

Vicinity Map for  
TENNECO OIL COMPANY  
#20M SCHWERTFEGER A LS  
2020FS & 1520FE S8 T27N R8W  
San Juan Co., N.M.

2 010 000 FEET  
(WEST)

36°30'  
107°45'

Mapped, edited, and published by the Geological Survey

Control by U.S.G.S and USC&SS

Topographic, photogrammetric methods from aerial  
photographs taken 1955; also checked 1959

Polyconic projection, 1927 North American datum  
10 000 foot grid based on New Mexico coordinate system,  
west and central zones  
1000 meter Universal Transverse Mercator grid ticks,  
zone 13, shown in blue

MAP#1

APPROXIMATE MEAN  
DECLINATION, 1959

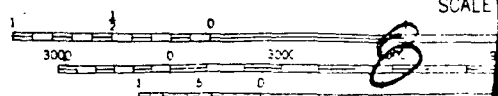

CONTOUR INTERVAL  
20 FEET

THIS MAP IS FOR SALE BY THE  
FOR SALE BY U.S. GEOLOGICAL SURVEY, DENVER  
A FOLDER DESCRIBING TOPOGRAPHIC MAPS

27-448

**Tenneco Oil**  
**Exploration and Production**  
A Tenneco Company

6162 South Willow Drive  
P.O. Box 3249  
Englewood, Colorado 80155  
(303) 740-4800



Western Rocky Mountain Division

June 21, 1985

CERTIFIED MAIL  
Return Receipt Requested

New Mexico Oil Conservation Commission  
P. O. Box 2088  
Santa Fe, NM 87501  
Attn: R. L. Stamets

New Mexico Oil Conservation Commission  
1000 Rio Brazos Rd.  
Aztec, NM 87410  
Attn: Frank Chavez

RE: Schwedtfeger, A LS 20M  
2020' FSL, 1520' FEL  
Sec. 8, T27N R8W  
San Juan County, NM

Gentlemen:

Attached in duplicate (to each office) are a well location plat (C-102) with an ownership plat for the above referenced well.

Due to steep topography and sandstone cliffs to the south and east and a well on the south, this location does not meet state spacing requirements. This is the only geologic and topographic site acceptable.

Pursuant to the authority of Rule 104-F, we respectfully request your approval of an exemption to the standard well location requirements.

Very truly yours,

TENNECO OIL COMPANY

A handwritten signature in dark ink, appearing to read "Scott McKinney", is written over the typed name.

Scott McKinney  
Sr. Regulatory Analyst

SMc:rmm

Attachments



Page 2  
Application for Unorthodox Location  
June 21, 1985

WAIVER

El Paso Natural Gas hereby waives objection to Tenneco Oil  
Company's application for unorthodox location for their Tenneco  
Schwedtfeger, A LS 20M, proposed above.

BY: Don Reed

DATE: 6-26-85

SMc:srp  
Attachments

cc: Offset Operators:

El Paso Natural Gas  
Post Office Box 4990  
Farmington, NM 87401  
Attention: Don Reed

Southern Union Exploration Company  
Post Office Box 2179  
Farmington, NM 87499  
Attention: Michael Davies





STATE OF NEW MEXICO  
ENERGY AND MINERALS DEPARTMENT  
OIL CONSERVATION DIVISION  
AZTEC DISTRICT OFFICE

NSL-2084  
1000 RIO BRAZOS ROAD  
AZTEC, NEW MEXICO 87410  
(505) 334-6178

OIL CONSERVATION DIVISION  
BOX 2088  
SANTA FE, NEW MEXICO 87501

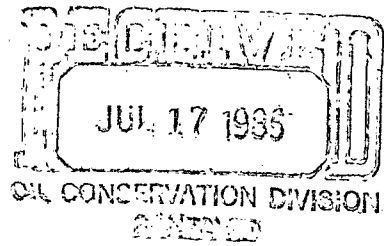

DATE 7-12-85

RE: Proposed MC \_\_\_\_\_  
Proposed DHC \_\_\_\_\_  
Proposed NSL A \_\_\_\_\_  
Proposed SWD \_\_\_\_\_  
Proposed WFX \_\_\_\_\_  
Proposed PMX \_\_\_\_\_

Gentlemen:

I have examined the application dated 6-24-85  
for the Tenneco Schweitzer ALSTOM J-8-27N-8W  
Operator Lease and Well No. Unit, S-T-R

and my recommendations are as follows:

Approve  
\_\_\_\_\_  
\_\_\_\_\_  
\_\_\_\_\_  
\_\_\_\_\_

Yours truly,

E. B. Bland