

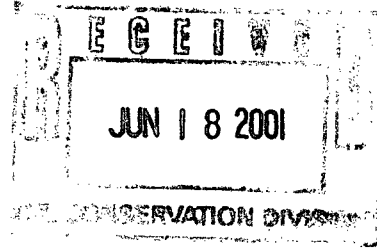

117030146 NSL 7/9/01



June 14, 2001

CERTIFIED MAIL:

Mr. Michael E. Stogner  
New Mexico Oil Conservation Division  
1220 S. Saint Francis Dr.  
Santa Fe, New Mexico 87504

RE: Application for Administrative Approval of Unorthodox Location  
XTO Energy Inc.'s Bolack C LS 15A Well  
560' FWL and 1,250' FNL (NW/4 NW/4)  
Unit D, Section 33, T27N-R8W  
San Juan County, New Mexico  
Otero Chacra Formation

Dear Mr. Stogner:

XTO Energy Inc. (XTO), formerly Cross Timbers Oil Company, hereby requests administrative approval for an unorthodox location for the above referenced well. Attached for your reference are the following exhibits:

823 29

1. Well location plat (NMOCD Form C-102)
2. Ownership map
3. List of Offset Owners

The above captioned well was drilled and completed on March 7, 1986 as a W2, 320 acre producing Mesaverde Pool unit. The unorthodox location for the Mesaverde Pool was approved under Administrative Orders NSL-2426 dated August 21, 1985 and ~~NSL-2087~~ dated October 22, 1985. XTO would like to move up the hole in the wellbore and recomple the well in the Otero Chacra Formation. The rules state that the well should be located no closer than 660' to the outer boundary of the 160-acre unit nor closer than 10 feet to any quarter-quarter section. The existing location will not conform to current footage requirements. A new well would not be economically feasible to drill for just the Otero Chacra formation. The current wellbore is in acceptable condition for the recompletion attempt with no additional work being required. By moving up the hole to the Otero Chacra formation, XTO would be able to minimize environmental impact in obtaining additional production and protection of correlative rights.

By certified mail, a copy of this application and request for administrative approval has been sent to all of the Otero Chacra formation working interest owners and offset operators listed on the attached list.

XTO would like to request your Administration Approval for the unorthodox location based on the above information. Should you need any additional information please feel free to contact me at (817) 885-2454.

Sincerely,  
XTO ENERGY INC.

A handwritten signature in black ink, appearing to read "George A. Cox", is written over the printed name.

George A. Cox, CPL  
Landman

Enclosures

cc: Gary Markestad  
Darrin Steed  
Jeff Patton  
Barry Voigt

State of New Mexico  
Energy, Minerals & Natural Resources Department

Form C-102  
Revised October 18, 199  
Instructions on back  
Submit to Appropriate District Office  
State Lease - 4 Copies  
Fee Lease - 3 Copies

OIL CONSERVATION DIVISION  
2040 South Pacheco  
Santa Fe, NM 87505

District I  
PO Box 1980, Hobbs, NM 88241-1980  
District II  
811 S. 1st Street, Artesia, NM 88210-2834  
District III  
1000 Rio Brazos Rd., Aztec, NM 87410  
District IV  
2040 South Pacheco, Santa Fe, NM 87505

☐ AMENDED REPORT

WELL LOCATION AND ACREAGE DEDICATION PLAT

<sup>1</sup> API Number 30-045-26579		<sup>2</sup> Pool Code 82329		<sup>3</sup> Pool Name Otero Chacra	
<sup>4</sup> Property Code		<sup>5</sup> Property Name Bolack C LS			<sup>6</sup> Well Number 15A
<sup>7</sup> OGRID No. 167067		<sup>8</sup> Operator Name Cross Timbers Operating Company			<sup>9</sup> Elevation 6762'

<sup>10</sup> Surface Location									
UL or lot no. D	Section 33	Township 27N	Range 8W	Lot. Idn	Feet from the 1,250'	North/South Line North	Feet from the 560'	East/West line West	County San Juan

<sup>11</sup> Bottom Hole Location If Different From Surface									
UL or lot no.	Section	Township	Range	Lot. Idn	Feet from the	North/South Line	Feet from the	East/West line	County
<sup>12</sup> Dedicated Acres 160		<sup>13</sup> Joint or Infill		<sup>14</sup> Consolidation Code		<sup>15</sup> Order No.			

NO ALLOWABLE WILL BE ASSIGNED TO THIS COMPLETION UNTIL ALL INTERESTS HAVE BEEN CONSOLIDATED  
OR A NON-STANDARD UNIT HAS BEEN APPROVED BY THE DIVISION

					<sup>17</sup> OPERATOR CERTIFICATION I hereby certify that the information contained herein is true and complete to the best of my knowledge and belief.		
					Signature Darrin Steed		
					Printed Name Operations Engineer		
					Title 6/12/01		
						<sup>18</sup> SURVEYOR CERTIFICATION I hereby certify that the well location shown on this plat was plotted from field notes of actual surveys made by me or under my supervision, and that the same is true and correct to the best of my belief.	
						Date of Survey 4/23/85	
						Signature and Seal of Professional Surveyor: Original signed by William Manke II	
						Certificate Number 8466	



STATE: NEW MEXICO COUNTY: SAN JUAN  
PROSPECT: Ownership in Chacra Formation DATE: 6/14/2001  
SECTIONS: 33 BLOCK: \_\_\_\_\_ SURVEY: \_\_\_\_\_  
ACRES: \_\_\_\_\_ TOWNSHIP: 27N RANGE: 8W

Bolack CLS#15A

SCALE: 1"=2,000'

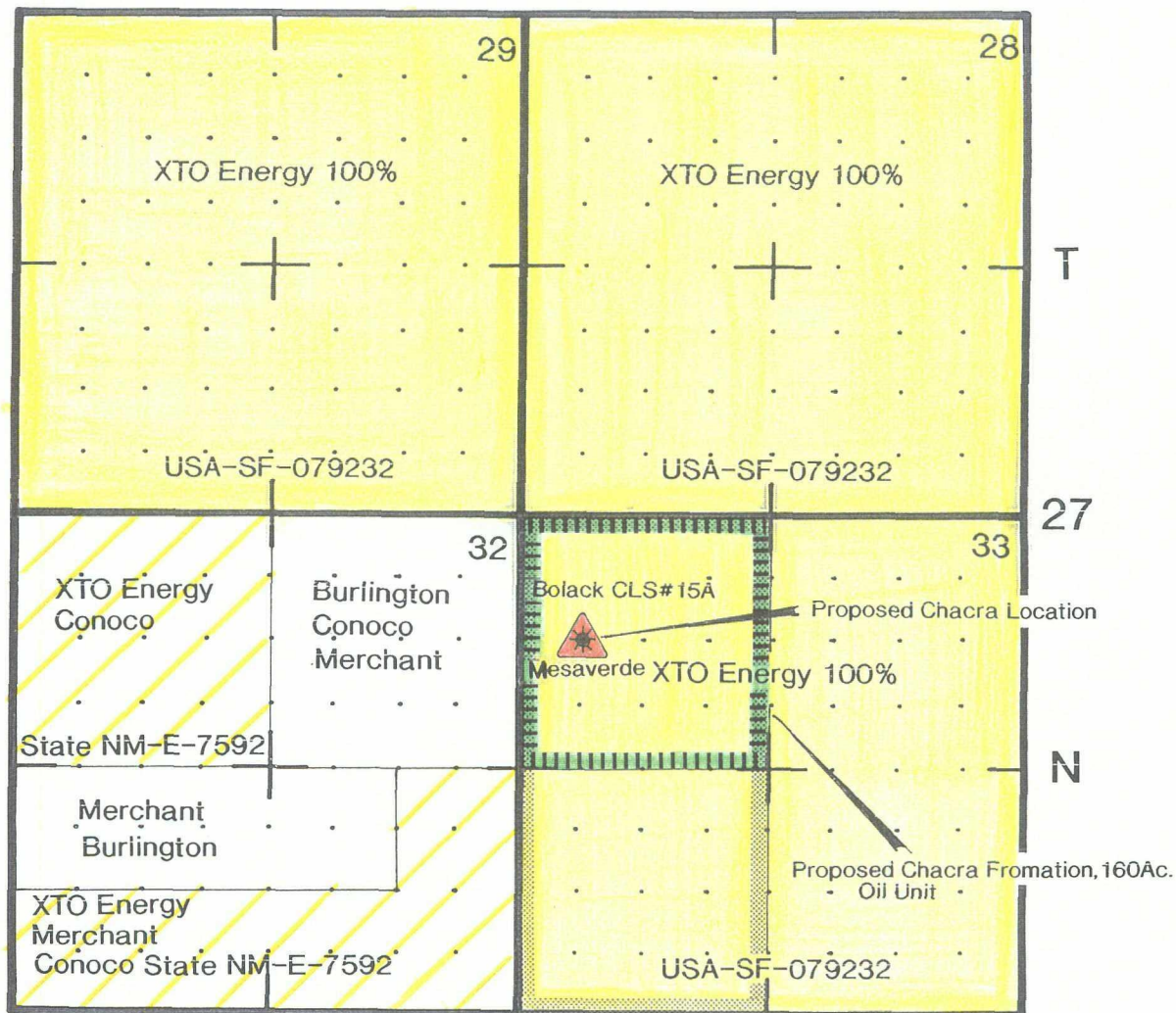

R-8-W

OFFSET OPERATORS AND OWNERS NOTIFICATION LIST  
BOLACK C LS #15A WELL

Burlington Resources Oil & Gas  
P.O. Box 4289  
Farmington, NM 87499-4289  
Attention: Dawn Howell

Taurus Exploration USA, Inc.  
2198 Bloomfield Hwy  
Farmington, NM 87404  
Attention: Rich Corcoran

Conoco Inc.  
600 North Dairy Ashford  
DU 3076  
Houston, TX 77079-1175  
Attention: Eva G. Rodriquez

Merchant Resources #1 L.P.  
Two Greenspoint Park, Suite 380-S  
16800 Greenspoint Park Drive  
Houston, TX 77060  
Attention: Walter Parlange

SENDER: COMPLETE THIS SECTION	COMPLETE THIS SECTION ON DELIVERY
<p>■ Complete items 1, 2, and 3. Also complete item 4 if Restricted Delivery is desired.</p> <p>■ Print your name and address on the reverse so that we can return the card to you.</p> <p>■ Attach this card to the back of the mailpiece, or on the front if space permits.</p>	<p>A. Received by <i>(Please Print Clearly)</i>      B. Date of Delivery</p> <hr/> <p>C. Signature  <div style="display: flex; justify-content: space-between;"> <span><b>X</b></span> <span><input type="checkbox"/> Agent <input type="checkbox"/> Addressee</span> </div> </p> <p>D. Is delivery address different from item 1? <input type="checkbox"/> Yes  If YES, enter delivery address below: <input type="checkbox"/> No</p> <hr/> <p>3. Service Type  <input type="checkbox"/> Certified Mail      <input type="checkbox"/> Express Mail  <input type="checkbox"/> Registered      <input type="checkbox"/> Return Receipt for Merchandise  <input type="checkbox"/> Insured Mail      <input type="checkbox"/> C.O.D.</p> <hr/> <p>4. Restrict</p>
<p>1. Article Addressed to:</p>  <p style="text-align: center;">     </p> <p><b>Burlington Resources</b>  <b>Ms. Dawn Howell</b>  <b>P. O. Box 4289</b>  <b>Farmington, NM 87499-4289</b>  <b>gac:6/14/01: Bolack C LS #15A</b></p>	<p>2. Article Number <i>(Copy from service label)</i></p> <p style="text-align: right; font-weight: bold;">7099 3400 0013 9835 9565</p>
<p>PS Form 3811, July 1999      Domestic Return Receipt      102595-00-M-0952</p>	

SENDER: COMPLETE THIS SECTION	COMPLETE THIS SECTION ON DELIVERY
<p>■ Complete items 1, 2, and 3. Also complete item 4 if Restricted Delivery is desired.</p> <p>■ Print your name and address on the reverse so that we can return the card to you.</p> <p>■ Attach this card to the back of the mailpiece, or on the front if space permits.</p>	<p>A. Received by <i>(Please Print Clearly)</i>      B. Date of Delivery</p> <hr/> <p>C. Signature  <div style="display: flex; justify-content: space-between;"> <span><b>X</b></span> <span><input type="checkbox"/> Agent <input type="checkbox"/> Addressee</span> </div> </p> <p>D. Is delivery address different from item 1? <input type="checkbox"/> Yes  If YES, enter delivery address below: <input type="checkbox"/> No</p> <hr/> <p>3. Service Type  <input type="checkbox"/> Certified Mail      <input type="checkbox"/> Express Mail  <input type="checkbox"/> Registered      <input type="checkbox"/> Return Receipt for Merchandise  <input type="checkbox"/> Insured Mail      <input type="checkbox"/> C.O.D.</p> <hr/> <p>4. Re:      <input type="checkbox"/> Yes</p>
<p>1. Article Addressed to:</p>  <p style="text-align: center;">     </p> <p><b>Taurus Exploration, USA, Inc.</b>  <b>Mr. Rich Corcoran</b>  <b>2198 Bloomfield Hwy</b>  <b>Farmington, NM 87404</b>  <b>gac:6/14/01: Bolack C LS #15A</b>  <b>.. .. .</b></p>	<p>2. Article Number <i>(Copy from service label)</i></p> <p style="text-align: right; font-weight: bold;">7099 3400 0013 9835 9572</p>
<p>PS Form 3811, July 1999      Domestic Return Receipt      102595-00-M-0952</p>	

**SENDER: COMPLETE THIS SECTION**

- Complete items 1, 2, and 3. Also complete item 4 if Restricted Delivery is desired.
- Print your name and address on the reverse so that we can return the card to you.
- Attach this card to the back of the mailpiece, or on the front if space permits.

1. Article Addressed to:



**Conoco Inc.**  
**Ms. Eva Rodriguez**  
**600 North Dairy Ashford, DU3076**  
**Houston, TX 77079-1175**  
**gac:6/14/01:Bohack C LS #15A**

2. Article Number (Copy from service label)

**COMPLETE THIS SECTION ON DELIVERY**

A. Received by (Please Print Clearly) B. Date of Delivery

C. Signature

**X**☐ Agent  
☐ AddresseeD. Is delivery address different from item 1? ☐ YesIf YES, enter delivery address below: ☐ No

3. Service Type

☐ Certified Mail ☐ Express Mail  
☐ Registered ☐ Return Receipt for Merchandise  
☐ Insured Mail ☐ C.O.D.

4. Restr

Yes

**7099 3400 0013 9835 9558**

PS Form 3811, July 1999

Domestic Return Receipt

102595-00-M-0952

**SENDER: COMPLETE THIS SECTION**

- Complete items 1, 2, and 3. Also complete item 4 if Restricted Delivery is desired.
- Print your name and address on the reverse so that we can return the card to you.
- Attach this card to the back of the mailpiece, or on the front if space permits.

1. Article Addressed to:



**Merchant Resources #1 L.P.**  
**Mr. Walter Parlange**  
**Two Greenspoint Park, Suite 380-S**  
**16800 Greenspoint Park Drive**  
**Houston, TX 77060**  
**gac:6/14/01:Bohack C LS #15A**

2. Article Number (Copy from service label)

**COMPLETE THIS SECTION ON DELIVERY**

A. Received by (Please Print Clearly) B. Date of Delivery

C. Signature

**X**☐ Agent  
☐ AddresseeD. Is delivery address different from item 1? ☐ YesIf YES, enter delivery address below: ☐ No

3. Service Type

☐ Certified Mail ☐ Express Mail  
☐ Registered ☐ Return Receipt for Merchandise  
☐ Insured Mail ☐ C.O.D.

4. Restr

Yes

**7099 3400 0013 9836 0738**

PS Form 3811, July 1999

Domestic Return Receipt

102595-00-M-0952



June 14, 2001

**CERTIFIED MAIL:**

Burlington Resources Oil & Gas  
P.O. Box 4289  
Farmington, NM 87499-4289  
Attention: Dawn Howell

RE: Application for Administrative Approval of Unorthodox Location  
XTO Energy Inc.'s Bolack C LS 15A Well  
560' FWL and 1,250' FNL (NW/4 NW/4)  
Unit D, Section 33, T27N-R8W  
San Juan County, New Mexico  
Otero Chacra Formation

Gentlemen:

Enclosed please find a copy of the above captioned application that has been sent to the NMOCD for administrative approval. Should you not agree with the request, please notify the NMOCD within 20 days of the date of this application. Should you have any questions, concerning the operations, please feel free to contact me at (817) 885-2454.

Sincerely,  
XTO ENERGY INC.

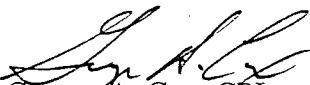

George A. Cox, CPL

Landman

Enclosures





June 14, 2001

**CERTIFIED MAIL:**

Taurus Exploration USA, Inc.  
2198 Bloomfield Hwy  
Farmington, NM 87404  
Attention: Rich Corcoran

RE: Application for Administrative Approval of Unorthodox Location  
XTO Energy Inc.'s Bolack C LS 15A Well  
560' FWL and 1,250' FNL (NW/4 NW/4)  
Unit D, Section 33, T27N-R8W  
San Juan County, New Mexico  
Otero Chacra Formation

Gentlemen:

Enclosed please find a copy of the above captioned application that has been sent to the NMOCD for administrative approval. Should you not agree with the request, please notify the NMOCD within 20 days of the date of this application. Should you have any questions, concerning the operations, please feel free to contact me at (817) 885-2454.

Sincerely,  
XTO ENERGY INC.

  
George A. Cox, CPL  
Landman

Enclosures



June 14, 2001

**CERTIFIED MAIL:**

Conoco Inc.  
600 North Dairy Ashford  
DU 3076  
Houston, TX 77079-1175  
Attention: Eva G. Rodriquez

RE: Application for Administrative Approval of Unorthodox Location  
XTO Energy Inc.'s Bolack C LS 15A Well  
560' FWL and 1,250' FNL (NW/4 NW/4)  
Unit D, Section 33, T27N-R8W  
San Juan County, New Mexico  
Otero Chacra Formation

Gentlemen:

Enclosed please find a copy of the above captioned application that has been sent to the NMOCD for administrative approval. Should you not agree with the request, please notify the NMOCD within 20 days of the date of this application. Should you have any questions, concerning the operations, please feel free to contact me at (817) 885-2454.

Sincerely,  
XTO ENERGY INC.

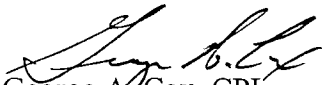
  
George A. Cox, CPL  
Landman

Enclosures



June 14, 2001

**CERTIFIED MAIL:**

Merchant Resources #1 L.P.  
Two Greenspoint Park, Suite 380-S  
16800 Greenspoint Park Drive  
Houston, TX 77060  
Attention: Walter Parlange

RE: Application for Administrative Approval of Unorthodox Location  
XTO Energy Inc.'s Bolack C LS 15A Well  
560' FWL and 1,250' FNL (NW/4 NW/4)  
Unit D, Section 33, T27N-R8W  
San Juan County, New Mexico  
Otero Chacra Formation

Gentlemen:

Enclosed please find a copy of the above captioned application that has been sent to the NMOCD for administrative approval. Should you not agree with the request, please notify the NMOCD within 20 days of the date of this application. Should you have any questions, concerning the operations, please feel free to contact me at (817) 885-2454.

Sincerely,  
XTO ENERGY INC.

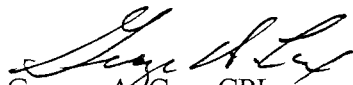
  
George A. Cox, CPL  
Landman

Enclosures

7-15-01

8-7-01

Talked w/  
Steve today  
on this.  
Will ~~check~~  
from m.s.



State of New Mexico  
OIL CONSERVATION COMMISSION

MICHAEL E. STOONER  
PETROLEUM ENGINEER

# Memo

To Steve Hayden and Charlie Perrin

Attached is a copy of an NSL  
request by XTO Perith Bolack  
C-LS #15-B.

I've received it and am ready  
to release an order, I'll await  
Steve's comments. Thanks.

*Michael Stoner*

P.O. BOX 2088  
LAND OFFICE BUILDING  
SANTA FE, NEW MEXICO 87501  
505-827-5811

## **Stogner, Michael**

---

**From:** Hayden, Steven  
**Sent:** Tuesday, August 07, 2001 9:23 AM  
**To:** Stogner, Michael  
**Cc:** Ezeanyim, Richard  
**Subject:** XTO NSL applications: T.L. Rhodes C #3, Krause WN Federal #1R, Bolack C LS # 15A

Mike, in answer to your request I have reviewed these NSL applications. The T>L> Rhodes C #3 and the Krause WN Federal # 1 R are applications to recomplete to the Kutz Gallup Pool and are non-standard due to being less than 330' from an interior line in the respective Dakota GPUs. XTO originally called me for guidance and I assigned them to the Kutz Gallup. I have no objection to these NSL applications.

The Bolack C LS #15A NSL app is for the Otero Chacra Pool and this is a member of the Cliff House Fm of the Mesaverde Group. Since the well already has a nonstandard location order for the Mesaverde, I see no reason it should not be extended to cover the Chacra.



Steve Hayden  
NM OCD District III  
1000 Rio Brazos Rd.  
Aztec, NM 87410

[shayden@state.nm.us](mailto:shayden@state.nm.us)  
(505) 334-6178 Ext. 14  
Fax: (505) 334-6170

CMD :  
OG5SECT

ONGARD  
INQUIRE LAND BY SECTION

08/07/01 10:07:46  
OGOMES -TQB1  
PAGE NO: 1

Sec : 33 Twp : 27N Rng : 08W Section Type : NORMAL

D 40.00  Federal owned  A	C 40.00  Federal owned	B 40.00  Federal owned	A 40.00  Federal owned  A
E 40.00  Federal owned  A	F 40.00  Federal owned	G 40.00  Federal owned	H 40.00  Federal owned

PF01 HELP  
PF07 BKWD

PF02  
PF08 FWD

PF03 EXIT  
PF09 PRINT

PF04 GoTo  
PF10 SDIV

PF05  
PF11

PF06  
PF12

CMD :  
OG5SECT

ONGARD  
INQUIRE LAND BY SECTION

08/07/01 10:07:50  
OGOMES -TQB1  
PAGE NO: 2

Sec : 33 Twp : 27N Rng : 08W Section Type : NORMAL

L 40.00	K 40.00	J 40.00	I 40.00
Federal owned	Federal owned	Federal owned	Federal owned
A			A A
M 40.00	N 40.00	O 40.00	P 40.00
Federal owned	Federal owned	Federal owned	Federal owned

PF01 HELP  
PF07 BKWD

PF02  
PF08 FWD

PF03 EXIT  
PF09 PRINT

PF04 GoTo  
PF10 SDIV

PF05  
PF11

PF06  
PF12

CMD : ONGARD 08/07/01 10:08:00  
OG6IWCM INQUIRE WELL COMPLETIONS OGOMES -TQB1

API Well No : 30 45 26579 Eff Date : 01-01-1998 WC Status : A  
Pool Idn : 72319 BLANCO-MESAVERDE (PRORATED GAS)  
OGRID Idn : 167067 CROSS TIMBERS OPERATING COMPANY  
Prop Idn : 22596 BOLACK C LS

Well No : 015A  
GL Elevation: 6762

	U/L	Sec	Township	Range	North/South	East/West	Prop/Act (P/A)
B.H. Locn	: D	33	27N	08W	FTG 1250 F N FTG	560 F W	P

Lot Identifier:

Dedicated Acre: 320.00

Lease Type : F

Type of consolidation (Comm, Unit, Forced Pooling - C/U/F/O) :

M0025: Enter PF keys to scroll

PF01 HELP	PF02	PF03 EXIT	PF04 GoTo	PF05	PF06
PF07	PF08	PF09	PF10 NEXT-WC	PF11 HISTORY	PF12 NXTREC



County San Juan Pool Otero-Chacra

TOWNSHIP 27 North Range 8 West NMPM

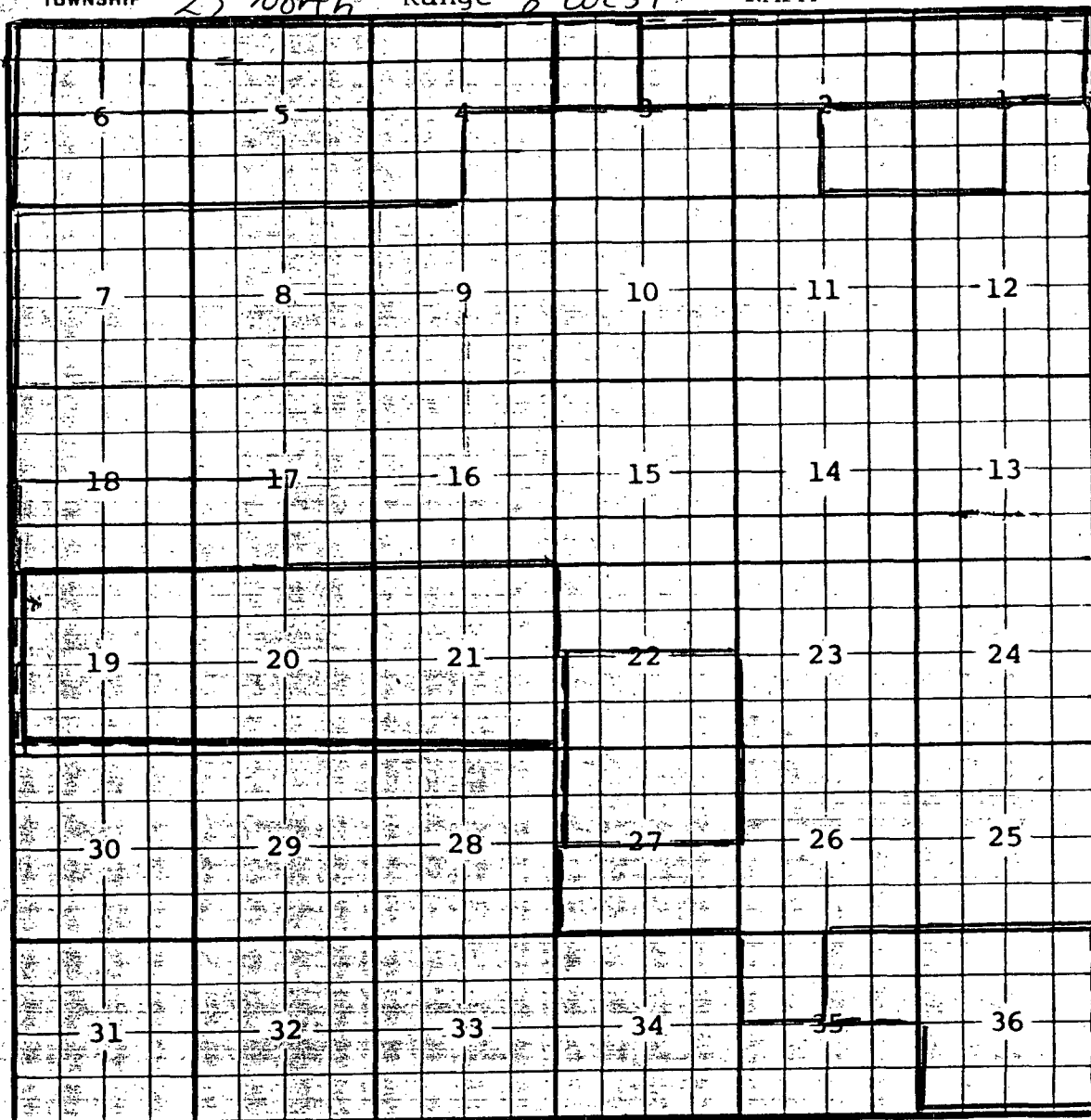

Ext:  $\frac{SE}{4}$  Sec. 1,  $\frac{SW}{4}$  Sec. 2,  $\frac{S}{2}$  Sec. 3,  $\frac{SE}{4}$  Sec. 4, All Secs. 7 through 16,  
 $\frac{N}{2}$  and  $\frac{SE}{4}$  Sec. 17,  $\frac{N}{2}$  Sec. 18,  $\frac{N}{2}$  Sec. 22, All Secs. 23 through 26,  $\frac{S}{2}$  Sec. 27,  
 $\frac{NW}{4}$  Sec. 35 (R-7201, 2-7-83) Ext:  $\frac{NW}{4}$  Sec. 3 (R-7764, 1-8-85)  
Ext:  $\frac{SW}{4}$  Sec. 1,  $\frac{SE}{4}$  Sec. 2,  $\frac{SW}{4}$  Sec. 17,  $\frac{S}{2}$  Sec. 18,  $\frac{S}{2}$  Sec. 22,  $\frac{N}{2}$  Sec. 27 (R-10178, 8-30-94)  
Ext: All Secs. 19 through 21 (R-10519, 11-20-95) Ext:  $\frac{N}{2}$  Sec. 1,  $\frac{N}{2}$  Sec. 2,  $\frac{NE}{4}$  Sec. 3  
(R-10676, 10-1-96) Ext:  $\frac{NE}{4}$  Sec. 35, All Sec. 36 (R-10788, 4-9-97)  
Ext:  $\frac{N}{2}$  and  $\frac{SW}{4}$  Sec. 4, All Secs. 5 and 6 (R-10902, 10-17-97)