

District I
1625 N French Dr., Hobbs, NM 88240
District II
1301 W Grand Avenue, Artesia, NM 88210
District III
1000 Rio Brazos Road, Aztec, NM 87410
District IV
1220 S. St Francis Dr., Santa Fe, NM 87505

State of New Mexico
Energy Minerals and Natural Resources
Oil Conservation Division
1220 South St. Francis Dr.
Santa Fe, NM 87505

Form C-141
Revised October 10, 2003

Submit 2 Copies to appropriate
District Office in accordance
with Rule 116 on back
side of form

Release Notification and Corrective Action

OPERATOR

☒ Initial Report

☐ Final Report

Name of Company: Occidental Permian Limited Partnership	Contact: Tony Summers
Address: 1017 West Stanolind Road, Hobbs, N.M. 88240	Telephone No: 505.397.8236 or 505.390.9228
Facility Name Myers Langlie Mattix Unit South Injection line	Facility Type Production - Injection line #245

Surface Owner - Kelly Myers	Mineral Owner Oxy/BLM	Lease No.
-----------------------------	-----------------------	-----------

LOCATION OF RELEASE

API# 30025/10420000

Unit Letter N	Section 7	Township 24S	Range 37E	Feet from the	North/South Line	Feet from the	East/West Line	County Lea
------------------	--------------	-----------------	--------------	---------------	------------------	---------------	----------------	------------

Latitude _____ Longitude _____

NATURE OF RELEASE

Type of Release Line leak - produced water	Volume of Release 150 bw	Volume Recovered 50 bw
Source of Release Injection line	Date and Hour of Occurrence 08/24/07 6:30am	Date and Hour of Discovery 08/24/07 8:00am
Was Immediate Notice Given? <input checked="" type="checkbox"/> Yes <input type="checkbox"/> No <input type="checkbox"/> Not Required	If YES, To Whom? Pat Caperton	
By Whom? Tony Summers	Date and Hour 08/24/07 2:00pm	
Was a Watercourse Reached? <input type="checkbox"/> Yes <input checked="" type="checkbox"/> No	If YES, Volume Impacting the Watercourse	

If a Watercourse was Impacted, Describe Fully.*

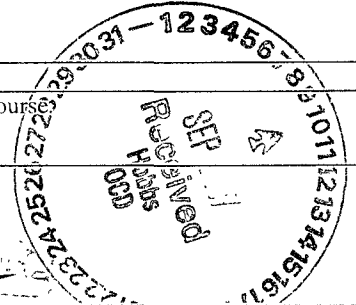

Describe Cause of Problem and Remedial Action Taken.* Leak was discovered by lease operator 89:00am Line was immediately shut in. Leak occurred in on a steel connection in a buried fiberglass line, corrosion. Vacuum truck was called and picked up 50 bbls of free standing produced water. Approximately 150 barrels of produced water were spilled Average chlorides for this water is 13000 ppm.

Describe Area Affected and Cleanup Action Taken.* Spill was in sandy area with limited vegetation. Contaminated soil will be removed down to NMOCD standards and replaced with clean soil. See attached map of spill site. According to NMOSE website, nearest depth to ground water found (sec 5) is 106' giving a ranking of 10

I hereby certify that the information given above is true and complete to the best of my knowledge and understand that pursuant to NMOCD rules and regulations all operators are required to report and/or file certain release notifications and perform corrective actions for releases which may endanger public health or the environment. The acceptance of a C-141 report by the NMOCD marked as "Final Report" does not relieve the operator of liability should their operations have failed to adequately investigate and remediate contamination that pose a threat to ground water, surface water, human health or the environment. In addition, NMOCD acceptance of a C-141 report does not relieve the operator of responsibility for compliance with any other federal, state, or local laws and/or regulations.

Signature: <u>Tony Summers</u>	OIL CONSERVATION DIVISION	
Printed Name: Tony Summers	Approved by District Supervisor. ENVIRONMENTAL ENGINEER	
Title: HES Technician	Approval Date: 9.17.07	Expiration Date: 11.16.07
E-mail Address: tony_summers@oxy.com	Conditions of Approval:	
Date: 8-28-07 Phone: 505.397.8236	Completed BY <u>[Signature]</u>	
		Attached <input type="checkbox"/>

* Attach Additional Sheets If Necessary

MLMU Injection
Leak South 8-24-07
Produced w/ r leak

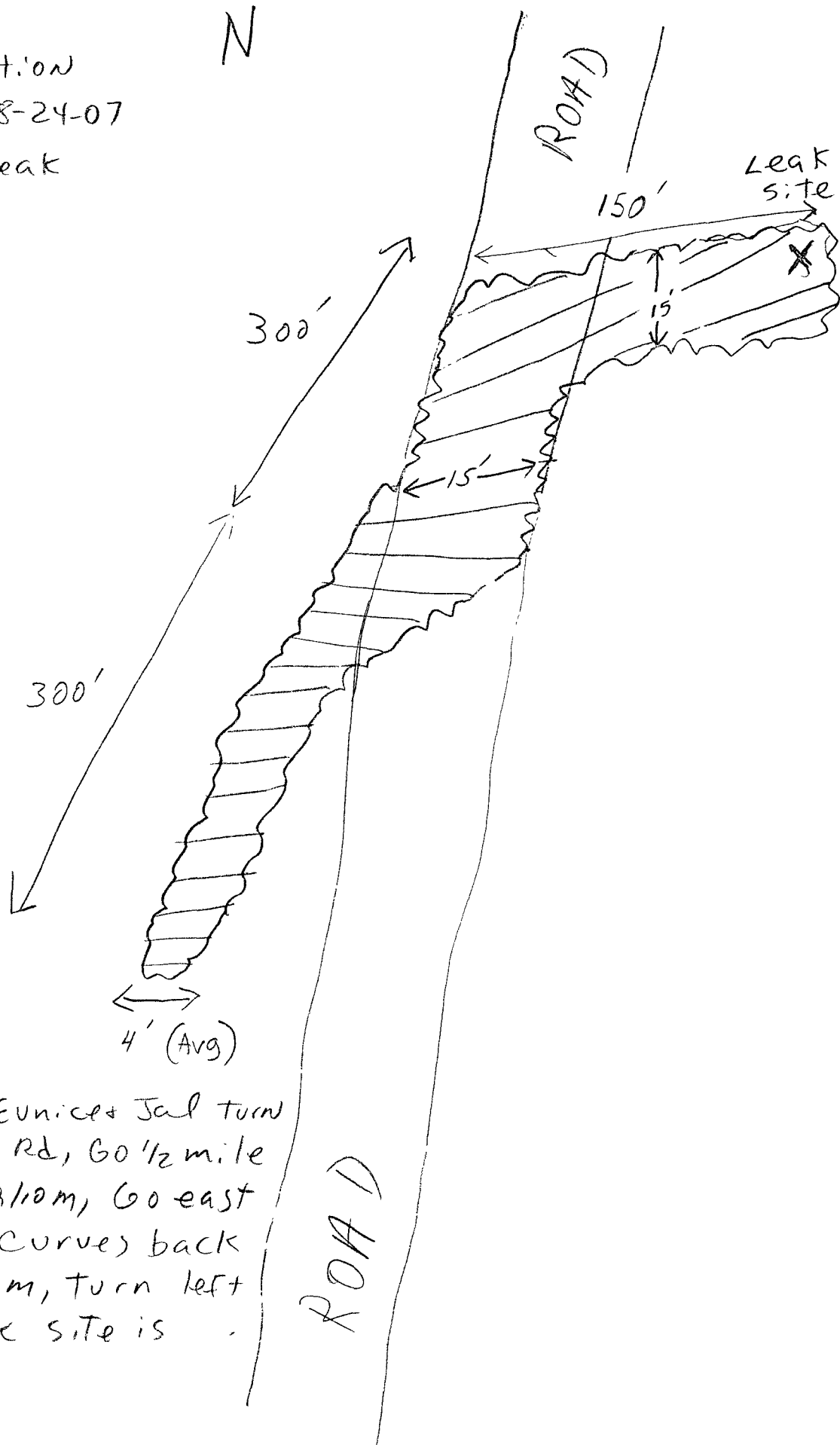

OFF Hwy 18 between Eunice & Jal turn
west on Deep Wells Rd, Go 1/2 mile
to tee, Go south 2/10 m, Go east
1/10 m where road curves back
south west for 1.1 m, turn left
for 1/10 m & leak site is
Left of road