

Release Date  
Aug 3, 1987

By DRC



**PHILLIPS PETROLEUM COMPANY**

ODESSA, TEXAS 79762  
4001 PENBROOK

EXPLORATION AND PRODUCTION GROUP

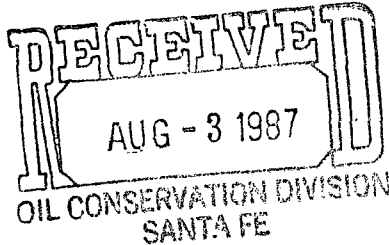

July 28, 1987

Order R-5897-Expansion of  
Authority by Administrative Action  
East Vacuum Grayburg/San Andres Unit,  
Well No. 3374-004  
Vacuum Grayburg/San Andres Unit  
Lea County, New Mexico

NSL-2373  
RULE-104 F(I)

New Mexico Department of Energy  
Oil and Gas Conservation Division  
P. O. Box 2088  
Santa Fe, New Mexico 87501

Attn: William J. Lemay  
Director

*Vacuum Grayburg San Andres Pool  
to Area dedication NW 1/4 SW 1/4*

*1950 FS  
210 FW Section 33, T-17 South, R-35 East.*

Gentlemen:

Administrative approval, provided by Order No. R-5897 and Statewide Rule 104 F (III) (IV), is requested to permit drilling the unorthodox location of subject well.

There are no offset operators to this proration unit other than Phillips Petroleum Co. However, Exxon Company, USA and Mobil Producing Co. have been notified by copy of this application according to Statewide Rule 102(c).

Please find attached a project plat identifying all producing and injection wells therein, and a statement explaining the necessity for this location.

Your early consideration is appreciated. Contact me at (915) 367-1488 if you have any questions.

Yours very truly,

*Larry M. Sanders*

Larry M. Sanders, Supervisor  
Regulation and Proration

LMS/JD/lsw  
REG/PRO6/evgsaul

Attachment

cc: New Mexico Dept. of Energy and Minerals  
Oil Conservation Division  
P. O. Box 1980  
Hobbs, New Mexico 88240

Exxon Co. USA  
P. O. Box 1600  
Midland, TX 79702-1600

Mobil Producing Texas and New Mexico, Inc.  
Nine Greenway Plaza, Ste. 2700  
Houston, Texas 77046

NO. OF COPIES RECEIVED	
DISTRIBUTION	
SANTA FE	
FILE	
U.S.G.S.	
LAND OFFICE	
OPERATOR	

5A. Indicate Type of Lease  
STATE ☒ FEE ☐

5. State Oil & Gas Lease No.  
B-2863-1

APPLICATION FOR PERMIT TO DRILL, DEEPEN, OR PLUG BACK

1a. Type of Work b. Type of Well OIL WELL <input checked="" type="checkbox"/> GAS WELL <input type="checkbox"/> OTHER <input type="checkbox"/> DRILL <input checked="" type="checkbox"/> DEEPEN <input type="checkbox"/> PLUG BACK <input type="checkbox"/> SINGLE ZONE <input checked="" type="checkbox"/> MULTIPLE ZONE <input type="checkbox"/>		7. Unit Agreement Name East Vacuum Gb/SA Unit
2. Name of Operator Phillips Petroleum Company		8. Farm or Lease Name East Vacuum Gb/SA Unit
3. Address of Operator Room 401, 4001 Penbrook St., Odessa, Texas 79762		9. Well No. Tract 3374 004
4. Location of Well UNIT LETTER L LOCATED 1980 FEET FROM THE South LINE AND 210 FEET FROM THE West LINE OF SEC. 33 TWP. 17-S RGE. 35-E NMPM		10. Field and Pool, or Wildcat Vacuum Gb/SA
11. Elevations (Show whether DF, RT, etc.) 3951.0 GL (Unprepared)		12. County Lea
21A. Kind & Status Plug. Bond Blanket	19. Proposed Depth 4800'	19A. Formation Grayburg San Andres
21B. Drilling Contractor advise later	20. Rotary or C.T. Rotary	
22. Approx. Date Work will start Upon approval		

23.

PROPOSED CASING AND CEMENT PROGRAM

SIZE OF HOLE	SIZE OF CASING	WEIGHT PER FOOT	SETTING DEPTH	SACKS OF CEMENT	EST. TOP
12-1/4	8-5/8	24#	1600'	1000 sk "C"	surface
7-7/8	5-1/2	15.5#	4800'	1400 sk "C"	surface

Use mud additives as required for control.

BOP Equipment: Series 900, 3000# WP (See attached schematic - Figure 7-9 or 7-10)

IN ABOVE SPACE DESCRIBE PROPOSED PROGRAM; IF PROPOSAL IS TO DEEPEN OR PLUG BACK, GIVE DATA ON PRESENT PRODUCTIVE ZONE AND PROPOSED NEW PRODUCTIVE ZONE. GIVE BLOWOUT PREVENTER PROGRAM, IF ANY.

I hereby certify that the information above is true and complete to the best of my knowledge and belief.

Signed W.J. Mueller Title Eng. Supervisor, Reservoir Date 7/27/87

(This space for State Use)

APPROVED BY \_\_\_\_\_ TITLE \_\_\_\_\_ DATE \_\_\_\_\_

CONDITIONS OF APPROVAL, IF ANY:

**NEW MEXICO OIL CONSERVATION COMMISSION  
WELL LOCATION AND ACREAGE DEDICATION PLAT**

Form C-102  
Supersedes C-128  
Effective 1-1-65

All distances must be from the outer boundaries of the Section.

Operator <b>Phillips Petroleum Company</b>			Lease <b>EVGSAU</b>		Well No. <b>3374-004</b>
Unit Letter <b>L</b>	Section <b>33</b>	Township <b>17 South</b>	Range <b>35 East</b>	County <b>Lea</b>	
Actual Footage Location of Well: <div style="display: flex; justify-content: space-between;"> <span>1950 feet from the South line and</span> <span>210 feet from the West line</span> </div>					
Ground Level Elev. <b>3951.0</b>	Producing Formation <b>Grayburg San Andres</b>		Pool <b>Vacuum</b>		Dedicated Acreage: <b>40</b> Acres

1. Outline the acreage dedicated to the subject well by colored pencil or hachure marks on the plat below.
2. If more than one lease is dedicated to the well, outline each and identify the ownership thereof (both as to working interest and royalty).
3. If more than one lease of different ownership is dedicated to the well, have the interests of all owners been consolidated by communitization, unitization, force-pooling, etc?

☒ Yes    ☐ No    If answer is "yes," type of consolidation Unitization

If answer is "no," list the owners and tract descriptions which have actually been consolidated. (Use reverse side of this form if necessary.) \_\_\_\_\_

No allowable will be assigned to the well until all interests have been consolidated (by communitization, unitization, forced-pooling, or otherwise) or until a non-standard unit, eliminating such interests, has been approved by the Commission.

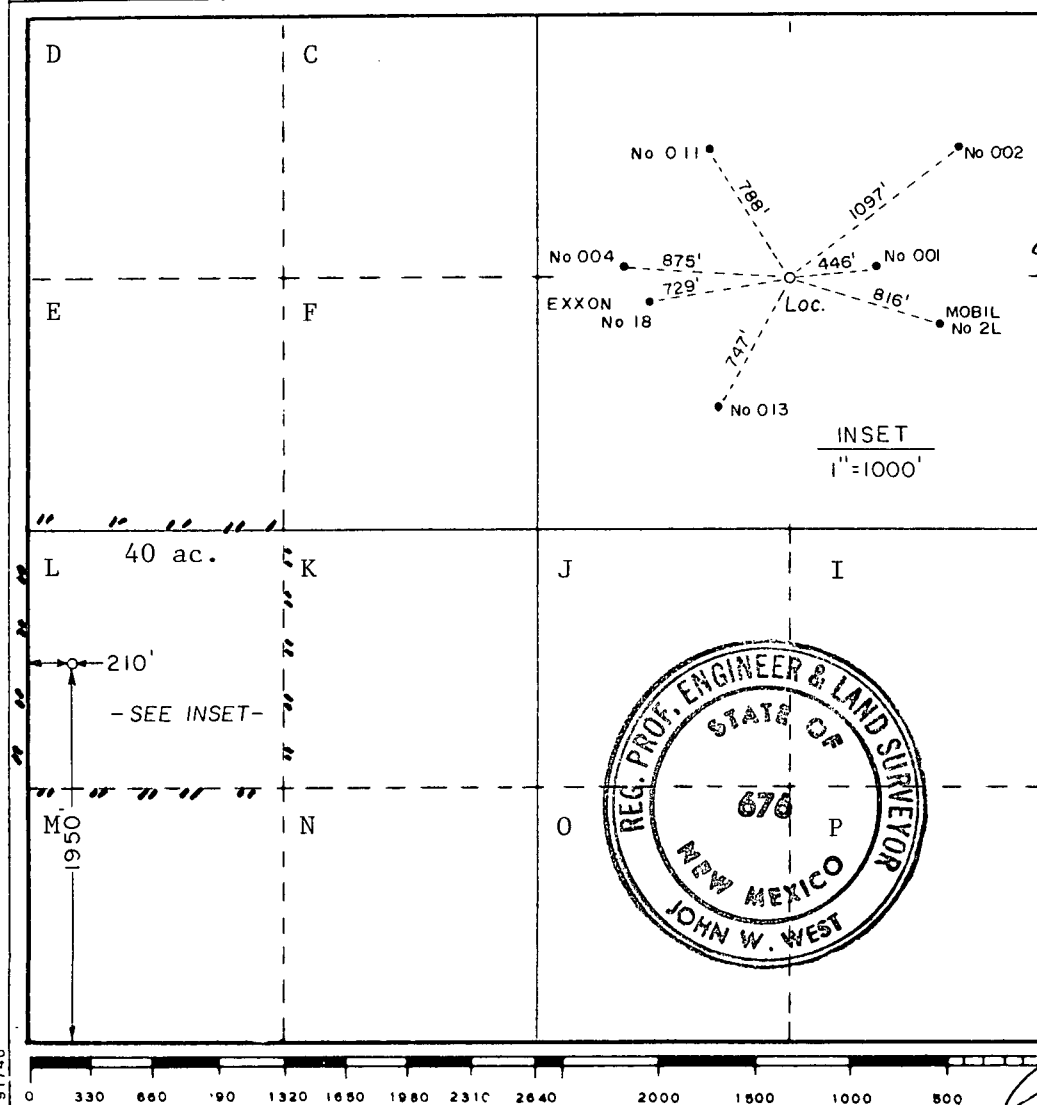

**CERTIFICATION**

I hereby certify that the information contained herein is true and complete to the best of my knowledge and belief.

*[Signature]*  
Name  
**W. J. Mueller**

Position  
**Eng. Supervisor, Reservoir**

Company  
**Phillips Petroleum Company**

Date  
**7/29/87**

I hereby certify that the well location shown on this plat was plotted from field notes of actual surveys made by me or under my supervision, and that the same is true and correct to the best of my knowledge and belief.

Date Surveyed  
**July 9, 1987**

Registered Professional Engineer and/or Land Surveyor

*[Signature]*  
Certificate No. **JOHN W. WEST, 676**  
**RONALD J. EIDSON, 3239**

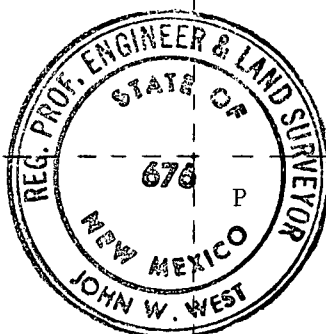

# FIELD PRACTICES AND STANDARDS

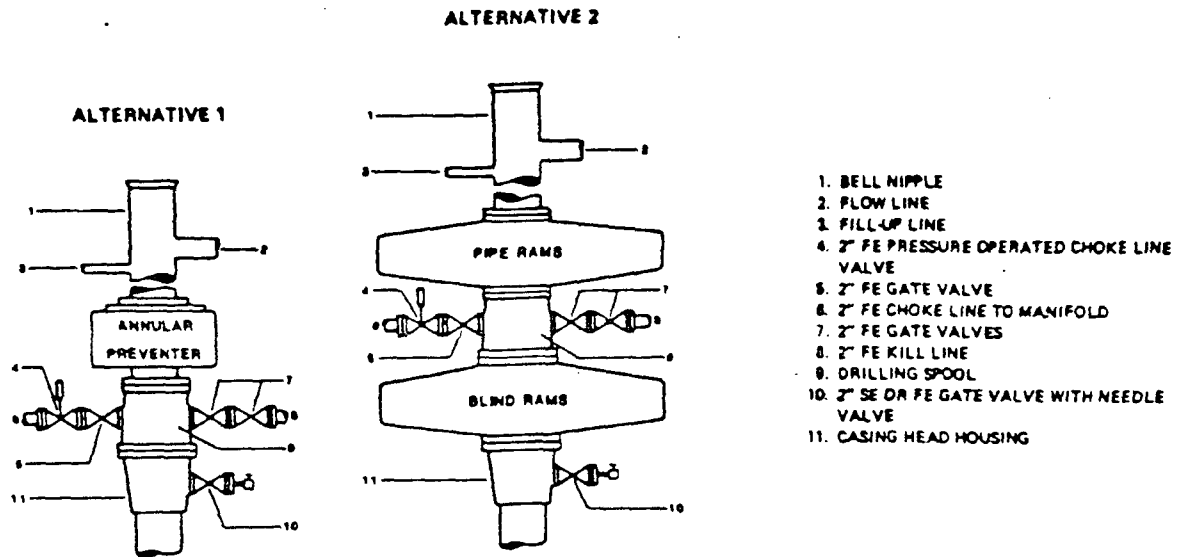

NOTE: THE DRILLING SPOOL MAY BE LOCATED BELOW BOTH SETS OF RAMS IF A DOUBLE PREVENTER IS USED AND IT DOES NOT HAVE SUITABLE OUTLETS BETWEEN RAMS

Figure 7-9. Standard Hydraulic Blowout Preventer Assembly (2 M or 3 M Working Pressure) Alternative 1

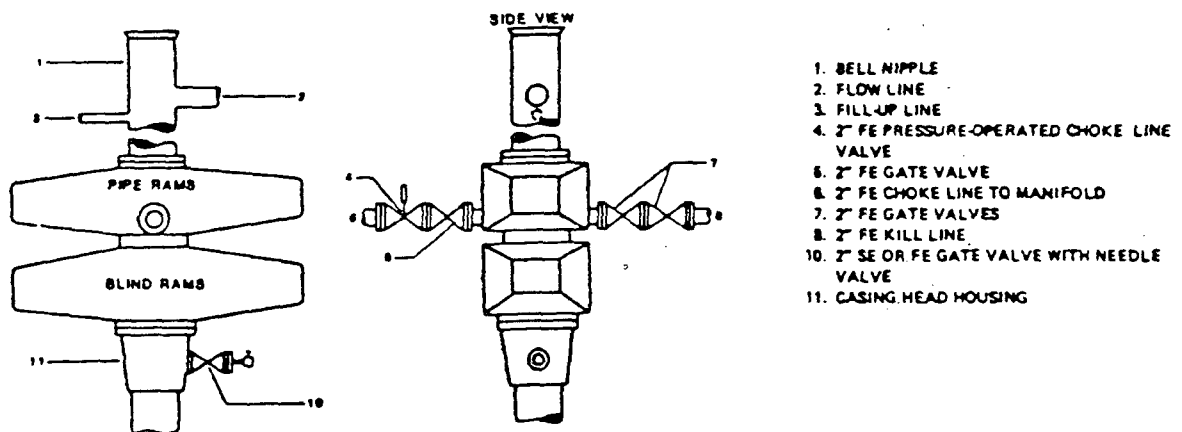
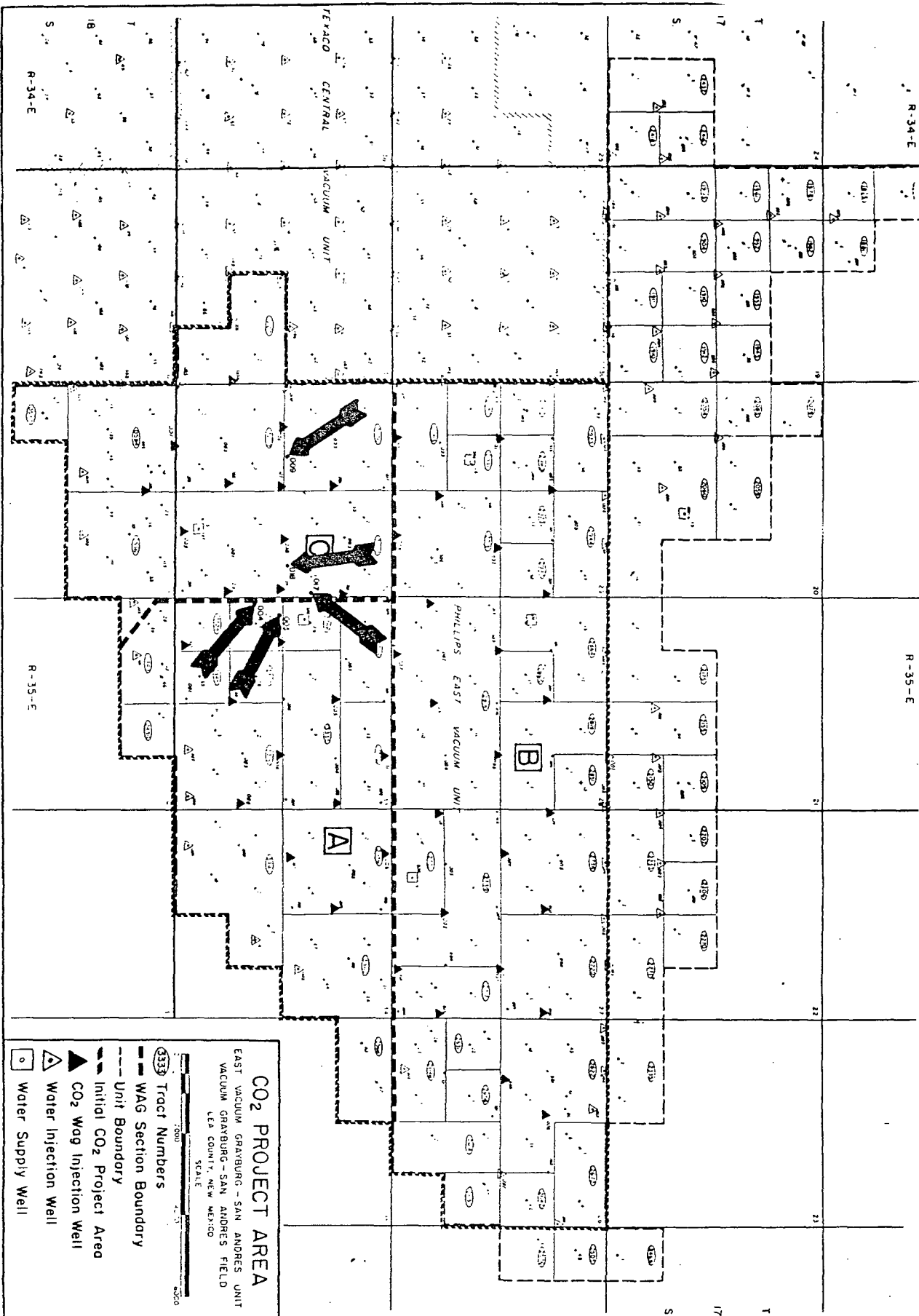

Figure 7-10. Standard Hydraulic Blowout Preventer Assembly (2 M or 3 M Working Pressure) Alternative 3 (without Drilling Spool)

EAST VACUUM GRAYBURG/SAN ANDRES UNIT  
Lea County, New Mexico  
Well No. 3374-004

The proposed infill producer is required to convert a 40-acre five spot pattern within the WAG Area to a 40-acre inverted nine-spot pattern. The 10-acre infill location will increase the WAG flood efficiency by producing oil currently trapped between adjacent injectors.

REG/PR06/evgsau



P 140 239 363

RECEIPT FOR CERTIFIED MAIL

NO INSURANCE COVERAGE PROVIDED  
NOT FOR INTERNATIONAL MAIL

(See Reverse)

PS Form 3800, Feb. 1982

★ U.S.G.P.O. 1984-446-014

Sent to	Mobil Producing TX & NM
Street and No.	572200
State and ZIP Code	Plaza
Postage	Houston, TX 77046
Certified Fee	\$
Special Delivery Fee	
Restricted Delivery Fee	
Return Receipt Showing to whom and Date Delivered	
Return receipt showing to whom, Date, and Address of Delivery	
TOTAL Postage and Fees	\$
Postmark or Date	

CERTIFIED

P 140 239 363

MAIL

P 140 239 362

RECEIPT FOR CERTIFIED MAIL

NO INSURANCE COVERAGE PROVIDED  
NOT FOR INTERNATIONAL MAIL

(See Reverse)

PS Form 3800, Feb. 1982

★ U.S.G.P.O. 1984-446-014

Sent to	Exxon Co USA
Street and No.	P.O. Box 1600
State and ZIP Code	Midland, TX 79702-1600
Postage	\$
Certified Fee	
Special Delivery Fee	
Restricted Delivery Fee	
Return Receipt Showing to whom and Date Delivered	
Return receipt showing to whom, Date, and Address of Delivery	
TOTAL Postage and Fees	\$
Postmark or Date	

CERTIFIED

P 140 239 362

MAIL



STATE OF NEW MEXICO  
ENERGY AND MINERALS DEPARTMENT  
OIL CONSERVATION DIVISION

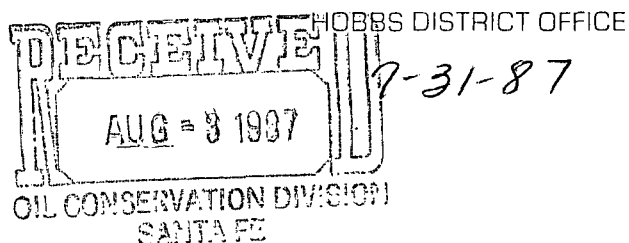

GARREY CARRUTHERS  
GOVERNOR

POST OFFICE BOX 1980  
HOBBS, NEW MEXICO 88241-1980  
(505) 393-6161

OIL CONSERVATION DIVISION  
P. O. BOX 2088  
SANTA FE, NEW MEXICO 87501

RE: Proposed:

MC	_____
DHC	_____
NSL	<u>X</u> <u>2373</u>
NSP	_____
SWD	_____
WFX	_____
PMX	_____

Gentlemen:

I have examined the application for the:

<u>Phillips Pet Co. East Vacuum GB-LA 2nd Tr. 3374 #4-L</u>			
Operator	Lease & Well No.	Unit	S-T-R
			<u>33-17-35</u>

and my recommendations are as follows:

\_\_\_\_\_  
\_\_\_\_\_  
\_\_\_\_\_

Yours very truly,

Jerry Sexton  
Supervisor, District 1

/ed



R-33-E

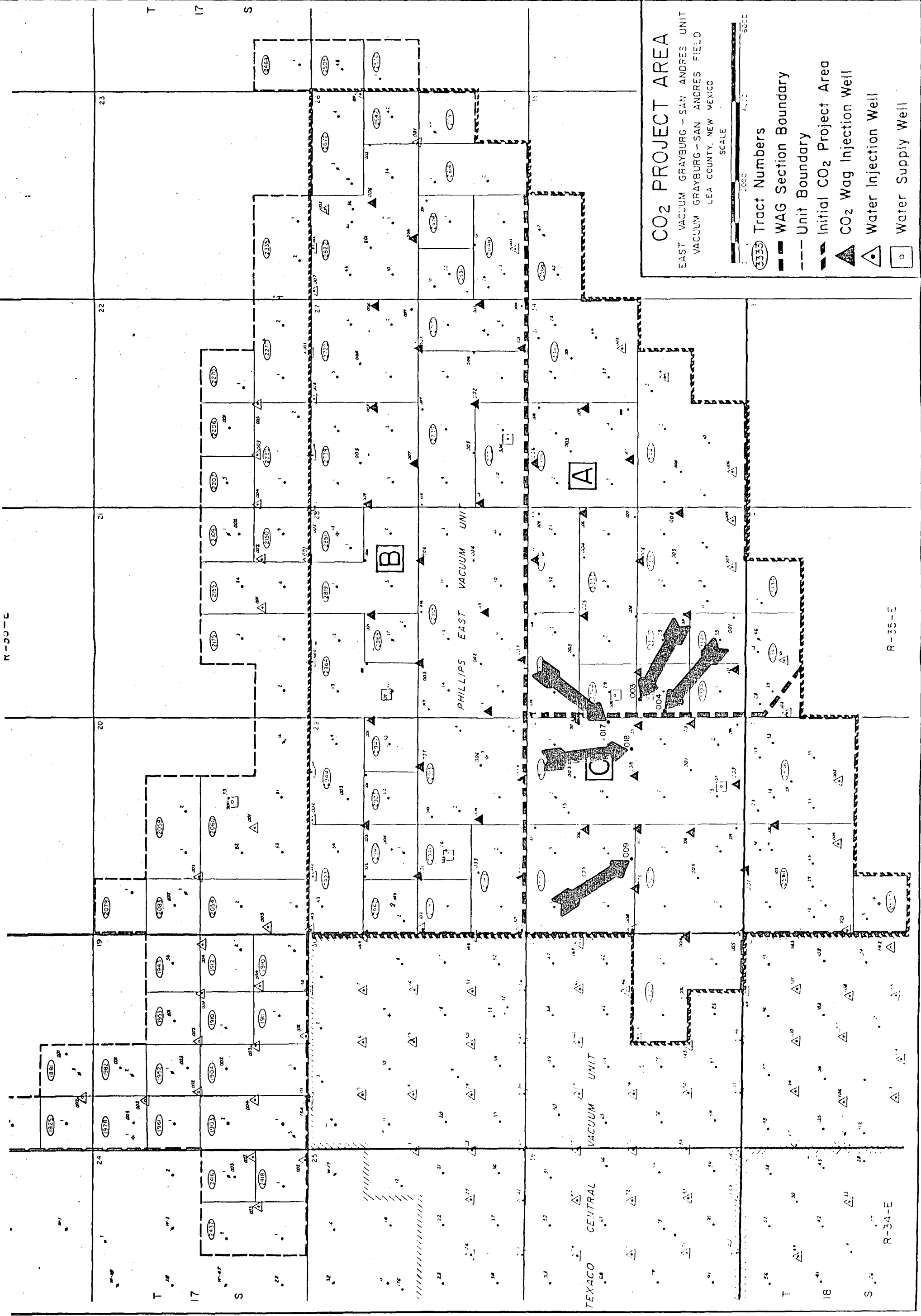

**CO2 PROJECT AREA**  
EAST VACUUM GRAYBURG - SAN ANDRES UNIT  
VACUUM GRAYBURG - SAN ANDRES FIELD  
LEA COUNTY, NEW MEXICO

SCALE  
0 1000 2000 3000 4000 5000 6000

3335 Tract Numbers  
--- WAG Section Boundary  
--- Unit Boundary  
▲ Initial CO2 Project Area  
▲ CO2 WAG Injection Well  
○ Water Injection Well

R-35-E

R-34-E