

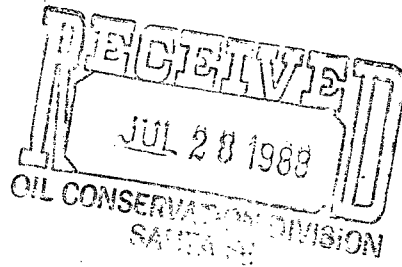

Release Date:
July 28,
1988



By DRC

OXY USA INC.
Box 50250, Midland, TX 79710

July 25, 1988

Energy and Minerals Department
Oil Conservation Division
P.O. Box 2088
Santa Fe, New Mexico 87501

Attention: William J. Lemay

NSL-2568
RULE-104F(E)

Undesignated East Area
Marathon Gas Pool
320 Acres Ad. N/2 Sec 2

RE: Request for Administrative Approval for an
Unorthodox Location for OXY USA Inc.'s State
EB Well No. 1, Located 840'FNL & 1400'FEL of
Sec. 2-T24S-R23E, Eddy County, New Mexico

Dear Mr. Lemay:

B

OXY USA Inc. respectfully requests Administrative Approval for an unorthodox location for the above captioned well. The subject drilling location is not an orthodox location, as per State requirements, for the proration unit, the N/2 of Sec. 2-T24S-R23E, Eddy County, New Mexico. The location was staked at this location, 840'FNL & 1400'FEL of Sec. 2-T24S-R23E, because of the extremely rugged and mountainous terrain at the orthodox location, 660'FNL & 1980'FEL of Sec. 2, and to minimize surface disturbance. Topography would not allow the well to be drilled at the orthodox location. Also, please be advised that OXY is the only offsetting operator of the proration unit dedicated to this well.

Thank you for your consideration of our request.

Very truly yours,

OXY USA Inc.

F. A. Vitrano

F. A. Vitrano
District Operations Manager - Production
Midland District
E & P Division

FAV:JME:jme
attachments

cc: New Mexico Oil Conservation Commission
District 2 Office
P.O. Drawer DD
Artesia, New Mexico 88210

NO. OF COPIES RECEIVED	
DISTRIBUTION	
SANTA FE	
FILE	
U.S.G.S.	
LAND OFFICE	
OPERATOR	

NEW MEXICO OIL CONSERVATION COMMISSION

Form C-101
Revised 1-1-65

5A. Indicate Type of Lease	
STATE <input checked="" type="checkbox"/>	FEE <input type="checkbox"/>
5. State Oil & Gas Lease No.	
LM 2083	

APPLICATION FOR PERMIT TO DRILL, DEEPEN, OR PLUG BACK

1a. Type of Work		7. Unit Agreement Name	
b. Type of Well OIL WELL <input type="checkbox"/> GAS WELL <input checked="" type="checkbox"/> OTHER <input type="checkbox"/>		8. Farm or Lease Name	
DRILL <input checked="" type="checkbox"/> DEEPEN <input type="checkbox"/> PLUG BACK <input type="checkbox"/>		State EB	
2. Name of Operator		9. Well No.	
OXY USA Inc.		1	
3. Address of Operator		10. Field and Pool, or Wildcat	
P.O. Box 50250 - Midland, Texas 79710		Undes. East Hess (Morrow)	
4. Location of Well		12. County	
UNIT LETTER B LOCATED 840 FEET FROM THE North LINE		Eddy	
AND 1400 FEET FROM THE East LINE OF SEC. 2 TWP. 24S RGE. 23E NMPM			
19. Proposed Depth		19A. Formation	
10760'		Morrow	
20. Rotary or C.T.		Rotary	
21. Elevations (Show whether DF, RT, etc.)		22. Approx. Date Work will start	
4366.7' GR		After permit approval	
21A. Kind & Status Plug. Bond		21B. Drilling Contractor	
Required/Bonded		Unknown	

PROPOSED CASING AND CEMENT PROGRAM

SIZE OF HOLE	SIZE OF CASING	WEIGHT PER FOOT	SETTING DEPTH	SACKS OF CEMENT	EST. TOP
17-1/2"	13-3/8"	48#	350'	500	Circulated
12-1/4"	8-5/8"	24#	2500'	1150	Circulated
7-7/8"	5-1/2"	17#	10760'	1500	TOC @ 2000'

It is proposed to drill this well to a T.D. of 10760' and test the Morrow Formation. The blowout prevention program is as follows:

1. One set of blind rams
2. One set of drill pipe rams
3. One Hydril

The acreage dedicated to this well has not be assigned to any gas purchaser.

IN ABOVE SPACE DESCRIBE PROPOSED PROGRAM; IF PROPOSAL IS TO DEEPEN OR PLUG BACK, GIVE DATA ON PRESENT PRODUCTIVE ZONE AND PROPOSED NEW PRODUCTIVE ZONE. GIVE BLOWOUT PREVENTER PROGRAM, IF ANY.

I hereby certify that the information above is true and complete to the best of my knowledge and belief.

Signed John A. Williams Title Dist. Opr. Mgr. - Prod. Date 7-25-88
(This space for State Use)

APPROVED BY _____ TITLE _____ DATE _____
CONDITIONS OF APPROVAL, IF ANY:

**NEW MEXICO OIL CONSERVATION COMMISSION
WELL LOCATION AND ACREAGE DEDICATION PLAT**

Form C-102
Supersedes C-128
Effective 1-1-65

All distances must be from the outer boundaries of the Section.

Operator OXY U.S.A., INC.			Lease STATE EB		Well No. 1
Unit Letter B	Section 2	Township 24-S	Range 23-E	County EDDY	
Actual Footage Location of Well: <div style="display: flex; justify-content: space-between;"> 840 feet from the NORTH line and 1400 feet from the EAST line </div>					
Ground Level Elev. 4366.7'	Producing Formation Morrow	Pool Undes. East Hess (Morrow)		Dedicated Acreage: 320 Acres	

1. Outline the acreage dedicated to the subject well by colored pencil or hachure marks on the plat below.
2. If more than one lease is dedicated to the well, outline each and identify the ownership thereof (both as to working interest and royalty).
3. If more than one lease of different ownership is dedicated to the well, have the interests of all owners been consolidated by communitization, unitization, force-pooling, etc?

☐ Yes ☐ No If answer is "yes," type of consolidation _____

If answer is "no," list the owners and tract descriptions which have actually been consolidated. (Use reverse side of this form if necessary.) _____

No allowable will be assigned to the well until all interests have been consolidated (by communitization, unitization, forced-pooling, or otherwise) or until a non-standard unit, eliminating such interests, has been approved by the Commission.

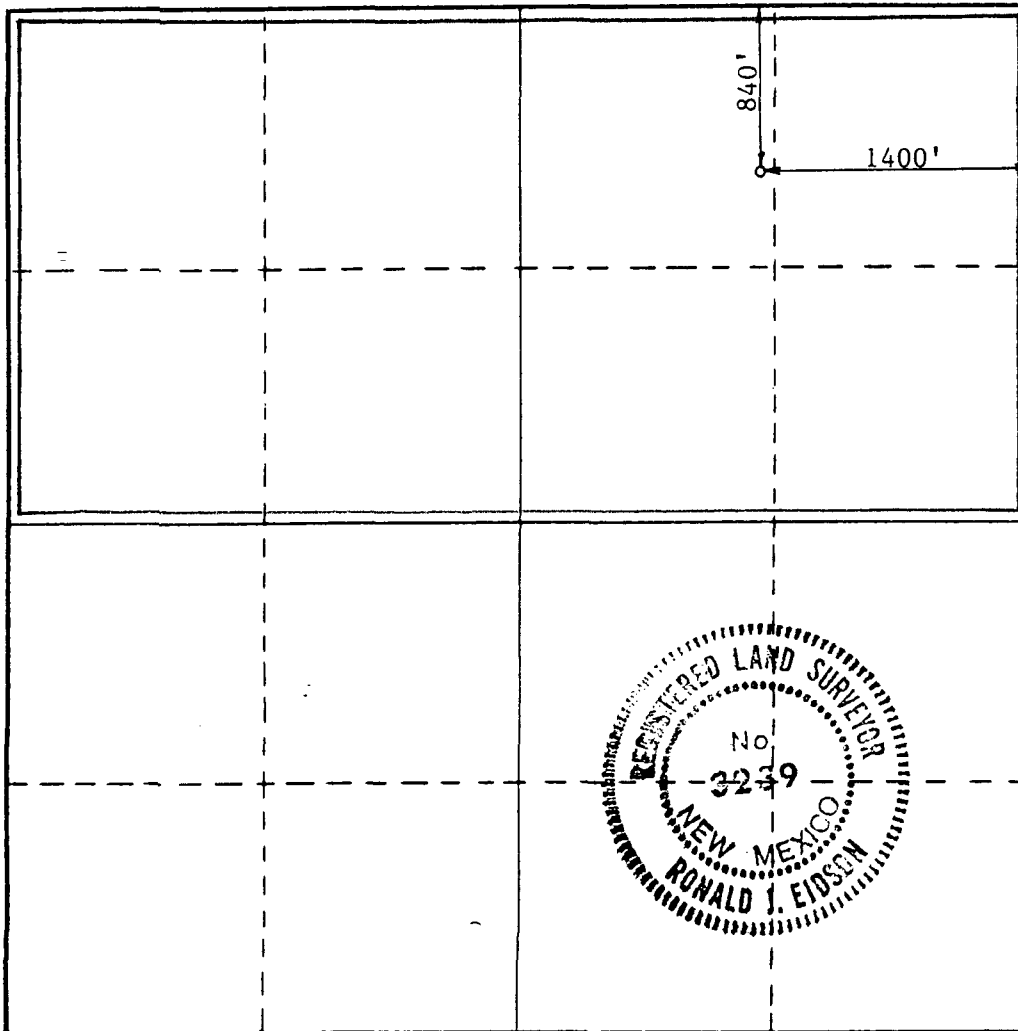

CERTIFICATION

I hereby certify that the information contained herein is true and complete to the best of my knowledge and belief.

Name *FA Vitars*
 Position Dist. Opr. Mgr. - Prod.
 Company OXY USA Inc.
 Date July 25-88

I hereby certify that the well location shown on this plat was plotted from field notes of actual surveys made by me or under my supervision, and that the same is true and correct to the best of my knowledge and belief.

Date Surveyed 3-31-88
 Registered Professional Engineer and/or Land Surveyor
Ronald J. Eidson
 Certificate No. JOHN W. WEST, 676
RONALD J. EIDSON, 3239

