

ROBERT L. BAYLESS

PETROLEUM PLAZA BUILDING  
P. O. BOX 168  
FARMINGTON, NEW MEXICO 87499  
(505) 326-2659

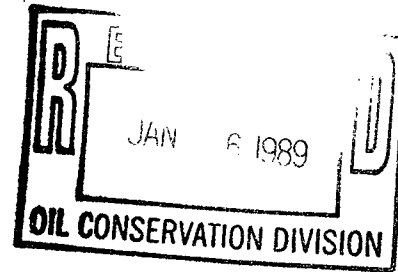

January 4, 1988

Mr. William J. LeMay  
NM Oil Conservation Division  
310 Old Santa Fe Trail, Room 206  
Santa Fe, New Mexico 87503

RE: Request for Administrative Approval  
of an Unorthodox Location  
Jicarilla 464 #10  
1700' FNL & 800' FWL  
Section 30, T30N, R3W  
Rio Arriba County, New Mexico

Dear Mr. LeMay:

We request administrative approval of an unorthodox location for our Jicarilla 464 #10 Pictured Cliffs formation gas well, located 1700' FNL & 800' FWL, Section 30, T30N, R3W, Rio Arriba County, New Mexico. This well is located in an irregular section and, therefore, cannot be located in standard statewide gas spacing. Besides, the topography in the area is very rugged, as shown in the enclosed topographic map, which causes this well to be staked at the above location.

You will also find enclosed a lease map indicating that Robert L. Bayless is the operator of all surrounding 160 acre tracts to this well other than the spacing units to the west of this well's spacing unit. You will note that none of these offset leaseholders are adversely affected by the location of this well. As per NMOCDC Regulations, by copy of this letter to offset leaseholders, we are asking that they waive any objection to this location.

Yours truly,  
*Kevin H. McCord*  
Kevin H. McCord  
Petroleum Engineer

*1/6/89 talked w/ E. Burch  
looks OK, will submit Burch  
short however.*

KHM/lmo

Enclosures

cc: Cecelia Wirt Simms and  
Richard R. Simms w/encls.  
Meridian Oil, Inc. w/encls.  
NMOCDC, Aztec w/encls.

ROBERT L. BAYLESS

PETROLEUM PLAZA BUILDING  
P. O. BOX 168  
FARMINGTON, NEW MEXICO 87499  
(505) 326-2659

January 4, 1988

Mr. William J. LeMay  
NM Oil Conservation Division  
310 Old Santa Fe Trail, Room 206  
Santa Fe, New Mexico 87503

RE: Request for Administrative Approval  
of an Unorthodox Location  
Jicarilla 464 #10  
1700' FNL & 800' FWL  
Section 30, T30N, R3W  
Rio Arriba County, New Mexico

Dear Mr. LeMay:

We request administrative approval of an unorthodox location for our Jicarilla 464 #10 Pictured Cliffs formation gas well, located 1700' FNL & 800' FWL, Section 30, T30N, R3W, Rio Arriba County, New Mexico. This well is located in an irregular section and, therefore, cannot be located in standard statewide gas spacing. Besides, the topography in the area is very rugged, as shown in the enclosed topographic map, which causes this well to be staked at the above location.

You will also find enclosed a lease map indicating that Robert L. Bayless is the operator of all surrounding 160 acre tracts to this well other than the spacing units to the west of this well's spacing unit. You will note that none of these offset leaseholders are adversely affected by the location of this well. As per NMOCD Regulations, by copy of this letter to offset leaseholders, we are asking that they waive any objection to this location.

Yours truly,

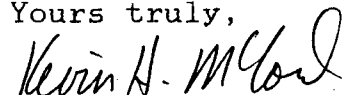
  
Kevin H. McCord  
Petroleum Engineer

KHM/lmo

Enclosures

cc: Cecelia Wirt Simms and  
Richard R. Simms w/encls.  
Meridian Oil, Inc. w/encls.  
NMOCD, Aztec w/encls.

The undersigned has no  
objection to the above  
location.

MERIDIAN OIL, INC.  
Southland Royalty Company

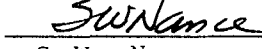
By:   
S.W. Nance  
Engineering Manager  
Date: January 25, 1989

If you concur and have no  
objection, please sign and  
return one copy of this letter  
to the NMOCD in Santa Fe, one  
copy to our office, and retain  
one for your files.

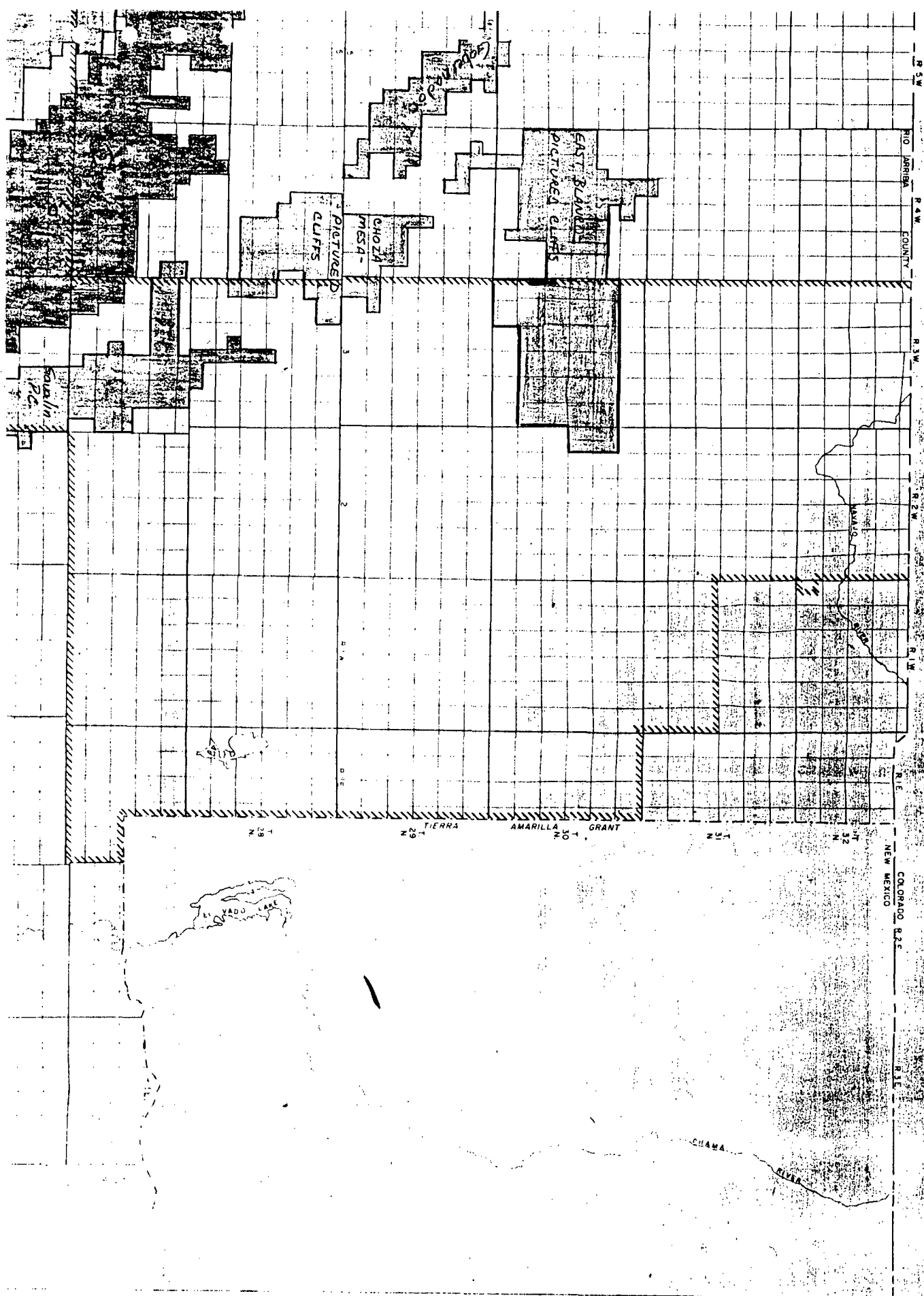

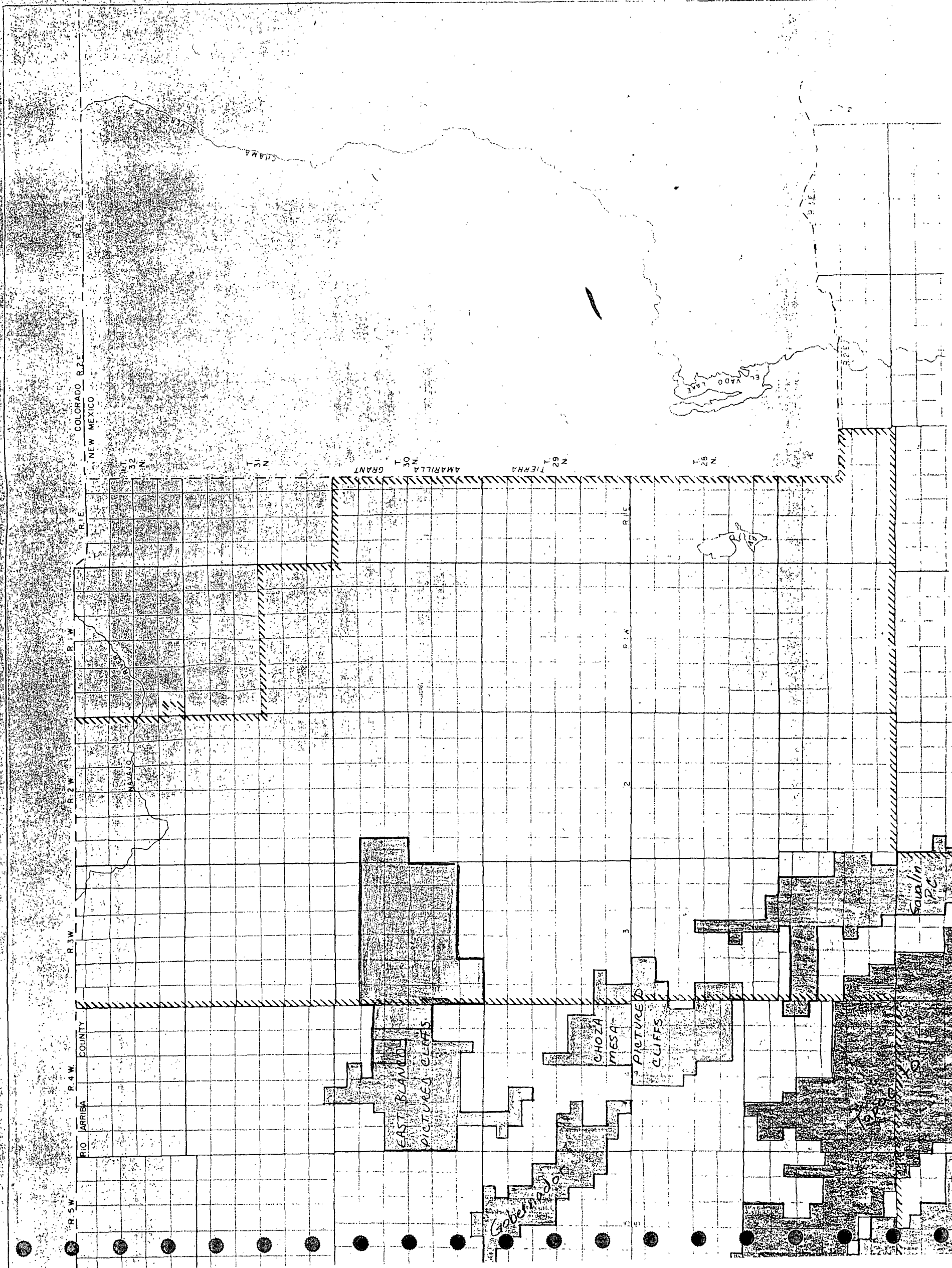

R. 5 W. R. 4 W. R. 3 W. R. 2 W. R. 1 W. R. 1 E. R. 2 E. R. 3 E. R. 4 E. R. 5 E.

RIO ARRIBA COUNTY

NEW MEXICO

COLORADO R. 2 E.

R. 3 E.

T. 32 N.

T. 31 N.

T. 30 N.

T. 29 N.

T. 28 N.

T. 27 N.

T. 26 N.

T. 25 N.

T. 24 N.

T. 23 N.

T. 22 N.

T. 21 N.

T. 20 N.

T. 19 N.

T. 18 N.

T. 17 N.

T. 16 N.

T. 15 N.

T. 14 N.

T. 13 N.

T. 12 N.

T. 11 N.

T. 10 N.

T. 9 N.

T. 8 N.

T. 7 N.

T. 6 N.

T. 5 N.

T. 4 N.

T. 3 N.

T. 2 N.

T. 1 N.

T. 0 N.

T. -1 N.

T. -2 N.

T. -3 N.

T. -4 N.

T. -5 N.

T. -6 N.

T. -7 N.

T. -8 N.

T. -9 N.

T. -10 N.

T. -11 N.

T. -12 N.

T. -13 N.

T. -14 N.

T. -15 N.

T. -16 N.

T. -17 N.

T. -18 N.

T. -19 N.

T. -20 N.

T. -21 N.

T. -22 N.

T. -23 N.

T. -24 N.

T. -25 N.

T. -26 N.

T. -27 N.

T. -28 N.

T. -29 N.

T. -30 N.

T. -31 N.

T. -32 N.

T. -33 N.

T. -34 N.

T. -35 N.

T. -36 N.

T. -37 N.

T. -38 N.

T. -39 N.

T. -40 N.

T. -41 N.

T. -42 N.

T. -43 N.

T. -44 N.

T. -45 N.

T. -46 N.

T. -47 N.

T. -48 N.

T. -49 N.

T. -50 N.

T. -51 N.

T. -52 N.

T. -53 N.

T. -54 N.

T. -55 N.

T. -56 N.

T. -57 N.

T. -58 N.

T. -59 N.

T. -60 N.

T. -61 N.

T. -62 N.

T. -63 N.

T. -64 N.

T. -65 N.

T. -66 N.

T. -67 N.

T. -68 N.

T. -69 N.

T. -70 N.

T. -71 N.

T. -72 N.

T. -73 N.

T. -74 N.

T. -75 N.

T. -76 N.

T. -77 N.

T. -78 N.

T. -79 N.

T. -80 N.

T. -81 N.

T. -82 N.

T. -83 N.

T. -84 N.

T. -85 N.

T. -86 N.

T. -87 N.

T. -88 N.

T. -89 N.

T. -90 N.

T. -91 N.

T. -92 N.

T. -93 N.

T. -94 N.

T. -95 N.

T. -96 N.

T. -97 N.

T. -98 N.

T. -99 N.

T. -100 N.

T. -101 N.

T. -102 N.

T. -103 N.

T. -104 N.

T. -105 N.

T. -106 N.

T. -107 N.

T. -108 N.

T. -109 N.

T. -110 N.

T. -111 N.

T. -112 N.

T. -113 N.

T. -114 N.

T. -115 N.

T. -116 N.

T. -117 N.

T. -118 N.

T. -119 N.

T. -120 N.

T. -121 N.

T. -122 N.

T. -123 N.

T. -124 N.

T. -125 N.

T. -126 N.

T. -127 N.

T. -128 N.

T. -129 N.

T. -130 N.

T. -131 N.

T. -132 N.

T. -133 N.

T. -134 N.

T. -135 N.

T. -136 N.

T. -137 N.

T. -138 N.

T. -139 N.

T. -140 N.

T. -141 N.

T. -142 N.

T. -143 N.

T. -144 N.

T. -145 N.

T. -146 N.

T. -147 N.

T. -148 N.

T. -149 N.

T. -150 N.

T. -151 N.

T. -152 N.

T. -153 N.

T. -154 N.

T. -155 N.

T. -156 N.

T. -157 N.

T. -158 N.

T. -159 N.

T. -160 N.

T. -161 N.

T. -162 N.

T. -163 N.

T. -164 N.

T. -165 N.

T. -166 N.

T. -167 N.

T. -168 N.

T. -169 N.

T. -170 N.

T. -171 N.

T. -172 N.

T. -173 N.

T. -174 N.

T. -175 N.

T. -176 N.

T. -177 N.

T. -178 N.

T. -179 N.

T. -180 N.

T. -181 N.

T. -182 N.

T. -183 N.

T. -184 N.

T. -185 N.

T. -186 N.

T. -187 N.

T. -188 N.

T. -189 N.

T. -190 N.

T. -191 N.

T. -192 N.

T. -193 N.

T. -194 N.

T. -195 N.

T. -196 N.

T. -197 N.

T. -198 N.

T. -199 N.

T. -200 N.

T. -201 N.

T. -202 N.

T. -203 N.

T. -204 N.

T. -205 N.

T. -206 N.

T. -207 N.

T. -208 N.

T. -209 N.

T. -210 N.

T. -211 N.

T. -212 N.

T. -213 N.

T. -214 N.

T. -215 N.

T. -216 N.

T. -217 N.

T. -218 N.

T. -219 N.

T. -220 N.

T. -221 N.

T. -222 N.

T. -223 N.

T. -224 N.

T. -225 N.

T. -226 N.

T. -227 N.

T. -228 N.

T. -229 N.

T. -230 N.

T. -231 N.

T. -232 N.

T. -233 N.

T. -234 N.

T. -235 N.

T. -236 N.

T. -237 N.

T. -238 N.

T. -239 N.

T. -240 N.

T. -241 N.

T. -242 N.

T. -243 N.

T. -244 N.

T. -245 N.

T. -246 N.

T. -247 N.

T. -248 N.

T. -249 N.

T. -250 N.

T. -251 N.

T. -252 N.

T. -253 N.

T. -254 N.

T. -255 N.

T. -256 N.

T. -257 N.

T. -258 N.

T. -259 N.

T. -260 N.

T. -261 N.

T. -262 N.

T. -263 N.

T. -264 N.

T. -265 N.

T. -266 N.

T. -267 N.

T. -268 N.

T. -269 N.

ROBERT L. BAYLESS

PETROLEUM PLAZA BUILDING  
P. O. BOX 168  
FARMINGTON, NEW MEXICO 87499  
(505) 326-2659

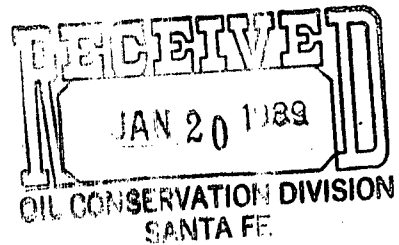

January 11, 1989

Mr. William J. LeMay  
NM Oil Conservation Division  
310 Old Santa Fe Trail, Room 206  
Santa Fe, New Mexico 87503

RE: Request for Administrative Approval  
of an Unorthodox Location  
Jicarilla 464 #10  
1700' FNL & 800' FWL  
Section 30, T30N, R3W  
Rio Arriba County, New Mexico

Dear Mr. LeMay:

We request administrative approval of an unorthodox location for our Jicarilla 464 #10 Pictured Cliffs formation gas well, located 1700' FNL & 800' FWL, Section 30, T30N, R3W, Rio Arriba County, New Mexico. This well is located in an irregular section and, therefore, cannot be located in standard statewide gas spacing. Besides, the topography in the area is very rugged, as shown in the enclosed topographic map, which causes this well to be staked at the above location.

You will also find enclosed a lease map indicating that Robert L. Bayless is the operator of all surrounding 160 acre tracts to this well other than the spacing units to the west of this well's spacing unit. You will note that none of these offset leaseholders are adversely affected by the location of this well. As per NMOCD Regulations, by copy of this letter to offset leaseholders, we are asking that they waive any objection to this location.

Yours truly,

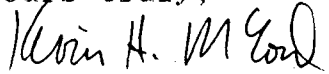
  
Kevin H. McCord  
Petroleum Engineer

KHM/lmo

Enclosures

cc: Richard W. Simms	w/encls.
Mary S. Schutz	w/encls.
Meridian Oil, Inc.	w/encls.
NMOCD, Aztec	w/encls.

The undersigned has no objection to the above location.

  
Mary S. Schutz

Date: January 18, 1989

If you concur and have no objection, please sign and return one copy of this letter to the NMOCD in Santa Fe, one copy to our office, and retain one for your files.

ROBERT L. BAYLESS

PETROLEUM PLAZA BUILDING  
P. O. BOX 168  
FARMINGTON, NEW MEXICO 87499  
(505) 326-2659



January 11, 1989

Mr. William J. LeMay  
NM Oil Conservation Division  
310 Old Santa Fe Trail, Room 206  
Santa Fe, New Mexico 87503

RE: Request for Administrative Approval  
of an Unorthodox Location  
Jicarilla 464 #10  
1700' FNL & 800' FWL  
Section 30, T30N, R3W  
Rio Arriba County, New Mexico

Dear Mr. LeMay:

We request administrative approval of an unorthodox location for our Jicarilla 464 #10 Pictured Cliffs formation gas well, located 1700' FNL & 800' FWL, Section 30, T30N, R3W, Rio Arriba County, New Mexico. This well is located in an irregular section and, therefore, cannot be located in standard statewide gas spacing. Besides, the topography in the area is very rugged, as shown in the enclosed topographic map, which causes this well to be staked at the above location.

You will also find enclosed a lease map indicating that Robert L. Bayless is the operator of all surrounding 160 acre tracts to this well other than the spacing units to the west of this well's spacing unit. You will note that none of these offset leaseholders are adversely affected by the location of this well. As per NMOCD Regulations, by copy of this letter to offset leaseholders, we are asking that they waive any objection to this location.

Yours truly,

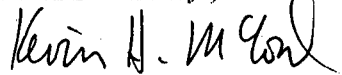
  
Kevin H. McCord  
Petroleum Engineer

KHM/lmo

Enclosures

cc: Richard W. Simms	w/encls.
Mary S. Schutz	w/encls.
Meridian Oil, Inc.	w/encls.
NMOCD, Aztec	w/encls.

The undersigned has no objection to the above location.

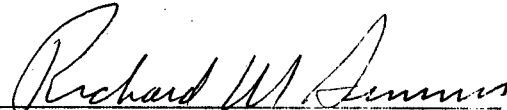
  
Richard W. Simms

Date: 1-17-89

If you concur and have no objection, please sign and return one copy of this letter to the NMOCD in Santa Fe, one copy to our office, and retain one for your files.

NEW MEXICO OIL CONSERVATION COMMISSION  
WELL LOCATION AND ACREAGE DEDICATION PLAT

Form O-128  
Supersedes O-128  
Effective 1-1-64

All distances must be from the outer boundaries of the Section

Operator <b>ROBERT L. BAYLESS</b>		Lease <b>JICARTILLA 464</b>		Well No. <b>10</b>
Unit Letter <b>F</b>	Section <b>30</b>	Township <b>30 N</b>	Range <b>3 W</b>	County <b>RIO ARRIBA</b>
Actual Footage Location of Well: <b>1700</b> feet from the <b>North</b> line and <b>800</b> feet from the <b>West</b> line				
Ground Level Elev. <b>7231</b>	Producing Formation <b>Pictured Cliffs</b>	Pool <b>East Blanco Pictured Cliffs</b>	Dedicated Acreage: <b>173.06</b> Acres	

1. Outline the acreage dedicated to the subject well by colored pencil or hachure marks on the plat below.
2. If more than one lease is dedicated to the well, outline each and identify the ownership thereof (both as to working interest and royalty).
3. If more than one lease of different ownership is dedicated to the well, have the interests of all owners been consolidated by communitization, unitization, force-pooling, etc?

☐ Yes ☐ No If answer is "yes," type of consolidation \_\_\_\_\_

If answer is "no," list the owners and tract descriptions which have actually been consolidated. (Use reverse side of this form if necessary.) \_\_\_\_\_

No allowable will be assigned to the well until all interests have been consolidated (by communitization, unitization, forced-pooling, or otherwise) or until a non-standard unit, eliminating such interests, has been approved by the Commission.

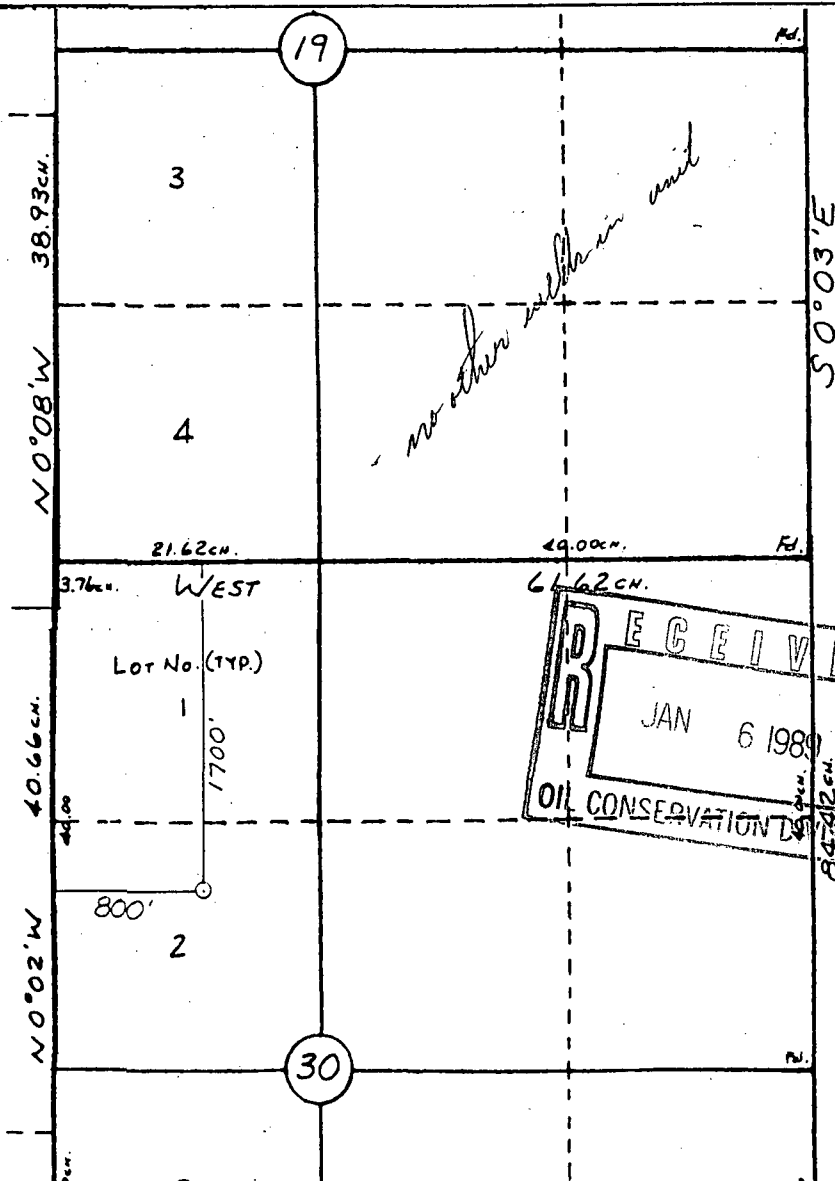

CERTIFICATION	
I hereby certify that the information contained herein is true and complete to the best of my knowledge and belief.	
Name	<b>Price M. Bayless</b>
Position	<b>Engineer</b>
Company	<b>Robert L. Bayless</b>
Date	<b>11/7/88</b>
I hereby certify that the well location shown on this plat was plotted from field notes of actual surveys made by me or under my supervision, and that the same is true and correct to the best of my knowledge and belief.	
Date Surveyed	<b>10-25-88</b>
<b>WILLIAM T. MAHNEY II</b> Registered Professional Engineer and Land Surveyor #8466	
Certificate No.	<b>11800</b>

RECEIVED  
JAN 16 1980  
OIL CONSERVATION DIVISION

'LI AN' PO CANYON



SF 079482-A  
MERIDIAN OIL CO.

JICARILLA 458 LEASE  
ROBERT L. BAYLESS  
OPERATOR

25  
D.A.  
'58

Fee - Cecelia + Richard  
Simms

1  
D  
A.  
'59

3  
\*

29  
Kpc D.A. '58

Fee  
Cecelia +  
Richard  
Simms

NM 13376  
MERIDIAN OIL CO.

1  
Kd D.A. '75

25

T 30N R 4W

4  
Kpc D.A. '84

T 29N R 4W

Fee - Cecelia +  
Richard Simms.

Kpc D.A. '84

INDIAN RESERVATION BOUNDARY

JICARILLA

459-9

464-10

464-9

464-11

19

30

31

6

7

2

18

19

31

©<sup>3</sup>

JIC 452 LEASE  
ROBERT L. BAYLESS  
OPERATOR

Kpc D.A. '86

OPERATOR

JICARILLA 459 LEASE  
ROBERT L. BAYLESS  
OPERATOR

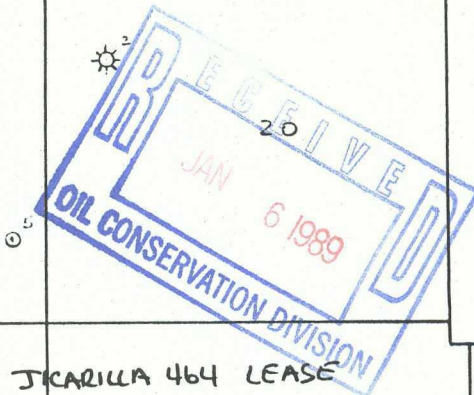

JICARILLA 464 LEASE  
ROBERT L. BAYLESS  
OPERATOR

T 30N R 3W

T 29N R 3W

2

20

29

32

5

8

1-Y

STATE OF NEW MEXICO  
ENERGY, MINERALS AND NATURAL RESOURCES DEPARTMENT  
OIL CONSERVATION DIVISION

IN THE MATTER OF THE HEARING  
CALLED BY THE OIL CONSERVATION  
DIVISION FOR THE PURPOSE OF  
CONSIDERING:

CASE NO. 9495  
Order No. R-8774

APPLICATION OF ROBERT L. BAYLESS  
FOR NINE NON-STANDARD GAS PRORATION  
UNITS, RIO ARriba COUNTY, NEW MEXICO.

ORDER OF THE DIVISION

BY THE DIVISION:

This cause came on for hearing at 8:15 a.m. on October 12, 1988, at Santa Fe, New Mexico, before Examiner David R. Catanach.

NOW, on this 28th day of October, 1988, the Division Director, having considered the testimony, the record, and the recommendations of the Examiner, and being fully advised in the premises,

FINDS THAT:

(1) Due public notice having been given as required by law, the Division has jurisdiction of this cause and the subject matter thereof.

(2) The applicant, Robert L. Bayless, seeks an order establishing nine non-standard gas spacing and proration units for any and all formations and/or pools developed on 160-acre spacing, which includes but is not necessarily limited to the East Blanco-Pictured Cliffs Gas Pool, Cabresto-Gallup Gas Pool, and Campo-Gallup Gas Pool, in Sections 6, 7, 18, 19, 30, and 31 of Township 30 North, Range 3 West, and Sections 6 and 7 of Township 29 North, Range 3 West, all in Rio Arriba County, New Mexico, and described as follows:

-2-

Case No. 9495

Order No. R-8774

TOWNSHIP 30 NORTH, RANGE 3 WEST, NMPM

<u>UNIT</u>	<u>ACRES</u>	<u>DESCRIPTION</u>
1	168.42	Section 6: Lots 3, 4, and 9
2	133.39	Section 6: Lot 10
		Section 7: Lots 3 and 4
3	174.62	Section 7: Lots 5 and 6
		Section 18: Lots 1 and 2
4	173.21	Section 18: Lots 3 and 4
		Section 19: Lots 1 and 2
5	173.06	Section 19: Lots 3 and 4
		Section 30: Lots 1 and 2
6	151.01	Section 30: Lots 3 and 4
		Section 31: Lot 1 and NE/4 NW/4
7	167.39	Section 31: Lots 2, 3, and 4, SE/4 NW/4, and E/2 SW/4

TOWNSHIP 29 NORTH, RANGE 3 WEST, NMPM

<u>UNIT</u>	<u>ACRES</u>	<u>DESCRIPTION</u>
8	163.76	Section 6: Lots 3, 4, 5, and 6
9	173.69	Section 7: Lots 1, 2, 3, and 4

(3) Evidence presented indicates that variations in legal subdivisions of the U.S. Public Lands Survey within the above-described area precludes the establishment of standard 160-acre spacing and proration units.

(4) The principal gas producing formations within the above-described area are the Pictured Cliffs and Gallup formations, both of which are currently subject to 160-acre gas spacing.

(5) The applicant is the operator of all the acreage described above and no offset operator objected to the establishment of the proposed non-standard gas spacing units.

(6) Approval of the subject application will ensure the orderly development of the acreage described above within the subject pools and should prevent waste and protect correlative rights.

-3-

Case No. 9495  
Order No. R-8774

IT IS THEREFORE ORDERED THAT:

(1) The application of Robert L. Bayless for the establishment of the following described non-standard gas spacing and proration units in the East Blanco-Pictured Cliffs Gas Pool, Cabresto-Gallup Gas Pool, Campo-Gallup Gas Pool, or in any and all formations and/or pools developed on 160-acre spacing in the subject area, Rio Arriba County, New Mexico, is hereby approved:

TOWNSHIP 30 NORTH, RANGE 3 WEST, NMPM

<u>UNIT</u>	<u>ACRES</u>	<u>DESCRIPTION</u>
1	168.42	Section 6: Lots 3, 4, and 9
2	133.39	Section 6: Lot 10
		Section 7: Lots 3 and 4
3	174.62	Section 7: Lots 5 and 6
		Section 18: Lots 1 and 2
4	173.21	Section 18: Lots 3 and 4
		Section 19: Lots 1 and 2
5	173.06	Section 19: Lots 3 and 4
		Section 30: Lots 1 and 2
6	151.01	Section 30: Lots 3 and 4
		Section 31: Lot 1 and NE/4 NW/4
7	167.39	Section 31: Lots 2, 3, and 4, SE/4 NW/4, and E/2 SW/4

TOWNSHIP 29 NORTH, RANGE 3 WEST, NMPM

<u>UNIT</u>	<u>ACRES</u>	<u>DESCRIPTION</u>
8	163.76	Section 6: Lots 3, 4, 5, and 6
9	173.69	Section 7: Lots 1, 2, 3, and 4

(2) Jurisdiction of this cause is retained for the entry of such further orders as the Division may deem necessary.

DONE at Santa Fe, New Mexico, on the day and year hereinabove designated.

STATE OF NEW MEXICO  
OIL CONSERVATION DIVISION

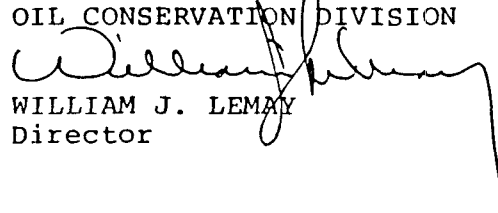
  
WILLIAM J. LEMAY  
Director

S E A L  
fd/

County RIO ARriba

Pool EAST BLANCO-PICTURED CLIFFS

TOWNSHIP 30 N South, RANGE 3 W East, NEW MEXICO PRINCIPAL MERIDIAN

6	5	4	3	2	1	
7	8	9	10	11	12	
13	17	16	15	14	13	
19	20	21	22	23	24	
29	28	27	26	25	24	
31	32	33	34	35	36	

EXT: ALL SECS 7-32 (R-8713, 8/12/88)

ROBERT L. BAYLESS

PETROLEUM PLAZA BUILDING  
P. O. BOX 168  
FARMINGTON, NEW MEXICO 87499  
(505) 326-2659



January 12, 1989

Mr. William J. LeMay  
NM Oil Conservation Division  
310 Old Santa Fe Trail, Room 206  
Santa Fe, New Mexico 87503

RE: Requests for Administrative Approval  
of Unorthodox Locations for 4 Wells

Dear Mr. LeMay:

Please refer to our letters to you dated January 4, 1988  
(sh/be 1989) regarding the following well locations:

Jicarilla 459 #9 - Section 19, T30N, R3W  
Jicarilla 464 #9 - Section 30, T30N, R3W  
Jicarilla 464 #10 - Section 30, T30N, R3W ✓  
Jicarilla 464 #11 - Section 31, T30N, R3W

We have been advised by telephone that the offset leaseholders, Cecelia Wirt Simms and Richard R. Simms referred to in our previous correspondence, have gifted their holdings to their children, Richard W. Simms and Mary S. Schutz, as of January of this year. We have, therefore, sent copies of our original letters requesting approval of unorthodox location on each well listed above to Richard W. Simms and Mary S. Schutz.

Hopefully, this will eliminate some confusion should you receive the signed waivers from these two parties. If you need any further information in this regard, please contact me at your earliest convenience.

Yours truly,

A handwritten signature in cursive script that reads "Kevin H. McCord".

Kevin H. McCord  
Petroleum Engineer

KHM/lmo

cc: NMOCD, Aztec



STATE OF NEW MEXICO  
ENERGY AND MINERALS DEPARTMENT  
OIL CONSERVATION DIVISION  
AZTEC DISTRICT OFFICE

STATE OF NEW MEXICO  
AZTEC, NEW MEXICO 87410  
(505) 334-6170

OIL CONSERVATION DIVISION  
BOX 2088  
SANTA FE, NEW MEXICO 87501

DATE 1-6-89

RE: Proposed MC \_\_\_\_\_  
Proposed DHC \_\_\_\_\_  
Proposed HSL X \_\_\_\_\_  
Proposed SWD \_\_\_\_\_  
Proposed WFX \_\_\_\_\_  
Proposed PHX \_\_\_\_\_

Gentlemen:

I have examined the application dated 1-5-89  
for the Robert L Bayless Jicarilla 464 #10 F-30-31N-3W  
Operator Lease and Well No. Unit, S-T-R

and my recommendations are as follows:

Approve  
\_\_\_\_\_  
\_\_\_\_\_  
\_\_\_\_\_  
\_\_\_\_\_

Yours truly,

E. B. Bush

