

MERIDIAN OIL

*Received
1/10/89
OCD*

December 27, 1988

Mr. William LeMay
New Mexico Oil Conservation Division
310 Old Santa Fe Trail Road
Santa Fe, New Mexico 87503

Dear Mr. LeMay:

This is a request for administrative approval for an unorthodox gas well location in the Basin Fruitland Coal Pool.

It is intended to locate the Meridian Oil Inc. Sharp #800 at 1250' from the North line and 2380' from the East line of Section 18, T-28-N, R-8-W, San Juan County, New Mexico.

Largo Wash, Blanco Wash, pipelines, the NAPI irrigation tunnel and terrain makes this location necessary.

A copy of this application is being submitted to all offset operators by certified mail with a request that they furnish your Santa Fe office with a Waiver of Objection, and return one copy to this office.

Plats showing the proposed well location and the terrain in Section 8, along with an ownership plat, are attached.

Sincerely yours,



Peggy Bradfield

encl.

WAIVER

_____ hereby waives objection to Meridian Oil Inc.'s application for an unorthodox location for their Sharp #800 as proposed above.

By: _____ Date: _____

cc: Tenneco Oil Inc.

Sent copy to E. Burch 1/10/89

MERIDIAN OIL INC.

Well Name Sharp #800

Footage----- 1250' FNL; 2380' FEL

APPLICATION FOR NON-STANDARD LOCATION

County San Juan State New Mexico Section 8 Township 28N Range 8W

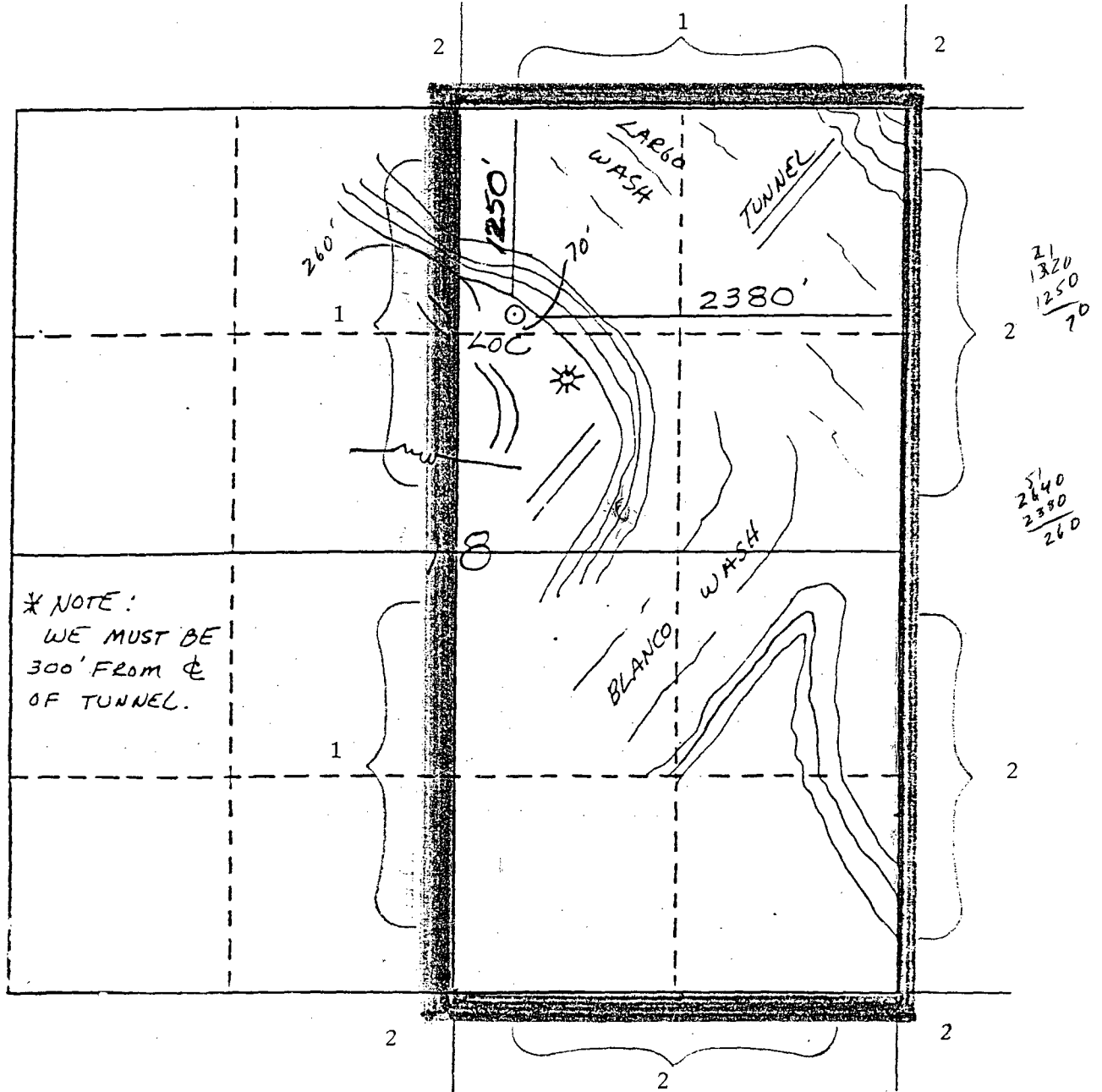

REMARKS:

1. Meridian Oil Inc.

2. Tenneco Oil Company

All distances must be from the outer boundaries of the Section.

| | | | | | |
|--|---------------------|----------------------|-----------------|-----------------------------|--|
| Operator Meridian Oil Inc. | | Lease Sharp | | Well No. 800 | |
| Unit Letter B | Section 18 | Township 28 North | Range 8 West | County San Juan | |
| Actual Footage Location of Well: 1250 feet from the North line and 2380 feet from the East line | | | | | |
| Ground Level Elev. 5740 | Producing Formation | | Pool | Dedicated Acreage: Acres | |

1. Outline the acreage dedicated to the subject well by colored pencil or hachure marks on the plat below.
2. If more than one lease is dedicated to the well, outline each and identify the ownership thereof (both as to working interest and royalty).
3. If more than one lease of different ownership is dedicated to the well, have the interests of all owners been consolidated by communitization, unitization, force-pooling, etc?

☐ Yes ☐ No If answer is "yes," type of consolidation _____

If answer is "no," list the owners and tract descriptions which have actually been consolidated. (Use reverse side of this form if necessary.) _____

No allowable will be assigned to the well until all interests have been consolidated (by communitization, unitization, forced-pooling, or otherwise) or until a non-standard unit, eliminating such interests, has been approved by the Division

* Non-standard due to pipe-lines, irrigation tunnel & terrain.

| CERTIFICATION | |
|--|------------------|
| I hereby certify that the information contained herein is true and complete to the best of my knowledge and belief. | |
| Name | Neale C. Edwards |
| Position | |
| Company | |
| Date | |
| I hereby certify that the location shown on this plat was plotted from field notes of actual surveys made by me or under my supervision, and that the same is true and correct to the best of my knowledge and belief. | |
| Date Surveyed | 12-15-88 |
| Registered Professional Engineer and/or Land Surveyor | |
| Neale C. Edwards | |
| Certificate No. | 6857 |



STATE OF NEW MEXICO
ENERGY AND MINERALS DEPARTMENT

OIL CONSERVATION DIVISION
AZTEC DISTRICT OFFICE

TERRELL BLVD. (Hwy 101)
AZTEC, NEW MEXICO 87410
(505) 334-6170

OIL CONSERVATION DIVISION
BOX 2088
SANTA FE, NEW MEXICO 87501

DATE 1-11-89

RE: Proposed MC _____
Proposed DHC _____
Proposed HSL _____
Proposed SWD _____
Proposed WFX _____
Proposed PHX _____

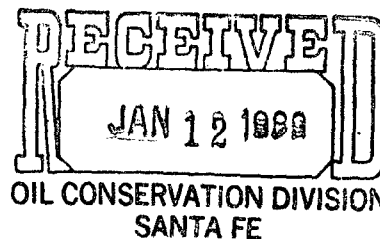

Gentlemen:

I have examined the application dated 12-30-87

for the Meridian Oil Inc. SHARP #800 B-15-23N-8W
Operator Lease and Well No. Unit, S-T-R

and my recommendations are as follows:

Approved

Yours truly,

[Signature]