

**MERIDIAN OIL**

OIL CONSERVATION DIVISION  
RECEIVED

'94 APR 16 AM 8 50

April 12, 1994

**Federal Express**

Mr. William LeMay  
New Mexico Oil Conservation Division  
310 Old Santa Fe Trail  
Santa Fe, New Mexico 87501

Re: Angel-Peak<sup>B</sup> #31  
990'FNL; 1650'FWL, Section 25, T-28-N, R-11-W, San Juan County, NM  
API #30-045-24458

Dear Mr. LeMay:

Meridian Oil wishes to make application for a non-standard location for this well to be plugged back in the Basin Fruitland Coal formation. This well originally was completed as a Gallup well. This location is considered off-pattern for the northeast/southwest quarter pool rules for the Fruitland Coal.

The following is a chronology of events by Union Texas, Meridian Oil and the New Mexico Oil Conservation Division concerning this well. Attached are copies for each event.

- July 19, 1989 - Application for non-standard location for this well in the Fruitland Coal made by Union Texas Petroleum
- August 17, 1989 - NSL 2688 issued by the New Mexico Oil Conservation Division.
- August 14, 1989 - Union Texas set a cement retainer at 5340' and squeeze cemented the Gallup. The lower Fruitland Coal was perforated 1769-80' and fracture treated. A bridge plug was set at 1740' and two squeeze holes perforated at 1604'. Operations were suspended at that time.
- January 1, 1990 - Meridian Oil assumes operatorship.
- October 10, 1990 - application was made by Meridian Oil for non-standard location.
- November 8, 1990 - letter from M. Stogner of NMOCD asking Meridian's involvement with well and several other issues.
- November 9, 1990 - objection made by General Minerals.
- November 14, 1990 - letter from M. Stogner setting hearing December 19, 1990.
- February 11, 1991 - Order R-9436 Case 10183 dismissed.
- February 12, 1991 - letter from M. Stogner placing Order NSL-2688 in abeyance.

Mr. William LeMay  
New Mexico Oil Conservation Division  
Page Two - Angel Peak B #31  
April 12, 1994

To comply with the New Mexico Oil Conservation Division rules, Meridian is submitting the following for your approval of this non-standard location:

1. C-102 plat showing location of the well;
2. Plat showing offset owners/operators;
3. Affidavit of notification of offset owners/operators;
4. Copy of Well Completion Log for original completion.

A copy of this application is being submitted to all offset owners/operators by certified mail with a request that they furnish your Santa Fe office with a Waiver of Objection, and return one copy to this office.

Sincerely yours,



Peggy Bradfield  
Regulatory/Compliance Representative

#### WAIVER

\_\_\_\_\_ hereby waives objection to Meridian Oil Inc.'s application for non-standard location for the Angel Peak B #31 as proposed above.

By: \_\_\_\_\_ Date: \_\_\_\_\_

xc: Marathan Oil  
BHP Petroleum  
James M. Collins  
Chaparral Oil & Gas  
Vanderslice Petroleum Corp.  
James U. Cnatrell Estate  
Joe C. Salmon  
Bettye Jean Salmon  
General Minerals Corp.

*Sent Copy to E. Branch 7/25/89*



Union Texas Petroleum

1330 Post Oak Blvd.  
P.O. Box 2120  
Houston, Texas 77252-2120  
(713) 623-6544

July 19, 1989

William J. LeMay - Director  
New Mexico Oil Conservation Commission  
P.O. Box 2088  
Santa Fe, New Mexico 87504

Re: Angel Peak "8" #31  
San Juan County, New Mexico

**RECEIVED**

JUL 24 1989

OIL CONSERVATION DIV.  
SANTA FE

Dear Mr. LeMay:

The well listed above is currently completed in the Armenta Gallup Field. We are planning recompletion to the Fruitland Coal formation but spacing rules place the existing well bore in an unorthodox location.

We request approval for exception to unorthodox location for this well.

Attached for your information is a C-102 reflecting the location of the well.

Please contact me at 713/968-4004 if you have any questions concerning this request.

Best regards,

Ken E. White  
Regulatory Permit Coordinator

Release Date: 8/14/89

KEW/acb  
Attachments

*- needs land plat showing offset.*

KEW:0436

All distances must be from the outer boundaries of the Section.

Operator <b>SUPRON ENERGY CORPORATION</b>			Lease <b>ANGEL PEAK "B"</b>		Well No. <b>27-E</b>
Unit Letter <b>C</b>	Section <b>25</b>	Township <b>28 NORTH</b>	Range <b>11 WEST</b>	County <b>SAN JUAN</b>	
Actual Footage Location of Well: <b>990</b> feet from the <b>NORTH</b> line and <b>1650</b> feet from the <b>WEST</b> line					
Ground Level Elev. <b>5807</b>	Producing Formation <b>Dakota</b>	Pool <b>Basin</b>		Dedicated Acreage: <b>W<math>\frac{1}{2}</math> 320 Acres</b>	

1. Outline the acreage dedicated to the subject well by colored pencil or hatchure marks on the plat below.
2. If more than one lease is dedicated to the well, outline each and identify the ownership thereof (both as to working interest and royalty).
3. If more than one lease of different ownership is dedicated to the well, have the interests of all owners been consolidated by communitization, unitization, force-pooling, etc?

☐ Yes ☐ No If answer is "yes," type of consolidation \_\_\_\_\_

If answer is "no," list the owners and tract descriptions which have actually been consolidated. (Use reverse side of this form if necessary.) \_\_\_\_\_

No allowable will be assigned to the well until all interests have been consolidated (by communitization, unitization, forced-pooling, or otherwise) or until a non-standard unit, eliminating such interests, has been approved by the Division.

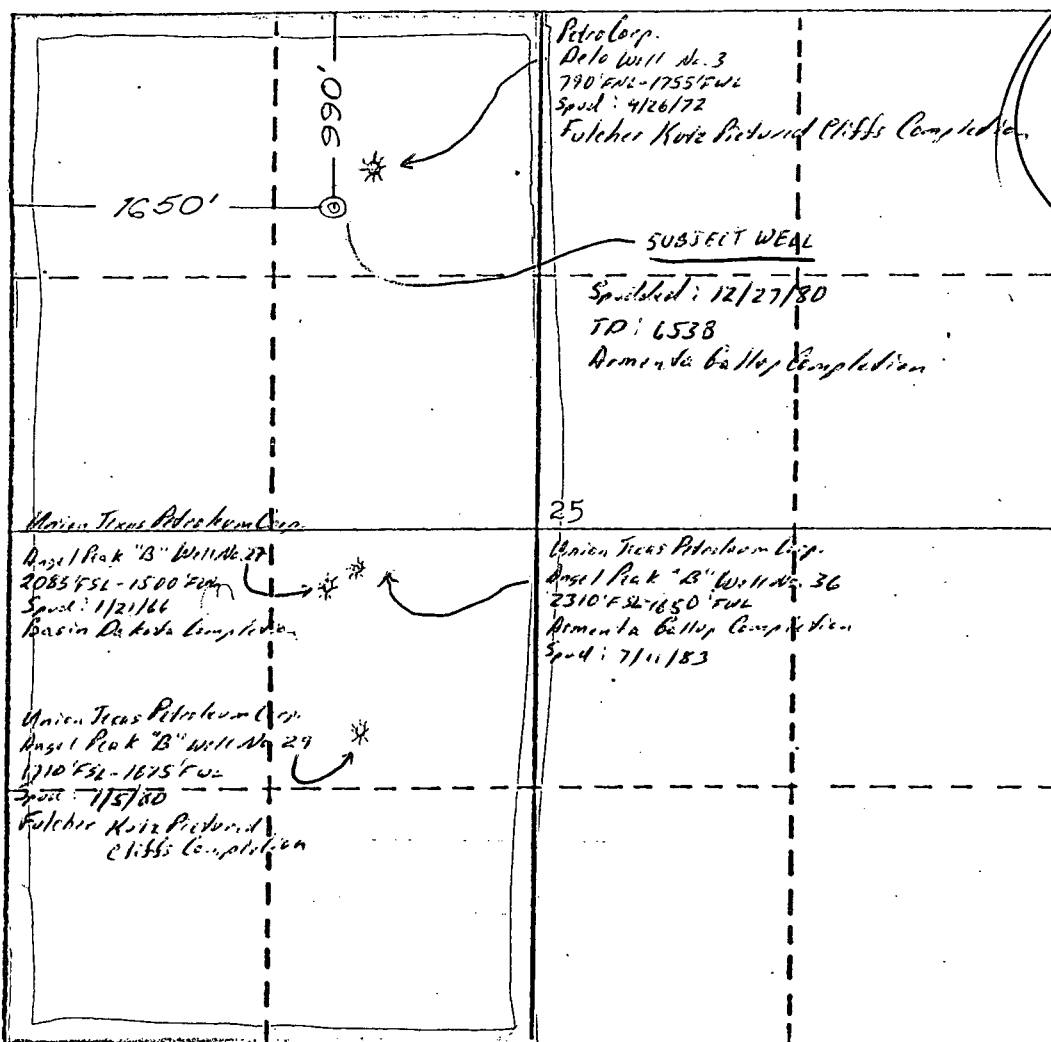

**CERTIFICATION**  
I hereby certify that the information contained herein is true and complete to the best of my knowledge and belief.

*Rudy D. Watts*  
Name \_\_\_\_\_

Area Superintendent

Position

Supron Energy Corporation

Company

March 6, 1980

Date

I hereby certify that the well location shown on this plat was plotted from field notes of actual surveys made by me or under my supervision, and that the same is true and correct to the best of my knowledge and belief.

Date Surveyed

February 21, 1980

Registered Professional Engineer  
and/or Land Surveyor

*James P. Leese*  
James P. Leese

Certificate No.

1463

OFFSET OPERATORS

Marathon Oil Company  
1515 Arapohoe Street, Ste 1300  
Denver, Colorado 80703

Meridian Oil Inc.  
P.O. Box 4289  
Farmington, New Mexico 87499

Dugan Production Corp.  
P.O. Box 208  
Farmington, New Mexico 87499

Amaco Production Company  
2325 E. 30th Street  
Farmington, New Mexico 87499

Chaparral Oil & Gas Company  
P.O. Box 100  
Aztec, New Mexico 87410

Gallaway, WM  
3005 Northridge Dr, Ste 1  
Farmington, New Mexico 87401

UNITED STATES  
DEPARTMENT OF THE INTERIOR  
BUREAU OF LAND MANAGEMENT

APPLICATION FOR PERMIT TO DRILL, DEEPEN, OR PLUG BACK

1a. TYPE OF WORK

DRILL ☐

DEEPEN ☐

PLUG BACK ☒

b. TYPE OF WELL

OIL  
WELL ☒

GAS  
WELL ☐

OTHER

SINGLE  
ZONE ☒

MULTIPLE  
ZONE ☐

2. NAME OF OPERATOR

Union Texas Petroleum Corp.

3. ADDRESS OF OPERATOR

P.O. Box 2120 Houston, Texas 77252-2120

4. LOCATION OF WELL (Report location clearly and in accordance with any State requirements.)\*

At surface

990' FNL & 1650' FWL

At proposed prod. zone

14. DISTANCE IN MILES AND DIRECTION FROM NEAREST TOWN OR POST OFFICE\*

6 miles SE Bloomfield NM

15. DISTANCE FROM PROPOSED\*

LOCATION TO NEAREST

PROPERTY OR LEASE LINE, FT.

(Also to nearest drlg. unit line, if any)

990'

18. DISTANCE FROM PROPOSED LOCATION\*  
TO NEAREST WELL, DRILLING, COMPLETED,  
OR APPLIED FOR, ON THIS LEASE, FT.

N/A

16. NO. OF ACRES IN LEASE

320

17. NO. OF ACRES ASSIGNED  
TO THIS WELL

320

19. PROPOSED DEPTH

5290

20. ROTARY OR CABLE TOOLS

21. ELEVATIONS (Show whether DF, RT, GR, etc.)

5820

22. APPROX. DATE WORK WILL START\*

8-1-89

23.

PROPOSED CASING AND CEMENTING PROGRAM

SIZE OF HOLE	SIZE OF CASING	WEIGHT PER FOOT	SETTING DEPTH	QUANTITY OF CEMENT
12 1/4	8 5/8	24 #	290	275
7 7/8	4 1/2	10.5 #	6538	1175 (3 stages)

We propose to plug the Gallup Formation and recompleate and test the uphole  
Fruitland Coal zone. Plug back procedure attached.

IN ABOVE SPACE DESCRIBE PROPOSED PROGRAM: If proposal is to deepen or plug back, give data on present productive zone and proposed new productive zone. If proposal is to drill or deepen directionally, give pertinent data on subsurface locations and measured and true vertical depths. Give blowout preventer program, if any.

24.

SIGNED

*[Signature]*

TITLE

Reg. Permit Coord.

DATE

7-18-89

(This space for Federal or State office use)

PERMIT NO.

APPROVAL DATE

APPROVED BY

TITLE

DATE

CONDITIONS OF APPROVAL, IF ANY:



STATE OF NEW MEXICO

ENERGY, MINERALS AND NATURAL RESOURCES DEPARTMENT

OIL CONSERVATION DIVISION

GARREY CARRUTHERS  
GOVERNOR

POST OFFICE BOX 2088  
STATE LAND OFFICE BUILDING  
SANTA FE, NEW MEXICO 87504  
(505) 827-5800

August 17, 1989

Union Texas Petroleum Corporation  
P.O. Box 2120  
Houston, TX 77252-2120

Attention: Ken E. White

Administrative Order NSL-2688

Dear Mr. White:

Reference is made to your application of July 24, 1989 for a non-standard coal gas well location for your existing Angel Peak "8" Well No. 31 located 990 feet from the North line and 1650 feet from the West line (Unit C) of Section 25, Township 28 North, Range 11 West, NMPM, Basin Fruitland Coal (Gas) Pool, San Juan County, New Mexico. The W/2 of said Section 25 shall be dedicated to the well forming a standard 320-acre gas spacing and proration unit for said pool.

By the authority granted me under the provisions of Rule 8 of the Special Rules and Regulations for the Basin-Fruitland Coal (Gas) Pool as promulgated by Division Order No. R-8768, the above-described unorthodox coal gas well location is hereby approved.

Sincerely,

William J. LeMay  
Director

WJL/MES/ag

cc: Oil Conservation Division - Aztec  
New Mexico Oil & Gas Engineering Committee - Hobbs  
US Bureau of Land Management - Farmington

UNITED STATES  
DEPARTMENT OF THE INTERIOR  
BUREAU OF LAND MANAGEMENT

RECEIVED  
BLM

Sundry Notices and Reports on Wells

<p>1. Type of Well GAS</p> <hr/> <p>2. Name of Operator Meridian Oil Inc.</p> <hr/> <p>3. Address &amp; Phone No. of Operator Box 4289, Farmington, NM 87499 (505) 326-9700</p> <hr/> <p>4. Location of Well, Footage, Sec, T, R, M. 990'N, 1650'W Sec. 25, T-28-N, R-11-W, NMPM</p>	<p>5. Lease Number SF-047017BTON, NM</p> <p>6. If Indian, All or Tribe Name</p> <p>7. Unit Agreement Name</p> <p>8. Well Name &amp; Number Angel Peak B #31</p> <p>9. API Well No.</p> <p>10. Field and Pool Basin Fruitland Coal</p> <p>11. County and State San Juan County, NM</p>
--	---

12. CHECK APPROPRIATE BOX TO INDICATE NATURE OF NOTICE, REPORT, OTHER DATA

Type of Submission	Type of Action	
<input type="checkbox"/> Notice of Intent	<input type="checkbox"/> Abandonment	<input type="checkbox"/> Change of Plans
<input checked="" type="checkbox"/> Subsequent Report	<input type="checkbox"/> Recompletion	<input type="checkbox"/> New Construction
<input type="checkbox"/> Final Abandonment	<input type="checkbox"/> Plugging Back	<input type="checkbox"/> Non-Routine Fracturing
	<input type="checkbox"/> Casing Repair	<input type="checkbox"/> Water Shut Off
	<input type="checkbox"/> Altering Casing	<input type="checkbox"/> Conversion to Injection
	<input type="checkbox"/> Other	

13. Describe Proposed or Completed Operations

08-14-89 MOL&RU. TOOH w/2 3/8" tbg. Set cmt retainer @ <sup>5340'</sup> 5355' and squeeze w/75 sx cmt. Stung out of retainer & dumped 2 bbl. cmt on top ret. Ran logs and perf'd lower coal 1769-80' w/4 spf, frac'd w/96,600# sand in 30# x-link gel. Set BP @ 1740'. Perf'd 2 squeeze holes @ 1604'.

08-16-89 TOOH w/tbg & suspended operations. Meridian is trying to obtain a non-standard location permit and will resume operations.

NOTE: the above work was done by Union Texas Petroleum

14. I hereby certify that the foregoing is true and correct  
Signed Patty Bradfield (MP) Title Regulatory Affairs Date 6-17-91

(This space for Federal or State office use)

ACCEPTED FOR RECORD

APPROVED BY \_\_\_\_\_ TITLE \_\_\_\_\_ DATE JUL 07 1991  
CONDITION OF APPROVAL, IF ANY:

OPERATOR

FARMINGTON RESOURCE AREA

BY [Signature]



UNITED STATES  
DEPARTMENT OF THE INTERIOR  
BUREAU OF LAND MANAGEMENT

SUBMIT IN TRI  
(Other instructions  
verse side)

Form approved.  
Budget Bureau No. 1004-0135  
Expires August 31, 1985

SUNDRY NOTICES AND REPORTS ON WELLS

(Do not use this form for proposals to drill or to deepen or plug back to a different reservoir.  
Use "APPLICATION FOR PERMIT—" for such proposals.)

1. OIL WELL <input type="checkbox"/> GAS WELL <input checked="" type="checkbox"/> OTHER <u>Angel Peak B #31</u>	5. LEASE DESIGNATION AND SERIAL NO. See Attached Exhibit "A"
2. NAME OF OPERATOR Union Texas Petroleum Corporation	6. IF INDIAN, ALLOTTEE OR TRIBE NAME See Attached Exhibit "A"
3. ADDRESS OF OPERATOR 1330 Post Oak Blvd., P.O. Box 2120, Houston, TX 77252-2120	7. UNIT AGREEMENT NAME See Attached Exhibit "A"
4. LOCATION OF WELL (Report location clearly and in accordance with any State requirements. See also space 17 below.) At surface  See Attached Exhibit "A"	8. FARM OR LEASE NAME See Attached Exhibit "A"
14. PERMIT NO.	9. WELL NO. See Attached Exhibit "A"
15. ELEVATIONS (Show whether OF, RT, GA, etc.)	10. FIELD AND POOL, OR WILDCAT See Attached Exhibit "A"
	11. SEC., T., R., M., OR BLK. AND SURVEY OR AREA See Attached Exhibit "A"
	12. COUNTY OR PARISH 13. STATE See Attached Exhibit "A"

16. Check Appropriate Box To Indicate Nature of Notice, Report, or Other Data

NOTICE OF INTENTION TO:		SUBSEQUENT REPORT OF:	
TEST WATER SHUT-OFF <input type="checkbox"/>	PCLL OR ALTER CASING <input type="checkbox"/>	WATER SHUT-OFF <input type="checkbox"/>	REPAIRING WELL <input type="checkbox"/>
FRACTURE TREAT <input type="checkbox"/>	MULTIPLE COMPLETE <input type="checkbox"/>	FRACTURE TREATMENT <input type="checkbox"/>	ALTERING CASING <input type="checkbox"/>
SHOOT OR ACIDIZE <input type="checkbox"/>	ABANDON* <input type="checkbox"/>	SHOOTING OR ACIDIZING <input type="checkbox"/>	ABANDONMENT* <input type="checkbox"/>
REPAIR WELL <input type="checkbox"/>	CHANGE PLANS <input type="checkbox"/>	(Other) <input type="checkbox"/>	
(Other) <u>Change of Operator</u>	<u>XX</u>	(NOTE: Report results of multiple completion on Well Completion or Recompletion Report and Log form.)	

17. DESCRIBE PROPOSED OR COMPLETED OPERATIONS (Clearly state all pertinent details, and give pertinent dates, including estimated date of starting any proposed work. If well is directionally drilled, give subsurface locations and measured and true vertical depths for all markers and zones pertinent to this work.) \*

Effective January 1, 1990, we request that the operator of the wells set forth on the attached Exhibit "A" be changed to:

**Meridian Oil Inc., as agent for**  
MERIDIAN OIL PRODUCTION INC.  
3535 East 30th Street  
Farmington, NM 87401

ACCEPTED FOR RECORD

FEB 10 1991

FILED IN RECORDS AREA  
BY G. L. H.

18. I hereby certify that the foregoing is true and correct

SIGNED <u>L. C. Scholz</u>	TITLE <u>L. C. Scholz Director, U.S. Land Operations</u>	DATE <u>JUN 21 1990</u>
(This space for Federal or State office use)		
APPROVED BY _____	TITLE _____	DATE _____
CONDITIONS OF APPROVAL, IF ANY:		

\*See Instructions on Reverse Side

MERIDIAN OIL

October 10, 1990

RECEIVED

OCT 11 1990

MAIL ROOM

Federal Express

Mr. William LeMay  
New Mexico Oil Conservation Division  
310 Old Santa Fe Trail  
Santa Fe, New Mexico 87503

RE: Angel Peak B #31  
990'FNL, 1650'FWL  
Section 25, T-28-N, R-11-W  
San Juan County, New Mexico

Dear Mr. LeMay:

This is a request for administrative approval for a non-standard gas well location in the Basin Fruitland Pool.

Meridian Oil intends to plugback and recomplete the Angel Peak B #31 well from the Wildcat Gallup pool to the Basin Fruitland Coal Pool. The current location of this well is 990'FNL, 1650'FWL, Section 25, T-28-N, R-11-W, San Juan County, New Mexico. The well is considered non-standard due to the NE-SW dedicated pattern established for the Basin Fruitland Coal Pool. To comply with the New Mexico Oil Conservation Division rules, Meridian is submitting the following for your approval of this non-standard location:

1. C-102 plat showing location of the well;
2. Plat showing offset owners/operators;
3. Affidavit of notification of offset owners/operators;
4. Copy of Well Completion Log for original completion.

A copy of this application is being submitted to all offset owners/operators by certified mail with a request that they furnish your Santa Fe office with a Waiver of Objection, and return one copy to this office.

Sincerely yours,

  
Peggy Bradfield  
encl.

WAIVER

BHP Petroleum (Americas) Inc. hereby waives objection to Meridian Oil Inc.'s application for a non-standard location for their Angel Peak B #31 as proposed above.

By:  Date: 11-7-90  
Reservoir Engineering Manager

xc: Amoco Production Company  
BHP Petroleum  
Marathon Oil Co.  
General Minerals Corp.

Angel Peak B #31  
990'FNL, 1650'FWL  
Section 25, T-28-N, R-11-W  
San Juan County, New Mexico

I hereby certify that the following offset owners/operators have been notified by certified mail of our application for administrative approval for non-standard gas well location for the plugback and recompletion of the above well.

Amoco Production Co.  
P.O. Box 800  
Denver, CO 80201

BHP Petroleum  
1650 Broadway, Suite 1900  
Denver, CO 80202

Marathon Oil Co.  
P.O. Box 88322  
Dallas, TX 75388

General Minerals Corp.  
P.O. Box 1289  
Noble, OK 73068

  
Peggy Bradfield  
October 10, 1990

San Juan County  
State of New Mexico

My commission expires August 17, 1992

MERIDIAN OIL INC

Well Name Angel Peak B #31

Footage 990' FNL; 1650' FWL

APPLICATION FOR NON-STANDARD LOCATION

County San Juan State New Mexico Section 25 Township 28 N Range 11 W

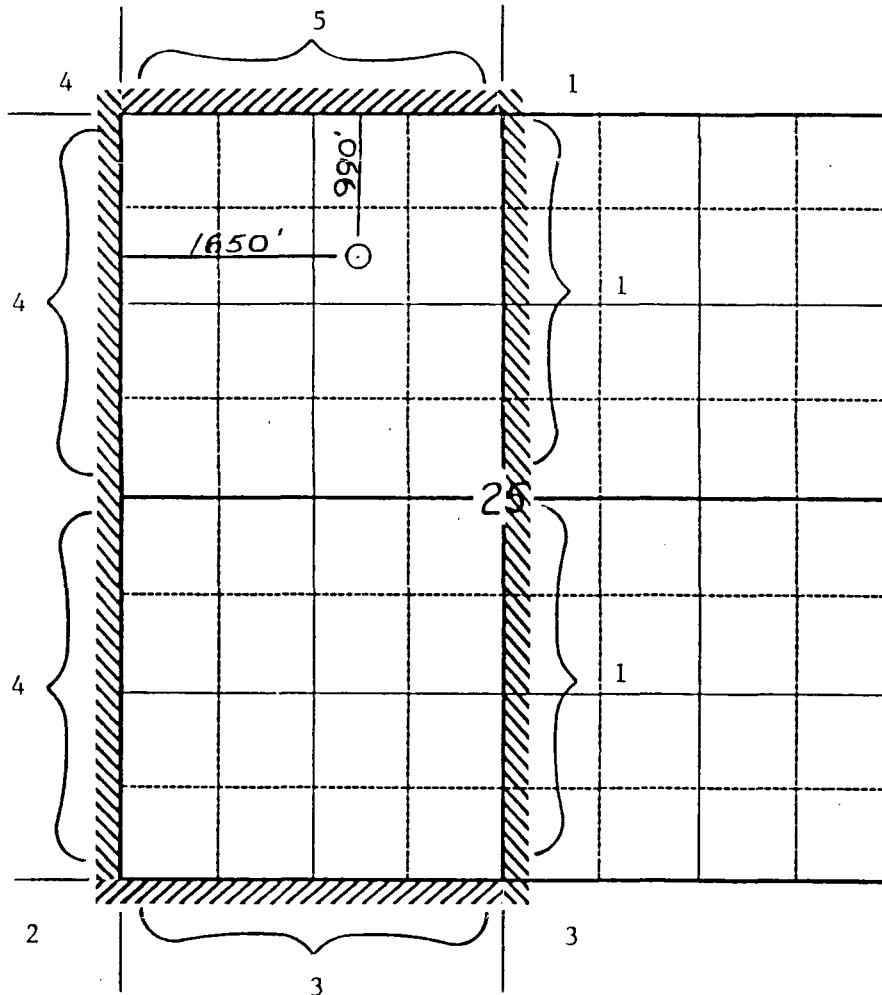

Remarks 1) Meridian Oil Inc.

2) Amoco Production Co.

3) BHP Petroleum- 1650 Broadway, Suite 1900, Denver, CO 80202

4) Marathon Oil Co.-P.O. Box 88322, Dallas, TX. 75388

5) General Minerals Corp.-P.O. Box 1289, Noble, OK 73068

STATE OF NEW MEXICO  
ENERGY, MINERALS AND NATURAL RESOURCES DEPARTMENT  
OIL CONSERVATION DIVISION

GARREY CARRUTHERS  
GOVERNOR

November 8, 1990

POST OFFICE BOX 2088  
STATE LAND OFFICE BUILDING  
SANTA FE, NEW MEXICO 87504  
(505) 827-5800

Meridian Oil, Inc.  
P.O. Box 4289  
Farmington, NM 87499-4289

Attention: Peggy Bradfield

*RE: Unorthodox coal gas well location, Union Texas Petroleum Corporation's Angel Peak "B" Well No. 31, 990' FNL - 1650' FWL (Unit C); 25-T28N-R11W, NMPM, Basin-Fruitland Coal Gas Pool, San Juan County, New Mexico.*

Dear Ms. Bradfield:

By Division Administrative Order NSL-2688, dated August 17, 1990, Union Texas Petroleum Corporation was granted an exception to the well location requirements in the Basin-Fruitland Coal Gas Pool for the subject well. Meridian, evidently, has overlooked this since your application is requesting the identical exception, resulting in the need for additional supporting information. At this time said Order NSL-2688 is hereby stayed pending additional information to clarify the following:

- (1) Meridian's involvement in this well;
- (2) Why this well was chosen over any existing wells in the SW/4 of this Section; and,
- (3) How will this off-pattern recompletion effect coal gas development in the surrounding Section.

Our records still show Union Texas Petroleum Corporation as operator of the subject well, what is Meridian's involvement? Has there been a C-104 (Change of Operator) filed for this well?

Please provide me a detailed plat showing all wells in the W/2 of this Section. For each well please show its status, well name, and number, operator, footage location, spud date, current completed interval and discuss why this well has been chosen over the wells in the SW/4 of the Section.

*Meridian Oil, Inc.*  
*Attention: Peggy Bradfield*  
*November 8, 1990*  
*Page 2*

Further, please submit any supporting production data, engineering evaluation and related technical data to support your choice of wells for recompletion. Also submit a plat of the offsetting sections showing the coal completions presently planned or currently producing and provide a discussion addressing the proposed off-pattern development.

Should you have any questions, please contact me.

Sincerely,

A handwritten signature in black ink, appearing to read "Michael E. Stogner", written in a cursive style.

Michael E. Stogner  
Chief Hearing Officer/Engineer

cc: Oil Conservation Division - Aztec  
US Bureau of Land Management - Farmington

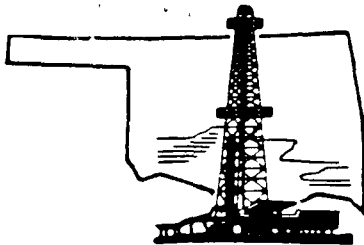

# GENERAL MINERAL CORPORATION

OIL CONSERVATION DIVISION

RECEIVED

Suite 203 • 130 South Main • Noble, Oklahoma 73068  
'90 NOV 13 AM 9 04 405-872-9281

November 9, 1990

William LeMay  
New Mexico Oil Conservation Division  
310 Old Santa Fe Trail  
Santa Fe, NM 87503

RE: Angel Peak B #44  
485' FNL, 2310' FWL  
Section 24-28N-11W  
Operator-Meridian Oil  
San Juan Co. NM

Angel Peak B #38  
NW/4 SW/4 (S/2)  
Section 24-28N-11W  
San Juan Co. NM  
Operator-Meridian Oil

Angel Peak B #31  
990' FNL, 1650' FWL  
Section 25-28N-11W  
Operator-Meridian Oil  
San Juan Co. NM

Gallegos Canyon Unit #390  
245' FSL and 1530' FWL  
Section 23-29N-13W  
San Juan Co. NM  
Operator-BHP Petroleum  
(Americas) Inc.

Dear Mr. LeMay:

Various companies have filed requests with your office for administrative approval of non-standard gas well locations in the San Juan Basin Fruitland Coal Gas Pool. We believe that all of these locations are selected to encroach upon our coal and gas resources under the disguise of non-standard locations. We are opposed to drilling any well at the proposed locations without compensation to our company for taking of our gas.

We also noticed that each of the operators has clearly avoided furnishing the logs to us which will establish the drainage on our resources of coal and gas and therefore, we sincerely request that the proposed locations not be approved.

Please register our objection to approving any of the locations listed above.

Thank you.

Sincerely,

Kris Agrawal  
cc Meridian Oil Co.  
BHP Petroleum (Americas) Inc.  
Chaparral Resources



STATE OF NEW MEXICO

ENERGY, MINERALS AND NATURAL RESOURCES DEPARTMENT

OIL CONSERVATION DIVISION

XC: KOB  
REF

GARREY CARRUTHERS  
GOVERNOR

November 14, 1990

POST OFFICE BOX 2088  
STATE LAND OFFICE BUILDING  
SANTA FE, NEW MEXICO 87504  
(505) 827-5800

**MERIDIAN OIL**

NOV 14 1990

FARMINGTON, NEW MEXICO  
REGULATORY

*Meridian Oil Inc.  
P.O. Box 4289  
Farmington, NM 87499-4289*

*Attention: Peggy Brachfield*

*Re: Application for two unworked  
coal gas well locations:*

*1) Union Texas Petroleum Corp.  
Angel Peak "B" Well No. 31  
990' FWL - 1650' FWL (Unit C)  
25-T28-N-RHW*

*2) Angel Peak "B" Well No. 44  
485' FWL - 2310' FWL (Unit C)  
24-T28-N-R11W*

*Both in San Juan County, New  
Mexico.*

*Dear Ms. Brachfield:*

*The Division has received an objection from General  
Minerals Corporation by letter dated November 9, 1990 (see copy  
attached) to both of the subject applications. This matter will  
therefore be set for hearing before a Division Examiner on the  
next available docket, which is scheduled for December 19, 1990.*



Please provide adequate notice for such applications  
prior to the hearing as required by Division General Rule 1207.

If you should have any questions, please contact me.

Sincerely

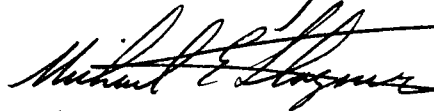

Chief Hearing Officer/Engineer

c.c. - Oil Conservation Division - Austin  
U.S. Bureau of Land Management - Farmington  
W. Thomas Sullivan - Santa Fe  
General Minerals Corporation - Noble, Oklahoma

STATE OF NEW MEXICO  
ENERGY, MINERALS AND NATURAL RESOURCES DEPARTMENT  
OIL CONSERVATION DIVISION

IN THE MATTER OF THE HEARING  
CALLED BY THE OIL CONSERVATION  
DIVISION FOR THE PURPOSE OF  
CONSIDERING:

CASE NO. 10183  
ORDER NO. R-9436

APPLICATION OF MERIDIAN OIL, INC.  
FOR AN UNORTHODOX COAL GAS WELL LOCATION,  
SAN JUAN COUNTY, NEW MEXICO

ORDER OF THE DIVISION

BY THE DIVISION:

This cause came on for hearing at 8:15 a.m. on February 7, 1991, at Santa Fe, New Mexico, before Examiner Michael E. Stogner.

NOW, on this 11th day of February, 1991, the Division Director, having considered the record and the recommendations of the Examiner, and being fully advised in the premises,

FINDS THAT:

The applicant's request for dismissal should be granted.

IT IS THEREFORE ORDERED THAT:

Case No. 10183 is hereby dismissed.

DONE at Santa Fe, New Mexico, on the day and year hereinabove designated.

STATE OF NEW MEXICO  
OIL CONSERVATION DIVISION

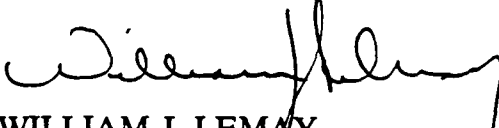
  
WILLIAM J. LEMAY  
Director

S E A L



STATE OF NEW MEXICO

ENERGY, MINERALS AND NATURAL RESOURCES DEPARTMENT

OIL CONSERVATION DIVISION

**MERIDIAN OIL**

FEB 14 1991

BRUCE KING  
GOVERNOR

FARMINGTON, NEW MEXICO  
REGULATORY

February 12, 1991

POST OFFICE BOX 2088  
STATE LAND OFFICE BUILDING  
SANTA FE, NEW MEXICO 87504  
(505) 827-5800

Meridian Oil, Inc.  
c/o Kellahin, Kellahin & Aubrey  
P.O. Box 2265  
Santa Fe, NM 87504-2265

Attention: W. Thomas Kellahin

*RE: Division Case No. 10183: Application of Meridian Oil, Inc. for an unorthodox coal gas well location, Union Texas Petroleum Corporation's Angel Peak "B" Well No. 31, 990' FNL - 1650' FWL (Unit C); 25-T28N-R11W, NMPM, Basin-Fruitland Coal Gas Pool.*

Dear Mr. Kellahin:

By Division Order No. R-9436 the subject application was dismissed. Please refer to my letter to Meridian Oil, Inc. dated November 8, 1990 which stayed said administrative order pending clarification of several issues. On November 13, 1990 an objection to this matter was received from General Minerals Corporation which resulted in the need of placing the matter on the hearing docket.

There are still many issues to be resolved in this matter before this well may be recompleted in the Basin-Fruitland Coal Gas Pool, if such a plan still exists by either Meridian or Union Texas.

Therefore, Division Administrative Order NSL-2688, dated August 17, 1990 is hereby placed in abeyance until further notice.

Sincerely,

Michael E. Stogner  
Chief Hearing Officer/Engineer

MES/ag

cc: Oil Conservation Division - Aztec  
Union Texas Petroleum Corporation - Houston, TX  
Meridian Oil, Inc. - Farmington, NM  
Division Files: Case No. 10183  
NSL-2688

All distances must be from the outer boundaries of the Section

Operator <b>Meridian Oil Inc.</b>			Lease <b>ANGEL PEAK "B"</b>		Well No. <b>31</b>
Unit Letter <b>C</b>	Section <b>25</b>	Township <b>28 NORTH</b>	Range <b>11 WEST</b>	County <b>SAN JUAN</b>	
Actual Locality Location of Well: <b>990</b> feet from the <b>NORTH</b> line and <b>1650</b> feet from the <b>WEST</b> line					
Ground Level Elev. <b>5807</b>	Producing Formation <b>Fruitland Coal</b>		Pool <b>Basin</b>		Dedicated Acres <b>W4 320</b>

1. Outline the acreage dedicated to the subject well by colored pencil or hatchure marks on the plat below.
2. If more than one lease is dedicated to the well, outline each and identify the ownership thereof (both as to working interest and royalty).
3. If more than one lease of different ownership is dedicated to the well, have the interests of all owners been consolidated by communitization, unitization, force-pooling, etc?

☐ Yes ☐ No If answer is "yes," type of consolidation \_\_\_\_\_

If answer is "no," list the owners and tract descriptions which have actually been consolidated. (Use reverse side of this form if necessary.) \_\_\_\_\_

No allowable will be assigned to the well until all interests have been consolidated (by communitization, unitization, force-pooling, or otherwise) or until a non-standard unit, eliminating such interests, has been approved by the Division.

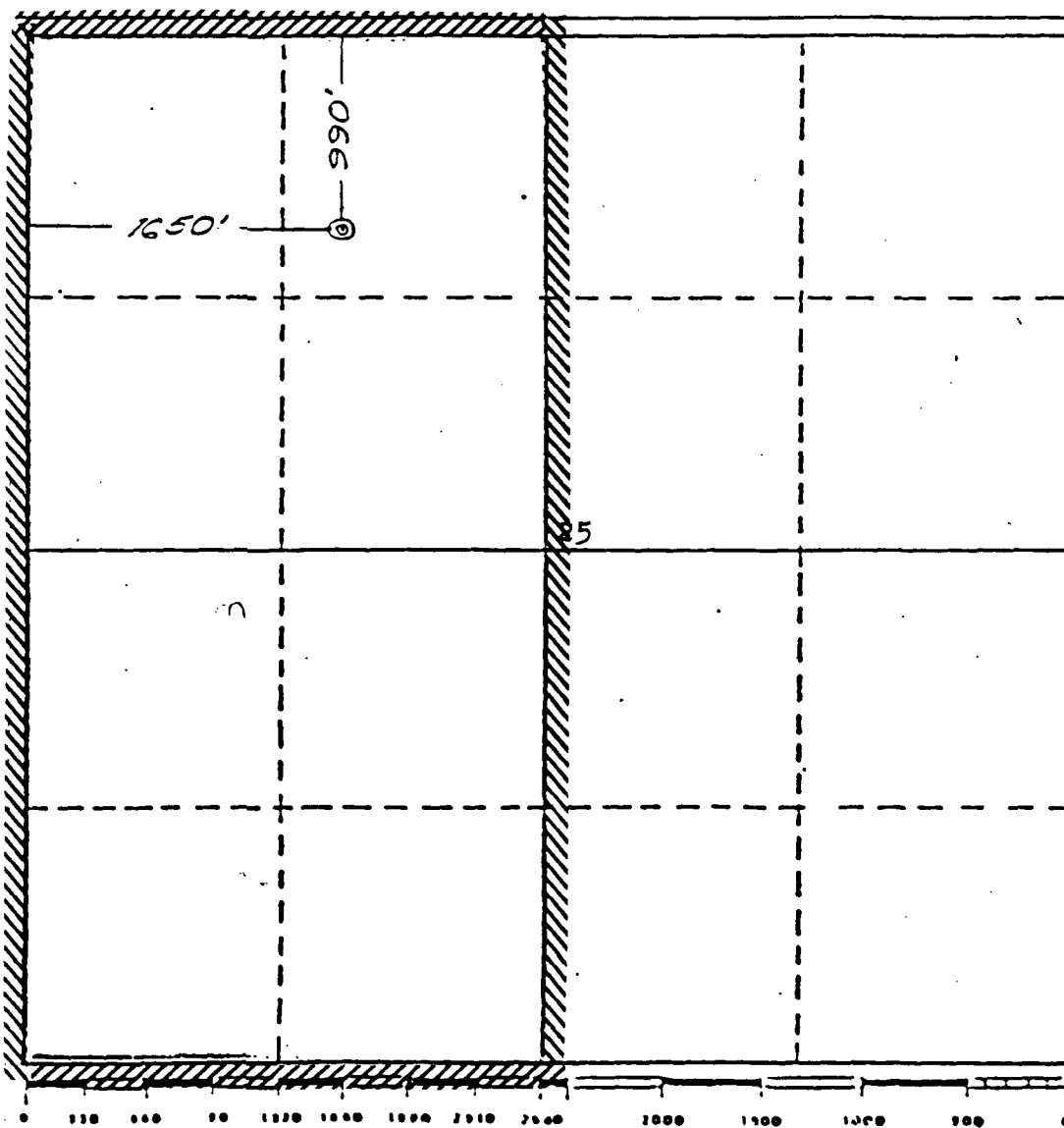

CERTIFICATION

I hereby certify that the information contained herein is true and complete to the best of my knowledge and belief.

Name  
**Peggy Bradfield**  
Position  
**Regulatory Affairs**  
Company  
**Meridian Oil Inc.**  
Date

I hereby certify that the well location shown on this plat was plotted from the notes of actual survey made by me under my supervision, and that the same is true to the best of my knowledge and belief.

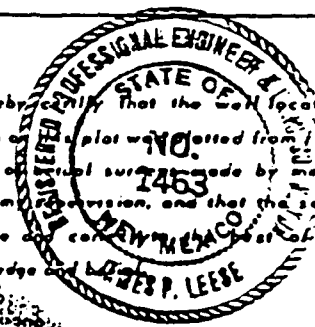

Date Surveyed  
**February 21, 1980**  
Registered Professional Engineer and/or Land Surveyor  
**James P. Leese**  
Certificate No.  
**1463**

# MERIDIAN OIL INC

## ANGEL PEAK B #31

OFFSET OPERATOR \ OWNER PLAT

### Unorthodox Fruitland Coal Well Location

Township 28 North, Range 11 West

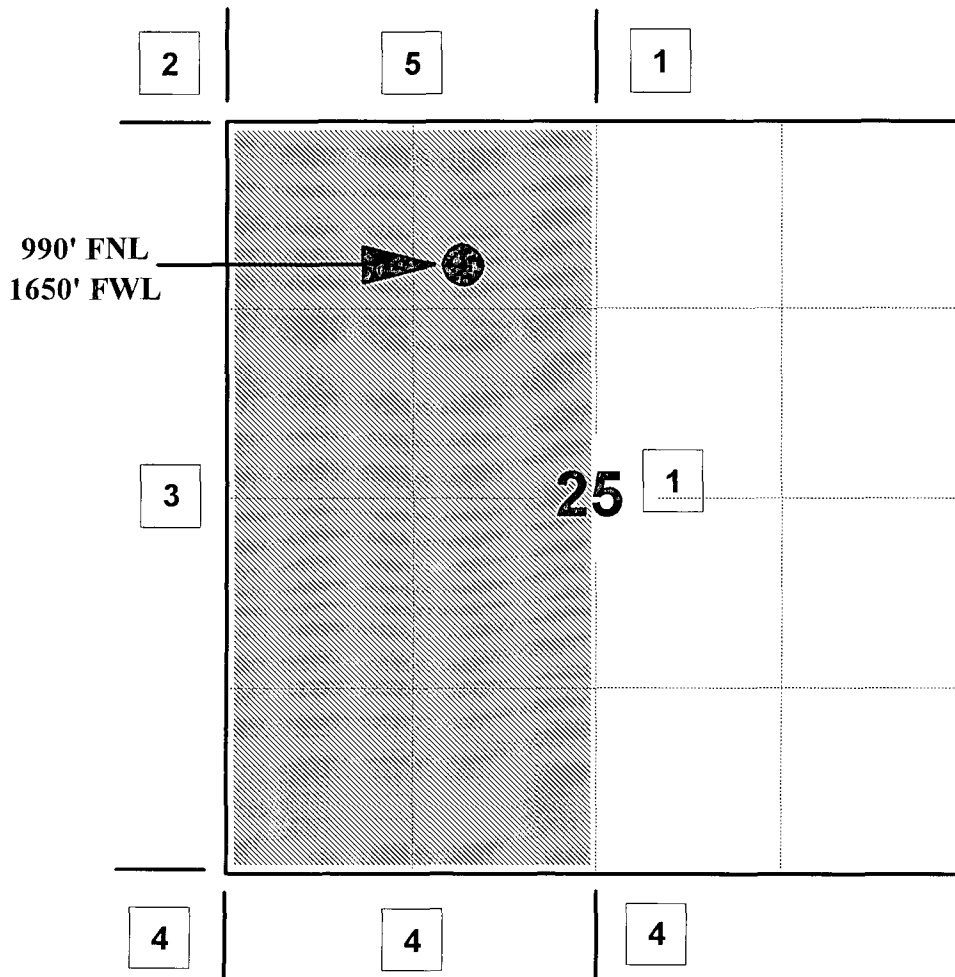

1) Meridian Oil Inc

2) Southland Royalty Company &

Marathon Oil Co.

PO Box 552, Midland, TX 79702

3) Marathon Oil Co.

4) BHP Petroleum

1360 Post Oak Blvd, Suite 500, Houston, TX 77056-3020

5) See Attached

5)	James M. Collins	2001 Bryan Tower, Dallas, TX 75201
	Chaparral Oil & Gas Company	PO Box B, Aztec, NM 87410
	Vanderslice Petroleum Corp.	14335 Regency Place, Dallas, TX 75240
	James U. Cantrell Estate c/o Rick Tully	PO 268, Farmington, NM 87499
	Joe C. Salmon	18929 White Wing Dr. #31484, Rio Verde, AZ 85263
	Bettye Jean Salmon	3604 Melrose Dr., Farmington, NM 87401
	General Minerals Corp. (Operator of Fruitland Sand well in the SW/4)	PO Box 1289, Noble, OK 73068

April 12, 1994

Re: Angel Peak B #31  
990'FNL, 1650'FWL, Section 25, T-28-N, R-11-W, San Juan County, NM  
API #30-045-24458

I hereby certify that the following offset owners/operators have been notified by certified mail of our application for administrative approval for non-standard gas well location for the plugback and recompletion of the above well.

Marathon Oil Co.  
PO Box 552  
Midland, TX 79702

BHP Petroleum  
1360 Post Oak Boulevard, Suite 500  
Houston, TX 77056-3020

James M. Collins  
2001 Bryan Tower  
Dallas, TX 75201

Chapparal Oil & Gas Company  
PO Box "B"  
Aztec, NM 87410

Vanderslice Petroleum Corp.  
14335 Regency Place  
Dallas, TX 75240

James U. Cantrell Estate  
c/o Rick Tully  
PO Box 268  
Farmington, NM 87499

Joe C. Salmon  
18929 White Wing Drive #31484  
Rio Verde, AZ 85263

Bettye Jean Salmon  
3604 Melrose Drive  
Farmington, NM 87401

General Minerals Corp.  
PO Box 1289  
Noble, OK 73068

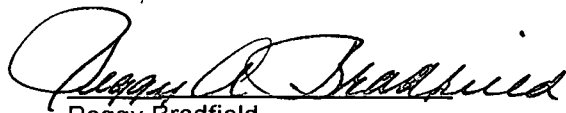
A handwritten signature in cursive script, appearing to read "Peggy Bradfield", written in dark ink.

Peggy Bradfield  
Notary Public  
San Juan County, New Mexico  
My commission expires August 17, 1996

UNITED STATES  
DEPARTMENT OF THE INTERIOR  
GEOLOGICAL SURVEY

SUBMIT IN DUP.

(See instructions on  
reverse side)

16

Form approved.  
Budget Bureau No. 42-R355.6.

## WELL COMPLETION OR RECOMPLETION REPORT AND LOG \*

1a. TYPE OF WELL: OIL WELL <input checked="" type="checkbox"/> GAS WELL <input type="checkbox"/> DRY <input type="checkbox"/> Other _____				3. LEASE DESIGNATION AND SERIAL NO. SF 047017 B							
b. TYPE OF COMPLETION: NEW WELL <input checked="" type="checkbox"/> WORK OVER <input type="checkbox"/> DEEP-EN <input type="checkbox"/> PLUG BACK <input type="checkbox"/> DIFF. RESVR. <input type="checkbox"/> Other _____				6. IF INDIAN, ALLOTTEE OR TRIBE NAME							
2. NAME OF OPERATOR Supron Energy Corporation				7. UNIT AGREEMENT NAME							
3. ADDRESS OF OPERATOR P. O. Box 808; Farmington, NM 87401				8. FARM OR LEASE NAME Angel Peak "B"							
4. LOCATION OF WELL (Report location clearly and in accordance with any State requirements): At surface 990 ft./N; 1650 ft/W line At top prod. interval reported below Same as above At total depth Same as above				9. WELL NO. 31							
14. PERMIT NO. _____ DATE ISSUED _____ U. S. GEOLOGICAL SURVEY FARMINGTON, N. M.				10. FIELD AND POOL, OR WILDCAT Wildcat Gallup							
15. DATE SPUDDED 12/27/80				16. DATE T.D. REACHED 1/7/81		17. DATE COMPL. (Ready to prod.) 3/1/82		18. ELEVATIONS (DF, REB, RT, GR, ETC.)* 5820 R.K.B.		19. ELEV. CASINGHEAD 5807	
20. TOTAL DEPTH, MD & TVD 6538 MD & TVD		21. PLUG BACK T.D., MD & TVD 5914 MD & TVD		22. IF MULTIPLE COMPL., HOW MANY* -----		23. INTERVALS DRILLED BY -----		ROTARY TOOLS 0-6538		CABLE TOOLS -----	
24. PRODUCING INTERVAL(S), OF THIS COMPLETION—TOP, BOTTOM, NAME (MD AND TVD)* 5348-5870 Gallup (MD & TVD)										25. WAS DIRECTIONAL SURVEY MADE NO	
26. TYPE ELECTRIC AND OTHER LOGS RUN Induction Electric & Compensated Density										27. WAS WELL CORED NO	
28. CASING RECORD (Report all strings set in well)											
CASING SIZE		WEIGHT, LB./FT.		DEPTH SET (MD)		HOLE SIZE		CEMENTING RECORD		AMOUNT PULLED	
8 5/8"		24.00		290		12 1/4"		275 sacks			
4 1/2"		10.50		6538		7 7/8"		1175 sacks (3 stages)			
								See Attached			
29. LINER RECORD											
SIZE		TOP (MD)		BOTTOM (MD)		SACKS CEMENT*		SCREEN (MD)			
30. TUBING RECORD											
SIZE		DEPTH SET (MD)		PACKER SET (MD)							
2 3/8" EUE		5799 ft.									
31. PERFORATION RECORD (Interval, size and number)											
Lower: 1-0.40" hole at each of the following depths: 5580, 86,96,5604,21,34, 61,69,75,82, 5700,09,29,36,51,57, 89,94,5235,70. (Total of 20 holes). Upper: 1-0.40" hole at each of the following depths: 5348,52,68,72,78,84,96,											
32. ACID, SHOT, FRACTURE, CEMENT SQUEEZE, ETC.											
DEPTH INTERVAL (MD)		AMOUNT AND KIND OF MATERIAL USED									
5580-5870		1000 gal. 7 1/2% HCL, 85,000 gal. 7 foam & 95,000 lb. 20-40 sand.									
5348-5530 1000		gal. 7 1/2% HCL, 85,000 gal. 70-30 foam, & 95,000 lb. 20-40 sand.									
33.* (OVER) PRODUCTION											
DATE FIRST PRODUCTION 2/2/82		PRODUCTION METHOD (Flowing, gas lift, pumping—size and type of pump) Pumping (TESTING)						WELL STATUS (Producing or shut-in) Shut-In			
DATE OF TEST 2/19/82		HOURS TESTED 24		CHOKE SIZE 1/2"		PROD'N. FOR TEST PERIOD -----		OIL—BBL. 25		GAS—MCF. 138	
FLOW, TUBING PRESS. 100		CASING PRESSURE 250		CALCULATED 24-HOUR RATE -----		OIL—BBL. 25		GAS—MCF. 138		WATER—BBL. 0	
										OIL GRAVITY-API (CORR.) 40°	
34. DISPOSITION OF GAS (Sold, used for fuel, vented, etc.) Vented										TEST WITNESSED BY Bennie Brown	
35. LIST OF ATTACHMENTS											
36. I hereby certify that the foregoing and attached information is complete and correct as determined from a direct examination of the records of the well.											

SIGNED

Kenneth E. Roddy

TITLE Production Superintendent

DATE

March 8, 1982

\*(See Instructions and Spaces for Additional Data on Reverse Side)

OPERATOR

FARMINGTON DISTRICT



## **Mike Stogner**

---

**From:** Ernie Busch  
**To:** Mike Stogner  
**Subject:** MERIDIAN OIL INC. (NSL)  
**Date:** Tue, May 17, 1994 7:29AM  
**Priority:** High

WELL NAME & NO. ANGEL PEAK B #31  
LOCATION: C-25-28N-11W  
FOOTAGE: 990 FNL; 1650 FWL  
RECOMMEND: APPROVAL



STATE OF NEW MEXICO  
ENERGY, MINERALS AND NATURAL RESOURCES DEPARTMENT  
OIL CONSERVATION DIVISION

BRUCE KING  
GOVERNOR

February 12, 1991

POST OFFICE BOX 2088  
STATE LAND OFFICE BUILDING  
SANTA FE, NEW MEXICO 87504  
(505) 827-5800

Meridian Oil, Inc.  
c/o Kellahin, Kellahin & Aubrey  
P.O. Box 2265  
Santa Fe, NM 87504-2265

Attention: W. Thomas Kellahin

*RE: Division Case No. 10183: Application of Meridian Oil, Inc. for an unorthodox coal gas well location, Union Texas Petroleum Corporation's Angel Peak "B" Well No. 31, 990' FNL - 1650' FWL (Unit C); 25-T28N-R11W, NMPM, Basin-Fruitland Coal Gas Pool.*

Dear Mr. Kellahin:

By Division Order No. R-9436 the subject application was dismissed. Please refer to my letter to Meridian Oil, Inc. dated November 8, 1990 which stayed said administrative order pending clarification of several issues. On November 13, 1990 an objection to this matter was received from General Minerals Corporation which resulted in the need of placing the matter on the hearing docket.

There are still many issues to be resolved in this matter before this well may be recompleted in the Basin-Fruitland Coal Gas Pool, if such a plan still exists by either Meridian or Union Texas.

Therefore, Division Administrative Order NSL-2688, dated August 17, 1990 is hereby placed in abeyance until further notice.

Sincerely,

Michael E. Stogner  
Chief Hearing Officer/Engineer

MES/ag

cc: Oil Conservation Division - Aztec  
Union Texas Petroleum Corporation - Houston, TX  
Meridian Oil, Inc. - Farmington, NM  
Division Files: Case No. 10183  
NSL-2683

STATE OF NEW MEXICO  
ENERGY, MINERALS AND NATURAL RESOURCES DEPARTMENT  
OIL CONSERVATION DIVISION

IN THE MATTER OF THE HEARING  
CALLED BY THE OIL CONSERVATION  
DIVISION FOR THE PURPOSE OF  
CONSIDERING:

CASE NO. 10183  
ORDER NO. R-9436

APPLICATION OF MERIDIAN OIL, INC.  
FOR AN UNORTHODOX COAL GAS WELL LOCATION,  
SAN JUAN COUNTY, NEW MEXICO

ORDER OF THE DIVISION

BY THE DIVISION:

This cause came on for hearing at 8:15 a.m. on February 7, 1991, at Santa Fe, New Mexico, before Examiner Michael E. Stogner.

NOW, on this 11th day of February, 1991, the Division Director, having considered the record and the recommendations of the Examiner, and being fully advised in the premises,

FINDS THAT:

The applicant's request for dismissal should be granted.

IT IS THEREFORE ORDERED THAT:

Case No. 10183 is hereby dismissed.

DONE at Santa Fe, New Mexico, on the day and year hereinabove designated.

STATE OF NEW MEXICO  
OIL CONSERVATION DIVISION

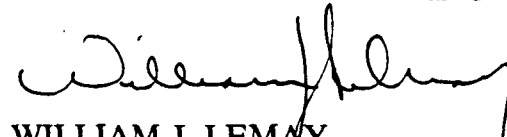
  
WILLIAM J. LEMAY  
Director

S E A L

STATE OF NEW MEXICO  
ENERGY, MINERALS AND NATURAL RESOURCES DEPARTMENT  
OIL CONSERVATION DIVISION

GARREY CARRUTHERS  
GOVERNOR

November 8, 1990

POST OFFICE BOX 2088  
STATE LAND OFFICE BUILDING  
SANTA FE, NEW MEXICO 87504  
(505) 827-5800

Meridian Oil, Inc.  
P.O. Box 4289  
Farmington, NM 87499-4289

Attention: Peggy Bradfield

*RE: Unorthodox coal gas well location, Union Texas Petroleum Corporation's Angel Peak "B" Well No. 31, 990' FNL - 1650' FWL (Unit C); 25-T28N-R11W, NMPM, Basin-Fruitland Coal Gas Pool, San Juan County, New Mexico.*

Dear Ms. Bradfield:

By Division Administrative Order NSL-2688, dated August 17, 1990, Union Texas Petroleum Corporation was granted an exception to the well location requirements in the Basin-Fruitland Coal Gas Pool for the subject well. Meridian, evidently, has overlooked this since your application is requesting the identical exception, resulting in the need for additional supporting information. At this time said Order NSL-2688 is hereby stayed pending additional information to clarify the following:

- (1) Meridian's involvement in this well;
- (2) Why this well was chosen over any existing wells in the SW/4 of this Section; and,
- (3) How will this off-pattern recompletion effect coal gas development in the surrounding Section.

Our records still show Union Texas Petroleum Corporation as operator of the subject well, what is Meridian's involvement? Has there been a C-104 (Change of Operator) filed for this well?

Please provide me a detailed plat showing all wells in the W/2 of this Section. For each well please show its status, well name, and number, operator, footage location, spud date, current completed interval and discuss why this well has been chosen over the wells in the SW/4 of the Section.

*Meridian Oil, Inc.*  
*Attention: Peggy Bradfield*  
*November 8, 1990*  
*Page 2*

Further, please submit any supporting production data, engineering evaluation and related technical data to support your choice of wells for recompletion. Also submit a plat of the offsetting sections showing the coal completions presently planned or currently producing and provide a discussion addressing the proposed off-pattern development.

Should you have any questions, please contact me.

Sincerely,

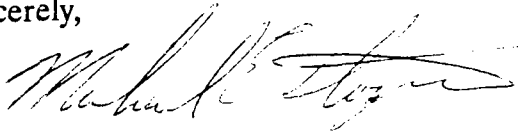
A handwritten signature in dark ink, appearing to read "Michael E. Stogner", with a stylized, flowing script.

Michael E. Stogner  
Chief Hearing Officer/Engineer

cc: Oil Conservation Division - Aztec  
US Bureau of Land Management - Farmington



STATE OF NEW MEXICO

ENERGY, MINERALS AND NATURAL RESOURCES DEPARTMENT

OIL CONSERVATION DIVISION

GARREY CARRUTHERS  
GOVERNOR

POST OFFICE BOX 2088  
STATE LAND OFFICE BUILDING  
SANTA FE, NEW MEXICO 87504  
(505) 827-5800

August 17, 1989

Union Texas Petroleum Corporation  
P.O. Box 2120  
Houston, TX 77252-2120

Attention: Ken E. White

Administrative Order NSL-2688

Dear Mr. White:

Reference is made to your application of July 24, 1989 for a non-standard coal gas well location for your existing Angel Peak "8" Well No. 31 located 990 feet from the North line and 1650 feet from the West line (Unit C) of Section 25, Township 28 North, Range 11 West, NMPM, Basin Fruitland Coal (Gas) Pool, San Juan County, New Mexico. The W/2 of said Section 25 shall be dedicated to the well forming a standard 320-acre gas spacing and proration unit for said pool.

By the authority granted me under the provisions of Rule 8 of the Special Rules and Regulations for the Basin-Fruitland Coal (Gas) Pool as promulgated by Division Order No. R-8768, the above-described unorthodox coal gas well location is hereby approved.

Sincerely,

A handwritten signature in dark ink, appearing to read "William J. LeMay".

William J. LeMay  
Director

WJL/MES/ag

cc: Oil Conservation Division - Aztec  
New Mexico Oil & Gas Engineering Committee - Hobbs  
US Bureau of Land Management - Farmington



STATE OF NEW MEXICO  
ENERGY, MINERALS AND NATURAL RESOURCES DEPARTMENT  
OIL CONSERVATION DIVISION

GARREY CARRUTHERS  
GOVERNOR

November 14, 1990

POST OFFICE BOX 2088  
STATE LAND OFFICE BUILDING  
SANTA FE, NEW MEXICO 87504  
(505) 827-5800

Meridian Oil Inc.  
P.O. Box 4289  
Farmington, N.M. 87499-4289

Case 10183

Attention: Peggy Bruchfield

Re: Application for two unorthodox  
coal gas well locations:

- 1) Union Texas Petroleum Corp.  
Angel Peak "B" Well No. 31  
990' FWL - 1650' FWL (Unit C)  
25-T28.N-R4W
- 2) Angel Peak "B" Well No. 44  
485' FWL - 2310' FWL (Unit C)  
24-T28.N-R11W

Both in San Juan County, New  
Mexico.

Dear Ms. Bruchfield:

The Division has received an objection from General Minerals Corporation by letter dated November 9, 1990 (see copy attached) to both of the subject applications. This matter will therefore be set for hearing before a Division Examiner on the next available docket, which is scheduled for December 19, 1990.

Please provide adequate notice for such applications  
prior to the hearing as required by Division General Rule 1207.

If you should have any questions, please contact me.

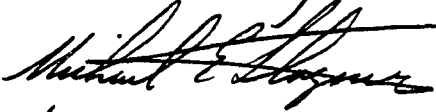
Sincerely  
  
Chief Hearing Officer/Engineer

c.c. - Oil Conservation Division - Nyls  
U.S. Bureau of Land Management - Farmington  
W. Thomas Sullivan - Santa Fe  
General Minerals Corporation - Noble, Oklahoma



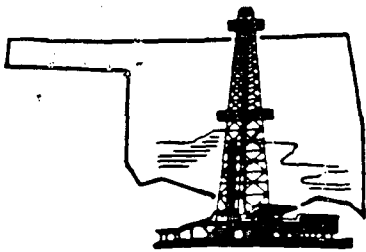

# GENERAL MINERALS CORPORATION

OIL CONSERVATION DIVISION

RECEIVED

'90 NOV 13 AM 9 04

Suite 203 • 130 South Main • Noble, Oklahoma 73068  
405-872-9281

November 9, 1990

William LeMay  
New Mexico Oil Conservation Division  
310 Old Santa Fe Trail  
Santa Fe, NM 87503

*Case 10183*

RE: Angel Peak B #44  
485' FNL, 2310' FWL  
Section 24-28N-11W  
Operator-Meridian Oil  
San Juan Co. NM

Angel Peak B #31  
990' FNL, 1650' FWL  
Section 25-28N-11W  
Operator-Meridian Oil  
San Juan Co. NM

Angel Peak B #38  
NW/4 SW/4 (S/2)  
Section 24-28N-11W  
San Juan Co. NM  
Operator-Meridian Oil

Gallegos Canyon Unit #390  
245' FSL and 1530' FWL  
Section 23-29N-13W  
San Juan Co. NM  
Operator-BHP Petroleum  
(Americas) Inc.

Dear Mr. LeMay:

Various companies have filed requests with your office for administrative approval of non-standard gas well locations in the San Juan Basin Fruitland Coal Gas Pool. We believe that all of these locations are selected to encroach upon our coal and gas resources under the disguise of non-standard locations. We are opposed to drilling any well at the proposed locations without compensation to our company for taking of our gas.

We also noticed that each of the operators has clearly avoided furnishing the logs to us which will establish the drainage on our resources of coal and gas and therefore, we sincerely request that the proposed locations not be approved.

Please register our objection to approving any of the locations listed above.

Thank you.

Sincerely,

Kris Agrawal  
cc Meridian Oil Co.  
BHP Petroleum (Americas) Inc.  
Chaparral Resources

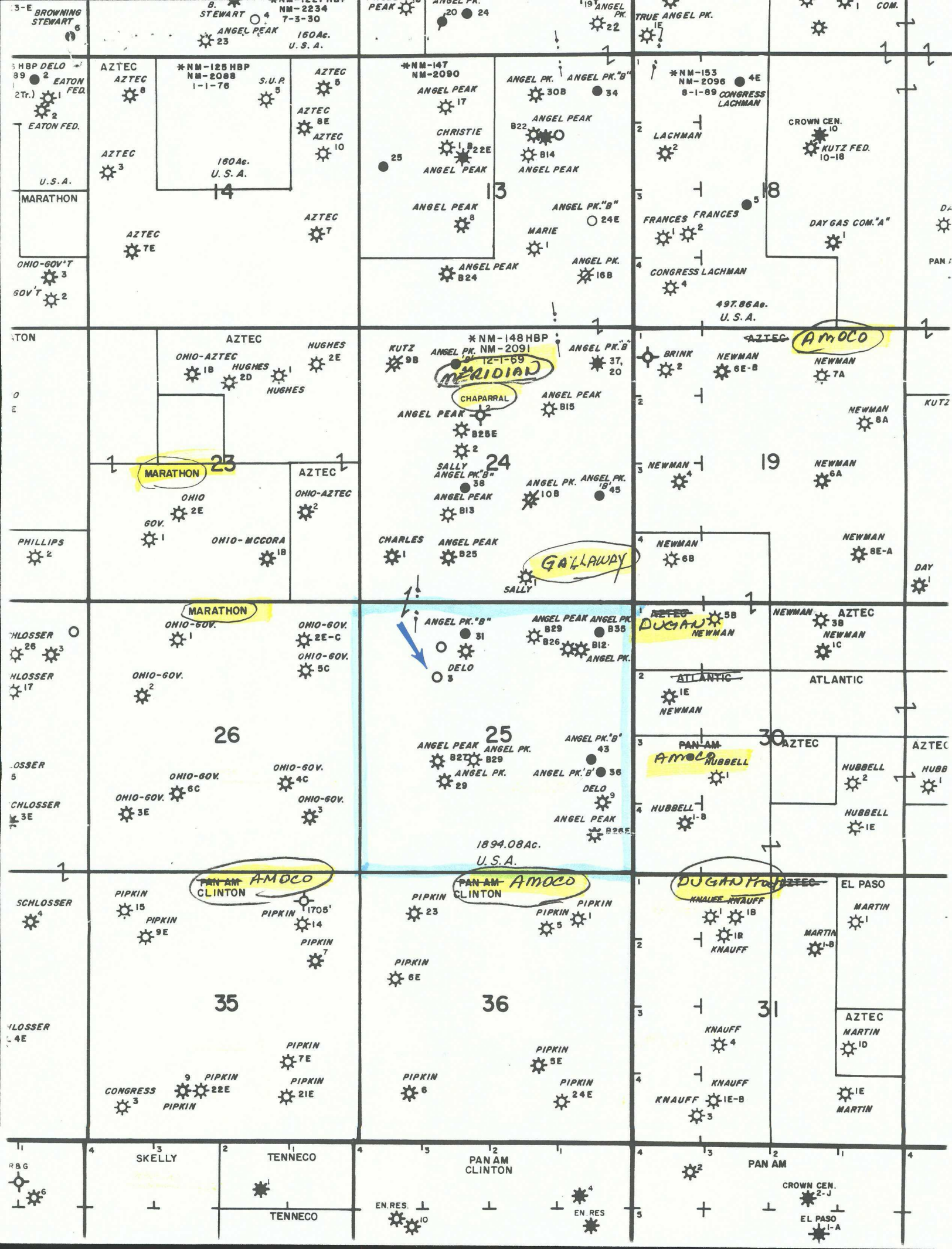



STATE OF NEW MEXICO  
ENERGY AND MINERALS DEPARTMENT  
OIL CONSERVATION DIVISION  
AZTEC DISTRICT OFFICE

GARREY CARRUTHERS  
GOVERNOR

1000 RIO BRAZOS ROAD  
AZTEC, NEW MEXICO 87410  
(505) 334-6178

Date: 8-1-89

Oil Conservation Division  
P.O. Box 2088  
Santa Fe, NM 87504-2088

RECEIVED

AUG 4 1989  
OIL CONSERVATION DIV.  
SANTA FE

Re: Proposed MC \_\_\_\_\_  
Proposed DHC \_\_\_\_\_  
Proposed NSL X \_\_\_\_\_  
Proposed SWD \_\_\_\_\_  
Proposed WFX \_\_\_\_\_  
Proposed PMX \_\_\_\_\_

Gentlemen:

I have examined the application dated 7-26-89  
for the Union Texas Petroleum Corp. Angel Peak 8 #31  
Operator Lease & Well No.

C-25-28N-11W and my recommendations are as follows:  
Unit, S-T-R

Approve  
\_\_\_\_\_  
\_\_\_\_\_  
\_\_\_\_\_  
\_\_\_\_\_

Yours truly,

E. A. Buel