

August 3, 1989

New Mexico Oil Conservation Division  
ATTN: Mike Stogner  
P O Box 2088  
Santa Fe, NM 87504-2088

RECEIVED

AUG 8 1989

OIL CONSERVATION DIV.  
SANTA FE

RE: Application for Unorthodox Location  
Nassau Resources, Inc.  
Carracas Unit 28 B #5  
1850' FNL - 790' FWL  
Sec. 28, Township 32 North, Range 4 West, NMPM  
Rio Arriba County, New Mexico

Gentlemen:

Nassau Resources, Inc., hereby requests administrative approval of an unorthodox location for the captioned well based upon topographic conditions and Carson National Forest requirements.

This location is unorthodox due to the rough terrain and Carson National Forest guidelines for development and off-road vehicle restriction. Enclosed is a letter from Phillip Settles regarding Carson's guidelines, as well as a topographic map.

This well is in Nassau's Carracas Unit. All offsetting leases, as shown on the attached lease plat, are owned by Kindermac Partners, an operating affiliate with Nassau Resources, Inc. Therefore, we request that the 20 day waiting period be waived, and that this application be approved as soon as possible.

Also attached are a production map of the area and the C-102 Plat.

Please contact us if anything further is required to complete this application.

Respectfully submitted,

*Fran Perrin*  
Fran Perrin

Attachments

xc: Ernie Busch, NMOCD, Aztec, NM  
Kindermac Partners

All distances must be from the outer boundaries of the Section.

Operator Nassau Resources, Inc.			Lease Carracas Unit 28 B		Well No. 5
Unit Letter E	Section 28	Township 32 North	Range 4 West	County Rio Arriba	
Actual Footage Location of Well 1850 feet from the North line and 790 feet from the West line					
Ground Level Elev. 7320	Producing Formation Fruitland		Pool Basin Fruitland Coal	Dedicated Acreage 320.0 Acres	

1. Outline the acreage dedicated to the subject well by colored pencil or hatchure marks on the plat below.
2. If more than one lease is dedicated to the well, outline each and identify the ownership thereof (both as to working interest and royalty).
3. If more than one lease of different ownership is dedicated to the well, have the interests of all owners been consolidated by communitization, unitization, force-pooling, etc?

☒ Yes ☐ No If answer is "yes," type of consolidation Unitization - Carracas Unit

If answer is "no," list the owners and tract descriptions which have actually been consolidated. (Use reverse side of this form if necessary.)

No allowable will be assigned to the well until all interests have been consolidated (by communitization, unitization, forced-pooling, or otherwise) or until a non-standard unit, eliminating such interests, has been approved by the Division.

1850	Nassau Resources, Inc. Carracas Unit 28 B #5
790	Appl. for Unorthodox Loc.
NM 30014 Kindermac Partners, Inc. 100%	
SECTION 28	
	FARMINGTON RESOURCE AREA FARMINGTON, NEW MEXICO 89 JAN 30 PM 2:13 RECEIVED BLM MAIL ROOM

CERTIFICATION	
I hereby certify that the information contained herein is true and complete to the best of my knowledge and belief.	
Name	Fran Perrin
Position	Admin. Asst.
Company	Nassau Resources, Inc.
Date	1/27/89
	
Date Surveyed	5-14-88
Registered Professional Engineer and/or Land Surveyor	
Edgar L. Risenhoover	



United States  
Department of  
Agriculture

Forest  
Service

Jicarilla  
Ranger District

Gobernador Route  
Blanco, NM 87412

Reply to: 2820

Date: August 3, 1988

Mr. James Hazen  
Nassau Resources, Inc.  
P.O. Box 809  
Farmington, New Mexico 87499

Dear James:

It was brought to my attention by Mike Atchison that you will be needing to apply for some unorthodox locations for some of the wells in the Carracas Unit. The current location in need of unorthodox approval is the well location just northwest of the Carracas Administrative site, Section 18, T. 32 N., R. 4 W. The need for moving the location to the new site is based upon wildlife habitat protection and in keeping within the guidelines set forth in the Carson Forest Plan. The Plan, as you know, has a major emphasis in wildlife and wildlife habitat. Also key to this request for moving the location is the current Off-Road-Vehicle restriction policy in place over the entire Carracas Unit. This restriction is in place to limit off-road-vehicle travel within a key wildlife management area so that security area will not be lost by unnecessary road construction.

Whenever possible, locations will be required to be placed along open access roads. Further unorthodox locations can be expected within the Carracas Unit to keep in line with the management direction set forth for this area.

Because of this management direction and the probability of future relocations, I would hope the approval of these unorthodox locations can become routine. If not, please don't hesitate to contact me for further help or if needed to appear in person before the approving officer. If you have any questions, please give me a call.

Sincerely,

*Philip R. Settles*

PHILIP R. SETTLES  
District Forest Ranger

Jerome P. McHugh  
Farmington, N.M.

CARING FOR THE LAND AND SERVING PEOPLE



AUG 9 1988

RECEIVED

17

16

15

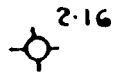

San Juan 32-4 Unit

20

21

22

Kindermac

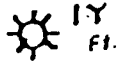

Proposed  
Location  
CU 21 B  
#13

Arboles 29A

Proposed  
Location  
CU 29 B  
#8

1 mile

28

27

Kindermac



Proposed  
Location  
CU 28 B  
#10

Arboles A

Proposed  
Location  
CU 33 B  
#4

32

33

34

T32N

R4W

T31N

5

4

3

Nassau Resources, Inc.  
Carracas Unit 28 B #5

Appl. for Unorthodox Loc.

Amoco

LEASE PLAT

Township 32 North, Range 4 West, NMPM, Rio Arriba County, New Mexico

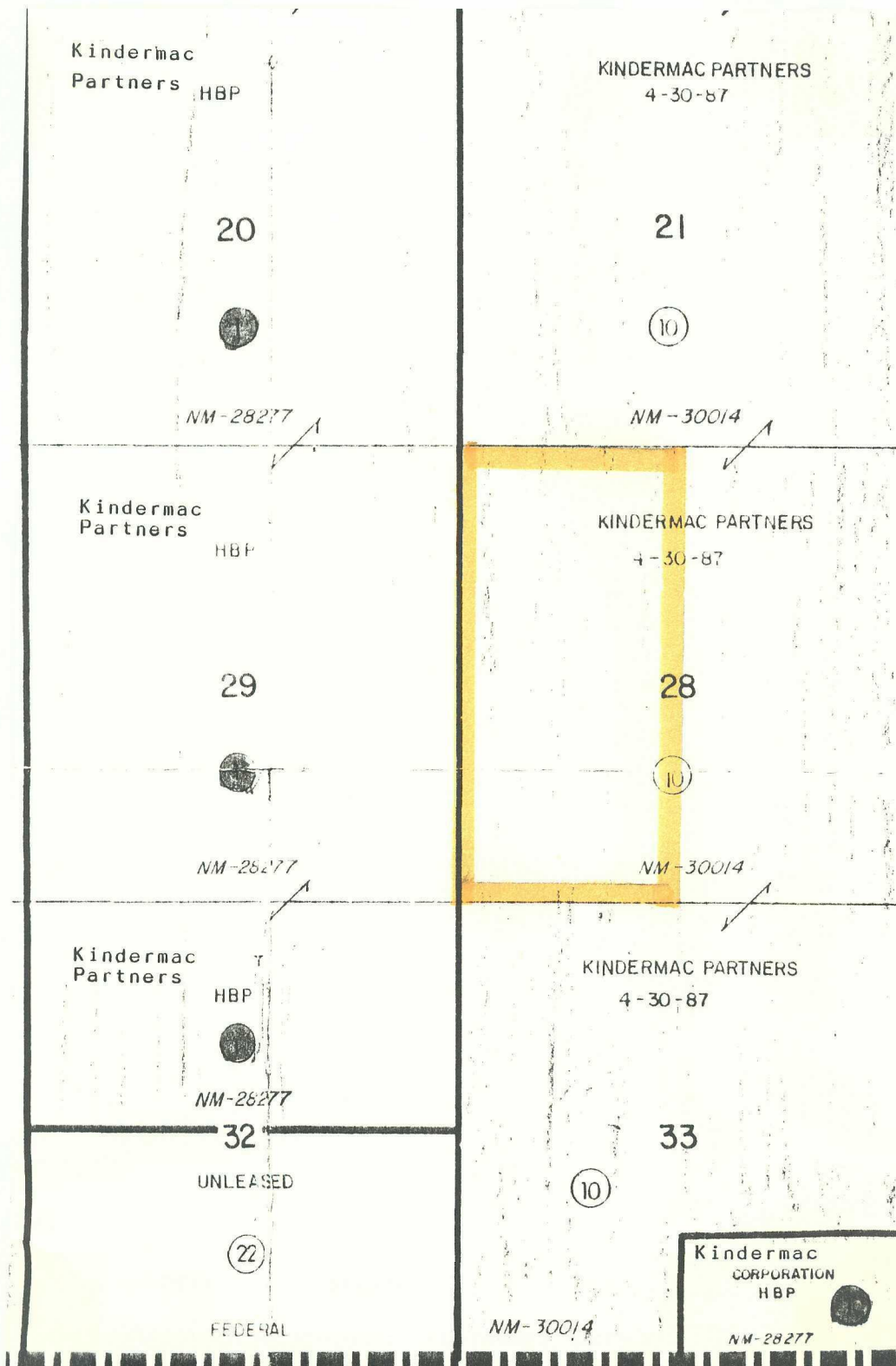





STATE OF NEW MEXICO  
ENERGY AND MINERALS DEPARTMENT  
OIL CONSERVATION DIVISION  
AZTEC DISTRICT OFFICE

GARREY CARRUTHERS  
GOVERNOR

1000 RIO BRAZOS ROAD  
AZTEC, NEW MEXICO 87410  
(505) 334-6178

Date: 8-8-89

Oil Conservation Division  
P.O. Box 2088  
Santa Fe, NM 87504-2088

Re: Proposed MC \_\_\_\_\_  
Proposed DHC \_\_\_\_\_  
Proposed NSL A \_\_\_\_\_  
Proposed SWD \_\_\_\_\_  
Proposed WFX \_\_\_\_\_  
Proposed PMX \_\_\_\_\_

RECEIVED

AUG 10 1989

OIL CONSERVATION DIV.  
SANTA FE

Gentlemen:

I have examined the application dated 8-7-89

for the Nascent Pet. Inc. Carroca Unit 28B #5  
Operator Lease & Well No.

E-28-32N-4W and my recommendations are as follows:  
Unit, S-T-R

Approve  
\_\_\_\_\_  
\_\_\_\_\_  
\_\_\_\_\_  
\_\_\_\_\_

Yours truly,

Earl A. Buel

RECEIVED

AUG 10 1989

OIL CONSERVATION DIV.  
SANTA FE