

# MERIDIAN OIL

June 28, 1990

RECEIVED

JUN 29 1990

OIL CONSERVATION DIVISION

Federal Express

Mr. William LeMay  
New Mexico Oil Conservation Division  
Post Office Box 2088  
Santa Fe, New Mexico 87503

RE: Huerfano Unit #84  
890'FSL, 991'FEL  
Section 26, T-27-N, R-11-W  
San Juan County, New Mexico

Dear Mr. LeMay:

This is a request for administrative approval for a non-standard gas well location in the Basin Fruitland Pool.

El Paso Natural Gas Company intends to plugback and recompleate the Huerfano Unit #84 well from the Pictured Cliffs pool to the Basin Fruitland Coal Pool. The current location of this well is 890'FSL, 991'FEL, Section 26, T-27-N, R-11-W, San Juan County, New Mexico. The well is considered non-standard due to the NE-SW dedicated pattern established for the Basin Fruitland Coal Pool. To comply with the New Mexico Oil Conservation Division rules, Meridian is submitting the following for your approval of this non-standard location:

1. C-102 plat showing location of the well;
2. Plat showing offset owners/operators;
3. Affidavit of notification of offset owners/operators;
4. Copy of Well Completion Log for original completion.

A copy of this application is being submitted to all offset owners/operators by certified mail with a request that they furnish your Santa Fe office with a Waiver of Objection, and return one copy to this office.

Sincerely yours,



Peggy Bradfield  
encl.

## WAIVER

\_\_\_\_\_ hereby waives objection to El Paso Natural Gas Company's application for a non-standard location for their Huerfano Unit #84 as proposed above.

By: \_\_\_\_\_ Date: \_\_\_\_\_

xc: Damson Oil Corporation  
Bonneville Fuels Corporation

Huerfano Unit #84  
890'FSL, 991'FEL  
Section 36, T-27-N, R-11-W  
San Juan County, New Mexico

I hereby certify that the following offset owners/operators have been notified by certified mail of our application for administrative approval for non-standard gas well location for the plugback and recompletion of the above well.

Damson Oil Co.  
P.O. Box 4391  
Houston, TX 77210-4391

Bonneville Fuels Corporation  
1600 S. Broadway, Suite 1110  
Denver, CO 80202



Peggy Bradfield  
June 28, 1990

San Juan County  
State of New Mexico

My commission expires August 17, 1992

EL PASO NATURAL GAS COMPANY

Well Name            Huerfano Unit #84

Footage 890' FLS; 991' FEL

## APPLICATION FOR NON-STANDARD LOCATION

County San Juan State New Mexico Section 36 Township 27N Range 11W

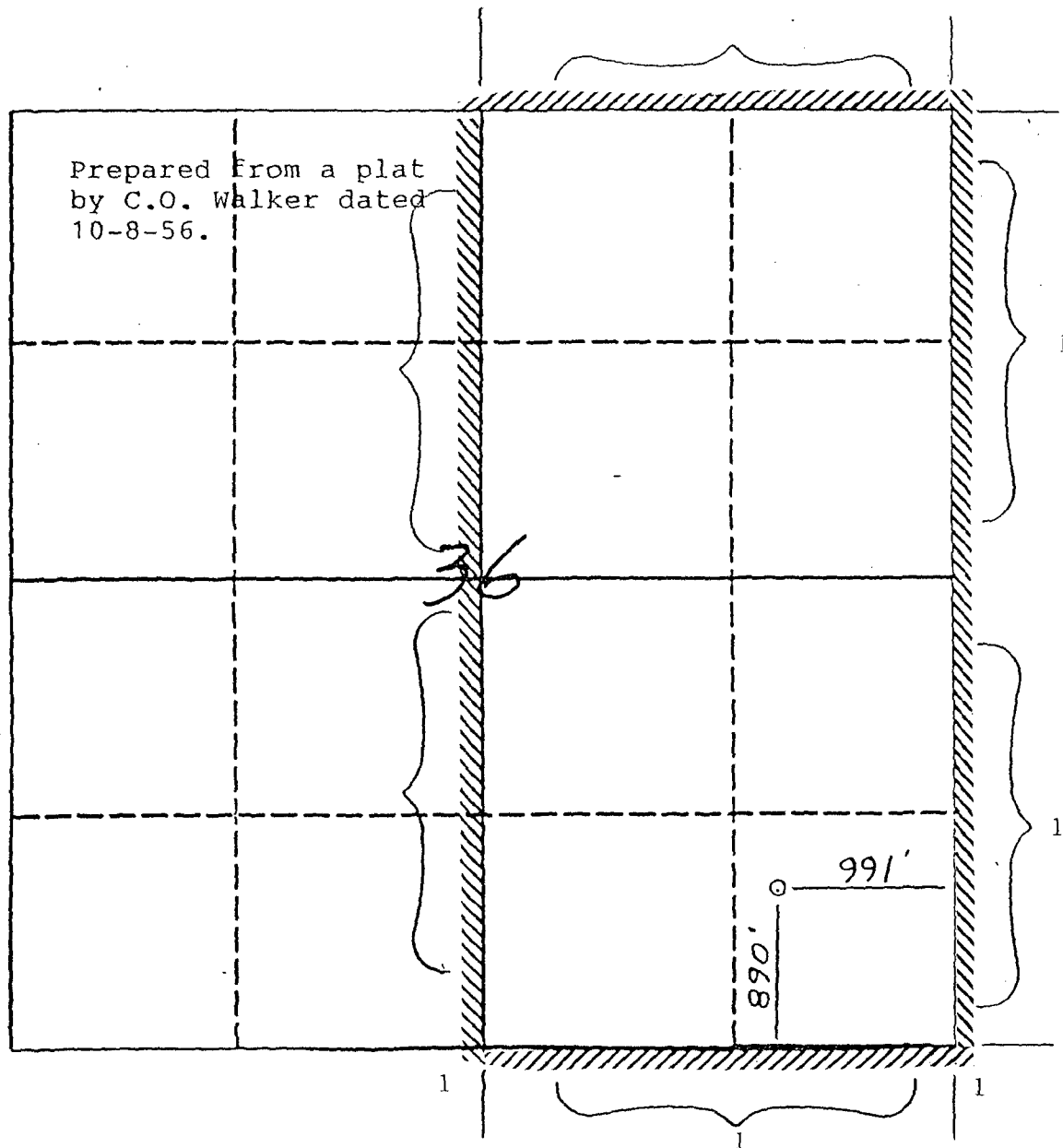

Remarks 1) Meridian Oil Inc.

2) Damson Oil Corporation

3) Bonneville Fuels Corp.

1600 S. Boradway, Suite 1110, Denver, CO 80202

Form 9-330

U. S. LAND OFFICE New Mexico  
SERIAL NUMBER 01074  
LEASE OR PERMIT TO PROSPECT \_\_\_\_\_

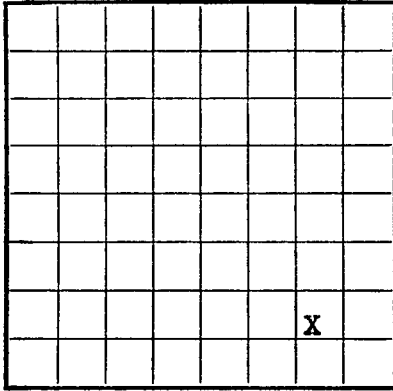

LOCATE WELL CORRECTLY

UNITED STATES  
DEPARTMENT OF THE INTERIOR  
GEOLOGICAL SURVEY

LOG OF OIL OR GAS WELL

Company El Paso Natural Gas Company Address Box 997, Farmington, New Mexico  
Lessor or Tract Huerfano Unit Field Fulcher Kutz Ex State New Mexico  
Well No. 84 Sec. 36 T. 27N R. 11W Meridian NMPM County San Juan  
Location 890 ft. N. of S. Line and 991 ft. W. of E. Line of Section 36 Elevation 6497'  
(Derrick floor relative to sea level)

The information given herewith is a complete and correct record of the well and all work done thereon so far as can be determined from all available records.

Signed Original Signed W. F. Covert

Date January 4, 1957 Title Petroleum Engineer

The summary on this page is for the condition of the well at above date.

Commenced drilling 11-24-56, 19\_\_\_\_ Finished drilling 11-27-56, 19\_\_\_\_

OIL OR GAS SANDS OR ZONES

(Denote gas by G)

No. 1, from 2050 to 2160 (G) No. 4, from \_\_\_\_\_ to \_\_\_\_\_  
No. 2, from \_\_\_\_\_ to \_\_\_\_\_ No. 5, from \_\_\_\_\_ to \_\_\_\_\_  
No. 3, from \_\_\_\_\_ to \_\_\_\_\_ No. 6, from \_\_\_\_\_ to \_\_\_\_\_

IMPORTANT WATER SANDS

No. 1, from \_\_\_\_\_ to \_\_\_\_\_ No. 3, from \_\_\_\_\_ to \_\_\_\_\_  
No. 2, from \_\_\_\_\_ to \_\_\_\_\_ No. 4, from \_\_\_\_\_ to \_\_\_\_\_

CASING RECORD

Size casing	Weight per foot	Threads per inch	Make	Amount	Kind of shoe	Cut and pulled from	Perforated		Purpose
							From	To	
9 5/8"	25.4#	P.E.	S.W.	125'	Howco	SOE			Surface
5 1/2"	15.5#	8 RD	1-1/2"	2150'	Howco				Prod. Csg.
1 1/4"	2.3#	8 RD	Grade B	2079'					Prod. Log.

MUDDING AND CEMENTING RECORD

Size casing	Where set	Number sacks of cement	Method used	Mud gravity	Amount of mud used
9 5/8"	135'	100	Circulated		
5 1/2"	2169'	150	Single Stage		

PLUGS AND ADAPTERS

Heaving plug—Material \_\_\_\_\_ Length \_\_\_\_\_ Depth set \_\_\_\_\_

FOLD MARK

# OIL CONSERVATION DIVISION

DISTRICT I  
P.O. Box 1980, Hobbs, NM 88240

P.O. Box 2088  
Santa Fe, New Mexico 87504-2088

DISTRICT II  
P.O. Drawer DD, Artesia, NM 88210

DISTRICT III  
1000 Rio Brazos Rd., Aztec, NM 87410

## WELL LOCATION AND ACREAGE DEDICATION PLAT

All Distances must be from the outer boundaries of the section

Operator El Paso Natural Gas			Lease Huerfano Unit (NM-01074)		Well No. 84
Unit Letter P	Section 36	Township 27 North	Range 11 West	County San Juan	
Actual Footage Location of Well: 890 feet from the South line and 991 feet from the East line					
Ground level Elev. 6587'	Producing Formation Fruitland Coal		Pool Basin		Dedicated Acreage: 320 Acres

1. Outline the acreage dedicated to the subject well by colored pencil or hatchure marks on the plat below.
2. If more than one lease is dedicated to the well, outline each and identify the ownership thereof (both as to working interest and royalty).
3. If more than one lease of different ownership is dedicated to the well, have the interest of all owners been consolidated by communitization, unitization, force-pooling, etc.?  
☒ Yes ☐ No If answer is "yes" type of consolidation unitization  
If answer is "no" list the owners and tract descriptions which have actually been consolidated. (Use reverse side of this form if necessary.)  
No allowable will be assigned to the well until all interests have been consolidated (by communitization, unitization, forced-pooling, or otherwise) or until a non-standard unit, eliminating such interest, has been approved by the Division.

Prepared from a plat  
by C.O. Walker dated  
10-8-56.

### OPERATOR CERTIFICATION

I hereby certify that the information contained herein is true and complete to the best of my knowledge and belief.

Signature  
Peggy Bradfield  
Printed Name  
Regulatory Affairs  
Position  
El Paso Natural Gas  
Company  
Date

### SURVEYOR CERTIFICATION

I hereby certify that the well location shown on this plat was plotted from field notes of actual surveys made by me or under my supervision, and that the same is true and correct to the best of my knowledge and belief. 6-25-90

Date Surveyed

Signature & Seal of  
Professional Surveyor

Certificate No.

Neale C. Edwards

0 330 660 990 1320 1650 1980 2310 2640 2000 1500 1000 500 0