



Chevron U.S.A. Inc.
P.O. Box 670, Hobbs, NM 88240

OIL CONSERVATION DIVISION
RECEIVED

'90 JUL 12 AM 8 50 June 25, 1990

R. C. Anderson
Division Manager
Production Department
Hobbs Division

ADMINISTRATIVE APPLICATION FOR
UNORTHODOX GAS WELL LOCATION
AND SIMULTANEOUS DEDICATION
EUMONT (PRO GAS) POOL
1980' FSL AND 560' FWL
SECTION 19, T-21S, R-37E, NMPM
LEA COUNTY, NEW MEXICO

State of New Mexico
Energy, Minerals & Natural Resources Dept.
Oil Conservation Division
P. O. Box 2088
Santa Fe, New Mexico

Attention: Mr. William J. LeMay - Director

Gentlemen:

Chevron U.S.A. Inc. respectfully requests your approval of our administrative application for an unorthodox gas well location in the Eumont (Pro Gas) Pool. We are also requesting your approval to simultaneously dedicate this 320-acre proration unit to our Eunice Com Wells No. 1 and 2, located in letter units K and L of Section 19, respectively.

Chevron plans to recomplete the Eunice Com #2 within the Eumont Gas Pool as a gas well. The current location, as described above, is unorthodox in that it is less than 660' from the outer boundary of the proration unit.

Chevron therefore, respectfully requests your approval of this administrative application under the provisions of Rule 104 (F). Attached is a map showing offset operators and a Form C-102. A copy of this letter and attachments are being furnished to the Offset Operators by Certified Mail, as notice of this application.

Yours very truly,

R. C. Anderson

JMT/jmt
Attachments
Enclosures

cc: NMOCD - Hobbs

Submit to Appropriate
District Office
State Lease - 4 copies
Fee Lease - 3 copies

State of New Mexico
Energy, Minerals and Natural Resources Department

Form C-102
Revised 1-1-89

OIL CONSERVATION DIVISION

P.O. Box 2088
Santa Fe, New Mexico 87504-2088

DISTRICT I
P.O. Box 1980, Hobbs, NM 88240

DISTRICT II
P.O. Drawer DD, Artesia, NM 88210

DISTRICT III
1000 Rio Brazos Rd., Aztec, NM 87410

WELL LOCATION AND ACREAGE DEDICATION PLAT

All Distances must be from the outer boundaries of the section

**SIMULTANEOUS DEDICATION
OF ACREAGE

Operator Chevron U.S.A. Inc.			Lease Eunice Com		Well No. 2
Unit Letter L	Section 19	Township 21S	Range 37E	County NMPM	Lea

Actual Footage Location of Well:

1980 feet from the South line and 560 feet from the West line	Dedicated Acreage: 320 more or less Acres	
Ground level Elev. 3515	Producing Formation Queen/Penrose	Pool Eumont

1. Outline the acreage dedicated to the subject well by colored pencil or hatchure marks on the plat below.

2. If more than one lease is dedicated to the well, outline each and identify the ownership thereof (both as to working interest and royalty).

3. If more than one lease of different ownership is dedicated to the well, have the interest of all owners been consolidated by communitization, unitization, force-pooling, etc.?

☐ Yes ☐ No If answer is "yes" type of consolidation

If answer is "no" list the owners and tract descriptions which have actually been consolidated. (Use reverse side of this form if necessary.)

No allowable will be assigned to the well until all interests have been consolidated (by communitization, unitization, forced-pooling, or otherwise) or until a non-standard unit, eliminating such interest, has been approved by the Division.

OPERATOR CERTIFICATION

I hereby certify that the information contained herein is true and complete to the best of my knowledge and belief.

Signature

M. E. Akins 4/25/90

Printed Name

M. E. Akins

Position

Staff Drlg. Engr.

Company

Chevron U.S.A. Inc.

Date

6-25-90

SURVEYOR CERTIFICATION

I hereby certify that the well location shown on this plat was plotted from field notes of actual surveys made by me or under my supervision, and that the same is true and correct to the best of my knowledge and belief.

Date Surveyed

Signature & Seal of
Professional Surveyor

Certificate No.

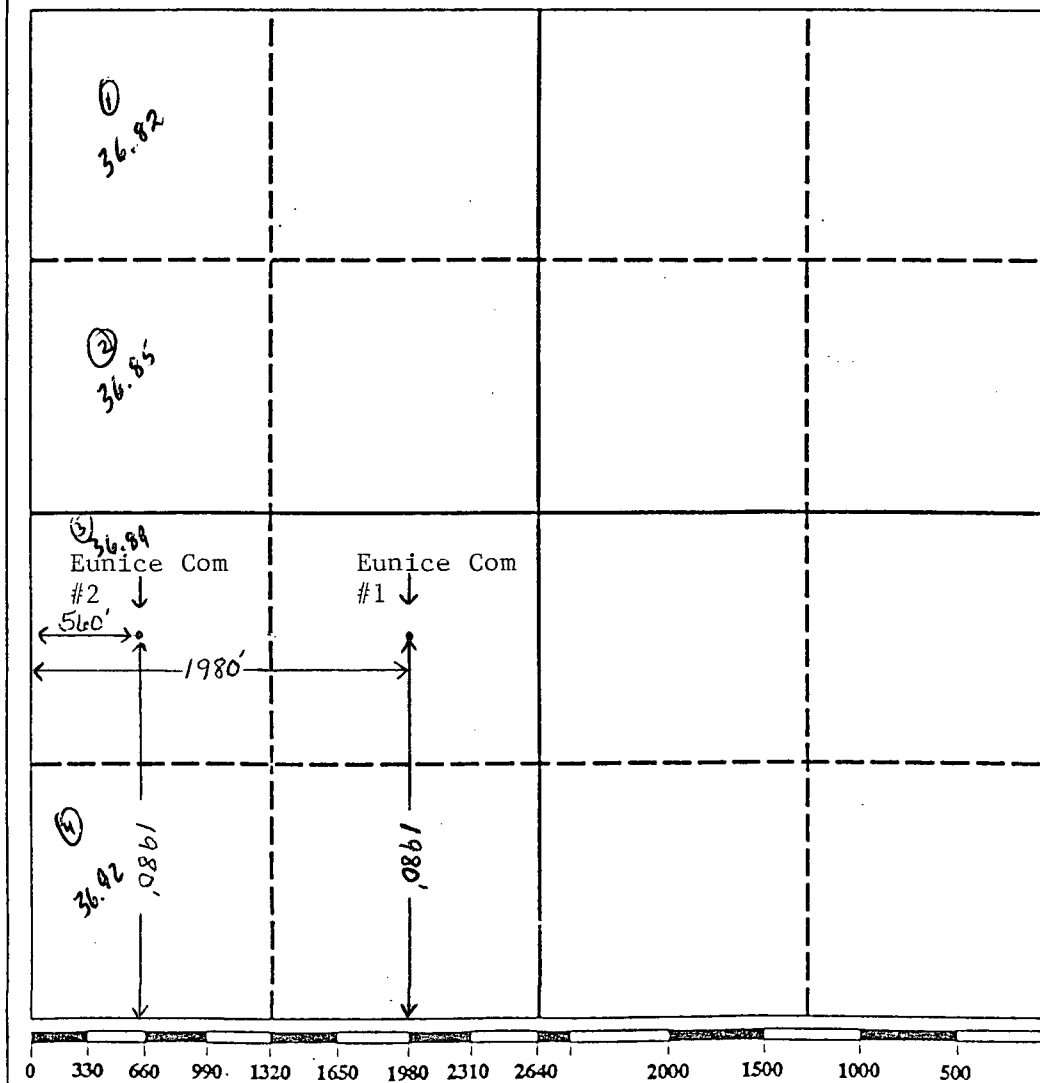

Application For An Unorthodox
Gas Well Location
and
Sumultaneous Dedication of Acreage
Eumont (Pro Gas) Pool
1980' FSL and 560' FWL
Section 19, T21S, R37E
Lea County, New Mexico

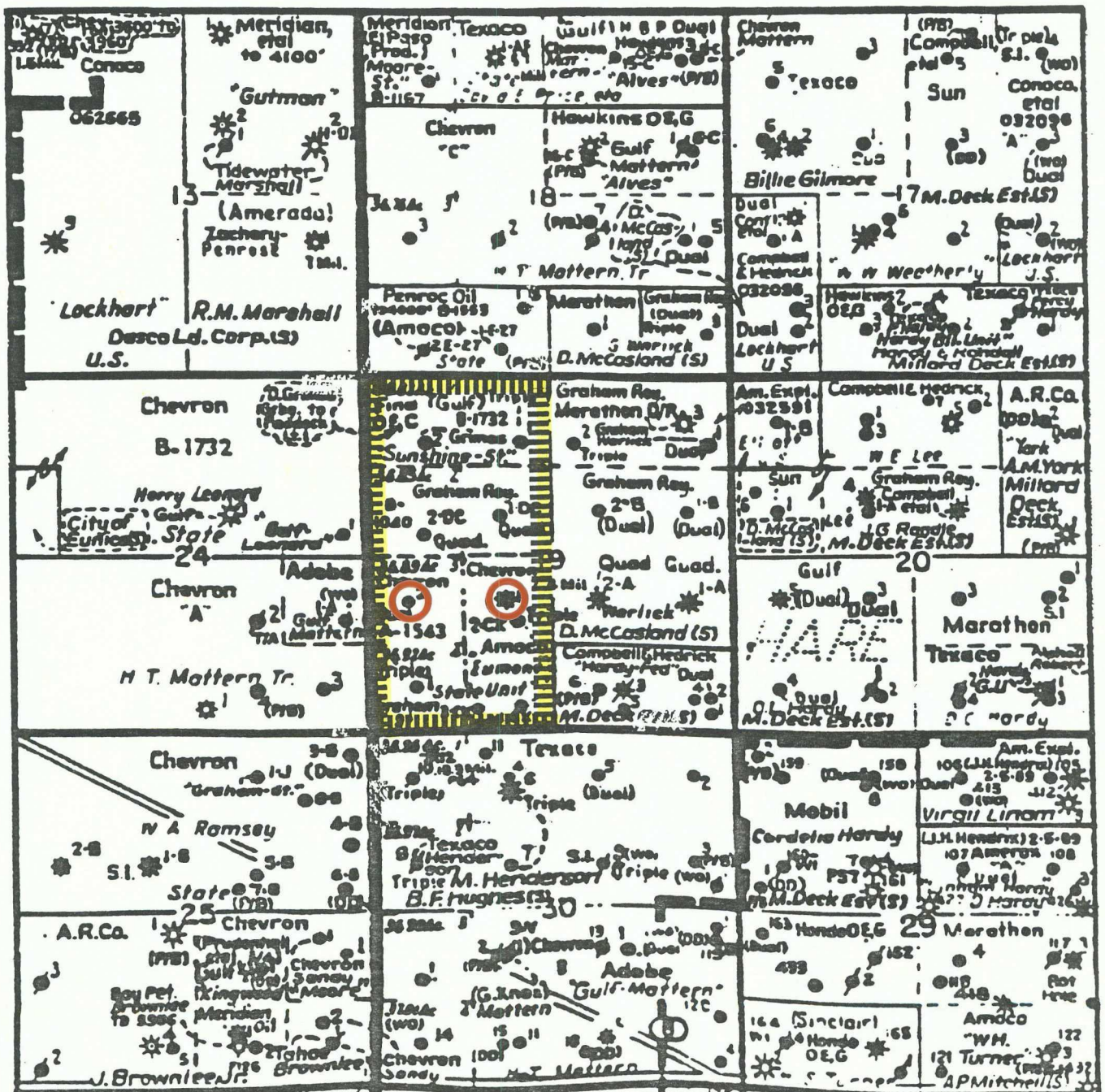

CHEVRON U.S.A. INC.
Eunice Gas Unit

Application For An Unorthodox
Gas Well Location
and
Sumultaneous Dedication of Acreage
Eumont (Pro Gas) Pool
1980' FSL and 560' FWL
Section 19, T21S, R37E
Lea County, New Mexico

OFFSET OPERATORS

Amoco Production Company
P.O. Box 3092
Houston, Tx 77253

Adobe Resources Corporation
Citicorp Center, Suite #1600
1200 Smith Street
Houston, Tx 77002

Texaco Incorporated
P.O. Box 3109
Midland, Tx 79702

Graham Royalty, LTD.
5429 LBJ Freeway, Suite 550
Attn: Production Dept.
Dallas, Tx 75240

Marathon Oil Company
P.O. Box 552
Midland, Tx 79702

Zachry Oil Operating Co.
1212 Commerce Building
Fort Worth, Tx 76102

Campbell and Hedrick
P.O. Box 401
Midland, Tx 79701

Penroc Oil Corporation
406 Bldg of Southwest
Midland, Tx 79701



OIL CONSERVATION DIVISION STATE OF NEW MEXICO
ENERGY AND MINERALS DEPARTMENT

'90 JUL 13 AM 9 11 OIL CONSERVATION DIVISION
HOBBS DISTRICT OFFICE

7-10-90

GARREY CARRUTHERS
GOVERNOR

POST OFFICE BOX 1980
HOBBS, NEW MEXICO 88241-1980
(505) 393-6161

OIL CONSERVATION DIVISION
P. O. BOX 2088
SANTA FE, NEW MEXICO 87501

RE: Proposed:

MC _____
DHC _____
NSL X + SD _____
NSP _____
SWD _____
WFX _____
PMX _____

Gentlemen:

I have examined the application for the:

Chevron USA Inc Eunice Corr # 2-L 19-21-37
Operator Lease & Well No. Unit S-T-R

and my recommendations are as follows:

OK

Yours very truly,

Jerry Sexton
Jerry Sexton
Supervisor, District 1

/ed