

OIL CONSERVATION DIVISION  
RECEIVED

'90 JUN 4 AM 8 59

## McKenzie Methane Corporation

May 28, 1990

*Case 10025*

Mr. Michael E. Stogner  
Chief Hearing Officer/Engineer  
State of New Mexico  
Energy, Minerals and Natural Resources Dept.  
Oil Conservation Division  
P.O. Box 2088  
Santa Fe, N.M. 87504

Re: Angel Peak 14L #6  
San Juan Co., N.M.  
Unorthodox Location

Mr. Stogner:

As per our conversation 5/24/90, I have attached a letter to Ernie Busch and a BLM sundry notice which should explain the apparent overlap of spacing units in the southeast quarter of section 14, T27N, R10W.

Regarding your letter of 5/21/90 to Heather Roark questioning the utilization of existing Amoco locations in the SW quarter, McKenzie always considers such use for both environmental and economic reasons. Although the Amoco locations would allow legal Fruitland Coal locations, keeping a safe operating distance from these wells (200 feet) is not geographically possible in one case and would cause severe environmental disturbance in the other. The northern-most Amoco well is situated on a narrow ridge preventing expansion with the location. The southern-most Amoco well is in a wooded area requiring destruction of the trees on the location as well as a necessary pipeline right-of-way.

Please be advised that Meridian Oil, the offset operator to our proposed well, has informed McKenzie that the unorthodox location will not be protested.

It is McKenzie Methane's intent to avoid unorthodox location requests when possible. In this instance, it is McKenzie's belief that the proposed location was staked with the best interests of the BLM, Amoco and McKenzie in mind.

It is requested that the NMOCD approve the unorthodox location.

Please call me in Durango at (303) 385-4654 if you have questions.

Sincerely,

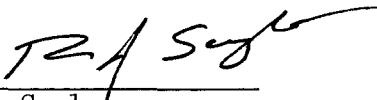
  
\_\_\_\_\_  
R.J. Sagle  
Petroleum Engineer

cc: Denver Office  
Well File

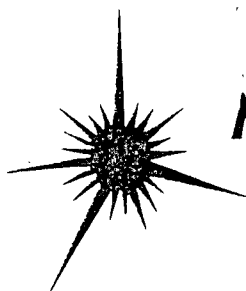

# McKenzie Methane Corporation

*Bob*  
*copy for well files*

April 19, 1990

Mr. Ernie Bush  
State Of New Mexico  
Energy & Minerals Department  
Oil Conservation Division  
1000 Rio Brazos Road  
Aztec, N.M. 87401

Re: Survey Plats

Sir:

Please find attached, as per our conversation this date, the new survey plats on the below listed wells:

Angel Peak 14H #5

Angel Peak 11K #2

If you have any questions, or require further information, please do not hesitate to call me.

Sincerely,

*Sam Cady*

Sam Cady  
McKenzie Methane Corp.

SC/me

attachments

cc: BLM - Ken Townsend - Farmington

OIL CONSERVATION DIVISION

P.O. Box 2088  
Santa Fe, New Mexico 87504-2088

DISTRICT II  
O. Drawer DD, Artesia, NM 88210

DISTRICT III  
1000 Rio Brazos Rd., Aztec, NM 87410

WELL LOCATION AND ACREAGE DEDICATION PLAT

All Distances must be from the outer boundaries of the section

Operator McKenzie Methane Corporation			Lease Angel Peak 14H		Well No. #5
Unit Letter H	Section 14	Township 27 North	Range 10 West	County San Juan	
Actual Footage Location of Well: 1755 feet from the North line and 1045 feet from the East line					
Ground level Elev. 6150	Producing Formation Fruitland Coal		Pool Basin Fruitland Coal	Dedicated Acreage: 172 320 Acres	

- Outline the acreage dedicated to the subject well by colored pencil or lacquer marks on the plat below.
- If more than one lease is dedicated to the well, outline each and identify the ownership thereof (both as to working interest and royalty).
- If more than one lease of different ownership is dedicated to the well, have the interest of all owners been consolidated by communitization, unitization, force-pooling, etc.?  
☐ Yes ☐ No If answer is "yes" type of consolidation \_\_\_\_\_  
If answer is "no" list the owners and tract descriptions which have actually been consolidated. (Use reverse side of this form if necessary.)  
No allowable will be assigned to the well until all interests have been consolidated (by communitization, unitization, forced-pooling, or otherwise) or until a non-standard unit, eliminating such interest, has been approved by the Division.

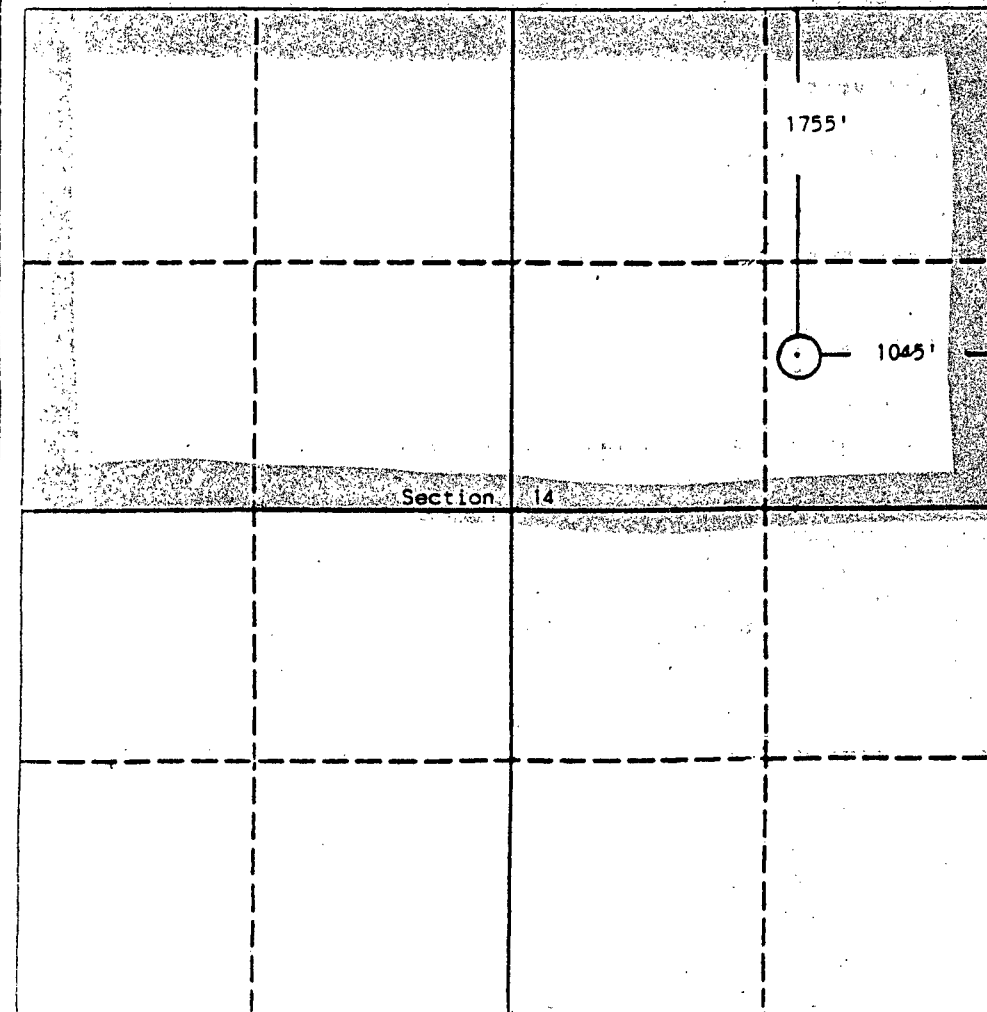

OPERATOR CERTIFICATION

I hereby certify that the information contained herein is true and complete to the best of my knowledge and belief.

Signature: Heather Roark

Printed Name: Technician

Position: McKenzie Methane Corp.

Company: March 27, 1990

Date: 4/19/90

SURVEYOR CERTIFICATION

I hereby certify that the well location shown on this plat was plotted from field notes of actual surveys made by me or under my supervision, and that the same is true and correct to the best of my knowledge and belief.

Date Surveyed: January 25, 1990

Signature & Seal of Professional Surveyor

Edgar L. Risenhoover

Edgar L. Risenhoover

Edgar L. Risenhoover

Edgar L. Risenhoover

Edgar L. Risenhoover

Edgar L. Risenhoover

Edgar L. Risenhoover

Edgar L. Risenhoover

UNITED STATES  
DEPARTMENT OF THE INTERIOR  
BUREAU OF LAND MANAGEMENT

SUBMIT IN TRIPLICATE  
(Other instructions on  
reverse side)

Form approved.  
Budget Bureau No. 1004-0135  
Expires August 31, 1985

SUNDRY NOTICES AND REPORTS ON WELLS

(Do not use this form for proposals to drill or to deepen or plug back to a different reservoir.  
Use "APPLICATION FOR PERMIT" for such proposals.)

3. LEASE DESIGNATION AND SERIAL NO.

BLM # SF-077329

6. IF INDIAN, ALLOTTEE OR TRIBE NAME

- Bob

7. UNIT ASSIGNMENT NAME

L

8. FARM OR LEASE NAME

Angel Peak 14L

9. WELL NO.

#6

10. FIELD AND POOL, OR WILDCAT

Basin Fruitland Coal

11. SEC. T. R. N. OR NE. AND  
S. E. OR AREA

Sec. 14-T27N-R10W

12. COUNTY OR PARISH 13. STATE

San Juan

NM

14. PERMIT NO.

15. ELEVATIONS (Show whether 27, 27.5, or 28.)

GR 6200

16. Check Appropriate Box To Indicate Nature of Notice, Report, or Other Data

NOTICE OF INTENTION TO:

TEST WATER SHUT-OFF

FRACTURE TREAT

SHOOT OR ACIDIZE

REPAIR WELL

(Other)

PULL OR ALTER CASING

MULTIPLE COMPLETE

ABANDON\*

CHANGE PLANS

X

SUBSEQUENT REPORT OF:

WATER SHUT-OFF

FRACTURE TREATMENT

SHOOTING OR ACIDIZING

(Other)

(Note: Report results of multiple completion on Well  
Completion or Recompletion Report and Log form.)

REPAIRING WELL

ALTERING CASING

ABANDONMENT\*

17. DESCRIBE PROPOSED OR COMPLETED OPERATIONS (Clearly state all pertinent details and give pertinent dates, including estimated date of starting any proposed work. If well is directionally drilled, give subsurface locations and measured and true vertical depths for all markers and zones pertinent to this work.)\*

REQUEST CHANGE OF LOCATION FROM STAND UP TO LAY DOWN

18. I hereby certify that the foregoing is true and correct

SIGNED

Sam Cooley

TITLE

Technician

DATE

4-17-90

(This space for Federal or State office use)

APPROVED BY

TITLE

DATE

CONDITIONS OF APPROVAL IF ANY:

\*See Instructions on Reverse Side

UNITED STATES  
DEPARTMENT OF THE INTERIOR  
BUREAU OF LAND MANAGEMENT

APPLICATION FOR PERMIT TO DRILL, DEEPEN, OR PLUG BACK

1a. TYPE OF WORK

DRILL ☒

DEEPEN ☐

PLUG BACK ☐

b. TYPE OF WELL

OIL  
WELL ☐

GAS  
WELL ☒

OTHER

SINGLE  
ZONE ☒

MULTIPLE  
ZONE ☐

2. NAME OF OPERATOR

McKenzie Methane Corporation

3. ADDRESS OF OPERATOR

1625 Broadway, Suite 2580, Denver, CO 80202

4. LOCATION OF WELL (Report location clearly and in accordance with any State requirements.)\*

At surface

1755' FNL, 1045' FEL

At proposed prod. zone

same

14. DISTANCE IN MILES AND DIRECTION FROM NEAREST TOWN OR POST OFFICE\*

±5 miles south, south-east of Bloomfield, New Mexico

15. DISTANCE FROM PROPOSED\*

LOCATION TO NEAREST  
PROPERTY OR LEASE LINE, FT.  
(Also to nearest drlg. unit line, if any)

1045'

16. NO. OF ACRES IN LEASE

±1240-1430

17. NO. OF ACRES ASSIGNED  
TO THIS WELL

320 E<sub>1</sub>

18. DISTANCE FROM PROPOSED LOCATION\*  
TO NEAREST WELL, DRILLING, COMPLETED,  
OR APPLIED FOR, ON THIS LEASE, FT.

±600'

19. PROPOSED DEPTH

2115'

20. ROTARY OR CABLE TOOLS

rotary

21. ELEVATIONS (Show whether DF, RT, GR, etc.)

6150' GR

22. APPROX. DATE WORK WILL START\*

May 3, 1990

23. This action is subject to compliance and  
procedural review pursuant to 43 CFR 3160.9  
and 43 CFR 3165.4.

PROPOSED CASING AND CEMENTING PROGRAM

DRILLING OPERATIONS AUTHORIZED ARE  
SUBJECT TO COMPLIANCE WITH ATTACHED

SIZE OF CASING	WEIGHT PER FOOT	SETTING DEPTH	GENERAL REQUIREMENTS
12-1/4"	24#	250'	175sx C1 'B' w/ 2% CaCl
7-7/8"	11.6#	2115'	300sx 65/35 POZ + 1#/sx floccle + 2% gel & 125sx 50/50 POZ + 2% Ca

RECEIVED

APR 24 1990

OIL CON. DIV  
DIST. 9

Notary Public for the State of New Mexico  
do hereby certify that the applicant  
holds legal or equitable rights  
or title to this lease."

RECEIVED  
APR 23 11:13  
OIL CON. DIV

IN ABOVE SPACE DESCRIBE PROPOSED PROGRAM: If proposal is to deepen or plug back, give data on present productive zone and proposed new productive zone. If proposal is to drill or deepen directionally, give pertinent data on subsurface locations and measured and true vertical depths. Give blowout preventer program, if any.

24.

SIGNED

Heather Roark

TITLE

Technician

DATE

March 27, 1990

(This space for Federal or State office use)

PERMIT NO.

APPROVAL DATE

APPROVED  
AS AMENDED

APPROVED BY

TITLE

CONDITIONS OF APPROVAL, IF ANY:

APR 20 1990

AREA MANAGER

NMOCD

\*See Instructions On Reverse Side

Submit to Appropriate  
District Office  
State Lease - 4 copies  
Fee Lease - 3 copies

State of New Mexico  
Energy, Minerals and Natural Resources Department

Form C-102  
Revised 1-1-89

OIL CONSERVATION DIVISION

P.O. Box 2088  
Santa Fe, New Mexico 87504-2088

DISTRICT I  
P.O. Box 1980, Hobbs, NM 88240

DISTRICT II  
P.O. Drawer DD, Artesia, NM 88210

DISTRICT III  
1000 Rio Brazos Rd., Aztec, NM 87410

WELL LOCATION AND ACREAGE DEDICATION PLAT

All Distances must be from the outer boundaries of the section

Operator McKenzie Methane Corporation			Lease Angel Peak 14H		Well No. #5
Unit Letter H	Section 14	Township 27 North	Range 10 West	County San Juan	
Actual Footage Location of Well: 1755 feet from the North line and 1045 feet from the East line					
Ground level Elev. 6150	Producing Formation Fruitland Coal	Pool Basin Fruitland Coal		Dedicated Acreage: E/320 Acres	

- Outline the acreage dedicated to the subject well by colored pencil or hatchure marks on the plat below.
- If more than one lease is dedicated to the well, outline each and identify the ownership thereof (both as to working interest and royalty).
- If more than one lease of different ownership is dedicated to the well, have the interest of all owners been consolidated by communitization, unitization, force-pooling, etc.?  
☐ Yes ☐ No If answer is "yes" type of consolidation \_\_\_\_\_  
If answer is "no" list the owners and tract descriptions which have actually been consolidated. (Use reverse side of this form if necessary.) \_\_\_\_\_  
No allowable will be assigned to the well until all interests have been consolidated (by communitization, unitization, forced-pooling, or otherwise) or until a non-standard unit, eliminating such interest, has been approved by the Division.

OPERATOR CERTIFICATION

I hereby certify that the information contained herein is true and complete to the best of my knowledge and belief.

Signature *Heather Roark*  
Printed Name  
Heather Roark  
Position  
Technician  
Company  
McKenzie Methane Corp.  
Date  
March 27, 1990

SURVEYOR CERTIFICATION

I hereby certify that the well location shown on this plat was plotted from field notes of actual surveys made by me or under my supervision, and that the same is true and correct to the best of my knowledge and belief.

Date Surveyed  
January 25, 1990

Signature & Seal of Professional Surveyor  
*Edgar L. Risenhoover*  
Certificate No. 5979  
Edgar L. Risenhoover  
REGISTERED LAND SURVEYOR  
NEW MEXICO

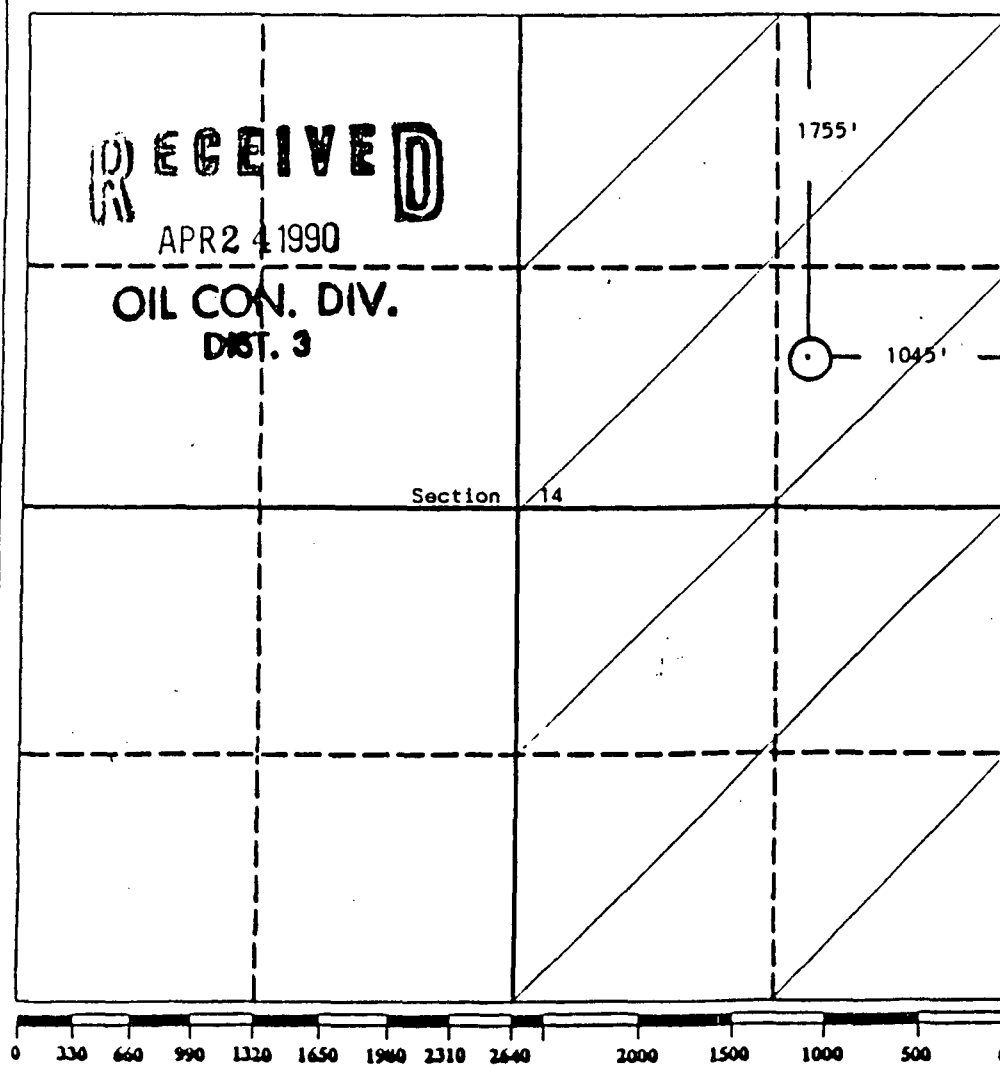



STATE OF NEW MEXICO

ENERGY AND MINERALS DEPARTMENT

OIL CONSERVATION DIVISION

AZTEC DISTRICT OFFICE RECEIVED

KEY CARRUTHERS  
GOVERNOR

'90 JUL 9 AM 9 49

TEXAS ROAD  
AZTEC, NEW MEXICO 87410  
(505) 334-0170

Date: 7-5-90

Oil Conservation Division  
P.O. Box 2088  
Santa Fe, NM 87504-2088

Case No. 10025

m.s.

Re: Proposed HC \_\_\_\_\_  
Proposed DHC \_\_\_\_\_  
Proposed HSL X \_\_\_\_\_  
Proposed SWD \_\_\_\_\_  
Proposed WFX \_\_\_\_\_  
Proposed PMX \_\_\_\_\_

Gentlemen:

I have examined the application dated 5-10-90

for the M. Keeney McShane Corp. Angel Peak 14L#6  
Operator Lease & Well No.

L-14-27N-10W and my recommendations are as follows:  
Unit, S-T-R

App. Docket for Hearing

Yours truly,

Ernest Burch