



# PYRAMID ENERGY, INC.

Pacific Plaza • 14100 San Pedro, Suite 700

San Antonio, Texas 78232 • (512) 490-5000 • FAX: (512) 494-0406

September 21, 1990

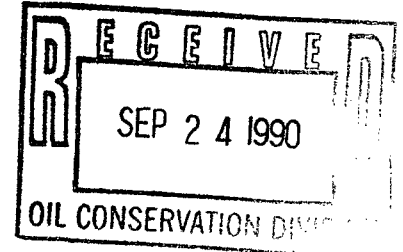

Michael E. Stogner  
NMOCD  
P.O. Box 2088  
Santa Fe, New Mexico 87504-2088

Re: Unorthodox Location  
West Pearl Queen Unit #190  
T19S, R35E  
Lea County, New Mexico

Dear Mr. Stogner:

This letter shall serve as our request to have the following unorthodox location approved by your office.

90' FEL 1440' FSL, Sec. 29, Unit I, T19S, R35E

On the attached plat, you will note our location lies within the unit boundaries of the West Pearl Queen Unit. We offset ourselves on these locations. We are requesting approval of this location because it will allow us to establish a more efficient waterflood pattern within the unit.

Should you have any questions, please call.

Sincerely,

Scott Graef  
Production Engineer

attachment

cc: NMOCD - Hobbs

# PYRAMID ENERGY, INC. East & West Pearl Queen Units

1000 ft  
Scale:   
Lee County  
New Mexico  
9-21-98  
File: pr/basel

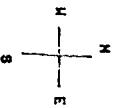

MPQU EPQU

- Producer
- ✦ Injector
- ✦ Plugged & Abandoned
- ⊙ Development Locations

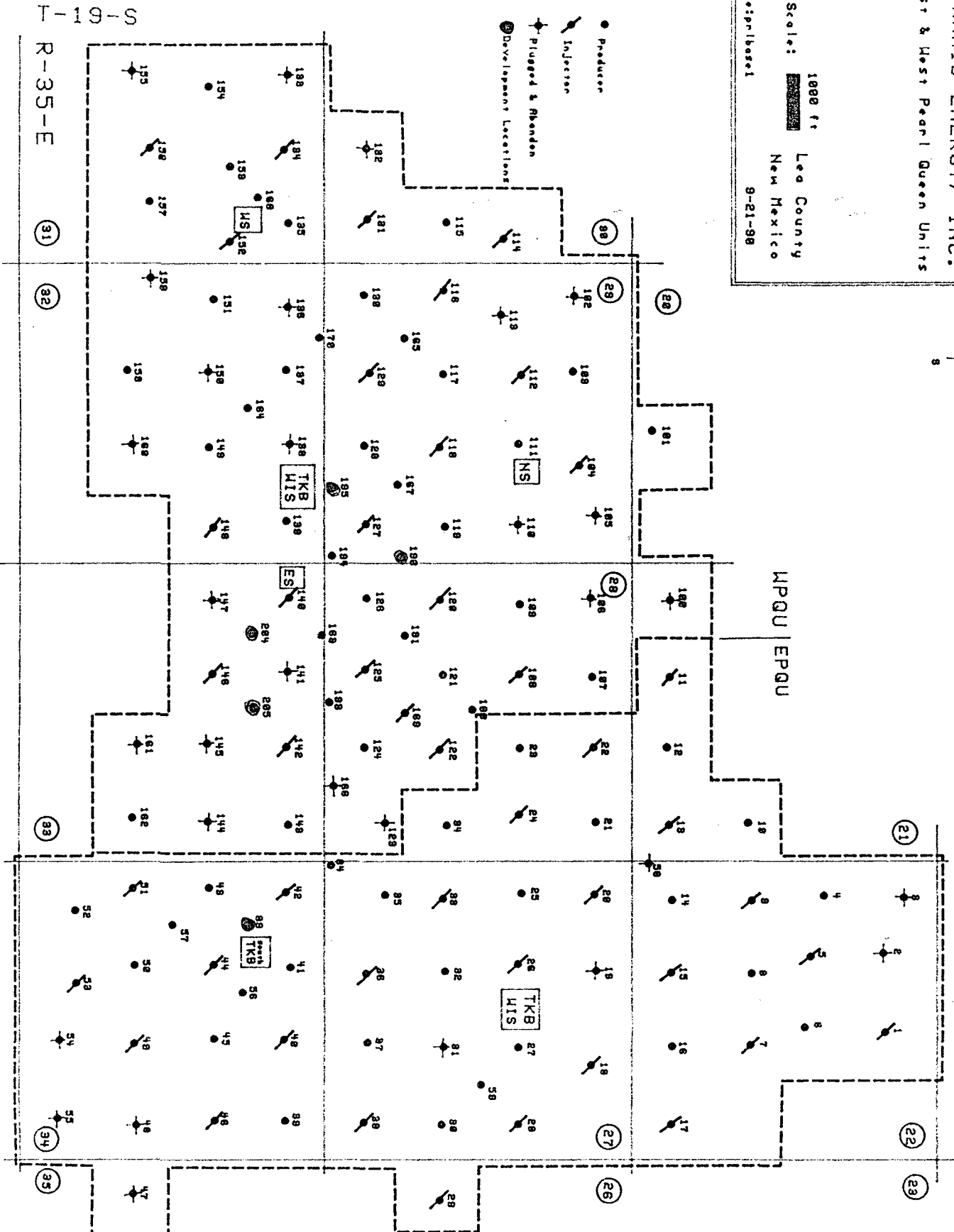

1-19-S  
R-35-E

**NEW MEXICO OIL CONSERVATION COMMISSION  
WELL LOCATION AND ACREAGE DEDICATION PLAT**

Form C-102  
Supersedes C-128  
Effective 1-1-65

All distances must be from the outer boundaries of the Section.

Operator <b>PYRAMID ENERGY INC.</b>			Lease <b>West Pearl Queen Unit</b>		Well No. <b>190</b>
Unit Letter <b>I</b>	Section <b>29</b>	Township <b>19 South</b>	Range <b>35 East</b>	County <b>Lea County, N.M.</b>	
Actual Footage Location of Well: <b>90</b> feet from the <b>East</b> line and <b>1440</b> feet from the <b>South</b> line					
Ground Level Elev. <b>3737.</b>	Producing Formation <b>Queen</b>		Pool <b>Pearl Queen</b>	Dedicated Acreage: <b>40</b> Acres	

1. Outline the acreage dedicated to the subject well by colored pencil or hatchure marks on the plat below.
2. If more than one lease is dedicated to the well, outline each and identify the ownership thereof (both as to working interest and royalty).
3. If more than one lease of different ownership is dedicated to the well, have the interests of all owners been consolidated by communitization, unitization, force-pooling, etc?

☒ Yes    ☐ No    If answer is "yes," type of consolidation Unitization, R-2728

If answer is "no," list the owners and tract descriptions which have actually been consolidated. (Use reverse side of this form if necessary.) \_\_\_\_\_

No allowable will be assigned to the well until all interests have been consolidated (by communitization, unitization, forced-pooling, or otherwise) or until a non-standard unit, eliminating such interests, has been approved by the Commission.

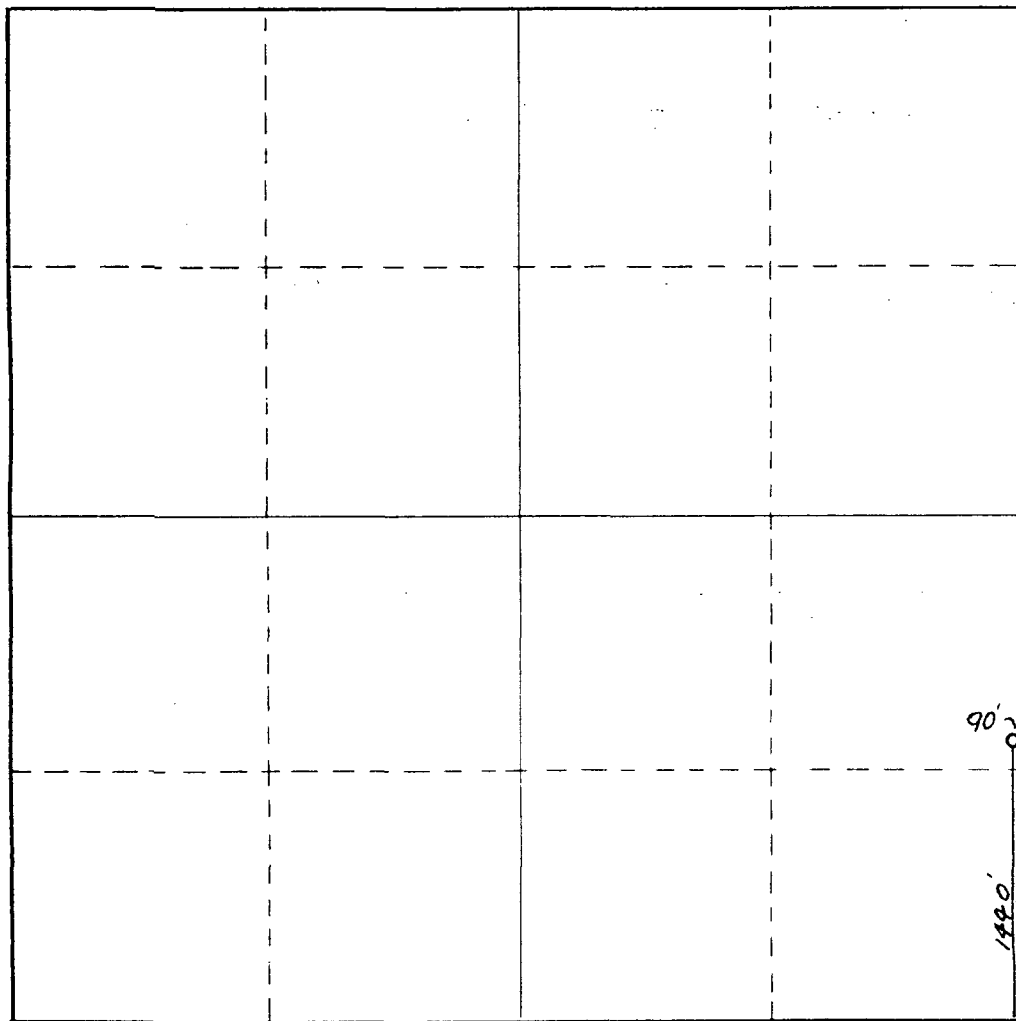

**CERTIFICATION**

I hereby certify that the information contained herein is true and complete to the best of my knowledge and belief.

*Scott Goff*

Name  
**Production Engineer**  
Position  
**Pyramid Energy, Inc.**  
Company  
**Sept. 21, 1990**  
Date

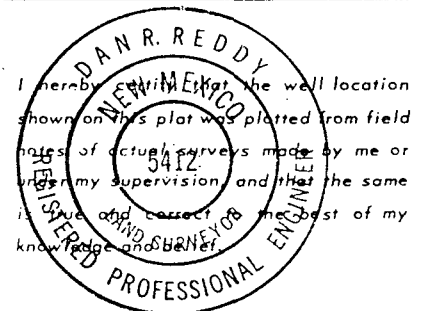

Date Surveyed  
**September 18, 1990**  
Registered Professional Engineer  
and/or Land Surveyor

*Dan R. Reddy*  
Certificate No.  
**NM PE&PS NO. 5412**

BOP

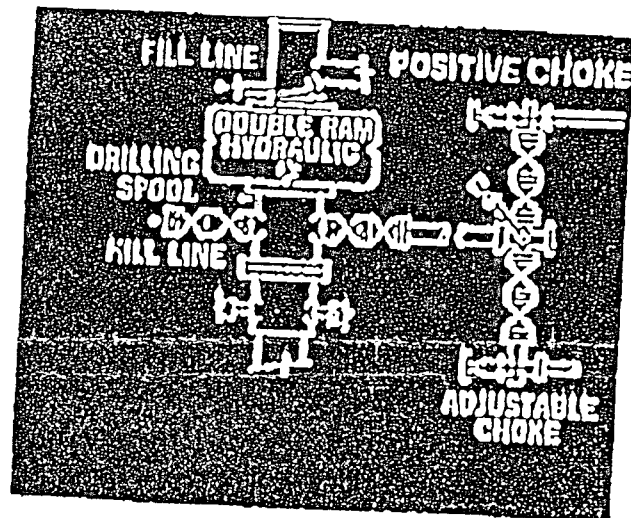

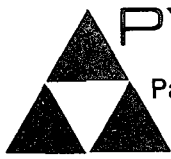

# PYRAMID ENERGY, INC.

Pacific Plaza • 14100 San Pedro, Suite 700

San Antonio, Texas 78232 • (512) 490-5000 • FAX: (512) 494-0406

September 21, 1990

Michael E. Stogner  
NMOCD  
P.O. Box 2088  
Santa Fe, New Mexico 87504-2088

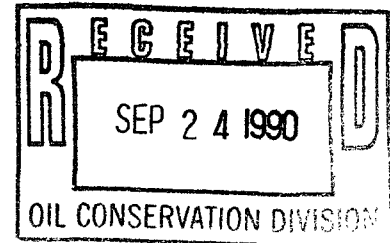

Re: Unorthodox Location  
West Pearl Queen Unit #195  
T19S, R35E  
Lea County, New Mexico

Dear Mr. Stogner:

This letter shall serve as our request to have the following unorthodox location approved by your office.

1340' FEL 100' FSL, Sec. 29, Unit 0, T19S, R35E

On the attached plat, you will note our location lies within the unit boundaries of the West Pearl Queen Unit. We offset ourselves on these locations. We are requesting approval of this location because it will allow us to establish a more efficient waterflood pattern within the unit.

Should you have any questions, please call.

Sincerely,

Scott Graef  
Production Engineer

attachment

cc: NMOCD - Hobbs

**PYRAMID ENERGY, INC.**  
 East & West Pearl Queen Units

Scale: 1000 ft  
 Lea County  
 New Mexico  
 9-21-90  
 File: prlbases1

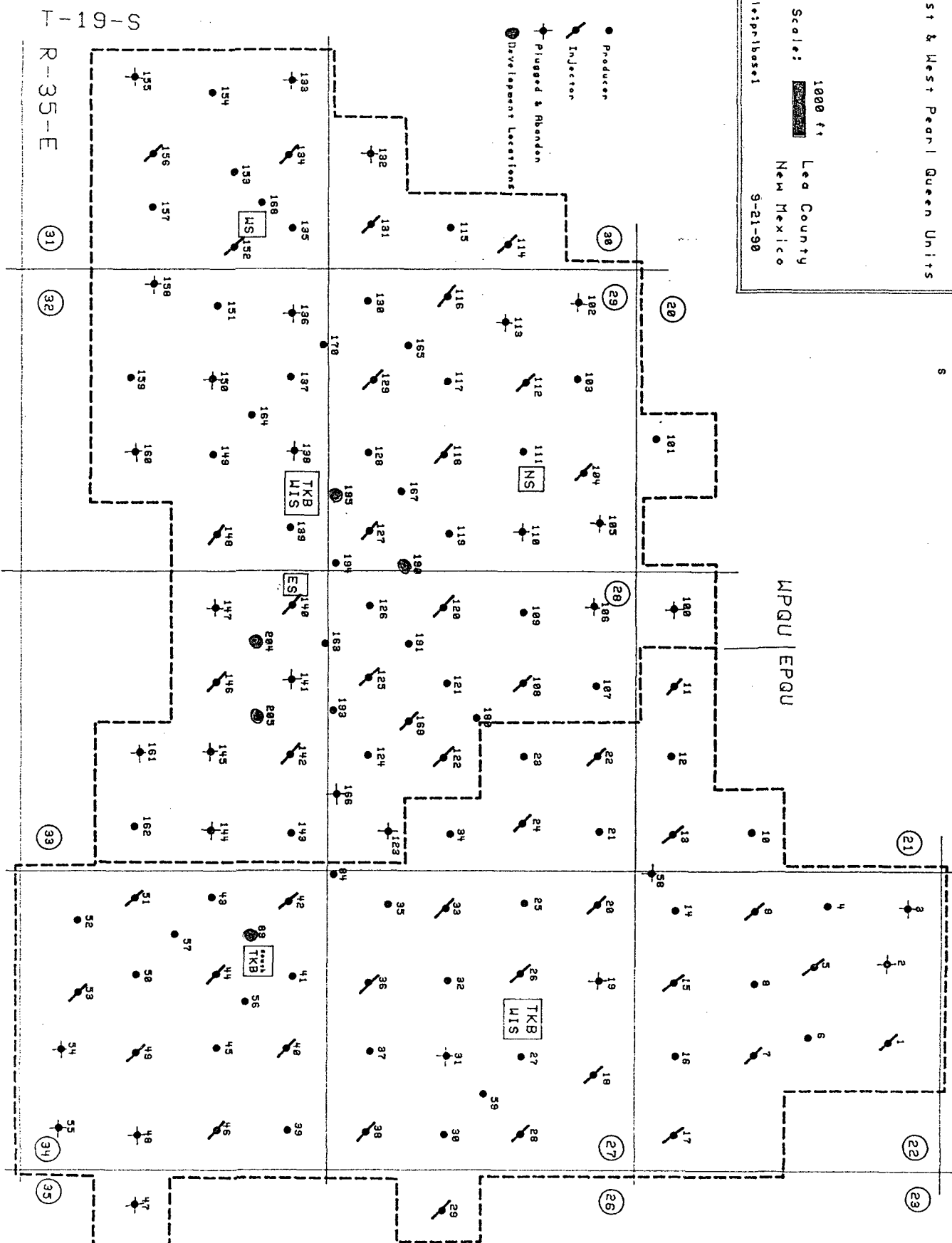
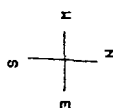

T-19-S

R-35-E

**NEW MEXICO OIL CONSERVATION COMMISSION  
WELL LOCATION AND ACREAGE DEDICATION PLAT**

Form C-102  
Supersedes C-128  
Effective 1-1-65

All distances must be from the outer boundaries of the Section.

Operator <b>PYRAMID ENERGY INC.</b>			Lease <b>West Pearl Queen Unit</b>		Well No. <b>195</b>
Unit Letter <b>O</b>	Section <b>29</b>	Township <b>19 South</b>	Range <b>35 East</b>	County <b>Lea County, N.M.</b>	
Actual Footage Location of Well: <b>1340</b> feet from the <b>East</b> line and <b>100</b> feet from the <b>South</b> line					
Ground Level Elev. <b>3745.</b>	Producing Formation <b>Queen</b>		Pool <b>Pearl Queen</b>		Dedicated Acreage: <b>40</b> Acres

1. Outline the acreage dedicated to the subject well by colored pencil or hatchure marks on the plat below.
2. If more than one lease is dedicated to the well, outline each and identify the ownership thereof (both as to working interest and royalty).
3. If more than one lease of different ownership is dedicated to the well, have the interests of all owners been consolidated by communitization, unitization, force-pooling, etc?

☒ Yes    ☐ No    If answer is "yes," type of consolidation Unitization, R-2728

If answer is "no," list the owners and tract descriptions which have actually been consolidated. (Use reverse side of this form if necessary.) \_\_\_\_\_

No allowable will be assigned to the well until all interests have been consolidated (by communitization, unitization, forced-pooling, or otherwise) or until a non-standard unit, eliminating such interests, has been approved by the Commission.

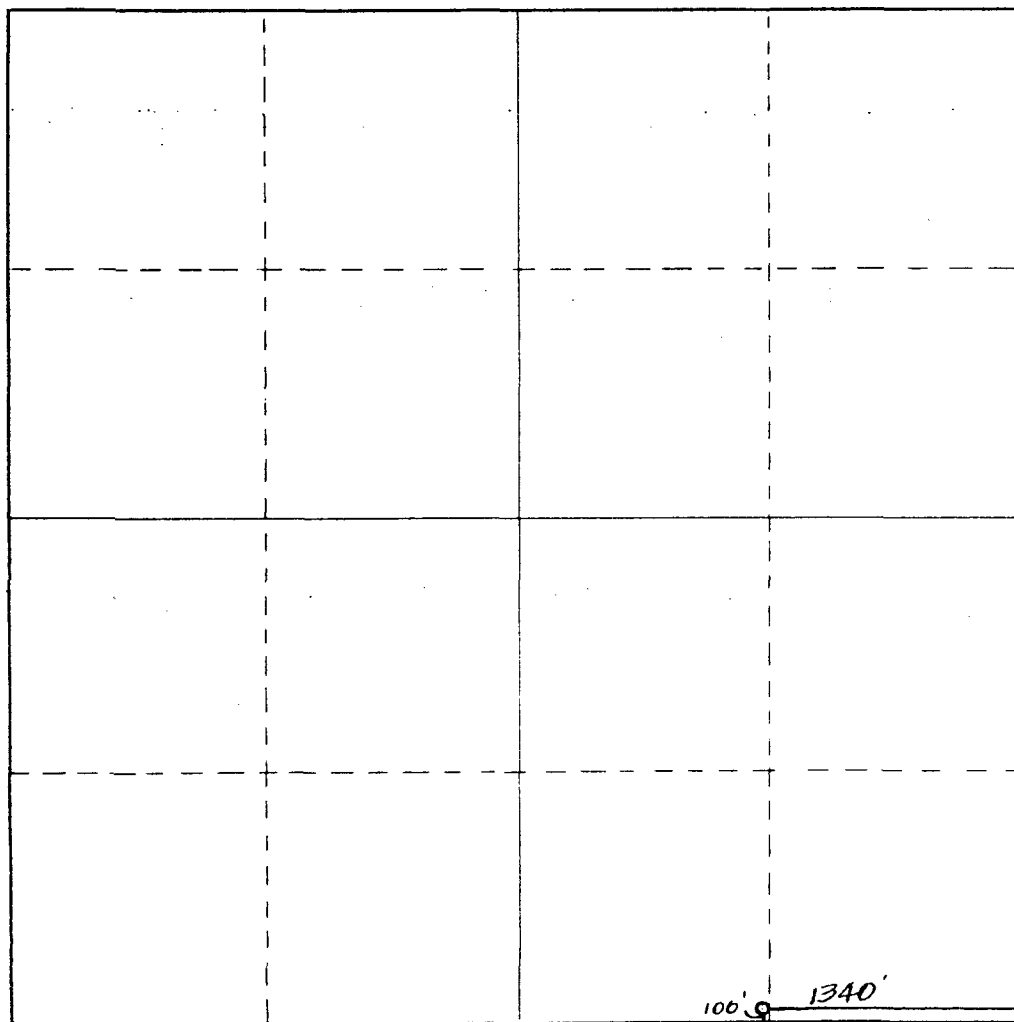

**CERTIFICATION**

*I hereby certify that the information contained herein is true and complete to the best of my knowledge and belief.*

*[Signature]*  
Name

Position  
**Production Engineer**

Company  
**Pyramid Energy, Inc.**

Date  
**Sept. 21, 1990**

*I hereby certify that the well location shown on this plat was plotted from field notes of actual surveys made by me or under my supervision, and that the same is true and correct to the best of my knowledge and belief.*

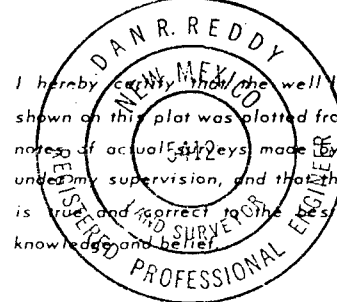

Date Surveyed  
**September 18, 1990**

Registered Professional Engineer  
and/or Land Surveyor

*[Signature]*  
Certificate No.

**NM PE&PS NO. 5412**

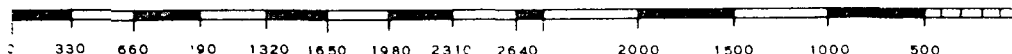

BOP

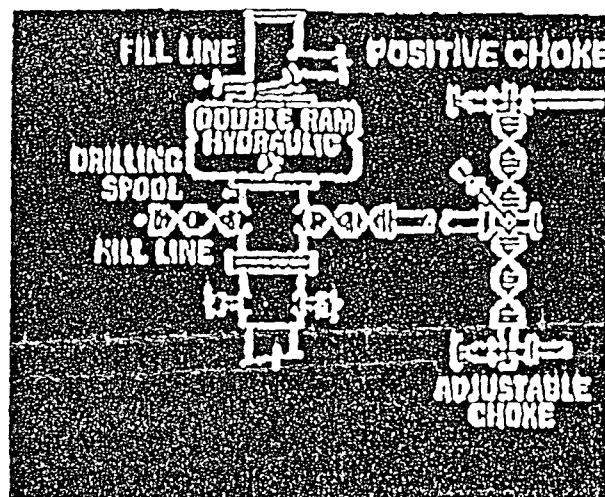





# PYRAMID ENERGY, INC.

Pacific Plaza • 14100 San Pedro, Suite 700

San Antonio, Texas 78232 • (512) 490-5000 • FAX: (512) 494-0406

September 21, 1990

Michael E. Stogner  
NMOCD  
P.O. Box 2088  
Santa Fe, New Mexico 87504-2088

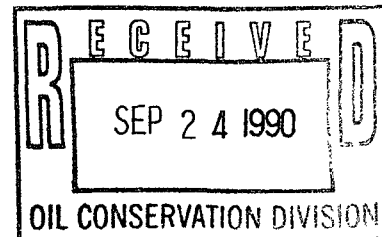

Re: Unorthodox Location  
West Pearl Queen Unit #204  
T19S, R35E  
Lea County, New Mexico

Dear Mr. Stogner:

This letter shall serve as our request to have the following unorthodox location approved by your office.

1310' FNL 1310' FWL, Sec. 33, Unit D, T19S, R35E

On the attached plat, you will note our location lies within the unit boundaries of the West Pearl Queen Unit. We offset ourselves on these locations. We are requesting approval of this location because it will allow us to establish a more efficient waterflood pattern within the unit.

Should you have any questions, please call.

Sincerely,

Scott Graef  
Production Engineer

attachment

cc: NMOCD - Hobbs

PYRAMID ENERGY, INC.  
 East & West Pearl Queen Units

Scale: 1000 ft  
 Lea County  
 New Mexico  
 9-21-90  
 File: pr/basel

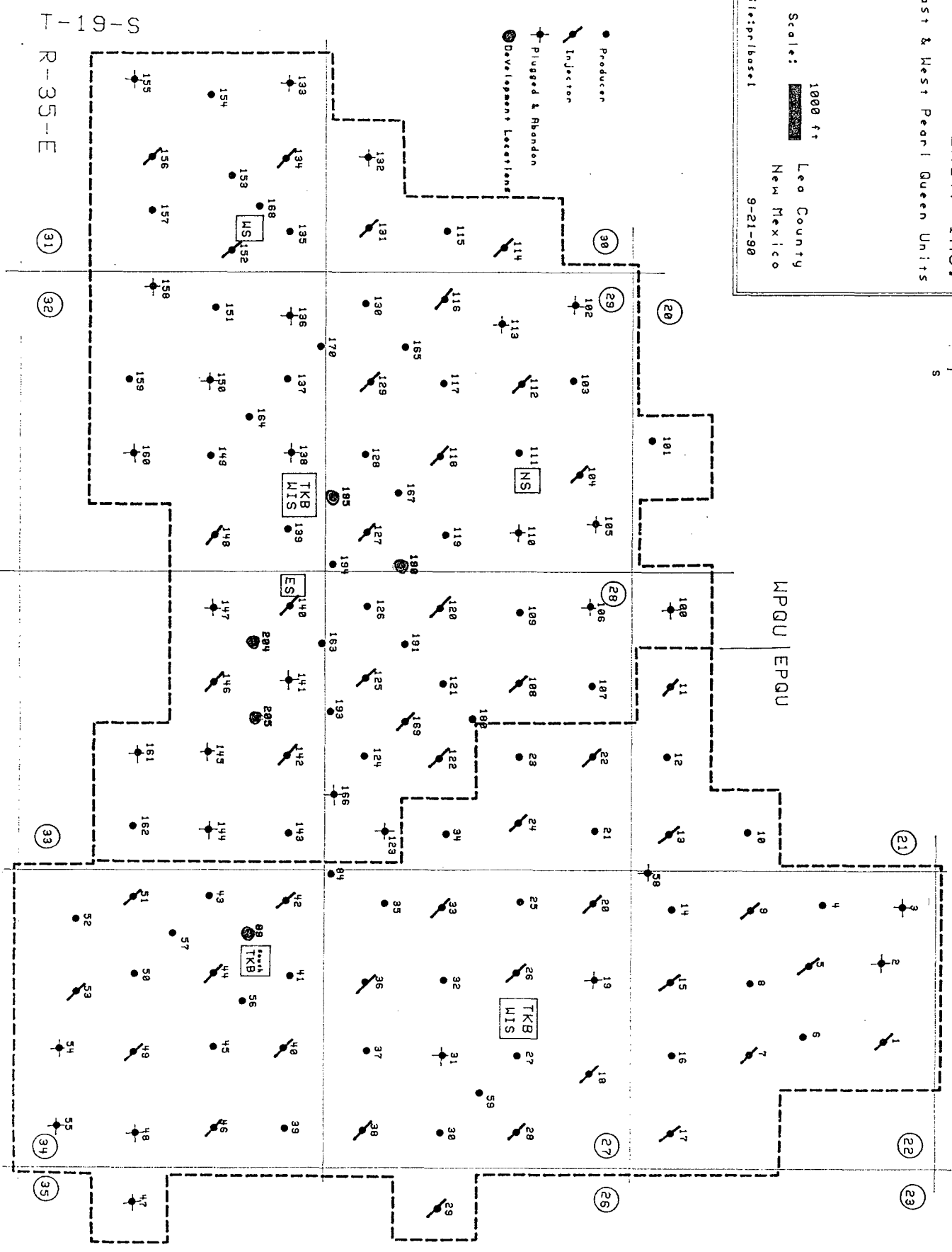
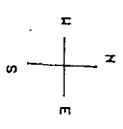

S-19-1  
 R-35-E

(31)

(32)

(33)

(34)

(35)

(30)

(29)

(27)

(26)

(20)

(28)

(21)

(22)

(23)

**NEW MEXICO OIL CONSERVATION COMMISSION  
WELL LOCATION AND ACREAGE DEDICATION PLAT**

Form C-102  
Supersedes C-128  
Effective 1-1-65

All distances must be from the outer boundaries of the Section.

Operator <b>PYRAMID ENERGY INC.</b>			Lease <b>West Pearl Queen Unit</b>		Well No. <b>204</b>
Unit Letter <b>D</b>	Section <b>33</b>	Township <b>19 South</b>	Range <b>35 East</b>	County <b>Lea County, N.M.</b>	
Actual Footage Location of Well: <b>1310</b> feet from the <b>North</b> line and <b>1310</b> feet from the <b>West</b> line					
Ground Level Elev. <b>3714.</b>	Producing Formation <b>Queen</b>		Pool <b>Pearl Queen</b>		Dedicated Acreage: <b>40</b> Acres

1. Outline the acreage dedicated to the subject well by colored pencil or hachure marks on the plat below.
2. If more than one lease is dedicated to the well, outline each and identify the ownership thereof (both as to working interest and royalty).
3. If more than one lease of different ownership is dedicated to the well, have the interests of all owners been consolidated by communitization, unitization, force-pooling, etc?

☒ Yes    ☐ No    If answer is "yes," type of consolidation Unitization, R-2728

If answer is "no," list the owners and tract descriptions which have actually been consolidated. (Use reverse side of this form if necessary.) \_\_\_\_\_

No allowable will be assigned to the well until all interests have been consolidated (by communitization, unitization, forced-pooling, or otherwise) or until a non-standard unit, eliminating such interests, has been approved by the Commission.

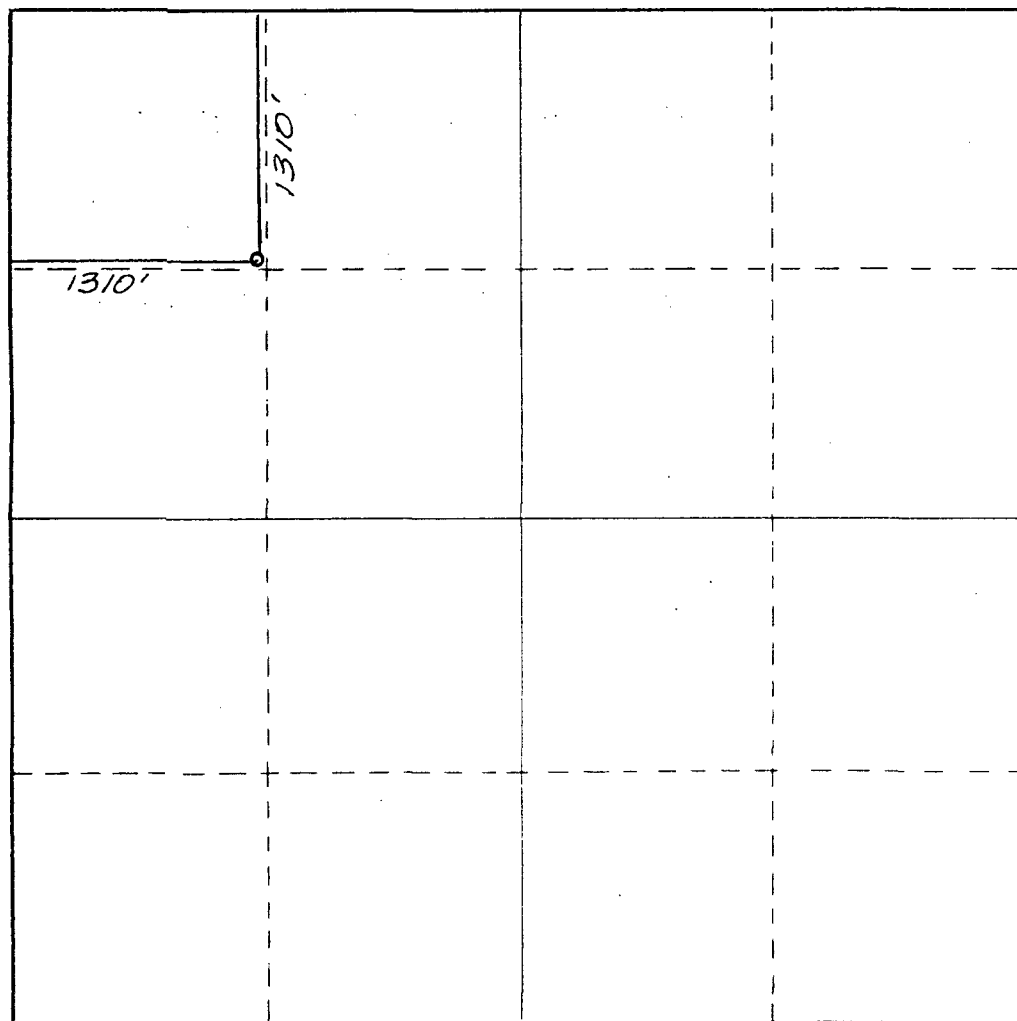

**CERTIFICATION**

I hereby certify that the information contained herein is true and complete to the best of my knowledge and belief.

*Scott Gault*

Name

Position

**Production Engineer**

Company

**Pyramid Energy, Inc.**

Date

**Sept. 21, 1990**

I hereby certify that the well location shown on this plat was plotted from field notes of actual surveys made by me or under my supervision, and that the same is true and correct to the best of my knowledge and belief.

Date Surveyed

**September 18, 1990**

Registered Professional Engineer  
and/or Land Surveyor

*Dan R. Reddy*

Certificate No.

**NM PE&PS NO. 5412**

BOP

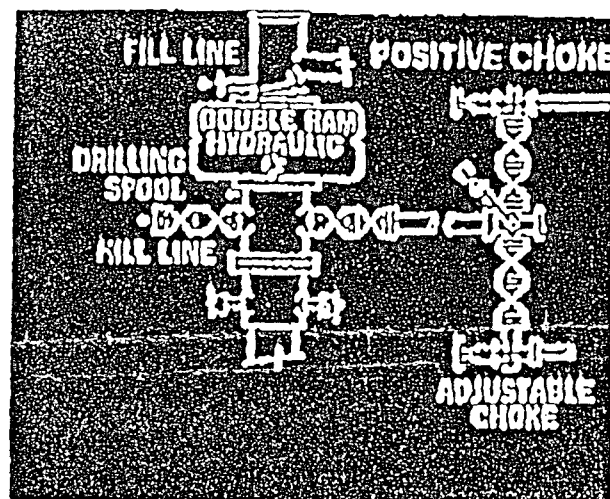



# PYRAMID ENERGY, INC.

Pacific Plaza • 14100 San Pedro, Suite 700

San Antonio, Texas 78232 • (512) 490-5000 • FAX: (512) 494-0406

September 21, 1990

Michael E. Stogner  
NMOCD  
P.O. Box 2088  
Santa Fe, New Mexico 87504-2088

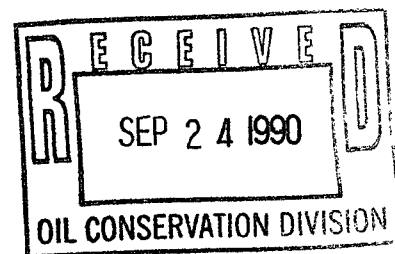

Re: Unorthodox Location  
West Pearl Queen Unit #205  
T19S, R35E  
Lea County, New Mexico

Dear Mr. Stogner:

This letter shall serve as our request to have the following unorthodox location approved by your office.

1310' FNL 2630' FWL, Sec. 33, Unit C, T19S, R35E

On the attached plat, you will note our location lies within the unit boundaries of the West Pearl Queen Unit. We offset ourselves on these locations. We are requesting approval of this location because it will allow us to establish a more efficient waterflood pattern within the unit.

Should you have any questions, please call.

Sincerely,

Scott Graef  
Production Engineer

attachment

cc: NMOCD - Hobbs

PYRAMID ENERGY, INC.  
East & West Pearl Queen Units

Scale: 1000 ft  
Lee County  
New Mexico  
9-21-90  
file:prlbaset1

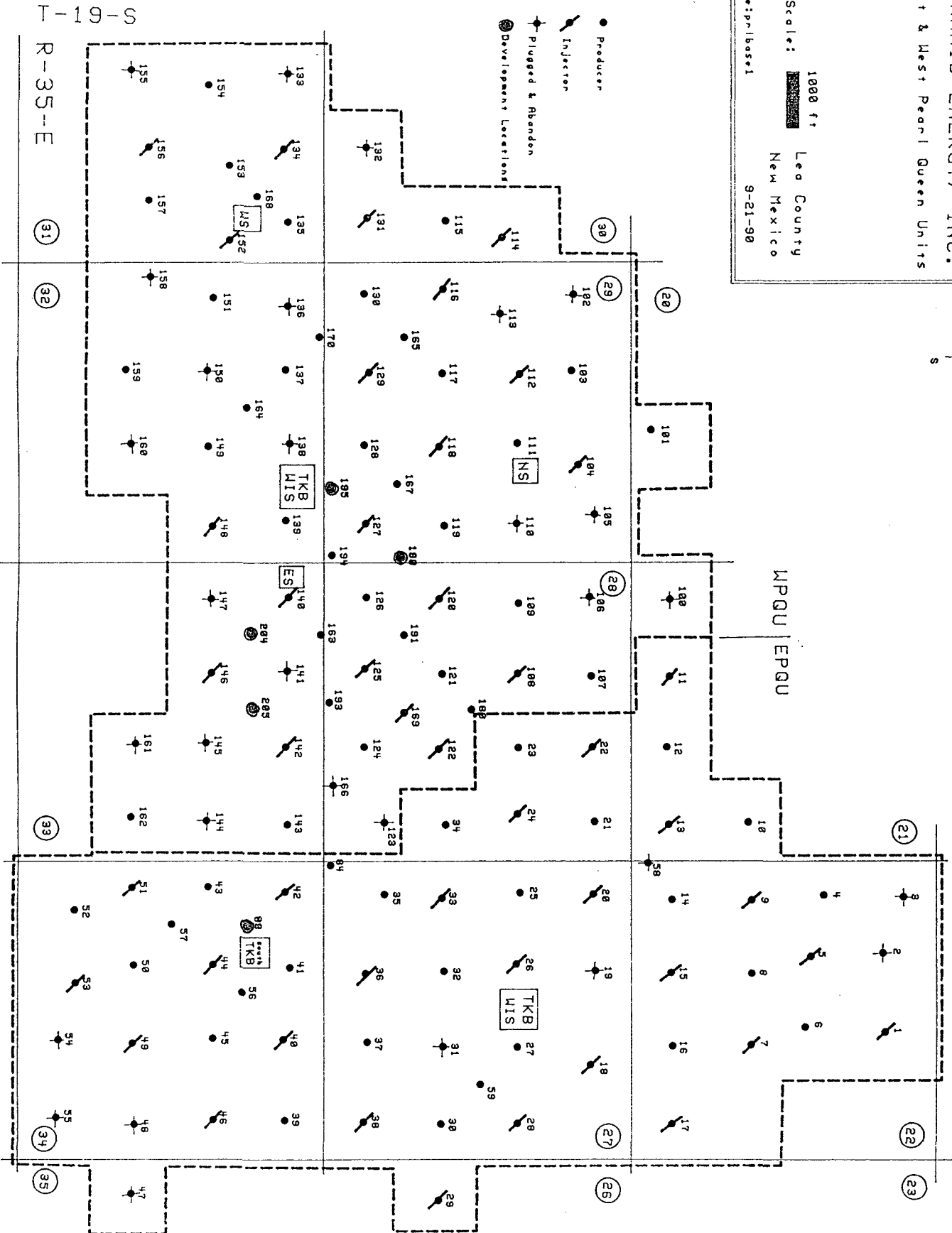
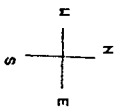

T-19-S

R-35-E

**NEW MEXICO OIL CONSERVATION COMMISSION  
WELL LOCATION AND ACREAGE DEDICATION PLAT**

Form C-102  
Supersedes C-128  
Effective 1-1-55

All distances must be from the outer boundaries of the Section.

Operator <b>PYRAMID ENERGY INC.</b>			Lease <b>West Pearl Queen Unit</b>		Well No. <b>205</b>
Unit Letter <b>C</b>	Section <b>33</b>	Township <b>19 South</b>	Range <b>35 East</b>	County <b>Lea County, N.M.</b>	
Actual Footage Location of Well:					
<b>1310</b> feet from the <b>North</b> line and		<b>2630</b> feet from the <b>West</b> line			
Ground Level Elev. <b>3707.</b>	Producing Formation <b>Queen</b>	Pool <b>Pearl Queen</b>		Dedicated Acreage: <b>40</b> Acres	

1. Outline the acreage dedicated to the subject well by colored pencil or hachure marks on the plat below.
2. If more than one lease is dedicated to the well, outline each and identify the ownership thereof (both as to working interest and royalty).
3. If more than one lease of different ownership is dedicated to the well, have the interests of all owners been consolidated by communitization, unitization, force-pooling, etc?

☒ Yes    ☐ No    If answer is "yes," type of consolidation Unitization, R-2728

If answer is "no," list the owners and tract descriptions which have actually been consolidated. (Use reverse side of this form if necessary.) \_\_\_\_\_

No allowable will be assigned to the well until all interests have been consolidated (by communitization, unitization, forced-pooling, or otherwise) or until a non-standard unit, eliminating such interests, has been approved by the Commission.

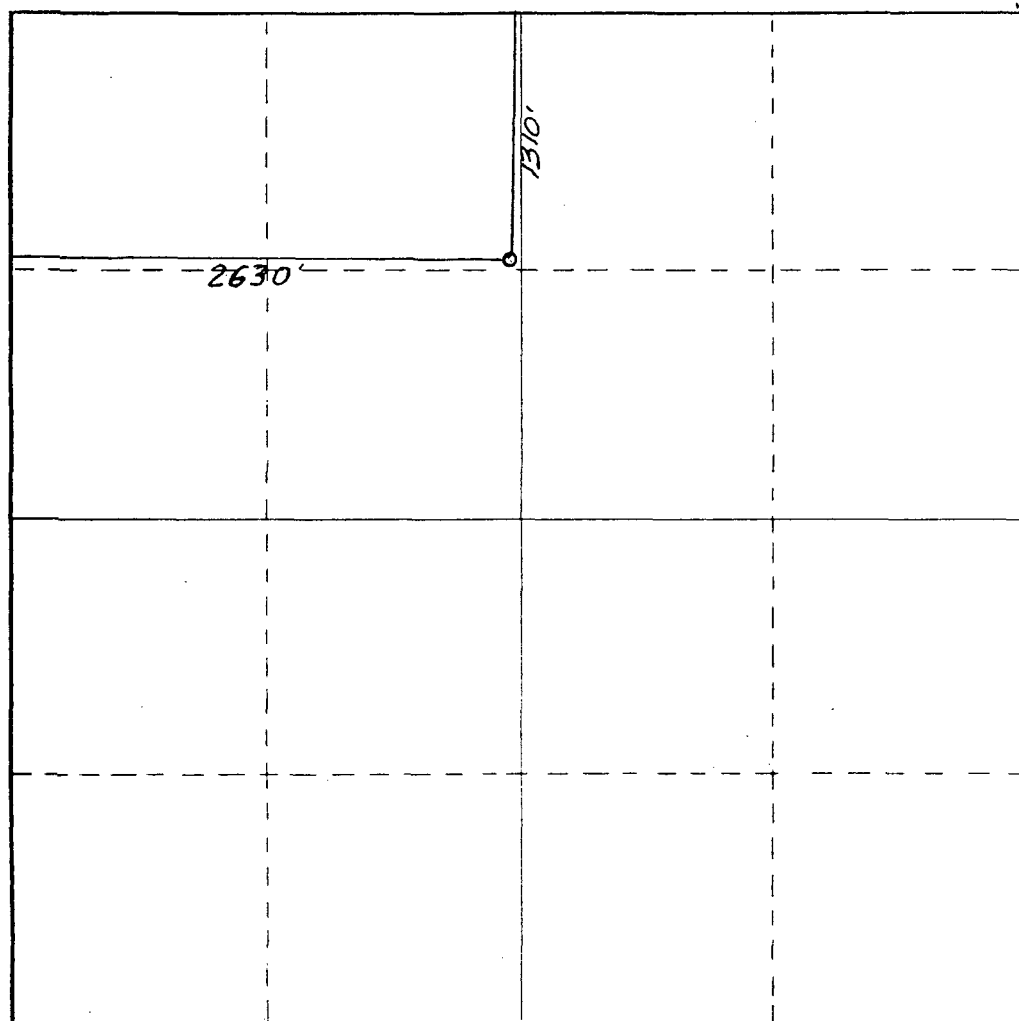

**CERTIFICATION**

I hereby certify that the information contained herein is true and complete to the best of my knowledge and belief.

*Scott Graf*  
Name

Position  
**Production Engineer**

Company  
**Pyramid Energy, Inc.**

Date  
**Sept. 21, 1990**

Date Surveyed  
**September 19, 1990**

Registered Professional Engineer and/or Land Surveyor

*Dan R. Reddy*  
Certificate No.

**NM PE&PS NO. 5412**

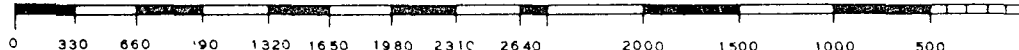

# BOP

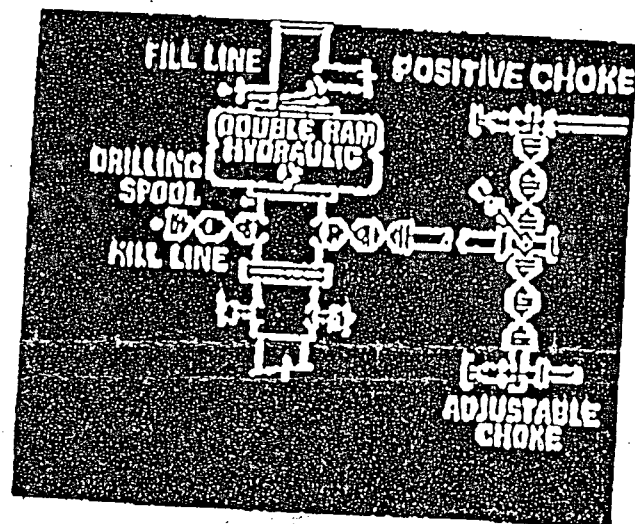



WEST PEARL-QUEEN POOL  
(West Pearl-Queen Unit Waterflood)  
Lea County, New Mexico

Order No. R-2729, Authorizing Gulf Oil Corporation to Institute a Waterflood Project in the West Pearl-Queen Unit Area, West Pearl-Queen Pool, Lea County, New Mexico, June 18, 1964, as Amended by Order No. R-2729-A, May 5, 1969.

Application of Gulf Oil Corporation for a Waterflood Project, Lea County, New Mexico.

CASE NO. 3066  
Order No. R-2729

ORDER OF THE COMMISSION

BY THE COMMISSION: This cause came on for hearing at 9 o'clock a.m. on June 10, 1964, at Santa Fe, New Mexico, before Examiner Daniel S. Nutter.

NOW, on this 18th day of June, 1964, the Commission, a quorum being present, having considered the testimony, the record, and the recommendations of the Examiner, and being fully advised in the premises,

FINDS:

(1) That due public notice having been given as required by law, the Commission has jurisdiction of this cause and the subject matter thereof.

(2) That the West Pearl Queen Unit Agreement has been approved by the Commission by Order No. R-2728, that the West Pearl Queen Unit Area comprises 2520 acres, more or less, of State, Fee, and Federal lands in Township 19 South, Range 35 East, NMPM, Lea County, New Mexico, as more fully described in said order.

(3) That of said 2520 acres, 160 acres being the NW/4 of Section 28, Township 19 South, Range 35 East, NMPM, has not been and evidently will not be committed to said unit agreement.

(4) That the applicant, Gulf Oil Corporation, seeks permission to institute a waterflood project in the Pearl-Queen Pool in the West Pearl Queen Unit Area by the injection of water into the Queen formation through 28 wells located within that portion of the unit area which has been or will be committed to the unit agreement.

(5) That the wells in the project area are in an advanced state of depletion and should properly be classified as "stripper" wells.

(6) That the proposed waterflood project is in the interest of conservation and should result in recovery of otherwise unrecoverable oil, thereby preventing waste.

(7) That the subject application should be approved and the project should be governed by the provisions of Rule 701 of the Commission Rules and Regulations.

(8) That Jake L. Hamon, owner of the NW/4 of Section 25, Township 19 South, Range 35 East, NMPM, should be permitted to convert any wells on said acreage only after notice and hearing.

IT IS THEREFORE ORDERED:

(1) That the applicant, Gulf Oil Corporation, is hereby authorized to institute a waterflood project in the Pearl-Queen Pool in the West Pearl Queen Unit Area by the injection of water into the Queen formation through the following-described 28 wells in Township 19 South, Range 35 East, NMPM, Lea County, New Mexico:

WELL

UNIT

Section 28

Cabot Carbon State "G" Well No. 5	J
Cabot Carbon State "G" Well No. 1	L
Cabot Carbon State "G" Well No. 4	N
Cabot Carbon State "G" Well No. 7	P

Section 29

Curtis R. Inman Superior Federal Well No. 2	B
Shell State "PK" Well No. 2	D
Cactus Parks Well No. 1	F
Skelly Hobbs-State "J" Well No. 1	H
Gulf Lea-State "IH" Well No. 1	J
Gulf Lea-State "IN" Well No. 4	L
Cactus Gulf-State "A" Well No. 4	N
Cactus Gulf-State "A" Well No. 2	P

Section 30

Gulf Lea-State "AP" Well No. 3	H
Gulf Lea-State "AP" Well No. 1	P

Section 31

Cactus Aztec-State Well No. 2	B
Cactus Aztec-State Well No. 6	F
Cactus Aztec-State Well No. 4	H
Cactus Aztec-State Well No. 7	J

Section 32

Gulf Lea-State "AQ" Well No. 2	B
Gulf Lea-State "AQ" Well No. 4	D
Cactus Lea-State "AQ" Well No. 5	F
Cactus Lea-State "AQ" Well No. 7	H
Phillips New Mex "C" Well No. 1	J

Section 33

Gulf Lea-State "BG" Well No. 3	B
Gulf Lea-State "BG" Well No. 1	D
Gulf Lea-State "BG" Well No. 6	F
Gulf Lea-State "BG" Well No. 8	H
Gulf Lea-State "AR" Well No. 4	J

(2) (As Amended by Order No. R-2729-A, May 5, 1969.) That the West Pearl Queen Unit Waterflood Project shall be governed by the provisions of Rules 701, 702, and 703 of the Commission Rules and Regulations;

PROVIDED HOWEVER, that the Secretary-Director of the Commission may approve such additional injection and producing wells at orthodox and unorthodox infill locations as may be necessary to complete an efficient injection and producing pattern, provided said wells are drilled no closer than 990 feet to the outer boundary of said West Pearl Queen Unit nor closer than 5 feet to any quarter-quarter section or subdivision inner boundary, and provided that the application therefor has been filed in accordance with Rule 701 B of the Commission Rules and Regulations. The showing of well response as required by Rule 701 E-5 shall not be necessary before obtaining administrative approval for the conversion of additional wells to water injection.

(3) That monthly progress reports of the waterflood project herein authorized shall be submitted to the Commission in accordance with Rules 704 and 1119 of the Commission Rules and Regulations.

(4) That jurisdiction of this cause is retained for the entry of such further orders as the Commission may deem necessary.

DONE at Santa Fe, New Mexico, on the day and year hereinabove designated.