



OIL CONSERVATION DIVISION  
Texaco RECEIVED

'90 AUG 29 AM 8 32

Texaco Inc.  
3300 N. Butler Ave.  
Farmington, NM 87401

August 24, 1990

Oil Conservation Division  
P. O. Box 2088  
Santa Fe, NM 87501

Attn: Mr. Mike Stogner

RE: Unorthodox Location  
H. J. Loe B Federal No. 2  
1850' FNL & 2310' FEL  
Sec. 23, T29N, R12W  
San Juan Co., NM  
Fulcher Kutz Pictured Cliffs

OK  
talk w/ E. Bosch

Gentlemen:

Texaco respectfully requests permission to recomplete the subject well at an unorthodox location in the Fulcher Kutz PC Pool. The subject well was plugged back after developing a casing leak and a replacement well was drilled nearby. The well has remained shut in since that time. Texaco plans to test uphole potential in the Pictured Cliffs and will plug the well if no commercial production is found. This location will not affect offset operators since it maintains the required footage buffers from the section lines and Texaco owns the PC rights in the remainder of the section.

Attached, for your information, is the notification to offset operators and C-102 for the subject well. If you have any questions or need additional information concerning this matter, please contact Brad Weiss at 505/325-4397.

Sincerely,

Mr. Alan A. Kleier  
AREA MANAGER

BLW

Attachments  
cc: file  
NMOCD - Aztec



Texaco

Texaco Inc.  
3300 N. Butler Ave.  
Farmington, NM 87401

August 24, 1990

Meridian Oil  
3535 E. 30th  
Farmington, NM 87401

RE: Unorthodox Location  
H. J. Loe B Federal No. 2  
1850' FNL & 2310' FEL  
Sec. 23, T29N, R12W  
San Juan Co., NM  
Fulcher Kutz Pictured Cliffs

Gentlemen:

As an offset operator to the spacing unit for the referenced well, you are being furnished with a copy of our application for an exception to NMOCD Rule 104.C.I.. If you have no objections, please sign the waiver at the bottom of this letter and return it to this address. If no objection is received within 20 days, the Director may approve the proposed application.

Sincerely,

Mr. Alan A. Kleier  
AREA MANAGER

BLW

Attachments  
cc: file

Waiver Approval:

COMPANY: \_\_\_\_\_

BY: \_\_\_\_\_

DATE: \_\_\_\_\_



Texaco

Texaco Inc.  
3300 N. Butler Ave.  
Farmington, NM 87401

August 24, 1990

R&G Drilling  
c/o Walsh Engineering & Prod. Co.  
P. O. Box 254  
Farmington, NM 87401

RE: Unorthodox Location  
H. J. Loe B Federal No. 2  
1850' FNL & 2310' FEL  
Sec. 23, T29N, R12W  
San Juan Co., NM  
Fulcher Kutz Pictured Cliffs

Gentlemen:

As an offset operator to the spacing unit for the referenced well, you are being furnished with a copy of our application for an exception to NMOC Rule 104.C.I.. If you have no objections, please sign the waiver at the bottom of this letter and return it to this address. If no objection is received within 20 days, the Director may approve the proposed application.

Sincerely,

Mr. Alan A. Kleier  
AREA MANAGER

BLW

Attachments  
cc: file

Waiver Approval:

COMPANY: \_\_\_\_\_

BY: \_\_\_\_\_

DATE: \_\_\_\_\_



Texaco

Texaco Inc.  
3300 N. Butler Ave.  
Farmington, NM 87401

August 24, 1990

Alpine Oil & Gas Corporation  
P. O. Box 2567  
Durango, CO 81302

RE: Unorthodox Location  
H. J. Loe B Federal No. 2  
1850' FNL & 2310' FEL  
Sec. 23, T29N, R12W  
San Juan Co., NM  
Fulcher Kutz Pictured Cliffs

Gentlemen:

As an offset operator to the spacing unit for the referenced well, you are being furnished with a copy of our application for an exception to NMOC Rule 104.C.I.. If you have no objections, please sign the waiver at the bottom of this letter and return it to this address. If no objection is received within 20 days, the Director may approve the proposed application.

Sincerely,

*Alan A. Kleier*

Mr. Alan A. Kleier  
AREA MANAGER

BLW

Attachments  
cc: file

Waiver Approval:

COMPANY: \_\_\_\_\_

BY: \_\_\_\_\_

DATE: \_\_\_\_\_

# OIL CONSERVATION DIVISION

DISTRICT I  
P.O. Box 1980, Hobbs, NM 88240

P.O. Box 2088  
Santa Fe, New Mexico 87504-2088

DISTRICT II  
P.O. Drawer DD, Artesia, NM 88210

DISTRICT III  
1000 Rio Brazos Rd., Aztec, NM 87410

## WELL LOCATION AND ACREAGE DEDICATION PLAT

All Distances must be from the outer boundaries of the section

Operator Texaco Inc.			Lease Loe, H. J. B. Federal		Well No. 2
Unit Letter G	Section 23	Township 29N	Range 12W	County NMPM San Juan	
Actual Footage Location of Well: 1850 feet from the North line and 2310 feet from the East line					
Ground level Elev. 5657'	Producing Formation Picture Cliffs		Pool Fulcher Kutz - PC		Dedicated Acreage: 160 Acres

1. Outline the acreage dedicated to the subject well by colored pencil or hatchure marks on the plat below.

2. If more than one lease is dedicated to the well, outline each and identify the ownership thereof (both as to working interest and royalty).

3. If more than one lease of different ownership is dedicated to the well, have the interest of all owners been consolidated by communitization, unitization, force-pooling, etc.?

☐ Yes ☐ No If answer is "yes" type of consolidation \_\_\_\_\_

If answer is "no" list the owners and tract descriptions which have actually been consolidated. (Use reverse side of this form if necessary.) \_\_\_\_\_

No allowable will be assigned to the well until all interests have been consolidated (by communitization, unitization, forced-pooling, or otherwise) or until a non-standard unit, eliminating such interest, has been approved by the Division.

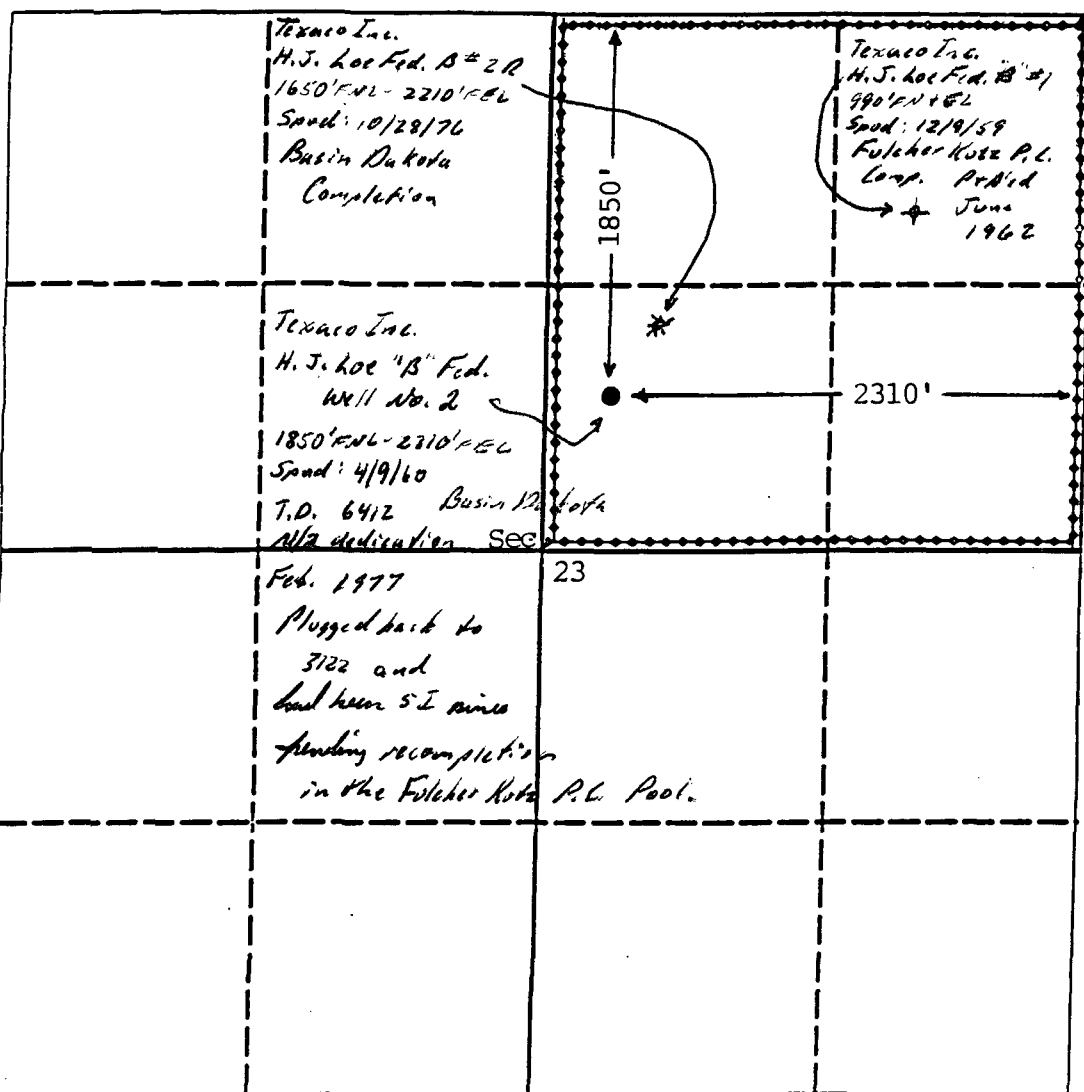

### OPERATOR CERTIFICATION

I hereby certify that the information contained herein is true and complete to the best of my knowledge and belief.

Signature

*Alan A. Kleier*

Printed Name

Alan A. Kleier

Position

Area Manager

Company

Texaco Inc.

Date

8-23-90

### SURVEYOR CERTIFICATION

I hereby certify that the well location shown on this plat was plotted from field notes of actual surveys made by me or under my supervision, and that the same is true and correct to the best of my knowledge and belief.

Date Surveyed

Signature & Seal of  
Professional Surveyor

Certificate No.

<p>15</p> <p>MAXEY - 001 0/0/202</p>	<p>CORNELL - 004 14 0/0/23</p> <p>HARDIE - 002 0/0/88</p> <p>HARDIE - 068 0/0/800</p> <p>REID DRUM</p>	<p>CARROLL CORNELL - 00088 0/0/305</p> <p>REID - 002 0/0/2156</p> <p>13</p> <p>Southland Royalty/Meridian Oil &amp; Gas</p>
<p>22</p>	<p>H J LOE LEASE</p> <p>SUBJECT WELL H. J. Loe B Fed #2 S.I.</p> <p>23</p>	<p>ALPINE OIL &amp; GAS FEDERAL - 001 0/1/40</p> <p>MAXEY - 001J 0/0/28</p> <p>24</p>

**Legend**