

Unocal Oil & Gas Division

Unocal Corporation

3300 North Butler Avenue

Suite 200

Farmington, New Mexico 87401

Telephone (505) 326-7600

Fax: (505) 326-6145

UNION DIVISION

RECEIVED

UNOCAL 76

'90 SEP 12 AM 9 04

September 10, 1990

Farmington District

Mr. William Lemay, Director
Oil Conservation Division
New Mexico Department of Energy,
Minerals and Natural Resources
State Land Office Building
P.O. Box 2088
Santa Fe, NM 87503

RE: Application of Union Oil Company
of California dba Unocal for a non-
standard Location of an existing well
recompletion to the Basin Fruitland
Coal (Gas) Rincon Unit #117, 1750'
FSL & 990' FEL, NE/4 SE/4, Sec. 21,
T27N-R6W, Rio Arriba County, NM
SF079366

Dear Mr. Lemay:

Union Oil Company of California dba Unocal hereby makes this application for administrative approval for a non-standard location to the Basin Fruitland Coal (Gas) formation as per Rule 8, Special Rules and Regulations for the Basin Fruitland Coal Gas Pool. The subject well, located in the SE/4 Sec. 21, T27N-R6W, was originally drilled to the Blanco Pictured Cliffs South formation and is no longer productive. It is proposed to plug back the Pictured Cliffs formation and recomplete uphole to the Fruitland Coal formation.

Since this well is located in the SE/4 of the section it is off pattern and therefore non-standard in the Basin Fruitland Coal.

As Unocal is the operator of all offset acreage no letters have been sent to any other operators notifying them of this application.

A map of the lease is attached to this application showing offset operators and owners.

Also attached is a new C-102 showing the 320 acre dedication to the Basin Fruitland Coal.

Union Oil Company of California requests that the Director approve this application for a non-standard location.

Respectfully submitted,

Union Oil Company of California
dba UNOCAL

A handwritten signature in cursive script, appearing to read "Bill Hering".

Bill Hering
District Petroleum Engineer

WH/df

Encl.

Submit to Appropriate
District Office
State Lease - 4 copies
Fee Lease - 3 copies

State of New Mexico
Energy, Minerals and Natural Resources Department

Form C-102
Revised 1-1-89

OIL CONSERVATION DIVISION

P.O. Box 2088
Santa Fe, New Mexico 87504-2088

DISTRICT I
P.O. Box 1980, Hobbs, NM 88240

DISTRICT II
P.O. Drawer DD, Artesia, NM 88210

DISTRICT III
1000 Rio Brazos Rd., Aztec, NM 87410

WELL LOCATION AND ACREAGE DEDICATION PLAT

All Distances must be from the outer boundaries of the section

Operator Union Oil Company of California			Lease Rincon Unit SF079366		Well No. 117
Unit Letter I	Section 21	Township 27N	Range 6W	County Rio Arriba	
Actual Footage Location of Well: 1750' feet from the South line and 990' feet from the East line					
Ground level Elev. 6515'	Producing Formation Fruitland Coal		Pool Basin Fruitland Coal	Dedicated Acreage: 320 Acres	

1. Outline the acreage dedicated to the subject well by colored pencil or hatchure marks on the plat below.
2. If more than one lease is dedicated to the well, outline each and identify the ownership thereof (both as to working interest and royalty).
3. If more than one lease of different ownership is dedicated to the well, have the interest of all owners been consolidated by communitization, unitization, force-pooling, etc.?
☒ Yes ☐ No If answer is "yes" type of consolidation Unitization
If answer is "no" list the owners and tract descriptions which have actually been consolidated. (Use reverse side of this form if necessary).
No allowable will be assigned to the well until all interests have been consolidated (by communitization, unitization, forced-pooling, or otherwise) or until a non-standard unit, eliminating such interest, has been approved by the Division.

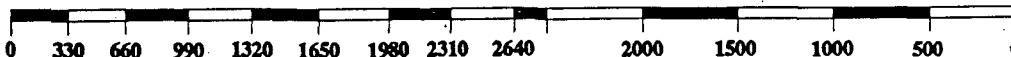
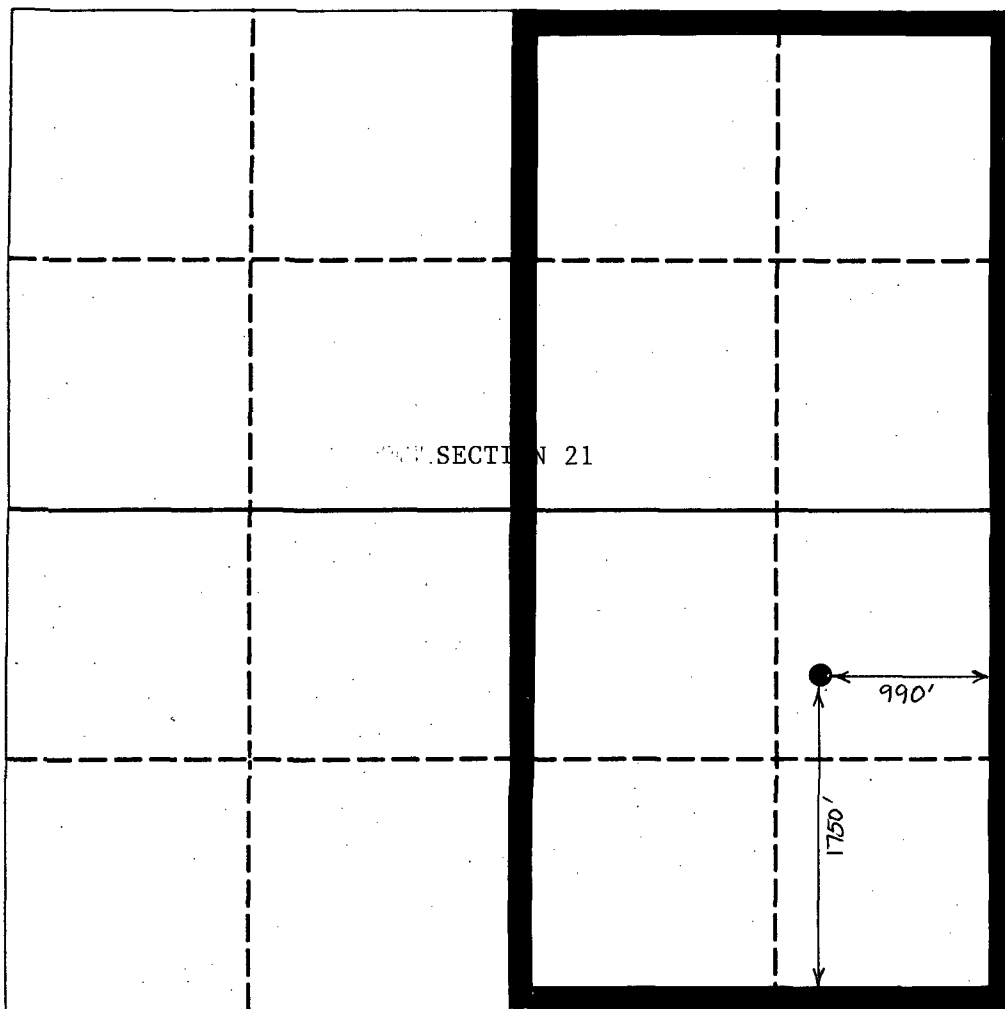

OPERATOR CERTIFICATION

I hereby certify that the information contained herein is true and complete to the best of my knowledge and belief.

Signature William Hering
Printed Name
William Hering
Position
Dist. Petroleum Engineer
Company
Union Oil Co. of Calif.
Date
9-1-90

SURVEYOR CERTIFICATION

I hereby certify that the well location shown on this plat was plotted from field notes of actual surveys made by me or under my supervision, and that the same is true and correct to the best of my knowledge and belief.

Date Surveyed

Signature & Seal of
Professional Surveyor

Certificate No.

Calculation Record

UNOCAL 76

PREPARED BY	CHECKED BY	DATE 9-1-90	PAGE OF
SUBJECT RINCON UNIT #117 - OFFSET OPERATOR PLAT			W.O.A.F.E. NO

