

# MERIDIAN OIL

OIL CONSERVATION DIVISION  
RECEIVED

93 DEC 22 AM 10 09

December 21, 1993

## Federal Express

Mr. William LeMay  
New Mexico Oil Conservation Division  
310 Old Santa Fe Trail  
Santa Fe, New Mexico 87503

Re: Huerfano Unit #258  
990'FSL, 990'FEL  
Section 36, T-27-N, R-10-W, San Juan County, NM

Dear Mr. LeMay:

This is a request for administrative approval for a non-standard gas well location in the Basin Fruitland Coal Pool.

Meridian Oil intends to plugback and recomplete the Huerfano Unit #258 from the Gallup to the Basin Fruitland Coal Pool and Fulcher Kutz Pictured Cliffs formation. The current location of this well is considered non-standard due to the NE-SW dedicated pattern established for the Basin Fruitland Coal pool. It is standard for the Pictured Cliffs formation. To comply with the New Mexico Oil Conservation Division rules, Meridian is submitting the following for your approval of this non-standard location:

1. C-102 plat showing location of the well;
2. Plat showing offset owners/operators;
3. Affidavit of notification of offset owners/operators;
4. Copy of Well Completion Log for original completion.

A copy of this application is being submitted to all offset owners/operators by certified mail with a request that they furnish your Santa Fe office with a Waiver of Objection, and return one copy to this office.

Sincerely yours,



Peggy Bradfield  
Regulatory/Compliance Representative

## WAIVER

\_\_\_\_\_ hereby waives objection to Meridian Oil's application for non-standard location for the Huerfano Unit #258 as proposed above.

By: \_\_\_\_\_ Date: \_\_\_\_\_

xc: McKenzie Methane Corp.  
Quintana Petroleum Services

NEW MEXICO OIL CONSERVATION COMMISSION  
WELL LOCATION AND ACREAGE DEDICATION PLAT

Form C-122  
Supersedes C-128  
Effective 1-1-55

All distances must be from the outer boundaries of the Section.

Operator <b>Meridian Oil Inc.</b>			Lease <b>Huerfano Unit (NM-03017)</b>		Well No. <b>258</b>
Unit Letter <b>P</b>	Section <b>36</b>	Township <b>27-N</b>	Range <b>10-W</b>	County <b>SAN JUAN</b>	
Actual Footage Location of Well: <div style="display: flex; justify-content: space-between;"> <span><b>990</b> feet from the <b>SOUTH</b> line and</span> <span><b>990</b> feet from the <b>EAST</b> line</span> </div>					
Ground Level Elev. <b>6496</b>	Producing Formation <b>Fruitland Coal/PC</b>		Pool <b>Basin /Fulcher Kutz</b>		Dedicated Acreage: <b>300.2/160</b> Acres

1. Outline the acreage dedicated to the subject well by colored pencil or hatchure marks on the plat below.
2. If more than one lease is dedicated to the well, outline each and identify the ownership thereof (both as to working interest and royalty).
3. If more than one lease of different ownership is dedicated to the well, have the interests of all owners been consolidated by communitization, unitization, force-pooling, etc?

☒ Yes    ☐ No    If answer is "yes," type of consolidation **Unitization**

If answer is "no," list the owners and tract descriptions which have actually been consolidated. (Use reverse side of this form if necessary.) \_\_\_\_\_

No allowable will be assigned to the well until all interests have been consolidated (by communitization, unitization, forced-pooling, or otherwise) or until a non-standard unit, eliminating such interests, has been approved by the Commission.

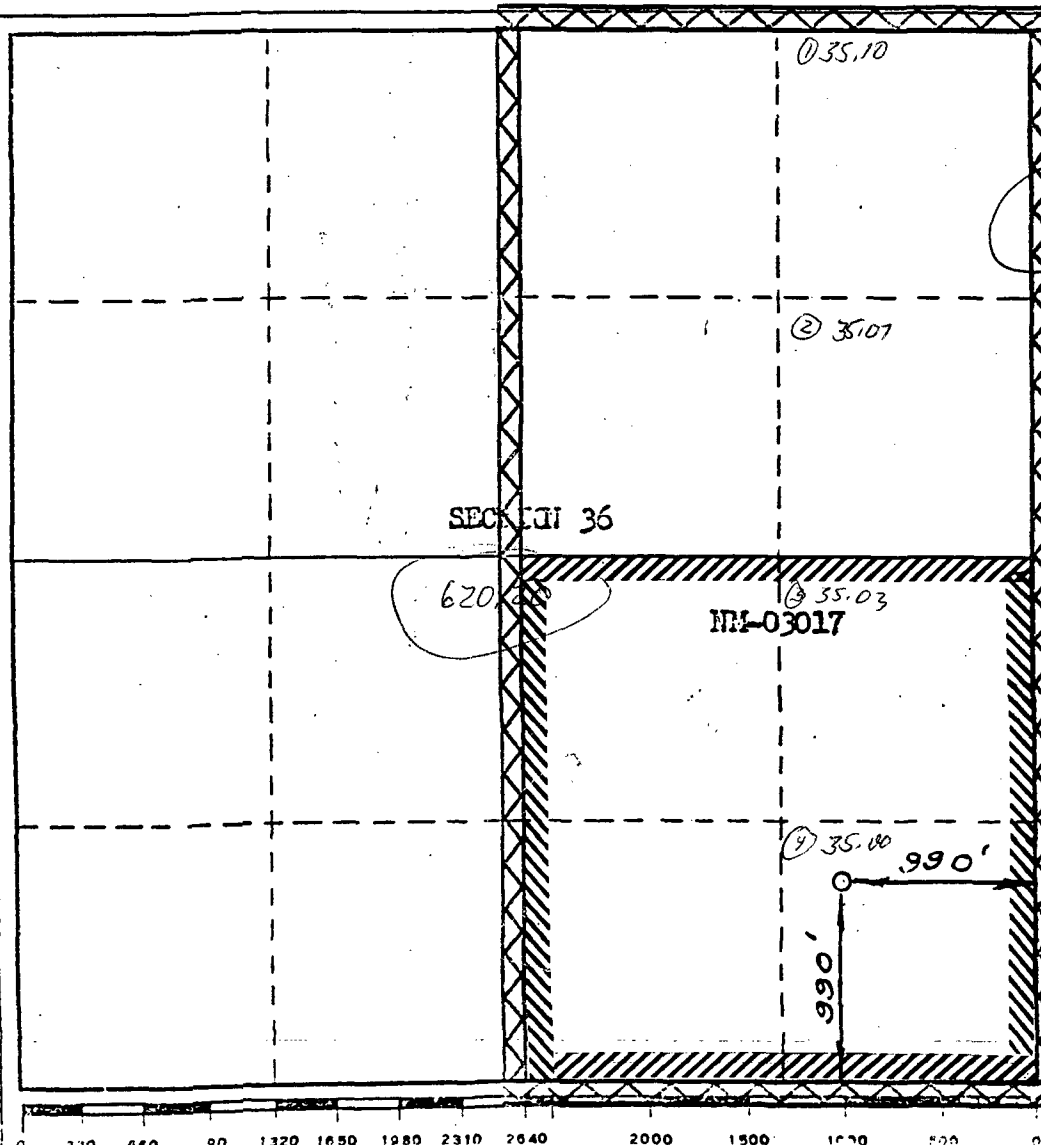

CERTIFICATION	
I hereby certify that the information contained herein is true and complete to the best of my knowledge and belief.	
 Name <b>Peggy Bradfield</b> Position <b>Regulatory Affairs</b> Company <b>Meridian Oil Inc.</b> Date <b>12-15-93</b>	
I hereby certify that the well location shown on this plat was plotted from field notes of actual surveys made by me or under my supervision, and that the same is true and correct to the best of my knowledge and belief.	
Date Surveyed <b>DECEMBER 11, 1973</b>	
Registered Professional Engineer and/or Land Surveyor  Certificate No. <b>1760</b>	

# MERIDIAN OIL INC

## HUERFANO UNIT #258

OFFSET OPERATOR \ OWNER PLAT

Unorthodox Well Location

Township 27 North, Range 10 West

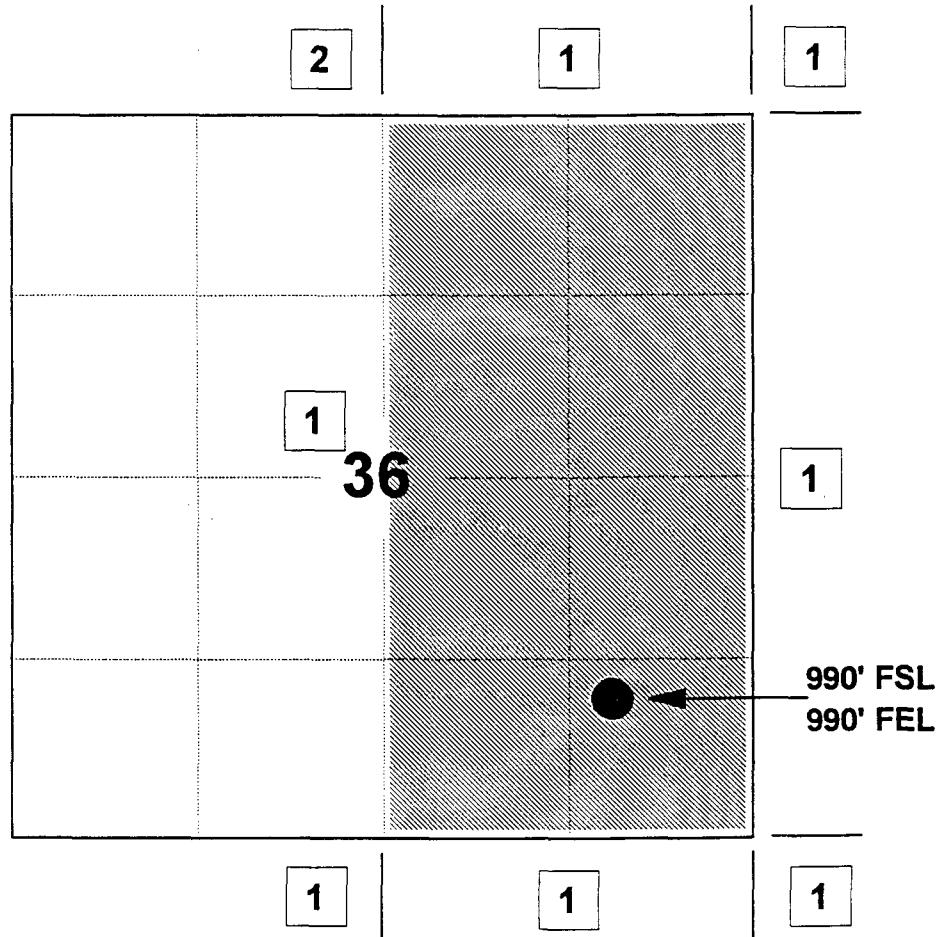

1) Meridian Oil Inc

2) McKenzie Methane Corp 1625 Broadway, Ste 2580, Denver, CO 80201 &  
Quintana Petroleum Services 601 Jefferson St, Houston, TX 77002

September 14, 1993

Huerfano Unit #258  
990'FSL, 990'FEL  
Section 36, T-27-N, R-10-W  
San Juan County, New Mexico

I hereby certify that the following offset owners/operators have been notified by certified mail of our application for administrative approval for non-standard gas well location for the plugback and recompletion of the above well.

McKenzie Methane Corp.  
1625 Boradway, Suite 2580  
Denver, CO 80201

Quintana Petroleum Services  
601 Jefferson Street  
Houston, TX 77002

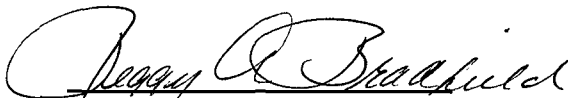
A handwritten signature in cursive script, appearing to read "Peggy Bradford", written over a horizontal line.

Peggy Bradford  
Notary Public  
San Juan County, New Mexico

My commission expires August 17, 1996.

UNITED STATES  
DEPARTMENT OF THE INTERIOR  
GEOLOGICAL SURVEY

SUBMIT IN DUPLICATE\*

(See other instructions on reverse side)

Form approved.  
Budget Bureau No. 42-R355.5.

## WELL COMPLETION OR RECOMPLETION REPORT AND LOG \*

5. LEASE DESIGNATION AND SERIAL NO.

NM03017

6. IF INDIAN, ALLOTTEE OR TRIBE NAME

7. UNIT AGREEMENT NAME

Huerfano Unit

8. FARM OR LEASE NAME

Huerfano Unit

9. WELL NO.

258

10. FIELD AND POOL, OR WILDCAT

Angel Peak Gallup Ext

11. SEC., T., R., M., OR BLOCK AND SURVEY OR AREA

Sec. 36, T-27-N, R-10-W  
N.M.P.M.

12. COUNTY OR PARISH

San Juan

13. STATE

New Mexico

1a. TYPE OF WELL: OIL WELL ☐ GAS WELL ☒ DRY ☐ Other

b. TYPE OF COMPLETION:

NEW WELL ☒ WORK OVER ☐ DEEP-EN ☐ PLUG BACK ☐ DIFF. RESVR. ☐ Other

2. NAME OF OPERATOR

El Paso Natural Gas Company

3. ADDRESS OF OPERATOR

P. O. Box 990, Farmington, NM 87401

4. LOCATION OF WELL (Report location clearly and in accordance with any State requirements)\*

At surface 990'S, 990'E

At top prod. interval reported below

At total depth

14. PERMIT NO.

DATE ISSUED

DEC 11 1974

U. S. GEOLOGICAL SURVEY

15. DATE SPUDDED 16. DATE T.D. REACHED 17. DATE COMPL. (Ready to prod.) 18. ELEVATIONS (DF, REB, RT, GR, ETC.)\* 19. ELEV. CASINGHEAD

03-26-74

04-05-74

11-29-74

6496- GL

20. TOTAL DEPTH, MD &amp; TVD 21. PLUG, BACK T.D., MD &amp; TVD 22. IF MULTIPLE COMPL., HOW MANY\* 23. INTERVALS DRILLED BY 24. PRODUCING INTERVAL(S), OF THIS COMPLETION—TOP, BOTTOM, NAME (MD AND TVD)\* 25. WAS DIRECTIONAL SURVEY MADE

6153'

6137'

ROTARY TOOLS

CABLE TOOLS

0-6153

5734-6090' (GL)

26. TYPE ELECTRIC AND OTHER LOGS RUN

IES; FDC-GR; Temp. Survey

27. WAS WELL CORED

No

No

28. CASING RECORD (Report all strings set in well)

CASING SIZE	WEIGHT, LB./FT.	DEPTH SET (MD)	HOLE SIZE	CEMENTING RECORD	AMOUNT PULLED
8 5/8"	24#	208'	12 1/4"	183 cu. ft.	
4 1/2"	10.5#	6153'	7 7/8"	1166 cu. ft.	

29. LINER RECORD

SIZE	TOP (MD)	BOTTOM (MD)	SACKS CEMENT*	SCREEN (MD)	SIZE	DEPTH SET (MD)	PACKER SET (MD)
					2 3/8"	6096'	

30. TUBING RECORD

31. PERFORATION RECORD (Interval, size and number)

5734', 5822', 5926', 5988', 6010',  
6048', 6086', 6090' with 1 shot per zone.

32. ACID, SHOT, FRACTURE, CEMENT SQUEEZE, ETC.

DEPTH INTERVAL (MD) AMOUNT AND KIND OF MATERIAL USED  
5734-6090' 80,000# sand; 83,202 gal wtr

33.\*

PRODUCTION

DATE FIRST PRODUCTION PRODUCTION METHOD (Flowing, gas lift, pumping—size and type of pump) WELL STATUS (Producing or shut-in)  
Flowing Shut-In

DATE OF TEST	HOURS TESTED	CHOKE SIZE	PROD'N. FOR TEST PERIOD	OIL—BBL.	GAS—MCF.	WATER—BBL.	GAS-OIL RATIO
11-29-74	3 hours	3/4" variable	→	17.16			
FLOW. TUBING PRESS.	CASING PRESSURE	CALCULATED 24-HOUR RATE	OIL—BBL.	GAS—MCF.	WATER—BBL.	OIL GRAVITY-API (CORR.)	
SI 257	SI 764	→		428 MCF/D-AOI		29	

34. DISPOSITION OF GAS (Sold, used for fuel, vented, etc.)

TEST WITNESSED BY

Johnson and Goodwin

35. LIST OF ATTACHMENTS

36. I hereby certify that the foregoing and attached information is complete and correct as determined from all available records

SIGNED

D. D. Brisco

TITLE

Drilling Clerk

DATE

December 6, 1974

\*(See Instructions and Spaces for Additional Data on Reverse Side)