



OIL CONSERVATION DIVISION  
RECEIVED

OIL CONSERVATION DIVISION

'90 DEC 3 AM 10 00

STATE OF NEW MEXICO

To: Mike Stogner E

From Evelyn

GARREY CARRUTHERS  
GOVERNOR

November 19, 1990

POST OFFICE BOX 2088  
STATE LAND OFFICE BUILDING  
SANTA FE, NEW MEXICO 87504  
(505) 827-5800

Greenhill Petroleum Corporation  
12777 Jones Road, Suite 375  
Houston, TX 77079

Attention: Michael J. Newport

Administrative Order NSL-2943

Dear Mr. Newport:

Reference is made to your applications dated September 5 and October 23, 1990 for two non-standard producing oil well locations to permit the completion of an efficient production/injection pattern within the Lovington-San Andres Unit Waterflood Project, Lea County, New Mexico. Both wells are to be dedicated to an existing standard 40-acre oil spacing and proration unit comprising the SW/4 SW/4 (Unit M) of Section 36, Township 16 South, Range 36 East, NMPM, Lovington-Grayburg-San Andres Pool, Lea County, New Mexico.

By the authority granted me under the provisions of General Rule 104F(I), both of the following described unorthodox oil well locations are hereby approved.

- ✓ Lovington San Andres Unit Well No. 63  
100' FSL - 115' FWL; and
- ✓ Lovington San Andres Unit Well No. 65  
1168' FSL - 1330' FWL.

Sincerely,

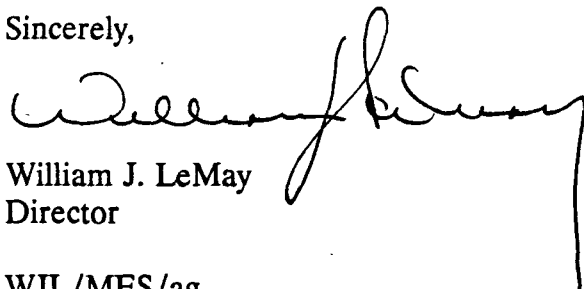
  
William J. LeMay  
Director

WJL/MES/ag

cc: Oil Conservation Division - Hobbs  
NM State Land Office - Santa Fe

Mike,  
#65 was moved  
from 1315/W (unit M)  
to 1330/W (unit N)

OIL CONSERVATION DIVISION

P.O. Box 2088  
Santa Fe, New Mexico 87504-2088

DISTRICT I  
P.O. Box 1980, Hobbs, NM 88240

DISTRICT II  
P.O. Drawer DD, Artesia, NM 88210

DISTRICT III  
1000 Rio Brazos Rd., Aztec, NM 87410

WELL LOCATION AND ACREAGE DEDICATION PLAT

All Distances must be from the outer boundaries of the section

Operator GREENHILL PETROLEUM CORP.			Lease Lovington San Andres Unit		Well No. 65
Unit Letter N	Section 36	Township 16 South	Range 36 East	County Lea	
NMPM					

Actual Footage Location of Well: 1168 feet from the South line and 1330 feet from the West line					
Ground level Elev. 3826.4	Producing Formation San Andres		Pool Lovington Grayburg San Andres		Dedicated Acreage: 40 <del>30</del> Acres

- Outline the acreage dedicated to the subject well by colored pencil or hatchure marks on the plat below.
- If more than one lease is dedicated to the well, outline each and identify the ownership thereof (both as to working interest and royalty).
- If more than one lease of different ownership is dedicated to the well, have the interest of all owners been consolidated by communitization, unitization, force-pooling, etc.?  
☐ Yes ☐ No If answer is "yes" type of consolidation \_\_\_\_\_  
If answer is "no" list the owners and tract descriptions which have actually been consolidated. (Use reverse side of this form if necessary.) \_\_\_\_\_  
No allowable will be assigned to the well until all interests have been consolidated (by communitization, unitization, forced-pooling, or otherwise) or until a non-standard unit, eliminating such interest, has been approved by the Division.

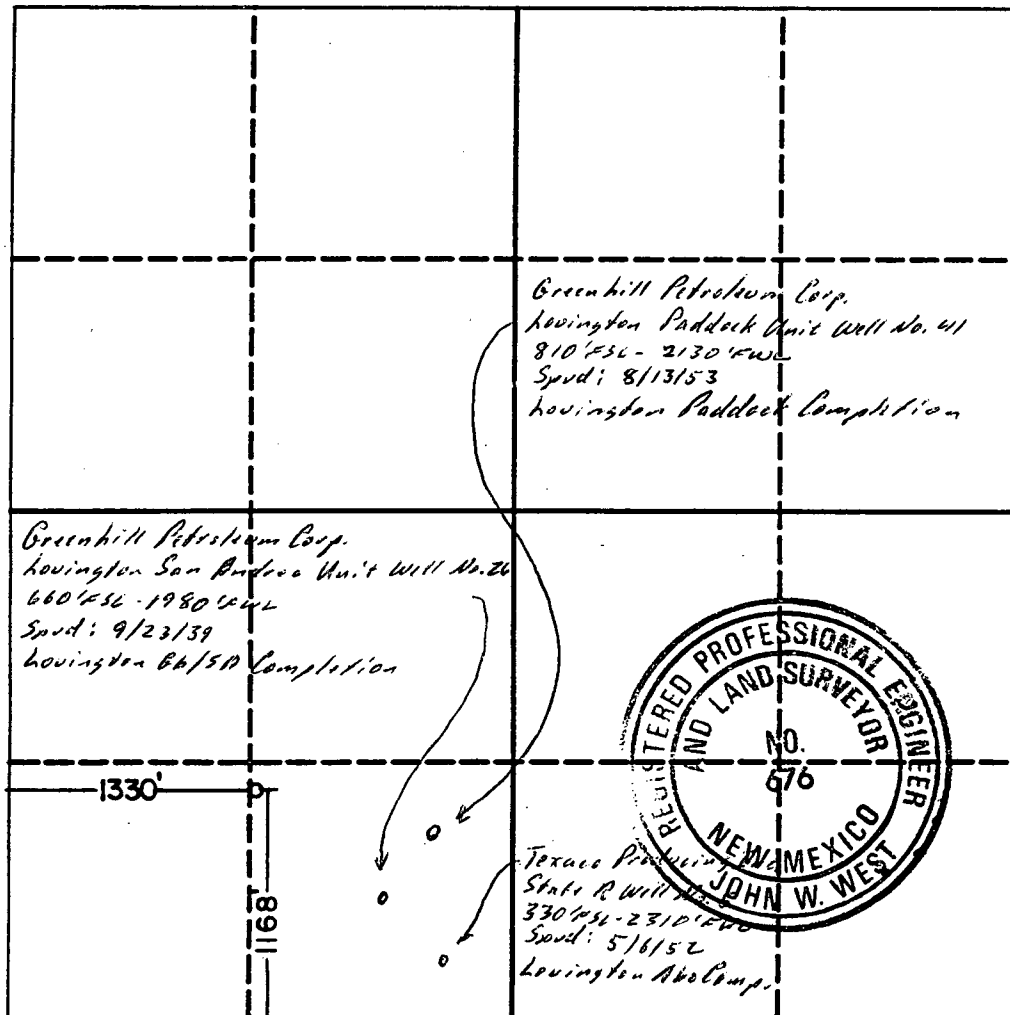

OPERATOR CERTIFICATION

I hereby certify that the information contained herein is true and complete to the best of my knowledge and belief.

Signature <i>Michael J. Newport</i>
Printed Name Michael J. Newport
Position Landman
Company Greenhill Petroleum Corp.
Date 10-23-90

SURVEYOR CERTIFICATION

I hereby certify that the well location shown on this plat was plotted from field notes of actual surveys made by me or under my supervision, and that the same is true and correct to the best of my knowledge and belief.

Date Surveyed August 20, 1990
Signature & Seal of Professional Surveyor <i>John W. West</i>
Certificate No. JOHN W. WEST, 676 RONALD J. EDSON, 3239