



STATE OF NEW MEXICO
ENERGY, MINERALS AND NATURAL RESOURCES DEPARTMENT
OIL CONSERVATION DIVISION

BRUCE KING
GOVERNOR

POST OFFICE BOX 2088
STATE LAND OFFICE BUILDING
SANTA FE, NEW MEXICO 87504
(505) 827-5800

July 10, 1991

Meridian Oil, Inc.
21 Desta Drive
Midland, Texas 79705

Attention: Connie L. Malik

Administrative Order NSL-3030(SD)

Dear Ms. Malik:

Reference is made to your application dated June 17, 1991, for an unorthodox Eumont gas well location in an existing non-standard 230.32-acre gas spacing and proration unit (GPU) for said Eumont Gas Pool comprising lots 9 through 14 of Section 6, Township 21 South, Range 36 East, NMPM, Lea County, New Mexico. Said GPU was authorized by Division Order No. R-3327, dated October 11, 1967 and presently has dedicated thereon the Shell "E" State Com Well No. 1 located 3300 feet from the North line and 1980 feet from the East line (Unit J) of said Section 6 and to the Shell "E" State Com Well No. 2 located 3566 feet from the South line and 1980 feet from the West line (Unit N) of said Section 6.

By authority granted me under the provisions of Rule 2(c) of the Special Rules and Regulations for the Eumont Gas Pool, as promulgated by Division Order No. R-8170, as amended, the following described well to be drilled at an unorthodox gas well location in said Section 17 is hereby approved:

Shell "E" State Com. Well No. 3
3450' FNL - 660' FWL (Unit L)

Meridian Oil, Inc.
Administrative Order NSL-3030SD)
Page 2
July 10, 1991

Also, you are hereby authorized to simultaneously dedicate Eumont Gas production from the Shell "E" State Com Well No. 3 with the Shell "E" State Com Well Nos. 1 and 2. Furthermore, you are hereby permitted to produce the allowable assigned the GPU from all of said wells in any proportion.

Sincerely,

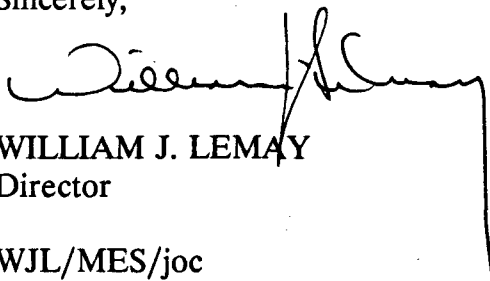

WILLIAM J. LEMAY
Director

WJL/MES/joc

cc: Oil Conservation Division - Hobbs

MERIDIAN OIL

OIL CONSERVATION DIVISION
RECEIVED

'91 JUL 26 AM 9 57

July 23, 1991

Mr. Michael E. Stogner
State of New Mexico
Energy, Minerals & Natural Resource Dept.
Oil Conservation Division
P. O. Box 2088
Santa Fe, NM 87501

RE: AMEND LOCATION
ADMINISTRATIVE ORDER NSL - 3030 (SD) DATED 7/10/91
FOR SIMULTANEOUS DEDICATION AND UNORTHODOX LOCATION
ORDER NO. R-3327, DATED OCTOBER 11, 1967 FOR NON-
STANDAS GAS PRORATION UNIT SHELL "E" COM WELL NO. 3
3500' FNL & 690' FWL
(L) SEC. 6, T21S, R36E
LEA COUNTY, NEW MEXICO

Dear Mr. Lemay:

The captioned orders have been approved or amended to include the Shell "E" State Com. Well No. 3. The location previously submitted was 3450' FNL & 660' FWL (Unit L), Sec. 6, T21S, R36E, Lea County, New Mexico.

When we applied for these requests, this was a proposed location. When well was surveyed by surveyor, the location had to be moved to 3500' FNL & 690' FWL due to a road and a power line.

Should you require additional information, please contact me at (915) 686-5767.

Sincerely,

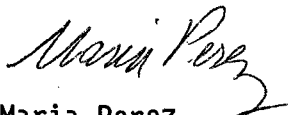

Maria Perez
Regulatory Assistant

cc: Oil Conservation Division
District I
P. O. Box 1980
Hobbs, NM 88240
Attn: Jerry Sexton

State Lease 4 copies
P.O. Box 1980
Hobbs, NM 88240

NEW MEXICO OIL CONSERVATION COMMISSION
WELL LOCATION AND ACREAGE DEDICATION PLAT

Form C-102
Supersedes C-128
Effective 1-1-65

All distances must be from the outer boundaries of the Section.

Operator MERIDIAN OIL INC.			Lease SHELL STATE E COM.			Well No. 3		
Unit Letter L	Section 6	Township 21 SOUTH	Range 36 EAST	County LEA COUNTY				
Actual Footage Location of Wells 3500 feet from the NORTH line and 690 feet from the WEST line								
Ground Level Elev. - 3553.2		Producing Formation Yates-7Rvrs		Pool Eumont (Yates-7Rvs-Queen)		Dedicated Acreage: 230.32 Acres		

1. Outline the acreage dedicated to the subject well by colored pencil or hachure marks on the plat below.
2. If more than one lease is dedicated to the well, outline each and identify the ownership thereof (both as to working interest and royalty).
3. If more than one lease of different ownership is dedicated to the well, have the interests of all owners been consolidated by communitization, unitization, force-pooling, etc?

☐ Yes ☐ No If answer is "yes," type of consolidation _____

If answer is "no," list the owners and tract descriptions which have actually been consolidated. (Use reverse side of this form if necessary.) _____

No allowable will be assigned to the well until all interests have been consolidated (by communitization, unitization, forced-pooling, or otherwise) or until a non-standard unit, eliminating such interests, has been approved by the Commission.

Simultaneous Dedication

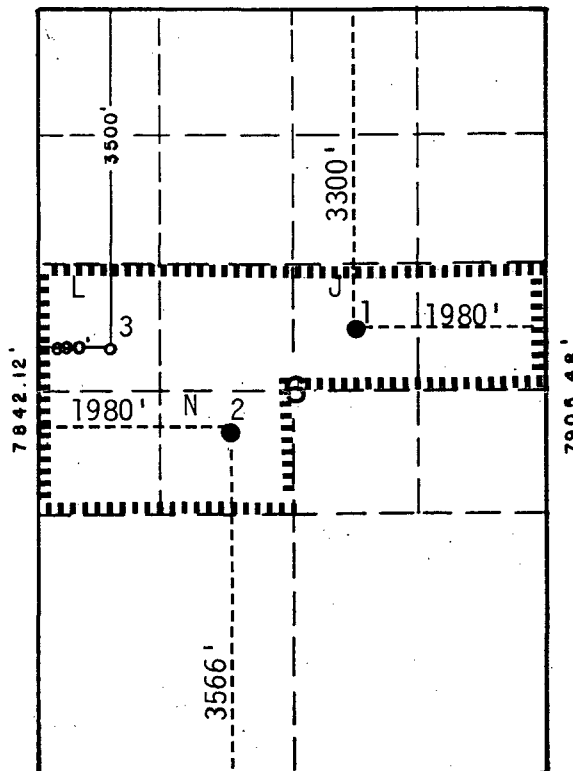

SCALE: 1" = 2000'

CERTIFICATION

I hereby certify that the information contained herein is true and complete to the best of my knowledge and belief.

Name
Maria L. Perez
Position
Proration Asst.

Company
Meridian Oil Inc.

Date
7-23-91

I hereby certify that the well location shown on this plat was plotted from field notes of actual surveys made by me or under my supervision, and that the same is true and correct to the best of my knowledge and belief.

Date Surveyed
7/23/91
Registered Professional Engineer
and Surveyor
JOHN W. ELDON
Certificate No. **50418** WEST **678**
NEW MEXICO
JOHN W. Eldon 3239

STATE OF NEW MEXICO

ENERGY, MINERALS AND NATURAL RESOURCES DEPARTMENT

OIL CONSERVATION DIVISION

BRUCE KING
GOVERNOR

July 29, 1991

POST OFFICE BOX 2088
STATE LAND OFFICE BUILDING
SANTA FE, NEW MEXICO 87504
(505) 827-5800Meridian Oil, Inc.
21 Desta Drive
Midland, Texas 79705

Attention: Connie L. Malik

Amended
Administrative Order NSL-3030(SD)

Dear Ms. Malik:

Reference is made to your application dated July 23, 1991, requesting amendment to Division Administrative Order NSL-3030(SD), dated July 10, 1991, which authorized Meridian's Shell "E" State Com Well No. 3 to be drilled at an unorthodox gas well location 3450 feet from the North line and 660 feet from the West line (Unit L) of Section 6, Township 21 South, Range 36 East, NMPM, Eumont Gas Pool, Lea County, New Mexico.

It is our understanding that the original well location was spotted on a map before surveying and said move is being requested because of the existence of a powerline and road at that location.

Division Administrative Order NSL-3030(SD) is hereby amended to show the well location for the Shell "E" State Com Well No. 3 to be "3500 feet from the North line and 690 feet from the West line (Unit L) of said Section 6", all other provisions of said Order NSL-3030(SD) shall remain in full force and effect until further notice.

Sincerely,

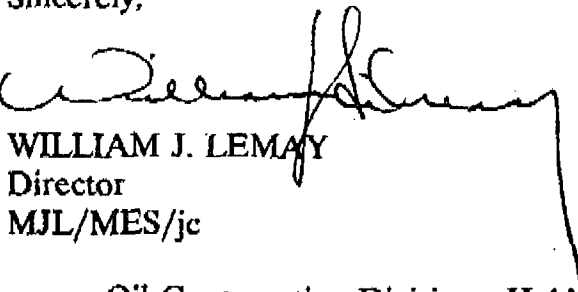
WILLIAM J. LEMAY
Director
MJL/MES/jc

cc: Oil Conservation Division - Hobbs