



**marbob**  
energy corporation

OIL CONSERVATION DIVISION  
RECEIVED

1991 SEP 13 AM 9 47

September 12, 1991

Oil Conservation Division  
P.O. Box 2088  
Santa Fe, New Mexico

Attention: Mr. Mike Stogner

Dear Mr. Stogner:

Marbob Energy Corporation respectfully requests an administrative approval without notice and hearing of the following unorthodox well locations pursuant to Order R-7808 of the New Mexico Oil Conservation Division. The well location's legal descriptions are as follows:

G-J West Coop Unit #100  
1345 FSL 1345 FWL  
Sec. 21-T17S-R29E  
Eddy County, New Mexico

G-J West Coop Unit #101  
2080 FSL 2615 FEL  
Sec. 21-T17S-R29E  
Eddy County, New Mexico

G-J West Coop Unit #102  
25 FSL 1295 FWL  
Sec. 21-T17S-R29E  
Eddy County, New Mexico

These wells will be completed in the Grayburg San Andres formation in the Grayburg Jackson Seven Rivers Queen Grayburg San Andres Pool.

Attached to this application are the following exhibits.

- A.) Well location and acreage dedication plat (form C-102) filed with the Artesia office of the Oil Conservation Division (Exhibit A).
- B.) A plat showing the proposed unorthodox locations, the respective proration units, and the offsetting proration units (Exhibit C).

Please note that Marbob Energy Corporation is the operator of all offsetting proration units in the Grayburg San Andres formation of the Grayburg Jackson Seven Rivers Queen Grayburg San Andres Pool, and therefore no other operators are required to be notified.

Thank you very much for your help in this matter. Should you have any further questions or be in need of any additional information, please feel free to call.

Sincerely,

A handwritten signature in cursive script that reads "David Martin".

David Martin  
Land Department

DM/mm  
Enclosures

Submit to Appropriate  
District Office  
State Lease - 4 copies  
Fee Lease - 3 copies

State of New Mexico  
Energy, Minerals and Natural Resources Department

Form C-102  
Revised 1-1-89

OIL CONSERVATION DIVISION

P.O. Box 2088  
Santa Fe, New Mexico 87504-2088

DISTRICT I

P.O. Box 1980, Hobbs, NM 88240

DISTRICT II

P.O. Drawer DD, Artesia, NM 88210

DISTRICT III

1000 Rio Brazos Rd., Aztec, NM 87410

WELL LOCATION AND ACREAGE DEDICATION PLAT

All Distances must be from the outer boundaries of the section

Operator Marbob Energy Corp.			Lease G. J. West		Well No. 100
Unit Letter K	Section 21	Township 17 South	Range 29 East	County NMPM Eddy	
Actual Footage Location of Well: 1345 feet from the South line and 1345 feet from the West line					
Ground level Elev. 3608.1	Producing Formation San Andres		Pool Grbg Jackson SR Q Grbg SA		Dedicated Acreage: 40 Acres

1. Outline the acreage dedicated to the subject well by colored pencil or hatchure marks on the plat below.
2. If more than one lease is dedicated to the well, outline each and identify the ownership thereof (both as to working interest and royalty).
3. If more than one lease of different ownership is dedicated to the well, have the interest of all owners been consolidated by communitization, unitization, force-pooling, etc.?  
☐ Yes ☐ No If answer is "yes" type of consolidation \_\_\_\_\_

If answer is "no" list the owners and tract descriptions which have actually been consolidated. (Use reverse side of this form if necessary.) \_\_\_\_\_

No allowable will be assigned to the well until all interests have been consolidated (by communitization, unitization, forced-pooling, or otherwise) or until a non-standard unit, eliminating such interest, has been approved by the Division.

OPERATOR CERTIFICATION

I hereby certify that the information contained herein is true and complete to the best of my knowledge and belief.

Signature

Printed Name

Rhonda Nelson

Position

Production Clerk

Company

Marbob Energy Corporation

Date

September 12, 1991

SURVEYOR CERTIFICATION

I hereby certify that the well location shown on this plat was plotted from field notes of actual surveys made by me or under my supervision, and that the same is true and correct to the best of my knowledge and belief.

Date Surveyed

September 9, 1991

Signature & Seal of  
Professional Surveyor

Certified No.

JOHN W. WEST,

676

RONALD J. EIDSON,

3239

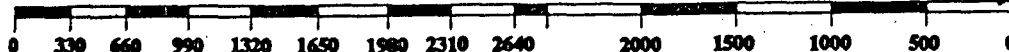
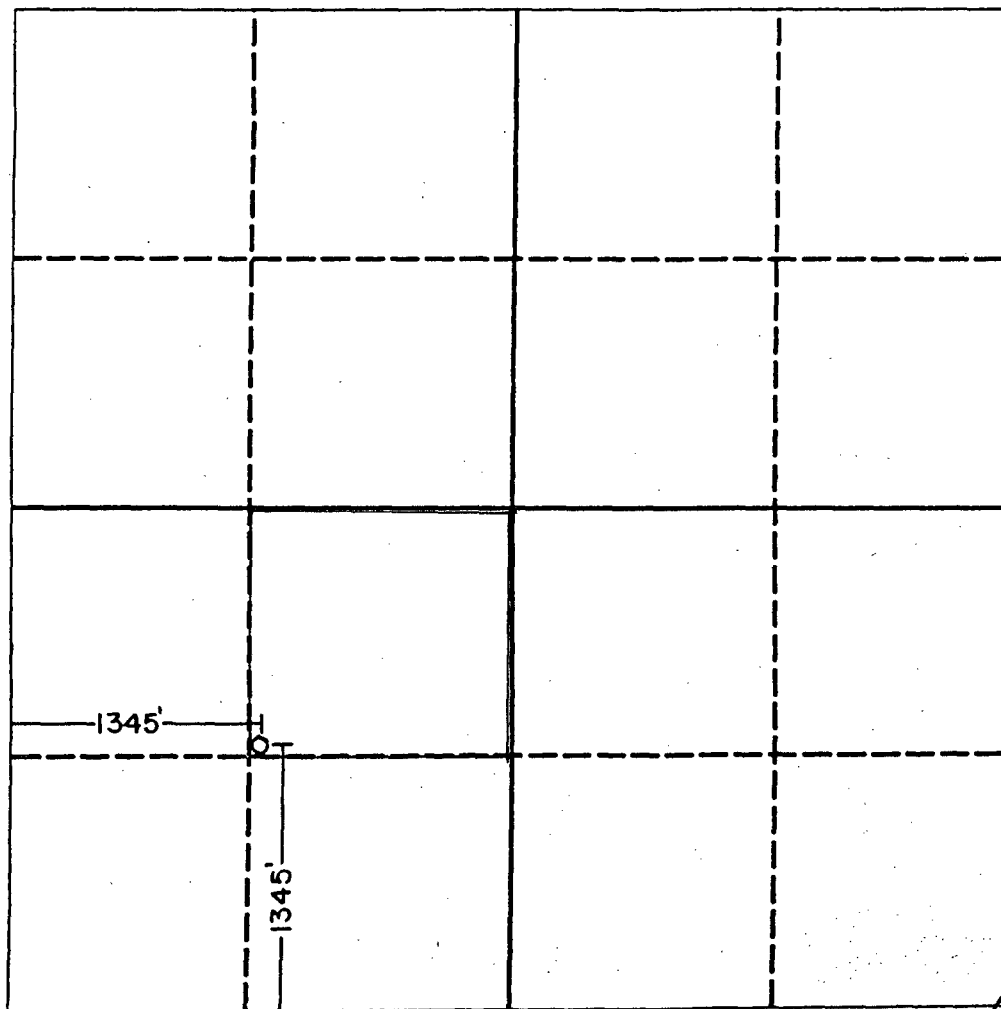

Submit to Appropriate  
District Office  
State Lease - 4 copies  
Fee Lease - 3 copies

State of New Mexico  
Energy, Minerals and Natural Resources Department

Form C-102  
Revised 1-1-89

OIL CONSERVATION DIVISION SEP 12 1991  
P.O. Box 2088  
Santa Fe, New Mexico 87504-2088

DISTRICT I  
P.O. Box 1980, Hobbs, NM 88240

DISTRICT II  
P.O. Drawer DD, Artesia, NM 88210

DISTRICT III  
1000 Rio Brazos Rd., Aztec, NM 87410

WELL LOCATION AND ACREAGE DEDICATION PLAT

All Distances must be from the outer boundaries of the section

Operator Marbob Energy Corp.			Lease G. J. West		Well No. 101
Unit Letter J	Section 21	Township 17 South	Range 29 East	County Eddy	
Actual Footage Location of Well: 2080 feet from the South line and 2615 feet from the East line					
Ground level Elev. 3596.5	Producing Formation San Andres		Pool Grbg Jackson SR Q Grbg SA		Dedicated Acreage: 40 Acres

1. Outline the acreage dedicated to the subject well by colored pencil or hatchure marks on the plat below.
2. If more than one lease is dedicated to the well, outline each and identify the ownership thereof (both as to working interest and royalty).
3. If more than one lease of different ownership is dedicated to the well, have the interest of all owners been consolidated by communitization, unitization, force-pooling, etc.?  
☐ Yes ☐ No If answer is "yes" type of consolidation \_\_\_\_\_

If answer is "no" list the owners and tract descriptions which have actually been consolidated. (Use reverse side of this form if necessary.) \_\_\_\_\_

No allowable will be assigned to the well until all interests have been consolidated (by communitization, unitization, forced-pooling, or otherwise) or until a non-standard unit, eliminating such interest, has been approved by the Division.

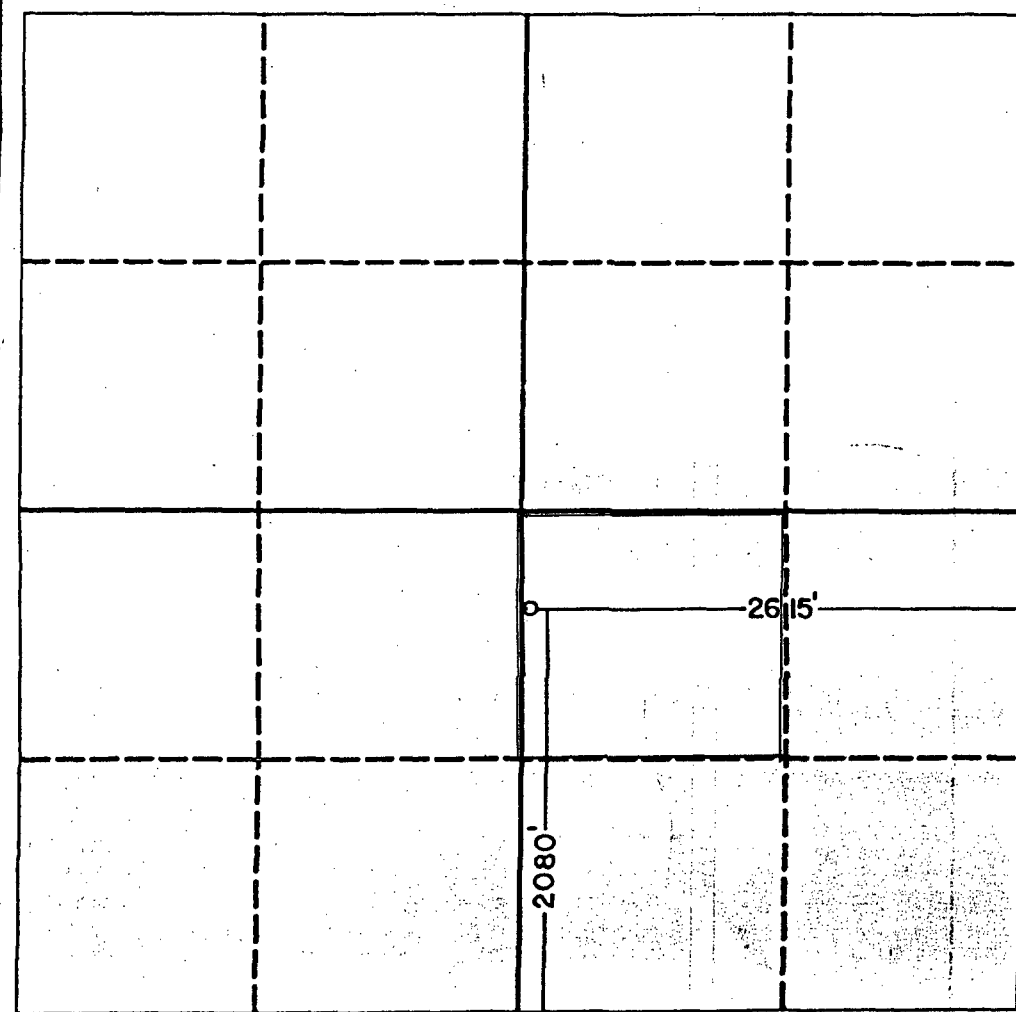

OPERATOR CERTIFICATION

I hereby certify that the information contained herein is true and complete to the best of my knowledge and belief.

Signature

Rhonda Nelson

Printed Name

Rhonda Nelson

Position

Production Clerk

Company

Marbob Energy Corporation

Date

September 12, 1991

SURVEYOR CERTIFICATION

I hereby certify that the well location shown on this plat was plotted from field notes of actual surveys made by me or under my supervision, and that the same is true and correct to the best of my knowledge and belief.

Date Surveyed

September 9, 1991

Signature & Seal of Professional Surveyor

676

Certificate No. 676

RONALD J. EIDSON,

3239

Submit to Appropriate  
District Office  
State Lease - 4 copies  
Fee Lease - 3 copies

State of New Mexico  
Energy, Minerals and Natural Resources Department

Form C-102  
Revised 1-1-89

OIL CONSERVATION DIVISION

P.O. Box 2088  
Santa Fe, New Mexico 87504-2088

SEP 12 1991

DISTRICT I  
P.O. Box 1980, Hobbs, NM 88240

DISTRICT II  
P.O. Drawer DD, Artesia, NM 88210

DISTRICT III  
1000 Rio Brazos Rd., Aztec, NM 87410

WELL LOCATION AND ACREAGE DEDICATION PLAT

All Distances must be from the outer boundaries of the section

Operator Marbob Energy Corp.			Lease G. J. West		Well No. 102
Unit Letter M	Section 21	Township 17 South	Range 29 East	County NMPM	Eddy
Actual Footage Location of Well: 25 feet from the South line and 1295 feet from the West line					
Ground level Elev. 3600.1	Producing Formation San Andres		Pool Grbg Jackson SR Q Grbg SA		Dedicated Acreage: 40 Acres

1. Outline the acreage dedicated to the subject well by colored pencil or hatchure marks on the plat below.
2. If more than one lease is dedicated to the well, outline each and identify the ownership thereof (both as to working interest and royalty).
3. If more than one lease of different ownership is dedicated to the well, have the interest of all owners been consolidated by communitization, unitization, force-pooling, etc.?  
☐ Yes ☐ No If answer is "yes" type of consolidation \_\_\_\_\_  
If answer is "no" list the owners and tract descriptions which have actually been consolidated. (Use reverse side of this form if necessary).  
No allowable will be assigned to the well until all interests have been consolidated (by communitization, unitization, forced-pooling, or otherwise) or until a non-standard unit, eliminating such interest, has been approved by the Division.

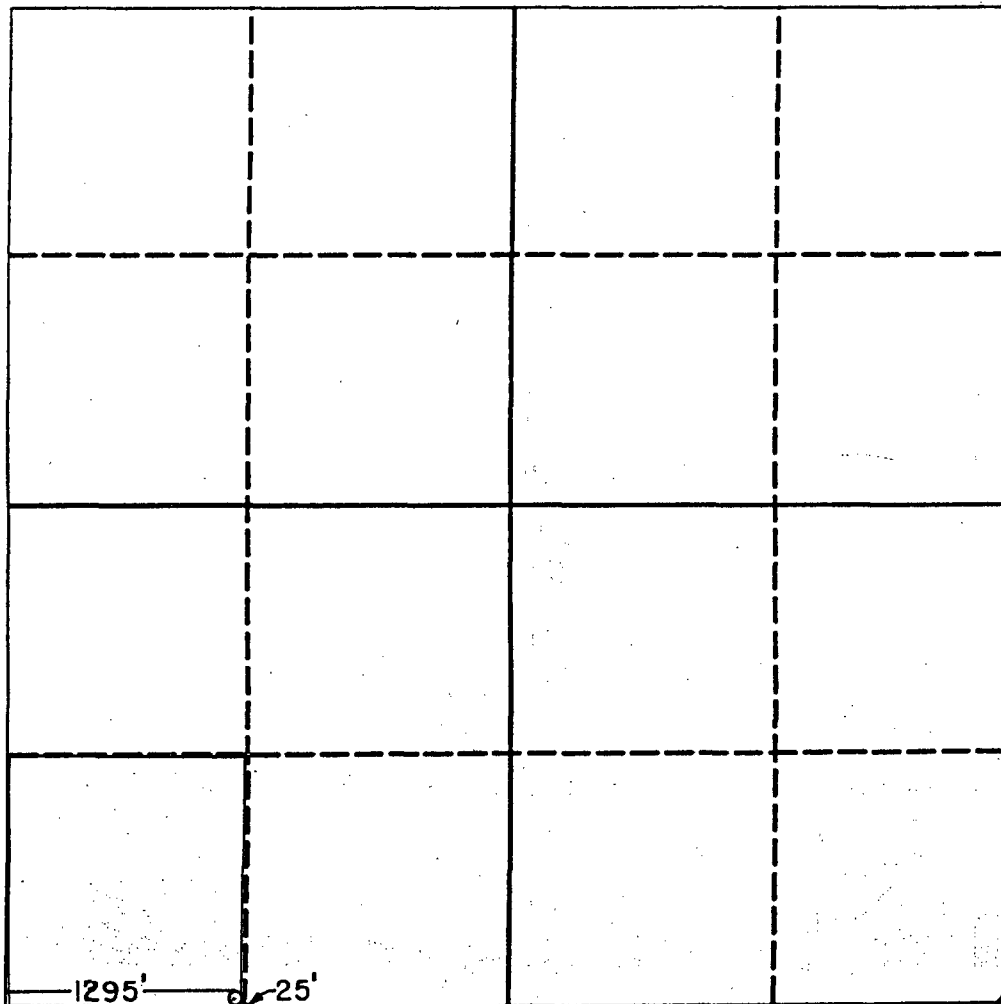

OPERATOR CERTIFICATION

I hereby certify that the information contained herein is true and complete to the best of my knowledge and belief.

Signature  
Rhonda Nelson  
Printed Name  
Rhonda Nelson  
Position  
Production Clerk  
Company  
Marbob Energy Corporation  
Date  
September 12, 1991

SURVEYOR CERTIFICATION

I hereby certify that the well location shown on this plat was plotted from field notes of actual surveys made by me or under my supervision, and that the same is true and correct to the best of my knowledge and belief.

Date Surveyed  
September 9, 1991  
Signature & Seal of Professional Surveyor  
676  
Certificate No. JOHN W. WEST, 676  
RONALD J. EIDSON, 3239



Map of the Grayburg, Texas area, showing various oil fields and wells. The map is divided into sections by a grid. Key features include:

- Grayburg, Texas** (centered in the map)
- Wells and Fields:** Numerous wells are marked with numbers and names, including Marbob, El Paso Nat'l, Tenneco, and others. Specific well names like "WELL #101" and "WELL #102" are highlighted in red.
- Oil Fields:** Labeled areas include "MARBOB (OPER.)", "WEST CO. OF UNIT", "So. Roy. S/R", and "So. Roy. (A.R.C.)".
- Geographical Features:** The map shows the intersection of major roads and the proximity to the Texas-Mexico border.
- Scale and Orientation:** A scale bar indicates distances in miles (0 to 10). A north arrow is present in the upper right corner.