



# PHILLIPS PETROLEUM COMPANY

ODESSA, TEXAS 79762  
4001 PENBROOK

EXPLORATION AND PRODUCTION GROUP  
Permian Basin Area

September 13, 1991

Unorthodox Well Location Request  
~~Burch C Fed Well No. 48~~  
Keely C Fed Well No. 62  
Eddy County, New Mexico

State of New Mexico  
Energy, Minerals and Natural Resources Department  
Oil Conservation Division  
P. O. Box 2088  
Santa Fe, New Mexico 87504

Attention: Michael Stogner  
Engineer

Gentlemen:

Phillips Petroleum Company respectfully requests administrative approval for unorthodox locations for the subject wells. Rule 104 F(1) provides administrative approval for unorthodox locations when the necessity for such unorthodox location is to permit the completion of an efficient production and injection pattern within a secondary recovery or pressure maintenance project.

The Burch C Fed Well No. 48 is to be located 1310' FSL and 2070' FEL of Section 23, T-17-South, R-29-East, Eddy County, New Mexico.

The Keely C Fed Well No. 62 is to be located 1310' FSL and 160' FEL of Section 24, T-17-South, R-29-East, Eddy County, New Mexico.

The development plan for the Burch Keely calls for infill drilling to place average well spacing on 26 acres, along with converting enough producing wells to water injection to create a staggered line drive injection pattern. The proposed unorthodox locations for the two subject wells were chosen as a means of accomplishing this development pattern as closely as possible. These proposed locations will optimize areal sweep efficiency of the two proposed wells, together with the surrounding production wells.

This project was approved under Order No. R-7900.

Unorthodox Well Location Request  
Burch C Fed Well No. 48  
Keely C Fed Well No. 62  
September 13, 1991  
Page 2

Phillips Petroleum Company is the offset operator of all proration units surrounding the proposed unorthodox locations.

Attached are Forms C-102 for both wells and a plat of the Burch Keely Waterflood area. If there are any questions or if additional information is needed, please contact me at the letterhead address or telephone (915) 368-1488.

Sincerely,



L. M. Sanders, Supervisor  
Regulation and Proration

LMS:ls  
regpro/lsand/unorth

Attachments

cc: Oil Conservation Division  
Artesia, New Mexico

Bureau of Land Management  
Carlsbad, New Mexico



# OIL CONSERVATION DIVISION

P.O. Box 2088

Santa Fe, New Mexico 87504-2088

## DISTRICT I

P.O. Box 1980, Hobbs, NM 88240

## DISTRICT II

P.O. Drawer DD, Artesia, NM 88210

## DISTRICT III

1000 Rio Brazos Rd., Aztec, NM 87410

## WELL LOCATION AND ACREAGE DEDICATION PLAT

All Distances must be from the outer boundaries of the section

Operator Phillips Petroleum Company			Lease Kelly "C"		Well No. 62
Unit Letter P	Section 24	Township 17 South	Range 29 East	County Eddy	

### Actual Footage Location of Well:

1310 feet from the South line and 160 feet from the East line

Ground level Elev. 3620.2	Producing Formation Grayburg-Jackson-7R-Q-GB-SA	Pool Grayburg-Jackson-7R-Q-GB-SA	Dedicated Acreage: 40 Acres
------------------------------	--	-------------------------------------	--------------------------------

- Outline the acreage dedicated to the subject well by colored pencil or hatchure marks on the plat below.
- If more than one lease is dedicated to the well, outline each and identify the ownership thereof (both as to working interest and royalty).
- If more than one lease of different ownership is dedicated to the well, have the interest of all owners been consolidated by communitization, unitization, force-pooling, etc.?  
☐ Yes ☐ No If answer is "yes" type of consolidation \_\_\_\_\_  
If answer is "no" list the owners and tract descriptions which have actually been consolidated. (Use reverse side of this form if necessary.)  
No allowable will be assigned to the well until all interests have been consolidated (by communitization, unitization, forced-pooling, or otherwise) or until a non-standard unit, eliminating such interest, has been approved by the Division.

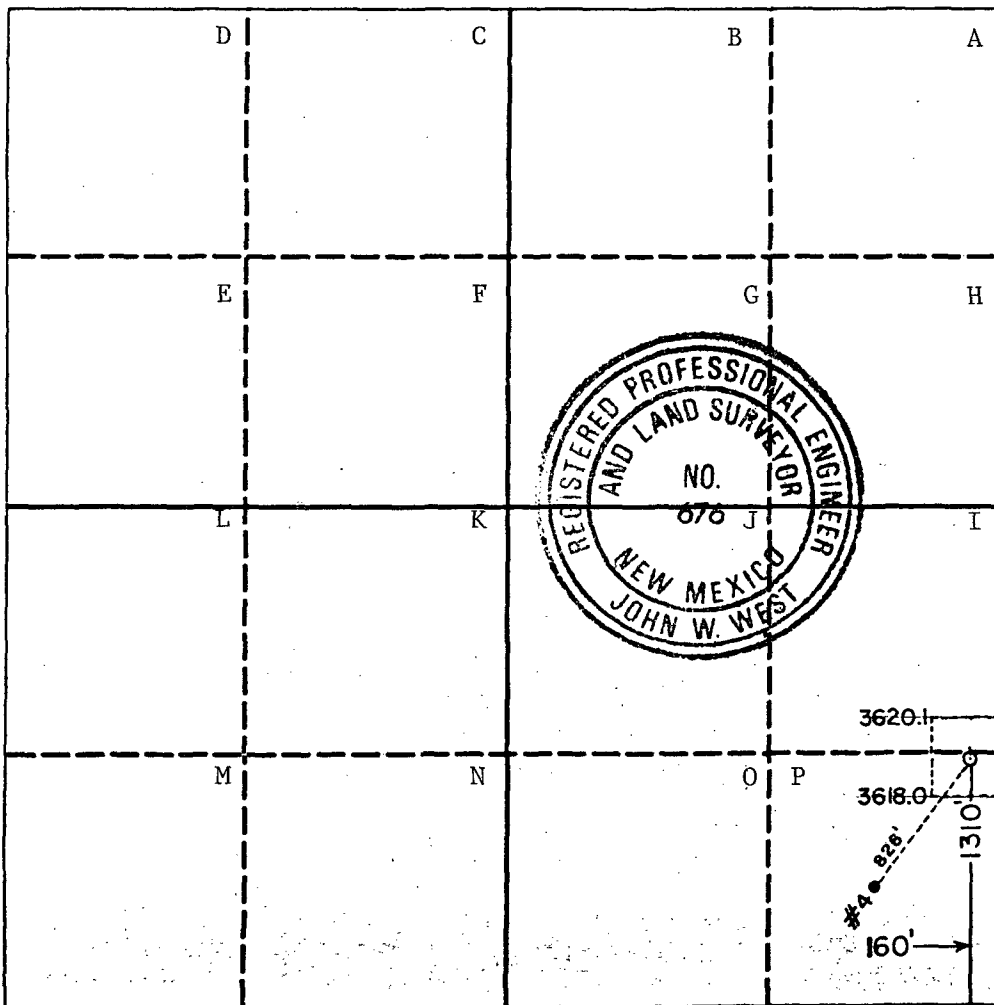

### OPERATOR CERTIFICATION

I hereby certify that the information contained herein is true and complete to the best of my knowledge and belief.

Signature  
*L. M. Sanders*  
Printed Name  
L. M. Sanders  
Position  
Supervisor,  
Regulation & Proration  
Company  
Phillips Pet. Co.  
Date  
9/16/91

### SURVEYOR CERTIFICATION

I hereby certify that the well location shown on this plat was plotted from field notes of actual surveys made by me or under my supervision, and that the same is true and correct to the best of my knowledge and belief.

Date Surveyed  
September 4, 1991  
Signature & Seal of  
Professional Surveyor

*John W. West*  
Certificate No. JOHN W. WEST, 676  
RONALD J. EIDSON, 3239

# OIL CONSERVATION DIVISION

P.O. Box 2088

Santa Fe, New Mexico 87504-2088

## DISTRICT I

P.O. Box 1980, Hobbs, NM 88240

## DISTRICT II

P.O. Drawer DD, Artesia, NM 88210

## DISTRICT III

1000 Rio Brazos Rd., Aztec, NM 87410

## WELL LOCATION AND ACREAGE DEDICATION PLAT

All Distances must be from the outer boundaries of the section

Operator Phillips Petroleum Company			Lease Burch C Federal		Well No. 48
Unit Letter 0	Section 23	Township 17 South	Range 29 East	County Eddy	

### Actual Footage Location of Well:

2070	feet from the	East	line and	1310	feet from the	South	line
Ground level Elev. 3584.6	Producing Formation Grayburg-Jackson-7R-Q-G-SA		Pool Grayburg-Jackson-7R-Q-G-SA		Dedicated Acreage: 40 Acres		

1. Outline the acreage dedicated to the subject well by colored pencil or hatchure marks on the plat below.
2. If more than one lease is dedicated to the well, outline each and identify the ownership thereof (both as to working interest and royalty).
3. If more than one lease of different ownership is dedicated to the well, have the interest of all owners been consolidated by communitization, unitization, force-pooling, etc.?  
☐ Yes ☐ No If answer is "yes" type of consolidation \_\_\_\_\_  
If answer is "no" list the owners and tract descriptions which have actually been consolidated. (Use reverse side of this form if necessary).  
No allowable will be assigned to the well until all interests have been consolidated (by communitization, unitization, forced-pooling, or otherwise) or until a non-standard unit, eliminating such interest, has been approved by the Division.

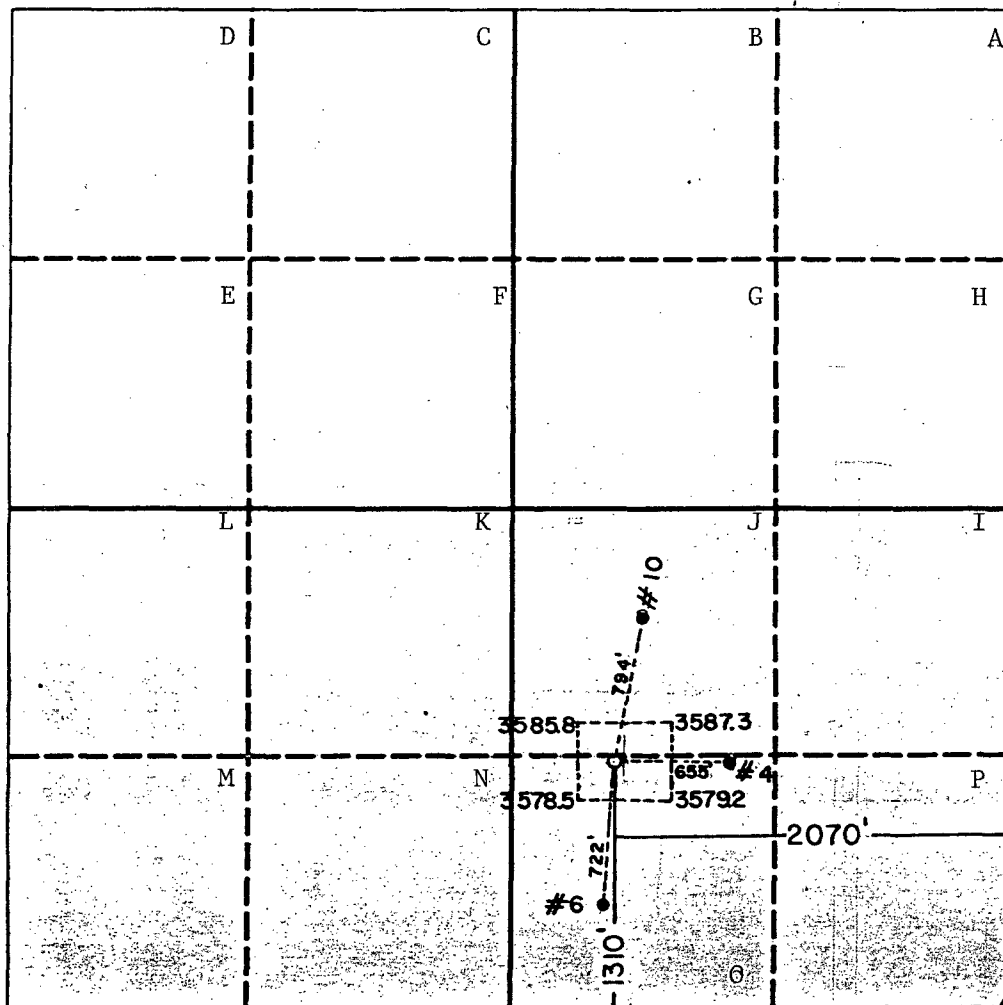

### OPERATOR CERTIFICATION

I hereby certify that the information contained herein is true and complete to the best of my knowledge and belief.

Signature

*L. M. Sanders*

Printed Name

L. M. Sanders

Position Supervisor,  
Regulation & Proration  
Company

PHILLIPS PETROLEUM CO.

Date

9/16/91

### SURVEYOR CERTIFICATION

I hereby certify that the well location shown on this plat was plotted from field notes of actual surveys made by me or under my supervision, and that the same is true and correct to the best of my knowledge and belief.

Date Surveyed

September 4, 1991

Signature & Seal of  
Professional Surveyor

*John W. West*  
Certificate No. JOHN W. WEST 676  
RONALD J. EDSON 3239  
NEW MEXICO  
JOHN W. WEST