

OIL CONSERVATION DIVISION
RECEIVED



2709 Resolana Dr.
Roswell, NM 88201

'91 OCT 29 AM 9 27 JERRY W. LONG
CONSULTANT

October 25, 1991

DIRECTOR
Department of Energy and Minerals
Oil Conservation Division
P.O. Box 2088
Santa Fe, New Mexico 87501-2088

Re: Application for Unorthodox Oil Locations
AVON ENERGY CORPORATION
Turner "B" Waterflood Project

Gentlemen:

You are respectfully requested to grant administrative approval for unorthodox locations for infill producing wells within the Turner "B" Waterflood Project, at the following locations:

No.6 Max Friess "MA" - 1270'FNL, 1460'FEL, Sec.30-17S-31E
No.7 Max Friess "MA" - 2610'FNL, 1460'FEL, Sec.30-17S-31E

These wells will be drilled to about 4900' to produce from the Grayburg-San Andres formation. The wells will be drilled at the unorthodox locations, in order to prevent waste by developing an efficient production and injection pattern within the State-approved Turner "B" Waterflood Project. Avon Energy Corporation, is drilling these wells to earn acreage from Socorro Petroleum Company, within portions of the Turner "B" Waterflood Project.

Socorro Petroleum Company is the working interest owner of all off-set pro-ration units, except the E/2NW/4 of Sec.30-17S-31E. The working interest owner and operator of the E/2NW/4 of Sec.30 is Jack Plemons, Box 25, Loco Hills, New Mexico.

Enclosed are copies of the well location plats, Application to Drill, and a map indicating lease ownership and locations of off-set Grayburg wells. The information in this request is accurate to the best of my knowledge.

A copy of this Application has been mailed to Jack Plemons and Socorro Petroleum Company, by Certified Mail, and a request for a waiver for the unorthodox locations under Rule 104.F.IV. A copy has also been sent to the Bureau of Land Management.

Sincerely yours

JERRY W. LONG
Permit Agent for:
AVON ENERGY CORPORATION

JWL/b11

UNITED STATES
DEPARTMENT OF THE INTERIOR
BUREAU OF LAND MANAGEMENT

APPLICATION FOR PERMIT TO DRILL, DEEPEN, OR PLUG BACK

1a. TYPE OF WORK

DRILL ☒

DEEPEN ☐

PLUG BACK ☐

b. TYPE OF WELL

OIL
WELL ☒

GAS
WELL ☐

OTHER IN-FILL WELL

SINGLE
ZONE ☒

MULTIPLE
ZONE ☐

2. NAME OF OPERATOR

AVON ENERGY CORPORATION

Ph.505-677-3223

3. ADDRESS OF OPERATOR

P.O. Box 38

Loco Hills, New Mexico 88255

4. LOCATION OF WELL (Report location clearly and in accordance with any State requirements.)*

At surface

1270'FNL, 1460'FEL, Sec.30-17S-31E

(UNIT B)

At proposed prod. zone

Same

(NWNE)

14. DISTANCE IN MILES AND DIRECTION FROM NEAREST TOWN OR POST OFFICE*

4.5 miles southeast of Loco Hills, New Mexico

15. DISTANCE FROM PROPOSED*

LOCATION TO NEAREST
PROPERTY OR LEASE LINE, FT.
(Also to nearest drlg. unit line, if any)

1270'

16. NO. OF ACRES IN LEASE

160

17. NO. OF ACRES ASSIGNED
TO THIS WELL

40

18. DISTANCE FROM PROPOSED LOCATION*

TO NEAREST WELL, DRILLING, COMPLETED,
OR APPLIED FOR, ON THIS LEASE, FT.

900'

19. PROPOSED DEPTH

3700'

20. ROTARY OR CABLE TOOLS

Rotary

21. ELEVATIONS (Show whether DF, RT, GR, etc.)

3592' GR

22. APPROX. DATE WORK WILL START*

As Soon As Possible

23.

PROPOSED CASING AND CEMENTING PROGRAM

SIZE OF HOLE	SIZE OF CASING	WEIGHT PER FOOT	SETTING DEPTH	QUANTITY OF CEMENT
17-1/2"	12-1/4"	42#	350'±	500 sx Class C (Circulate)
11-7/8"	8-5/8"	24#	1400'±	600 sx LW+200 sx Cl. C (Circ)
7-7/8"	5-1/2"	15.5#	3700'	250 sx LW+1000 sx Cl. C (Circ)

Propose to drill to 3700'± and complete as an in-fill non-standard Grayburg-San Andres producer in the Turner "B" Waterflood Project.

Circulate cement on above casing strings to isolate all porosity zones. Selectively perforate favorable zones. Run 2-7/8" tubing and treat formation with 15% NeFe. Sand frac formation and test to tank.

See attached Drilling data and Surface Use Plan.

IN ABOVE SPACE DESCRIBE PROPOSED PROGRAM: If proposal is to deepen or plug back, give data on present productive zone and proposed new productive zone. If proposal is to drill or deepen directionally, give pertinent data on subsurface locations and measured and true vertical depths. Give blowout preventer program, if any.

24.

SIGNED

JERRY W. LONG

TITLE Permit Agent

DATE October 10, 1991

(This space for Federal or State office use)

PERMIT NO.

APPROVAL DATE

APPROVED BY

TITLE

DATE

CONDITIONS OF APPROVAL, IF ANY:

*See Instructions On Reverse Side

Title 18 U.S.C. Section 1001, makes it a crime for any person knowingly and willfully to make to any department or agency of the United States any false, fictitious or fraudulent statements or representations as to any matter within its jurisdiction.

OIL CONSERVATION DIVISION

P.O. Box 2088

Santa Fe, New Mexico 87504-2088

DISTRICT I
P.O. Box 1980, Hobbs, NM 88240

DISTRICT II
P.O. Drawer DD, Artesia, NM 88210

DISTRICT III
1000 Rio Brazos Rd., Aztec, NM 87410

WELL LOCATION AND ACREAGE DEDICATION PLAT

All Distances must be from the outer boundaries of the section

Operator Avon Energy Corporation			Lease Max Friess "MA"		Well No. 6
Unit Letter B	Section 30	Township 17 South	Range 31 East	County Eddy	
Actual Footage Location of Well: 1270 feet from the North line and 1460 feet from the East line					
Ground level Elev. 3592	Producing Formation Grayburg-San Andres		Pool Grayburg-Jackson		Dedicated Acreage: 40 Acres

1. Outline the acreage dedicated to the subject well by colored pencil or hatchure marks on the plat below.

2. If more than one lease is dedicated to the well, outline each and identify the ownership thereof (both as to working interest and royalty).

SINGLE LEASE

3. If more than one lease of different ownership is dedicated to the well, have the interest of all owners been consolidated by communization, unitization, force-pooling, etc.?

☐ Yes

☐ No

If answer is "yes" type of consolidation **NA**

If answer is "no" list the owners and tract descriptions which have actually been consolidated. (Use reverse side of this form if necessary.)

No allowable will be assigned to the well until all interests have been consolidated (by communization, unitization, forced-pooling, or otherwise) or until a non-standard unit, eliminating such interest, has been approved by the Division.

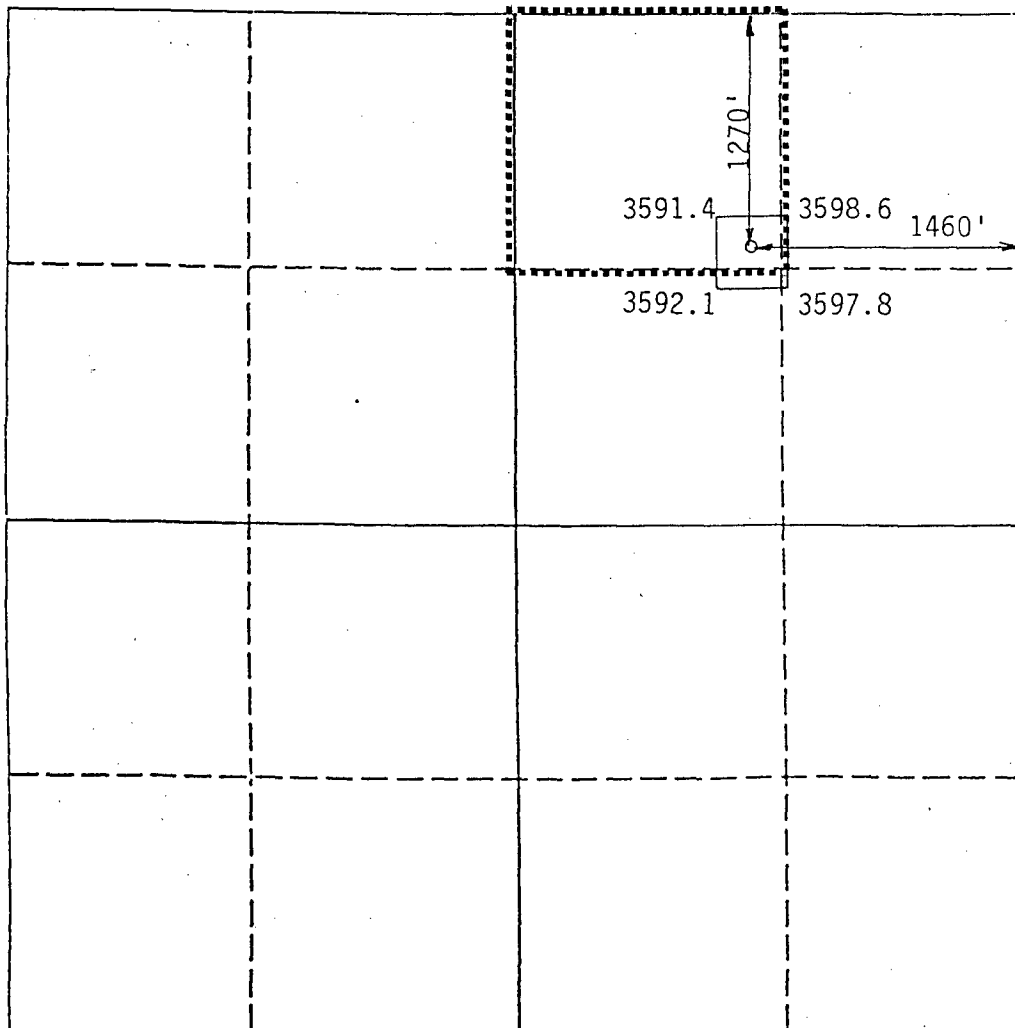

OPERATOR CERTIFICATION

I hereby certify that the information contained herein is true and complete to the best of my knowledge and belief.

Signature

Printed Name

JERRY W. LONG

Position

Permit Agent

Company

AVON ENERGY CORPORATION

Date

October 10, 1991

SURVEYOR CERTIFICATION

I hereby certify that the well location shown on this plat was plotted from field notes of actual surveys made by me or under my supervision, and that the same is true and correct to the best of my knowledge and belief.

Date Surveyed

October 4, 1991

Signature & Seal of Professional Surveyor

Certificate No.

8112

0 330 660 990 1320 1650 1980 2310 2640 2000 1500 1000 500 0

UNITED STATES
DEPARTMENT OF THE INTERIOR
BUREAU OF LAND MANAGEMENT

APPLICATION FOR PERMIT TO DRILL, DEEPEN, OR PLUG BACK

1a. TYPE OF WORK

DRILL ☒

DEEPEN ☐

PLUG BACK ☐

b. TYPE OF WELL

OIL
WELL ☒

GAS
WELL ☐

OTHER IN-FILL WELL

SINGLE
ZONE ☒

MULTIPLE
ZONE ☐

2. NAME OF OPERATOR

AVON ENERGY CORPORATION

Ph.505-677-3223

3. ADDRESS OF OPERATOR

P.O. Box 38

Loco Hills, New Mexico 88255

4. LOCATION OF WELL (Report location clearly and in accordance with any State requirements.)*
At surface

2610'FNL, 1460'FEL, Sec.30-17S-31E
At proposed prod. zone

(UNIT G)

(SWNE)

Same

14. DISTANCE IN MILES AND DIRECTION FROM NEAREST TOWN OR POST OFFICE*

4.5 miles southeast of Loco Hills, New Mexico

15. DISTANCE FROM PROPOSED*

LOCATION TO NEAREST
PROPERTY OR LEASE LINE, FT.
(Also to nearest drig. unit line, if any)

30'

16. NO. OF ACRES IN LEASE

160

17. NO. OF ACRES ASSIGNED
TO THIS WELL

40

18. DISTANCE FROM PROPOSED LOCATION*
TO NEAREST WELL, DRILLING, COMPLETED,
OR APPLIED FOR, ON THIS LEASE, FT.

900'

19. PROPOSED DEPTH

3700'

20. ROTARY OR CABLE TOOLS

Rotary

21. ELEVATIONS (Show whether DF, RT, GR, etc.)

3605' GR

22. APPROX. DATE WORK WILL START*

As Soon As Possible

23.

PROPOSED CASING AND CEMENTING PROGRAM

SIZE OF HOLE	SIZE OF CASING	WEIGHT PER FOOT	SETTING DEPTH	QUANTITY OF CEMENT
17-1/2"	12-1/4"	42#	350'±	500 sx Class C (Circulate)
11-7/8"	8-5/8"	24#	1400'±	600 sx LW+200 sx Cl. C (Circ)
7-7/8"	5-1/2"	15.5#	3700'	250 sx LW+1000 sx Cl. C (Circ)

Propose to drill to 3700'± and complete as an in-fill non-standard Grayburg-San Andres producer in the Turner "B" Waterflood Project.

Circulate cement on above casing strings to isolate all porosity zones. Selectively perforate favorable zones. Run 2-7/8" tubing and treat formation with 15% NeFe. Sand frac formation and test to tank.

See attached Drilling data and Surface Use Plan.

IN ABOVE SPACE DESCRIBE PROPOSED PROGRAM: If proposal is to deepen or plug back, give data on present productive zone and proposed new productive zone. If proposal is to drill or deepen directionally, give pertinent data on subsurface locations and measured and true vertical depths. Give blowout preventer program, if any.

24.

SIGNED

JERRY W. LONG

TITLE Permit Agent

DATE October 10, 1991

(This space for Federal or State office use)

PERMIT NO.

APPROVAL DATE

APPROVED BY

TITLE

DATE

CONDITIONS OF APPROVAL, IF ANY:

*See Instructions On Reverse Side

Title 18 U.S.C. Section 1001, makes it a crime for any person knowingly and willfully to make to any department or agency of the United States any false, fictitious or fraudulent statements or representations as to any matter within its jurisdiction.

OIL CONSERVATION DIVISION

P.O. Box 2088
Santa Fe, New Mexico 87504-2088

DISTRICT I
P.O. Box 1980, Hobbs, NM 88240

DISTRICT II
P.O. Drawer DD, Artesia, NM 88210

DISTRICT III
1000 Rio Brazos Rd., Aztec, NM 87410

WELL LOCATION AND ACREAGE DEDICATION PLAT

All Distances must be from the outer boundaries of the section

Operator Avon Energy Corporation			Lease Max Friess "MA"		Well No. 7
Unit Letter G	Section 30	Township 17 South	Range 31 East	County Eddy	
Actual Footage Location of Well: 2610 feet from the North line and 1460 feet from the East line					
Ground level Elev. 3605	Producing Formation Grayburg - San Andres		Pool Grayburg-Jackson	Dedicated Acreage: 40 Acres	

1. Outline the acreage dedicated to the subject well by colored pencil or hatchure marks on the plat below.

2. If more than one lease is dedicated to the well, outline each and identify the ownership thereof (both as to working interest and royalty):

SINGLE LEASE

3. If more than one lease of different ownership is dedicated to the well, have the interest of all owners been consolidated by communitization, unitization, force-pooling, etc.?

☐ Yes

☐ No

If answer is "yes" type of consolidation **NA**

If answer is "no" list the owners and tract descriptions which have actually been consolidated. (Use reverse side of this form if necessary.)

No allowable will be assigned to the well until all interests have been consolidated (by communitization, unitization, forced-pooling, or otherwise) or until a non-standard unit, eliminating such interest, has been approved by the Division.

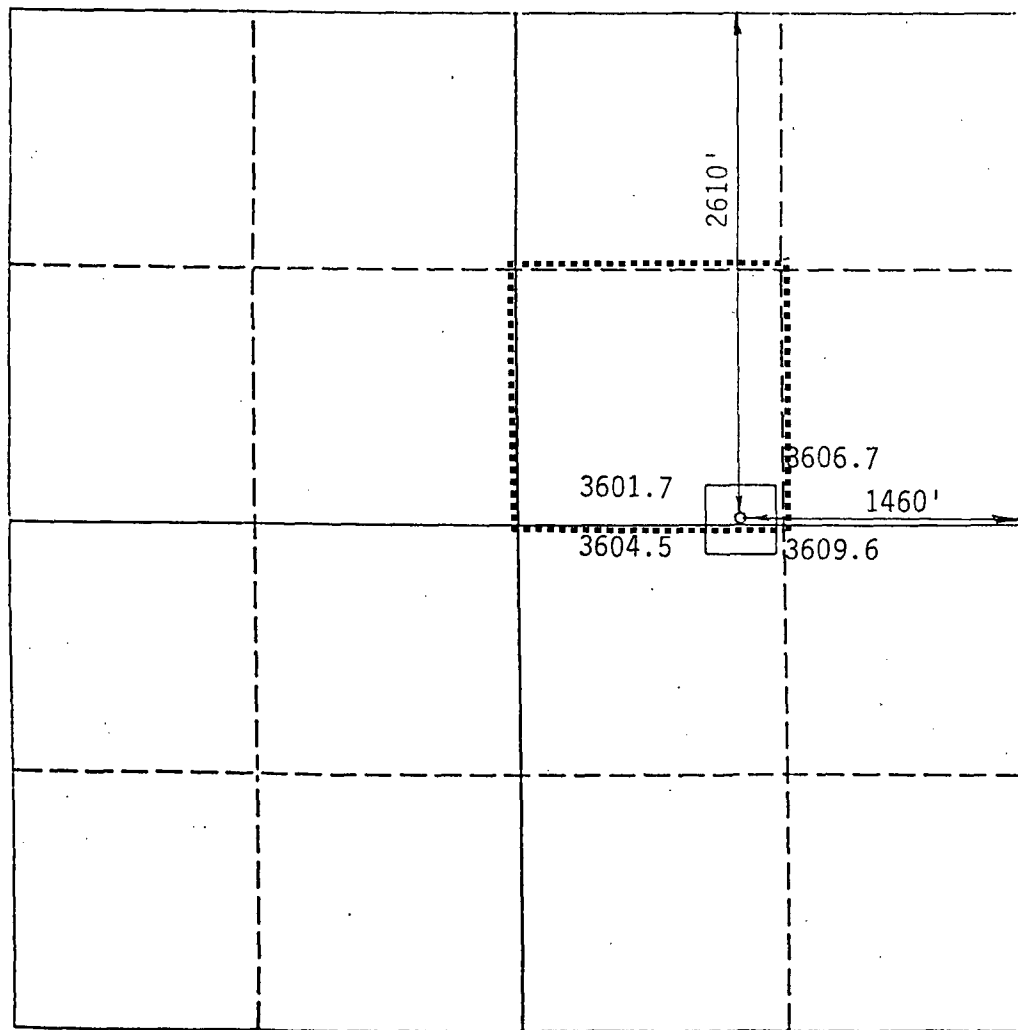

OPERATOR CERTIFICATION

I hereby certify that the information contained herein is true and complete to the best of my knowledge and belief.

Signature

Printed Name

JERRY W. LONG

Position

Permit Agent

Company

AVON ENERGY CORPORATION

Date

October 10, 1991

SURVEYOR CERTIFICATION

I hereby certify that the well location shown on this plat was plotted from field notes of actual surveys made by me or under my supervision, and that the same is true and correct to the best of my knowledge and belief.

Date Surveyed

October 4, 1991

Signature & Seal of Professional Surveyor

Certificate No.

8112

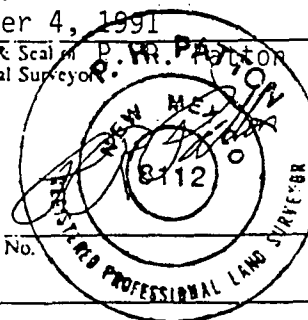

(GRAYBURG)

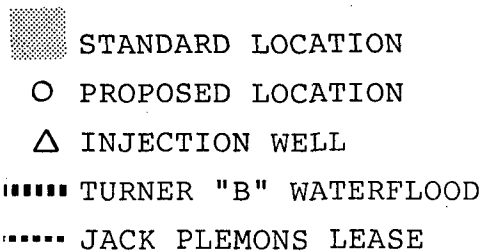

P 664 412 911

**Certified Mail Receipt**

No Insurance Coverage Provided
Do not use for International Mail
(See Reverse)

Sent to	
JACK PLEMONS	
Street & No.	
BOX 25	
P.O., State & ZIP Code	
LOCO HILLS, N.M. 88255	
Postage	\$ 52
Certified Fee	1.00
Special Delivery Fee	
Restricted Delivery Fee	
Return Receipt Showing to Whom & Date Delivered	1.00
Return Receipt Showing to Whom, Date & Address of Delivery	
TOTAL Postage & Fees	\$ 2.52
Postmark or Date	OCT 2 1991

PS Form 3800, June 1990

Fold at line over top of envelope to the right of the return address.

P 664 412 912

**Certified Mail Receipt**

No Insurance Coverage Provided
Do not use for International Mail
(See Reverse)

Sent to	
SOCORRO PETROLEUM CO.	
c/o Mr. Wyatt Fender	
Street & No.	
P.O. Drawer 3268	
P.O., State & ZIP Code	
Midland, TX 79705	
Postage	\$ 52
Certified Fee	1.00
Special Delivery Fee	
Restricted Delivery Fee	
Return Receipt Showing to Whom & Date Delivered	1.00
Return Receipt Showing to Whom, Date & Address of Delivery	
TOTAL Postage & Fees	\$ 2.52
Postmark or Date	OCT 2 1991

PS Form 3800, June 1990

Fold at line over top of envelope to the right of the return address.

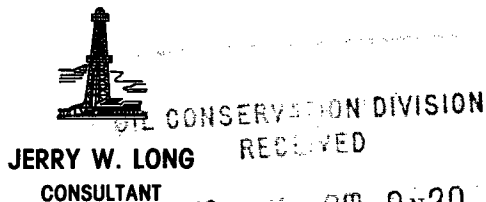

RECEIVED
NOV 4 AM 9:30
November 1, 1991

DIRECTOR
Department of Energy and Minerals
Oil Conservation Division
P.O. Box 2088
Santa Fe, New Mexico 87501-2088

Re: Application for Unorthodox Oil Locations
AVON ENERGY CORPORATION
Turner "B" Waterflood Project

Gentlemen:

You are respectfully requested to grant administrative approval for unorthodox locations for infill producing wells within the Turner "B" Waterflood Project, at the following locations:

- No.101 Turner "B" - 990'FNL, 1150'FWL, Sec.20, T.17S., R.31E.
- No.102 Turner "B" - 990'FNL, 2590'FWL, Sec.20, T.17S., R.31E.
- No.103 Turner "B" - 1300'FNL, 1370'FEL, Sec.20, T.17S., R.31E.

These wells will be drilled to about 4900' to produce from the Grayburg-San Andres formation. The wells will be drilled at the unorthodox locations, in order to prevent waste by developing an efficient production and injection pattern within the State-approved Turner "B" Waterflood Project. Avon Energy Corporation is drilling these wells to earn acreage from Socorro Petroleum Company, within portions of the Turner "B" Waterflood Project.

Enclosed are copies of the well location plats, Application to Drill, and a map indicating lease ownership and locations of off-set Grayburg wells. The information in this request is accurate to the best of my knowledge.

Socorro Petroleum Company is the working interest owner of all off-set production units. A copy of this Application has been mailed to Socorro Petroleum Company, by Certified Mail, and a request for a waiver for the unorthodox locations under Rule 104.F.IV. A copy has also been sent to the Bureau of Land Management.

Sincerely yours,

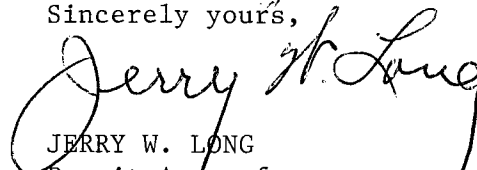
JERRY W. LONG
Permit Agent for:
AVON ENERGY CORPORATION

UNITED STATES
DEPARTMENT OF THE INTERIOR
BUREAU OF LAND MANAGEMENT

E-13

APPLICATION FOR PERMIT TO DRILL, DEEPEN, OR PLUG BACK

1a. TYPE OF WORK DRILL <input checked="" type="checkbox"/> DEEPEN <input type="checkbox"/> PLUG BACK <input type="checkbox"/>		5. LEASE DESIGNATION AND SERIAL NO. LC 029395-B
b. TYPE OF WELL OIL WELL <input checked="" type="checkbox"/> GAS WELL <input type="checkbox"/> OTHER <input type="checkbox"/> IN-FILL WELL <input type="checkbox"/> SINGLE ZONE <input checked="" type="checkbox"/> MULTIPLE ZONE <input type="checkbox"/>		6. IF INDIAN, ALLOTTEE OR TRIBE NAME ---
2. NAME OF OPERATOR AVON ENERGY CORPORATION Ph. 505-677-3223		7. UNIT AGREEMENT NAME ---
3. ADDRESS OF OPERATOR P.O. Box 38 Loco Hills, New Mexico 88255		8. FARM OR LEASE NAME Turner "B"
4. LOCATION OF WELL (Report location clearly and in accordance with any State requirements.) At surface 990' FNL 1150' FWL, Sec. 20-17S-31E (UNIT D) At proposed prod. zone Same (NWNW)		9. WELL NO. 101
14. DISTANCE IN MILES AND DIRECTION FROM NEAREST TOWN OR POST OFFICE* 5.3 air miles ENE of Loco Hills, New Mexico		10. FIELD AND POOL, OR WILDCAT Grayburg-Jackson
10. DISTANCE FROM PROPOSED* LOCATION TO NEAREST PROPERTY OR LEASE LINE, FT. (Also to nearest drlg. unit line, if any) 1150'		11. SEC., T., R., M., OR BLK. AND SURVEY OR AREA Sec. 20-17S-31E
18. DISTANCE FROM PROPOSED LOCATION* TO NEAREST WELL, DRILLING, COMPLETED, OR APPLIED FOR, ON THIS LEASE, FT. 800'±		12. COUNTY OR PARISH Eddy
21. ELEVATIONS (Show whether DF, RT, GR, etc.) 3655.6 GL.		13. STATE N.M.
16. NO. OF ACRES IN LEASE 1786.15		17. NO. OF ACRES ASSIGNED TO THIS WELL 40
19. PROPOSED DEPTH 3700'		20. ROTARY OR CABLE TOOLS Rotary
22. APPROX. DATE WORK WILL START* As Soon As Possible		

23. PROPOSED CASING AND CEMENTING PROGRAM					No Water Basin
SIZE OF HOLE	SIZE OF CASING	WEIGHT PER FOOT	SETTING DEPTH	QUANTITY OF CEMENT	
12-1/4"	8-5/8"	24.0# J-55	600'±	300 sx Class C (Circulate)	
7-7/8"	5-1/2"	15.5# K-55	3700'±	200 sx Class C + 600 sx Lite (Tie Back To 8-5/8")	

Propose to drill to about 3700' and complete as an in-fill non-standard Grayburg producer. State approval of the unorthodox location is pending. Set 5-1/2" production casing to TD, cemented with sufficient cement isolate all porosity zones. Selectively perforate favorable Grayburg zones.

Run 2-7/8" tubing to perforations and treat formation with 15% HCL. Sand-frac formation and test to tanks.

See attached Drilling Data and Surface Use Plan.

The surface grazing lessee has been advised of the proposed operation.

IN ABOVE SPACE DESCRIBE PROPOSED PROGRAM: If proposal is to deepen or plug back, give data on present productive zone and proposed new productive zone. If proposal is to drill or deepen directionally, give pertinent data on subsurface locations and measured and true vertical depths. Give blowout preventer program, if any.

24. SIGNED <u>Jerry H. Long</u> JERRY H. LONG (This space for Federal or State office use)		TITLE <u>Permit Agent</u>	DATE <u>February 12, 1991</u>
PERMIT NO. _____		APPROVAL DATE _____ Acting AREA MANAGER	DATE <u>3-26-91</u>
APPROVED BY <u>[Signature]</u> APPROVAL SUBJECT TO: GENERAL REQUIREMENTS AND SPECIAL STIPULATIONS ATTACHED		TITLE <u>CARLSBAD RESOURCE AREA</u>	

*See Instructions On Reverse Side

NOS REC'D. 1-17-91

OIL CONSERVATION DIVISION

P.O. Box 2088

Santa Fe, New Mexico 87504-2088

DISTRICT I
P.O. Box 1980, Hobbs, NM 88240

DISTRICT II
P.O. Drawer DD, Artesia, NM 88210

DISTRICT III
1000 Rio Brazos Rd., Aztec, NM 87410

WELL LOCATION AND ACREAGE DEDICATION PLAT

All Distances must be from the outer boundaries of the section

Operator Avon Energy Corporation			Lease Turner "B" Federal		Well No. 101
Unit Letter D	Section 20	Township 17 South	Range 31 East	County Eddy	
Actual Footage Location of Well: 990 feet from the North line and 1150 feet from the West line					
Ground level Elev. 3655.6		Producing Formation Grayburg		Pool Grayburg-Jackson	Dedicated Acreage: 40 Acres

- Outline the acreage dedicated to the subject well by colored pencil or hatchure marks on the plat below.
- If more than one lease is dedicated to the well, outline each and identify the ownership thereof (both as to working interest and royalty).
- If more than one lease of different ownership is dedicated to the well, have the interest of all owners been consolidated by communitization, unitization, force-pooling, etc.?
☐ Yes ☐ No If answer is "yes" type of consolidation _____
If answer is "no" list the owners and tract descriptions which have actually been consolidated. (Use reverse side of this form if necessary).
No allowable will be assigned to the well until all interests have been consolidated (by communitization, unitization, forced-pooling, or otherwise) or until a non-standard unit, eliminating such interest, has been approved by the Division.

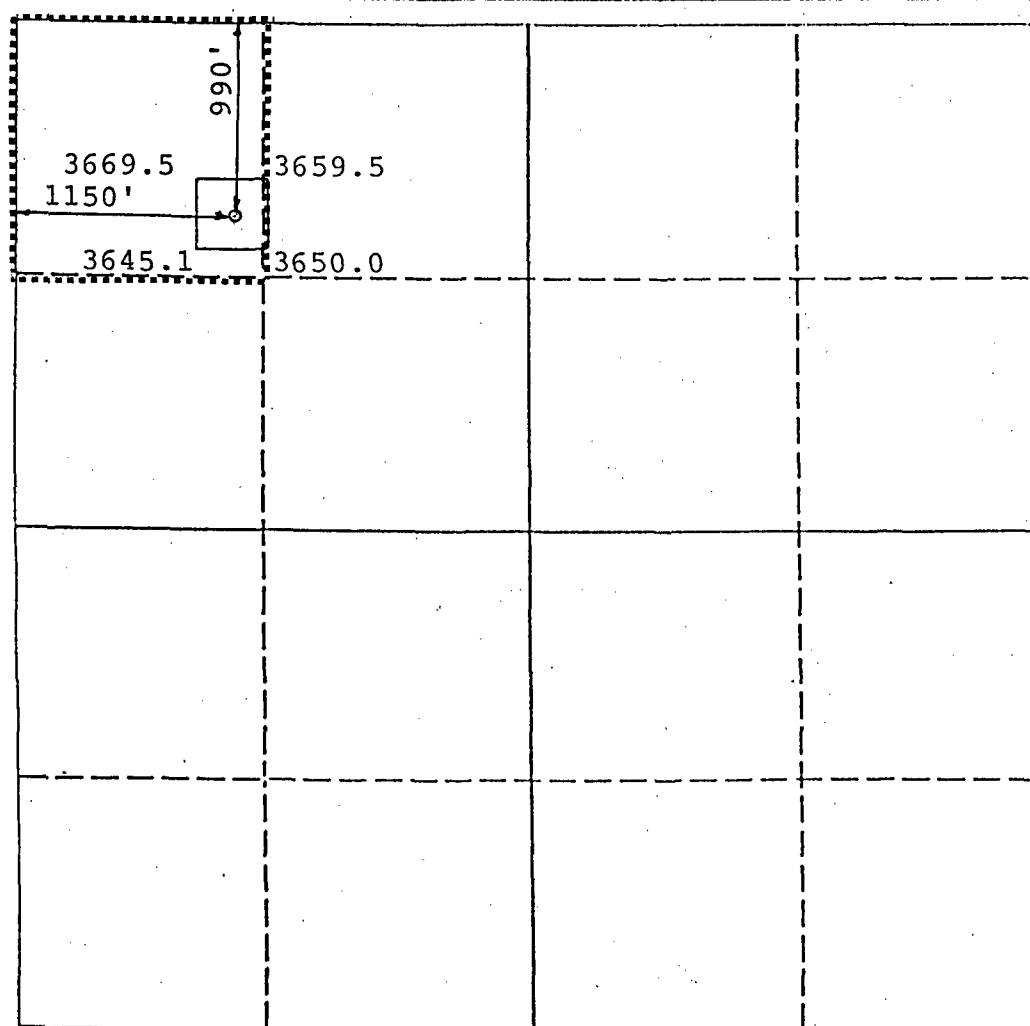

OPERATOR CERTIFICATION

I hereby certify that the information contained herein is true and complete to the best of my knowledge and belief.

Signature
Jerry W. Long
Printed Name
JERRY W. LONG

Position
Permit Agent

Company
AVON ENERGY CORPORATION

Date
February 12, 1991

SURVEYOR CERTIFICATION

I hereby certify that the well location shown on this plat was plotted from field notes of actual surveys made by me or under my supervision, and that the same is true and correct to the best of my knowledge and belief.

Date Surveyed
February 12, 1991
Signature & Seal of **P. O. Patton**
Professional Surveyor

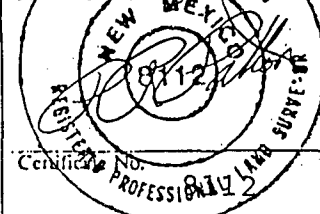

Certificate No.
8112

0 330 660 990 1320 1650 1980 2310 2640 2000 1500 1000 500 0

UNITED STATES
DEPARTMENT OF THE INTERIOR
BUREAU OF LAND MANAGEMENT

BJM CARLSBAD

Other instructions on
reverse side)

E-14

APPLICATION FOR PERMIT TO DRILL, DEEPEN, OR PLUG BACK

1a. TYPE OF WORK
DRILL ☒ DEEPEN ☐ PLUG BACK ☐

b. TYPE OF WELL
OIL WELL ☒ GAS WELL ☐ OTHER ☐ IN-FILL WELL ☐ SINGLE ZONE ☒ MULTIPLE ZONE ☐

2. NAME OF OPERATOR
Ph.505-677-3223

3. ADDRESS OF OPERATOR
AVON ENERGY CORPORATION
P.O. Box 38
Loco Hills, New Mexico 88255

4. LOCATION OF WELL (Report location clearly and in accordance with any State requirements.)*
At surface
990' FNL 2590' FWL, Sec.20 17S-31E (UNIT C)
At proposed prod. zone (NENW)
Same

14. DISTANCE IN MILES AND DIRECTION FROM NEAREST TOWN OR POST OFFICE*
5.5 air miles ENE of Loco Hills, New Mexico

15. DISTANCE FROM PROPOSED* LOCATION TO NEAREST PROPERTY OR LEASE LINE, FT. (Also to nearest drlg. unit line, if any)
2590'

18. DISTANCE FROM PROPOSED LOCATION* TO NEAREST WELL, DRILLING, COMPLETED, OR APPLIED FOR, ON THIS LEASE, FT.
750'±

21. ELEVATIONS (Show whether DF, RT, GR, etc.)
3659 GL.

23. PROPOSED CASING AND CEMENTING PROGRAM

SIZE OF HOLE	SIZE OF CASING	WEIGHT PER FOOT	SETTING DEPTH	QUANTITY OF CEMENT
12-1/4"	8-5/8"	24.0# J-55	600'±	300 sx Class C (Circulate)
7-7/8"	5-1/2"	15.5# K-55	3700'±	200 sx Class C + 600 sx Lite (Tie Back To 8-5/8")

Propose to drill to about 3700' and complete as an in-fill non-standard Grayburg producer. State approval of the unorthodox location is pending. Set 5-1/2" production casing to TD, cemented with sufficient cement to isolate all porosity zones. Selectively perforate favorable Grayburg zones.

Run 2-7/8" tubing to perforations and treat formation with 15% HCL. Sand-frac formation and test to tanks.

See attached Drilling Data and Surface Use Plan.

The surface grazing lessee has been advised of the proposed operation.

IN ABOVE SPACE DESCRIBE PROPOSED PROGRAM: If proposal is to deepen or plug back, give data on present productive zone and proposed new productive zone. If proposal is to drill or deepen directionally, give pertinent data on subsurface locations and measured and true vertical depths. Give blowout preventer program, if any.

24. SIGNED Jerry W. Long TITLE Permit Agent DATE February 12, 1991
(This space for Federal or State office use)

PERMIT NO. APPROVAL DATE
APPROVED BY TITLE DATE 3-8-91
AGENCY OF APPROVAL, IF ANY:

GENERAL REQUIREMENTS AND
SPECIAL STIPULATIONS
ATTACHED

*See Instructions On Reverse Side

NOS REC'D: 1-17-91

Title 18 U.S.C. Section 1001, makes it a crime for any person knowingly and willfully to make to any department or agency of the United States any false, fictitious or fraudulent statements or representations as to any matter within its jurisdiction.

5. LEASE DESIGNATION AND SERIAL NO.
LC 029395-B
6. IF INDIAN, ALLOTTEE OR TRIBE NAME

7. UNIT AGREEMENT NAME

8. FARM OR LEASE NAME
Turner "B"
9. WELL NO.
102
10. FIELD AND POOL, OR WILDCAT
Grayburg-Jackson
11. SEC., T., R., M., OR BLK.
AND SURVEY OR AREA
Sec.20-17S-31E
12. COUNTY OR PARISH
Eddy
13. STATE
N.M.

16. NO. OF ACRES IN LEASE
1786.15
17. NO. OF ACRES ASSIGNED TO THIS WELL
40
19. PROPOSED DEPTH
3700'
20. ROTARY OR CABLE TOOLS
Rotary
22. APPROX. DATE WORK WILL START*
As Soon As Possible

RECEIVED
FEB 15 12 22 PM '91
CARLSBAD RESOURCE
AREA HEADQUARTERS

OIL CONSERVATION DIVISION

DISTRICT
P.O. Box 1980, Hobbs, NM 88240

DISTRICT
P.O. Drawer DD, Artesia, NM 88210

DISTRICT III
1000 Rio Brazos Rd., Aztec, NM 87410

P.O. Box 2088

Santa Fe, New Mexico 87504-2088

WELL LOCATION AND ACREAGE DEDICATION PLAT

All Distances must be from the outer boundaries of the section

Operator Avon Energy Corporation		Lease Turner "B" Federal		Well No. 102
Unit Letter C	Section 20	Township 17 South	Range 31 East	County Eddy
Actual Footage Location of Well:				
990 feet from the North		line and 2590 feet from the West line		
Ground level Elev. 3659	Producing Formation Grayburg	Pool Grayburg-Jackson		Dedicated Acreage: 40 Acres

1. Outline the acreage dedicated to the subject well by colored pencil or hatchure marks on the plat below.
2. If more than one lease is dedicated to the well, outline each and identify the ownership thereof (both as to working interest and royalty).
- SINGLE LEASE**
3. If more than one lease of different ownership is dedicated to the well, have the interest of all owners been consolidated by communitization, unitization, force-pooling, etc.?
- ☐ Yes ☐ No If answer is "yes" type of consolidation _____
- If answer is "no" list the owners and tract descriptions which have actually been consolidated. (Use reverse side of this form if necessary.) _____
- No allowable well be assigned to the well until all interests have been consolidated (by communitization, unitization, forced-pooling, or otherwise) or until a non-standard unit, eliminating such interest, has been approved by the Division.

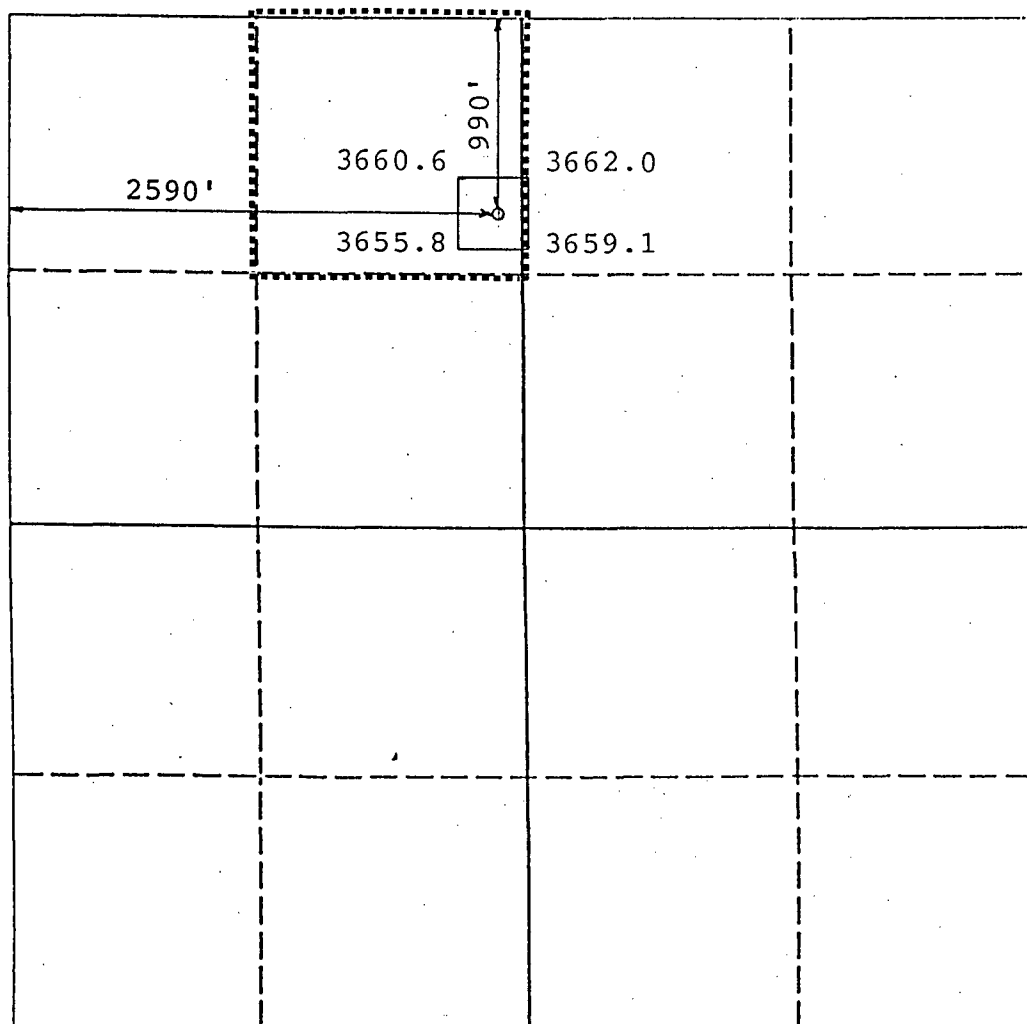

OPERATOR CERTIFICATION

I hereby certify that the information contained herein is true and complete to the best of my knowledge and belief.

Signature

Printed Name _____

JERRY W. LONG

Position

Permit Agent

Company

AVON ENERGY CORPORATION

Date _____

February 12, 1991

SURVEYOR CERTIFICATION

I hereby certify that the well location shown on this plat was plotted from field notes of actual surveys made by me or under my supervision, and that the same is true and correct to the best of my knowledge and belief.

Date Surveyed _____

February 5, 1991

Signature & Seal of P. Patton Patton

~~Certificate~~
8112

UNITED STATES
DEPARTMENT OF THE INTERIOR
BUREAU OF LAND MANAGEMENT

E-15

APPLICATION FOR PERMIT TO DRILL, DEEPEN, OR PLUG BACK

1a. TYPE OF WORK
DRILL ☒ DEEPEN ☐ PLUG BACK ☐

b. TYPE OF WELL
OIL WELL ☒ GAS WELL ☐ OTHER ☐ IN-FILL WELL ☐ SINGLE ZONE ☒ MULTIPLE ZONE ☐

2. NAME OF OPERATOR
AVON ENERGY CORPORATION Ph. 505-677-3223

3. ADDRESS OF OPERATOR
P.O. Box 38
Loco Hills, New Mexico 88255

4. LOCATION OF WELL (Report location clearly and in accordance with any State requirements.)
At surface
1370' FNL 1370' FEL, Sec. 20-17S-31E (UNIT G)
At proposed prod. zone Same (SWNE)

14. DISTANCE IN MILES AND DIRECTION FROM NEAREST TOWN OR POST OFFICE*
5.8 air miles ENE of Loco Hills, New Mexico

15. DISTANCE FROM PROPOSED* LOCATION TO NEAREST PROPERTY OR LEASE LINE, FT. (Also to nearest drlg. unit line, if any)
1370'

16. NO. OF ACRES IN LEASE
1786.15

17. NO. OF ACRES ASSIGNED TO THIS WELL
40

18. DISTANCE FROM PROPOSED LOCATION* TO NEAREST WELL, DRILLING, COMPLETED, OR APPLIED FOR, ON THIS LEASE, FT.
850'±

19. PROPOSED DEPTH
3700'

20. ROTARY OR CABLE TOOLS
Rotary

21. ELEVATIONS (Show whether DF, RT, GR, etc.)
3691' GL

22. APPROX. DATE WORK WILL START*
As Soon As Possible

PROPOSED CASING AND CEMENTING PROGRAM					No Water Basin
SIZE OF HOLE	SIZE OF CASING	WEIGHT PER FOOT	SETTING DEPTH	QUANTITY OF CEMENT	
12-1/4"	8-5/8"	24.0# J-55	600'±	300 sx Class C (Circulate)	
7-7/8"	5-1/2"	15.5# K-55	3700'±	200 sx Class C + 600 sx Lite	
					(Tie Back To 8-5/8")

Propose to drill to about 3700' and complete as an in-fill non-standard Grayburg producer. State approval of the unorthodox location is pending. ✓
Set 5-1/2" production casing to TD, cemented with sufficient cement to isolate all porosity zones. Selectively perforate favorable Grayburg zones.

Run 2-7/8" tubing to perforations and treat formation with 15% HCL.
Sand-frac formation and test to tanks.

See attached Drilling Data and Surface Use Plan.

The surface grazing lessee has been advised of the proposed operation.

IN ABOVE SPACE DESCRIBE PROPOSED PROGRAM: If proposal is to deepen or plug back, give data on present productive zone and proposed new productive zone. If proposal is to drill or deepen directionally, give pertinent data on subsurface locations and measured and true vertical depths. Give blowout preventer program, if any.

SIGNED Jerry W. Long TITLE Permit Agent DATE February 15, 1991

(This space for Federal or State office use)

PERMIT NO. APPROVAL DATE
AREA MANAGER
TITLED CARLSBAD RESOURCE AREA DATE 3-8-91

APPROVED BY Richard L. Morris
APPROVAL SUBJECT TO:
GENERAL REQUIREMENTS AND
SPECIAL STIPULATIONS

ATTACHED

*See Instructions On Reverse Side

NOSREC'D: 1-17-91

Title 18 U.S.C. Section 1001, makes it a crime for any person knowingly and willfully to make to any department or agency of the United States any false, fictitious or fraudulent statements or representations as to any matter within its jurisdiction.

RECEIVED
FEB 19 9 03 AM '91
CARLSBAD RESOURCE AREA

UNITED STATES
DEPARTMENT OF THE INTERIOR
BUREAU OF LAND MANAGEMENT

FORM APPROVED
Budget Bureau No. 1004-0135
Expires: March 31, 1993

SUNDRY NOTICES AND REPORTS ON WELLS

Do not use this form for proposals to drill or to deepen or reentry to a different reservoir.
Use "APPLICATION FOR PERMIT—" for such proposals

SUBMIT IN TRIPLICATE

1. Type of Well

☒ Oil Well ☐ Gas Well ☐ Other

2. Name of Operator

AVON ENERGY CORPORATION

3. Address and Telephone No.

P.O. Box 38

Ph. 505-677-3223

Loco Hills, New Mexico 88255

4. Location of Well (Footage, Sec., T., R., M., or Survey Description)

1300' FNL, 1370' FEL, Sec. 20-17S-31E

(UNIT B)
(NWNE)

5. Lease Designation and Serial No.

LC 029395-B

6. If Indian, Allottee or Tribe Name

7. If Unit or CA, Agreement Designation

Turner "B" Waterflood

8. Well Name and No.

Turner "B" No. 103

9. API Well No.

10. Field and Pool, or Exploratory Area

Grayburg-Jackson

11. County or Parish, State

Eddy County, N.M.

12. CHECK APPROPRIATE BOX(s) TO INDICATE NATURE OF NOTICE, REPORT, OR OTHER DATA

TYPE OF SUBMISSION

- ☒ Notice of Intent
☐ Subsequent Report
☐ Final Abandonment Notice

TYPE OF ACTION

- ☐ Abandonment
☐ Recompletion
☐ Plugging Back
☐ Casing Repair
☐ Altering Casing
☐ Other

- ☒ Change of Plans
☐ New Construction
☐ Non-Routine Fracturing
☐ Water Shut-Off
☐ Conversion to Injection
☐ Dispose Water

(Note: Report results of multiple completion on Well Completion or Recompletion Report and Log form.)

13. Describe Proposed or Completed Operations (Clearly state all pertinent details, and give pertinent dates, including estimated date of starting any proposed work. If well is directionally drilled, give subsurface locations and measured and true vertical depths for all markers and zones pertinent to this work.)*

Propose to:

1. Amend location to above footage, due to requirements of farm-out contract.
2. Change proposed depth to 4900' Grayburg-San Andres.
3. Set 5-1/2" casing to TD, with cement back to 8-5/8" casing.
4. Orient rig as in attached plat.
5. Power will be obtained from adjacent CVE line.
6. Construct 2" steel production flow line on surface to the tank battery. Routed as indicated on attached map.

ASC has conducted an Arch. review of the amended location and flow line route.

Remainder of Surface Use and Operations Plan will remain as previously approved.

SEE ASC REPORT #91-095

14. I hereby certify that the foregoing is true and correct

Signed

Jerry L. Long

Title Permit Agent

Date October 26, 1991

(This space for Federal or State office use)

Approved by

Conditions of approval, if any:

Title

Date

OIL CONSERVATION DIVISION

DISTRICT I
P.O. Box 1980, Hobbs, NM 88240

P.O. Box 2088

Santa Fe, New Mexico 87504-2088

DISTRICT II
P.O. Drawer DD, Artesia, NM 88210

DISTRICT III
1000 Rio Brazos Rd., Aztec, NM 87410

WELL LOCATION AND ACREAGE DEDICATION PLAT

All Distances must be from the outer boundaries of the section

Operator Avon Energy Corporation			Lease Turner "B" Federal		Well No. 103
Unit Letter B	Section 20	Township 17 South	Range 31 East	County Eddy	
Actual Footage Location of Well: 1300 feet from the North line and 1370 feet from the East line					
Ground level Elev. 3691	Producing Formation SR-Q-GB-SA		Pool Grayburg-Jackson		Dedicated Acreage: 40 Acres

1. Outline the acreage dedicated to the subject well by colored pencil or hatchure marks on the plat below.

2. If more than one lease is dedicated to the well, outline each and identify the ownership thereof (both as to working interest and royalty).

SINGLE LEASE

3. If more than one lease of different ownership is dedicated to the well, have the interest of all owners been consolidated by communitization, unitization, force-pooling, etc.?

☐ Yes

☐ No

If answer is "yes" type of consolidation

If answer is "no" list the owners and tract descriptions which have actually been consolidated. (Use reverse side of this form if necessary.)

No allowable will be assigned to the well until all interests have been consolidated (by communitization, unitization, forced-pooling, or otherwise) or until a non-standard unit, eliminating such interest, has been approved by the Division.

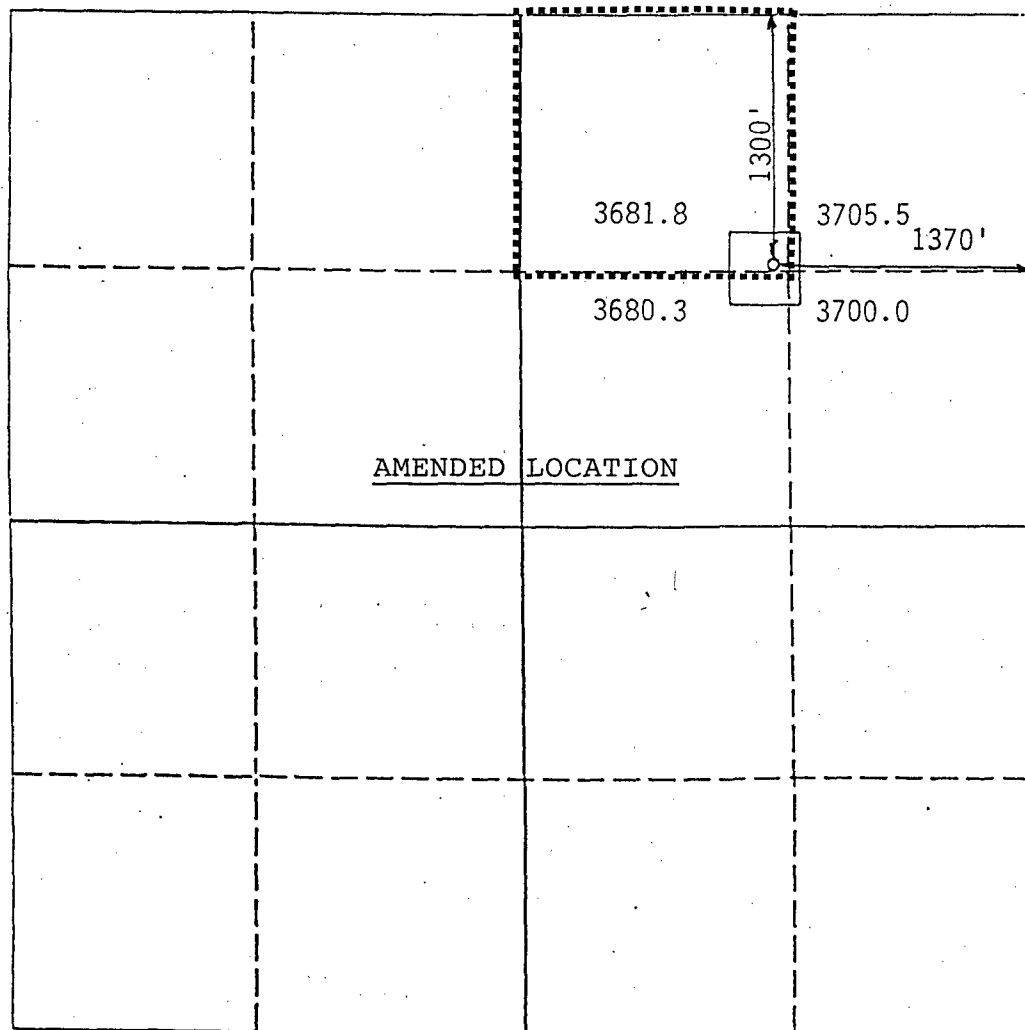

OPERATOR CERTIFICATION

I hereby certify that the information contained herein is true and complete to the best of my knowledge and belief.

Signature

Jerry W. Long

Printed Name

JERRY W. LONG

Position

Permit Agent

Company

AVON ENERGY CORPORATION

Date

October 26, 1991

SURVEYOR CERTIFICATION

I hereby certify that the well location shown on this plat was plotted from field notes of actual surveys made by me or under my supervision, and that the same is true and correct to the best of my knowledge and belief.

Date Surveyed

October 21, 1991

Signature & Seal of **P. R. Patton**
Professional Surveyor

Certificate No.

8112

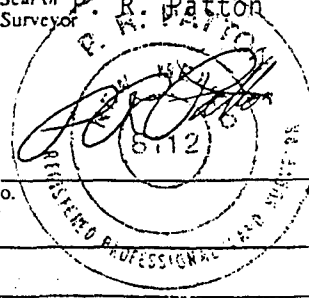

OWNERSHIP MAP
(GRAYBURG)

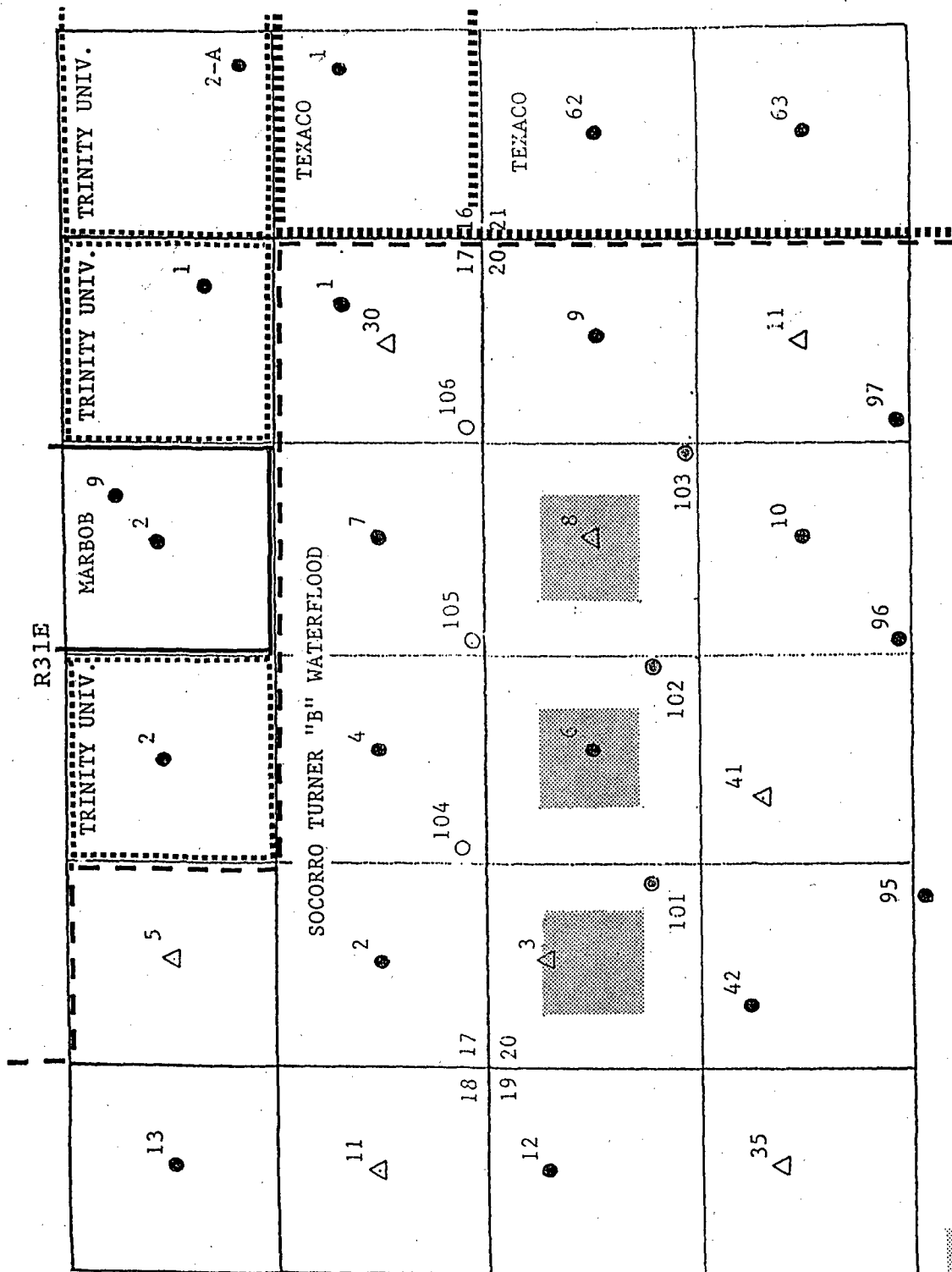

STANDARD LOCATION

PROPOSED LOCATION

P 664 412 913



Certified Mail Receipt

No Insurance Coverage Provided
Do not use for International Mail
(See Reverse)

Sent to		SOCORRO PETROLEUM CO.	
		c/o Mr. Wyatt Fender	
Street & No.			
P.O. DRAWER 3268			
P.O., State & ZIP Code			
MIDLAND, TX 79705			
Postage		\$	52
Certified Fee			1.00
Special Delivery Fee			
Restricted Delivery Fee			
Return Receipt Showing to Whom & Date Delivered			1.00
Return Receipt Showing to Whom, Date, & Address of Delivery			
TOTAL Postage & Fees		\$	2.52
Postmark or Date			
88201			

PS Form 3800 June 1990

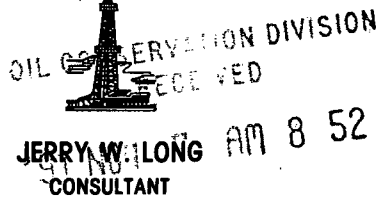

November 5, 1991

DIRECTOR
Department of Energy and Minerals
Oil Conservation Division
P.O. Box 2088
Santa Fe, New Mexico 87501-2088

Re: Application for Unorthodox Oil Locations
AVON ENERGY CORPORATION
Turner "B" Waterflood Project

Gentlemen:

You are respectfully requested to grant administrative approval for unorthodox locations for infill producing wells within the Turner "B" Waterflood Project, at the following locations:

No.104 Turner "B" - 1650'FSL, 1370'FWL, Sec.17, T.17S., R.31E.
No.105 Turner "B" - 15'FSL, 2625'FEL, Sec.17, T.17S., R.31E.
No.106 Turner "B" - 15'FSL, 1305'FEL, Sec.17, T.17S., R.31E.

These wells will be drilled to about 4900' to produce from the Grayburg-San Andres formation. The wells will be drilled at the unorthodox locations, in order to prevent waste by developing an efficient production and injection pattern within the State-approved Turner "B" Waterflood Project. Avon Energy Corporation is drilling these wells to earn acreage from Socorro Petroleum Company, within portions of the Turner "B" Waterflood Project.

Enclosed are copies of the well location plats, Application to Drill, and a map indicating lease ownership and locations of off-set Grayburg wells. The information in this request is accurate to the best of my knowledge.

Socorro Petroleum Company is the working interest owner of all off-set units within the Turner "B" Waterflood Project. Off-set working interests outside of the Project are indicated on the enclosed Ownership Map.

A copy of this Application and request for waiver has been furnished to the following, by Certified Mail:

Trinity University
c/o Ernest Closuit, Jr.
777 Taylor St., Ste. P1-B
Ft. Worth Club Tower
Ft. Worth, Texas 76102

E.M. Closuit Trust
c/o Ernest Closuit, Jr.
777 Taylor St., Ste. P1-B
Ft. Worth Club Tower
Ft. Worth, TX 76102

Marbob Energy Corporation
P.O. Box 217
Artesia, N.M. 88210

Texaco, Inc.
c/o Mr. Terry Young
P.O. Box 2100
Denver, CO 80201

Socorro Petroleum Company
c/o Mr. Wyatt Fender
P.O. Drawer 3268
Midland, TX 79705

A copy of this Application has also been furnished to the Bureau of Land Management. Please call me if you need additional information.

Sincerely yours,

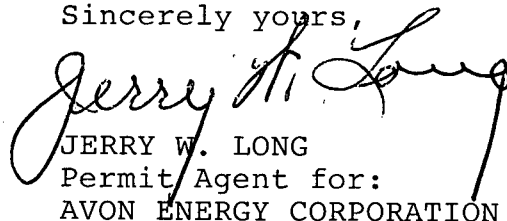

JERRY W. LONG
Permit Agent for:
AVON ENERGY CORPORATION

JWL/b11

OWNERSHIP MAP

(GRAYBURG)

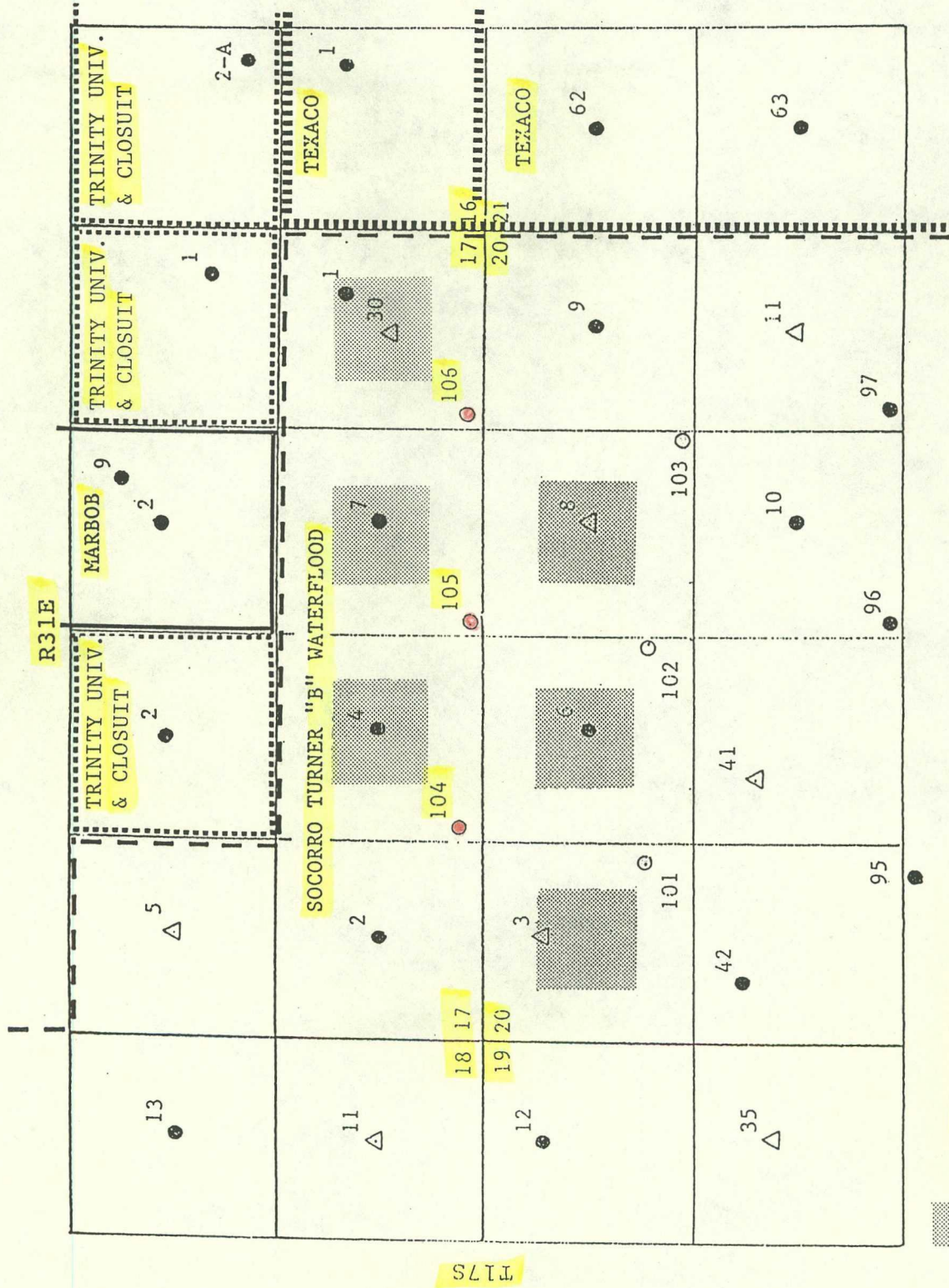

STANDARD LOCATION

PROPOSED LOCATION

UNITED STATES
DEPARTMENT OF THE INTERIOR
BUREAU OF LAND MANAGEMENT

APPLICATION FOR PERMIT TO DRILL, DEEPEN, OR PLUG BACK

1a. TYPE OF WORK

DRILL ☒

DEEPEN ☐

PLUG BACK ☐

b. TYPE OF WELL

OIL
WELL ☒

GAS
WELL ☐

OTHER IN-FILL WELL

SINGLE
ZONE ☒

MULTIPLE
ZONE ☐

2. NAME OF OPERATOR

Ph. 505-677-3223

3. ADDRESS OF OPERATOR

AVON ENERGY CORPORATION

P.O. Box 38

Loco Hills, New Mexico 88255

4. LOCATION OF WELL (Report location clearly and in accordance with any State requirements.)*

At surface

160' FSL 1370' FWL, Sec. 17-17S-31E

(UNIT N)

At proposed prod. zone

Same

(SESW)

14. DISTANCE IN MILES AND DIRECTION FROM NEAREST TOWN OR POST OFFICE*

5.3 air miles ENE of Loco Hills, New Mexico

15. DISTANCE FROM PROPOSED*

LOCATION TO NEAREST
PROPERTY OR LEASE LINE, FT.
(Also to nearest drlg. unit line, if any)

1370'

16. NO. OF ACRES IN LEASE

1786.15

17. NO. OF ACRES ASSIGNED
TO THIS WELL

40

18. DISTANCE FROM PROPOSED LOCATION*

TO NEAREST WELL, DRILLING, COMPLETED,
OR APPLIED FOR, ON THIS LEASE, FT.

750'±

19. PROPOSED DEPTH

3700'

20. ROTARY OR CABLE TOOLS

Rotary

21. ELEVATIONS (Show whether DF, RT, GR, etc.)

3672' GL.

22. APPROX. DATE WORK WILL START*

As Soon As Possible

23.

PROPOSED CASING AND CEMENTING PROGRAM

SIZE OF HOLE	SIZE OF CASING	WEIGHT PER FOOT	SETTING DEPTH	QUANTITY OF CEMENT
12-1/4"	8-5/8"	24.0# J-55	600'±	300 sx Class C (Circulate)
7-7/8"	5-1/2"	15.5# K-55	3700'±	200 sx Class C + 600 sx Lite (Tie Back To 8-5/8")

Propose to drill to about 3700' and complete as an in-fill non-standard Grayburg producer. State approval of the unorthodox location is pending. Set 5-1/2" production casing to TD, cemented with sufficient cement to isolate all porosity zones. Selectively perforate favorable Grayburg zones.

Run 2-7/8" tubing to perforations and treat formation with 15% HCL. Sand-frac formation and test to tanks.

See attached Drilling Data and Surface Use Plan.

The surface grazing lessee has been advised of the proposed operation.

IN ABOVE SPACE DESCRIBE PROPOSED PROGRAM: If proposal is to deepen or plug back, give data on present productive zone and proposed new productive zone. If proposal is to drill or deepen directionally, give pertinent data on subsurface locations and measured and true vertical depths. Give blowout preventer program, if any.

24.

SIGNED

Jerry M. Long
JERRY M. LONG

TITLE Permit Agent

DATE February 15, 1991

(This space for Federal or State office use)

PERMIT NO.

APPROVAL DATE

APPROVED BY *[Signature]*
CONDITIONS OF APPROVAL, IF ANY:

TITLE

DATE

3-29-91

*See Instructions On Reverse Side

Title 18 U.S.C. Section 1001, makes it a crime for any person knowingly and willfully to make to any department or agency of the United States any false, fictitious or fraudulent statements or representations as to any matter within its jurisdiction.

OIL CONSERVATION DIVISION

P.O. Box 2088

Santa Fe, New Mexico 87504-2088

DISTRICT I
P.O. Box 1980, Hobbs, NM 88240

DISTRICT II
P.O. Drawer DD, Artesia, NM 88210

DISTRICT III
1000 Rio Brazos Rd., Aztec, NM 87410

WELL LOCATION AND ACREAGE DEDICATION PLAT

All Distances must be from the outer boundaries of the section.

Operator Avon Energy Corporation			Lease Turner "B" Federal		Well No. 104
Unit Letter N	Section 17	Township 17 South	Range 31 East	County Eddy	
Actual Footage Location of Well: 160 feet from the South line and 1370 feet from the West line					
Ground level Elev. 3672.0	Producing Formation Grayburg	Pool Grayburg-Jackson		Dedicated Acreage: 40 Acres	

1. Outline the acreage dedicated to the subject well by colored pencil or hatchure marks on the plat below.

2. If more than one lease is dedicated to the well, outline each and identify the ownership thereof (both as to working interest and royalty).

SINGLE LEASE

3. If more than one lease of different ownership is dedicated to the well, have the interest of all owners been consolidated by communitization, unitization, force-pooling, etc.?

☐ Yes

☐ No

If answer is "yes" type of consolidation

If answer is "no" list the owners and tract descriptions which have actually been consolidated. (Use reverse side of this form if necessary.)

No allowable will be assigned to the well until all interests have been consolidated (by communitization, unitization, forced-pooling, or otherwise) or until a non-standard unit, eliminating such interest, has been approved by the Division.

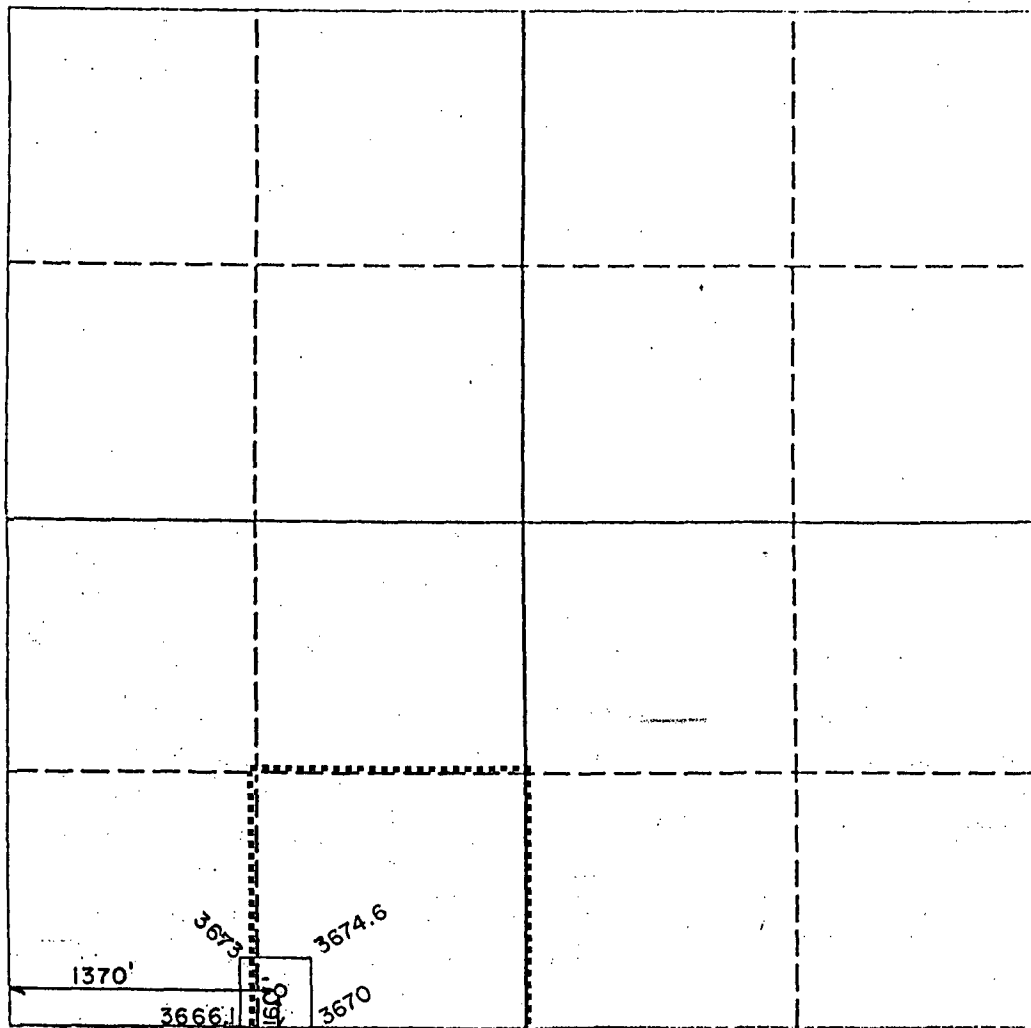

OPERATOR CERTIFICATION

I hereby certify that the information contained herein is true and complete to the best of my knowledge and belief.

Signature

Jerry W. Long
Printed Name
JERRY W. LONG

Position

Permit Agent

Company

AVON ENERGY CORPORATION

Date

February 15, 1991

SURVEYOR CERTIFICATION

I hereby certify that the well location shown on this plat was plotted from field notes of actual surveys made by me or under my supervision, and that the same is true and correct to the best of my knowledge and belief.

Date Surveyed

September 5, 1991

Signature & Seal of Professional Surveyor **R. PATTON**

Certificate No.

8112

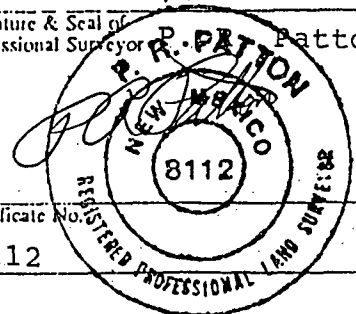

UNITED STATES
DEPARTMENT OF THE INTERIOR
BUREAU OF LAND MANAGEMENT

FORM APPROVED
Budget Bureau No. 1004-0135
Expires: March 31, 1993

SUNDRY NOTICES AND REPORTS ON WELLS

Do not use this form for proposals to drill or to deepen or reentry to a different reservoir.
Use "APPLICATION FOR PERMIT—" for such proposals

SUBMIT IN TRIPLICATE

1. Type of Well

☒ Oil Well ☐ Gas Well ☐ Other

2. Name of Operator

AVON ENERGY CORPORATION

3. Address and Telephone No.

P.O. Box 38

Ph. 505-677-3223

Loco Hills, New Mexico 88255

4. Location of Well (Footage, Sec., T., R., M., or Survey Description)

15'FSL, 2625'FEL, Sec.17-17S-31E

(UNIT O)

(SWSE)

5. Lease Designation and Serial No.

LC 029395-B

6. If Indian, Allottee or Tribe Name

7. If Unit or CA, Agreement Designation

Turner "B" Waterflood

8. Well Name and No.

Turner "B" No.105

9. API Well No.

10. Field and Pool, or Exploratory Area

Grayburg-Jackson

11. County or Parish, State

Eddy County, N.M.

12. CHECK APPROPRIATE BOX(S) TO INDICATE NATURE OF NOTICE, REPORT, OR OTHER DATA

TYPE OF SUBMISSION

- ☒ Notice of Intent
☐ Subsequent Report
☐ Final Abandonment Notice

TYPE OF ACTION

- ☐ Abandonment
☐ Recompletion
☐ Plugging Back
☐ Casing Repair
☐ Altering Casing
☐ Other

- ☒ Change of Plans
☐ New Construction
☐ Non-Routine Fracturing
☐ Water Shut-Off
☐ Conversion to Injection
☐ Dispose Water

(Note: Report results of multiple completion on Well Completion or Recompletion Report and Log form.)

13. Describe Proposed or Completed Operations (Clearly state all pertinent details, and give pertinent dates, including estimated date of starting any proposed work. If well is directionally drilled, give subsurface locations and measured and true vertical depths for all markers and zones pertinent to this work.)*

Propose to:

1. Amend location to above footage, due to requirements of farm-out contract.
2. Change proposed depth to 4900' Grayburg-San Andres.
3. Set 5-1/2" casing to TD, with cement back to 8-5/8" casing.
4. Orient rig as in attached plat.
5. Power will be obtained from adjacent CVE line.
6. Construct 2" steel production flow line on surface to the tank battery. Routed as indicated on attached map.

ASC has conducted an Arch. review of the amended location and flow line route.

Remainder of Surface Use and Operations Plan will remain as previously approved.

SEE ASC NO. 91-196

14. I hereby certify that the foregoing is true and correct

Signed Derry W. Long Title Permit Agent Date October 26, 1991

(This space for Federal or State office use)

Approved by _____ Title _____ Date _____
Conditions of approval, if any:

OIL CONSERVATION DIVISION

P.O. Box 2088

Santa Fe, New Mexico 87504-2088

DISTRICT I

P.O. Box 1980, Hobbs, NM 88240

DISTRICT II

P.O. Drawer DD, Artesia, NM 88210

DISTRICT III

1000 Rio Brazos Rd., Aztec, NM 87410

WELL LOCATION AND ACREAGE DEDICATION PLAT

All Distances must be from the outer boundaries of the section

Operator Avon Energy Corporation			Lease Turner "B" Federal		Well No. 105
Unit Letter 0	Section 17	Township 17 South	Range 31 East	County Eddy	
Actual Footage Location of Well: 15 feet from the South line and 2625 feet from the East line					
Ground level Elev. 3663	Producing Formation SR-Q-GB-SA		Pool Grayburg-Jackson	Dedicated Acreage: 40 Acres	

1. Outline the acreage dedicated to the subject well by colored pencil or hatchure marks on the plat below.

2. If more than one lease is dedicated to the well, outline each and identify the ownership thereof (both as to working interest and royalty).

SINGLE LEASE

3. If more than one lease of different ownership is dedicated to the well, have the interest of all owners been consolidated by communitization, unitization, force-pooling, etc.?

☐ Yes

☐ No

If answer is "yes" type of consolidation

If answer is "no" list the owners and tract descriptions which have actually been consolidated. (Use reverse side of this form if necessary.)

No allowable will be assigned to the well until all interests have been consolidated (by communitization, unitization, forced-pooling, or otherwise) or until a non-standard unit, eliminating such interest, has been approved by the Division.

AMENDED LOCATION

3661.4

3659.7

3667.7

3663.1

2625'

OPERATOR CERTIFICATION

I hereby certify that the information contained herein is true and complete to the best of my knowledge and belief.

Signature

Jerry W. Long

Printed Name

JERRY W. LONG

Position

Permit Agent

Company

AVON ENERGY CORPORATION

Date

October 26, 1991

SURVEYOR CERTIFICATION

I hereby certify that the well location shown on this plat was plotted from field notes of actual surveys made by me or under my supervision, and that the same is true and correct to the best of my knowledge and belief.

Date Surveyed

October 21, 1991

Signature & Seal of
Professional Surveyor

P. R. Patton
P. R. PATTON
REGISTERED PROFESSIONAL LAND SURVEYOR
NEW MEXICO

Certificate No.

8112

UNITED STATES
DEPARTMENT OF THE INTERIOR
BUREAU OF LAND MANAGEMENT

E-26

APPLICATION FOR PERMIT TO DRILL, DEEPEN, OR PLUG BACK

1a. TYPE OF WORK DRILL <input checked="" type="checkbox"/> DEEPEN <input type="checkbox"/> PLUG BACK <input type="checkbox"/>			5. LEASE DESIGNATION AND SERIAL NO. LC 029395-B		
b. TYPE OF WELL OIL WELL <input checked="" type="checkbox"/> GAS WELL <input type="checkbox"/> OTHER <input type="checkbox"/> IN-FILL WELL <input type="checkbox"/> SINGLE ZONE <input checked="" type="checkbox"/> MULTIPLE ZONE <input type="checkbox"/>			6. IF INDIAN, ALLOTTEE OR TRIBE NAME ---		
2. NAME OF OPERATOR AVON ENERGY CORPORATION Ph. 505-677-3223			7. UNIT AGREEMENT NAME ---		
3. ADDRESS OF OPERATOR P.O. Box 38 Loco Hills, New Mexico 88255			8. FARM OR LEASE NAME Turner "B"		
4. LOCATION OF WELL (Report location clearly and in accordance with any State requirements.) At surface 150' FSL 2480' FEL, Sec. 17-17S-31E (UNIT 0) At proposed prod. zone Same SEE REVISED LOCATION (SWSE)			9. WELL NO. 105		
14. DISTANCE IN MILES AND DIRECTION FROM NEAREST TOWN OR POST OFFICE* 5.5 air miles ENE of Loco Hills, New Mexico			10. FIELD AND POOL, OR WILDCAT Grayburg-Jackson		
15. DISTANCE FROM PROPOSED* LOCATION TO NEAREST PROPERTY OR LEASE LINE, FT. (Also to nearest drlg. unit line, if any) 2480'			11. SEC., T. R., M., OR BLK. AND SURVEY OR AREA Sec. 17-17S-31E		
16. NO. OF ACRES IN LEASE 1786.15			12. COUNTY OR PARISH Eddy		
17. NO. OF ACRES ASSIGNED TO THIS WELL 40			13. STATE N.M.		
18. DISTANCE FROM PROPOSED* LOCATION TO NEAREST WELL, DRILLING, COMPLETED, OR APPLIED FOR, ON THIS LEASE, FT. 725' ±			20. ROTARY OR CABLE TOOLS Rotary		
21. ELEVATIONS (Show whether DF, RT, GR, etc.) 3674' GL.			22. APPROX. DATE WORK WILL START* As Soon As Possible		

23. PROPOSED CASING AND CEMENTING PROGRAM				
SIZE OF HOLE	SIZE OF CASING	WEIGHT PER FOOT	SETTING DEPTH	QUANTITY OF CEMENT
12-1/4"	8-5/8"	24.0# J-55	600' ±	300 sx Class C (Circulate)
7-7/8"	5-1/2"	15.5# K-55	3700' ±	200 sx Class C + 600 sx Lite (Tie Back To 8-5/8")

Propose to drill to about 3700' and complete as an in-fill non-standard Grayburg producer. State approval of the unorthodox location is pending. ✓
Set 5-1/2" production casing to TD, cemented with sufficient cement to isolate all porosity zones. Selectively perforate favorable Grayburg zones. ✓

Run 2-7/8" tubing to perforations and treat formation with 15% HCL.
Sand-frac formation and test to tanks.

See attached Drilling Data and Surface Use Plan.

The surface grazing lessee has been advised of the proposed operation.

IN ABOVE SPACE DESCRIBE PROPOSED PROGRAM: If proposal is to deepen or plug back, give data on present productive zone and proposed new productive zone. If proposal is to drill or deepen directionally, give pertinent data on subsurface locations and measured and true vertical depths. Give blowout preventer program, if any.

24. SIGNED Jerry W. Long TITLE Permit Agent DATE February 18, 1991
(This space for Federal or State office use)

PERMIT NO. 4-5-91 APPROVAL DATE 4-5-91
APPROVED BY [Signature] TITLE Acting DATE 4-5-91

APPROVAL SUBJECT TO:
GENERAL REQUIREMENTS AND
SPECIAL STIPULATIONS

ATTACHED
Title 18 U.S.C. Section 1001, makes it a crime for any person knowingly and willfully to make to any department or agency of the United States any false, fictitious or fraudulent statements or representations as to any matter within its jurisdiction.

*See Instructions On Reverse Side

NOS REC'D: 1/17/91

RECEIVED

FEB 21 11 52 AM '91

UNITED STATES
DEPARTMENT OF THE INTERIOR
BUREAU OF LAND MANAGEMENT

FORM APPROVED
Budget Bureau No. 1004-0135
Expires: March 31, 1993

SUNDRY NOTICES AND REPORTS ON WELLS

Do not use this form for proposals to drill or to deepen or reentry to a different reservoir.
Use "APPLICATION FOR PERMIT" for such proposals

SUBMIT IN TRIPLICATE

1. Type of Well
☒ Oil Well ☐ Gas Well ☐ Other

2. Name of Operator

AVON ENERGY CORPORATION

3. Address and Telephone No.

P.O. Box 38

Ph. 505-677-3223

Loco Hills, New Mexico 88255

4. Location of Well (Footage, Sec., T., R., M., or Survey Description)

15'FSL, 1305'FEL, Sec.17-17S-31E

(UNIT P)

(SESE)

5. Lease Designation and Serial No.

LC 029395-B

6. If Indian, Allottee or Tribe Name

7. If Unit or CA, Agreement Designation

Turner "B" Waterflood

8. Well Name and No.

Turner "B" No.106

9. API Well No.

10. Field and Pool, or Exploratory Area

Grayburg-Jackson

11. County or Parish, State

Eddy County, N.M.

12. CHECK APPROPRIATE BOX(s) TO INDICATE NATURE OF NOTICE, REPORT, OR OTHER DATA

TYPE OF SUBMISSION

- ☒ Notice of Intent
☐ Subsequent Report
☐ Final Abandonment Notice

TYPE OF ACTION

- ☐ Abandonment
☐ Recompletion
☐ Plugging Back
☐ Casing Repair
☐ Altering Casing
☐ Other
☒ Change of Plans
☐ New Construction
☐ Non-Routine Fracturing
☐ Water Shut-Off
☐ Conversion to Injection
☐ Dispose Water

(Note: Report results of multiple completion on Well Completion or Recompletion Report and Log form.)

13. Describe Proposed or Completed Operations (Clearly state all pertinent details, and give pertinent dates, including estimated date of starting any proposed work. If well is directionally drilled, give subsurface locations and measured and true vertical depths for all markers and zones pertinent to this work.)*

Propose to:

1. Amend location to above footage, due to requirements of farm-out contract.
2. Change proposed depth to 4900' Grayburg-San Andres.
3. Set 5-1/2" casing to TD, with cement back to 8-5/8" casing.
4. Orient rig as in attached plat.
5. Power will be obtained from adjacent CVE line.
6. Construct 2" steel production flow line on surface to the tank battery. Routed as indicated on attached map.

ASC has conducted an Arch. review of the amended location and flow line route.

Remainder of Surface Use and Operations Plan will remain as previously approved.

SEE ARCH. REPORT ASC #91-197

14. I hereby certify that the foregoing is true and correct

Signed

Title Permit Agent

Date October 26, 1991

(This space for Federal or State office use)

Approved by

Title

Date

Conditions of approval, if any:

Title 18 U.S.C. Section 1001, makes it a crime for any person knowingly and willfully to make to any department or agency of the United States any false, fictitious or fraudulent statements or representations as to any matter within its jurisdiction.

*See Instruction on Reverse Side

OIL CONSERVATION DIVISION

P.O. Box 2088

Santa Fe, New Mexico 87504-2088

DISTRICT I
P.O. Box 1980, Hobbs, NM 88240

DISTRICT II
P.O. Drawer DD, Artesia, NM 88210

DISTRICT III
1000 Rio Brazos Rd., Aztec, NM 87410

WELL LOCATION AND ACREAGE DEDICATION PLAT

All Distances must be from the outer boundaries of the section

Operator Avon Energy Corporation			Lease Turner "B" Federal		Well No. 106
Unit Letter P	Section 17	Township 17 South	Range 31 East	County Eddy	
Actual Footage Location of Well: 15 feet from the South line and 1305 feet from the East line					
Ground level Elev. 3698	Producing Formation SR-Q-GB-SA		Pool Grayburg-Jackson	Dedicated Acreage: 40 Acres	

1. Outline the acreage dedicated to the subject well by colored pencil or hatchure marks on the plat below.

2. If more than one lease is dedicated to the well, outline each and identify the ownership thereof (both as to working interest and royalty).

SINGLE LEASE

3. If more than one lease of different ownership is dedicated to the well, have the interest of all owners been consolidated by communization, unitization, force-pooling, etc.?

☐ Yes

☐ No

If answer is "yes" type of consolidation

If answer is "no" list the owners and tract descriptions which have actually been consolidated. (Use reverse side of this form if necessary.)

No allowable will be assigned to the well until all interests have been consolidated (by communization, unitization, forced-pooling, or otherwise) or until a non-standard unit, eliminating such interest, has been approved by the Division.

AMENDED LOCATION

OPERATOR CERTIFICATION

I hereby certify that the information contained herein is true and complete to the best of my knowledge and belief.

Signature

Jerry W. Long
Printed Name
JERRY W. LONG

Position

Permit Agent

Company

AVON ENERGY CORPORATION

Date

October 26, 1991

SURVEYOR CERTIFICATION

I hereby certify that the well location shown on this plat was plotted from field notes of actual surveys made by me or under my supervision, and that the same is true and correct to the best of my knowledge and belief.

Date Surveyed

October 21, 1991

Signature & Seal of
Professional Surveyor

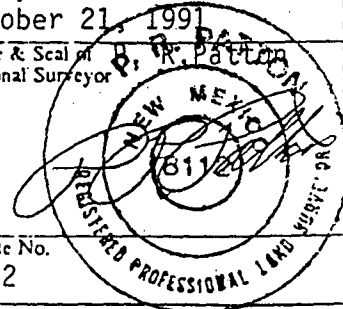

Certificate No.

8112

0 330 660 990 1320 1650 1980 2310 2640 2000 1500 1000 500 0

UNITED STATES
DEPARTMENT OF THE INTERIOR
BUREAU OF LAND MANAGEMENT

E-27

APPLICATION FOR PERMIT TO DRILL, DEEPEN, OR PLUG BACK

1a. TYPE OF WORK

DRILL ☒

DEEPEN ☐

PLUG BACK ☐

b. TYPE OF WELL

OIL WELL ☒

GAS WELL ☐

OTHER IN-FILL WELL

SINGLE ZONE ☒

MULTIPLE ZONE ☐

2. NAME OF OPERATOR

AVON ENERGY CORPORATION

Ph. 505-677-3223

3. ADDRESS OF OPERATOR

P.O. Box 38

Loco Hills, New Mexico 88255

4. LOCATION OF WELL (Report location clearly and in accordance with any State requirements.)*

At surface

160' FSL 1100' FEL, Sec. 17-17S-31E

(UNIT P)

(SESE)

At proposed prod. zone

Same

14. DISTANCE IN MILES AND DIRECTION FROM NEAREST TOWN OR POST OFFICE*

5.8 air miles ENE of Loco Hills, New Mexico

15. DISTANCE FROM PROPOSED* LOCATION TO NEAREST PROPERTY OR LEASE LINE, FT.

(Also to nearest drlg. unit line, if any)

1100'

16. NO. OF ACRES IN LEASE

1786.15

17. NO. OF ACRES ASSIGNED TO THIS WELL

40

18. DISTANCE FROM PROPOSED LOCATION* TO NEAREST WELL, DRILLING, COMPLETED, OR APPLIED FOR, ON THIS LEASE, FT.

900'±

19. PROPOSED DEPTH

3700'

20. ROTARY OR CABLE TOOLS

Rotary

21. ELEVATIONS (Show whether DF, RT, GR, etc.)

3738' GL.

22. APPROX. DATE WORK WILL START*

As Soon As Possible

23.

PROPOSED CASING AND CEMENTING PROGRAM

No Water Basin

SIZE OF HOLE	SIZE OF CASING	WEIGHT PER FOOT	SETTING DEPTH	QUANTITY OF CEMENT
12-1/4"	8-5/8"	24.0# J-55	600'±	300 sx Class C (Circulate)
7-7/8"	5-1/2"	15.5# K-55	3700'±	200 sx Class C + 600 sx Lite 4 1/2 (Tie Back To 8-5/8") casing with cement prod. string to H

Propose to drill to about 3700' and complete as an in-fill non-standard Grayburg producer. State approval of the unorthodox location is pending. Set 5-1/2" production casing to TD, cemented with sufficient cement to isolate all porosity zones. Selectively perforate favorable Grayburg zones.

Run 2-7/8" tubing to perforations and treat formation with 15% HCL. Sand-frac formation and test to tanks.

See attached Drilling Data and Surface Use Plan.

The surface grazing lessee has been advised of the proposed operations.

IN ABOVE SPACE DESCRIBE PROPOSED PROGRAM: If proposal is to deepen or plug back, give data on present productive zone and proposed new productive zone. If proposal is to drill or deepen directionally, give pertinent data on subsurface locations and measured and true vertical depths. Give blowout preventer program, if any.

24.

SIGNED

JERRY W. LONG

TITLE Permit Agent

DATE February 18, 1991

(This space for Federal or State office use)

PERMIT NO.

APPROVAL DATE

APPROVED BY

Richard L. Mann

TITLE

AREA MANAGER

CARLSBAD RESOURCE AREA

DATE

4-5-91

APPROVAL SUBJECT TO

GENERAL REQUIREMENTS AND

SPECIAL STIPULATIONS

*See Instructions On Reverse Side

NOS REC'D: 1/17/91

ATTACHED Title 18 U.S.C. Section 1001, makes it a crime for any person knowingly and willfully to make to any department or agency of the United States any false, fictitious or fraudulent statements or representations as to any matter within its jurisdiction.

P 664 412 916

**Certified Mail Receipt**No Insurance Coverage Provided
Do not use for International Mail
(See Reverse)

Sent to	
MARBOB ENERGY CORPORATION	
Street & No.	
P.O. BOX 217	
P.O., State & ZIP Code	
ARTESIA, N.M. 88210	
Postage	\$.52
Certified Fee	1.00
Special Delivery Fee	
Restricted Delivery Fee	
Return Receipt Showing to Whom & Date Delivered	1.00
Return Receipt Showing to Whom, Date, & Address of Delivery	
TOTAL Postage & Fees	\$ 2.52
Postmark or Date	
88201	

PS Form 3800, June 1990

P 664 412 914

**Certified Mail Receipt**No Insurance Coverage Provided
Do not use for International Mail
(See Reverse)

Sent to	
SOCORRO PETROLEUM CO.	
c/o Mr. Wyatt Fender	
Street & No.	
P.O. DRAWER 3268	
P.O., State & ZIP Code	
MIDLAND, TX 79705	
Postage	\$.52
Certified Fee	1.00
Special Delivery Fee	
Restricted Delivery Fee	
Return Receipt Showing to Whom & Date Delivered	1.00
Return Receipt Showing to Whom, Date, & Address of Delivery	
TOTAL Postage & Fees	\$ 2.52
Postmark or Date	
88201	

PS Form 3800, June 1990

P 664 412 917

**Certified Mail Receipt**No Insurance Coverage Provided
Do not use for International Mail
(See Reverse)

Sent to	
E.M. Closuit Trust	
c/o Ernest Closuit, Jr.	
Street & No. 777 Taylor St. Ste. P1-B	
Ft. Worth Club Tower	
P.O., State & ZIP Code	
Ft. Worth, TX 76102	
Postage	\$.52
Certified Fee	1.00
Special Delivery Fee	
Restricted Delivery Fee	
Return Receipt Showing to Whom & Date Delivered	1.00
Return Receipt Showing to Whom, Date, & Address of Delivery	
TOTAL Postage & Fees	\$ 2.52
Postmark or Date	
88201	

PS Form 3800, June 1990

P 664 412 915

**Certified Mail Receipt**No Insurance Coverage Provided
Do not use for International Mail
(See Reverse)

Sent to	
TEXACO, INC.	
c/o Mr. Terry Young	
Street & No.	
P.O. BOX 2100	
P.O., State & ZIP Code	
Denver, CO 80201	
Postage	\$.52
Certified Fee	1.00
Special Delivery Fee	
Restricted Delivery Fee	
Return Receipt Showing to Whom & Date Delivered	1.00
Return Receipt Showing to Whom, Date, & Address of Delivery	
TOTAL Postage & Fees	\$ 2.52
Postmark or Date	
88201	

PS Form 3800, June 1990

P 664 412 918

**Certified Mail Receipt**No Insurance Coverage Provided
Do not use for International Mail
(See Reverse)

Sent to	
TRINITY UNIVERSITY	
c/o Ernest Closuit, Jr.	
Street & No. 777 Taylor St. Ste. P1-B	
Ft. Worth Club Tower	
P.O., State & ZIP Code	
Ft. Worth, TX 76102	
Postage	\$.52
Certified Fee	1.00
Special Delivery Fee	
Restricted Delivery Fee	
Return Receipt Showing to Whom & Date Delivered	1.00
Return Receipt Showing to Whom, Date, & Address of Delivery	
TOTAL Postage & Fees	\$ 2.52
Postmark or Date	
88201	

PS Form 3800, June 1990



JERRY W. LONG
CONSULTANT

November 9, 1991

DIRECTOR
Department of Energy and Minerals
Oil Conservation Division
P.O. Box 2088
Santa Fe, New Mexico 87501-2088

Re: Application for Unorthodox Oil Locations
AVON ENERGY CORPORATION
Turner "B" Waterflood Project
No.6 and No.7 Max Friess "MA"
Eddy County, New Mexico

Gentlemen:

Enclosed are copies of "Waiver of Objection" to referenced Application. The waivers have been executed by Jack Plemons and Socorro Petroleum Company, owners of off-set mineral interests.

Please send a copy of your approval to me at the letterhead address.

Sincerely,

A handwritten signature in cursive script that reads "Jerry W. Long". The signature is written in dark ink and is positioned above the typed name.

JERRY W. LONG
Permit Agent for:
AVON ENERGY CORPORATION

JWL/bl1



JERRY W. LONG
CONSULTANT

2709 Resolana Dr.
Roswell, NM 88201

October 25, 1991

Jack Plemons
Box 25
Loco Hills, New Mexico 88255

Re: Waiver of Objection to Unorthodox Locations
AVON ENERGY CORPORATION
No.6 and No.7 Max Friess "MA"

Dear Mr. Plemons:

Enclosed is a copy of referenced Application which requests NMOCD approval of two unorthodox locations.

If you offer no objection to the Application, we would appreciate your execution of a waiver to objection in the space below. Return two executed copies to me in the enclosed envelope and retain one copy for your records.

We would appreciate a timely response to this request.

Sincerely yours,

JERRY W. LONG
Permit Agent for:
AVON ENERGY CORPORATION

JWL/bl1

The undersigned has no objection to the Application for an unorthodox location for referenced wells.

JACK PLEMONS

11-2 91
Date



JERRY W. LONG
CONSULTANT

October 25, 1991

SOCORRO PETROLEUM COMPANY
c/o Mr. Wyatt Fender
P.O. Drawer 3268
Midland, Texas 79705

Re: Waiver of Objection to Unorthodox Locations
AVON ENERGY CORPORATION
No.6 and No.7 Max Friess "MA"

Gentlemen:

Enclosed is a copy of referenced Application which requests NMOCD approval of two unorthodox locations.

If you offer no objection to the Application, we would appreciate your execution of a waiver to objection in the space below. Return two executed copies to me in the enclosed envelope and retain one copy for your records.

We would appreciate a timely response to this request.

Sincerely yours,

A large, stylized handwritten signature of Jerry W. Long in black ink.

JERRY W. LONG
Permit Agent for:
AVON ENERGY CORPORATION

JWL/bl1

The undersigned has no objection to the Application for an unorthodox location for referenced wells.

SOCORRO PETROLEUM COMPANY

by: A handwritten signature of Wyatt Fender in black ink, written over a horizontal line.

Date: A handwritten date '10-28-91' in black ink, written over a horizontal line.

OIL CONSERVATION DIVISION
RECEIVED



'91 DEC 12 AM 8:30
JERRY W. LONG
CONSULTANT

December 9, 1991

NSL-3079

DIRECTOR
Department of Energy and Minerals
Oil Conservation Division
P.O. Box 2088
Santa Fe, New Mexico 87501-2088

Re: Application for Unorthodox Oil Locations
AVON ENERGY CORPORATION
Turner "B" Waterflood Project
Well Nos. 101, 102, 103, 104, 105, and 106 Turner "B"
Well Nos. 6 and 7 Max Friess "MA"

Gentlemen:

I have today received a copy of Administration Order NSL-3079, approving the non-standard locations and transfer of dedicated acreage into the AVON ENERGY CORPORATION Turner "B" Grayburg-Jackson Waterflood Project for referenced wells.

Enclosed are executed copies of Waiver of Objection from Trinity University and Texaco, Inc. to complete your file for the Application dated November 5, 1991.

We appreciate your assistance in this waterflood project.

Sincerely yours,

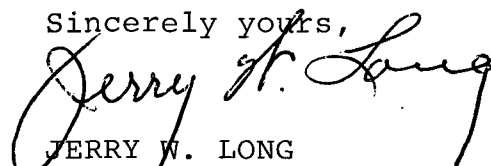

JERRY W. LONG
Permit Agent for:
AVON ENERGY CORPORATION

1c: Avon Energy Corporation
410. 17th St., Ste.430
Denver, CO 80202

1c: Avon Energy Corporation
P.O. Box 38
Loco Hills, N.M. 88255



JERRY W. LONG
CONSULTANT

November 5, 1991

TRINITY UNIVERSITY
c/o Ernest Closuit, Jr.
777 Taylor St., Ste. Pl-B
Ft. Worth Club Tower
Ft. Worth, TX 76102

Re: Waiver of Objection to Unorthodox Locations
AVON ENERGY CORPORATION
Nos. 104, 105 and 106 Turner "B"

Gentlemen:

Enclosed is a copy of referenced Application which requests NMOCD approval of three unorthodox locations.

If you offer no objection to the Application, we would appreciate your execution of a waiver to objection in the space below. Return two executed copies to me in the enclosed envelope and retain one copy for your records.

We would appreciate a timely response to this request.

Sincerely yours,

JERRY W. LONG
Permit Agent for:
AVON ENERGY CORPORATION

JWL/bll

The undersigned has no objection to the Application for an unorthodox location for referenced wells.

TRINITY UNIVERSITY

by

Date: December 4, 1991



JERRY W. LONG
CONSULTANT

2709 Resolana Dr.
Roswell, NM 88201

717344 (FPI)
November 5, 1991

TEXACO, INC.
c/o Mr. Terry Young
P.O. Box 2100
Denver, CO 80201

Re: Waiver of Objection to Unorthodox Locations
AVON ENERGY CORPORATION
Nos. 104, 105 and 106 Turner "B"

Gentlemen:

Enclosed is a copy of referenced Application which requests NMOCD approval of three unorthodox locations.

If you offer no objection to the Application, we would appreciate your execution of a waiver to objection in the space below. Return two executed copies to me in the enclosed envelope and retain one copy for your records.

We would appreciate a timely response to this request.

Sincerely yours,

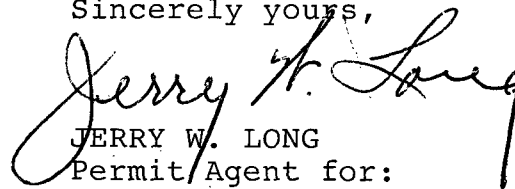
JERRY W. LONG
Permit Agent for:
AVON ENERGY CORPORATION

JWL/bl1

The undersigned has no objection to the Application for an unorthodox location for referenced wells.

TEXACO, INC.

by: 

Date: 11/26/91



JERRY W. LONG
CONSULTANT

November 1, 1991

SOCORRO PETROLEUM COMPANY
c/o Mr. Wyatt Fender
P.O. Drawer 3268
Midland, Texas 79705

Re: Waiver of Objection to Unorthodox Locations
AVON ENERGY CORPORATION
Nos. 101, 102 and 103 Turner "B"

Gentlemen:

Enclosed is a copy of referenced Application which requests NMOCD approval of three unorthodox locations.

If you offer no objection to the Application, we would appreciate your execution of a waiver to objection in the space below. Return two executed copies to me in the enclosed envelope and retain one copy for your records.

We would appreciate a timely response to this request.

Sincerely yours,

JERRY W. LONG
Permit Agent for:
AVON ENERGY CORPORATION

JWL/bl1

The undersigned has no objection to the Application for an unorthodox location for referenced wells.

SOCORRO PETROLEUM COMPANY

by: Wyatt Fender

Date: 11/5/91

OIL CONSERVATION DIVISION
RECEIVED

'91 DEC 2 AM 10 02



JERRY W. LONG
CONSULTANT

2709 Resolana Dr.
Roswell, NM 88201

November 26, 1991

DIRECTOR
Department of Energy and Minerals
Oil Conservation Division
P.O. Box 2088
Santa Fe, New Mexico 87501-2088

Re: Application for Unorthodox Oil Locations
AVON ENERGY CORPORATION
Turner "B" Waterflood Project
Well Nos. 104, 105, and 106 Turner "B"

Gentlemen:

It has come to my attention that the Application, dated November 5, 1991, has a typographical error in the footage location of the No. 104 Turner "B" well.

Please correct the Application to indicate that the No. 104 Turner "B" well is located 160'FSL, 1370'FWL of Sec.17, T.17S., R.31E. The map was correct as submitted.

As of today, I have obtained waivers from all off-set operators, except Texaco, Inc. and Trinity University. Mr. Harold Herndon has advised me by telephone that he will furnish a waiver for Trinity University.

Enclosed are two copies of waivers which I have received.

Sincerely yours,

JERRY W. LONG
Permit Agent for:
AVON ENERGY CORPORATION

JWL/bl1



JERRY W. LONG
CONSULTANT

November 5, 1991

E.M. Closuit Trust
c/o Ernest Closuit, Jr.
777 Taylor St., Ste. P1-B
Ft. Worth Club Tower
Ft. Worth, TX 76102

Re: Waiver of Objection to Unorthodox Locations
AVON ENERGY CORPORATION
Nos. 104, 105 and 106 Turner "B"

Gentlemen:

Enclosed is a copy of referenced Application which requests NMOCD approval of three unorthodox locations.

If you offer no objection to the Application, we would appreciate your execution of a waiver to objection in the space below. Return two executed copies to me in the enclosed envelope and retain one copy for your records.

We would appreciate a timely response to this request.

Sincerely yours,

JERRY W. LONG
Permit Agent for:
AVON ENERGY CORPORATION

JWL/bl1

The undersigned has no objection to the Application for an unorthodox location for referenced wells.

E.M. Closuit Trust

by:

Jeanne Closuit Long

Date: 11/12/91



JERRY W. LONG
CONSULTANT

NOV 07 1991

2709 Resolana Dr.
Roswell, NM 88201

November 5, 1991

MARBOB ENERGY CORPORATION
P.O. Box 217
Artesia, New Mexico 88210

Re: Waiver of Objection to Unorthodox Locations
AVON ENERGY CORPORATION
Nos. 104, 105 and 106 Turner "B"

Gentlemen:

Enclosed is a copy of referenced Application which requests NMOCD approval of three unorthodox locations.

If you offer no objection to the Application, we would appreciate your execution of a waiver to objection in the space below. Return two executed copies to me in the enclosed envelope and retain one copy for your records.

We would appreciate a timely response to this request.

Sincerely yours,

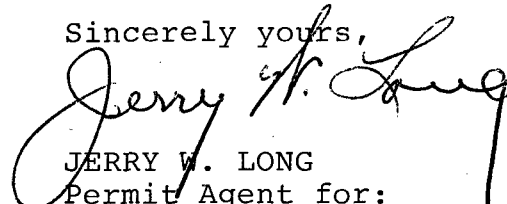
JERRY W. LONG
Permit Agent for:
AVON ENERGY CORPORATION

JWL/b11

The undersigned has no objection to the Application for an unorthodox location for referenced wells.

MARBOB ENERGY CORPORATION

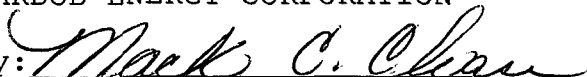
by: 

Date: Nov. 11, 1991



JERRY W. LONG
CONSULTANT

November 5, 1991

SOCORRO PETROLEUM COMPANY
c/o Mr. Wyatt Fender
P.O. Drawer 3268
Midland, Texas 79705

Re: Waiver of Objection to Unorthodox Locations
AVON ENERGY CORPORATION
Nos. 104, 105 and 106 Turner "B"

Gentlemen:

Enclosed is a copy of referenced Application which requests NMOCD approval of three unorthodox locations.

If you offer no objection to the Application, we would appreciate your execution of a waiver to objection in the space below. Return two executed copies to me in the enclosed envelope and retain one copy for your records.

We would appreciate a timely response to this request.

Sincerely yours,

A handwritten signature in cursive script, reading "Jerry W. Long".

JERRY W. LONG
Permit Agent for:
AVON ENERGY CORPORATION

JWL/bl1

The undersigned has no objection to the Application for an unorthodox location for referenced wells.

SOCORRO PETROLEUM COMPANY

by: Wyatt Fender

Date: 11/7/91

● **SENDER:** Complete items 1 and 2 when additional services are desired, and complete items 3 and 4.

Put your address in the "RETURN TO" Space on the reverse side. Failure to do this will prevent this card from being returned to you. The return receipt fee will provide you the name of the person delivered to and the date of delivery. For additional fees the following services are available. Consult postmaster for fees and check box(es) for additional service(s) requested.

1. ☐ Show to whom delivered, date, and addressee's address. 2. ☐ Restricted Delivery
(Extra charge) (Extra charge)

3. Article Addressed to:

TRINITY UNIVERSITY
c/o Ernest Closuit, Jr.
777 Taylor St., Ste. Pl-B
Ft. Worth, TX 76102

4. Article Number

P 664 412 918

Type of Service:

- ☐ Registered ☐ Insured
☒ Certified ☐ COD
☐ Express Mail ☐ Return Receipt
for Merchandise

Always obtain signature of addressee
or agent and **DATE DELIVERED**.

5. Signature — Addressee

X

6. Signature — Agent

X

7. Date of Delivery

NOV 12 1991

8. Addressee's Address (ONLY if
requested and fee paid)

PS Form 3811, Apr. 1989

★ U.S.G.P.O. 1989-238-815

DOMESTIC RETURN RECEIPT

● **SENDER:** Complete items 1 and 2 when additional services are desired, and complete items 3 and 4.

Put your address in the "RETURN TO" Space on the reverse side. Failure to do this will prevent this card from being returned to you. The return receipt fee will provide you the name of the person delivered to and the date of delivery. For additional fees the following services are available. Consult postmaster for fees and check box(es) for additional service(s) requested.

1. ☐ Show to whom delivered, date, and addressee's address. 2. ☐ Restricted Delivery
(Extra charge) (Extra charge)

3. Article Addressed to:

TEXACO, INC.
c/o Mr. Terry Young
P.O. BOX 2100
DENVER, CO 80201

4. Article Number

P 664 412 915

Type of Service:

- ☐ Registered ☐ Insured
☒ Certified ☐ COD
☐ Express Mail ☐ Return Receipt
for Merchandise

Always obtain signature of addressee
or agent and **DATE DELIVERED**.

5. Signature — Addressee

X

6. Signature — Agent

X

7. Date of Delivery

11-12-91

8. Addressee's Address (ONLY if
requested and fee paid)

PS Form 3811, Apr. 1989

★ U.S.G.P.O. 1989-238-815

DOMESTIC RETURN RECEIPT