

ENRON
Oil & Gas Company

P. O. Box 2267 Midland, Texas 79702 (915) 686-3600

February 12, 1992

New Mexico Oil Conservation Commission
P. O. Box 2088
Santa Fe, New Mexico 87501
(505) 827-5800

Re: Cedar Lake 35 Federal Com, Well No. 1
Section 35, T17S, R30E
Eddy County, New Mexico

Gentlemen:

Due to a pipeline that crosses the Northeast corner of the above-named lease, Enron Oil & Gas Company has to apply for an unorthodox location as shown on the attached Application for Permit to Drill and Plat.

Enclosed are three (3) copies of Form 3160-3 and plat which will be submitted to the Bureau of Land Management in Carlsbad, New Mexico. Also enclosed is a map which shows the location of all offset operators, and where applicable the mineral interest owners all of which were were notified of our request for unorthodox location via certified mail on February 11, 1992.

If you have any questions, or need additional information, please let me know.

Very truly yours,

ENRON OIL & GAS COMPANY



Betty Gildon
Regulatory Analyst

enclosures

bg

UNITED STATES
DEPARTMENT OF THE INTERIOR
BUREAU OF LAND MANAGEMENT

APPLICATION FOR PERMIT TO DRILL, DEEPEN, OR PLUG BACK

1a. TYPE OF WORK

DRILL ☒

DEEPEN ☐

PLUG BACK ☐

b. TYPE OF WELL

OIL
WELL ☐

GAS
WELL ☒

OTHER

SINGLE
ZONE ☒

MULTIPLE
ZONE ☐

2. NAME OF OPERATOR

Enron Oil & Gas Company

3. ADDRESS OF OPERATOR

P. O. Box 2267, Midland, Texas 79702

4. LOCATION OF WELL (Report location clearly and in accordance with any State requirements.*)

At surface

1240' FNL & 1980' FEL

At proposed prod. zone

1240' FNL & 1980' FEL

14. DISTANCE IN MILES AND DIRECTION FROM NEAREST TOWN OR POST OFFICE*

2 miles SW from Loco Hills

15. DISTANCE FROM PROPOSED*

LOCATION TO NEAREST
PROPERTY OR LEASE LINE, FT.
(Also to nearest drlg. unit line, if any)

1240

16. NO. OF ACRES IN LEASE

320

17. NO. OF ACRES ASSIGNED
TO THIS WELL

320

18. DISTANCE FROM PROPOSED LOCATION*
TO NEAREST WELL, DRILLING, COMPLETED,
OR APPLIED FOR, ON THIS LEASE, FT.

None

19. PROPOSED DEPTH

12,500'

20. ROTARY OR CABLE TOOLS

Rotary

21. ELEVATIONS (Show whether DF, RT, GR, etc.)

3548.1' GL

22. APPROX. DATE WORK WILL START*

Before April 1, 1992

23.

PROPOSED CASING AND CEMENTING PROGRAM

SIZE OF HOLE	SIZE OF CASING	WEIGHT PER FOOT	SETTING DEPTH	QUANTITY OF CEMENT
17-1/2	13-3/8	48	600	515 sacks circulated
11	8-5/8	32	4500	1475 sacks circulated
7-7/8	5-1/2	15.5 & 17	12500	525 sacks

BOP - Install at 4500' with 3000# cap. and 2450# annular preventer.

Will use standard Surface Controlled BOP installation.

Acreage is dedicated.

IN ABOVE SPACE DESCRIBE PROPOSED PROGRAM: If proposal is to deepen or plug back, give data on present productive zone and proposed new productive zone. If proposal is to drill or deepen directionally, give pertinent data on subsurface locations and measured and true vertical depths. Give blowout preventer program, if any.

24.

SIGNED

Betty Gordon
Betty Gordon

TITLE Regulatory Analyst

DATE 2/11/92

(This space for Federal or State office use)

PERMIT NO.

APPROVAL DATE

APPROVED BY

TITLE

DATE

CONDITIONS OF APPROVAL, IF ANY:

*See Instructions On Reverse Side

Title 18 U.S.C. Section 1001, makes it a crime for any person knowingly and willfully to make to any department or agency of the United States any false, fictitious or fraudulent statements or representations as to any matter within its jurisdiction.

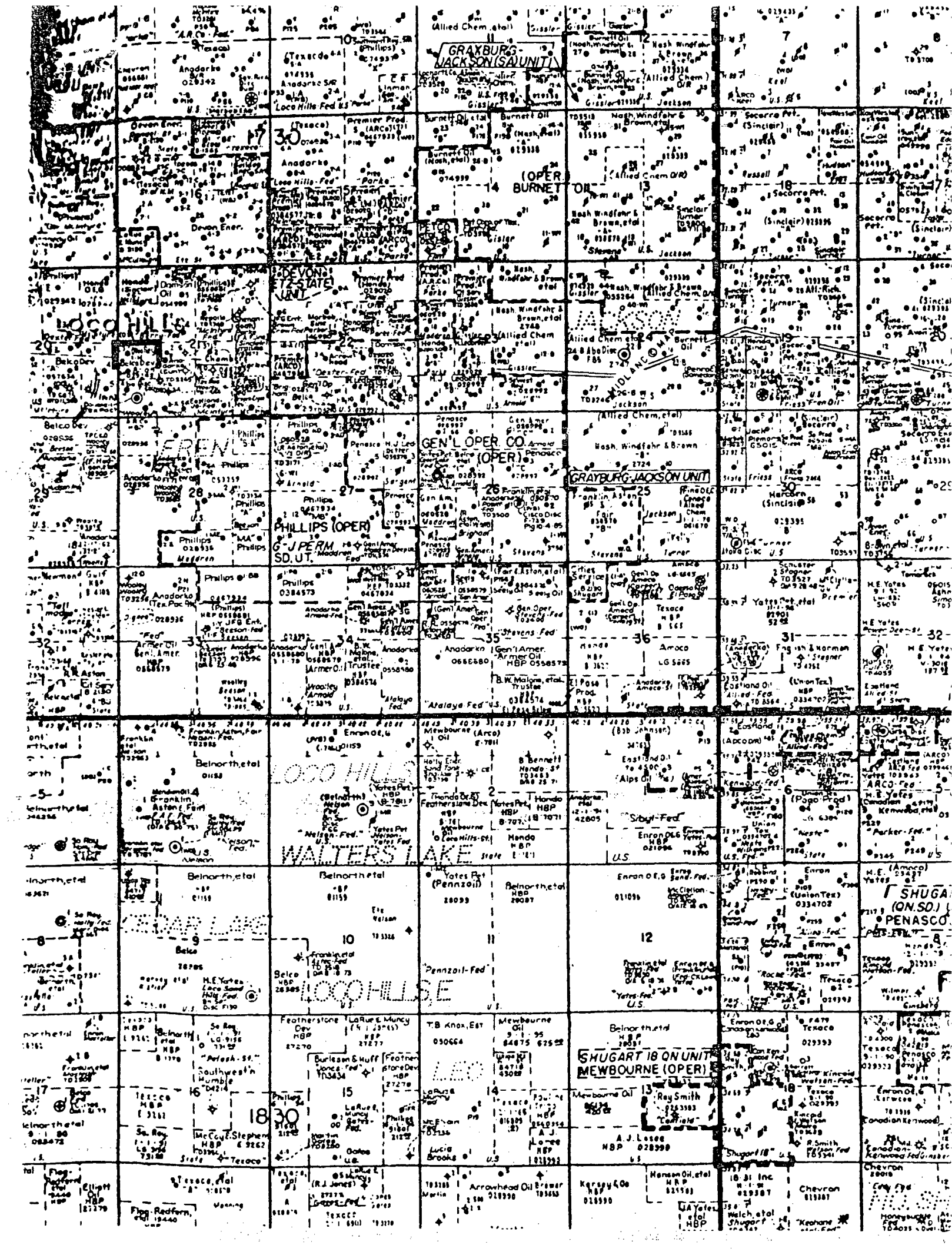

ENRON
Oil & Gas Company

RECEIVED

CONSERVATION DIVISION
RECEIVED

FEB 13 1992

BAND SECTION
PHILLIPS PETROLEUM CO.
ODESSA, TEXAS

P. O. Box 2267 Midland, Texas 79702 (915) 686-3600

February 11, 1992

Phillips Petroleum Company
4001 Penbrook
Odessa, Texas 79762
Attn: Mr. Jim Carlton

Arco Oil & Gas Company
P. O. Box 1610
Midland, Texas 79702
Attn: Mr. Padrick Pinkney

Weller Energy, Inc.
P. O. Box 1388
E. Orleans, MA 02643
Attn: Mr. Frank Weller

Oxy USA, Inc.
P. O. Box 50250
Midland, Texas 79710
Attn: Mr. Pat McGee

Anadarko Petroleum Corp
P. O. Box 2497
400 W. Illinois, Ste 1300
Midland, Texas 79702
Attn: Mr. Mike Goode

Yates Petroleum
105 South 4th
Artesia, NM 88210
Attn: Mr. Randy Patterson

Re: Cedar Lake 35 Federal Com., Well No. 1, Section 35, T17S, R30E
Eddy County, New Mexico

Gentlemen:

Enron Oil & Gas Company has applied to the New Mexico Oil Conservation Division in Santa Fe, New Mexico for an unorthodox location for the above-named well as per the attached Application for Permit to Drill and location plat. If you, as offset operator, have no objection to this special permit, please sign in the space provided below, and return to my attention in the enclosed envelope.

Your early attention is appreciated.

Very truly yours,

ENRON OIL & GAS COMPANY

Betty Gildon

Betty Gildon
Regulatory Analyst

DATE: 2/19/92 COMPANY: Phillips Petroleum Co. BY: *D. R. Wier* D. R. Wier

Res. Eng. & Regulatory Affairs
Director

Enclosures: Form 3160-3 with plat
Return Stamped Envelope

bg

ENRON
Oil & Gas Company

RECEIVED

FEB 13 1992

P. O. Box 2267 Midland, Texas 79702 (915) 686-3600

MIDLAND LAND

February 11, 1992

Phillips Petroleum Company
4001 Penbrook
Odessa, Texas 79762
Attn: Mr. Jim Carlton

Arco Oil & Gas Company
P. O. Box 1610
Midland, Texas 79702
Attn: Mr. Padrick Pinkney

Weller Energy, Inc.
P. O. Box 1388
E. Orleans, MA 02643
Attn: Mr. Frank Weller

Oxy USA, Inc.
P. O. Box 50250
Midland, Texas 79710
Attn: Mr. Pat McGee

Anadarko Petroleum Corp
P. O. Box 2497
400 W. Illinois, Ste 1300
Midland, Texas 79702
Attn: Mr. Mike Goode

Yates Petroleum
105 South 4th
Artesia, NM 88210
Attn: Mr. Randy Patterson

Re: Cedar Lake 35 Federal Com., Well No. 1, Section 35, T17S, R30E
Eddy County, New Mexico

Gentlemen:

Enron Oil & Gas Company has applied to the New Mexico Oil Conservation Division in Santa Fe, New Mexico for an unorthodox location for the above-named well as per the attached Application for Permit to Drill and location plat. If you, as offset operator, have no objection to this special permit, please sign in the space provided below, and return to my attention in the enclosed envelope.

Your early attention is appreciated.

Very truly yours,

ENRON OIL & GAS COMPANY

Betty Gildon

Betty Gildon
Regulatory Analyst

DATE: 2-13-92 COMPANY: ANADARKO PETROLEUM BY: *Mike R. Goode*
CORPORATION

Enclosures: Form 3160-3 with plat
Return Stamped Envelope

bg

ENRON

Oil & Gas Company

P. O. Box 2267 Midland, Texas 79702 (915) 686-3600

February 11, 1992

Richard L. Ray,
Richard L. Ray, Trustee
Fair Oil, LTd.
225 S. College
Box 689
Tyler, Texas 75710

Lincoln Aston
P. O. Box 3048
LaJolla, Calif 92038

Rogers Aston
P. O. Box 1090
Roswell, NM 88202

Rogers Aston and
NCNB Texas National Bank as Co-Trustees
of the "C" Trusts U/W/O Bert Aston
P. O. Box 830308
Dallas, Texas 75283-0308

Sunwest Bank of Albuquerque as Ancillary
Personal Representative of the
Charles Albert Aston, Jr. Estate
P. O. Box 26900
Albuquerque, NM 87125

Sharon A. Olsen, Trustee Under Declaration of
Trust created by Sharon Aston Olsen, Trustor
P. O. Box 7296
Leguna Niguel, Calif. 92607-7296

Re: Cedar Lake 35 Federal Com., Well No. 1, Section 35, T17S, R30E
Eddy County, New Mexico

Gentlemen:

Enron Oil & Gas Company has applied to the New Mexico Oil Conservation Division in Santa Fe, New Mexico for an unorthodox location for the above-named well as per the attached Application for Permit to Drill and location plat. If you, as mineral interest owner in offsetting Sections 25 and/or 26, have no objection to this application, please sign in the space provided below, and return to my attention in the enclosed envelope.

Your early attention is appreciated.

Very truly yours,

ENRON OIL & GAS COMPANY



Betty Gildon
Regulatory Analyst

DATE:

2-20-92

SIGNATURE:

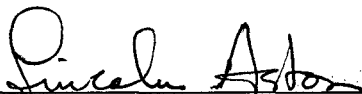

bg

ENRON

Oil & Gas Company

P. O. Box 2267 Midland, Texas 79702 (915) 686-3600

February 11, 1992

Richard L. Ray,
Richard L. Ray, Trustee
Fair Oil, LTd.
225 S. College
Box 689
Tyler, Texas 75710

Lincoln Aston
P. O. Box 3048
LaJolla, Calif 92038

Sunwest Bank of Albuquerque as Ancillary
Personal Representative of the
Charles Albert Aston, Jr. Estate
P. O. Box 26900
Albuquerque, NM 87125

Rogers Aston
P. O. Box 1090
Roswell, NM 88202

Rogers Aston and
NCNB Texas National Bank as Co-Trustees
of the "C" Trusts U/W/O Bert Aston
P. O. Box 830308
Dallas, Texas 75283-0308

Sharon A. Olsen, Trustee Under Declaration of
Trust created by Sharon Aston Olsen, Trustor
P. O. Box 7296
Leguna Niguel, Calif. 92607-7296

Re: Cedar Lake 35 Federal Com., Well No. 1, Section 35, T17S, R30E
Eddy County, New Mexico

Gentlemen:

Enron Oil & Gas Company has applied to the New Mexico Oil Conservation Division in Santa Fe, New Mexico for an unorthodox location for the above-named well as per the attached Application for Permit to Drill and location plat. If you, as mineral interest owner in offsetting Sections 25 and/or 26, have no objection to this application, please sign in the space provided below, and return to my attention in the enclosed envelope.

Your early attention is appreciated.

Very truly yours,

ENRON OIL & GAS COMPANY

Betty Gildon
Regulatory Analyst

Sunwest Bank of Albuquerque, N.A., Agent for
Sunwest Bank of Roswell, Anc. Pers. Rep. of the
Charles Aston Estate

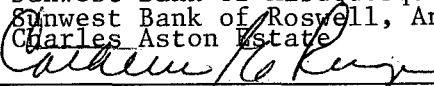
DATE: Feb. 19, 1992 SIGNATURE: 
By: Catherine E. Rugen, Trust Officer

bg

ENRON

Oil & Gas Company

P. O. Box 2267 Midland, Texas 79702 (915) 686-3600

February 11, 1992

Richard L. Ray,
Richard L. Ray, Trustee
Fair Oil, LTD.
225 S. College
Box 689
Tyler, Texas 75710

Lincoln Aston
P. O. Box 3048
LaJolla, Calif 92038

Sunwest Bank of Albuquerque as Ancillary
Personal Representative of the
Charles Albert Aston, Jr. Estate
P. O. Box 26900
Albuquerque, NM 87125

Rogers Aston
P. O. Box 1090
Roswell, NM 88202

Rogers Aston and
NCNB Texas National Bank as Co-Trustees
of the "C" Trusts U/W/O Bert Aston
P. O. Box 830308
Dallas, Texas 75283-0308

Sharon A. Olsen, Trustee Under Declaration of
Trust created by Sharon Aston Olsen, Trustor
P. O. Box 7296
Leguna Niguel, Calif. 92607-7296

Re: Cedar Lake 35 Federal Com., Well No. 1, Section 35, T17S, R30E
Eddy County, New Mexico

Gentlemen:

Enron Oil & Gas Company has applied to the New Mexico Oil Conservation Division in Santa Fe, New Mexico for an unorthodox location for the above-named well as per the attached Application for Permit to Drill and location plat. If you, as mineral interest owner in offsetting Sections 25 and/or 26, have no objection to this application, please sign in the space provided below, and return to my attention in the enclosed envelope.

Your early attention is appreciated.

Very truly yours,

ENRON OIL & GAS COMPANY

Betty Gildon
Regulatory Analyst

DATE: 2-24-92 SIGNATURE: Rogers Aston

bg

ENRON

Oil & Gas Company

P. O. Box 2267 Midland, Texas 79702 (915) 686-3600

February 11, 1992

Richard L. Ray,
Richard L. Ray, Trustee
Fair Oil, LTd.
225 S. College
Box 689
Tyler, Texas 75710

Lincoln Aston
P. O. Box 3048
LaJolla, Calif 92038

Sunwest Bank of Albuquerque as Ancillary
Personal Representative of the
Charles Albert Aston, Jr. Estate
P. O. Box 26900
Albuquerque, NM 87125

Rogers Aston
P. O. Box 1090
Roswell, NM 88202

Rogers Aston and
NCNB Texas National Bank as Co-Trustees
of the "C" Trusts U/W/O Bert Aston
P. O. Box 830308
Dallas, Texas 75283-0308

Sharon A. Olsen, Trustee Under Declaration of
Trust created by Sharon Aston Olsen, Trustor
P. O. Box 7296
Leguna Niguel, Calif. 92607-7296

Re: Cedar Lake 35 Federal Com., Well No. 1, Section 35, T17S, R30E
Eddy County, New Mexico

Gentlemen:

Enron Oil & Gas Company has applied to the New Mexico Oil Conservation Division in Santa Fe, New Mexico for an unorthodox location for the above-named well as per the attached Application for Permit to Drill and location plat. If you, as mineral interest owner in offsetting Sections 25 and/or 26, have no objection to this application, please sign in the space provided below, and return to my attention in the enclosed envelope.

Your early attention is appreciated.

Very truly yours,

ENRON OIL & GAS COMPANY

Betty Gildon
Regulatory Analyst

DATE: 2/14/92 SIGNATURE: Sharon A. Olsen

bg

RECEIVED
FEB 18 1992

ENRON
Oil & Gas Company

OIL CONSERVATION DIVISION
RECEIVED

'92 APR 23 AM 9 05

P. O. Box 2267 Midland, Texas 79702 (915) 686-3600

February 11, 1992

Richard L. Ray,
Richard L. Ray, Trustee
Fair Oil, LTd.
225 S. College
Box 689
Tyler, Texas 75710

Lincoln Aston
P. O. Box 3048
LaJolla, Calif 92038

Sunwest Bank of Albuquerque as Ancillary
Personal Representative of the
Charles Albert Aston, Jr. Estate
P. O. Box 26900
Albuquerque, NM 87125

Rogers Aston
P. O. Box 1090
Roswell, NM 88202

Rogers Aston and
NCNB Texas National Bank as Co-Trustees
of the "C" Trusts U/W/O Bert Aston
P. O. Box 830308
Dallas, Texas 75283-0308

Sharon A. Olsen, Trustee Under Declaration of
Trust created by Sharon Aston Olsen, Trustor
P. O. Box 7296
Leguna Niguel, Calif. 92607-7296

Re: Cedar Lake 35 Federal Com., Well No. 1, Section 35, T17S, R30E
Eddy County, New Mexico

Gentlemen:

Enron Oil & Gas Company has applied to the New Mexico Oil Conservation Division in Santa Fe, New Mexico for an unorthodox location for the above-named well as per the attached Application for Permit to Drill and location plat. If you, as mineral interest owner in offsetting Sections 25 and/or 26, have no objection to this application, please sign in the space provided below, and return to my attention in the enclosed envelope.

Your early attention is appreciated.

Very truly yours,

ENRON OIL & GAS COMPANY

Betty Gildon

Betty Gildon
Regulatory Analyst

DATE: 4-13-92

SIGNATURE: *James H. Coleman*

bg

VICEPRESIDENT
NATIONS BANK & TEXAS, FORMERLY
IV CMB TEXAS NATIONAL BANK

ENRON
Oil & Gas Company

P. O. Box 2267 Midland, Texas 79702 (915) 686-3600

February 11, 1992

OIL CONSERVATION DIVISION
RECEIVED

Phillips Petroleum Company
4001 Penbrook
Odessa, Texas 79762
Attn: Mr. Jim Carlton

Weller Energy, Inc.
P. O. Box 1388
E. Orleans, MA 02643
Attn: Mr. Frank Weller

Anadarko Petroleum Corp
P. O. Box 2497
400 W. Illinois, Ste 1300
Midland, Texas 79702
Attn: Mr. Mike Goode

Arco Oil & Gas Company 26
P. O. Box 1610
Midland, Texas 79702
Attn: Mr. Padrick Pinkney

Oxy USA, Inc.
P. O. Box 50250
Midland, Texas 79710
Attn: Mr. Pat McGee

Yates Petroleum
105 South 4th
Artesia, NM 88210
Attn: Mr. Randy Patterson

Re: Cedar Lake 35 Federal Com., Well No. 1, Section 35, T17S, R30E
Eddy County, New Mexico

Gentlemen:

Enron Oil & Gas Company has applied to the New Mexico Oil Conservation Division in Santa Fe, New Mexico for an unorthodox location for the above-named well as per the attached Application for Permit to Drill and location plat. If you, as offset operator, have no objection to this special permit, please sign in the space provided below, and return to my attention in the enclosed envelope.

Your early attention is appreciated.

Very truly yours,

ENRON OIL & GAS COMPANY

Betty Gildon

Betty Gildon
Regulatory Analyst

DATE: 2/29/92 COMPANY: Weller Energy Inc BY: Francis J. Weller Jr.
President

Enclosures: Form 3160-3 with plat
Return Stamped Envelope

bg

ENRON
Oil & Gas Company

OIL CONSERVATION DIVISION
RECEIVED

'92 MAR 23 AM 9 10

P. O. Box 2267 Midland, Texas 79702 (915) 686-3600

February 11, 1992

Richard L. Ray,
Richard L. Ray, Trustee
Fair Oil, LTD.
225 S. College
Box 689
Tyler, Texas 75710

Lincoln Aston
P. O. Box 3048
LaJolla, Calif 92038

Sunwest Bank of Albuquerque as Ancillary
Personal Representative of the
Charles Albert Aston, Jr. Estate
P. O. Box 26900
Albuquerque, NM 87125

Rogers Aston
P. O. Box 1090
Roswell, NM 88202

Rogers Aston and
NCNB Texas National Bank as Co-Trustees
of the "C" Trusts U/W/O Bert Aston
P. O. Box 830308
Dallas, Texas 75263-0308

Sharon A. Olsen, Trustee Under Declaration of
Trust created by Sharon Aston Olsen, Trustor
P. O. Box 7296
Leguna Niguel, Calif. 92607-7296

Re: Cedar Lake 35 Federal Com., Well No. 1, Section 35, T17S, R30E
Eddy County, New Mexico

Gentlemen:

Enron Oil & Gas Company has applied to the New Mexico Oil Conservation Division in Santa Fe, New Mexico for an unorthodox location for the above-named well as per the attached Application for Permit to Drill and location plat. If you, as mineral interest owner in offsetting Sections 25 and/or 26, have no objection to this application, please sign in the space provided below, and return to my attention in the enclosed envelope.

Your early attention is appreciated.

Very truly yours,

ENRON OIL & GAS COMPANY

Betty Gildon

Betty Gildon
Regulatory Analyst

RICHARD L. RAY TRUSTEE

Wilton H. Fair
Wilton H. Fair, Substitute Trustee

FAIR OIL, LTD.

DATE: 03-16-92

SIGNATURE:

Wilton H. Fair
Wilton H. Fair, General Partner

bg

ENRON
Oil & Gas Company

OIL CONSERVATION DIVISION
RECEIVED

'92 MAR 16 AM 8 26

P. O. Box 2267 Midland, Texas 79702 (915) 686-3600

March 12, 1992

New Mexico Oil Conservation Division
P. O. Box 2088
Santa Fe, New Mexico 87504

Attn: Mr. Mike Stogner

In Re: Administrative Order NSL-3103

Cedar Lake 35 Federal Com Well No. 1
1240' FNL & 1980' FEL (Unit B)
Section 35, Township 17 South, Range 30 East
Eddy County, New Mexico

Dear Mr. Stogner:

Enron Oil & Gas Company failed to name the Siluro as a part of the Devonian pool in our request for a non-standard location.

Please correct your records and/or approval of the above-named unorthodox location dated March 6, 1992.

We plan to test the north 320 acres of Section 35 as the Siluro-Devonian. Sorry for any inconvenience this may have caused you.

Very truly yours,

ENRON OIL & GAS COMPANY



Betty Gildon
Regulatory Analyst

BG

enclosures

OIL CONSERVATION DIVISION

DISTRICT I

P.O. Box 1980, Hobbs, NM 88240

P.O. Box 2088

Santa Fe, New Mexico 87504-2088

DISTRICT II

P.O. Drawer DD, Artesia, NM 88210

DISTRICT III

1000 Rio Brazos Rd., Artec, NM 87410

WELL LOCATION AND ACREAGE DEDICATION PLAT

All Distances must be from the outer boundaries of the section

Operator Enron Oil & Gas Company			Lease Cedar Lake 35 Fed. Com.		Well No. 1
Unit Letter B	Section 35	Township 17 South	Range 30 East	County Eddy	
Actual Footage Location of Well: 1240 feet from the North line and 1980 feet from the East line					
Ground Level Elev. 3548.1	Producing Formation Devonian		Pool Wildcat	Dedicated Acreage: 320 Acres	

1. Outline the acreage dedicated to the subject well by colored pencil or hatchure marks on the plat below.
 2. If more than one lease is dedicated to the well, outline each and identify the ownership thereof (both as to working interest and royalty).
 3. If more than one lease of different ownership is dedicated to the well, have the interest of all owners been consolidated by communization, unitization, force-pooling, etc.?
☐ Yes ☐ No If answer is "yes" type of consolidation _____
- If answer is "no" list of owners and tract descriptions which have actually been consolidated. (Use reverse side of this form necessary.)
- No allowable will be assigned to the well unit all interests have been consolidated (by communization, unitization, forced-pooling, otherwise) or until a non-standard unit, eliminating such interest, has been approved by the Division.

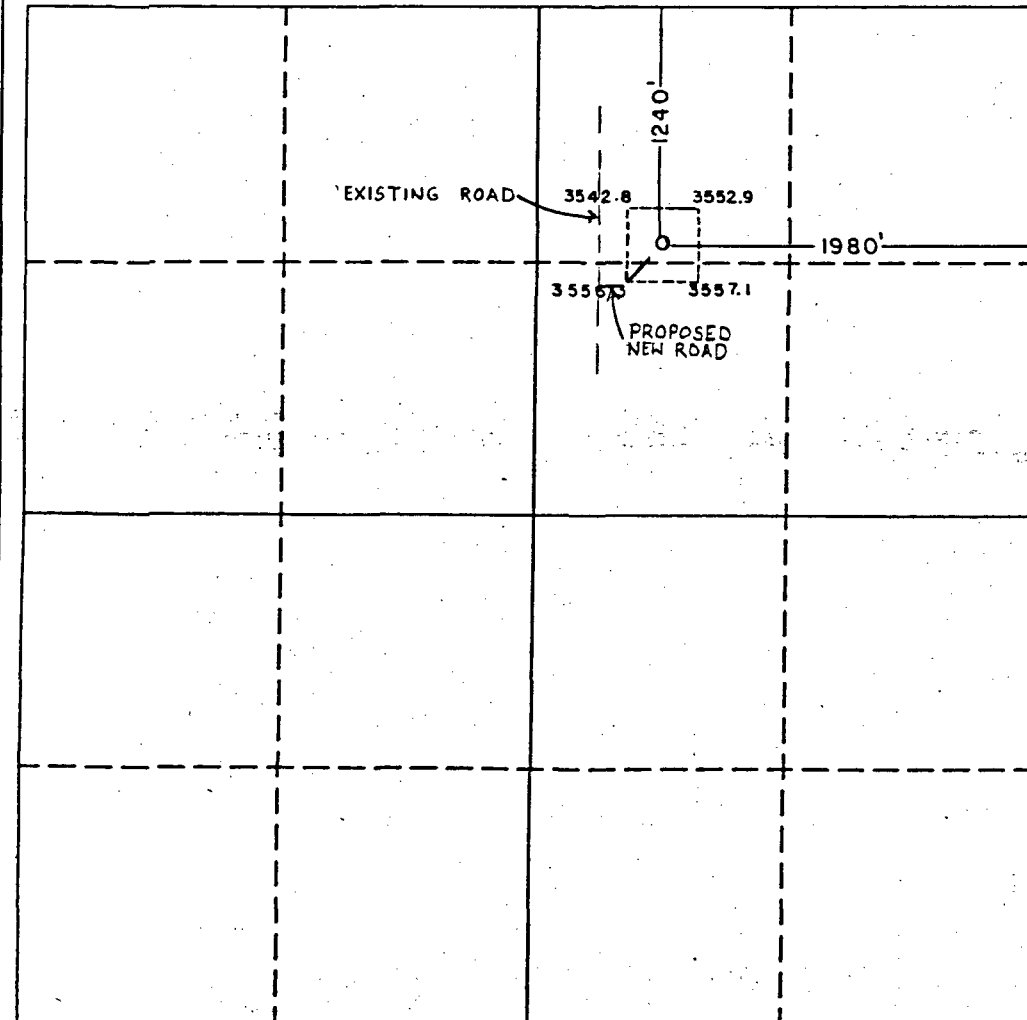

OPERATOR CERTIFICATION

I hereby certify the the information contained herein is true and complete to the best of my knowledge and belief.

Signature
Betty Gildon

Printed Name
Betty Gildon

Position
Regulatory Analyst

Company
Enron Oil & Gas Company

Date
2/11/92

SURVEYOR CERTIFICATION

I hereby certify that the well location shown on this plat was plotted from field notes of actual surveys made by me or under my supervision, and that the same is true and correct to the best of my knowledge and belief.

Date Surveyed
January 29, 1992

Signature & Seal of
Professional Surveyor

Ronald J. Eason
Certificate No. JOHN W. WEST, 878
RONALD J. EASON, 3839
MEXICO, 7877
W-012

