



GREENHILL PETROLEUM CORPORATION
RECEIVED

11490 WESTHEIMER ROAD, SUITE 200
HOUSTON, TEXAS 77077-6841
TELEPHONE (713) 589-8484
FAX. (713) 589-7892

'92 MAR 23 AM 9 12

Incorporated in Delaware, U.S.A.

March 18, 1992

NSL-3106

Oil Conservation Division
State of New Mexico
Energy, Minerals and Natural Resources Department
P. O. Box 2088
Santa Fe, New Mexico 87504-2088

Attention: Mr. Mike Stogner

Re: Unorthodox Location and Drilling Permit
Proposed Well Number 141
Lovington Paddock
Lea County, New Mexico

Dear Mr. Stogner:

On March 16, 1992 I Federal Expressed Forms C-101 and C-102 on the above referenced well. I failed to enclose the BOP Program for this well. Enclosed please find this Program along with additional copies of Forms C-101 and C-102 along with a copy of the map for the area.

Please excuse my error.

Very truly yours,

Sharon J. Stephens
Land Secretary

sjs:s
92.217

Enclosures

Submit to Appropriate
District Office
State Lease - 6 copies
For Lease - 5 copies

State of New Mexico
Energy, Minerals and Natural Resources Department

Form C-101
Revised 1-1-89

OIL CONSERVATION DIVISION

P.O. Box 2088
Santa Fe, New Mexico 87504-2088

DISTRICT I

P.O. Box 1980, Hobbs, NM 88240

DISTRICT II

P.O. Drawer DD, Artesia, NM 88210

DISTRICT III

1000 Rio Brazos Rd., Aztec, NM 87410

API NO. (assigned by OCD on New Wells)

5. Indicate Type of Lease

STATE ☒ FEE ☐

6. State Oil & Gas Lease No.

B 2359

APPLICATION FOR PERMIT TO DRILL, DEEPEN, OR PLUG BACK

1a. Type of Work:

DRILL ☒

RE-ENTER ☐

DEEPEN ☐

PLUG BACK ☐

b. Type of Well:

OIL
WELL ☒

GAS
WELL ☐

OTHER ☐

SINGLE
ZONE ☐

MULTIPLE
ZONE ☐

7. Lease Name or Unit Agreement Name

Lovington Paddock Unit

2. Name of Operator

Greenhill Petroleum Corporation

3. Address of Operator

11490 Westheimer, Suite 200, Houston, Texas 77077

8. Well No.

141

9. Pool name or Wildcat

Lovington Paddock Unit

4. Well Location

Unit Letter G : 2545 Feet From The North Line and 1440 Feet From The East Line

Section 1 Township 17 South Range 36 East NMPM Lea County

10. Proposed Depth

6450'

11. Formation

Paddock

12. Rotary or C.T.

Rotary

13. Elevations (Show whether DF, RT, GR, etc.)

3819 GR

14. Kind & Status Plug. Bond

on file

15. Drilling Contractor

TBD

16. Approx. Date Work will start

4-1-92

17.

PROPOSED CASING AND CEMENT PROGRAM

SIZE OF HOLE	SIZE OF CASING	WEIGHT PER FOOT	SETTING DEPTH	SACKS OF CEMENT	EST. TOP
12 1/4	8 5/8	24	1300	550	surface
7 7/8	5 1/2	15.5	6450	1100	surface

IN ABOVE SPACE DESCRIBE PROPOSED PROGRAM: IF PROPOSAL IS TO DEEPEN OR PLUG BACK, GIVE DATA ON PRESENT PRODUCTIVE ZONE AND PROPOSED NEW PRODUCTIVE ZONE. GIVE BLOWOUT PREVENTER PROGRAM, IF ANY.

I hereby certify that the information above is true and complete to the best of my knowledge and belief.

SIGNATURE

Michael J. Newport

TITLE

Land Manager-Permian Basin

DATE

3-16-92

TYPE OR PRINT NAME

Michael J. Newport

(713) 589-8484
TELEPHONE NO.

(This space for State Use)

APPROVED BY

TITLE

DATE

CONDITIONS OF APPROVAL, IF ANY:

OIL CONSERVATION DIVISION

P.O. Box 2088
Santa Fe, New Mexico 87504-2088

DISTRICT I

P.O. Box 1980, Hobbs, NM 88240

DISTRICT II

P.O. Drawer DD, Artesia, NM 88210

DISTRICT III

1000 Rio Brazos Rd., Artec, NM 87410

WELL LOCATION AND ACREAGE DEDICATION PLAT

All Distances must be from the outer boundaries of the section

Operator Greenhill Petroleum Corp.			Lease Lovington Paddock Unit		Well No. 141
Unit Letter G	Section 1	Township 17 South	Range 36 East	NMPM	County Lea
Actual Footage Location of Well: 2545 feet from the north line and 1440 feet from the east line					
Ground Level Elev. 3819.3	Producing Formation Lovington Paddock	Pool Lovington Paddock Unit	Dedicated Acreage: 40 Acres		

1. Outline the acreage dedicated to the subject well by colored pencil or hatchure marks on the plat below.
2. If more than one lease is dedicated to the well, outline each and identify the ownership thereof (both as to working interest and royalty).
3. If more than one lease of different ownership is dedicated to the well, have the interest of all owners been consolidated by communitization, unitization, force-pooling, etc.?
☒ Yes ☐ No If answer is "yes" type of consolidation Unitized

If answer is "no" list of owners and tract descriptions which have actually been consolidated. (Use reverse side of this form necessary.)

No allowable will be assigned to the well unit all interests have been consolidated (by communitization, unitization, forced-pooling, otherwise) or until a non-standard unit, eliminating such interest, has been approved by the Division.

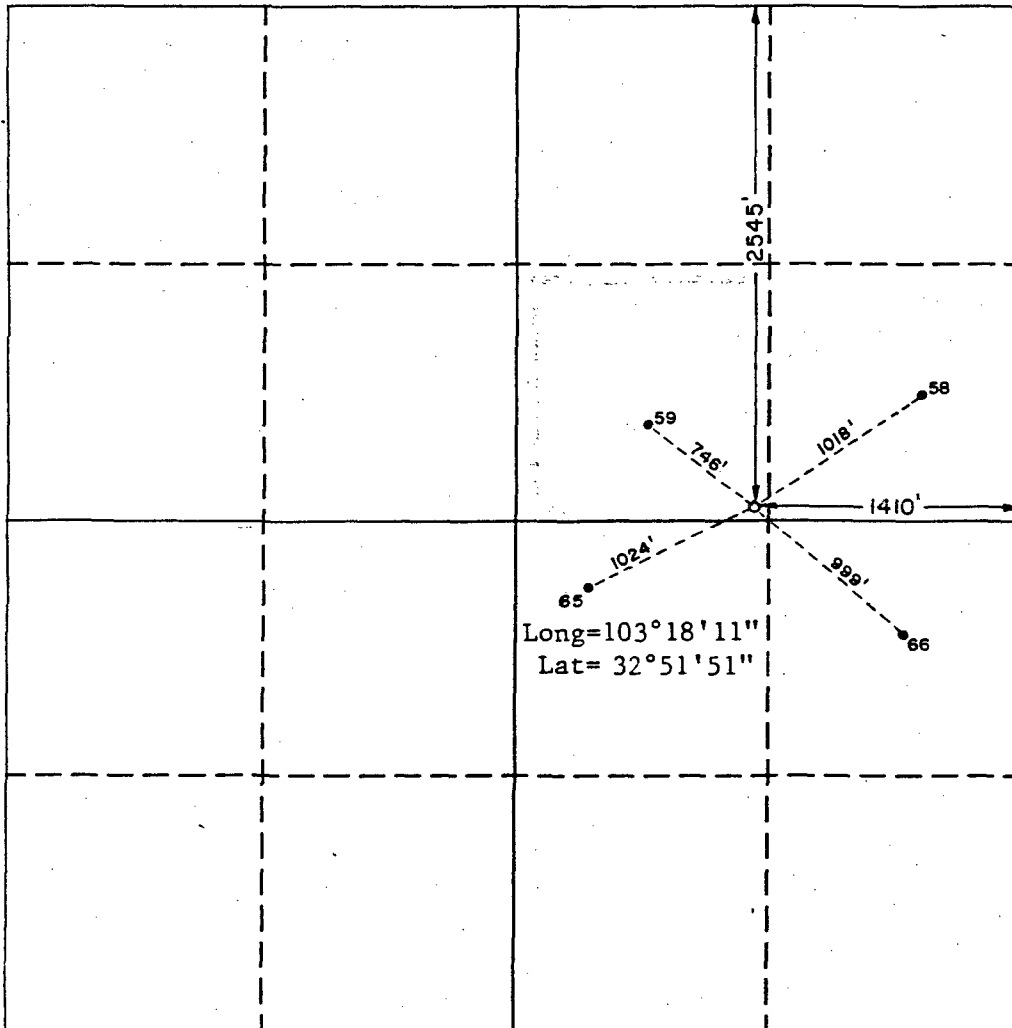

OPERATOR CERTIFICATION

I hereby certify the the information contained herein is true and complete to the best of my knowledge and belief.

Signature
Michael J. Newport
Printed Name
Michael J. Newport
Position
Landman
Company
Greenhill Petroleum Corp
Date
3/16/92

SURVEYOR CERTIFICATION

I hereby certify that the well location shown on this plat was plotted from field notes of actual surveys made by me or under my supervision, and that the same is true and correct to the best of my knowledge and belief.

Date Surveyed
February 28, 1992
Signature & Seal of
Professional Surveyor

Ronald J. Edson
Certificate No. JOHN W. WEST, 878
RONALD J. EDSON, 3839
GARY L. JONES, 7977

W.O. 92-11-0190

0 330 660 990 1320 1650 1980 2310 2640 2000 1500 1000 500 0

GREENHILL PETROLEUM CORPORATION
BOP PROGRAM FOR
LOVINGTON PADDOCK UNIT #141

Casing Program

BOP Program

Size	Depth	Wt.	Grade	Configuration	Test Pressure
8 5/8"	1300'	24	H40, STC	RA*	200 psi
5 1/2"	6450'	15.5	K55, STC	RR*	250/1500 psi

*RR-Ram Ram
RA-Ram Annular

Diverter-Hydrill may be substituted for a diverter.

26

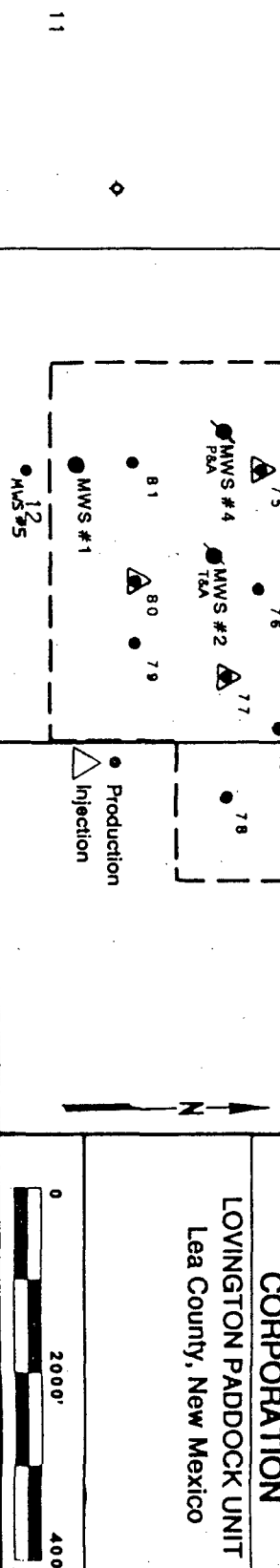
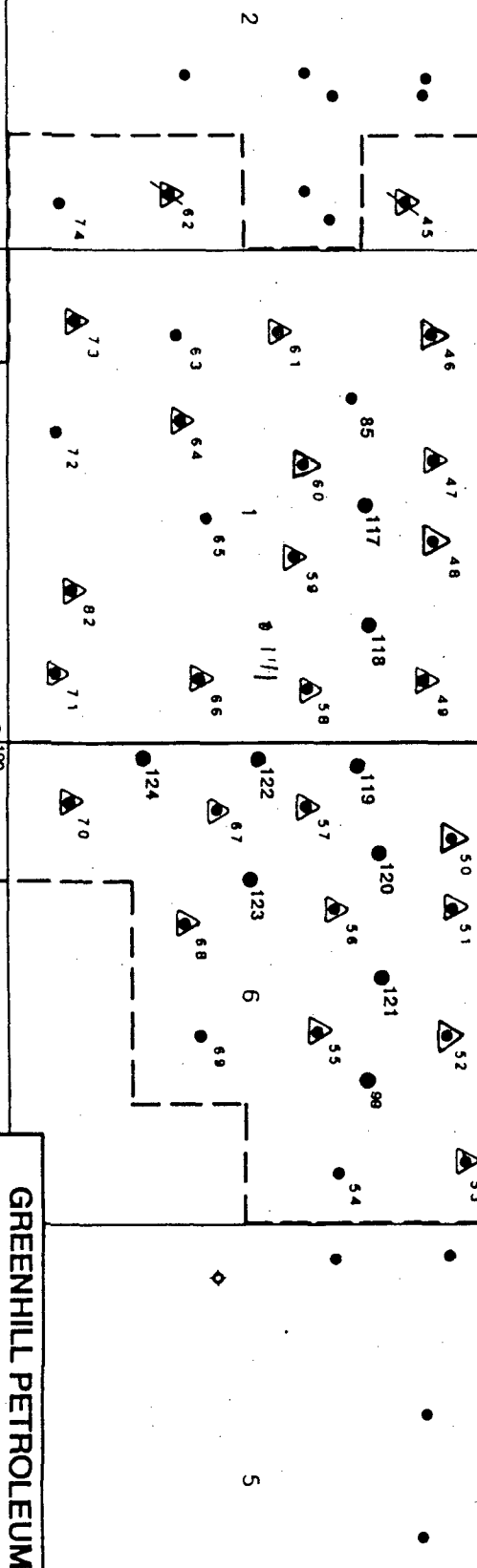
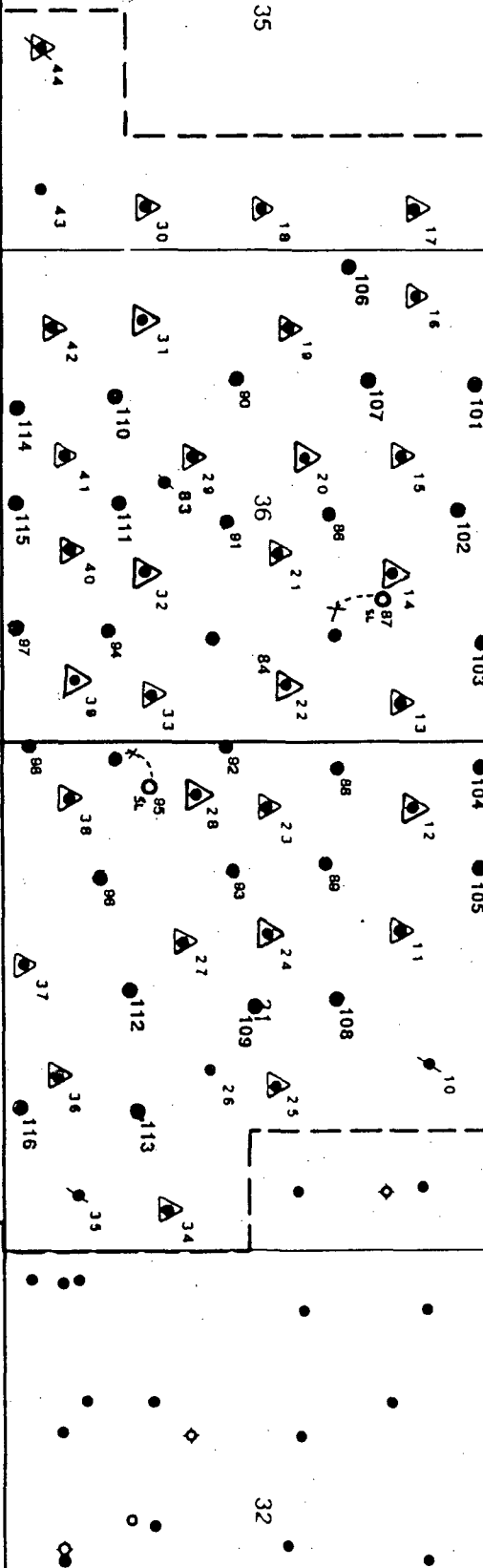
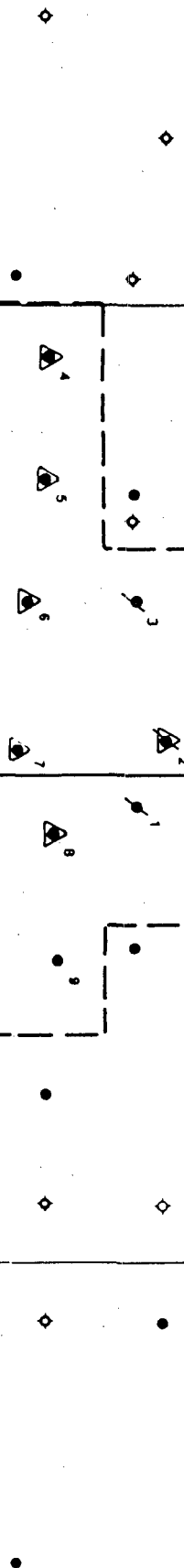

GREENHILL PETROLEUM CORPORATION
LOVINGTON PADDOCK UNIT
Lea County, New Mexico

0 2000' 4000'

12/91