

MARTIN YATES, III  
1912 - 1985  
FRANK W. YATES  
1936 - 1986



105 SOUTH FOURTH STREET  
ARTESIA, NEW MEXICO 88210

TELEPHONE (505) 748-1471

OIL CONSERVATION DIVISION  
RECEIVED

22 APR 27 AM 9:50

S. P. YATES  
CHAIRMAN OF THE BOARD  
JOHN L. YATES  
PRESIDENT  
PEYTON YATES  
EXECUTIVE VICE PRESIDENT  
GARY G. PATTERSON  
SECRETARY  
DENNIS G. KINSEY  
TREASURER

April 22, 1992

New Mexico Oil Conservation Division  
P.O. Box 2088  
Santa Fe, New Mexico 87501

Attention: Mr. William LeMay

Re: Lusk AHB Federal #9  
1650' FNL and 1040' FEL  
Section 35-T19S-R32E  
Lea County, New Mexico

Dear Sir:

Yates Petroleum Corporation requests administrative approval for the above captioned non-standard location as provided for under NMOCD rule 104F.

The reason for requesting this non-standard location is that Bureau of Land Management is requiring us to move from our preferred location of 1650' FNL and 990' FEL due to an archeological site on the east and south sides of the proposed location. By moving the required 50' to the west would allow us to build this well pad without disturbing the archeological site. Enclosed is a copy of the Archeological Survey Report with their maps and drawings. The site covers approximately three quarters of the SENE quarter preventing a standard location to be built.

Enclosed is a copy of the lease map showing offsetting lease operators and survey plat. Offsetting lease operators have been notified of our intentions by certified mail, via a xerox copy of this letter.

Formations that we expect to drill through are: Rustler, Yates, Delaware, Brushy Canyon, and Bone Springs. Our expected total depth is 7900'.

If you have any questions concerning this matter, please don't hesitate to call me at (505) 748-1471.

Sincerely,

YATES PETROLEUM CORPORATION

Clifton R. May  
Permit Agent

CRM:tg  
Enclosures

cc: See Attached

Submit to Appropriate  
District Office  
State Lease - 4 copies  
Fee Lease - 3 copies

State of New Mexico  
Energy, Minerals and Natural Resources Department

Form C-102  
Revised 1-1-89

OIL CONSERVATION DIVISION

P.O. Box 2088

Santa Fe, New Mexico 87504-2088

DISTRICT I

P.O. Box 1980, Hobbs, NM 88240

DISTRICT II

P.O. Drawer DD, Artesia, NM 88210

DISTRICT III

1000 Rio Brazos Rd., Aztec, NM 87410

WELL LOCATION AND ACREAGE DEDICATION PLAT

All Distances must be from the outer boundaries of the section

Operator <b>YATES PETROLEUM CORPORATION</b>			Lease <b>LUSK "AHB" FEDERAL</b>		Well No. <b>9</b>
Unit Letter <b>H</b>	Section <b>35</b>	Township <b>19 SOUTH</b>	Range <b>32 EAST</b>	County <b>NMPM LEA</b>	
Actual Footage Location of Well: <b>1650</b> feet from the <b>NORTH</b> line and <b>1040</b> feet from the <b>EAST</b> line					
Ground level Elev. <b>3566</b>	Producing Formation <b>DELAWARE</b>		Pool <b>EAST LUSK DELAWARE</b>		Dedicated Acreage: <b>40</b> Acres

1. Outline the acreage dedicated to the subject well by colored pencil or hatchure marks on the plat below.

2. If more than one lease is dedicated to the well, outline each and identify the ownership thereof (both as to working interest and royalty).

3. If more than one lease of different ownership is dedicated to the well, have the interest of all owners been consolidated by communitization, unitization, force-pooling, etc.?

☐ Yes ☐ No If answer is "yes" type of consolidation \_\_\_\_\_

If answer is "no" list the owners and tract descriptions which have actually been consolidated. (Use reverse side of this form if necessary.) \_\_\_\_\_

No allowable will be assigned to the well until all interests have been consolidated (by communitization, unitization, forced-pooling, or otherwise) or until a non-standard unit, eliminating such interest, has been approved by the Division.

OPERATOR CERTIFICATION

I hereby certify that the information contained herein is true and complete to the best of my knowledge and belief.

Signature

*Clifton R. May*

Printed Name

Clifton R. May

Position

Permit Agent

Company

YATES PETROLEUM CORPORATION

Date

April 24, 1992

SURVEYOR CERTIFICATION

I hereby certify that the well location shown on this plat was plotted from field notes of actual surveys made by me or under my supervision, and that the same is true and correct to the best of my knowledge and belief.

Date Surveyed

April 16, 1992

Signature & Seal of Professional Surveyor

*Herschel*  
Certificate No. 3840  
3640  
RED LAND SURVEY

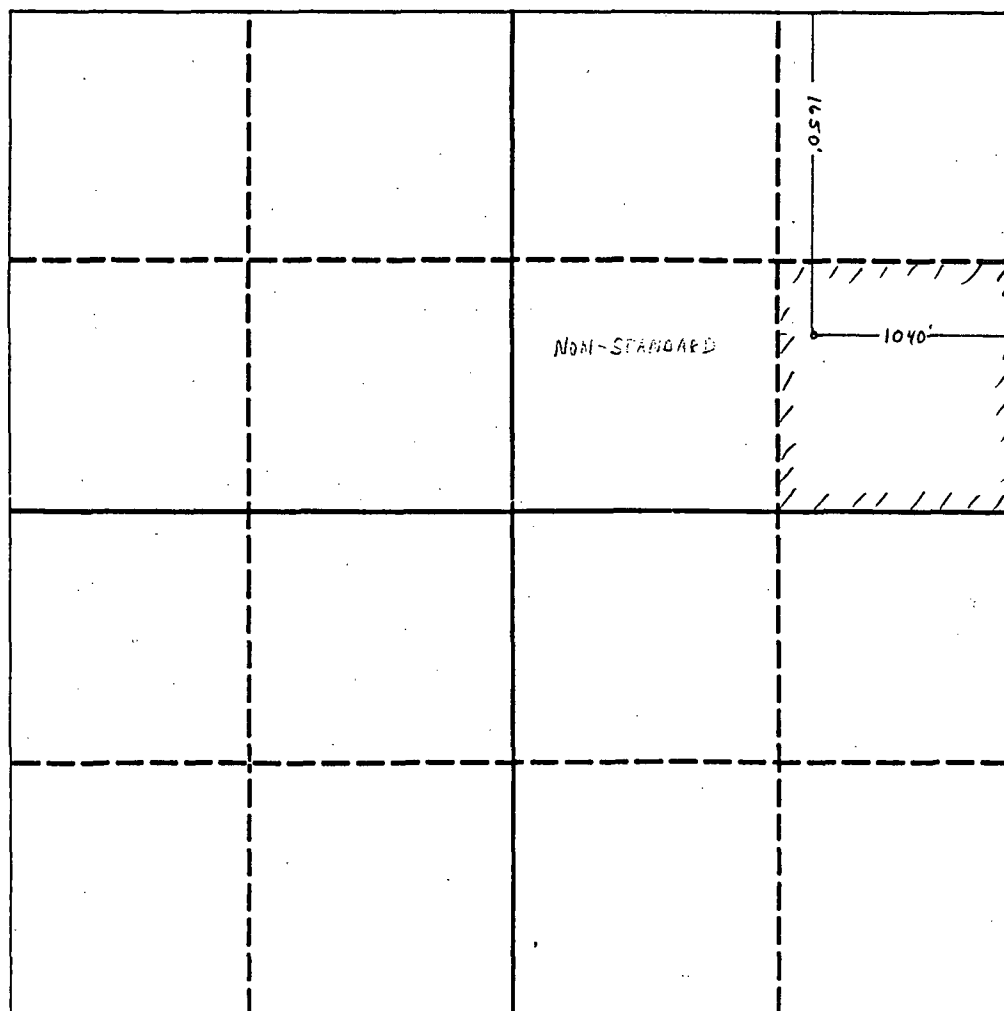

0 330 660 990 1320 1650 1980 2310 2640 2000 1500 1000 500 0

Lusk "AHB" Federal #9  
1650' FNL and 1040' FEL  
Section 35-T19S-R32E  
Lea County, New Mexico

Meridian Oil Inc.  
21 Desta Drive  
Midland, Texas 79701

Oryx Energy Company  
P.O. Box 2880  
Dallas, Texas 75221-2880

Manzano Oil Corporation  
P.O. Box 2107  
Roswell, NM 88202

Union Texas Petroleum  
P.O. Box 2120  
Houston, TX 77252-2120

Mitchell Energy Corporation  
400 W. Illinois  
1000 Independence Plaza  
Midland, Texas 79701

Oxy USA, Inc.  
P.O. Box 50250  
Midland, Texas 79705

Texaco USA  
P.O. Box 2100  
Denver, CO 80201

Anadarko Petroleum Corporation  
P.O. Box 2497  
Midland, Texas 79702

Lanexco, Inc.  
P.O. Box 2730  
Midland, Texas 79702

Grace Petroleum Corporation  
6501 N. Broadway  
Oklahoma City, OK 73116

Unocal Corporation  
P.O. Box 3100  
Midland, TX 79702

Bass Enterprises Production Company  
3100 First City Bank Tower  
201 Main Street  
Ft. Worth, Texas 76102

Fina Oil & Chemical Company  
6 Desta Drive, Suite 4400  
Midland, TX 79705

APR 27 1992

MARTIN YATES III  
1912 - 1985  
FRANK W. YATES  
1936 - 1986

OIL CONSERVATION DIVISION  
RECEIVED



'92 JUN 1 AM 10 27

105 SOUTH FOURTH STREET  
ARTESIA, NEW MEXICO 88210  
TELEPHONE (505) 748-1471

S. P. YATES  
CHAIRMAN OF THE BOARD  
JOHN A. YATES  
PRESIDENT  
PEYTON YATES  
EXECUTIVE VICE PRESIDENT  
RANDY G. PATTERSON  
SECRETARY  
DENNIS G. KINSEY  
TREASURER

April 22, 1992

*NSL-3115*

Mitchell Energy Corporation  
400 W. Illinois  
1000 Independence Plaza  
Midland, TX 79701

RE: Non-Standard Location for  
Lusk AHB Federal #9  
1650' FNL and 1040' FEL  
Section 35-T19S-R32E  
Lea County, New Mexico

Gentlemen:

Please sign and return one (1) copy to Yates Petroleum Corporation, 105 South Fourth Street, Artesia, New Mexico 88210, to the attention of Clifton R. May, and one (1) copy to Mr. William LeMay, New Mexico Oil Conservation Division, P.O. Box 2088, Santa Fe, New Mexico 87501, if you have no objections to the proposed unorthodox location listed above. A xerox copy of a letter to Mr. William LeMay is attached to inform you of our intentions.

#### WAIVER

As an offset operator, Mitchell Energy Corporation, has no objections to the unorthodox location for the well listed above.

Signature

DISTRICT LANDMAN

Title

5/19/92  
Date

MARTIN YATES, III  
1912 - 1985  
FRANK W. YATES  
1936 - 1986

OIL CONSERVATION DIVISION  
RECEIVED

92 APR 29 AM 8 35



105 SOUTH FOURTH STREET  
ARTESIA, NEW MEXICO 88210  
TELEPHONE (505) 748-1471

S. P. YATES  
CHAIRMAN OF THE BOARD  
JOHN A. YATES  
PRESIDENT  
PEYTON YATES  
EXECUTIVE VICE PRESIDENT  
RANDY G. PATTERSON  
SECRETARY  
DENNIS G. KINSEY  
TREASURER

April 22, 1992

Lanexco, Inc.  
P.O. Box 2730  
Midland, Texas 79702

RE: Non-Standard Location for  
Lusk AHB Federal #9  
1650' FNL and 1040' FEL  
Section 35-T19S-R32E  
Lea County, New Mexico

Gentlemen:

Please sign and return one (1) copy to Yates Petroleum Corporation, 105 South Fourth Street, Artesia, New Mexico 88210, to the attention of Clifton R. May, and one (1) copy to Mr. William LeMay, New Mexico Oil Conservation Division, P.O. Box 2088, Santa Fe, New Mexico 87501, if you have no objections to the proposed unorthodox location listed above. A xerox copy of a letter to Mr. William LeMay is attached to inform you of our intentions.

#### WAIVER

As an offset operator, Lanexco, Inc., has no objections to the unorthodox location for the well listed above.

Signature

Title

Date

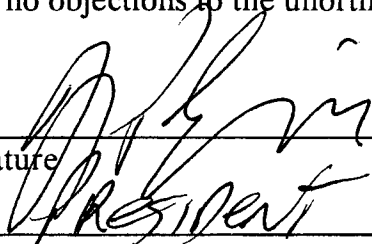
  
President  
4-27-92

COUNTY

Lea

POOL

East Lusk - Delaware

TOWNSHIP

19 South

RANGE

32 East

NMPM

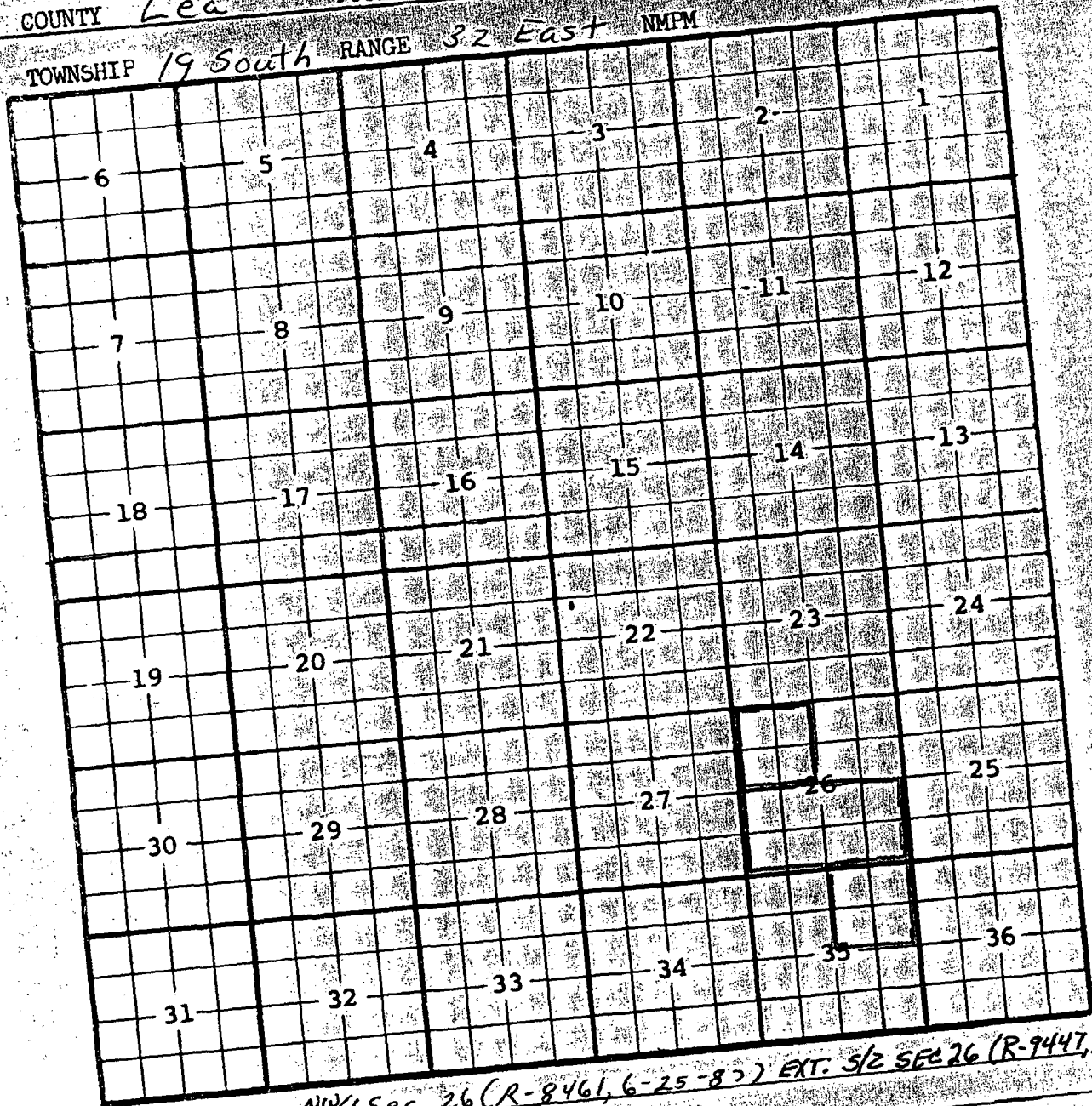

Description: NW 1/4 Sec. 26 (R-8461, 6-25-82) EXT. 5/2 SEC 26 (R-9447, 3-1-91)  
Ext. NE 1/4 Sec. 35 (R-9544, 7-1-91)