

MERIDIAN OIL

OIL CONSERVATION DIVISION
RECEIVED

'92 AUG 3 AM 10 14

July 30, 1992

Mr. Michael E. Stogner
State of New Mexico
Energy, Minerals and Natural Resources Dept.
P. O. Box 2088
Santa Fe, NM 87504

RE: AMEND CASE NO. 8078, ORDER NO. R-7525
APPLICATION OF MERIDIAN OIL INC. FOR
A NON-STANDARD GAS PRORATION UNIT,
SIMULTANEOUS DEDICATION AND
UNORTHODOX LOCATION TO PLUG BACK
AND RECOMPLETE THE WINNINGHAM #6
P, 660' FSL & 660' FEL, SEC. 30,
T25S, R37E, LEA COUNTY, NEW MEXICO
FROM A JALMAT OIL WELL TO A JALMAT
GAS WELL IN THE YATES FORMATION

Dear Mr. Stogner:

Meridian operates the 480 - acre Winningham Lease,
comprising the E/2 SE/4 of Section 19 and the E/2 and E/2
NW/4 of Section 30, all in T25S, R37E, Lea County, New
Mexico. Meridian Oil requests approval to recomplete the
Winningham Well No. 6 well captioned above and
simultaneously dedicate the 480 acre non-standard gas
proration to the Winningham wells No's #6 - O, Sec 30; #8 -
I, Sec. 19; #9-B - Sec. 30.

The following wells will be deleted from this acreage as
they are shut in and will be plugged and abandoned in the
near future, Winningham #1 - C, Sec. 30; #2 - P, Sec. 19; #3
- I, Sec. 30; and #7 - H Sec. 30.

Also, we request approval for an unorthodox location for the
Winningham No. 6. A plat is enclosed showing the location
of these three wells.

The offset operators were notified by certified mail on
7/30/92, list attached

Mr. Stogner
Page 2

Should you require additional information, please call me at
A/C 915-688-6906.

Sincerely,

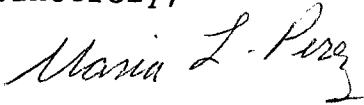
A handwritten signature in cursive script that reads "Maria L. Perez".

Maria L. Perez
Prod. Asst.

MLP/sm

xc: Well File
Don McBee
Land (2)
Jt. Interest
Resv. Engineer
Prod. Engineer
Geologist
Hobbs Office
Richard Atchley
OCD - Hobbs
Roxann Scholz
Michele Alcantara
Reading File
Regulatory File

OFFSET OPERATOR ADDRESSES

LEWIS B. BURLESON, INC.
P. O. BOX 2479
MIDLAND, TEXAS 79702

CHEVRON U.S.A. INC.
ATTN: AL BOHLING
PRORATION ENGINEER
P. O. BOX 1150
MIDLAND, TEXAS 79702

TAHOE ENERGY INC.
ATTN: KEN FREEMAN
3909 WEST INDUSTRIAL
MIDLAND, TEXAS 79703

LIST OF OFFSET OPERATORS
JALMAT TANSILL YATES 7 RIVERS (PRO GAS)
MERIDIAN OIL INC.

WINNINGHAM #6

(30P-25S-37E)

W/2 SW/4 SEC. 19, E/2 NW/4 & E/2 SEC. 30, T-25-S, R-37-E

LEA COUNTY, NEW MEXICO

REF. NO.	OPERATOR	WELL NAME(S)	GAS WELL LOCATIONS	UNIT DESCRIPTION	NO. OF ACRES
1.	TAHOE ENERGY INC.	SHOLES A 19 #1	L-19-25S-37E	W/2 E/2 SECTION 19 T-25-S, R-37-E	160
2.	LEWIS B. BURLERSON, INC.	SHOLES B 19 #4	K-19-25S-37E	W/2 E/2 & SE/4 NW/4 & E/2 SW/4 SECTION 19 T-25-S, R-37-E	280
3.	LEWIS B. BURLERSON, INC.	SHOLES B 30 #2	D-30-25S-37E	W/2 NW/4 SECTION 20 T-25-S, R-37-E	80
4.	LEWIS B. BURLERSON, INC.	DYER #3	H-31-25S-37E	NE/4 SECTION 31 T-25-S, R-37-E	160
5.	CHEVRON U.S.A. INC.	ARNOTT RAMSAY NCT B #1 ARNOTT RAMSAY NCT B #10	M-32-25S-37E F-32-25S-37E	W/2 SECTION 32 T-25-S, R-37-E	320

MERIDIAN OIL

July 30, 1992

Lewis B. Burleson, Inc.
P. O. Box 2479
Midland, TX 79702

RE: OFFSET OPERATOR, NOTIFICATION
AMEND CASE NO. 8078, ORDER NO. R-7525
APPLICATION OF MERIDIAN OIL INC. FOR
A NON-STANDARD GAS PRORATION UNIT,
SIMULTANEOUS DEDICATION AND UNORTHODOX
LOCATION TO PLUG BACK AND RECOMPLETE
THE WINNINGHAM #6, P, 660' FSL & 660'
FEL, SEC. 30, T25S, R37E, LEA COUNTY
NEW MEXICO FROM A JALMAT OIL WELL TO A
JALMAT GAS WELL IN THE YATES FORMATION

Gentlemen:

Enclosed is a copy of the captioned application sent to the
Oil Conservation Division in Santa Fe.

Should you have any questions, please contact Mr. Kevin
Midkiff, Production Engineer at A/C 915-688-6828.

Sincerely,

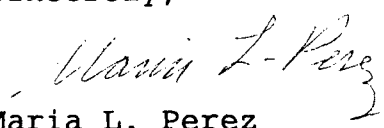
Maria L. Perez
Prod. Asst.

MLP/sm

xc: Well File
Don McBee
Land (2)
Jt. Interest
Resv. Engineer
Prod. Engineer
Geologist
Hobbs Office
Michele Alcantara
Richard Atchley
Roxann Scholz
Reading File
Regulatory File

MERIDIAN OIL

July 30, 1992

Chevron U.S.A. Inc.
Attn: Al Bohling
Proration Engineer
P. O. Box 1150
Midland, TX 79702

RE: OFFSET OPERATOR, NOTIFICATION
AMEND CASE NO. 8078, ORDER NO. R-7525
APPLICATION OF MERIDIAN OIL INC. FOR
A NON-STANDARD GAS PRORATION UNIT,
SIMULTANEOUS DEDICATION AND UNORTHODOX
LOCATION TO PLUG BACK AND RECOMPLETE
THE WINNINGHAM #6, P, 660' FSL & 660'
FEL, SEC. 30, T25S, R37E, LEA COUNTY
NEW MEXICO FROM A JALMAT OIL WELL TO A
JALMAT GAS WELL IN THE YATES FORMATION

Gentlemen:

Enclosed is a copy of the captioned application sent to the
Oil Conservation Division in Santa Fe.

Should you have any questions, please contact Mr. Kevin
Midkiff, Production Engineer at A/C 915-688-6828.

Sincerely,

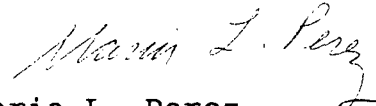
Maria L. Perez
Prod. Asst.

MLP/sm

xc: Well File
Don McBee
Land (2)
Jt. Interest
Resv. Engineer
Prod. Engineer
Geologist
Hobbs Office
Michele Alcantara
Richard Atchley
Roxann Scholz
Reading File
Regulatory File

MERIDIAN OIL

July 30, 1992

Tahoe Energy Inc.
Attn: Ken Freeman
3909 West Industrial
Midland, TX 79703

RE: OFFSET OPERATOR, NOTIFICATION
AMEND CASE NO. 8078, ORDER NO. R-7525
APPLICATION OF MERIDIAN OIL INC. FOR
A NON-STANDARD GAS PRORATION UNIT,
SIMULTANEOUS DEDICATION AND UNORTHODOX
LOCATION TO PLUG BACK AND RECOMPLETE
THE WINNINGHAM #6, P, 660' FSL & 660'
FEL, SEC. 30, T25S, R37E, LEA COUNTY
NEW MEXICO FROM A JALMAT OIL WELL TO A
JALMAT GAS WELL IN THE YATES FORMATION

Gentlemen:

Enclosed is a copy of the captioned application sent to the
Oil Conservation Division in Santa Fe.

Should you have any questions, please contact Mr. Kevin
Midkiff, Production Engineer at A/C 915-688-6828.

Sincerely,

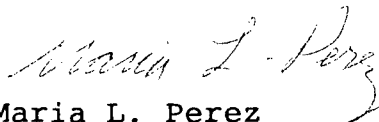
Maria L. Perez
Prod. Asst.

MLP/sm

xc: Well File
Don McBee
Land (2)
Jt. Interest
Resv. Engineer
Prod. Engineer
Geologist
Hobbs Office
Michele Alcantara
Richard Atchley
Roxann Scholz
Reading File
Regulatory File

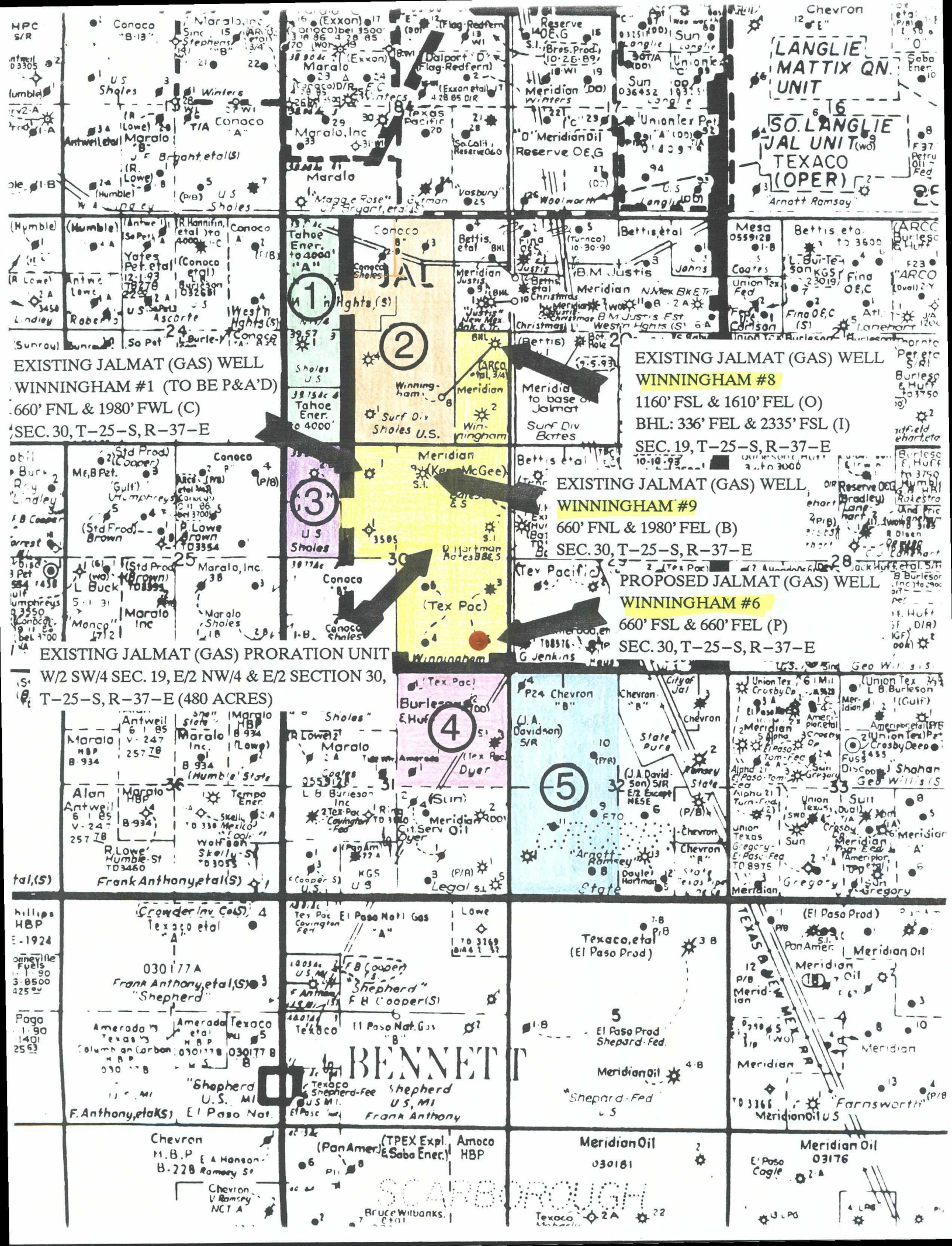

HPC S/R
03305
tumble
rv2-A
rv2-1-A
le 1-B
(Humble)
W 4
Conoco
"B-13"
Sinc
15
Stephens
141
No. 21
22
Shales
3
1 Winters
28
WI
37 WI
T/A Conoco
A
Maralo
J F Bryant et al (S)
(R) Lowe
B
(Humble)
5
U.S.
7
Shales
(P/B)
U.S.

(Humble)
(Humble)
(R) Lowe
Lindley
Sunrout
Sunrout
So Pet
So Pet
Yates
Pet et al
12-193
7878
22-193
U.S.
Ascor
West
Hights (S)
24
Burley
Conoco
A
832

EXISTING JALMAT (GAS) WELL
WINNINGHAM #1 (TO BE P&A'D)
660' FNL & 1980' FWL (C)
SEC. 30, T-25-S, R-37-E

abil
Burr
Ray
Lindley
B Cooper
arrest
B. S
3 Pet
3350
Lumpreys
3350
Conoco
Bel 3700
14
Std Prod
2 Cooper
Me, B Pet
Gulf
Lumpreys
3700
Std Prod
Brown
3354
Maralo, Inc.
38
Maralo
Shales
18
28
1-B
Conoco
Shales

EXISTING JALMAT (GAS) PRORATION UNIT
W/2 SW/4 SEC. 19, E/2 NW/4 & E/2 SECTION 30,
T-25-S, R-37-E (480 ACRES)

Maralo
HBP
B 934
257.78
Alan
Antwell
6 1 85
V-247
B-934
257.78
R Lowe
Humble
T 3460
Frank Anthony et al (S)
Maralo
HBP
B 934
257.78
Maralo
Inc.
(Lowe)
B 934
Humble State
Tempo
Ener.
0 330 Mexico
Wohlsch
Skelly-S
03055
Frank Anthony et al (S)

hillips
HBP
E-1924
anneville
Fuels
3-8500
42500
Pago
1-90
1401
2503
Crowder Inv. Co (S)
Texaco et al
A
030177A
Frank Anthony et al (S)
"Shepherd"
Amerada
Texaco
HBP
Columbian Carbon
0301178
030177B
"Shepherd"
U.S. MI
F. Anthony et al (S)
Chevron
H.B.P. & Hanson
B-228 Ramsey St
Chevron
V Ramsey
NCT A

Chevron
H.B.P. & Hanson
B-228 Ramsey St
Chevron
V Ramsey
NCT A
(Pan Amer)
(TPEX Expl
& Saba Ener.)
Amoco
HBP
Bruce Wilbanks
Texaco
2A
22

(Exxon)
17
Flag-Redfern
WI
Dallport
Flag-Redfern
2
(Exxon et al)
T
428 85 DIR
Texas
Pacific
20
Sa Calit
Reserve O&G
Vosbury
25
Maggie Rose
German
U F Bryant et al (S)

Conoco
Tahoe
Ener.
to 4000
"A"
Winning-
ham
Surf Div
Shales U.S.
39 57
3
Shales
U.S.
39 57
4
Tahoe
Ener.
to 4000

EXISTING JALMAT (GAS) WELL
WINNINGHAM #8
1160' FSL & 1610' FEL (O)
BHL: 336' FEL & 2335' FSL (I)
SEC. 19, T-25-S, R-37-E

Meridian
Justis
BHL
Meridian
to base of
Jalmat
Surf Div
Bates
Bettis et al
BHL
Meridian
to base of
Jalmat
Surf Div
Bates
Bettis et al
BHL
Meridian
to base of
Jalmat
Surf Div
Bates

EXISTING JALMAT (GAS) WELL
WINNINGHAM #9
660' FNL & 1980' FEL (B)
SEC. 30, T-25-S, R-37-E

Meridian
Justis
BHL
Meridian
to base of
Jalmat
Surf Div
Bates
Bettis et al
BHL
Meridian
to base of
Jalmat
Surf Div
Bates
Bettis et al
BHL
Meridian
to base of
Jalmat
Surf Div
Bates

Texaco
El Paso Nat'l Gas
Covington
Fed
10034
U.S. MI
F B Cooper
Shepherd
F B Cooper (S)
Texaco
El Paso Nat'l Gas
"B"
Texaco
Shepherd-Fed
U.S. MI
Frank Anthony
Texaco
El Paso Nat'l Gas
Covington
Fed
10034
U.S. MI
F B Cooper
Shepherd
F B Cooper (S)
Texaco
El Paso Nat'l Gas
"B"
Texaco
Shepherd-Fed
U.S. MI
Frank Anthony

Texaco
El Paso Nat'l Gas
Covington
Fed
10034
U.S. MI
F B Cooper
Shepherd
F B Cooper (S)
Texaco
El Paso Nat'l Gas
"B"
Texaco
Shepherd-Fed
U.S. MI
Frank Anthony

Reserve
O&G
S.I. Bros. Prod.
10-26-89
10-WI
19
Meridian
DO
Winters
"O" Meridian Oil
Reserve O&G
27
(O)
26 Woolworth
Langlie
AD 51

Bettis et al
BHL
Meridian
to base of
Jalmat
Surf Div
Bates
Bettis et al
BHL
Meridian
to base of
Jalmat
Surf Div
Bates
Bettis et al
BHL
Meridian
to base of
Jalmat
Surf Div
Bates

EXISTING JALMAT (GAS) WELL
WINNINGHAM #6
660' FSL & 660' FEL (P)
SEC. 30, T-25-S, R-37-E

Meridian
Justis
BHL
Meridian
to base of
Jalmat
Surf Div
Bates
Bettis et al
BHL
Meridian
to base of
Jalmat
Surf Div
Bates
Bettis et al
BHL
Meridian
to base of
Jalmat
Surf Div
Bates

EXISTING JALMAT (GAS) WELL
WINNINGHAM #5
660' FSL & 660' FEL (P)
SEC. 30, T-25-S, R-37-E

Meridian
Justis
BHL
Meridian
to base of
Jalmat
Surf Div
Bates
Bettis et al
BHL
Meridian
to base of
Jalmat
Surf Div
Bates
Bettis et al
BHL
Meridian
to base of
Jalmat
Surf Div
Bates

Texaco
El Paso Nat'l Gas
Covington
Fed
10034
U.S. MI
F B Cooper
Shepherd
F B Cooper (S)
Texaco
El Paso Nat'l Gas
"B"
Texaco
Shepherd-Fed
U.S. MI
Frank Anthony

Texaco
El Paso Nat'l Gas
Covington
Fed
10034
U.S. MI
F B Cooper
Shepherd
F B Cooper (S)
Texaco
El Paso Nat'l Gas
"B"
Texaco
Shepherd-Fed
U.S. MI
Frank Anthony

Chevron
12
"E"
LANGLIE
MATTIX QN.
UNIT
SO. LANGLIE
JAL UNIT (WO)
TEXACO
(OPER)
Arnett Ramsay

Mesa
0559128
1-B
Coates
Union Tex
Fed
Fina O&C
(S)
Carson
Bettis et al
BHL
Meridian
to base of
Jalmat
Surf Div
Bates
Bettis et al
BHL
Meridian
to base of
Jalmat
Surf Div
Bates

EXISTING JALMAT (GAS) WELL
WINNINGHAM #4
660' FSL & 660' FEL (P)
SEC. 30, T-25-S, R-37-E

Meridian
Justis
BHL
Meridian
to base of
Jalmat
Surf Div
Bates
Bettis et al
BHL
Meridian
to base of
Jalmat
Surf Div
Bates
Bettis et al
BHL
Meridian
to base of
Jalmat
Surf Div
Bates

EXISTING JALMAT (GAS) WELL
WINNINGHAM #3
660' FSL & 660' FEL (P)
SEC. 30, T-25-S, R-37-E

Meridian
Justis
BHL
Meridian
to base of
Jalmat
Surf Div
Bates
Bettis et al
BHL
Meridian
to base of
Jalmat
Surf Div
Bates
Bettis et al
BHL
Meridian
to base of
Jalmat
Surf Div
Bates

Texaco
El Paso Nat'l Gas
Covington
Fed
10034
U.S. MI
F B Cooper
Shepherd
F B Cooper (S)
Texaco
El Paso Nat'l Gas
"B"
Texaco
Shepherd-Fed
U.S. MI
Frank Anthony

Texaco
El Paso Nat'l Gas
Covington
Fed
10034
U.S. MI
F B Cooper
Shepherd
F B Cooper (S)
Texaco
El Paso Nat'l Gas
"B"
Texaco
Shepherd-Fed
U.S. MI
Frank Anthony

SPECIAL RULES AND REGULATIONS FOR THE JALMAT GAS POOL

The Jalmat Gas Pool, Lea County, New Mexico, was created effective September 1, 1954, from a consolidation of the Jalco and Langmat Pools, which were created February 7, 1953. Gas prorationing was instituted in the Jalco and Langmat Pools January 1, 1954, and was continued after consolidation to form the Jalmat Gas Pool. The Jalmat Gas Pool now includes acreage that was formerly included in the Jal, Cooper-Jal, Eaves, Falby-Yates, Jalco and Langmat Pools.

A. DEFINITIONS

THE VERTICAL LIMITS of the Jalmat Gas Pool shall extend from the top of the Tansill formation to a point 100 feet above the base of the Seven Rivers formation, thereby including all of the Yates formation, except,

In the area described immediately below, the vertical limits of the Jalmat Gas Pool shall extend from the top of the Tansill formation to a point 250 feet above the base of the Seven Rivers formation, thereby including all of the Yates formation:

TOWNSHIP 24 SOUTH, RANGE 36 EAST, NMPM

Section 13: SE/4 NE/4, SE/4

Section 23: E/2 E/2

Section 24: All

Section 25: N/2

Section 26: E/2 NE/4

TOWNSHIP 24 SOUTH, RANGE 37 EAST, NMPM

Section 18: SW/4 NW/4, W/2 SW/4

Section 19: W/2

Section 30: NW/4

A GAS WELL in the Jalmat Gas Pool shall be a well producing from the vertical limits of the pool with a gas-liquid ratio in excess of 100,000 cubic feet of gas per barrel of oil.

AN OIL WELL in the Jalmat Gas Pool shall be a well producing from the vertical limits of the pool and not classified as a gas well as defined above.

THE LIMITING GAS-OIL RATIO for oil wells in the Jalmat Gas Pool shall be 10,000 cubic feet of gas per barrel of oil.

B. WELL LOCATION AND ACREAGE REQUIREMENTS

RULE 2(a) 1. A standard gas proration in the Jalmat Gas Pool shall be 640 acres.

2. A standard oil proration unit in the Jalmat Gas Pool shall be 40 acres.

3. Acreage dedicated to a gas well in the Jalmat Gas Pool shall not be simultaneously dedicated to an oil well in the Jalmat Gas Pool, and the dual completion of a well so as to produce oil from the Yates and oil from the Seven Rivers or Queen formation is prohibited.

RULE 2(b) 1. A gas well in the Jalmat Gas Pool to which 640 acres is dedicated shall be located no nearer than 1650 feet to the outer boundary of the section and no nearer than 330 feet to any governmental quarter-quarter section line or subdivision boundary line.

2. An oil well in the Jalmat Gas Pool shall be located no nearer than 330 feet to the outer boundary of any governmental quarter-quarter section or subdivision boundary line.

(Any well drilled to and producing from the Jalmat Gas Pool prior to September 1, 1954, at a location conforming with the spacing requirements effective at the time said well was drilled, shall be granted a tolerance not exceeding 330 feet with respect to the required distance from the boundary lines.)

RULE 4(b) 2. In establishing a non-standard gas proration unit in the Jalmat Gas Pool, the location of the well with respect to the two nearest boundary lines thereof shall govern the maximum amount of acreage that may be assigned to the well for the purposes of gas proration as follows:

Location	Maximum Acreage
660-660	160 acres
660-990	320 acres
990-990	600 acres

D. ALLOCATION AND GRANTING OF ALLOWABLES

RULE 5. Acreage is the only proration factor in the Jalmat Gas Pool.

(a) A 640 acre proration unit in the Jalmat Gas Pool shall be assigned an Acreage Factor of 4.00, a 160 acre proration unit an Acreage Factor of 1.00, etc.

I. MISCELLANEOUS SPECIAL POOL RULES

RULE 26. Oil wells in the Jalmat Gas Pool shall receive oil and casinghead gas allowables as provided in Rules 503, 505, and 506 of the Division Rules and Regulations.



STATE OF NEW MEXICO
ENERGY, MINERALS AND NATURAL RESOURCES DEPARTMENT

OIL CONSERVATION DIVISION
OIL CONSERVATION DIVISION
HOBBS DISTRICT OFFICE

8-32 AM 9 46

BRUCE KING
GOVERNOR

POST OFFICE BOX 1980
HOBBS, NEW MEXICO 88241-1980
(505) 393-6161

OIL CONSERVATION DIVISION
P. O. BOX 2088
SANTA FE, NEW MEXICO 87501

RE: Proposed:

MC _____
DHC _____
NSL _____
NSP X _____
SWD _____
WFX _____
PMX _____

Gentlemen:

I have examined the application for the:

Meridian Oil Inc. Winningham #6-P 30-25-37
Operator Lease & Well No. Unit S-T-R

and my recommendations are as follows:

OK

Yours very truly,

Gerry Sexton
Gerry Sexton
Supervisor, District 1

/ed

DISTRICT I
P.O. Box 1980, Hobbs, NM 88240

DISTRICT II
P.O. Drawer DD, Artesia, NM 88210

DISTRICT III
1000 Rio Brazos Rd., Aztec, NM 874

OIL CONSERVATION DIVISION

P.O. Box 2088
Santa Fe, New Mexico 87504-2088

NON-STANDARD
SIMULTANEOUS DEDICATION
UNORTHODOX LOCATION

WELL LOCATION AND ACREAGE DEDICATION PLAT

All Distances must be from the outer boundaries of the section

Operator MERIDIAN OIL INC.			Lease WINNINGHAM		Well No. 6
Unit Letter P	Section 30	Township 25-S	Range 37-E	County NMPM	LEA
Actual Footage Location of Well:					
660 feet from the		SOUTH	line and	660 feet from the	EAST line
Ground level Elev. 3010' DF		Producing Formation YATES	Pool JALMAT TANSILL YATES 7-RIVERS		Dedicated Acreage: 480 Acres

1. Outline the acreage dedicated to the subject well by colored pencil or hatchure marks on the plat below.
2. If more than one lease is dedicated to the well, outline each and identify the ownership thereof (both as to working interest and royalty).
3. If more than one lease of different ownership is dedicated to the well, have the interest of all owners been consolidated by communitization, unitization, force-pooling, etc.?
- ☐ Yes ☐ No If answer is "yes" type of consolidation _____
- If answer is "no" list the owners and tract descriptions which have actually been consolidated. (Use reverse side of this form if necessary.) _____
- No allowable will be assigned to the well until all interests have been consolidated (by communitization, unitization, forced-pooling, or otherwise) or until a non-standard unit, eliminating such interest, has been approved by the Division.

[illegible]

OPERATOR CERTIFICATION

I hereby certify that the information contained herein is true and complete to the best of my knowledge and belief.

Signature _____

Printed Name

MARIA L. PEREZ

Position

PRODUCTION ASST.

Company

MERIDIAN OIL INC.

Date _____

7-30-92

SURVEYOR CERTIFICATION

I hereby certify that the well location shown on this plat was plotted from field notes of actual surveys made by me or under my supervision, and that the same is true and correct to the best of my knowledge and belief.

Date Surveyed _____

Signature & Seal of
Professional Surveyor

Certificate No.

0 330 660 990 1320 1650 1980 2310 2640 2000 1500 1000 500