

Ph. 505-622-1299

OIL CONSERVATION DIVISION
RECEIVED

'92 DEC 15 AM 8 56



2709 Resolana Dr.
Roswell, NM 88201

JERRY W. LONG
CONSULTANT

December 14, 1992

STATE OF NEW MEXICO
Energy and Minerals Department
Oil Conservation Division
P.O. Box 2088
Santa Fe, New Mexico 87501-2088

Re: Application for Unorthodox Oil Location
SOCORRO PETROLEUM COMPANY
Keel-West Waterflood Project
Federal Lease LC 029426-A
Eddy County, New Mexico

Gentlemen:

You are respectfully requested to grant administrative approval under Rule 104 F.(I) for an unorthodox location for the following infill producing well within the Keel-West Waterflood Project:

No.19 H.E. West "A" - 1305'FSL, 1305'FEL, Sec. 4, T.17S., R.31E.

The above location does not conform to Rule 104.C.I. because it is located closer than 330' to the governmental quarter-quarter section boundaries. This well will be drilled to about 4900' to produce from the Grayburg-San Andres formation. The well will be drilled at the unorthodox location, in order to prevent waste by developing an efficient production and injection pattern within the Keel-West Waterflood Project, which was approved under Order R-2268, as amended. A royalty owner agreement for the affected leases has previously been filed with your office.

Enclosed are copies of the well location plat, Application to Drill, and a map indicating lease ownership and locations of off-set Grayburg wells. The information in this request is accurate to the best of my knowledge.

A copy of this application has been mailed to the Bureau of Land Management. Please send the approval to SOCORRO PETROLEUM COMPANY at the address below and a copy to me at the letterhead address.

Sincerely yours,

JERRY W. LONG
Permit Agent for:
SOCORRO PETROLEUM COMPANY

1c: SOCORRO PETROLEUM COMPANY
410 17th Street, Ste.430
Denver, CO 80202
Attn: Mr. Keeton Barker

JWL/bll

UNITED STATES
DEPARTMENT OF THE INTERIOR
BUREAU OF LAND MANAGEMENT

APPLICATION FOR PERMIT TO DRILL, DEEPEN, OR PLUG BACK

1a. TYPE OF WORK DRILL <input checked="" type="checkbox"/> DEEPEN <input type="checkbox"/> PLUG BACK <input type="checkbox"/>			5. LEASE DESIGNATION AND SERIAL NO. LC-029426-A		
b. TYPE OF WELL OIL WELL <input checked="" type="checkbox"/> GAS WELL <input type="checkbox"/> OTHER <input type="checkbox"/> SINGLE ZONE <input checked="" type="checkbox"/> MULTIPLE ZONE <input type="checkbox"/>			6. IF INDIAN, ALLOTTEE OR TRIBE NAME		
2. NAME OF OPERATOR Socorro Petroleum Company			3a. Area Code & Phone No. 505/677-2360		
3. ADDRESS OF OPERATOR Loco Hills, NM 88255			7. UNIT ASSIGNMENT NAME		
4. LOCATION OF WELL (Report location clearly and in accordance with any State requirements.) At surface 1305' FEL & 1305' FSL At proposed prod. zone 1305' FEL & 1305' FSL			8. FARM OR LEASE NAME H.E. West "A"		
14. DISTANCE IN MILES AND DIRECTION FROM NEAREST TOWN OR POST OFFICE 11 mi. NE of Loco Hills, New Mexico			9. WELL NO. 19		
10. DISTANCE FROM PROPOSED LOCATION TO NEAREST PROPERTY OR LEASE LINE, FT. (Also to nearest drg. unit line, if any) 1305'			10. FIELD AND POOL, OR WILDCAT Grayburg Jackson		
13. DISTANCE FROM PROPOSED LOCATION TO NEAREST WELL, DRILLING, COMPLETED, OR APPLIED FOR, ON THIS LEASE, FT. 912'			11. SEC., T., R., W., OR BLK. AND SURVEY OR AREA Sec. 4 T17S R31E		
16. NO. OF ACRES IN LEASE 639.56			17. NO. OF ACRES ASSIGNED TO THIS WELL 20		
18. PROPOSED DEPTH 4000'			20. ROTARY OR CABLE TOOLS Rotary		
21. ELEVATIONS (Show whether DF, RT, GR, etc.) 3919' GL			22. APPROX. DATE WORK WILL START 6/1/91		

PROPOSED CASING AND CEMENTING PROGRAM

HOLE SIZE	CASING SIZE	WEIGHT/FOOT	GRADE	THREAD TYPE	SETTING DEPTH	QUANTITY OF CEMENT
12-1/4"	8-5/8"	24 #	J-55 CIRCULAR	8 Rd.	625'	300 sx. Cl. "C"
7-7/8"	5-1/2"	17 #	J-55	8 Rd.	4000'	200 sx. Cl. "C"
					(35)	+ 600 sx. LW

Mud Program

0 - 625' Drill with Fresh water
625 - TO Drill with brine water

BOP Program

Will install on the 8-5/8" surface casing a 10" Series 900 Type "E" Shaffer double hydraulic BOP & will test before drilling into Queen formation.

IN ABOVE SPACE DESCRIBE PROPOSED PROGRAM: If proposal is to deepen or plug back, give data on present productive depth and proposed new productive zone. If proposal is to drill or deepen directionally, give pertinent data on subsurface location and measured and true vertical depths. Give blowout preventer program, if any.

24. John Gould Jr TITLE Manager DATE 6/15/91
(This space for Federal or State office use)

PERMIT NO. _____ APPROVAL DATE _____

APPROVED BY _____ TITLE _____ DATE 7-16-91

APPROVAL SUBJECT TO:

GENERAL REQUIREMENTS AND

UNITED STATES
DEPARTMENT OF THE INTERIOR
BUREAU OF LAND MANAGEMENT

SUNDRY NOTICES AND REPORTS ON WELLS

Do not use this form for proposals to drill or to deepen or reentry to a different reservoir.
Use "APPLICATION FOR PERMIT—" for such proposals

SUBMIT IN TRIPLICATE

FORM APPROVED
Budget Bureau No. 1004-0135
Expires: March 31, 1993

5. Lease Designation and Serial No.

LC 054426 A

6. If Indian, Allottee or Tribe Name

7. If Unit or CA, Agreement Designation

8. Well Name and No.

H.E. WEST "A" #19

9. API Well No.

30-015-26790

10. Field and Pool, or Exploratory Area

Grayburg Jackson

11. County or Parish, State

Eddy Co., N.M.

1. Type of Well

☒ Oil Well ☐ Gas Well ☐ Other

2. Name of Operator

Socorro Petroleum Co.

3. Address and Telephone No.

P.O. Box 37, Loco Hills, NM 88255 (505) 677-3223

4. Location of Well (Footage, Sec., T., R., M., or Survey Description)

1305' FEL, 1305' FSL, Sec 4, T17S-R31E

12. CHECK APPROPRIATE BOX(s) TO INDICATE NATURE OF NOTICE, REPORT, OR OTHER DATA

TYPE OF SUBMISSION

☐ Notice of Intent

☒ Subsequent Report

☐ Final Abandonment Notice

TYPE OF ACTION

☐ Abandonment

☐ Recompletion

☐ Plugging Back

☐ Casing Repair

☒ Altering Casing

☒ Other Extend Application To
Drill Date

☐ Change of Plans

☐ New Construction

☐ Non-Routine Fracturing

☐ Water Shut-Off

☐ Conversion to Injection

☐ Dispose Water

(Note: Report results of multiple completion on Well Completion or Recompletion Report and Log form)

13. Describe Proposed or Completed Operations (Clearly state all pertinent details, and give pertinent dates, including estimated date of starting any proposed work. If well is directionally drilled, give subsurface locations and measured and true vertical depths for all markers and zones pertinent to this work.)*

THE CASING PROGRAM FOR THE SUBJECT WELL WAS CHANGED TO RUN AN ADDITIONAL STRING OF CASING AS SHOWN BELOW:

PROPOSED CASING AND CEMENTING PROGRAM

SIZE OF HOLE	GRADE, SIZE OF CASING	WEIGHT PER FOOT	SETTING DEPTH	QUANTITY OF CEMENT
17 1/2"	13 3/8" J-55	#48	625'	500sx Class C (Circ)
12 1/4"	8 5/8" J-55	#24	1770'	600sx Class C (Circ)
7 7/8"	5 1/2" J-55	#14	4000'	1200sx Class C (Circ)

REQUEST FOR APPLICATION TO DRILL DATE BE EXTENDED FOR ANOTHER YEAR. DATE WOULD BE EXTENDED TO JULY 29, 1993.

ACCEPTED FOR RECORD

4 1992

CARLSBAD, NEW MEXICO

14. I hereby certify that the foregoing is true and correct

Signed

Robert J. [Signature]

Title Production Manager

Date

7-29-92

(This space for Federal or State office use)

Approved by

Adam Salameh

Title

Date

8/4/92

Conditions of approval, if any:

Title 18 U.S.C. Section 1001, makes it a crime for any person knowingly and willfully to make to any department or agency of the United States any false, fictitious or fraudulent statements or representations as to any matter within its jurisdiction.

*See Instruction on Reverse Side

RECEIVED AUG 05 1992

State of New Mexico
Energy, Minerals and Natural Resources Department

OIL CONSERVATION DIVISION

P.O. Box 2088
Santa Fe, New Mexico 87504-2088DISTRICT I
P.O. Box 1980, Hobbs, NM 88240DISTRICT II
P.O. Drawer DD, Artesia, NM 88210DISTRICT III
1000 Rio Brazos Rd., Aztec, NM 87410

WELL LOCATION AND ACREAGE DEDICATION PLAT

All Distances must be from the outer boundaries of the section

Operator Socorro Petroleum Company			Lease H.E. West "A"		Well No. 19
Unit Letter P	Section 4	Township 17 South	Range 31 East	County Eddy	
Actual Footage Location of Well: 1305 feet from the South line and 1305 feet from the East line					
Ground level Elev. 3919	Producing Formation Grayburg		Pool Grayburg Jackson		Dedicated Acreage: 20 Acres

1. Outline the acreage dedicated to the subject well by colored pencil or hatchure marks on the plat below.

2. If more than one lease is dedicated to the well, outline each and identify the ownership thereof (both as to working interest and royalty).

3. If more than one lease of different ownership is dedicated to the well, have the interest of all owners been consolidated by communitization, unitization, force-pooling, etc.?

☐ Yes ☐ No If answer is "yes" type of consolidation _____

If answer is "no" list the owners and tract descriptions which have actually been consolidated. (Use reverse side of this form if necessary.) _____

No allowable will be assigned to the well until all interests have been consolidated (by communitization, unitization, forced-pooling, or otherwise) or until a non-standard unit, eliminating such interest, has been approved by the Division.

OPERATOR CERTIFICATION

I hereby certify that the information contained herein is true and complete to the best of my knowledge and belief.

Signature

Ben D. Gould

Printed Name

Manager

Position

Socorro Petroleum Co.

Company

5/15/91

Date

SURVEYOR CERTIFICATION

I hereby certify that the well location shown on this plat was plotted from field notes of actual surveys made by me or under my supervision, and that the same is true and correct to the best of my knowledge and belief.

Date Surveyed

February 22, 1991

Signature & Seal of
Professional Surveyor

P.R. Patton

Certificate No.

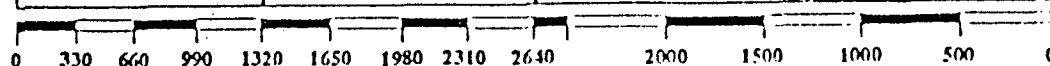
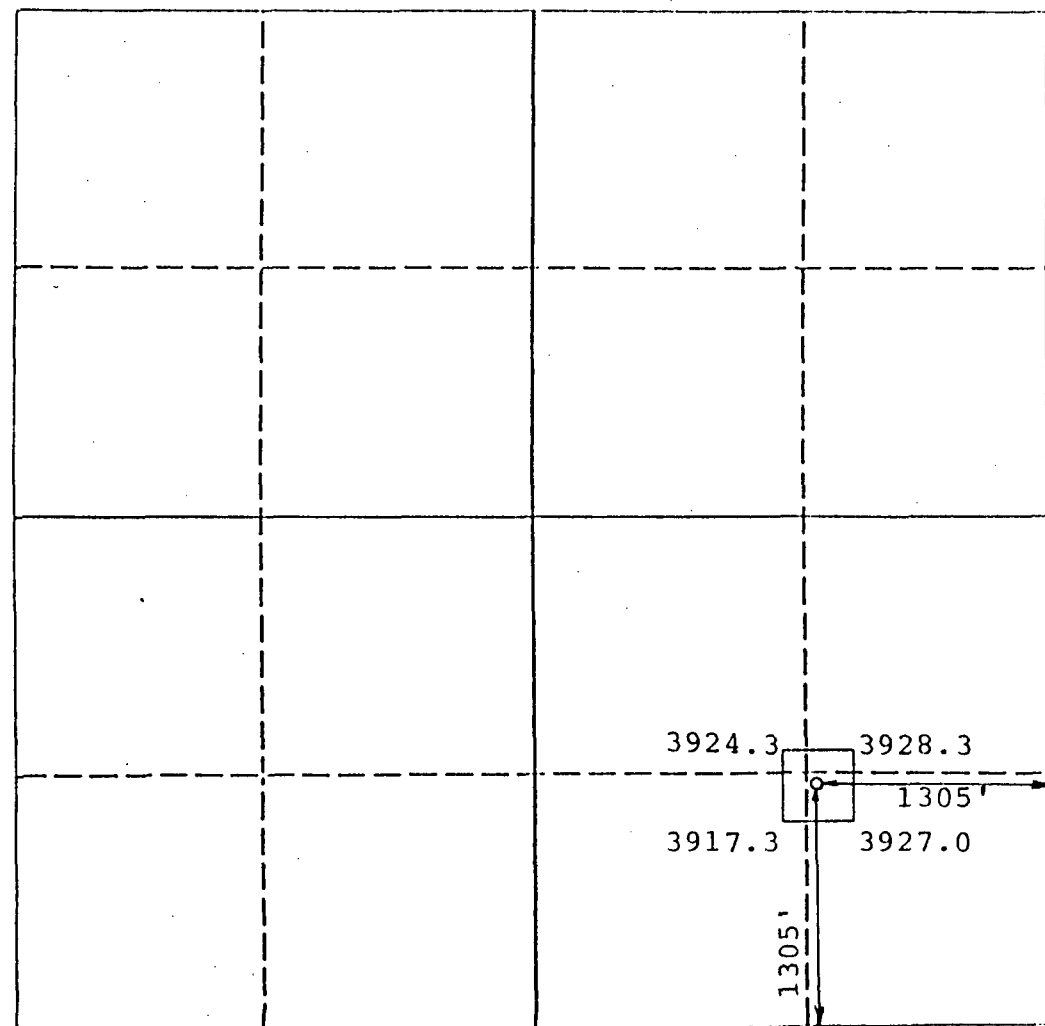
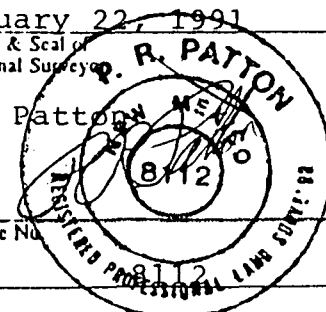

SOCORRO PETROLEUM COMPANY
KEEL-WEST WATERFLOOD PROJECT
Eddy County, New Mexico

T.17S., R.31E.

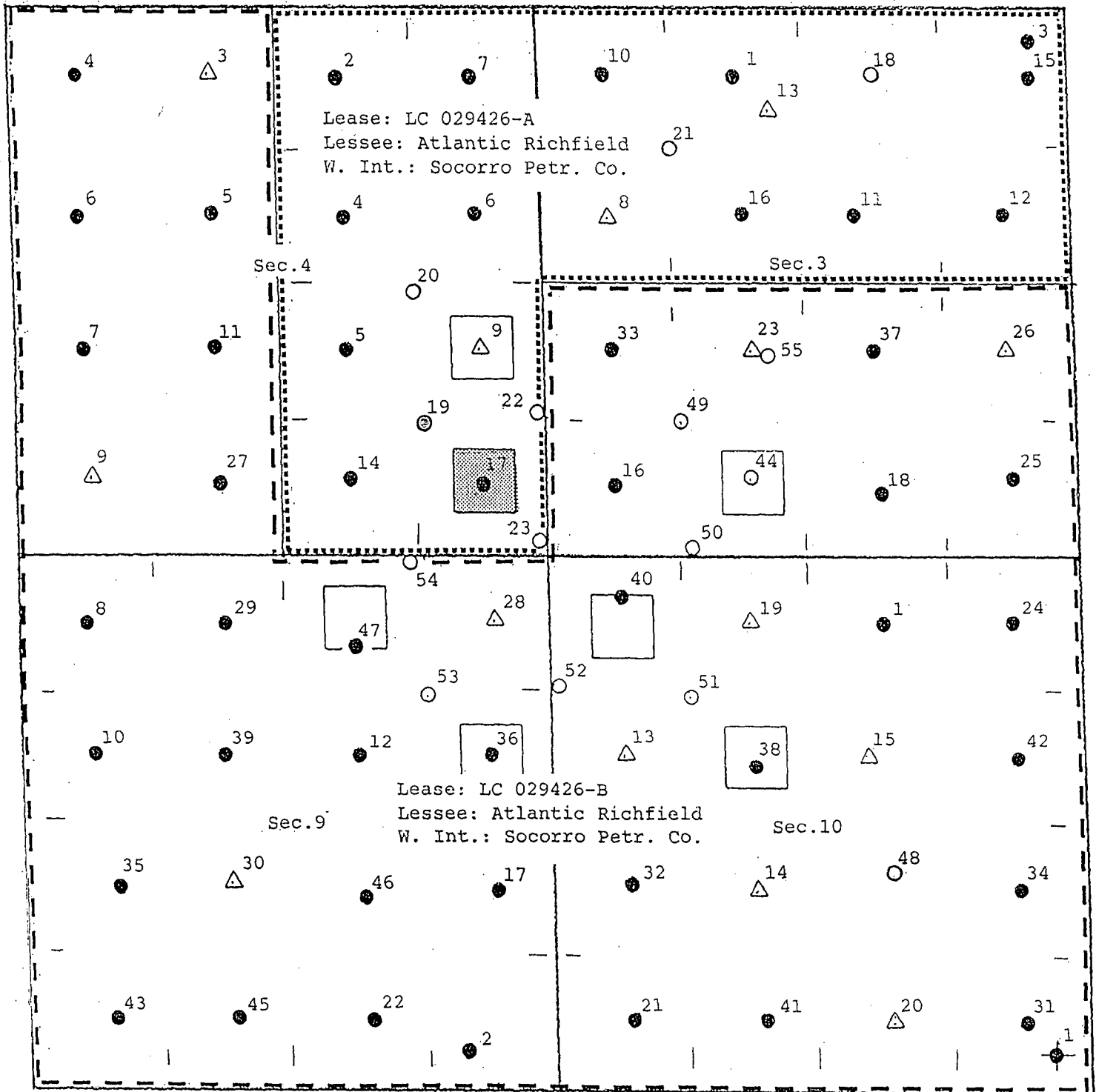

OWNERSHIP MAP
(Grayburg)