



OIL CONSERVATION DIVISION  
RECEIVED

'93 FEB 2 AM 8 41

**Amoco Production Company**

501 WestLake Park Boulevard  
Post Office Box 3092  
Houston, Texas 77253-3092

January 28, 1993

State of New Mexico  
Energy and Minerals Department  
Oil Conservation Division  
P.O. Box 2088  
Santa Fe, NM 87501

Attn: W. J. LeMay, Director

File: KWB-WF

Gentlemen:

**Application for Approval of Unorthodox Location**  
**Empire South Deep Unit Well No. 6**  
**State Lease E-1284-3**  
**Unit P, Sec. 1, T-18S, R-28E**  
**Bear Grass Draw (Atoka) Pool**  
**Eddy County, New Mexico**

Amoco Production Company, as operator of the Empire South Deep Unit, hereby applies for administrative approval to recomplete subject well into the Bear Grass Draw (Atoka) Pool. This well is currently completed in the South Empire-Morrow Pool. This well is currently shut-in due to depletion of the gas in the Morrow and has become uneconomical to operate. This unorthodox well location was authorized by NMOCD Order R-4402.

Required notice of this application has been sent by certified mail to all operators offsetting our lease. Attached is a list of the parties included in our notification.

If additional information is required, please contact me at (713) 584-7213.

Yours very truly,

H. I. Black  
Staff Administrative Analyst

HIB/ms

Attachments  
A:\ESDUWN6.DOC

## OFFSET OPERATORS

SDX Resources, Inc.  
300 W. Texas  
Midland, TX 79701

Harvey E. Yates Company  
Box 1933  
Roswell, NM 88202

Yates, Energy Corporation  
Box 2323  
Roswell, NM 88202

Anadarko Petroleum Corporation  
Box 130  
Artesia, NM 88211-0130

Brothers Production Company  
407 N. Big Springs, Suite 103  
Midland, TX 79702

W. E. Jeffers  
Box 65  
Artesia, NM 88211-0065

Ray Westall Operating, Inc.  
Box 4  
Loco Hills, NM 88255

DeKalb Energy Company  
Box 1302  
Artesia, NM 88211-1302

Kersey & Company  
Box 316  
Artesia, NM 88210

Submit to Appropriate  
District Office  
State Lease - 6 copies  
Fee Lease - 5 copies

State of New Mexico  
Energy, Minerals and Natural Resources Department

Form C-101  
Revised 1-1-89

OIL CONSERVATION DIVISION

DISTRICT I  
P.O. Box 1980, Hobbs, NM 88240

DISTRICT II  
P.O. Drawer DD, Artesia, NM 88210

DISTRICT III  
1000 Rio Brazos Rd., Aztec, NM 87410

P.O. Box 2088  
Santa Fe, New Mexico 87504-2088

API NO. (assigned by OCD on New Wells)

30-015-21562

5. Indicate Type of Lease

STATE ☒

FEE ☐

6. State Oil & Gas Lease No.

E-1284-3

APPLICATION FOR PERMIT TO DRILL, DEEPEN, OR PLUG BACK

1a. Type of Work:

DRILL ☐

RE-ENTER ☐

DEEPEN ☐

PLUG BACK ☒

b. Type of Well:

OIL  
WELL ☐

GAS  
WELL ☒

OTHER

SINGLE  
ZONE ☒

MULTIPLE  
ZONE ☐

7. Lease Name or Unit Agreement Name

Empire South Deep Unit

8. Well No.

6

2. Name of Operator

Amoco Production Company Rm. 17.184

3. Address of Operator

P.O. Box 3092 Houston, TX 77253

9. Pool name or Wildcat

Bear Grass Draw (Atoka)

4. Well Location

Unit Letter P : 1315 Feet From The South Line and 1315 Feet From The East Line

Section 1

Township 18-S

Range 28-E

NMPM Eddy

County

10. Proposed Depth

11. Formation

Atoka

12. Rotary or C.T.

Rotary

13. Elevations (Show whether DF, RT, GR, etc.)

3664 GL

14. Kind & Status Plug Bond

15. Drilling Contractor

16. Approx. Date Work will start

ASAP

17.

PROPOSED CASING AND CEMENT PROGRAM

SIZE OF HOLE	SIZE OF CASING	WEIGHT PER FOOT	SETTING DEPTH	SACKS OF CEMENT	EST. TOP
17 1/2"	13 3/8"	54.5	406'	725 SX	Circ
12 1/4"	9 5/8"	32 + 36	2900'	2025 SX	Circ
8 3/4"	5 1/2"	15.5 + 17	11065'	2920 SX	

Abandon the Morrow and complete in the Atoka.

Unorthodox well location authorized by NMCD Order R-4402.

1. RUSU X KILL WELL X POH W/ TBG X PKR.

2. SET CIBP @ 10650' X CAP W/ 35' CMT.

3. RIH W/ TBG X PKR X SET PKR @ APPROX 10100'. LOAD BACKSIDE W/ PKR  
FLUID X SWAB DOWN TBG TO APPROX 6000' TO PERFORATE.

4. RIG UP MASH TRUCK X LUBRICATOR.

5. PERFORATE W/ THRU TBG 2 1/8" STRIP GUN @ 4 JS PF X PERF 10230'-10238' X  
10360'-10364'.

6. SWAB/FLOW TO TST X RETURN TO PRODUCTION

IN ABOVE SPACE DESCRIBE PROPOSED PROGRAM: IF PROPOSAL IS TO DEEPEN OR PLUG BACK, GIVE DATA ON PRESENT PRODUCTIVE ZONE AND PROPOSED NEW PRODUCTIVE  
ZONE. GIVE BLOWOUT PREVENTER PROGRAM, IF ANY.

I hereby certify that the information above is true and complete to the best of my knowledge and belief.

SIGNATURE

H. I. Black

TITLE

Stf. Admin. Analyst

DATE

1-28-93

TYPE OR PRINT NAME

H. I. BLACK

713-584-7213  
TELEPHONE NO.

(This space for State Use)

APPROVED BY

TITLE

DATE

CONDITIONS OF APPROVAL, IF ANY:

NEW MEXICO OIL CONSERVATION COMMISSION  
WELL LOCATION AND ACREAGE DEDICATION PLAT

Form C-102  
Supersedes C-12  
Effective 1-1-65

All distances must be from the outer boundaries of the Section.

Operator <b>AMOCO PRODUCTION COMPANY</b>			Lease <b>Empire South Deep Unit</b>		Well No. <b>6</b>
Unit Letter <b>P</b>	Section <b>1</b>	Township <b>18 South</b>	Range <b>28 East</b>	County <b>Eddy</b>	
Actual Footage Location of Well: <b>1315</b> feet from the <b>south</b> line and <b>1315</b> feet from the <b>east</b> line					
Ground Level Elev. <b>3664.0</b>	Producing Formation <b>Atoka</b>		Pool <b>Bear Grass Draw</b>	Dedicated Acreage: <b>320</b> Acres	

1. Outline the acreage dedicated to the subject well by colored pencil or hachure marks on the plat below.
2. If more than one lease is dedicated to the well, outline each and identify the ownership thereof (both as to working interest and royalty).
3. If more than one lease of different ownership is dedicated to the well, have the interests of all owners been consolidated by communitization, unitization, force-pooling, etc?

☐ Yes ☐ No If answer is "yes," type of consolidation.

If answer is "no," list the owners and tract descriptions which have actually been consolidated. (Use reverse side of this form if necessary.)

No allowable will be assigned to the well until all interests have been consolidated (by communitization, unitization, forced-pooling, or otherwise) or until a non-standard unit, eliminating such interests, has been approved by the Commission.

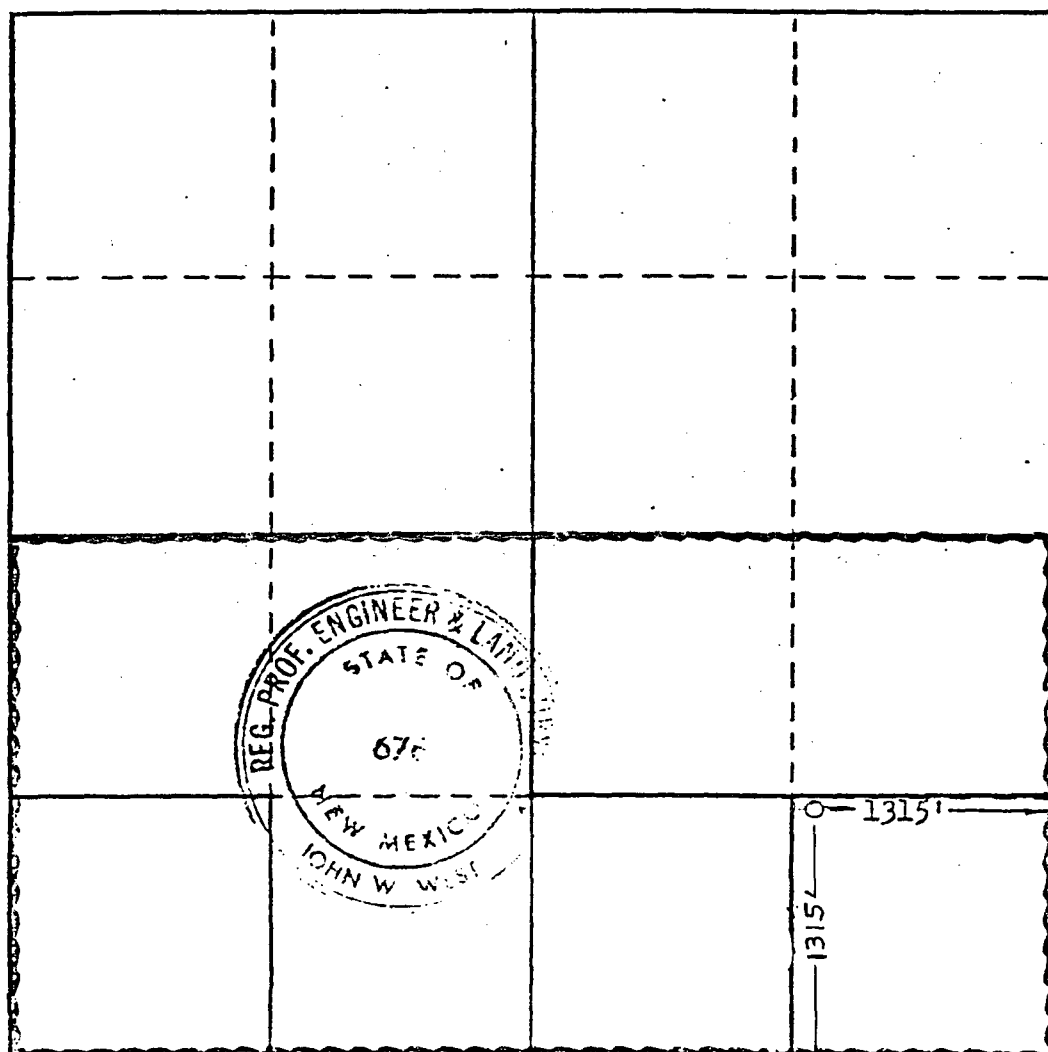

COUNTY Eddy POOL Empire - Pennsylvanian Gas

TOWNSHIP 10-South RANGE 20-East NMPM

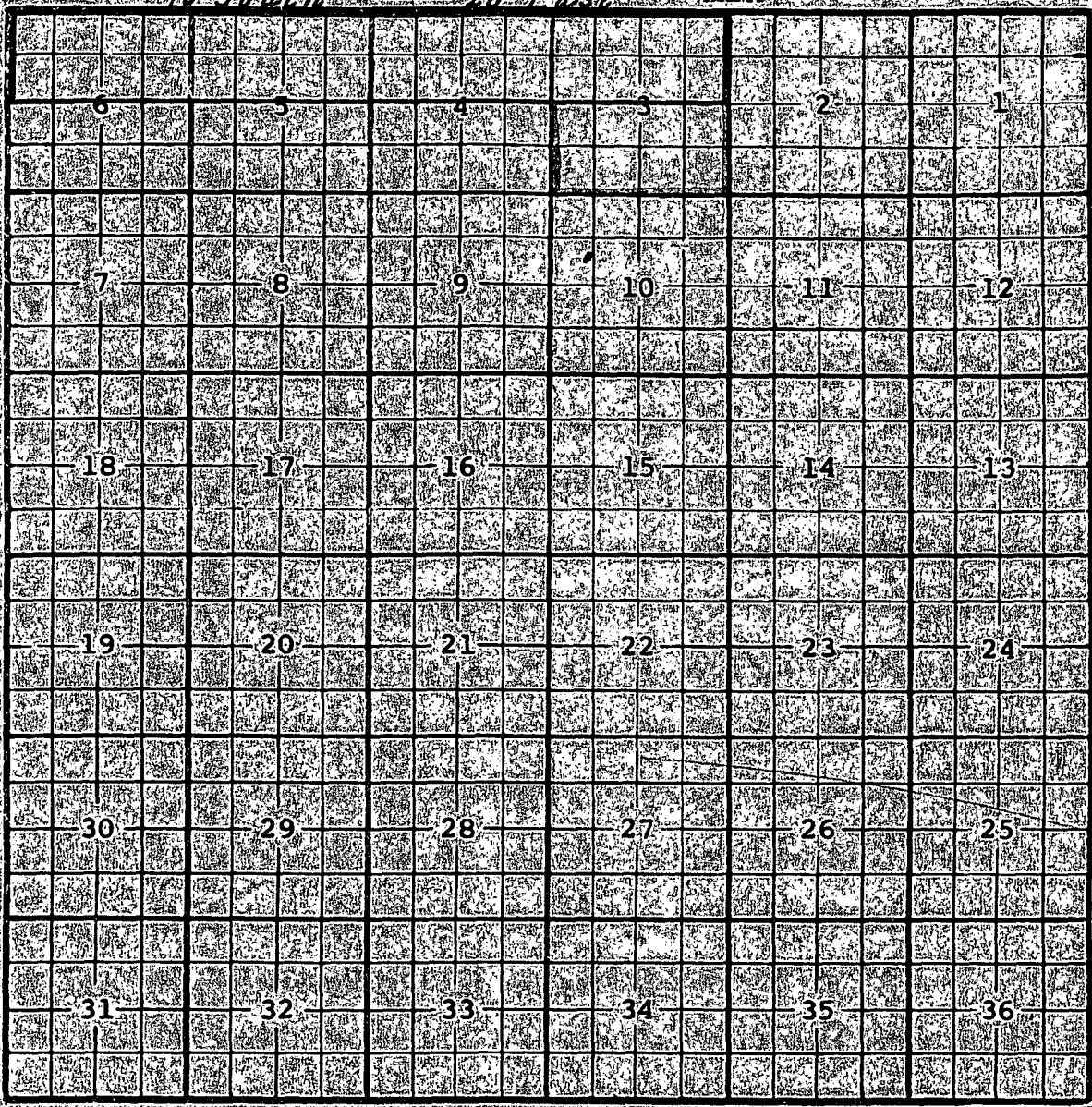

Description: 1/4 Sec. 3, 1/4 Sec. 4, 1/4 Sec. 5, 1/4 Sec. 6 (R-391, 11-25-53)  
Est. Sec. 3 1/2 (R-7048, 8-9-80)

Blank lined area for additional notes or calculations.



Pool BEAR GRASS DRAW - ATOKA GAS

185

## Range

29 E

**NMPM**

DESC: S/2 SEC 5 (R-9241 7-31-90)

BEFORE THE OIL CONSERVATION COMMISSION  
OF THE STATE OF NEW MEXICO

IN THE MATTER OF THE HEARING  
CALLED BY THE OIL CONSERVATION  
COMMISSION OF NEW MEXICO FOR  
THE PURPOSE OF CONSIDERING:

CASE NO. 4812  
Order No. R-4402

APPLICATION OF MIDWEST OIL  
CORPORATION FOR AN UNORTHODOX  
LOCATION, EDDY COUNTY, NEW  
MEXICO.

ORDER OF THE COMMISSION

BY THE COMMISSION:

This cause came on for hearing at 9 a.m. on September 13, 1972, at Santa Fe, New Mexico, before Examiner Daniel S. Nutter.

NOW, on this 22nd day of September, 1972, the Commission, a quorum being present, having considered the testimony, the record, and the recommendations of the Examiner, and being fully advised in the premises,

FINDS:

(1) That due public notice having been given as required by law, the Commission has jurisdiction of this cause and the subject matter thereof.

(2) That the applicant, Midwest Oil Corporation, seeks an exception to Rule 104 of the Commission Rules and Regulations for approval of a gas well location 1315 feet from the South line and 1315 feet from the East line of Section 1, Township 18 South, Range 28 East, NMPM, to test the Morrow formation, adjacent to the South Empire-Morrow Gas Pool, Eddy County, New Mexico.

(3) That the S/2 of said Section 1 is to be dedicated to the well.

(4) That a well drilled at the proposed location should encounter a more porous section of the subject formation than a well drilled at a standard location.

(5) That approval of the subject application will afford the applicant the opportunity to produce its just and equitable share of the gas in the subject pool, will prevent the economic loss caused by the drilling of unnecessary wells, avoid the augmentation of risk arising from the drilling of an excessive number of wells, and will otherwise prevent waste and protect correlative rights.

IT IS THEREFORE ORDERED:

(1) That an unorthodox gas well location for the Morrow formation is hereby approved for the Midwest Oil Corporation's Empire South Deep Unit Well No. 4, to be located at a point 1315 feet from the South line and 1315 feet from the East line of Section 1, Township 18 South, Range 28 East, NMPM, adjacent to the South Empire-Morrow Gas Pool, Eddy County, New Mexico, as an exception to Rule 104 of the Commission Rules and Regulations.

(2) That the S/2 of said Section 1 shall be dedicated to the above-described well.

(3) That jurisdiction of this cause is retained for the entry of such further orders as the Commission may deem necessary.

DONE at Santa Fe, New Mexico, on the day and year hereinabove designated.

STATE OF NEW MEXICO  
OIL CONSERVATION COMMISSION

BRUCE KING, Chairman

ALEX J. ARMIJO, Member

A. L. PORTER, Jr., Member & Secretary

S E A L

dr/