

1R - 289

REPORTS

DATE:

04/30/2007

1R 0289



Matthew P. Hudson
Remediation Project
Manager

**Abandonment Business
Unit**

Chevron Environmental
Management Company
11111 S Wilcrest Dr
Room N2104A
Houston, TX 77009
Tel 281 561 3466
Fax 281 561 3841
mhkw@chevron.com

April 30, 2007

Mr. Glenn Von Gonten
Senior Hydrologist
Environmental Bureau
New Mexico Oil Conservation Division
1220 South St. Francis Drive
Santa Fe, New Mexico 87505

**Subject: 2006 Annual Groundwater Monitoring Report Addendum/Geological Cross Sections
Cooper-Jal Unit South Injection Station
NW/4, NW/4, SE/4, Section 24, Township 24 South, Range 36 East,
Lea County, New Mexico
OGRID No. 4323
Case #1R289**

Dear Mr. Von Gonten:

Please find enclosed two additional figures as an addendum (per our 3/7/07 meeting) to the above-referenced report. The figures illustrate geological cross sections detailing site lithology, monitor well screen intervals, and groundwater level elevations.

Should you have any questions or comments concerning this addendum, please call me at (281) 561-3466 or Luke Markham with CRA at (432) 686-0086.

Sincerely,

A handwritten signature in black ink, appearing to read "Matthew P. Hudson", written in a cursive style.

Matthew P. Hudson

Enclosure: FIGURE 1 – A-A' Transect Map
FIGURE 2 – A-A' Cross Section

Cc: Patricia Caperton, NMOCD (electronic copy)
Luke Markham, CRA (cover letter only)

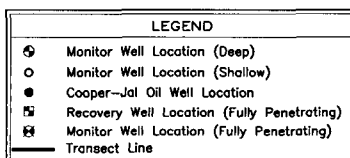
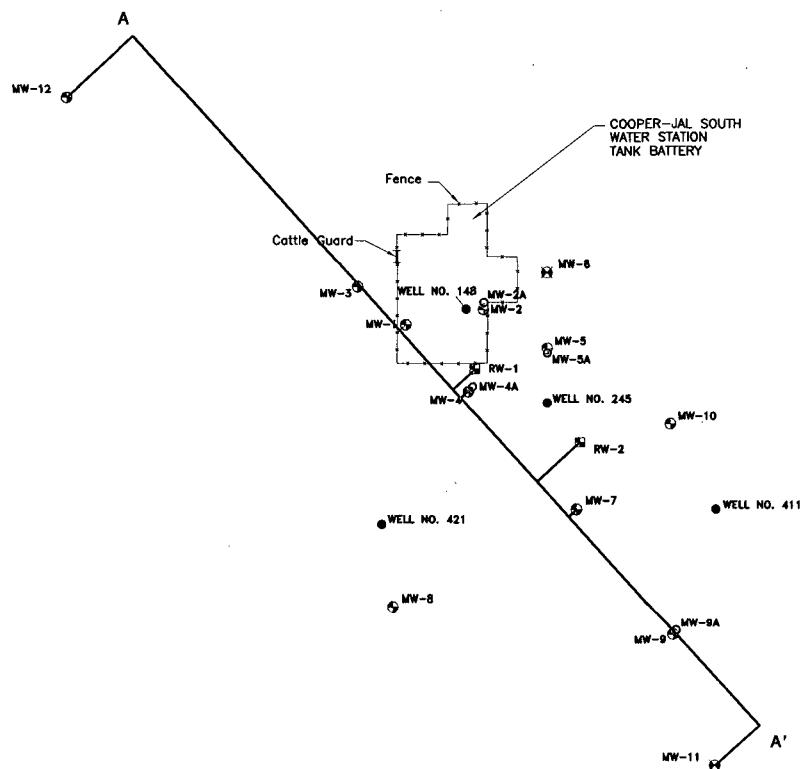

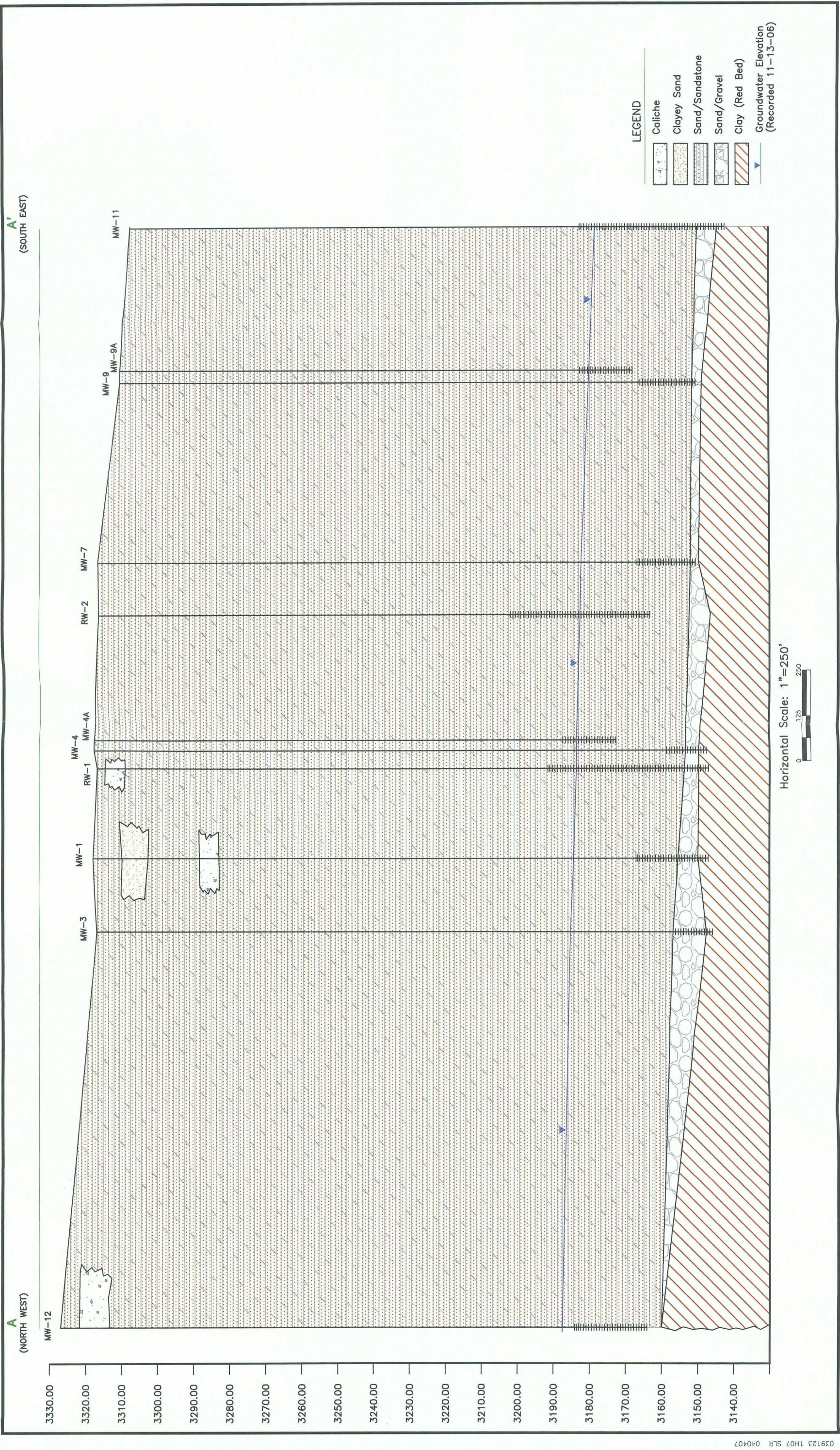

039123 1H07 SLR 040407