

CAMPBELL, CARR, BERGE
& SHERIDAN, P.A.
LAWYERS

MICHAEL B. CAMPBELL
WILLIAM F. CARR
BRADFORD C. BERGE
MARK F. SHERIDAN
WILLIAM P. SLATTERY

PATRICIA A. MATTHEWS
MICHAEL H. FELDEWERT
DAVID B. LAWRENZ
TANYA M. TRUJILLO

JACK M. CAMPBELL
OF COUNSEL

JEFFERSON PLACE
SUITE 1 - 110 NORTH GUADALUPE
POST OFFICE BOX 2208
SANTA FE, NEW MEXICO 87504-2208
TELEPHONE: (505) 988-4421
TELECOPIER: (505) 983-6043

November 19, 1993

HAND-DELIVERED

William J. LeMay, Director
Oil Conservation Division
New Mexico Department of Energy,
Minerals and Natural Resources
State Land Office Building
Santa Fe, New Mexico 87503

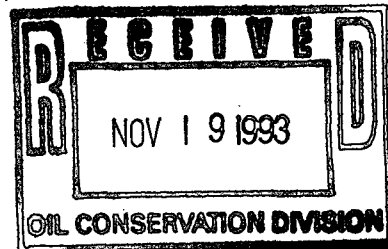

Re: Application of Collins & Ware, Inc. for Administrative Approval of an Unorthodox Well Location for its Sheep Draw Federal No. 6 Well, located 1190 feet from the North line and 990 feet from the West line of Section 33, Township 22 South, Range 26 East, Eddy County, New Mexico.

Dear Mr. LeMay:

Collins & Ware, Inc. hereby requests administrative approval of an unorthodox well location for its Sheep Draw Federal No. 6 Well. The proposed location will be in the Delaware formation, Happy Valley Delaware Pool, at a point 1190 feet from the North Line and 990 feet from the West line of Section 33, Township 22 South, Range 26 East, N.M.P.M., Eddy County, New Mexico. This unorthodox location is necessary due to an archaeological site located in the NW/4 NW/4 of Section 33 which causes, this location to be unorthodox.

Attached to this application is a plat showing the acreage which is the subject of this application identifying the operations of the offsetting leases and wells completed thereon and showing the extent of this archaeological site. Also attached is a copy of an archaeological survey which also locates this site. As you will note, Collins & Ware, Inc., is the operator of all tracts offsetting this spacing unit.

William J. LeMay, Director
Oil Conservation Division
New Mexico Department of Energy,
Minerals and Natural Resources
November 19, 1993
Page 2

Your consideration of this administrative application is appreciated.

Very truly yours,

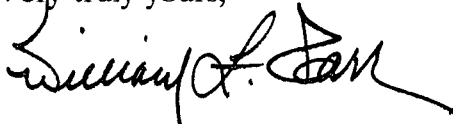
A handwritten signature in black ink, appearing to read "William F. Carr", with a stylized flourish at the end.

WILLIAM F. CARR

WFC:mlh
Enclosures

cc: M. B. Williams, Supervisor (w/enclosures)
District II
Post Office Drawer DD
Artesia, NM 88210

Ron J. King, Landman (w/enclosures)
Collins & Ware, Inc.
303 W. Wall Avenue, Suite 2200
Midland, TX 79701

County Eddy Pool Happy Valley - Delaware

TOWNSHIP 22 South Range 26 East NMPM

6	5	4	3	2	1
7	8	9	10	11	12
18	17	16	15	14	13
19	20	21	22	23	24
30	29	28	27	26	25
31	32	33	34	35	36

Descriptions NE¹/₄ NW¹/₄ Sec. 33 (R-9832, 1-27-93)

Ext: NW¹/₄ NW¹/₄ and S¹/₂ NW¹/₄ Sec. 33 (R-9963, 9-20-93)

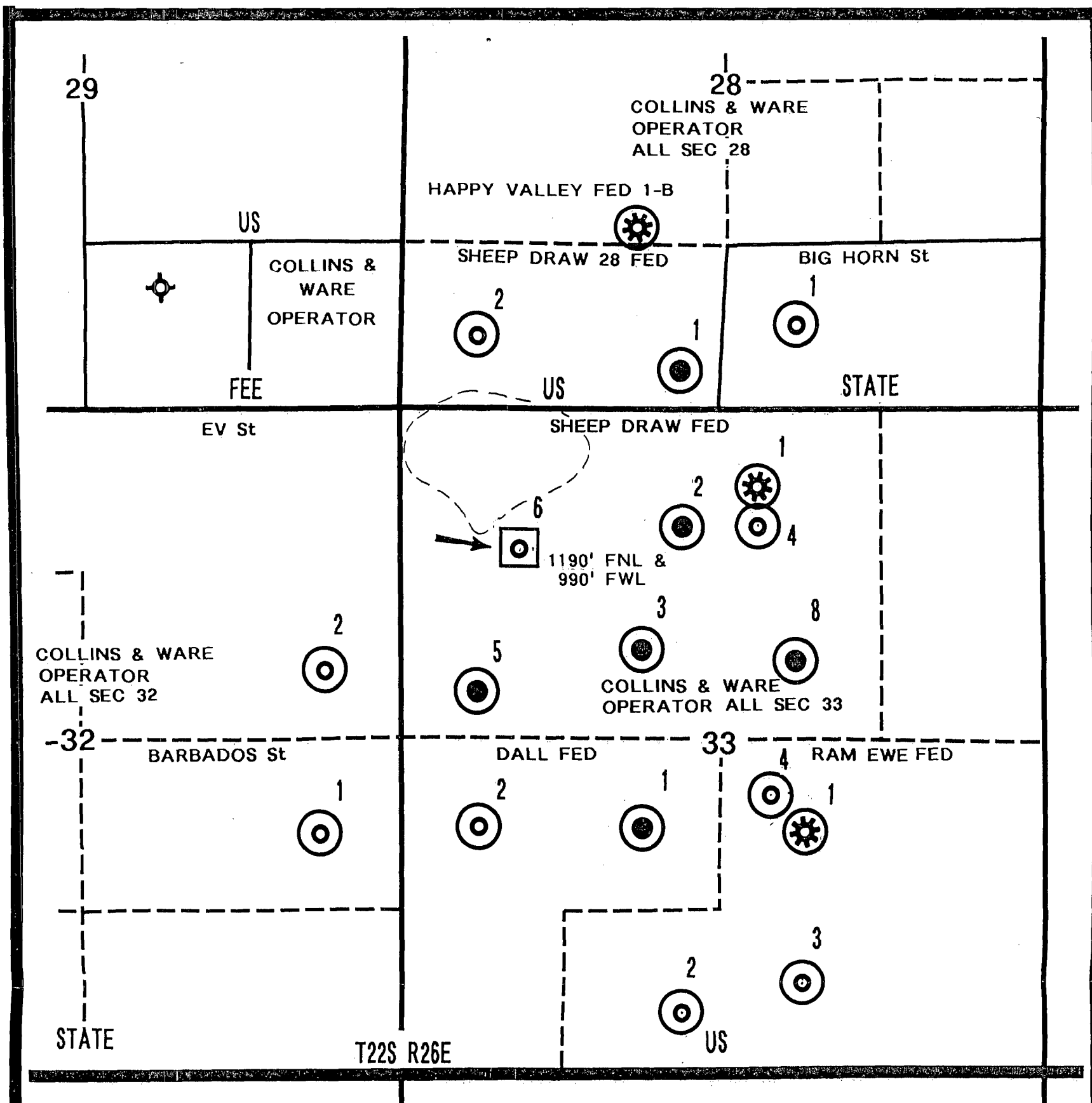

LEGEND WORKING INTEREST

	COLLINS & WARE, INC	MEWBOURNE	SANTA FE ENERGY	AMOCO PROD COMPANY
<input type="checkbox"/>	.60000	.25000	.15000	
<input type="checkbox"/>	.53125		.09375	.37500
<input type="checkbox"/>	.75625	.09375	.15000	



PROPOSED LOCATION



STAKED LOCATION

PRODUCERS



DELAWARE



STRAWN



MORROW



ARCHAEOLOGICAL SITE

COLLINS & WARE

HAPPY VALLEY DELAWARE FIELD
EDDY COUNTY, NEW MEXICO

OWNERSHIP MAP

SCALE 1:1000

**AN ARCHAEOLOGICAL SURVEY OF
FOUR PROPOSED WELL LOCATIONS,
ASSOCIATED ACCESS ROADS, AND A PIPELINE
EASEMENT AT SHEEP DRAW,
EDDY COUNTY, NEW MEXICO**

Sheep Draw Federal #6 Relocation
Ram Ewe Federal #2
Ram Ewe Federal #3
Ram Ewe Federal #4

Prepared by
Don Clifton
for
Collins and Ware, Inc.

Bureau of Land Management
Cultural Resource Use Permit 83-2920-93-E

Report Number 57
October, 1993

DON CLIFTON
ARCHAEOLOGICAL CONSULTANT

**AN ARCHAEOLOGICAL SURVEY OF
FOUR PROPOSED WELL LOCATIONS, ASSOCIATED ACCESS ROADS,
AND A PIPELINE EASEMENT AT SHEEP DRAW,
EDDY COUNTY, NEW MEXICO**

Sheep Draw Federal #6 Relocation
Ram Ewe Federal #2
Ram Ewe Federal #3
Ram Ewe Federal #4

Prepared by
Don Clifton
for
Collins and Ware, Inc.

Bureau of Land Management
Cultural Resource Use Permit 83-2920-93-E

Report Number 57
October, 1993

ABSTRACT

Between October 7 and 15, 1993, an archaeological survey of four proposed well locations, associated access roads, and a pipeline easement was conducted. The archaeological project was performed by Don Clifton, Archaeological Consultant, for Collins and Ware, Inc. The archaeological survey was performed on Bureau of Land Management lands in Eddy County, New Mexico, under provisions of Cultural Resource Use Permit 83-2920-93-E. A total of 18.6 acres was inspected for cultural resources.

Previously recorded Site LA84820 was relocated and portions of its boundary flagged for avoidance during the survey.

Archaeological clearance is recommended.

TABLE OF CONTENTS

ABSTRACT.....	1
INTRODUCTION.....	1
ENVIRONMENTAL SETTING.....	4
METHODS.....	4
SURVEY RESULTS.....	4
RECOMMENDATIONS.....	5
REFERENCES CITED.....	5
APPENDIX A - Plan of Proposed Sheep Draw Federal #6.....	6

LIST OF FIGURES

1. PROJECT LOCATION.....	2
2. SURVEY AREA.....	3

INTRODUCTION

An archaeological survey of four proposed well locations, access roads and a pipeline easement has been completed. The archaeological survey was conducted for Collins and Ware, Inc. by Don Clifton, Archaeological Consultant. The proposed areas of impact are on lands under the jurisdiction of the Bureau of Land Management, in Eddy County, New Mexico.

The project was conducted under provisions of Cultural Resource Use Permit 83-2920-93-E which expires on June 16, 1994. Fieldwork was performed between October 7 and 15, 1993.

The project is located southwest of Carlsbad, New Mexico, in Section 33, Township 22 South, Range 26 East. The map source is USGS 7.5' Kitchen Cove, New Mexico, topographic map. A total area of 18.6 acres was inspected for cultural resources during the project.

Proposed Ram Ewe Federal #2 well location is in the SE1/4 SE1/4, SW1/4, Section 33, at 470 feet from the south line and 2,310 feet from the west line. A fence and adjacent trail road cut through the southern edge of the proposed location. The proposed access road is 500 feet long and connects with proposed Ram Ewe Federal #3 well location. A total area of 4.8 acres was inspected for cultural resources.

Proposed Ram Ewe Federal #3 well location is in the SE1/4 SE1/4, Section 33, at 1,980 feet from the east line and 700 feet from the south line. A fence line and two-track road cuts through the southeastern portion of the proposed well location. The proposed access road is 800 feet long and connects with existing Ram Ewe Federal #1 well location. A total area of 5.5 acres was inspected for cultural resources.

Proposed Ram Ewe Federal #4 well location is in the NE1/4 SE1/4, Section 33, at 2,240 feet from the south line and 2,240 feet from the east line. The proposed well location overlaps existing Ram Ewe Federal #1 well location. A total area of 3.7 acres was inspected for cultural resources.

Proposed Sheep Draw Federal #6 relocation is in the SE1/4 NW1/4 NW1/4, Section 33, at 990 feet from the west line and 1,190 feet from the north line. The proposed well location was originally located to the west and north (Clifton 1993). An existing access road cuts through the southeastern corner of the proposed location. A total of 3.7 acres was inspected for cultural resources.

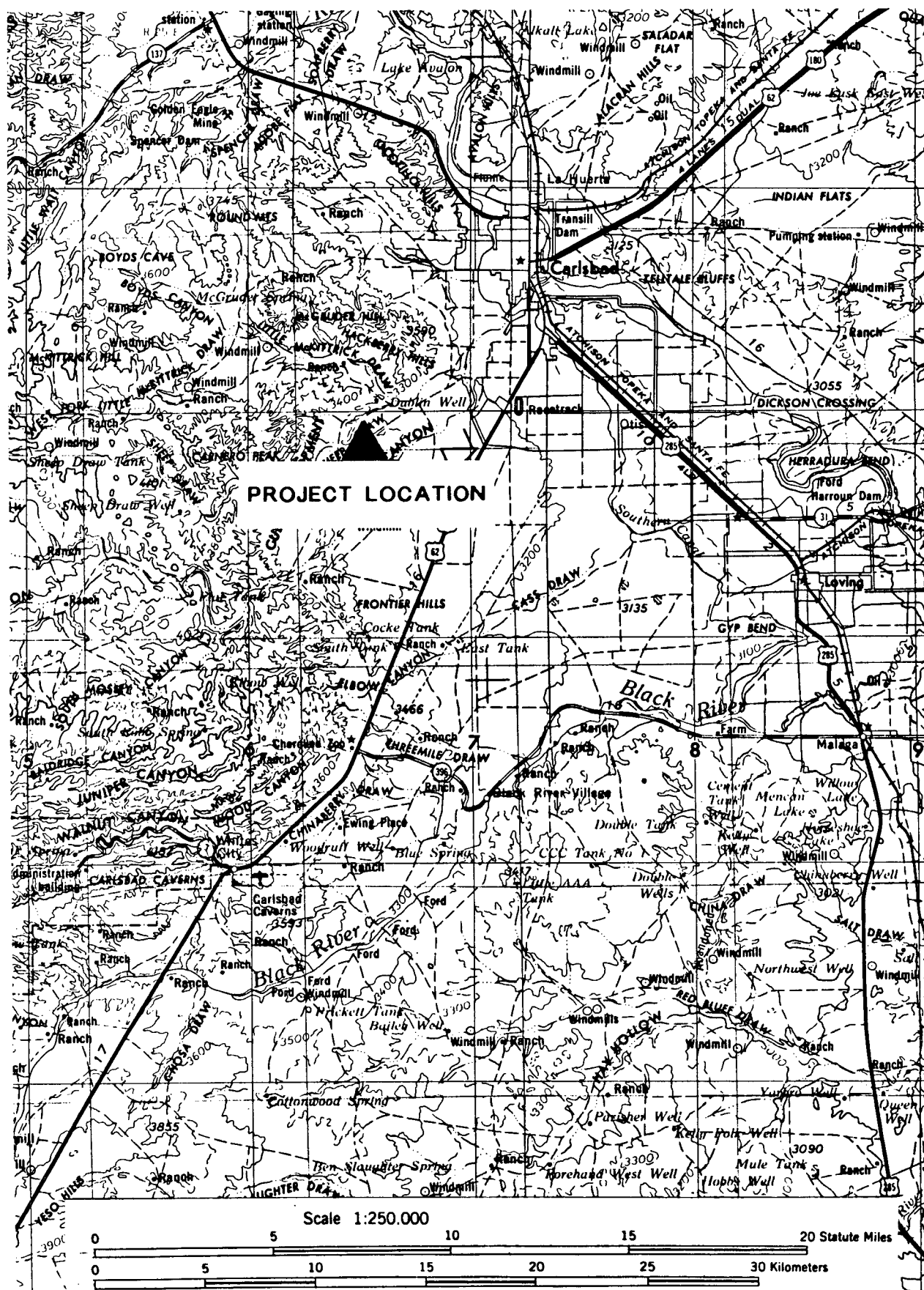

Figure 1. Project Location

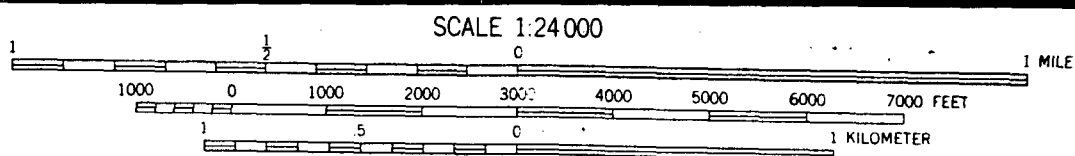
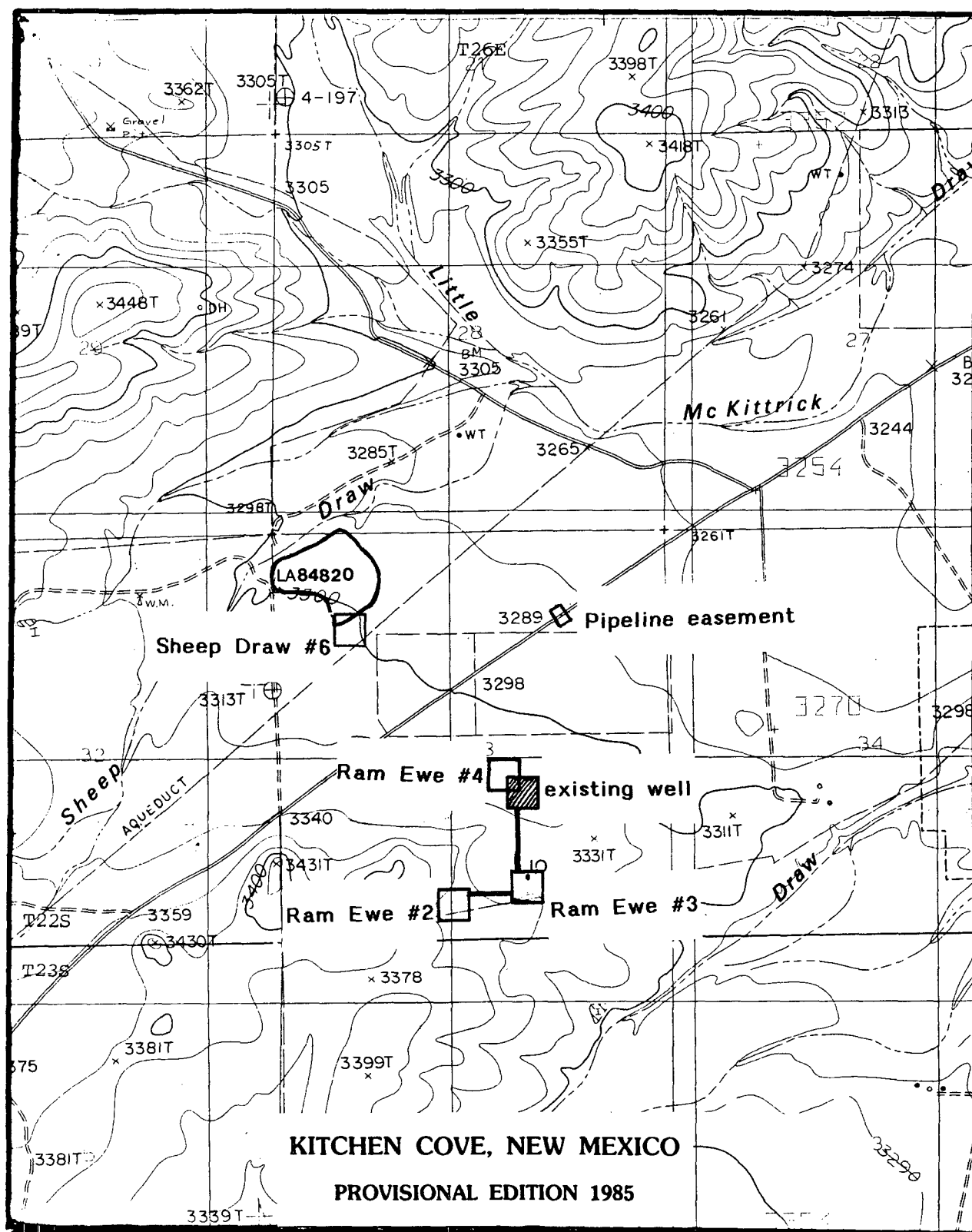

Figure 2. Survey Area

A proposed pipeline easement of 200' x 200' (.9 acres) was inspected for a pipeline to cross an existing paved county road. The proposed easement is in the SE1/4 NW1/4 NE1/4, Section 33. The pipeline will be adjacent to existing access roads.

ENVIRONMENTAL SETTING

The project is located near the foothills of the Guadalupe Mountains. Little McKittrick Draw, its tributary Sheep Draw, and Dark Canyon are the major drainages in the area. Soils are shallow silty loams underlaid by limestone deposits. Vegetation includes shrubs of tarbush, creosote, acacia, mesquite, little leaf sumac, and algerita.

Numerous well locations, pipelines, powerlines, access roads, and other oil well related facilities are in the area.

METHODS

The archaeological survey of the proposed areas of impact was conducted by walking parallel transects spaced no wider than 15m (50 feet) apart. The proposed access roads were also inspected by walking two linear parallel transects spaced 15m apart.

The center of each proposed well location is marked with a metal fence post and each corner is marked with wood lath. A series of wood lath spaced approximately 100 feet apart delineates the access roads.

A records search at the Archaeological Records Management System of the Historic Preservation Division of the State of New Mexico was accomplished prior to fieldwork. A records search was also accomplished at the Bureau of Land Management, Carlsbad Resource Area.

The two records searches revealed previously recorded Sites LA51007 and LA84820 in the vicinity.

SURVEY RESULTS

During the survey, previously recorded Site LA84820 was relocated and one isolated occurrence was found and recorded.

Site LA84820 covers a large area and contains many fire-cracked rock features, flakes, and groundstone artifacts. The age and cultural affiliation of the site is unknown. Proposed Sheep Draw Federal #6 was moved to the south and west to avoid this site. The northern portion of the proposed well location is within the site limits (Appendix A). The site limits were identified with red, white, and blue flagging tape.

The isolated occurrence is the proximal portion of a white chert flake. A lateral edge of the artifact displays utilization and the flake contains 20% cortex. The location of the isolated occurrence is UTM Zone 13, 566300E, 3579480N on the north-central portion of proposed Ram Ewe Federal #3 well location.

RECOMMENDATIONS

To avoid Site LA84820 at proposed Sheep Draw Federal #6, permanent fencing is recommended along the northern portion of the well pad (Appendix A). The single isolated occurrence is not considered significant and, therefore, does not need to be avoided.

Archaeological clearance is recommended for the four proposed well locations, access roads, and the pipeline easement. The only stipulation necessary for the project would be the fencing referred to above at proposed Sheep Draw #6.

REFERENCES CITED

- Clifton, Don
1993 An Archaeological Survey of Five Proposed Well Locations Near Carlsbad, New Mexico. Don Clifton, Archaeological Consultant, Report No. 42, Las Cruces, New Mexico.

APPENDIX A

Plan of Proposed Sheep Draw Federal #6

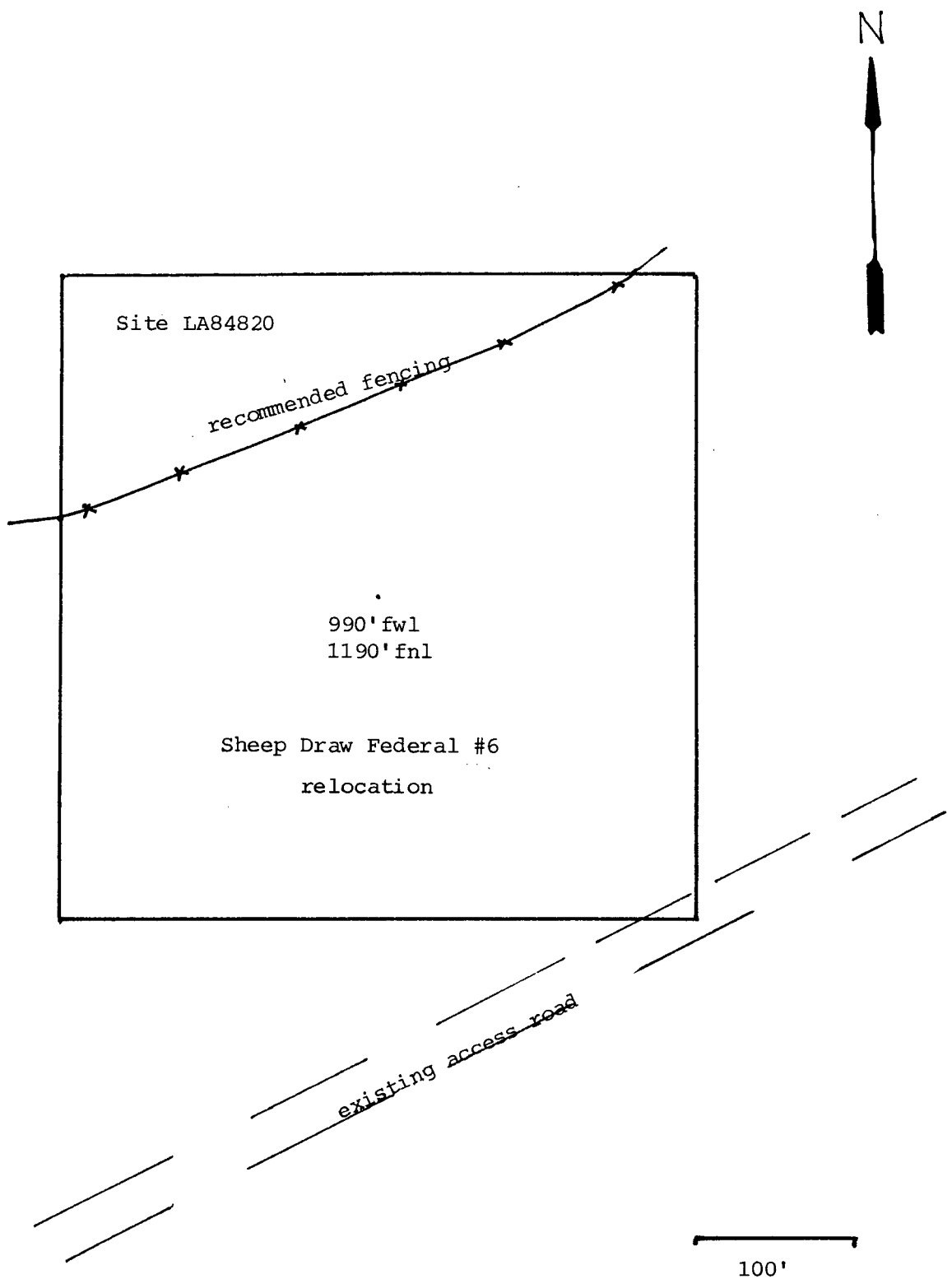

Plan of Sheep Draw Federal #6 relocation

- Happy Valley Del. Pool

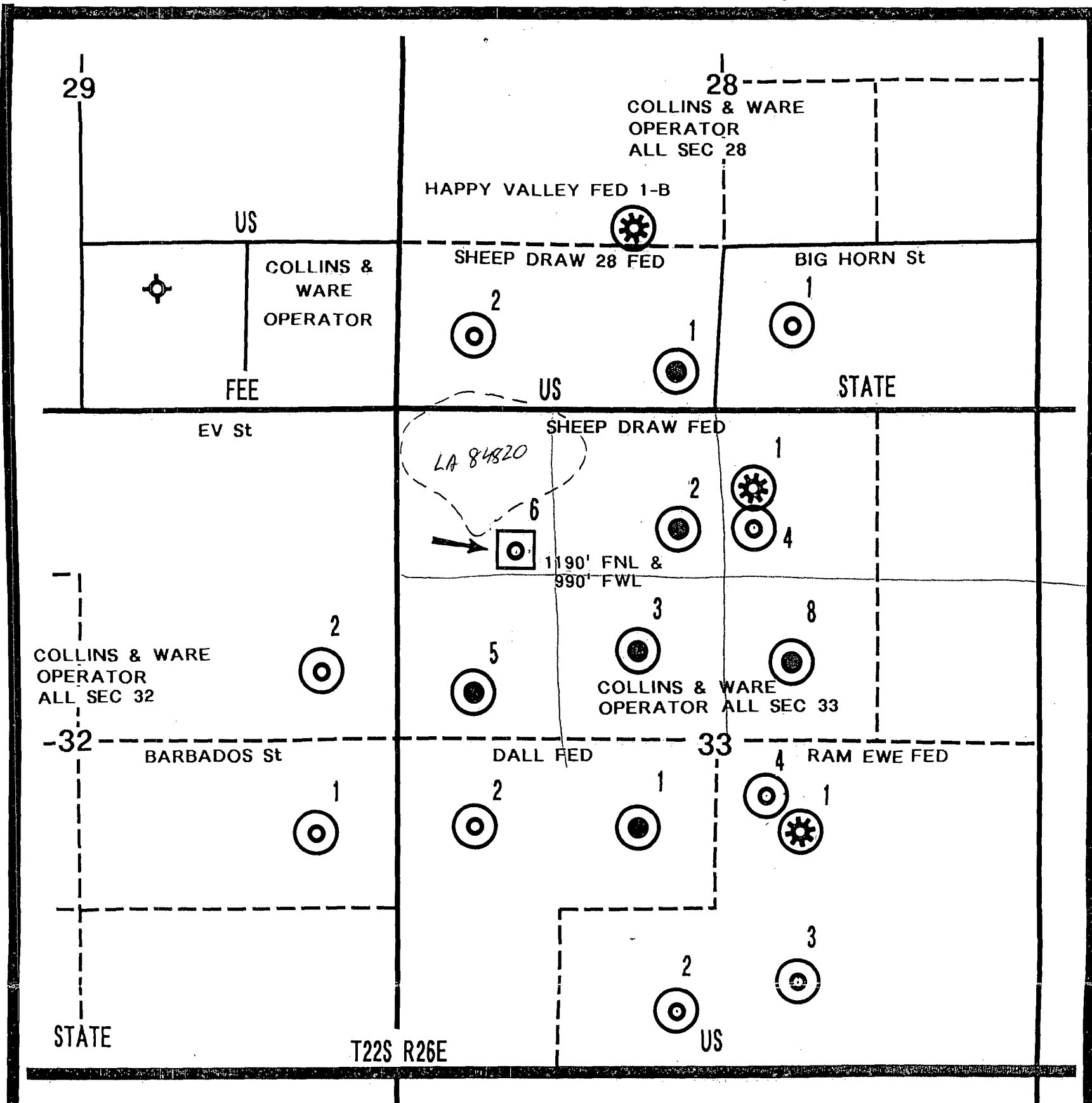

LEGEND
WORKING INTEREST

	COLLINS & WARE, INC	MEWBOURNE	SANTA FE ENERGY	AMOCO PROD COMPANY
<input type="checkbox"/>	.60000	.25000	.15000	
<input type="checkbox"/>	.53125		.09375	.37500
<input type="checkbox"/>	.75625	.09375	.15000	

- ☐ PROPOSED LOCATION
- ☒ STAKED LOCATION
- PRODUCERS
- ☒ DELAWARE
- ☐ STRAWN
- ☐ MORROW
- ☐ ARCHAEOLOGICAL SITE

COLLINS & WARE

HAPPY VALLEY DELAWARE FIELD
EDDY COUNTY, NEW MEXICO

OWNERSHIP MAP

SCALE 1:1000

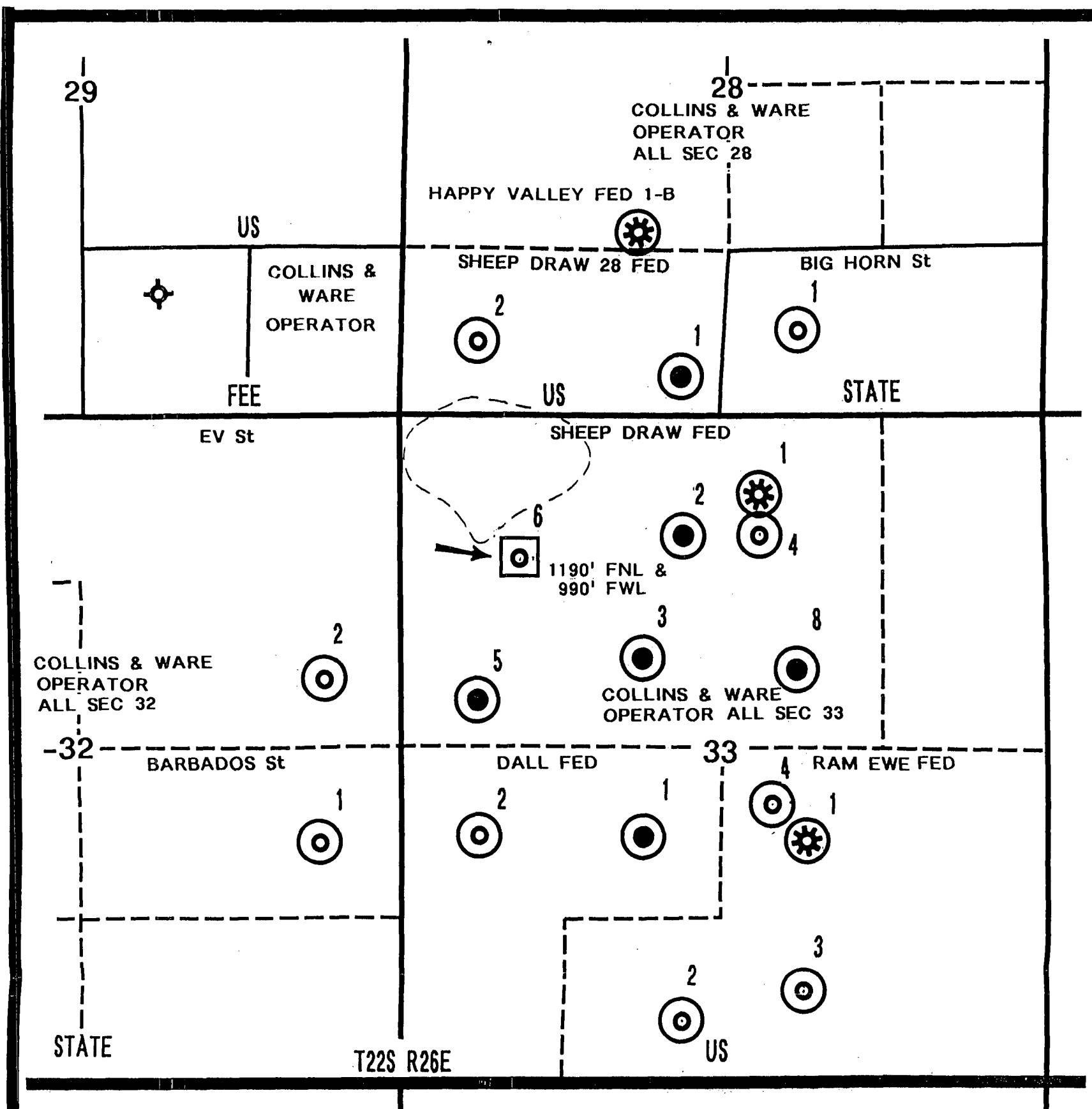

LEGEND WORKING INTEREST

	COLLINS & WARE, INC	MEWBOURNE	SANTA FE ENERGY	AMOCO PROD COMPANY
<input type="checkbox"/>	.60000	.25000	.15000	
<input type="checkbox"/>	.53125		.09375	.37500
<input type="checkbox"/>	.75625	.09375	.15000	

- ☐ PROPOSED LOCATION
- ☒ STAKED LOCATION
- PRODUCERS
- ☒ DELAWARE
- ☐ STRAWN
- ☐ MORROW
- ☐ ARCHAEOLOGICAL SITE

COLLINS & WARE

HAPPY VALLEY DELAWARE FIELD
EDDY COUNTY, NEW MEXICO

OWNERSHIP MAP

SCALE 1:1000

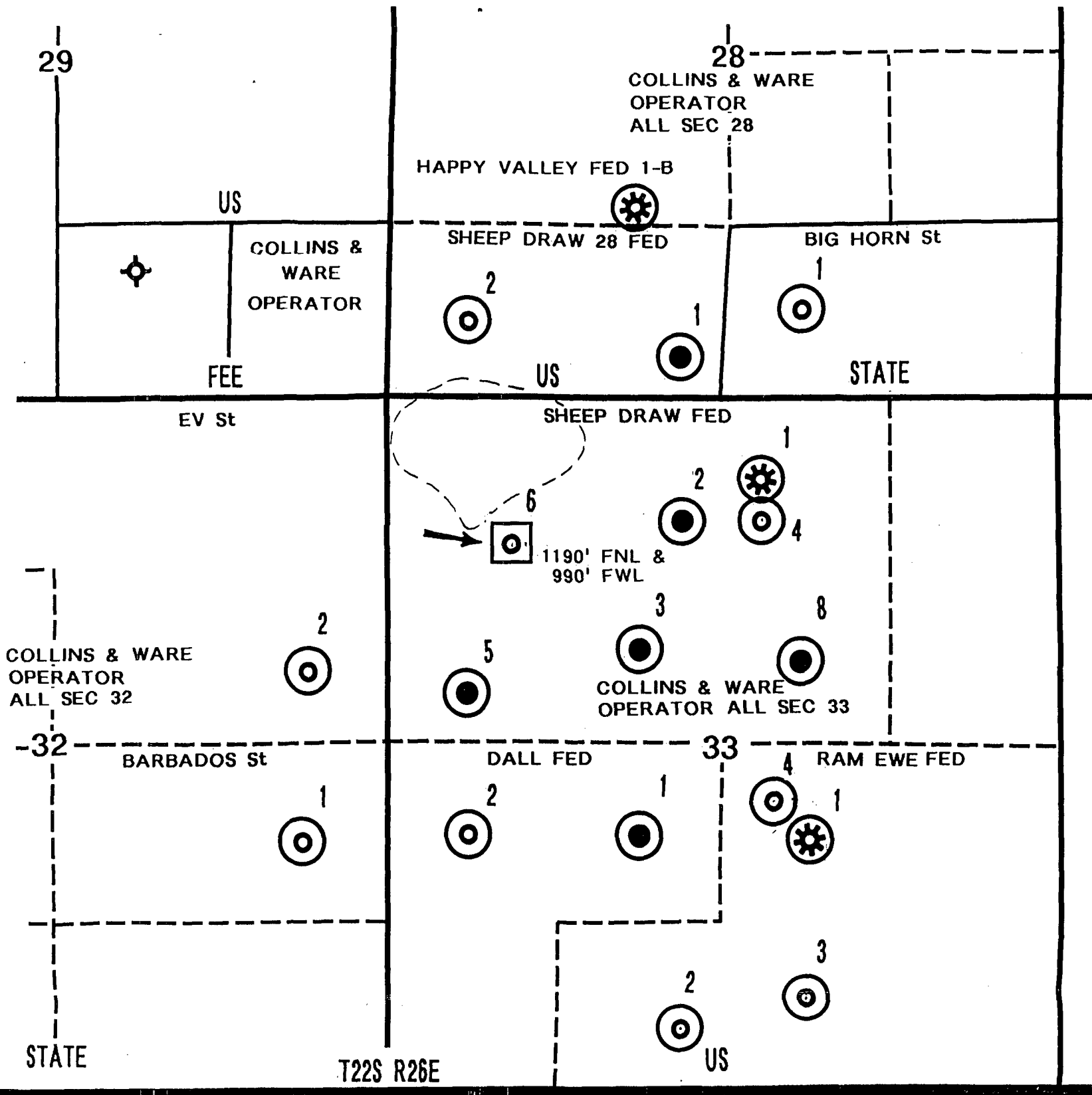

LEGEND WORKING INTEREST

	COLLINS & WARE, INC	MEWBOURNE	SANTA FE ENERGY	AMOCO PROD COMPANY
<input type="checkbox"/>	.60000	.25000	.15000	
<input type="checkbox"/>	.53125		.09375	.37500
<input type="checkbox"/>	.75625	.09375	.15000	

- ☐ PROPOSED LOCATION
- ☒ STAKED LOCATION
- PRODUCERS
- ☒ DELAWARE
- ☐ STRAWN
- ☐ MORROW
- ☐ ARCHAEOLOGICAL SITE

COLLINS & WARE

HAPPY VALLEY DELAWARE FIELD
EDDY COUNTY, NEW MEXICO

OWNERSHIP MAP

SCALE 1:1000