

BARBARA FASKEN
FASKEN OIL AND RANCH INTERESTS

303 WEST WALL AVENUE, SUITE 1900
MIDLAND, TEXAS 79701-5116
(915) 687-1777

1995 MAR 8 AM 8 52

March 1, 1995

Mr. Michael Stogner
Chief Hearing Examiner
Oil Conservation Division
P. O. Box 2088
Santa Fe, New Mexico 87504-2088

Re: Unorthodox Location Exception
Barbara Fasken - Operator
State "36" No. 1
990' FSL & 1650' FWL
Sec 36, T17S, R26E
Eddy County, New Mexico

Dear Sir:

Barbara Fasken respectfully requests administrative approval of an unorthodox gas well location for the State "36" No. 1 to a total depth of 9200 feet in the Atoka (Penn) gas pool. The proposed location is 990' FSL & 1650' FWL, Sec 36, T17S, R26E, Eddy County, New Mexico. The Atoka (Penn) special field rules call for 320 acre gas proration units with locations in the northwest quarter or the southeast quarter of the section. The southeast quarter of section 36 has been tested with the Yates Big Boggy State #1-Y drilled and abandoned as a dry hole at a total depth of 9120 feet.

Waivers of objection from offset operators and mineral interest owners are attached. The attached mail list contains 55 addresses. There are 36 waivers attached. Additional waivers will be forwarded to you upon receipt.

Attached also are topographic and ownership maps, and survey plat. Thank you for your help in this matter.

Sincerely,

Carl W. Brown

Carl W. Brown

Petroleum Engineer

CWB/cb

cc: file

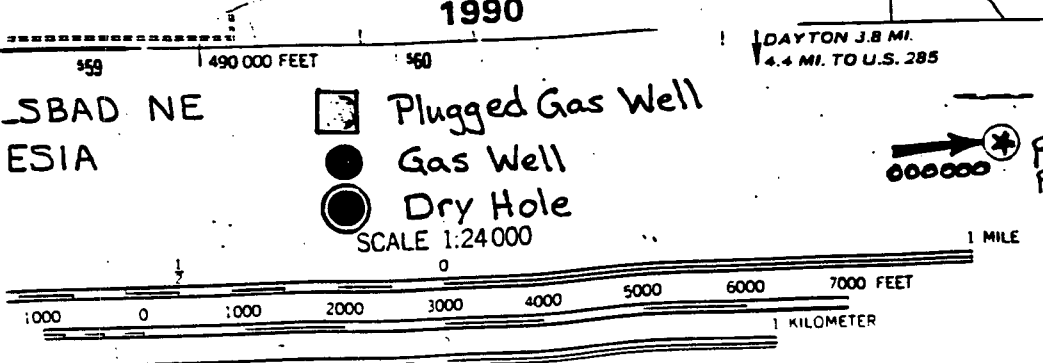
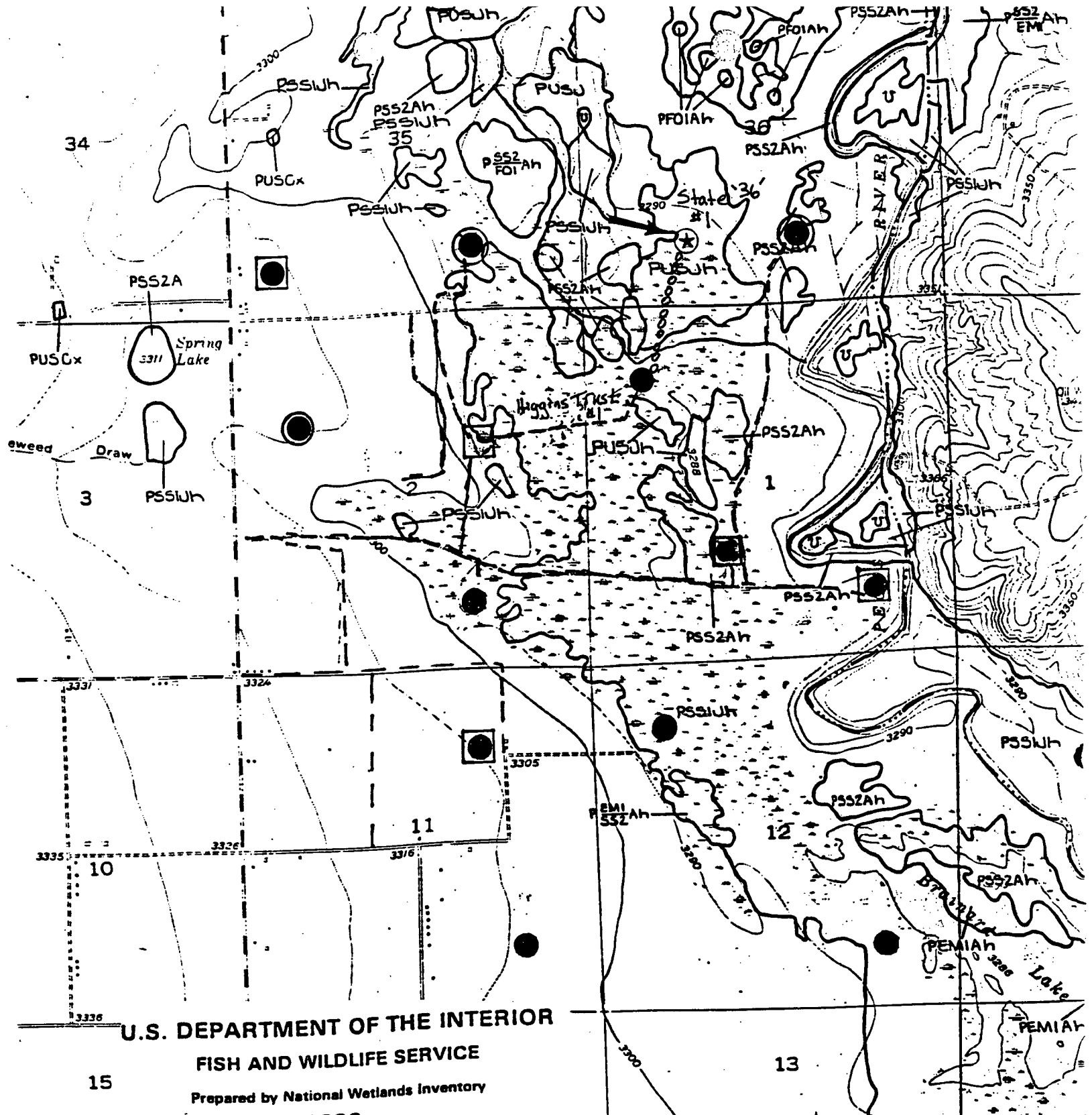

SPECIAL NOTE
This document was prepared primarily by s
analysis of high altitude aerial photographs. We
identified on the photographs based on vegeta
hydrology, and geography in accordance with
tion of Wetlands and Deepwater Habitats on
States (FWS OBS 79 21 December 1979)

4 P. BLOW UNIT
RED Tr P.

DISTRICT II
P.O. Drawer DD, Artesia, NM 88210

OIL CONSERVATION DIVISION

DISTRICT III
1000 Rio Brazos Rd., Aztec, NM 87410

P.O. Box 2088
Santa Fe, New Mexico 87504-2088

☐ AMENDED REPORT

WELL LOCATION AND ACREAGE DEDICATION PLAT

API Number		Pool Code 70800	Pool Name Atoka Penn (Prorated Gas)
Property Code	Property Name STATE "36"		Well Number 1
OGRID No. 1621	Operator Name BARBARA FASKEN		Elevation 3288'

Surface Location

UL or lot No.	Section	Township	Range	Lot Idn	Feet from the	North/South line	Feet from the	East/West line	County
N	36	17 S	26 E		990'	SOUTH	1650'	WEST	EDDY

Bottom Hole Location If Different From Surface

UL or lot No.	Section	Township	Range	Lot Idn	Feet from the	North/South line	Feet from the	East/West line	County
Dedicated Acres	Joint or Infill	Consolidation Code	Order No.						
320									

NO ALLOWABLE WILL BE ASSIGNED TO THIS COMPLETION UNTIL ALL INTERESTS HAVE BEEN CONSOLIDATED
OR A NON-STANDARD UNIT HAS BEEN APPROVED BY THE DIVISION

				<p>OPERATOR CERTIFICATION</p> <p>I hereby certify the the information contained herein is true and complete to the best of my knowledge and belief.</p> <p><u>Tommy E. Taylor</u></p> <p>Signature</p> <p><u>Tommy E. Taylor</u></p> <p>Printed Name</p> <p><u>Drlg. & Prod. Engineer</u></p> <p>Title</p> <p><u>2/3/95</u></p> <p>Date</p>
				<p>SURVEYOR CERTIFICATION</p> <p>I hereby certify that the well location shown on this plat was plotted from field notes of actual surveys made by me or under my supervision, and that the same is true and correct to the best of my belief.</p> <p>January 19, 1995</p> <p>Date Surveyed</p> <p><u>GARY L. JONES</u></p> <p>Signature & Seal of</p> <p>Professional Surveyor</p> <p>7977</p> <p>REGISTERED PROFESSIONAL SURVEYOR</p> <p>W.C. #05310</p>
<p>320 acres</p> <p>1650'</p> <p>990'</p> <p>Adm - Drills</p>				<p>Certificate No. GARY L. JONES, # 7977</p>

State "36" No. 1
990' FSL & 1650' FWL
Section 36, T-17-S, R-26-E, Eddy County, New Mexico

OFF-SET OWNERS	OFF-SET PROPERTY DESCRIPTION	CERTIFIED MAIL #	WOB REPLY
Meryl W. Tatman - DECEASED 705 W. Richardson Artesia, NM 88210	E/2 SE/4, Sec 35, T-17-S, R-26-E, Eddy Cty, NM	P 684 782 031 DELIVERED 02/16/95	SIGNED 02/25/95
Alan Lee Caraway P.O. Box 1513 Taos, NM 87571	E/2 SE/4, Sec 35, T-17-S, R-26-E, Eddy Cty, NM	P 143 453 933 NO FORWARDING ADDRESS	
Addie Swearingen 1100 Gemini Circle Portales, NM 88130	E/2 NE/4 NE/4 NE/4, Sec. 2, T-18-S, R-26-E, Eddy Cty, NM	P 143 453 937 DELIVERED 02/13/95	SIGNED 02/16/95
Arthur D. Lundblade Rt. 2, Box 92 Jamestown, KS 66948	E/2 NE/4 NE/4 NE/4, Sec. 2, T-18-S, R-26-E, Eddy Cty, NM	P 219 763 472 DELIVERED 02/13/95	SIGNED 02/14/95
Chalmers A. Loughridge Executor of the Estate of George A. Lundblade 3901 Rive Drive Alexandria, VA 22309-3053	E/2 NE/4 NE/4 NE/4, Sec. 2, T-18-S, R-26-E, Eddy Cty, NM	P 219 763 473 DELIVERED 02/13/95	
Marvin L. Lundblade 13184 S.E. 124th Clackamas, OR 97015	E/2 NE/4 NE/4 NE/4, Sec. 2, T-18-S, R-26-E, Eddy Cty, NM	P 219 763 474 DELIVERED 02/13/95	SIGNED 02/15/95
Helen Marcotte P.O. Box 42 Concordia, KS 66901	E/2 NE/4 NE/4 NE/4, Sec. 2, T-18-S, R-26-E, Eddy Cty, NM	P 219 763 475 DELIVERED 02/14/95	SIGNED 02/16/95

State "36" No. 1
990' FSL & 1650' FWL
Section 36, T-17-S, R-26-E, Eddy County, New Mexico

OFF-SET OWNERS	OFF-SET PROPERTY DESCRIPTION	CERTIFIED MAIL #	WOB REPLY
Darlene Pearson 2706 Fort Hays, KS 67601	E/2 NE/4 NE/4 NE/4, Sec. 2, T-18-S, R-26-E, Eddy Cty, NM	P 219 763 476 DELIVERED 02/14/95	
Norma Gupton 1902 Moody Ct. Arlington, TX 76012	E/2 NE/4 NE/4 NE/4, Sec. 2, T-18-S, R-26-E, Eddy Cty, NM	P 219 763 477 DELIVERED 02/21/95	SIGNED 02/25/95
Ronald Rogers 19955 Indian Summer Ln. Monument, CO 80132	E/2 NE/4 NE/4 NE/4, Sec. 2, T-18-S, R-26-E, Eddy Cty, NM	P 219 763 478 DELIVERED 02/13/95	SIGNED 02/15/95
Marion L. Swearingen 2828 S.E. Downing Rd. Topeka, KS 66605	E/2 NE/4 NE/4 NE/4, Sec. 2, T-18-S, R-26-E, Eddy Cty, NM	P 219 763 470 DELIVERED 02/13/95	POA SIGNED 02/16/95
Homer A. Swearingen 2364 N. Richmond St. Wichita, KS 67204	E/2 NE/4 NE/4 NE/4, Sec. 2, T-18-S, R-26-E, Eddy Cty, NM	P 219 763 479 DELIVERED 02/13/95	SIGNED 02/15/95
Helen J. Hardgrave & Meredith P.O. Box 514 Antlers, OK 74523	E/2 NE/4 NE/4 NE/4, Sec. 2, T-18-S, R-26-E, Eddy Cty, NM	P 219 763 480 DELIVERED 02/11/95	SIGNED 02/13/95
Bank IV Kansas-Topeka Trust Dept., Trustee for the Julie J. (Bistline) Martin Tr. P.O. Box 48348 Wichita, KS 67201-8348	E/2 NE/4 NE/4 NE/4, Sec. 2, T-18-S, R-26-E, Eddy Cty, NM	P 143 453 939 DELIVERED 02/13/95	

State "36" No. 1
990' FSL & 1650' FWL
Section 36, T-17-S, R-26-E, Eddy County, New Mexico

OFF-SET OWNERS	OFF-SET PROPERTY DESCRIPTION	CERTIFIED MAIL #	WOB REPLY
Howard Swearingen Rt. 1 Jamestown, KS 66948	E/2 NE/4 NE/4 NE/4, Sec. 2, T-18-S, R-26-E, Eddy Cty, NM	P 143 453 938 DELIVERED 02/13/95	SIGNED 02/15/95
Glen Swearingen 1066 Burr Oak Lane Salina, KS 67401	E/2 NE/4 NE/4 NE/4, Sec. 2, T-18-S, R-26-E, Eddy Cty, NM	P 143 453 946 DELIVERED NO DATE	SIGNED 02/15/95
Anna Pauline Swearingen 512 Cedar Street Concordia, KS 66901	E/2 NE/4 NE/4 NE/4, Sec. 2, T-18-S, R-26-E, Eddy Cty, NM	P 219 763 486 DELIVERED 02/13/95	SIGNED 02/16/95
Sheryl S. Collins 3209 S.W. Belle Ave. Topeka, KS 66614-4027	E/2 NE/4 NE/4 NE/4, Sec. 2, T-18-S, R-26-E, Eddy Cty, NM	P 219 763 487 DELIVERED 02/16/95	SIGNED 02/16/95
Flora Jane Hopkins 2149 San Anseline Ave. Long Beach, CA 90815	E/2 NE/4 NE/4 NE/4, Sec. 2, T-18-S, R-26-E, Eddy Cty, NM	P 219 763 488 DELIVERED 02/14/95	SIGNED 02/25/95
Jonathan J. Peden 4681 Diane Ave. San Diego, CA 92117-2903	E/2 NE/4 NE/4 NE/4, Sec. 2, T-18-S, R-26-E, Eddy Cty, NM	P 219 763 489 DELIVERED 02/13/95	SIGNED 02/13/95
Ralph W. Peden 2704 Meadow Green Bedford, TX 76021	E/2 NE/4 NE/4 NE/4, Sec. 2, T-18-S, R-26-E, Eddy Cty, NM	P 219 763 490 DELIVERED 02/13/95	SIGNED 02/14/95

State "36" No. 1
990' FSL & 1650' FWL
Section 36, T-17-S, R-26-E, Eddy County, New Mexico

OFF-SET OWNERS	OFF-SET PROPERTY DESCRIPTION	CERTIFIED MAIL #	WOB REPLY
Birdie F. Coryell c/o Worthen Natl. Bank P.O. Box 1681 Little Rock, AR 72203-1681	E/2 NE/4 NE/4 NE/4, Sec. 2, T-18-S, R-26-E, Eddy Cty, NM	P 219 763 492 DELIVERED 02/14/95	SIGNED NO DATE
Gleason Brown 7002 W. Orange Dr. Glendale, AZ 85303	E/2 NE/4 NE/4 NE/4, Sec. 2, T-18-S, R-26-E, Eddy Cty, NM	P 143 453 954 DELIVERED 02/11/95	SIGNED 02/13/95
Landa M. Harrel and Don Harrel P.O. Box 443 Fletcher, OK 73541	E/2 NE/4 NE/4 NE/4, Sec. 2, T-18-S, R-26-E, Eddy Cty, NM	P 143 453 953 DELIVERED 02/11/95	SIGNED 02/20/95
James A. Brown and Judith A. Brown P.O. Box 928 Elk City, OK 73648	E/2 NE/4 NE/4 NE/4, Sec. 2, T-18-S, R-26-E, Eddy Cty, NM	P 143 453 952 DELIVERED 02/13/95	SIGNED 02/13/95
M.D. Vandaveer & Lois Rt. 2, Box 1 PP Miller, MO 65707	E/2 NE/4 NE/4 NE/4, Sec. 2, T-18-S, R-26-E, Eddy Cty, NM	P 143 453 951 DELIVERED 02/13/95	SIGNED 02/13/95
Louise M. Richardson 1916 Norwood Independence, MO 64052	E/2 NE/4 NE/4 NE/4, Sec. 2, T-18-S, R-26-E, Eddy Cty, NM	P 143 453 950 DELIVERED 02/13/95	SIGNED 02/27/95
Ernest L. Redford 111 Nara Visa, N.W. Albuquerque, NM 87107	E/2 NE/4 NE/4 NE/4, Sec. 2, T-18-S, R-26-E, Eddy Cty, NM	P 143 453 949 DELIVERED 02/11/95	

State "36" No. 1
990' FSL & 1650' FWL
Section 36, T-17-S, R-26-E, Eddy County, New Mexico

OFF-SET OWNERS	OFF-SET PROPERTY DESCRIPTION	CERTIFIED MAIL #	WOB REPLY
Edna Mae Watt 400 Holland Dr. West Sacramento, CA 95605	E/2 NE/4 NE/4 NE/4, Sec. 2, T-18-S, R-26-E, Eddy Cty, NM	P 143 453 948 DELIVERED 02/13/95	
Terry A. White and Carla K. White P.O. Box 27 Tonkawa, OK 74653	E/2 NE/4 NE/4 NE/4, Sec. 2, T-18-S, R-26-E, Eddy Cty, NM	P 143 453 947 DELIVERED 02/15/95	SIGNED 02/24/95
Harrie L. Perry, Jr. and Maxine J. Perry P.O. Box 396 Deridder, LA 70634	E/2 NE/4 NE/4 NE/4, Sec. 2, T-18-S, R-26-E, Eddy Cty, NM	P 219 763 483 DELIVERED 02/13/95	SIGNED 02/14/95
Stanico Energy Corp. P.O. Box 32467 Oklahoma City, OK 73123-2462	E/2 NE/4 NE/4 NE/4, Sec. 2, T-18-S, R-26-E, Eddy Cty, NM	P 219 763 484 DELIVERED 02/15/95	SIGNED 02/15/95
John Collier Major and Stephen Alfred Major P.O. Box 5 Mooreland, OK 73852	E/2 NE/4 NE/4 NE/4, Sec. 2, T-18-S, R-26-E, Eddy Cty, NM	P 219 763 485 DELIVERED 02/13/95	
Jimmy Lee Collier Exec. of the Est. of James A. Collier P.O. Box 63 Elgin, OK 73538	E/2 NE/4 NE/4 NE/4, Sec. 2, T-18-S, R-26-E, Eddy Cty, NM	P 143 453 932 DELIVERED 02/22/95	

State "36" No. 1
990' FSL & 1650' FWL
Section 36, T-17-S, R-26-E, Eddy County, New Mexico

OFF-SET OWNERS	OFF-SET PROPERTY DESCRIPTION	CERTIFIED MAIL #	WOB REPLY
Chevron U.S.A. P.O. Box 1150 Midland, TX 79702	N/2 NE/4, Sec. 1, T-18-S, R-26-E, Eddy Cty, NM Fairchild Farm Land Tract #'s 230, 232	P 143 453 924 DELIVERED 02/13/95	
Lynden A. Ruester 980 Grove Hamlet Way Apt. B Deland, FL 32720	N/2 NE/4, Sec. 1, T-18-S, R-26-E, Eddy Cty, NM Fairchild Farm Land Tract #226	P 175 145 718 DELIVERED 02/24/95	SIGNED 02/25/95
Breck Operating Co. P.O. Box 911 Breckenridge, TX 76024	NW/4 NW/4, Sec. 6, T-18-S, R-27-E, Eddy Cty, NM	P 143 453 931 DELIVERED 02/14/95	SIGNED 02/14/95
Yates Petroleum Corp. 105 S. 4th St. Artesia, NM 88210	W/2 SW/4 and SW/4 NW/4, Sec. 31, T-17-S, R-27-E, Eddy Cty, NM. E/2 NE/4, Sec. 35, T-17-S, R-26-E, Eddy Cty, NM.	P 143 453 923 DELIVERED 02/10/95	
Tierra Oil Company P.O. Box 1354 Roswell, NM 88201	N/2 NE/4, Sec. 1, T-18-S, R-26-E, Eddy Cty, NM Fairchild Farm Land Tract #231 (containing ± 5.62 acres).	P 143 453 955 DELIVERED 02/13/95	SIGNED 02/20/95
Roy Leslie Hildon 8 Haig Drive Sunrise Country Club Rancho Mirage, CA 92270	N/2 NE/4, Sec. 1, T-18-S, R-26-E, Eddy Cty, NM Fairchild Farm Land Tract #226 (containing 7.10 acres more or less).	P 143 453 430 DELIVERED 02/13/95	SIGNED 02/14/95
Monaca H. Dempsey Box 132 Old Rockland Rd. Libertyville, IL 60048	N/2 NE/4, Sec. 1, T-18-S, R-26-E, Eddy Cty, NM Fairchild Farm Land Tract #226 (containing 7.10 acres more or less).	P 175 145 719 DELIVERED 02/21/95	

State "36" No. 1
990' FSL & 1650' FWL
Section 36, T-17-S, R-26-E, Eddy County, New Mexico

OFF-SET OWNERS	OFF-SET PROPERTY DESCRIPTION	CERTIFIED MAIL #	WOB REPLY
Scope Energy Resources, Inc. 233 Wilshire Blvd. Suite 790 Santa Monica, CA 90401	NE/4 NE/4, Sec. 1, lying East of the river (containing 39.1 acres, more or less), T-18-S, R-26-E, Eddy Cty, NM	P 219 763 482 DELIVERED 02/13/95	
Kathleen Irwin, ssp 1911 W. Missouri Midland, TX 79701	NE/4 NE/4, Sec. 1, lying East of the river (containing 39.1 acres, more or less), T-18-S, R-26-E, Eddy Cty, NM	P 143 453 929 DELIVERED 02/10/95	SIGNED 02/10/95
Dan W. Irwin, ssp 118 N. Grant St. Hinsdale, IL 60521	NE/4 NE/4, Sec. 1, lying East of the river (containing 39.1 acres, more or less), T-18-S, R-26-E, Eddy Cty, NM	P 143 453 921 DELIVERED 02/15/95	SIGNED 02/16/95
Kathleen Irwin Schuster 4555 Apache Rd. Boulder, CO 80303	NE/4 NE/4, Sec. 1, lying East of the river (containing 39.1 acres, more or less), T-18-S, R-26-E, Eddy Cty, NM	P 214 763 481 NO FORWARDING ADDRESS	
Shirley C. Wallace, Trustee of the Culberson Mgmt. Tr. P.O. Box 29702 Midland, TX 79702	NE/4 NE/4, Sec. 1, lying East of the river (containing 39.1 acres, more or less), T-18-S, R-26-E, Eddy Cty, NM	P 684 782 032 DELIVERED 02/15/95	SIGNED 02/15/95
Marshall & Winston, Inc. P.O. Box 50880 Midland, TX 79710-0880	E/2 SE/4, Sec 35, T-17-S, R-26-E, Eddy Cty, NM	Z 112 328 425 2ND ATTEMPT MAILED 03/01/95	
David J. & Bonnie J. Sorenson P.O. Box 1453 Roswell, NM 88201	E/2 SE/4, Sec 35, T-17-S, R-26-E, Eddy Cty, NM	P 143 453 936 DELIVERED 02/10/95	SIGNED 02/10/95

State "36" No. 1
990' FSL & 1650' FWL
Section 36, T-17-S, R-26-E, Eddy County, New Mexico

OFF-SET OWNERS	OFF-SET PROPERTY DESCRIPTION	CERTIFIED MAIL #	WOB REPLY
Gladys M. Shobe 2811 Quenby Ave. Houston, TX 77005	E/2 SE/4, Sec 35, T-17-S, R-26-E, Eddy Cty, NM	P 175 145 716 2ND ATTEMPT MAILED 02/21/95	
Lanita C. Williamson 3101 Diamond A. Drive Roswell, NM 88201	E/2 SE/4, Sec 35, T-17-S, R-26-E, Eddy Cty, NM	P 684 782 033 DELIVERED 02/18/95	SIGNED 02/23/95
G. Dee Williamson P. O. Box 2206 Roswell, NM 88201	E/2 SE/4, Sec 35, T-17-S, R-26-E, Eddy Cty, NM	P 143 453 935 DELIVERED 02/10/95	SIGNED 02/10/95
Alta A. Solsby 738 South Erie St. Wichita, KS 67211	E/2 SE/4, Sec 35, T-17-S, R-26-E, Eddy Cty, NM	P 143 453 926 NO FORWARDING ADDRESS	
Marjorie Naylor Estate Nile Martin Executrix 1306 Yucca Artesia, NM 88210	E/2 SE/4, Sec 35, T-17-S, R-26-E, Eddy Cty, NM	P 684 782 029 DELIVERED 02/14/95	
Lawrence A. Tvedt and Mary Slocumb 3658 Waynoka Ave. Memphis, TN 38111	E/2 SE/4, Sec 35, T-17-S, R-26-E, Eddy Cty, NM	P 143 453 934 DELIVERED 02/11/95	
Louis Meidell 2811 Columbine Street Wichita, KS 67204	E/2 SE/4, Sec 35, T-17-S, R-26-E, Eddy Cty, NM	P 143 453 925 DELIVERED 02/13/95	

FEB 13 1995

RECEIPT FOR CERTIFIED MAIL

NO INSURANCE COVERAGE PROVIDED
NOT FOR INTERNATIONAL MAIL

(See Reverse)

New Mexico Oil Conservation Division
P.O. Box 2208
Santa Fe, New Mexico 87501

Re: Waiver of Objection to
Unorthodox Location
Barbara Fasken - Oper
State "36" No. 1
990' FSL & 1650' FWL
Sec. 36, T17S, R26E
Eddy County, New Mex

PS Form 3800, June 1985

Sent to <i>J. Dee Williamson</i>	
Postage and No. <i>P.O. Box 2208</i>	
State and ZIP Code <i>Roswell, NM 88201</i>	
Return Receipt showing to whom Date and Address of Delivery	
TOTAL Postage and Fees	
Postmark or Date <i>Waiver of Objection State 36 #1 FEB 06</i>	

Dear Sirs:

As an offset operator or mineral interest owner to the above referenced location, objection is hereby waived to the application of Barbara Fasken to drill the above referenced well as an unorthodox gas well location in the Atoka (Penn) gas pool to a total depth of 9200'. The Atoka (Penn) special field rules call for 320 acre gas proration units with locations in the northwest quarter or the southeast quarter of the section. It is noted that the southeast quarter of section 36 has been tested with the Yates Big Boggy State #1-Y drilled and abandoned as a dry hole at a total depth of 9120 feet.

G. DEE WILLIAMSON

By: *J. Dee Williamson*Title: *Owner*Date: *2-10-95*

SENDER:

- Complete items 1 and/or 2 for additional services.
- Complete items 3, and 4a & b.
- Print your name and address on the reverse of this form so that we can return this card to you.
- Attach this form to the front of the mailpiece, or on the back if space does not permit.
- Write "Return Receipt Requested" on the mailpiece below the article number.
- The Return Receipt will show to whom the article was delivered and the date delivered.

I also wish to receive the following services (for an extra fee):

- ☐ Addressee's Address
- ☐ Restricted Delivery

Consult postmaster for fee.

3. Article Addressed to:

*J. Dee Williamson
P.O. Box 2208
Roswell, NM 88201*

4a. Article Number

P143 453 935

4b. Service Type

☐ Registered ☐ Insured☒ Certified☐ Express Mail ☐ Return Receipt for Merchandise

7. Date of Delivery

FEB 10 1995

5. Signature (Addressee)

6. Signature (Agent)

Dorothy B. Bell

8. Addressee's Address (Only if requested and fee is paid)

88201

Thank you for using Return Receipt Service.

FEB 14 1995

RECEIPT FOR CERTIFIED MAIL

NO INSURANCE COVERAGE PROVIDED
NOT FOR INTERNATIONAL MAIL

(See Reverse)

New Mexico Oil Conservation Division
P.O. Box 2208
Santa Fe, New Mexico 87501

Re: Waiver of Objection to
Unorthodox Location
Barbara Fasken - Oper
State "36" No. 1
990' FSL & 1650' FWL
Sec. 36, T17S, R26E
Eddy County, New Me

PS Form 3800, June 1985

Sent to <i>Kathleen Irwin, SSP</i>	
Street and No. <i>1911 W. Missouri</i>	
City, State and ZIP Code <i>Midland, TX 79701</i>	
Return Receipt showing to whom and Date of Delivery:	
Return Receipt showing to whom Date and Address of Delivery:	
TOTAL Postage and Fees	
Postmark or Date <i>Waiver of Objection</i> <i>State 36 #1</i> FEB 09 1995	

Dear Sirs:

As an offset operator or mineral interest owner to the above referenced location, objection is hereby waived to the application of Barbara Fasken to drill the above referenced well as an unorthodox gas well location in the Atoka (Penn) gas pool to a total depth of 9200'. The Atoka (Penn) special field rules call for 320 acre gas proration units with locations in the northwest quarter or the southeast quarter of the section. It is noted that the southeast quarter of section 36 has been tested with the Yates Big Boggy State #1-Y drilled and abandoned as a dry hole at a total depth of 9120 feet.

KATHLEEN IRWIN, SSP

By: *Kathleen Irwin*

Title: _____

Date: *2/10/95*

SENDER:

- Complete items 1 and/or 2 for additional services.
- Complete items 3, and 4a & b.
- Print your name and address on the reverse of this form so that we can return this card to you.
- Attach this form to the front of the mailpiece, or on the back if space does not permit.
- Write "Return Receipt Requested" on the mailpiece below the article number.
- The Return Receipt will show to whom the article was delivered and the date delivered.

I also wish to receive the following services (for an extra fee):

- ☐ Addressee's Address
- ☐ Restricted Delivery

Consult postmaster for fee.

3. Article Addressed to:

Kathleen Irwin, SSP
1911 W. Missouri
Midland, TX 79701

4a. Article Number

P 143 453 929

4b. Service Type

- | | |
|---|---|
| <input type="checkbox"/> Registered | <input type="checkbox"/> Insured |
| <input checked="" type="checkbox"/> Certified | <input type="checkbox"/> COD |
| <input type="checkbox"/> Express Mail | <input type="checkbox"/> Return Receipt for Merchandise |

7. Date of Delivery

2/10/95

8. Addressee's Address (Only if requested and fee is paid)

5. Signature (Addressee)

K Irwin

6. Signature (Agent)

Thank you for using Return Receipt Service.

FEB 15 1995

P 143 453 952

RECEIPT FOR CERTIFIED MAIL
NO INSURANCE COVERAGE PROVIDED
NOT FOR INTERNATIONAL MAIL
(See Reverse)

New Mexico Oil Conservation Division
P.O. Box 2208
Santa Fe, New Mexico 87501

Re: Waiver of Objection to
Unorthodox Location
Barbara Fasken - Oper:
State "36" No. 1
990' FSL & 1650' FWL
Sec. 36, T17S, R26E
Eddy County, New Mex

PS Form 3800, June 1985

Sent to <i>James A & Judith A Brown</i>	
Street and No. <i>P.O. Box 928</i>	
City, State, ZIP <i>Eck City OK 73648</i>	
Return Receipt showing to whom, Date and Address of Delivery	
TOTAL Postage and Fees	5
Postmark or Date <i>Waiver of Objection</i> <i>State 36 #1 FEB 09 1995</i>	

Dear Sirs:

As an offset operator or mineral interest owner to the above referenced location, objection is hereby waived to the application of Barbara Fasken to drill the above referenced well as an unorthodox gas well location in the Atoka (Penn) gas pool to a total depth of 9200'. The Atoka (Penn) special field rules call for 320 acre gas proration units with locations in the northwest quarter or the southeast quarter of the section. It is noted that the southeast quarter of section 36 has been tested with the Yates Big Boggy State #1-Y drilled and abandoned as a dry hole at a total depth of 9120 feet.

JAMES A. BROWN AND JUDITH A. BROWN

By: *James A. Brown Judith A. Brown*
Date: *2-13-95*

SENDER: • Complete items 1 and/or 2 for additional services. • Complete items 3, and 4a & b. • Print your name and address on the reverse of this form so that we can return this card to you. • Attach this form to the front of the mailpiece, or on the back if space does not permit. • Write "Return Receipt Requested" on the mailpiece below the article number. • The Return Receipt will show to whom the article was delivered and the date delivered.		I also wish to receive the following services (for an extra fee): 1. <input type="checkbox"/> Addressee's Address 2. <input type="checkbox"/> Restricted Delivery Consult postmaster for fee.	
3. Article Addressed to: <i>James A Brown & Judith A Brown</i> <i>P.O. Box 928</i> <i>Eck City OK 73648</i>		4a. Article Number <i>P143 453 952</i>	
4b. Service Type <input type="checkbox"/> Registered <input type="checkbox"/> Insured <input checked="" type="checkbox"/> Certified <input type="checkbox"/> COD <input type="checkbox"/> Express Mail <input type="checkbox"/> Return Receipt for Merchandise		7. Date of Delivery FEB 13 1995	
5. Signature (Addressee) <i>James A. Brown</i>		8. Addressee's Address (Only if requested and fee is paid)	
6. Signature (Agent)		Thank you for using Return Receipt Service.	

Is your RETURN ADDRESS completed on the reverse side?

FEB 16 1995

P 684 782 032



Certified Mail Receipt
No Insurance Coverage Provided
Do not use for International Mail
(See Reverse)

New Mexico Oil Conservation Division
P.O. Box 2208
Santa Fe, New Mexico 87501

Re: Waiver of Objection to
Unorthodox Location
Barbara Fasken - Oper.
State "36" No. 1
990' FSL & 1650' FWL
Sec. 36, T17S, R26E
Eddy County, New Mex

PS Form 3800, June 1990

Sent to <i>Shirley C. Wallace</i>	
Street & No. <i>1404 W. Pine</i>	
P.O., State & ZIP Code <i>Midland, TX 79705</i>	
Postage	\$
Certified Fee	
Special Delivery Fee	
Restricted Delivery Fee	
Return Receipt Showing to Whom & Date Delivered	
Return Receipt Showing to Whom, Date, & Address of Delivery	
TOTAL Postage & Fees	\$
Postmark or Date <i>Waiver of Objection</i> <i>State #1</i> FEB 14 1995	

Dear Sirs:

As an offset operator or mineral interest owner to the above referenced location, objection is hereby waived to the application of Barbara Fasken to drill the above referenced well as an unorthodox gas well location in the Atoka (Penn) gas pool to a total depth of 9200'. The Atoka (Penn) special field rules call for 320 acre gas proration units with locations in the northwest quarter or the southeast quarter of the section. It is noted that the southeast quarter of section 36 has been tested with the Yates Big Boggy State #1-Y drilled and abandoned as a dry hole at a total depth of 9120 feet.

SHIRLEY C. WALLACE

By: *Shirley C. Wallace*
Title: *Trustee, Culbertson Aug. Trust.*
Date: *2-15-95*

Is your RETURN ADDRESS completed on the reverse side?

SENDER: • Complete items 1-and/or 2 for additional services. • Complete items 3, and 4a & b. • Print your name and address on the reverse of this form so that we can return this card to you. • Attach this form to the front of the mailpiece, or on the back if space does not permit. • Write "Return Receipt Requested" on the mailpiece below the article number. • The Return Receipt will show to whom the article was delivered and the date delivered.		I also wish to receive the following services (for an extra fee): 1. <input type="checkbox"/> Addressee's Address 2. <input type="checkbox"/> Restricted Delivery Consult postmaster for fee.	
3. Article Addressed to: <i>Shirley C. Wallace</i> <i>1404 W. Pine</i> <i>Midland, TX 79705</i>		4a. Article Number <i>P 684 782 032</i>	
5. Signature (Addressee) <i>Shirley C. Wallace</i>		4b. Service Type <input type="checkbox"/> Registered <input type="checkbox"/> Insured <input checked="" type="checkbox"/> Certified <input type="checkbox"/> COD <input type="checkbox"/> Express Mail <input type="checkbox"/> Return Receipt for Merchandise	
6. Signature (Agent)		7. Date of Delivery <i>2-15-95</i>	
		8. Addressee's Address (Only if requested and fee is paid)	

Thank you for using Return Receipt Service.

**Receipt for
Certified Mail**

 No Insurance Coverage Provided
Do not use for International Mail
(See Reverse)

FEB 17 1995

 New Mexico Oil Conservation Division
P.O. Box 2208
Santa Fe, New Mexico 87501

 Re: Waiver of Objection to
Unorthodox Location
Barbara Fasken - Operat
State "36" No. 1
990' FSL & 1650' FWL
Sec. 36, T17S, R26E
Eddy County, New Mexico

PS Form 3800, June 1991

Sender <i>Ralph W Peden</i>	
Street and No. <i>2704 Meadow Green</i>	
P.O., State and ZIP Code <i>Bedford 2X 76021</i>	
Postage	\$
Certified Fee	
Special Delivery Fee	
Restricted Delivery Fee	
Return Receipt Showing to Whom & Date Delivered	
Return Receipt Showing to Whom, Date, and Addressee's Address	
TOTAL Postage & Fees	\$
Postmark or Date <i>Waiver of Objection</i> <i>State 36 #1</i> FEB 09 1995	

Dear Sirs:

As an offset operator or mineral interest owner to the above referenced location, objection is hereby waived to the application of Barbara Fasken to drill the above referenced well as an unorthodox gas well location in the Atoka (Penn) gas pool to a total depth of 9200'. The Atoka (Penn) special field rules call for 320 acre gas proration units with locations in the northwest quarter or the southeast quarter of the section. It is noted that the southeast quarter of section 36 has been tested with the Yates Big Boggy State #1-Y drilled and abandoned as a dry hole at a total depth of 9120 feet.

RALPH W. PEDEN

By: *Ralph W Peden*

Title: _____

Date: *14 Feb. '95***SENDER:**

- Complete items 1 and/or 2 for additional services.
- Complete items 3, and 4a & b.
- Print your name and address on the reverse of this form so that we can return this card to you.
- Attach this form to the front of the mailpiece, or on the back if space does not permit.
- Write "Return Receipt Requested" on the mailpiece below the article number.
- The Return Receipt will show to whom the article was delivered and the date delivered.

I also wish to receive the following services (for an extra fee):

1. ☐ Addressee's Address2. ☐ Restricted Delivery

Consult postmaster for fee.

3. Article Addressed to:

Ralph W Peden
2704 Meadow Green
Bedford, 2X 76021

4a. Article Number

P 219 763 490

4b. Service Type

☐ Registered☐ Insured☒ Certified☐ COD☐ Express Mail☐ Return Receipt for Merchandise

7. Date of Delivery

2-B-95

5. Signature (Addressee)

6. Signature (Agent)

8. Addressee's Address (Only if requested and fee is paid)

Thank you for using Return Receipt Service.

FEB 17 1995

**Receipt for
Certified Mail**

 No Insurance Coverage Provided
 Do not use for International Mail
 (See Reverse)

 New Mexico Oil Conservation Division
 P.O. Box 2208
 Santa Fe, New Mexico 87501

 Re: Waiver of Objection to
 Unorthodox Location
 Barbara Fasken - Ope
 State "36" No. 1
 990' FSL & 1650' FW
 Sec. 36, T17S, R26E
 Eddy County, New Mexico

PS Form 3800, June 1991

Sent to <u>Arthur D. Lundblade</u>	
Street and No. <u>Rt 2, Box 92</u>	
City, State and ZIP Code <u>Jimenez KS 66948</u>	
Postage	\$
Certified Fee	
Special Delivery Fee	
Restricted Delivery Fee	
Return Receipt Showing to Whom & Date Delivered	
Return Receipt Showing to Whom, Date, and Addressee's Address	
TOTAL Postage & Fees	\$
Postmark or Date <u>Waiver of Objection</u> <u>State 36 #1</u> FEB 09 1995	

Dear Sirs:

As an offset operator or mineral interest owner to the above referenced location, objection is hereby waived to the application of Barbara Fasken to drill the above referenced well as an unorthodox gas well location in the Atoka (Penn) gas pool to a total depth of 9200'. The Atoka (Penn) special field rules call for 320 acre gas proration units with locations in the northwest quarter or the southeast quarter of the section. It is noted that the southeast quarter of section 36 has been tested with the Yates Big Boggy State #1-Y drilled and abandoned as a dry hole at a total depth of 9120 feet.

ARTHUR D. LUNDBLADE

 By: Arthur D. Lundblade

 Title: owner

 Date: 2-14-1995
SENDER:

- Complete items 1 and/or 2 for additional services.
- Complete items 3, and 4a & b.
- Print your name and address on the reverse of this form so that we can return this card to you.
- Attach this form to the front of the mailpiece, or on the back if space does not permit.
- Write "Return Receipt Requested" on the mailpiece below the article number.
- The Return Receipt will show to whom the article was delivered and the date delivered.

I also wish to receive the following services (for an extra fee):

- ☐ Addressee's Address
- ☐ Restricted Delivery

Consult postmaster for fee.

3. Article Addressed to:

Arthur D. Lundblade
Rt 2, Box 92
Jimenez KS 66948

4a. Article Number

P219763472

4b. Service Type

- | | |
|---|---|
| <input type="checkbox"/> Registered | <input type="checkbox"/> Insured |
| <input checked="" type="checkbox"/> Certified | <input type="checkbox"/> COD |
| <input type="checkbox"/> Express Mail | <input type="checkbox"/> Return Receipt for Merchandise |

7. Date of Delivery

2-13-95

8. Addressee's Address (Only if requested and fee is paid)

5. Signature (Addressee)

Arthur Lundblade
Arthur Lundblade

6. Signature (Agent)

Thank you for using Return Receipt Service.

P 143 453 936

RECEIPT FOR CERTIFIED MAIL

NO INSURANCE COVERAGE PROVIDED
NOT FOR INTERNATIONAL MAIL

(See Reverse)

Sent to	David G. + Bonnie G. Sarner
Street and No.	P.O. Box 1453
State and ZIP Code	Roswell, N.M. 88201
Postmark	
Postage	
Delivery Fee	
Receipt showing Date and Date Delivered	
Return Receipt showing to whom, Date and Address of Delivery	
TOTAL Postage and Fees	\$
Postmark or Date	Waiver of Objection State 36 #1
FEB 09 1995	

New Mexico Oil Conservation Division
P.O. Box 2208
Santa Fe, New Mexico 87501

Re: Waiver of Objection to
Unorthodox Location
Barbara Fasken - Oper.
State "36" No. 1
990' FSL & 1650' FWL
Sec. 36, T17S, R26E
Eddy County, New Mex

Dear Sirs:

As an offset operator or mineral interest owner to the above referenced location, objection is hereby waived to the application of Barbara Fasken to drill the above referenced well as an unorthodox gas well location in the Atoka (Penn) gas pool to a total depth of 9200'. The Atoka (Penn) special field rules call for 320 acre gas proration units with locations in the northwest quarter or the southeast quarter of the section. It is noted that the southeast quarter of section 36 has been tested with the Yates Big Boggy State #1-Y drilled and abandoned as a dry hole at a total depth of 9120 feet.

DAVID J. & BONNIE J. SORENSON

By: Harold J. Sorensen

Title: Mr.

Date: Feb. 10, 1995

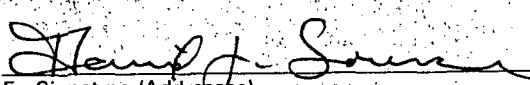
SENDER: • Complete items 1 and/or 2 for additional services. • Complete items 3, and 4a & b. • Print your name and address on the reverse of this form so that we can return this card to you. • Attach this form to the front of the mailpiece, or on the back if space does not permit. • Write "Return Receipt Requested" on the mailpiece below the article number. • The Return Receipt will show to whom the article was delivered and the date delivered.		I also wish to receive the following services (for an extra fee): 1. <input type="checkbox"/> Addressee's Address 2. <input type="checkbox"/> Restricted Delivery Consult postmaster for fee.	
3. Article Addressed to: David J. + Bonnie J. Sorenson P.O. Box 1453 Roswell, NM 88201		4a. Article Number P143 453 936	
5. Signature (Addressee) 		4b. Service Type <input type="checkbox"/> Registered <input type="checkbox"/> Insured <input checked="" type="checkbox"/> Certified <input type="checkbox"/> COD <input type="checkbox"/> Express Mail <input type="checkbox"/> Return Receipt for Merchandise	
		7. Date of Delivery 2-10-95	
6. Signature (Agent)		8. Addressee's Address (Only if requested and fee is paid)	

Thank you for using Return Receipt Service.

FEB 16 1995

RECEIPT FOR CERTIFIED MAIL

NO INSURANCE COVERAGE PROVIDED
NOT FOR INTERNATIONAL MAIL

(See Reverse)

New Mexico Oil Conservation Division
P.O. Box 2208
Santa Fe, New Mexico 87501

Re: Waiver of Objection to
Unorthodox Location
Barbara Fasken - Oper
State "36" No. 1
990' FSL & 1650' FWL
Sec. 36, T17S, R26E
Eddy County, New Me

PS Form 3800, June 1985

Sent to <i>Breck Operating Co.</i>	
Street and No. <i>P.O. Box 911</i>	
City, State and ZIP Code <i>Breckenridge, Ia. 76024</i>	
Return Receipt showing to whom Date, and Address of Delivery	
TOTAL Postage and Fees	\$
Postmark or Date <i>Waiver of Objection</i> <i>State Ia #1</i> FEB 09 1995	

Dear Sirs:

As an offset operator or mineral interest owner to the above referenced location, objection is hereby waived to the application of Barbara Fasken to drill the above referenced well as an unorthodox gas well location in the Atoka (Penn) gas pool to a total depth of 9200'. The Atoka (Penn) special field rules call for 320 acre gas proration units with locations in the northwest quarter or the southeast quarter of the section. It is noted that the southeast quarter of section 36 has been tested with the Yates Big Boggy State #1-Y drilled and abandoned as a dry hole at a total depth of 9120 feet.

BRECK OPERATING COMPANY

By: *[Signature]*Title: *V.P. - Prod. Mgr*Date: *2/14/95*

SENDER:

- Complete items 1 and/or 2 for additional services.
- Complete items 3, and 4a & b.
- Print your name and address on the reverse of this form so that we can return this card to you.
- Attach this form to the front of the mailpiece, or on the back if space does not permit.
- Write "Return Receipt Requested" on the mailpiece below the article number.
- The Return Receipt will show to whom the article was delivered and the date delivered.

I also wish to receive the following services (for an extra fee):

1. ☐ Addressee's Address2. ☐ Restricted Delivery

Consult postmaster for fee.

3. Article Addressed to:

Breck Operating Co.
P.O. Box 911
Breckenridge, Ia. 76024

4a. Article Number

P143-453931

4b. Service Type

- ☐ Registered ☐ Insured
☒ Certified ☐ COD
☐ Express Mail ☐ Return Receipt for Merchandise

7. Date of Delivery

FEB 14 1995

5. Signature (Addressee)

8. Addressee's Address (Only if requested and fee is paid)

6. Signature (Agent)

Tina Wright

Thank you for using Return Receipt Service.

FEB 16 1995

RECEIPT FOR CERTIFIED MAIL
 NO INSURANCE COVERAGE PROVIDED
 NO. FOR INTERNATIONAL MAIL
 (See Reverse)

Sender <i>Gleason Brown</i>	
Street and No. <i>7002 W. Orange Dr.</i>	
City, State, and ZIP <i>Glendale AZ 85303</i>	
Return Receipt (if checked) to whom and for what	
Return Receipt (if checked) showing to whom, Date, and Address of Delivery	
TOTAL Postage and Fees	\$
Postmark or Date <i>Waiver of Subrogation</i> <i>State 36 #1</i> FEB 09 1995	

PS Form 3800, June 1985

New Mexico Oil Conservation Division
 P.O. Box 2208
 Santa Fe, New Mexico 87501

Re: Waiver of Objection to
 Unorthodox Location
 Barbara Fasken - Opera
 State "36" No. 1
 990' FSL & 1650' FWL
 Sec. 36, T17S, R26E
 Eddy County, New Mexico

Dear Sirs:

As an offset operator or mineral interest owner to the above referenced location, objection is hereby waived to the application of Barbara Fasken to drill the above referenced well as an unorthodox gas well location in the Atoka (Penn) gas pool to a total depth of 9200'. The Atoka (Penn) special field rules call for 320 acre gas proration units with locations in the northwest quarter or the southeast quarter of the section. It is noted that the southeast quarter of section 36 has been tested with the Yates Big Boggy State #1-Y drilled and abandoned as a dry hole at a total depth of 9120 feet.

GLEASON BROWN

By: *Gleason Brown*

Title: _____

Date: *2-13-95*

SENDER:

- Complete items 1 and/or 2 for additional services.
- Complete items 3 and 4a & b.
- Print your name and address on the reverse of this form so that we can return this card to you.
- Attach this form to the front of the mailpiece, or on the back if space does not permit.
- Write "Return Receipt Requested" on the mailpiece below the article number.
- The Return Receipt will show to whom the article was delivered and the date delivered.

3. Article Addressed to:

Gleason Brown
7002 West Orange Drive
Glendale, AZ 85303

5. Signature (Addressee)

6. Signature (Agent)

I also wish to receive the following services (for an extra fee):

- ☐ Addressee's Address
- ☐ Restricted Delivery

Consult postmaster for fee.

4a. Article Number

P143 453 954

4b. Service Type

- ☐ Registered ☐ Insured
☒ Certified ☐ COD
☐ Express Mail ☐ Return Receipt for Merchandise

7. Date of Delivery

2-11-95

8. Addressee's Address (Only if requested and fee is paid)

Thank you for using Return Receipt Service.

Is your RETURN ADDRESS completed on the reverse side?

EB 16 1995

P 219 763 480



**Receipt for
Certified Mail**

No Insurance Coverage Provided
Do not use for International Mail
(See Reverse)

Sent to <i>Helen J. Hardgrave & Meredith</i>	
Street and No. <i>P.O. Box 514</i>	
P.O. State and ZIP Code <i>Antlers OK 74523</i>	
Postage	\$
Certified Fee	
Special Delivery Fee	
Restricted Delivery Fee	
Return Receipt Showing to Whom & Date Delivered	
Return Receipt Showing to Whom, Date, and Addressee's Address	
TOTAL Postage & Fees	\$
Postmark or Date <i>Waivers of Objection</i> <i>State 36 #1</i> FEB 09 1995	

PS Form 3800, June 1991

New Mexico Oil Conservation Division
P.O. Box 2208
Santa Fe, New Mexico 87501

Re: Waiver of Objection to
Unorthodox Location
Barbara Fasken - Opera
State "36" No. 1
990' FSL & 1650' FWL
Sec. 36, T17S, R26E
Eddy County, New Mexico

Dear Sirs:

As an offset operator or mineral interest owner to the above referenced location, objection is hereby waived to the application of Barbara Fasken to drill the above referenced well as an unorthodox gas well location in the Atoka (Penn) gas pool to a total depth of 9200'. The Atoka (Penn) special field rules call for 320 acre gas proration units with locations in the northwest quarter or the southeast quarter of the section. It is noted that the southeast quarter of section 36 has been tested with the Yates Big Boggy State #1-Y drilled and abandoned as a dry hole at a total depth of 9120 feet.

HELEN J. HARDGRAVE AND MEREDITH

By: *Helen J. Hardgrave*
Title: *Meredith Hardgrave*
Date: *2-13-95*

SENDER:

- Complete items 1 and/or 2 for additional services.
- Complete items 3, and 4a & b.
- Print your name and address on the reverse of this form so that we can return this card to you.
- Attach this form to the front of the mailpiece, or on the back if space does not permit.
- Write "Return Receipt Requested" on the mailpiece below the article number.
- The Return Receipt will show to whom the article was delivered and the date delivered.

I also wish to receive the following services (for an extra fee):

- ☐ Addressee's Address
 - ☐ Restricted Delivery
- Consult postmaster for fee.

3. Article Addressed to:

Helen J. Hardgrave & Meredith
P.O. Box 514
Antlers, OK 74523

4a. Article Number

P 219 763 480

4b. Service Type

- | | |
|---|---|
| <input type="checkbox"/> Registered | <input type="checkbox"/> Insured |
| <input checked="" type="checkbox"/> Certified | <input type="checkbox"/> COD |
| <input type="checkbox"/> Express Mail | <input type="checkbox"/> Return Receipt for Merchandise |

7. Date of Delivery

2-11-95

5. Signature (Addressee)

Helen J. Hardgrave

6. Signature (Agent)

8. Addressee's Address (Only if requested and fee is paid)

Thank you for using Return Receipt Service.

Is your RETURN ADDRESS completed on the reverse side?

**Receipt for
Certified Mail**

 No Insurance Coverage Provided
 Do not use for International Mail
 (See Reverse)

FEB 17 1995

 New Mexico Oil Conservation Division
 P.O. Box 2208
 Santa Fe, New Mexico 87501

 Re: Waiver of Objection to
 Unorthodox Location
 Barbara Fasken - Oper
 State "36" No. 1
 990' FSL & 1650' FWL
 Sec. 36, T17S, R26E
 Eddy County, New Mexico

PS Form 3800, June 1991

Sent by <i>Ronald Rogers</i>	
Street and No. <i>19455 Indian Summer Ln</i>	
P.O. State and ZIP Code <i>Monument CO 80132</i>	
Postage	\$
Certified Fee	
Special Delivery Fee	
Restricted Delivery Fee	
Return Receipt Showing to Whom & Date Delivered	
Return Receipt Showing to Whom, Date, and Addressee's Address	
TOTAL Postage & Fees	\$
Postmark or Date <i>Waiver of Objection</i> <i>State 36 #1</i> FEB 09 1995	

Dear Sirs:

As an offset operator or mineral interest owner to the above referenced location, objection is hereby waived to the application of Barbara Fasken to drill the above referenced well as an unorthodox gas well location in the Atoka (Penn) gas pool to a total depth of 9200'. The Atoka (Penn) special field rules call for 320 acre gas proration units with locations in the northwest quarter or the southeast quarter of the section. It is noted that the southeast quarter of section 36 has been tested with the Yates Big Boggy State #1-Y drilled and abandoned as a dry hole at a total depth of 9120 feet.

RONALD ROGERS

By: *Ronald Rogers*Title: *Owner*Date: *2/15/95***SENDER:**

- Complete items 1 and/or 2 for additional services.
- Complete items 3, and 4a & b.
- Print your name and address on the reverse of this form so that we can return this card to you.
- Attach this form to the front of the mailpiece, or on the back if space does not permit.
- Write "Return Receipt Requested" on the mailpiece below the article number.
- The Return Receipt will show to whom the article was delivered and the date delivered.

I also wish to receive the following services (for an extra fee):

- ☐ Addressee's Address
- ☐ Restricted Delivery

Consult postmaster for fee.

3. Article Addressed to:

Ronald Rogers
19455 Indian Summer Ln
Monument CO 80132

4a. Article Number

P 219 763 478

4b. Service Type

- | | |
|---|---|
| <input type="checkbox"/> Registered | <input type="checkbox"/> Insured |
| <input checked="" type="checkbox"/> Certified | <input type="checkbox"/> COD |
| <input type="checkbox"/> Express Mail | <input type="checkbox"/> Return Receipt for Merchandise |

7. Date of Delivery

5. Signature (Addressee)

Ronald Rogers

6. Signature (Agent)

8. Addressee's Address (Only if requested and fee is paid)

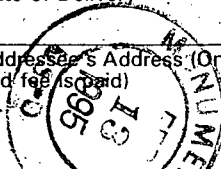

Thank you for using Return Receipt Service.

RECEIPT FOR CERTIFIED MAIL

NO INSURANCE COVERAGE PROVIDED
NOT FOR INTERNATIONAL MAIL

(See Reverse)

FEB 17 1995

New Mexico Oil Conservation Division
P.O. Box 2208
Santa Fe, New Mexico 87501

Re: Waiver of Objection to
Unorthodox Location
Barbara Fasken - Opera
State "36" No. 1
990' FSL & 1650' FWL
Sec. 36, T17S, R26E
Eddy County, New Mexi

PS Form 3800, June 1985

Sent to <i>Roy Leslie Hildon</i>	
Street and No. <i>8 Haig Dr., Sunrise Country Club</i>	
City, State, and Zip <i>Rancho Mirage, CA 92270</i>	
Postage	
Restricted Delivery Fee	
Return Receipt showing to whom and Date Delivered	
Return Receipt showing to whom, Date, and Address of Delivery	
TOTAL Postage and Fees	\$
Postmark or Date <i>Waiver of Objection, State 36 FEB 08 1995</i>	

Dear Sirs:

As an offset operator or mineral interest owner to the above referenced location, objection is hereby waived to the application of Barbara Fasken to drill the above referenced well as an unorthodox gas well location in the Atoka (Penn) gas pool to a total depth of 9200'. The Atoka (Penn) special field rules call for 320 acre gas proration units with locations in the northwest quarter or the southeast quarter of the section. It is noted that the southeast quarter of section 36 has been tested with the Yates Big Boggy State #1-Y drilled and abandoned as a dry hole at a total depth of 9120 feet.

ROY LESLIE HILDON, MARION HALENE HILDON,
ROBERT LESLIE HILDON, RICHARD ALAN HILDON

By: *Marion Halene Hildon*

Title: *Richard Alan Hildon*

Date: *2-14-95*

SENDER:

- Complete items 1 and/or 2 for additional services.
- Complete items 3, and 4a & b.
- Print your name and address on the reverse of this form so that we can return this card to you.
- Attach this form to the front of the mailpiece, or on the back if space does not permit.
- Write "Return Receipt Requested" on the mailpiece below the article number.
- The Return Receipt will show to whom the article was delivered and the date delivered.

I also wish to receive the following services (for an extra fee):

- 1: ☐ Addressee's Address
2: ☐ Restricted Delivery

Consult postmaster for fee.

3. Article Addressed to:

*Roy Leslie Hildon
8 Haig Dr.
Sunrise Country Club
Rancho Mirage, CA
92270*

4a. Article Number

P143 453 930

4b. Service Type

- ☐ Registered ☐ Insured
☒ Certified ☐ COD
☐ Express Mail ☐ Return Receipt for Merchandise

7. Date of Delivery

5. Signature (Addressee)

6. Signature (Agent)

2-13-95

8. Addressee's Address (Only if requested and fee is paid)

Thank you for using Return Receipt Service.

FEB 20 1995

P 219 763 483



**Receipt for
Certified Mail**

No Insurance Coverage Provided
Do not use for International Mail
(See Reverse)

Sent to <u>Harrie L. Perry Jr. & Maxine J. Perry</u>	
Street and No. <u>PO Box 396</u>	
P.O., State and ZIP Code <u>Deridder LA 70634</u>	
Postage	\$
Certified Fee	
Special Delivery Fee	
Restricted Delivery Fee	
Return Receipt Showing to Whom & Date Delivered	
Return Receipt Showing to Whom, Date, and Addressee's Address	
TOTAL Postage & Fees	\$
Postmark or Date <u>Waiver of Objection State 36 4/1</u>	

PS Form 3800, June 1991

New Mexico Oil Conservation Division
P.O. Box 2208
Santa Fe, New Mexico 87501

Re: Waiver of Objection to
Unorthodox Location
Barbara Fasken - Opera
State "36" No. 1
990' FSL & 1650' FWL
Sec. 36, T17S, R26E
Eddy County, New Mexico

Dear Sirs:

As an offset operator or mineral interest owner to the above referenced location, objection is hereby waived to the application of Barbara Fasken to drill the above referenced well as an unorthodox gas well location in the Atoka (Penn) gas pool to a total depth of 9200'. The Atoka (Penn) special field rules call for 320 acre gas proration units with locations in the northwest quarter or the southeast quarter of the section. It is noted that the southeast quarter of section 36 has been tested with the Yates Big Boggy State #1-Y drilled and abandoned as a dry hole at a total depth of 9120 feet.

HARRIE L. PERRY, JR. AND MAXINE J. PERRY

By: Harrie L. Perry Jr.
Title: Trustee, up/e dated 11-14-89
Date: 2-14-95

Is your RETURN ADDRESS completed on the reverse side?

SENDER: • Complete items 1. and/or 2. for additional services. • Complete items 3. and 4a & b. • Print your name and address on the reverse of this form so that we can return this card to you. • Attach this form to the front of the mailpiece, or on the back if space does not permit. • Write "Return Receipt Requested" on the mailpiece below the article number. • The Return Receipt will show to whom the article was delivered and the date delivered.		I also wish to receive the following services (for an extra fee): 1. <input type="checkbox"/> Addressee's Address 2. <input type="checkbox"/> Restricted Delivery Consult postmaster for fee.	
3. Article Addressed to: <u>Harrie L. Perry, Jr. & Maxine J. Perry</u> <u>PO Box 396</u> <u>Deridder LA 70634</u>		4a. Article Number <u>P 219 763 483</u>	
5. Signature (Addressee) <u>Harrie L. Perry Jr.</u>		4b. Service Type <input type="checkbox"/> Registered <input type="checkbox"/> Insured <input checked="" type="checkbox"/> Certified <input type="checkbox"/> COD <input type="checkbox"/> Express Mail <input type="checkbox"/> Return Receipt for Merchandise	
6. Signature (Agent)		7. Date of Delivery <u>2/13/95</u>	
		8. Addressee's Address (Only if requested and fee is paid)	

FEB 20 1995

P. 219 763 489



Receipt for Certified Mail

No Insurance Coverage Provided
Do not use for International Mail
(See Reverse)

New Mexico Oil Conservation Division
P.O. Box 2208
Santa Fe, New Mexico 87501

Re: Waiver of Objection to
Unorthodox Location
Barbara Fasken - Opera
State "36" No. 1
990' FSL & 1650' FWL
Sec. 36, T17S, R26E
Eddy County, New Mexico

PS Form 3800, June 1991

Sent to <i>Jonathan J Peden</i>	
Street and No. <i>4681 Diane Ave</i>	
City, State and ZIP Code <i>San Diego CA 92117-2903</i>	
Postage	\$
Certified Fee	
Special Delivery Fee	
Restricted Delivery Fee	
Return Receipt Showing to Whom & Date Delivered	
Return Receipt Showing to Whom, Date, and Addressee's Address	
TOTAL Postage & Fees	\$
Postmark or Date <i>Waiver of Objection</i> <i>State 36 #1</i> FEB 09 1995	

Dear Sirs:

As an offset operator or mineral interest owner to the above referenced location, objection is hereby waived to the application of Barbara Fasken to drill the above referenced well as an unorthodox gas well location in the Atoka (Penn) gas pool to a total depth of 9200'. The Atoka (Penn) special field rules call for 320 acre gas proration units with locations in the northwest quarter or the southeast quarter of the section. It is noted that the southeast quarter of section 36 has been tested with the Yates Big Boggy State #1-Y drilled and abandoned as a dry hole at a total depth of 9120 feet.

JONATHAN J. PEDEN

By: *Jonathan J Peden*

Title: *mineral interest owner*

Date: *2/13/95*

SENDER: • Complete items 1 and/or 2 for additional services. • Complete items 3, and 4a & b. • Print your name and address on the reverse of this form so that we can return this card to you. • Attach this form to the front of the mailpiece, or on the back if space does not permit. • Write "Return Receipt Requested" on the mailpiece below the article number. • The Return Receipt will show to whom the article was delivered and the date delivered.		I also wish to receive the following services (for an extra fee): 1. <input type="checkbox"/> Addressee's Address 2. <input type="checkbox"/> Restricted Delivery Consult postmaster for fee.	
3. Article Addressed to: <i>Jonathan J Peden</i> <i>4681 Diane Ave</i> <i>San Diego, CA 92117-2903</i>		4a. Article Number <i>P 219 763 489</i>	
4b. Service Type <input type="checkbox"/> Registered <input type="checkbox"/> Insured <input checked="" type="checkbox"/> Certified <input type="checkbox"/> COD <input type="checkbox"/> Express Mail <input type="checkbox"/> Return Receipt for Merchandise		Date of Delivery 	
5. Signature (Addressee) <i>Jonathan J Peden</i>		8. Addressee's Address (Only if requested and fee is paid)	
6. Signature (Agent) <i>Helene C. Peden</i>			

Thank you for using Return Receipt Service.

FEB 20 1995

R 219 763 474



Receipt for Certified Mail

No Insurance Coverage Provided
Do not use for International Mail
(See Reverse)

Sent to <i>Marvin L. Lundblade</i>	
Street and No. <i>13184 S E 124th</i>	
P.O., State and ZIP Code <i>Clackamas OR 97015</i>	
Postage	\$
Certified Fee	
Special Delivery Fee	
Restricted Delivery Fee	
Return Receipt Showing to Whom & Date Delivered	
Return Receipt Showing to Whom, Date, and Addressee's Address	
TOTAL Postage & Fees	\$
Postmark or Date <i>Waiver of Objection State 36 41 FEB 09 1995</i>	

PS Form 3800, June 1991

New Mexico Oil Conservation Division
P.O. Box 2208
Santa Fe, New Mexico 87501

Re: Waiver of Objection to
Unorthodox Location
Barbara Fasken - Opera
State "36" No. 1
990' FSL & 1650' FWL
Sec. 36, T17S, R26E
Eddy County, New Mexico

Dear Sirs:

As an offset operator or mineral interest owner to the above referenced location, objection is hereby waived to the application of Barbara Fasken to drill the above referenced well as an unorthodox gas well location in the Atoka (Penn) gas pool to a total depth of 9200'. The Atoka (Penn) special field rules call for 320 acre gas proration units with locations in the northwest quarter or the southeast quarter of the section. It is noted that the southeast quarter of section 36 has been tested with the Yates Big Boggy State #1-Y drilled and abandoned as a dry hole at a total depth of 9120 feet.

MARVIN L. LUNDBLADE

By: *Marvin L. Lundblade*

Title: _____

Date: *2/15/95*

SENDER: • Complete items 1 and/or 2 for additional services. • Complete items 3, and 4a & b. • Print your name and address on the reverse of this form so that we can return this card to you. • Attach this form to the front of the mailpiece, or on the back if space does not permit. • Write "Return Receipt Requested" on the mailpiece below the article number. • The Return Receipt will show to whom the article was delivered and the date delivered.		I also wish to receive the following services (for an extra fee): 1. <input type="checkbox"/> Addressee's Address 2. <input type="checkbox"/> Restricted Delivery Consult postmaster for fee.	
3. Article Addressed to: <i>Marvin L. Lundblade 13184 S E 124th Clackamas, OR 97015 Marvin L. Lundblade</i>		4a. Article Number <i>P 219 763 474</i>	
5. Signature (Addressee) <i>Marvin L. Lundblade</i>		4b. Service Type <input type="checkbox"/> Registered <input type="checkbox"/> Insured <input checked="" type="checkbox"/> Certified <input type="checkbox"/> COD <input type="checkbox"/> Express Mail <input type="checkbox"/> Return Receipt for Merchandise	
6. Signature (Agent)		7. Date of Delivery <i>2-13-95</i>	
		8. Addressee's Address (Only if requested and fee is paid)	

Is your RETURN ADDRESS completed on the reverse side?

Thank you for using Return Receipt Service.

FEB 20 1995

P 219 763 479



**Receipt for
Certified Mail**

No Insurance Coverage Provided
Do not use for International Mail
(See Reverse)

Sent to <i>Homer A. Swearingen</i>	
Street and No. <i>2364 N Richmond St</i>	
P.O., State and ZIP Code <i>Wichita KS 67204</i>	
Postage	\$
Certified Fee	
Special Delivery Fee	
Restricted Delivery Fee	
Return Receipt Showing to Whom & Date Delivered	
Return Receipt Showing to Whom, Date, and Addressee's Address	
TOTAL Postage & Fees	\$
Postmark or Date <i>Waiver of Objection State 36 #1 FEB 09 1995</i>	

PS Form 3800, June 1991

New Mexico Oil Conservation Division
P.O. Box 2208
Santa Fe, New Mexico 87501

Re: Waiver of Objection to
Unorthodox Location
Barbara Fasken - Oper.
State "36" No. 1
990' FSL & 1650' FWL
Sec. 36, T17S, R26E
Eddy County, New Mexico

Dear Sirs:

As an offset operator or mineral interest owner to the above referenced location, objection is hereby waived to the application of Barbara Fasken to drill the above referenced well as an unorthodox gas well location in the Atoka (Penn) gas pool to a total depth of 9200'. The Atoka (Penn) special field rules call for 320 acre gas proration units with locations in the northwest quarter or the southeast quarter of the section. It is noted that the southeast quarter of section 36 has been tested with the Yates Big Boggy State #1-Y drilled and abandoned as a dry hole at a total depth of 9120 feet.

HOMER A. SWEARINGEN

By: *Homer A. Swearingen*

Title: _____

Date: *2-15-95*

SENDER:

- Complete items 1 and/or 2 for additional services.
- Complete items 3; and 4a & b.
- Print your name and address on the reverse of this form so that we can return this card to you.
- Attach this form to the front of the mailpiece, or on the back if space does not permit.
- Write "Return Receipt Requested" on the mailpiece below the article number.
- The Return Receipt will show to whom the article was delivered and the date delivered.

I also wish to receive the following services (for an extra fee):

- ☐ Addressee's Address
- ☐ Restricted Delivery

Consult postmaster for fee.

3. Article Addressed to: <i>Homer A. Swearingen 2364 N Richmond St Wichita KS 67204</i>	
5. Signature (Addressee) <i>Homer Swearingen</i>	
6. Signature (Agent)	

4a. Article Number <i>P 219 763 479</i>
4b. Service Type <input type="checkbox"/> Registered <input type="checkbox"/> Insured <input checked="" type="checkbox"/> Certified <input type="checkbox"/> COD <input type="checkbox"/> Express Mail <input type="checkbox"/> Return Receipt for Merchandise
7. Date of Delivery <i>2-13-95</i>
8. Addressee's Address (Only if requested and fee is paid)

Thank you for using Return Receipt Service.

Is your RETURN ADDRESS completed on the reverse side?

FEB 21 1995

RECEIPT FOR CERTIFIED MAIL

NO INSURANCE COVERAGE PROVIDED
NOT FOR INTERNATIONAL MAIL

(See Reverse)

New Mexico Oil Conservation Division
P.O. Box 2208
Santa Fe, New Mexico 87501

Re: Waiver of Objection to
Unorthodox Location
Barbara Fasken - Op
State "36" No. 1
990' FSL & 1650' FW
Sec. 36, T17S, R26E
Eddy County, New M

PS Form 3800, June 1985

Sent to	Howard Swearingen
Street and No.	Rt. 1
State and Zip Code	Jamestown, KS 66948
Postage	
Restricted Delivery	
Return Receipt showing to whom and Date Delivered	
Return Receipt showing to whom Date, and Address of Delivery	
TOTAL Postage and Fees	\$
Postmark or Date	Waiver of Objection State 36 #1 FEB 9 9 1995

Dear Sirs:

As an offset operator or mineral interest owner to the above referenced location, objection is hereby waived to the application of Barbara Fasken to drill the above referenced well as an unorthodox gas well location in the Atoka (Penn) gas pool to a total depth of 9200'. The Atoka (Penn) special field rules call for 320 acre gas proration units with locations in the northwest quarter or the southeast quarter of the section. It is noted that the southeast quarter of section 36 has been tested with the Yates Big Boggy State #1-Y drilled and abandoned as a dry hole at a total depth of 9120 feet.

HOWARD SWEARINGEN

By: H Swearingen

Title: _____

Date: Feb 15 - 1995

Is your RETURN ADDRESS completed on the reverse side?

SENDER:

- Complete items 1, and/or 2 for additional services.
- Complete items 3, and 4a & b.
- Print your name and address on the reverse of this form so that we can return this card to you.
- Attach this form to the front of the mailpiece, or on the back if space does not permit.
- Write "Return Receipt Requested" on the mailpiece below the article number.
- The Return Receipt will show to whom the article was delivered and the date delivered.

I also wish to receive the following services (for an extra fee):

- ☐ Addressee's Address
 - ☐ Restricted Delivery
- Consult postmaster for fee.

3. Article Addressed to:

Howard Swearingen
Rt. 1
Jamestown, KS 66948

4a. Article Number

P143 453 938

4b. Service Type

- ☐ Registered ☐ Insured
☒ Certified ☐ COD
☐ Express Mail ☐ Return Receipt for Merchandise

7. Date of Delivery

2-13-95

5. Signature (Addressee)

H Swearingen

6. Signature (Agent)

8. Addressee's Address (Only if requested and fee is paid)

Thank you for using Return Receipt Service.

FEB 21 1995



New Mexico Oil Conservation Division
P.O. Box 2208
Santa Fe, New Mexico 87501

Re: Waiver of Objection to
Unorthodox Location
Barbara Fasken - Opera
State "36" No. 1
990' FSL & 1650' FWL
Sec. 36, T17S, R26E
Eddy County, New Mexico

PS Form 3800, June 1991

Sent to <u>Helen Marcotte</u>	
Suggested No. <u>PQ Box 42</u>	
P.O. State and ZIP Code <u>Concordia KS 66901</u>	
Postage	\$
Certified Fee	
Special Delivery Fee	
Restricted Delivery Fee	
Return Receipt Showing to Whom & Date Delivered	
Return Receipt Showing to Whom, Date, and Addressee's Address	
TOTAL Postage & Fees	\$
Postmark or Date <u>Waiver of Objection</u> <u>State 36th 1</u> FEB 09 1995	

Dear Sirs:

As an offset operator or mineral interest owner to the above referenced location, objection is hereby waived to the application of Barbara Fasken to drill the above referenced well as an unorthodox gas well location in the Atoka (Penn) gas pool to a total depth of 9200'. The Atoka (Penn) special field rules call for 320 acre gas proration units with locations in the northwest quarter or the southeast quarter of the section. It is noted that the southeast quarter of section 36 has been tested with the Yates Big Boggy State #1-Y drilled and abandoned as a dry hole at a total depth of 9120 feet.

HELEN MARCOTTE

By: Helen Marcotte

Title: owner

Date: 2-16-1995

SENDER:

- Complete items 1 and/or 2 for additional services.
- Complete items 3, and 4a & b.
- Print your name and address on the reverse of this form so that we can return this card to you.
- Attach this form to the front of the mailpiece, or on the back if space does not permit.
- Write "Return Receipt Requested" on the mailpiece below the article number.
- The Return Receipt will show to whom the article was delivered and the date delivered.

I also wish to receive the following services (for an extra fee):

- ☐ Addressee's Address
- ☐ Restricted Delivery

Consult postmaster for fee.

3. Article Addressed to:

Helen Marcotte
PQ Box 42
Concordia KS 66901

4a. Article Number

P219 763 475

4b. Service Type

- ☐ Registered ☐ Insured
☒ Certified ☐ COD
☐ Express Mail ☐ Return Receipt for Merchandise

7. Date of Delivery

FEB 14 1995

5. Signature (Addressee)

HELEN MARCOTTE

6. Signature (Agent)

Helen Marcotte

8. Addressee's Address (Only if requested and fee is paid)

FEB 14 1995

Thank you for using Return Receipt Service

Is your RETURN ADDRESS completed on the reverse side?

FEB 21 1995

RECEIPT FOR CERTIFIED MAIL

NO INSURANCE COVERAGE PROVIDED
NOT FOR INTERNATIONAL MAIL

(See Reverse)

New Mexico Oil Conservation Division
P.O. Box 2208
Santa Fe, New Mexico 87501

Re: Waiver of Objection to
Unorthodox Location
Barbara Fasken - Oper;
State "36" No. 1
990' FSL & 1650' FWL
Sec. 36, T17S, R26E
Eddy County, New Mex

PS Form 3800, June 1985

Sent to	<i>Dan W. Irwin, SSP</i>
Street and No.	<i>118 N. Grant St.</i>
City, State and ZIP Code	<i>Hensdale, IL 60521</i>
Postage	
Restricted Delivery Charge	
Return Receipt (showing to whom Date and Address of Delivery)	
TOTAL Postage and Fees	\$
Postmark or Date	<i>FEB 09 1995</i>
	<i>W.D. Byron</i>
	<i>State 36 #1</i>

Dear Sirs:

As an offset operator or mineral interest owner to the above referenced location, objection is hereby waived to the application of Barbara Fasken to drill the above referenced well as an unorthodox gas well location in the Atoka (Penn) gas pool to a total depth of 9200'. The Atoka (Penn) special field rules call for 320 acre gas proration units with locations in the northwest quarter or the southeast quarter of the section. It is noted that the southeast quarter of section 36 has been tested with the Yates Big Boggy State #1-Y drilled and abandoned as a dry hole at a total depth of 9120 feet.

DAN W. IRWIN, SSP

By: *Dan W. Irwin*Title: *Co. Trustee, Wallace W. Irwin Testamentary Trust*Date: *2/16/95*

SENDER:

- Complete items 1. and/or 2. for additional services.
- Complete items 3. and 4a & b.
- Print your name and address on the reverse of this form so that we can return this card to you.
- Attach this form to the front of the mailpiece, or on the back if space does not permit.
- Write "Return Receipt Requested" on the mailpiece below the article number.
- The Return Receipt will show to whom the article was delivered and the date delivered.

3. Article Addressed to:

Dan W. Irwin, SSP
118 N. Grant St.
Hensdale, IL 60521

5. Signature (Addressee)

6. Signature (Agent)

I also wish to receive the following services (for an extra fee):

- ☐ Addressee's Address
- ☐ Restricted Delivery

Consult postmaster for fee.

4a. Article Number

P143 453 921

4b. Service Type

- ☒ Registered ☐ Insured
☒ Certified ☐ COD
☐ Express Mail ☐ Return Receipt for Merchandise

7. Date of Delivery

2-15-95

8. Addressee's Address (Only if requested and fee is paid)

Thank you for using Return Receipt Service

FEB 21 1995

P 219 763 487



**Receipt for
Certified Mail**

No Insurance Coverage Provided
Do not use for International Mail
(See Reverse)

New Mexico Oil Conservation Division
P.O. Box 2208
Santa Fe, New Mexico 87501

Re: Waiver of Objection to
Unorthodox Location
Barbara Fasken - Opera
State "36" No. 1
990' FSL & 1650' FWL
Sec. 36, T17S, R26E
Eddy County, New Mexi

PS Form 3800, June 1991

Name to	
Sheryl S Collins	
Street and No.	
3209 SW Belle Ave	
P.O. State and ZIP Code	
Lopeka KS 66614-4027	
Postage	\$
Certified Fee	
Special Delivery Fee	
Restricted Delivery Fee	
Return Receipt Showing to Whom & Date Delivered	
Return Receipt Showing to Whom, Date, and Addressee's Address	
TOTAL Postage & Fees	\$
Postmark or Date	
Waiver of Objection State 36 #1 FEB 09 1995	

Dear Sirs:

As an offset operator or mineral interest owner to the above referenced location, objection is hereby waived to the application of Barbara Fasken to drill the above referenced well as an unorthodox gas well location in the Atoka (Penn) gas pool to a total depth of 9200'. The Atoka (Penn) special field rules call for 320 acre gas proration units with locations in the northwest quarter or the southeast quarter of the section. It is noted that the southeast quarter of section 36 has been tested with the Yates Big Boggy State #1-Y drilled and abandoned as a dry hole at a total depth of 9120 feet.

SHERYL S. COLLINS

By: Sheryl S. Collins

Title: Owner

Date: 2/16/95

SENDER:

- Complete items 1 and/or 2 for additional services.
- Complete items 3, and 4a & b.
- Print your name and address on the reverse of this form so that we can return this card to you.
- Attach this form to the front of the mailpiece, or on the back if space does not permit.
- Write "Return Receipt Requested" on the mailpiece below the article number.
- The Return Receipt will show to whom the article was delivered and the date delivered.

I also wish to receive the following services (for an extra fee):

- ☐ Addressee's Address
- ☐ Restricted Delivery

Consult postmaster for fee.

3. Article Addressed to:

Sheryl S Collins
3209 SW Belle Ave
Lopeka KS 66614-4027

4a. Article Number

P 219 763 487

4b. Service Type

- | | |
|---|---|
| <input type="checkbox"/> Registered | <input type="checkbox"/> Insured |
| <input checked="" type="checkbox"/> Certified | <input type="checkbox"/> COD |
| <input type="checkbox"/> Express Mail | <input type="checkbox"/> Return Receipt for Merchandise |

7. Date of Delivery

FEB 15 1995

5. Signature (Addressee)

Sheryl S. Collins

6. Signature (Agent)

SHERYL S. COLLINS

8. Addressee's Address (Only if requested and fee is paid)

Thank you for using Return Receipt Service.

FE

P 219 763 470



Receipt for Certified Mail

No Insurance Coverage Provided
Do not use for International Mail
(See Reverse)

New Mexico Oil Conservation Division
P.O. Box 2208
Santa Fe, New Mexico 87501

Re: Waiver of Objection to
Unorthodox Location
Barbara Fasken - Opera
State "36" No. 1
990' FSL & 1650' FWL
Sec. 36, T17S, R26E
Eddy County, New Mexi

PS Form 3800, June 1991

Sent to <i>Marion Swearingen</i>	
Street and No. <i>2828 S E Downing Rd</i>	
P.O. State and ZIP Code <i>Topeka KS 66605</i>	
Postage	\$
Certified Fee	
Special Delivery Fee	
Restricted Delivery Fee	
Return Receipt Showing to Whom & Date Delivered	
Return Receipt Showing to Whom, Date, and Addressee's Address	
TOTAL Postage & Fees	\$
Postmark or Date <i>Waiver of Objection State 36 #1 FEB 09 1995</i>	

Dear Sirs:

As an offset operator or mineral interest owner to the above referenced location, objection is hereby waived to the application of Barbara Fasken to drill the above referenced well as an unorthodox gas well location in the Atoka (Penn) gas pool to a total depth of 9200'. The Atoka (Penn) special field rules call for 320 acre gas proration units with locations in the northwest quarter or the southeast quarter of the section. It is noted that the southeast quarter of section 36 has been tested with the Yates Big Boggy State #1-Y drilled and abandoned as a dry hole at a total depth of 9120 feet.

MARION L. SWEARINGEN

By: *Marion L. Swearingen* by
 Title: *Lenora M. Swearingen* by
Power of Attorney
 Date: *2 / 16 / 95*

SENDER:

- Complete items 1 and/or 2 for additional services.
- Complete items 3, and 4a & b.
- Print your name and address on the reverse of this form so that we can return this card to you.
- Attach this form to the front of the mailpiece, or on the back if space does not permit.
- Write "Return Receipt Requested" on the mailpiece below the article number.
- The Return Receipt will show to whom the article was delivered and the date delivered.

I also wish to receive the following services (for an extra fee):

- ☐ Addressee's Address
- ☐ Restricted Delivery

Consult postmaster for fee.

3. Article Addressed to:

Marion L Swearingen
2828 S E Downing Rd
Topeka KS 66605
Lenora Swearingen

4a. Article Number

P219 763 470

4b. Service Type

- | | |
|---|---|
| <input type="checkbox"/> Registered | <input type="checkbox"/> Insured |
| <input checked="" type="checkbox"/> Certified | <input type="checkbox"/> COD |
| <input type="checkbox"/> Express Mail | <input type="checkbox"/> Return Receipt for Merchandise |

7. Date of Delivery

13 FEB 1995

5. Signature (Addressee)

8. Addressee's Address (Only if requested and fee is paid)

6. Signature (Agent)

Thank you for using Return Receipt Service.

FEB 21 1995

P 143 453 946

RECEIPT FOR CERTIFIED MAIL

NO INSURANCE COVERAGE PROVIDED
NOT FOR INTERNATIONAL MAIL

(See Reverse)

Sent to <i>Mr Swearingen</i>	
Street and No. <i>1066 Burr Oak Ln.</i>	
Post Office and ZIP Code <i>Salina, KS 67401</i>	
Postage	
Registered Delivery Fee	
Return Receipt showing to whom and Date Delivered	
Return Receipt showing to whom Date and Address of Delivery	
TOTAL Postage and Fees	5
Postmark or Date <i>Waiver of Objection</i> <i>State 36 #1</i> FEB 09 1995	

PS Form 3800, June 1985

New Mexico Oil Conservation Division
P.O. Box 2208
Santa Fe, New Mexico 87501

Re: Waiver of Objection to
Unorthodox Location
Barbara Fasken - Oper
State "36" No. 1
990' FSL & 1650' FWL
Sec. 36, T17S, R26E
Eddy County, New Me

Dear Sirs:

As an offset operator or mineral interest owner to the above referenced location, objection is hereby waived to the application of Barbara Fasken to drill the above referenced well as an unorthodox gas well location in the Atoka (Penn) gas pool to a total depth of 9200'. The Atoka (Penn) special field rules call for 320 acre gas proration units with locations in the northwest quarter or the southeast quarter of the section. It is noted that the southeast quarter of section 36 has been tested with the Yates Big Boggy State #1-Y drilled and abandoned as a dry hole at a total depth of 9120 feet.

GLEN SWEARINGEN

By: *Glen Swearingen*

Title: _____

Date: *2-15-95*

SENDER:

- Complete items 1 and/or 2 for additional services.
- Complete items 3j and 4a & b.
- Print your name and address on the reverse of this form so that we can return this card to you.
- Attach this form to the front of the mailpiece, or on the back if space does not permit.
- Write "Return Receipt Requested" on the mailpiece below the article number.
- The Return Receipt will show to whom the article was delivered and the date delivered.

3. Article Addressed to:

Mr Swearingen
1066 Burr Oak Lane
Salina, KS 67401

4a. Article Number

0143 453 946

4b. Service Type

- ☐ Registered ☐ Insured
☒ Certified ☐ COD
☐ Express Mail ☐ Return Receipt for Merchandise

7. Date of Delivery

5. Signature (Addressee)

6. Signature (Agent)

8. Addressee's Address (Only if requested and fee is paid)

Thank you for using Return Receipt Service.

Is your RETURN ADDRESS completed on the reverse side?

FEB 21 1995

P 219 763 486

**Receipt for
Certified Mail**

 No Insurance Coverage Provided
 Do not use for International Mail
 (See Reverse)

 New Mexico Oil Conservation Division
 P.O. Box 2208
 Santa Fe, New Mexico 87501

 Re: Waiver of Objection to
 Unorthodox Location
 Barbara Fasken - Opera
 State "36" No. 1
 990' FSL & 1650' FWL
 Sec. 36, T17S, R26E
 Eddy County, New Mexic

Sent to <i>Anna Pauline Swearingen</i>	
Street and No. <i>512 Cedar St.</i>	
P.O., State and ZIP Code <i>Concordia, KS 66901</i>	
Postage	\$
Certified Fee	
Special Delivery Fee	
Restricted Delivery Fee	
Return Receipt Showing to Whom & Date Delivered	
Return Receipt Showing to Whom, Date, and Addressee's Address	
TOTAL Postage & Fees	\$
Postmark or Date <i>Waiver of Objection State 36 #1 FEB 09 1995</i>	

PS Form 3800, June 1991

Dear Sirs:

As an offset operator or mineral interest owner to the above referenced location, objection is hereby waived to the application of Barbara Fasken to drill the above referenced well as an unorthodox gas well location in the Atoka (Penn) gas pool to a total depth of 9200'. The Atoka (Penn) special field rules call for 320 acre gas proration units with locations in the northwest quarter or the southeast quarter of the section. It is noted that the southeast quarter of section 36 has been tested with the Yates Big Boggy State #1-Y drilled and abandoned as a dry hole at a total depth of 9120 feet.

ANNA PAULINE SWEARINGEN

By: *A. Pauline Swearingen*Title: *interest*Date: *Feb. 16 1995***SENDER:**

- Complete items 1 and/or 2 for additional services.
- Complete items 3, and 4a & b.
- Print your name and address on the reverse of this form so that we can return this card to you.
- Attach this form to the front of the mailpiece, or on the back if space does not permit.
- Write "Return Receipt Requested" on the mailpiece below the article number.
- The Return Receipt will show to whom the article was delivered and the date delivered.

I also wish to receive the following services (for an extra fee):

1. ☐ Addressee's Address
2. ☐ Restricted Delivery
- Consult postmaster for fee.

3. Article Addressed to:

*Anna Pauline Swearingen
 512 Cedar St.
 Concordia KS 66901
 Pauline Swearingen*

5. Signature (Addressee)

Pauline Swearingen

6. Signature (Agent)

4a. Article Number

P 219 763 486

4b. Service Type

- ☐ Registered ☐ Insured
- ☒ Certified ☐ COD
- ☐ Express Mail ☐ Return Receipt for Merchandise

7. Date of Delivery

2-13-95

8. Addressee's Address (Only if requested and fee is paid)

Thank you for using Return Receipt Service.

Is your RETURN ADDRESS completed on the reverse side?

FEB 23 1995

P. 219 763 484



Receipt for Certified Mail

No Insurance Coverage Provided
Do not use for International Mail
(See Reverse)

New Mexico Oil Conservation Division
P.O. Box 2208
Santa Fe, New Mexico 87501

Re: Waiver of Objection to
Unorthodox Location
Barbara Fasken - Opera
State "36" No. 1
990' FSL & 1650' FWL
Sec. 36, T17S, R26E
Eddy County, New Mexico

PS Form 3800, June 1991

Sept 16	
Stanico Energy Corp	
Street and No.	
P.O. Box 32467	
City, State and Zip Code	
OKla. City OK 73123-2462	
Postage	\$
Certified Fee	
Special Delivery Fee	
Restricted Delivery Fee	
Return Receipt Showing to Whom & Date Delivered	
Return Receipt Showing to Whom, Date, and Addressee's Address	
TOTAL Postage & Fees	\$
Postmark or Date	
Waiver of Objection	
State 36 #1	
FEB 09 1995	

Dear Sirs:

As an offset operator or mineral interest owner to the above referenced location, objection is hereby waived to the application of Barbara Fasken to drill the above referenced well as an unorthodox gas well location in the Atoka (Penn) gas pool to a total depth of 9200'. The Atoka (Penn) special field rules call for 320 acre gas proration units with locations in the northwest quarter or the southeast quarter of the section. It is noted that the southeast quarter of section 36 has been tested with the Yates Big Boggy State #1-Y drilled and abandoned as a dry hole at a total depth of 9120 feet.

STANICO ENERGY CORPORATION

By: Nelson Collier
Title: President
Date: Feb. 15, 1995

Is your RETURN ADDRESS completed on the reverse side?

SENDER: • Complete items 1 and/or 2 for additional services. • Complete items 3, and 4a & b. • Print your name and address on the reverse of this form so that we can return this card to you. • Attach this form to the front of the mailpiece, or on the back if space does not permit. • Write "Return Receipt Requested" on the mailpiece below the article number. • The Return Receipt will show to whom the article was delivered and the date delivered.		I also wish to receive the following services (for an extra fee): 1. <input type="checkbox"/> Addressee's Address 2. <input type="checkbox"/> Restricted Delivery Consult postmaster for fee.	
3. Article Addressed to: <u>Stanico Energy Corp</u> <u>P.O. Box 32467</u> <u>Oklahoma City, OK 73123</u> <u>2462</u>		4a. Article Number <u>P 219 763 484</u>	
4b. Service Type <input type="checkbox"/> Registered <input type="checkbox"/> Insured <input checked="" type="checkbox"/> Certified <input type="checkbox"/> COD <input type="checkbox"/> Express Mail <input type="checkbox"/> Return Receipt for Merchandise		7. Date of Delivery 	
5. Signature (Addressee) <u>Rosemary Collier</u>		8. Addressee's Address (Only if requested and fee is paid)	
6. Signature (Agent)			

PS Form 3811, December 1991 ★U.S. GPO: 1993-352-714 **DOMESTIC RETURN RECEIPT**

Thank you for using Return Receipt Service.

FEB 23 1995

RECEIPT FOR CERTIFIED MAIL
 NO INSURANCE COVERAGE PROVIDED
 NOT FOR INTERNATIONAL MAIL
 (See Reverse)

Sent To	Sierra Oil Co
Street and No.	P.O. Box 1354
P.O. State and Zip Code	Roswell NM 88201
P. Stamp	
Postage Fee	
Restricted Delivery Fee	
Registered Delivery Fee	
Return Receipt showing to whom and Date Delivered	
Return Receipt showing to whom, Date, and Address of Delivery	
TOTAL Postage and Fees	\$
Postmark or Date	Waiver of Objection State 36 #1 FEB 09 1995

PS Form 3800, June 1985

New Mexico Oil Conservation Division
 P.O. Box 2208
 Santa Fe, New Mexico 87501

Re: Waiver of Objection to
 Unorthodox Location
 Barbara Fasken - Operat
 State "36" No. 1
 990' FSL & 1650' FWL
 Sec. 36, T17S, R26E
 Eddy County, New Mexic

Dear Sirs:

As an offset operator or mineral interest owner to the above referenced location, objection is hereby waived to the application of Barbara Fasken to drill the above referenced well as an unorthodox gas well location in the Atoka (Penn) gas pool to a total depth of 9200'. The Atoka (Penn) special field rules call for 320 acre gas proration units with locations in the northwest quarter or the southeast quarter of the section. It is noted that the southeast quarter of section 36 has been tested with the Yates Big Boggy State #1-Y drilled and abandoned as a dry hole at a total depth of 9120 feet.

TIERRA OIL COMPANY

By: W. Ch. Bahill
 Title: VIC - PRESIDENT
 Date: 2/20/95

SENDER:

- Complete items 1 and/or 2 for additional services.
- Complete items 3, and 4a & b.
- Print your name and address on the reverse of this form so that we can return this card to you.
- Attach this form to the front of the mailpiece, or on the back if space does not permit.
- Write "Return Receipt Requested" on the mailpiece below the article number.
- The Return Receipt will show to whom the article was delivered and the date delivered.

I also wish to receive the following services (for an extra fee):

- ☐ Addressee's Address
- ☐ Restricted Delivery

Consult postmaster for fee.

3. Article Addressed to:

Sierra Oil Company
 P.O. Box 1354
 Roswell NM 88201
Brian Banks

4a. Article Number

P143453955

4b. Service Type

- | | |
|---|---|
| <input type="checkbox"/> Registered | <input type="checkbox"/> Insured |
| <input checked="" type="checkbox"/> Certified | <input type="checkbox"/> COD |
| <input type="checkbox"/> Express Mail | <input type="checkbox"/> Return Receipt for Merchandise |

7. Date of Delivery

2-13-95

5. Signature (Addressee)
8. Addressee's Address (Only if requested and fee is paid)
6. Signature (Agent)

Thank you for using Return Receipt Service

Is your RETURN ADDRESS completed on the reverse side?

FEB 23 1995

RECEIPT FOR CERTIFIED MAIL

NO INSURANCE COVERAGE PROVIDED

NOT FOR INTERNATIONAL MAIL

(See Reverse)

New Mexico Oil Conservation Division
P.O. Box 2208
Santa Fe, New Mexico 87501

Re: Waiver of Objection to
Unorthodox Location
Barbara Fasken - Ope
State "36" No. 1
990' FSL & 1650' FW
Sec. 36, T17S, R26E
Eddy County, New Mexico

PS Form 3800, June 1985

Sent to <i>Landa M. Harrel & Don Harrel</i>	
Street and No. <i>P.O. Box 443</i>	
City, State, and ZIP Code <i>Fletcher, OK 73541</i>	
Postage	
Return Receipt showing to whom and Date Delivered	
Return Receipt showing to whom Date, and Address of Delivery	
TOTAL Postage and Fees	\$
Postmark or Date <i>Waiver of Objection</i> <i>State 36</i> FEB 03 1995	

Dear Sirs:

As an offset operator or mineral interest owner to the above referenced location, objection is hereby waived to the application of Barbara Fasken to drill the above referenced well as an unorthodox gas well location in the Atoka (Penn) gas pool to a total depth of 9200'. The Atoka (Penn) special field rules call for 320 acre gas proration units with locations in the northwest quarter or the southeast quarter of the section. It is noted that the southeast quarter of section 36 has been tested with the Yates Big Boggy State #1-Y drilled and abandoned as a dry hole at a total depth of 9120 feet.

LANDA M. HARREL

By: *Landa M. Harrel*Title: *Mineral Interest Owner*Date: *2-20-95*

SENDER:

- Complete items 1. and/or 2 for additional services.
- Complete items 3. and 4a & b.
- Print your name and address on the reverse of this form so that we can return this card to you.
- Attach this form to the front of the mailpiece, or on the back if space does not permit.
- Write "Return Receipt Requested" on the mailpiece below the article number.
- The Return Receipt will show to whom the article was delivered and the date delivered.

I also wish to receive the following services (for an extra fee):

- ☐ Addressee's Address
- ☐ Restricted Delivery

Consult postmaster for fee.

3. Article Addressed to:

Landa M. Harrel & Don Harrel
P.O. Box 443
Fletcher, OK 73541

4a. Article Number

P 143 453 953

4b. Service Type

- | | |
|---|---|
| <input type="checkbox"/> Registered | <input type="checkbox"/> Insured |
| <input checked="" type="checkbox"/> Certified | <input type="checkbox"/> COD |
| <input type="checkbox"/> Express Mail | <input type="checkbox"/> Return Receipt for Merchandise |

7. Date of Delivery

2/11/95

5. Signature (Addressee)

X Don Harrel

6. Signature (Agent)

8. Addressee's Address (Only if requested and fee is paid)

Thank you for using Return Receipt Service.

FEB 2

RECEIPT FOR CERTIFIED MAIL
 NO INSURANCE COVERAGE PROVIDED
 NOT FOR INTERNATIONAL MAIL
 (See Reverse)

Sent to <u>Addie Swearingen</u>	
Street and No. <u>1100 Gemini Circle</u>	
City, State and ZIP Code <u>Portales, NM 88130</u>	
Postage \$	
Insurance Fee \$	
Special Delivery Fee \$	
Registered Delivery Fee \$	
Return Receipt showing to whom and Date Delivered \$	
Return Receipt showing to whom Date, and Address of Delivery \$	
TOTAL Postage and Fees \$	
Postmark or Date <u>Waiver of Objection</u> <u>State 36 #P</u> <u>FEB 09 1995</u>	

PS Form 3800, June 1985

New Mexico Oil Conservation Division
 P.O. Box 2208
 Santa Fe, New Mexico 87501

Re: Waiver of Objection to
 Unorthodox Location
 Barbara Fasken - Opera
 State "36" No. 1
 990' FSL & 1650' FWL
 Sec. 36, T17S, R26E
 Eddy County, New Mexi

Dear Sirs:

As an offset operator or mineral interest owner to the above referenced location, objection is hereby waived to the application of Barbara Fasken to drill the above referenced well as an unorthodox gas well location in the Atoka (Penn) gas pool to a total depth of 9200'. The Atoka (Penn) special field rules call for 320 acre gas proration units with locations in the northwest quarter or the southeast quarter of the section. It is noted that the southeast quarter of section 36 has been tested with the Yates Big Boggy State #1-Y drilled and abandoned as a dry hole at a total depth of 9120 feet.

ADDIE SWEARINGEN

By: Addie Swearingen

Title: owner

Date: 2-16-95

SENDER: • Complete items 1 and/or 2 for additional services. • Complete items 3, and 4a & b. • Print your name and address on the reverse of this form so that we can return this card to you. • Attach this form to the front of the mailpiece, or on the back if space does not permit. • Write "Return Receipt Requested" on the mailpiece below the article number. • The Return Receipt will show to whom the article was delivered and the date delivered.		I also wish to receive the following services (for an extra fee): 1. <input type="checkbox"/> Addressee's Address 2. <input type="checkbox"/> Restricted Delivery Consult postmaster for fee.	
3. Article Addressed to: <u>Addie Swearingen</u> <u>1100 Gemini Circle</u> <u>Portales, NM 88130</u>		4a. Article Number <u>P143 453 937</u>	
4b. Service Type <input type="checkbox"/> Registered <input type="checkbox"/> Insured <input checked="" type="checkbox"/> Certified <input type="checkbox"/> COD <input type="checkbox"/> Express Mail <input type="checkbox"/> Return Receipt for Merchandise		7. Date of Delivery <u>2-13-95</u>	
5. Signature (Addressee) <u>Addie Swearingen</u>		8. Addressee's Address (Only if requested and fee is paid)	
6. Signature (Agent)			

Thank you for using Return Receipt Service.

FEB 27 1995

**Certified Mail Receipt**

No Insurance Coverage Provided

Do not use for International Mail

(See Reverse)

Sent to	
Lanita Williamson	
Street & No.	
9352 Highedge Circle	
P.O., State & ZIP Code	
Dallas, TX 75238-2585	
Postage	\$
Certified Fee	
Special Delivery Fee	
Restricted Delivery Fee	
Return Receipt Showing to Whom & Date Delivered	
Return Receipt Showing to Whom, Date, & Address of Delivery	
TOTAL Postage & Fees	\$
Postmark or Date	
Waiver of Objection State 36 th FEB 18 1995	

PS Form 3800, June 1990

New Mexico Oil Conservation Division
P.O. Box 2208
Santa Fe, New Mexico 87501

Re: Waiver of Objection to
Unorthodox Location
Barbara Fasken - Ope
State "36" No. 1
990' FSL & 1650' FWL
Sec. 36, T17S, R26E
Eddy County, New Me

Dear Sirs:

As an offset operator or mineral interest owner to the above referenced location, objection is hereby waived to the application of Barbara Fasken to drill the above referenced well as an unorthodox gas well location in the Atoka (Penn) gas pool to a total depth of 9200'. The Atoka (Penn) special field rules call for 320 acre gas proration units with locations in the northwest quarter or the southeast quarter of the section. It is noted that the southeast quarter of section 36 has been tested with the Yates Big Boggy State #1-Y drilled and abandoned as a dry hole at a total depth of 9120 feet.

LANITA C. WILLIAMSON

By: Lanita C. Williamson

Title: _____

Date: 2-23-95**SENDER:**

- Complete items 1 and/or 2 for additional services.
- Complete items 3; and 4a & b.
- Print your name and address on the reverse of this form so that we can return this card to you.
- Attach this form to the front of the mailpiece, or on the back if space does not permit.
- Write "Return Receipt Requested" on the mailpiece below the article number.
- The Return Receipt will show to whom the article was delivered and the date delivered.

3. Article Addressed to:
Lanita Williamson
9352 Highedge Circle
Dallas, TX 75238-2585

5. Signature (Addressee)
Lanita Williamson
6. Signature (Agent)

I also wish to receive the following services (for an extra fee):

- ☐ Addressee's Address
- ☐ Restricted Delivery

Consult postmaster for fee.

4a. Article Number
P684 782 033

4b. Service Type
☐ Registered ☐ Insured
☒ Certified ☐ COD
☐ Express Mail ☐ Return Receipt for Merchandise

7. Date of Delivery
2/18/95

8. Addressee's Address (only if requested and fee is paid)
LANITA C. WILLIAMSON
9352 HIGHEDGE CIR
DALLAS TX 75238-2585

Thank you for using Return Receipt Service.

FEB 27 1995

P 219 763 492



Receipt for Certified Mail

No Insurance Coverage Provided
Do not use for International Mail
(See Reverse)

Sent to: <u>Birdie F. Coryell</u>	
Street and No.: <u>c/o Werthen Natl Bank</u>	
P.O. Box: <u>1681</u>	
H.O. State and Zip Code: <u>Little Rock AR 72203-1681</u>	
Postage	\$
Certified Fee	
Special Delivery Fee	
Restricted Delivery Fee	
Return Receipt Showing to Whom & Date Delivered	
Return Receipt Showing to Whom, Date, and Addressee's Address	
TOTAL Postage & Fees	\$

PS Form 3800, June 1991

Postmark or Date
Waiver of Objection
State 36 #1

FEB 09 1995

New Mexico Oil Conservation Division
P.O. Box 2208
Santa Fe, New Mexico 87501

Re: Waiver of Objection
Unorthodox Local
Barbara Fasken -
State "36" No. 1
990' FSL & 1650
Sec. 36, T17S, F
Eddy County, New Mexico

Dear Sirs:

As an offset operator or mineral interest owner to the above referenced location, objection is hereby waived to the application of Barbara Fasken to drill the above referenced well as an unorthodox gas well location in the Atoka (Penn) gas pool to a total depth of 9200'. The Atoka (Penn) special field rules call for 320 acre gas proration units with locations in the northwest quarter or the southeast quarter of the section. It is noted that the southeast quarter of section 36 has been tested with the Yates Big Boggy State #1-Y drilled and abandoned as a dry hole at a total depth of 9120 feet.

BIRDIE F. CORYELL

By: Birdie F. Coryell

Title: _____

Date: _____

Is your RETURN ADDRESS completed on the reverse side?

SENDER:

- Complete items 1 and/or 2 for additional services.
- Complete items 3, and 4a & b.
- Print your name and address on the reverse of this form so that we can return this card to you.
- Attach this form to the front of the mailpiece, or on the back if space does not permit.
- Write "Return Receipt Requested" on the mailpiece below the article number.
- The Return Receipt will show to whom the article was delivered and the date delivered.

I also wish to receive the following services (for an extra fee):

- 1. ☐ Addressee's Address
- 2. ☐ Restricted Delivery

Consult postmaster for fee.

3. Article Addressed to:

Birdie F. Coryell
c/o Werthen Natl Bank
PO Box 1681
Little Rock, AR 72203-1681

4a. Article Number

P 219 763 492

4b. Service Type

- ☐ Registered
- ☒ Certified
- ☐ Express Mail
- ☐ Insured
- ☐ Return Receipt for Merchandise

7. Date of Delivery

2-14-95

5. Signature (Addressee)

6. Signature (Agent)

[Signature]

8. Addressee's Address (Only if requested and fee is paid)

Thank you for using Return Receipt Service.

FEB 28 1995

P 684 782 031



Certified Mail Receipt

No Insurance Coverage Provided
Do not use for International Mail
(See Reverse)

Sent to <u>Meryl W. Tatman Est.</u> <u>c/o Wanda Biegel</u>	
Street & No. <u>5239 Coventry Dr.</u>	
P.O., State & ZIP Code <u>Riverside, CA 92506</u>	
Postage	\$
Certified Fee	
Special Delivery Fee	
Restricted Delivery Fee	
Return Receipt Showing to Whom & Date Delivered	
Return Receipt Showing to Whom, Date, & Address of Delivery	
TOTAL Postage & Fees	\$
Postmark or Date <u>Waiver of Objection</u> <u>State 36 #1</u>	
FEB 13 1995	

PS Form 3800, June 1990

New Mexico Oil Conservation Division
P.O. Box 2208
Santa Fe, New Mexico 87501

Re: Waiver of Objection to
Unorthodox Location
Barbara Fasken - Oper
State "36" No. 1
990' FSL & 1650' FWL
Sec. 36, T17S, R26E
Eddy County, New Mex

Dear Sirs:

As an offset operator or mineral interest owner to the above referenced location, objection is hereby waived to the application of Barbara Fasken to drill the above referenced well as an unorthodox gas well location in the Atoka (Penn) gas pool to a total depth of 9200'. The Atoka (Penn) special field rules call for 320 acre gas proration units with locations in the northwest quarter or the southeast quarter of the section. It is noted that the southeast quarter of section 36 has been tested with the Yates Big Boggy State #1-Y drilled and abandoned as a dry hole at a total depth of 9120 feet.

MERYL W. TATMAN — DECEASED

By: Wanda Story Biegel

Title: Heir

Date: 2-25-95

SENDER:

- Complete items 1 and/or 2 for additional services.
- Complete items 3, and 4a & b.
- Print your name and address on the reverse of this form so that we can return this card to you.
- Attach this form to the front of the mailpiece, or on the back if space does not permit.
- Write "Return Receipt Requested" on the mailpiece below the article number.
- The Return Receipt will show to whom the article was delivered and the date delivered.

I also wish to receive the following services (for an extra fee):

- ☐ Addressee's Address
 - ☐ Restricted Delivery
- Consult postmaster for fee.

3. Article Addressed to:
Meryl W. Tatman Est.
c/o Wanda Biegel
5239 Coventry Dr.
Riverside, CA 92506

4a. Article Number
P 684 782 031

4b. Service Type
☐ Registered ☐ Insured
☒ Certified ☐ COD
☐ Express Mail ☐ Return Receipt for Merchandise

7. Date of Delivery
FEB 16 1995

8. Addressee's Address (Only if requested and fee is paid)

5. Signature (Addressee)

6. Signature (Agent)
Wanda Biegel

Is your RETURN ADDRESS completed on the reverse side?

Thank you for using Return Receipt Service

RECEIPT FOR CERTIFIED MAIL

NO INSURANCE COVERAGE PROVIDED
NOT FOR INTERNATIONAL MAIL

(See Reverse)

FEB 28 1995

New Mexico Oil Conservation Division
P.O. Box 2208
Santa Fe, New Mexico 87501

Re: Waiver of Objection to
Unorthodox Location
Barbara Fasken - Opera
State "36" No. 1
990' FSL & 1650' FWL
Sec. 36, T17S, R26E
Eddy County, New Mexi

PS Form 3800, June 1985

Sent to <i>M.D. Vandavee & Lois</i>
Postage and No. <i>Rt 2, Box 1 PP</i>
Postmaster <i>Miller, MO 65907</i>
Special Delivery Fee
Postage and Fees
Return Receipt showing to whom and Date Delivered
Return Receipt showing to whom and Date and Address of Delivery
TOTAL Postage and Fees
Postmark or Date <i>Waiver of Objection</i> <i>State 36 #</i> FEB 09 1995

Dear Sirs:

As an offset operator or mineral interest owner to the above referenced location, objection is hereby waived to the application of Barbara Fasken to drill the above referenced well as an unorthodox gas well location in the Atoka (Penn) gas pool to a total depth of 9200'. The Atoka (Penn) special field rules call for 320 acre gas proration units with locations in the northwest quarter or the southeast quarter of the section. It is noted that the southeast quarter of section 36 has been tested with the Yates Big Boggy State #1-Y drilled and abandoned as a dry hole at a total depth of 9120 feet.

SS# 488-36-9062

M. D. VANDAVEE AND LOIS

By *M.D. Vandavee*Title: *owners*Date: *2-13-95*

Is your RETURN ADDRESS completed on the reverse side?

SENDER:

- Complete items 1 and/or 2 for additional services.
- Complete items 3, and 4a & b.
- Print your name and address on the reverse of this form so that we can return this card to you.
- Attach this form to the front of the mailpiece, or on the back if space does not permit.
- Write "Return Receipt Requested" on the mailpiece below the article number.
- The Return Receipt will show to whom the article was delivered and the date delivered.

3. Article Addressed to:

M.D. Vandavee & Lois
Rt 2, Box 1 PP
Miller, MO 65907

5. Signature (Addressee)

6. Signature (Agent)

4a. Article Number

P143 453 951

4b. Service Type

- ☐ Registered ☐ Insured
☒ Certified ☐ COD
☐ Express Mail ☐ Return Receipt for Merchandise

7. Date of Delivery

2-13-95

8. Addressee's Address (Only if requested and fee is paid)

I also wish to receive the following services (for an extra fee):

1. ☐ Addressee's Address
2. ☐ Restricted Delivery

Consult postmaster for fee.

Thank you for using Return Receipt Service.

MAR 01 1995

New Mexico Oil Conservation Division
P.O. Box 2208
Santa Fe, New Mexico 87501

Re: Waiver of Objection to
Unorthodox Location
Barbara Fasken - Ope
State "36" No. 1
990' FSL & 1650' FW
Sec. 36, T17S, R26E
Eddy County, New M

Dear Sirs:

As an offset operator or mineral interest owner to the above referenced location, objection is hereby waived to the application of Barbara Fasken to drill the above referenced well as an unorthodox gas well location in the Atoka (Penn) gas pool to a total depth of 9200'. The Atoka (Penn) special field rules call for 320 acre gas proration units with locations in the northwest quarter or the southeast quarter of the section. It is noted that the southeast quarter of section 36 has been tested with the Yates Big Boggy State #1-Y drilled and abandoned as a dry hole at a total depth of 9120 feet.

NORMA GUPTON

By: Norma Gupton

Title: _____

Date: 2/25/95

P 219 763 477

Receipt for Certified Mail
No Insurance Coverage Provided
Do not use for International Mail (See Reverse)

Sent to	<u>Norma Gupton</u>
Street and No.	<u>1902 Moody Ct</u>
P.O., State and ZIP Code	<u>Arlington TX 76012</u>
Postage	\$ _____
Certified Fee	_____
Special Delivery Fee	_____
Restricted Delivery Fee	_____
Return Receipt Showing to Whom & Date Delivered	_____
Return Receipt Showing to Whom, Date, and Addressee's Address	_____
TOTAL Postage & Fees	\$ _____
Postmark or Date	<u>Waiver of Objection</u> <u>State 36 41</u> FEB 09 1995

PS Form 3800, June 1991

SENDER:

- Complete items 1 and/or 2 for additional services.
- Complete items 3 and 4a & b.
- Print your name and address on the reverse of this form so that we can return this card to you.
- Attach this form to the front of the mailpiece, or on the back if space does not permit.
- Write "Return Receipt Requested" on the mailpiece below the article number.
- The Return Receipt will show to whom the article was delivered and the date delivered.

I also wish to receive the following services (for an extra fee):

- ☐ Addressee's Address
 - ☐ Restricted Delivery
- Consult postmaster for fee.

3. Article Addressed to:

Norma Gupton
1902 Moody Ct
Arlington, TX 76012

4a. Article Number:

P219 763 477

4b. Service Type

- | | |
|---|---|
| <input type="checkbox"/> Registered | <input type="checkbox"/> Insured |
| <input checked="" type="checkbox"/> Certified | <input type="checkbox"/> COD |
| <input type="checkbox"/> Express Mail | <input type="checkbox"/> Return Receipt for Merchandise |

7. Date of Delivery:

2-21-95

5. Signature (Addressee)

[Signature]

6. Signature (Agent)

[Signature]

8. Addressee's Address (Only if requested and fee is paid)

Thank you for using Return Receipt Service.

P 143 453 950

MAR 02 1995

RECEIPT FOR CERTIFIED MAIL

NO INSURANCE COVERAGE PROVIDED
NOT FOR INTERNATIONAL MAIL

(See Reverse)

New Mexico Oil Conservation Division
P.O. Box 2208
Santa Fe, New Mexico 87501

Re: Waiver of Objection to
Unorthodox Location
Barbara Fasken - Operat
State "36" No. 1
990' FSL & 1650' FWL
Sec. 36, T17S, R26E
Essey County, New Mexico

PS Form 3800, June 1985

Sent to <i>Louise M. Richardson</i>	
Street and No. <i>1916 Norwood</i>	
City, State and ZIP Code <i>Independence, MO 64052</i>	
Postage	
Return Receipt	
Restricted Delivery Fee	
Return Receipt showing to whom and Date Delivered	
Return Receipt showing to whom Date, and Address of Delivery	
TOTAL Postage and Fees	\$
Postmark or Date <i>Waiver of Objection State 36 A1 FEB 09 1995</i>	

Dear Sirs:

As an offset operator or mineral interest owner to the above referenced location, objection is hereby waived to the application of Barbara Fasken to drill the above referenced well as an unorthodox gas well location in the Atoka (Penn) gas pool to a total depth of 9200'. The Atoka (Penn) special field rules call for 320 acre gas proration units with locations in the northwest quarter or the southeast quarter of the section. It is noted that the southeast quarter of section 36 has been tested with the Yates Big Boggy State #1-Y drilled and abandoned as a dry hole at a total depth of 9120 feet.

LOUISE M. RICHARDSON

By: *Louise M. Richardson*

Title: _____

Date: *Feb 27, 1995*

SENDER:

- Complete items 1. and/or 2. for additional services.
- Complete items 3. and 4a & b.
- Print your name and address on the reverse of this form so that we can return this card to you.
- Attach this form to the front of the mailpiece, or on the back if space does not permit.
- Write "Return Receipt Requested" on the mailpiece below the article number.
- The Return Receipt will show to whom the article was delivered and the date delivered.

I also wish to receive the following services (for an extra fee):

- ☐ Addressee's Address
- ☐ Restricted Delivery

Consult postmaster for fee.

3. Article Addressed to:

Louise M. Richardson
1916 Norwood
Independence, MO
64052

4a. Article Number

P143 453 950

4b. Service Type

- ☐ Registered ☐ Insured
☒ Certified ☐ COD
☐ Express Mail ☐ Return Receipt for Merchandise

7. Date of Delivery

2-13-95

5. Signature (Addressee)

6. Signature (Agent)

Thank you for using Return Receipt Service.

RECEIVED

MAR - 2 1995

FASKEN OIL AND
RANCH INTERESTS

RECEIPT OR CERTIFIED MAIL

NO INSURANCE COVERAGE PROVIDED

NOT FOR INTERNATIONAL MAIL

(See Reverse)

New Mexico Oil Conservation Division
P.O. Box 2208
Santa Fe, New Mexico 87501

Re: Waiver of Objection to
Unorthodox Location
Barbara Fasken - Operator
State "36" No. 1
990' FSL & 1650' FWL
Sec. 36, T17S, R26E
Eddy County, New Mexico

PS Form 3800, June 1985

Sent to <u>Jerry A. White + Carla K.</u>	
Street and City <u>P.O. Box 27</u>	
Post Office, State and ZIP Code <u>Intkawa, OK 74653</u>	
Postage	\$
Special Delivery Fee	
Postage and Delivery Fee	
Return Receipt showing to whom and Date Delivered	
Return Receipt showing to whom Date, and Address of Delivery	
TOTAL Postage and Fees	\$
Postmark or Date <u>Waiver of Objection</u> <u>State 36 #1</u> <u>FEB 09 1995</u>	

Dear Sirs:

As an offset operator or mineral interest owner to the above referenced location, objection is hereby waived to the application of Barbara Fasken to drill the above referenced well as an unorthodox gas well location in the Atoka (Penn) gas pool to a total depth of 9200'. The Atoka (Penn) special field rules call for 320 acre gas proration units with locations in the northwest quarter or the southeast quarter of the section. It is noted that the southeast quarter of section 36 has been tested with the Yates Big Boggy State #1-Y drilled and abandoned as a dry hole at a total depth of 9120 feet.

TERRY A. WHITE AND CARLA K. WHITE

By: Jerry A. White
Carla K. White
Date: 2-24-95

Is your RETURN ADDRESS completed on the reverse side?

SENDER:

- Complete items 1 and/or 2 for additional services.
- Complete items 3 and 4a & b.
- Print your name and address on the reverse of this form so that we can return this card to you.
- Attach this form to the front of the mailpiece, or on the back if space does not permit.
- Write "Return Receipt Requested" on the mailpiece below the article number.
- The Return Receipt will show to whom the article was delivered and the date delivered.

I also wish to receive the following services (for an extra fee):

- ☐ Addressee's Address
- ☐ Restricted Delivery

Consult postmaster for fee.

3. Article Addressed to:

Jerry A. White + Carla K. White
P.O. Box 27
Intkawa, OK 74653

4a. Article Number

P 143 453 947

4b. Service Type

- ☐ Registered ☐ Insured
☒ Certified ☐ COD
☐ Express Mail ☐ Return Receipt for Merchandise

7. Date of Delivery

2-15-94

5. Signature (Addressee)

6. Signature (Agent)

Thank you for using Return Receipt Service.

RECEIVED

MAR - 21

FASKEN OIL
RANCH INC

P 219 763 488

**Receipt for
Certified Mail**

 No Insurance Coverage Provided
 Do not use for International Mail
 (See Reverse)

Sent to <i>Flora Jane Hopkins</i>	
Street and No. <i>2149 San Anselmo Ave</i>	
City, State and ZIP Code <i>Long Beach CA 90815</i>	
Postage	\$
Certified Fee	
Special Delivery Fee	
Restricted Delivery Fee	
Return Receipt Showing to Whom & Date Delivered	
Return Receipt Showing to Whom, Date, and Addressee's Address	
TOTAL Postage & Fees	\$
Postmark or Date <i>Waiver of Objection</i> <i>State 36 #1</i>	

PS Form 3800, June 1991

FEB 09 1995

 New Mexico Oil Conservation Division
 P.O. Box 2208
 Santa Fe, New Mexico 87501

 Re: Waiver of Objection
 Unorthodox Location
 Barbara Fasken - O
 State "36" No. 1
 990' FSL & 1650' FV
 Sec. 36, T17S, R26E
 Eddy County, New M

Dear Sirs:

As an offset operator or mineral interest owner to the above referenced location, objection is hereby waived to the application of Barbara Fasken to drill the above referenced well as an unorthodox gas well location in the Atoka (Penn) gas pool to a total depth of 9200'. The Atoka (Penn) special field rules call for 320 acre gas proration units with locations in the northwest quarter or the southeast quarter of the section. It is noted that the southeast quarter of section 36 has been tested with the Yates Big Boggy State #1-Y drilled and abandoned as a dry hole at a total depth of 9120 feet.

FLORA JANE HOPKINS

By: *Flora Jane Hopkins*Title: *Mineral interest owner*Date: *Feb 25, 1995***SENDER:**

- Complete items 1 and/or 2 for additional services.
- Complete items 3, and 4a & b.
- Write your name and address on the reverse of this form so that we can return this card to you.
- Attach this form to the front of the mailpiece, or on the back if space does not permit.
- Write "Return Receipt Requested" on the mailpiece below the article number.
- The Return Receipt will show to whom the article was delivered and the date delivered.

 I also wish to receive the
 following services (for an extra
 fee):

- ☐ Addressee's Address
- ☐ Restricted Delivery

Consult postmaster for fee.

3. Article Addressed to:

Flora Jane Hopkins
2149 San Anselmo Ave
Long Beach, CA 90815

4a. Article Number

P 219 763 488

4b. Service Type

- | | |
|---|---|
| <input type="checkbox"/> Registered | <input type="checkbox"/> Insured |
| <input checked="" type="checkbox"/> Certified | <input type="checkbox"/> COD |
| <input type="checkbox"/> Express Mail | <input type="checkbox"/> Return Receipt for Merchandise |

7. Date of Delivery

2/14

8. Addressee's Address (Only if requested and fee is paid)

5. Signature (Addressee)

Flora Jane Hopkins

6. Signature (Agent)

Thank you for using Return Receipt Service.

Is your RETURN ADDRESS completed on the reverse side?

MAR 02 1995

P 175 145 718

**Receipt for
Certified Mail**

No Insurance Coverage Provided
Do not use for International Mail
(See Reverse)

New Mexico Oil Conservation Division
P.O. Box 2208
Santa Fe, New Mexico 87501

Re: Waiver of Objection to
Unorthodox Location
Barbara Fasken - Opera
State "36" No. 1
990' FSL & 1650' FWL
Sec. 36, T17S, R26E
Eddy County, New Mexico

PS Form 3800, June 1991

Sent to	Lynden A. Rueter
Street and No.	400 E. Hawry Ave, #306
P.O., State and Zip Code	Deland, FL 32724
Postage	\$
Certified Fee	\$
Special Delivery Fee	\$
Restricted Delivery Fee	\$
Return Receipt Showing to Whom & Date Delivered	
Return Receipt Showing to Whom, Date, and Addressee's Address	
TOTAL Postage & Fees	\$
Postmark or Date	Waiver of Objection State 36 #1 FEB 21 1995

Dear Sirs:

As an offset operator or mineral interest owner to the above referenced location, objection is hereby waived to the application of Barbara Fasken to drill the above referenced well as an unorthodox gas well location in the Atoka (Penn) gas pool to a total depth of 9200'. The Atoka (Penn) special field rules call for 320 acre gas proration units with locations in the northwest quarter or the southeast quarter of the section. It is noted that the southeast quarter of section 36 has been tested with the Yates Big Boggy State #1-Y drilled and abandoned as a dry hole at a total depth of 9120 feet.

LYNDEN A. RUETER

By: Lynden A. Rueter

Title: Owner

Date: 2-25-95

SENDER:

- Complete items 1 and/or 2 for additional services.
- Complete items 3, and 4a & b.
- Print your name and address on the reverse of this form so that we can return this card to you.
- Attach this form to the front of the mailpiece, or on the back if space does not permit.
- Write "Return Receipt Requested" on the mailpiece below the article number.
- The Return Receipt will show to whom the article was delivered and the date delivered.

3. Article Addressed to:

Lynden A. Rueter
400 E. Hawry Ave, #306
Deland, FL 32724

4a. Article Number

~~175~~ P175145718

4b. Service Type

- ☐ Registered ☐ Insured
☒ Certified ☐ COD
☐ Express Mail ☐ Return Receipt for Merchandise

7. Date of Delivery

2-24-95

5. Signature (Addressee)
6. Signature (Agent)

Chire Hall

8. Addressee's Address (Only if requested and fee is paid)

Thank you for using Return Receipt Service.

P 219 763 482

Receipt for Certified Mail



No Insurance Coverage Provided
Do not use for International Mail
(See Reverse)

Sent to	Scope Energy Resources Inc
Street and No.	233 Wilshire Blvd Ste 740
P.O. State and ZIP Code	Santa Monica, CA 90401
Postage	\$
Certified Fee	
Special Delivery Fee	
Restricted Delivery Fee	
Return Receipt Showing to Whom & Date Delivered	
Return Receipt Showing to Whom, Date, and Addressee's Address	
TOTAL Postage & Fees	\$

Postmark or Date

Winner of Dispute
State 36 # FEB 09 1995

PS Form 3800, June 1991

SENDER:

- Complete items 1 and/or 2 for additional services.
- Complete items 3, 4a & b.
- Print your name and address on the reverse of this form so that we can return this card to you.
- Attach this form to the front of the mailpiece, or on the back if space does not permit.
- Write "Return Receipt Requested" on the mailpiece below the article number.
- The Return Receipt will show to whom the article was delivered and the date delivered.

1. I also wish to receive the following services (for an extra fee):

1. ☐ Addressee's Address

2. ☐ Restricted Delivery

Consult postmaster for fee.

2a. Article Number 219 763 482

4b. Service Type

☐ Registered ☐ Insured

☒ Certified ☐ COD

☐ Express Mail ☐ Return Receipt for Merchandise

7. Date of Delivery 2/13/95

8. Addressee's Address (Only if requested and fee is paid)

Is your RETURN ADDRESS completed on the reverse side?

3. Article Addressed to:

Scope Energy Resources Inc
233 Wilshire Blvd
Suite 740
Santa Monica, CA 90401

5. Signature (Addressee)

6. Signature (Agent)

PS Form 3811, December 1991 *U.S. GPO: 1993-352-714

DOMESTIC RETURN RECEIPT

Thank you for using Return Receipt Service

Is your RETURN ADDRESS completed on the reverse side?

SENDER:

- Complete items 1 and/or 2 for additional services.
- Complete items 3 and 4a & b.
- Print your name and address on the reverse of this form so that we can return this card to you.
- Attach this form to the front of the mailpiece, or on the back if space does not permit.
- Write "Return Receipt Requested" on the mailpiece below the article number.
- The Return Receipt will show to whom the article was delivered and the date delivered.

I also wish to receive the following services (for an extra fee):

1. ☐ Addressee's Address
2. ☐ Restricted Delivery

Consult postmaster for fee.

3. Article Addressed to:
Eara Mae Watt
400 Holland Dr.
West Sacramento, CA
95605

4a. Article Number:
P143 453 948

4b. Service Type

<input type="checkbox"/> Registered	<input type="checkbox"/> Insured
<input checked="" type="checkbox"/> Certified	<input type="checkbox"/> COD
<input type="checkbox"/> Express Mail	<input type="checkbox"/> Return Receipt for Merchandise

7. Date of Delivery
2-13-95

5. Signature (Addressee)
Eara M. Watt

8. Addressee's Address (Only if requested and fee is paid)

6. Signature (Agent)

PS Form 3811, December 1991 U.S. GPO: 1993-352-714

DOMESTIC RETURN RECEIPT

Thank you for using Return Receipt Service

P 143 453 948

RECEIPT FOR CERTIFIED MAIL

NO INSURANCE COVERAGE PROVIDED
NOT FOR INTERNATIONAL MAIL
(See Reverse)

Sent to <i>Eara Mae Watt</i>	
Street and No. <i>400 Holland Dr.</i>	
P.O., State and ZIP Code <i>West Sacramento, CA 95605</i>	
Postage	
Certified Fee	
Special Delivery Fee	
Restricted Delivery Fee	
Return Receipt showing to whom and Date Delivered	
Return Receipt showing to whom, Date, and Address of Delivery	
TOTAL Postage and Fees	\$
Postmark or Date <i>waiver of objection</i> <i>state 3/1</i> FEB 20 9 1995	

PS Form 3800, June 1985

Is your RETURN ADDRESS completed on the reverse side?

SENDER:

- Complete items 1 and/or 2 for additional services.
- Complete items 3 and 4a & b.
- Print your name and address on the reverse of this form so that we can return this card to you.
- Attach this form to the front of the mailpiece, or on the back if space does not permit.
- Write "Return Receipt Requested" on the mailpiece below the article number.
- The Return Receipt will show to whom the article was delivered and the date delivered.

I also wish to receive the following services (for an extra fee):

1. ☐ Addressee's Address
 2. ☐ Restricted Delivery
- Consult postmaster for fee.

Thank you for using Return Receipt Service.

3. Article Addressed to:
*John Collins Major &
Stephen Alfred Major
P.O. Box 5
Mooreland OK 73852*

4a. Article Number
P 219 763 485

4b. Service Type
☐ Registered ☐ Insured
☒ Certified ☐ COD
☐ Express Mail ☐ Return Receipt for Merchandise

7. Date of Delivery
2/13/95

5. Signature (Addressee)
[Signature]

8. Addressee's Address (Only if requested and fee is paid)

6. Signature (Agent)
[Signature]

PS Form 3811, December 1991 *U.S. GPO: 1993-352-714 **DOMESTIC RETURN RECEIPT**

P 219 763 485



Receipt for Certified Mail

No Insurance Coverage Provided
Do not use for International Mail
(See Reverse)

Sent to <i>John Collins Major & Stephen Alfred Major P.O. Box 5 Mooreland OK 73852</i>	
P.O. State and ZIP Code	
Postage	\$
Certified Fee	
Special Delivery Fee	
Restricted Delivery Fee	
Return Receipt Showing to Whom & Date Delivered	
Return Receipt Showing to Whom, Date, and Addressee's Address	
TOTAL Postage & Fees	\$
Postmark or Date <i>Waiver of Objection State 36 #1</i>	
FEB 09 1995	

PS Form 3800, June 1991

IS YOUR RETURN ADDRESS COMPLETELY CORRECT? IF NOT, REVERSE SIDE

SENDER:

- Complete items 1 and/or 2 for additional services.
- Complete items 3, and 4a & b.
- Print your name and address on the reverse of this form so that we can return this card to you.
- Attach this form to the front of the mailpiece, or on the back if space does not permit.
- Write "Return Receipt Requested" on the mailpiece below the article number.
- The Return Receipt will show to whom the article was delivered and the date delivered.

I also wish to receive the following services (for an extra fee):

1. ☐ Addressee's Address

2. ☐ Restricted Delivery

Consult postmaster for fee.

3. Article Addressed to:
Jimmy Lee Collier
Attn: of the Est. of
James A. Collier
P.O. Box 63
Edgar, OK 73538

4a. Article Number
P143 453 932

4b. Service Type
☒ Registered ☐ Insured
☒ Certified ☐ COD
☐ Express Mail ☐ Return Receipt for Merchandise

7. Date of Delivery
2/22/95

5. Signature (Addressee)
Jimmy Lee Collier

8. Addressee's Address (Only if requested and fee is paid)

6. Signature (Agent)

PS Form 3811, December 1991 ★ U.S. GPO: 1993-352-714

DOMESTIC RETURN RECEIPT

Thank you for using Return Receipt Service.

P 143 453 932

RECEIPT FOR CERTIFIED MAIL

NO INSURANCE COVERAGE PROVIDED
NOT FOR INTERNATIONAL MAIL
(See Reverse)

Sent to <i>Jimmy Lee Collier</i>	
Street and No. <i>P.O. Box 63</i>	
P.O. State and ZIP Code <i>Edgar, OK 73538</i>	
Postage	\$
Certified Fee	
Special Delivery Fee	
Restricted Delivery Fee	
Return Receipt showing to whom and Date Delivered	
Return Receipt showing to whom, Date, and Address of Delivery	
TOTAL Postage and Fees	\$
Postmark or Date <i>Lawyer's Office</i> <i>State 36 #1</i> FEB 09 1995	

PS Form 3800, June 1985

Is your RETURN ADDRESS completed on the reverse side?

SENDER:

- Complete items 1 and/or 2 for additional services.
- Complete items 3, and 4a & b.
- Print your name and address on the reverse of this form so that we can return this card to you.
- Attach this form to the front of the mailpiece, or on the back if space does not permit.
- Write "Return Receipt Requested" on the mailpiece below the article number.
- The Return Receipt will show to whom the article was delivered and the date delivered.

I also wish to receive the following services (for an extra fee):

- 1. ☐ Addressee's Address
 - 2. ☐ Restricted Delivery
- Consult postmaster for fee.

Thank you for using Return Receipt Service.

3. Article Addressed to:
Ernest L Redford
111 Naravisa, N.W.
Albuquerque, NM
87107

4a. Article Number
P 43 453 949

4b. Service Type:
☐ Registered ☐ Insured
☒ Certified ☐ COD
☐ Express Mail ☐ Return Receipt for Merchandise

7. Date of Delivery
2-11-95

5. Signature (Addressee)

8. Addressee's Address (Only if requested and fee is paid)

6. Signature (Agent)
Beth Nicholas

PS Form 3811, December 1991 • U.S. GPO: 1993-352-714

DOMESTIC RETURN RECEIPT

P 143 453 949

RECEIPT FOR CERTIFIED MAIL

NO INSURANCE COVERAGE PROVIDED
NOT FOR INTERNATIONAL MAIL
(See Reverse)

Sent to <i>Ernest L. Redford</i>	
Street and No. <i>111 Naravisa, N.W.</i>	
City, State and ZIP Code <i>Albuquerque, NM 87107</i>	
Postage	
Certified Fee	
Special Delivery Fee	
Restricted Delivery Fee	
Return Receipt showing to whom and Date Delivered	
Return Receipt showing to whom, Date, and Address of Delivery	
TOTAL Postage and Fees	\$
Postmark or Date <i>Waiver of Objection</i> <i>Stall 36 #1</i> FEB 09 1995	

PS Form 3800, June 1985

Is your RETURN ADDRESS completed on the reverse side?

SENDER:

- Complete items 1 and/or 2 for additional services.
- Complete items 3, and 4a & b.
- Print your name and address on the reverse of this form so that we can return this card to you.
- Attach this form to the front of the mailpiece, or on the back if space does not permit.
- Write "Return Receipt Requested" on the mailpiece below the article number.
- The Return Receipt will show to whom the article was delivered and the date delivered.

I also wish to receive the following services (for an extra fee):

1. ☐ Addressee's Address
2. ☐ Restricted Delivery

Consult postmaster for fee:

3. Article Addressed to:
Darlene Pearson
2706 Fort
Hays, KS 67601

4a. Article Number
P219 763 476

4b. Service Type
☐ Registered ☐ Insured
☒ Certified ☐ COD
☐ Express Mail ☐ Return Receipt for Merchandise

7. Date of Delivery
3-14-95

5. Signature (Addressee)
Darlene Pearson

6. Signature (Agent)

8. Addressee's Address (Only if requested and fee is paid)

PS Form 3811, December 1991 U.S. GPO: 1993-352-714 **DOMESTIC RETURN RECEIPT**

Thank you for using Return Receipt Service

P 219 763 476



Receipt for Certified Mail

No Insurance Coverage Provided
Do not use for International Mail
(See Reverse)

Sent to <i>Darlene Pearson</i>	
Street and No. <i>2706 Fort</i>	
P.O. State and ZIP Code <i>Hays KS 67601</i>	
Postage	\$
Certified Fee	
Special Delivery Fee	
Restricted Delivery Fee	
Return Receipt Showing to Whom & Date Delivered	
Return Receipt Showing to Whom, Date, and Addressee's Address	
TOTAL Postage & Fees	\$
Postmark or Date <i>Waiver of Objection</i> <i>State 36 #1</i> FEB 09 1995	

PS Form 3800, June 1991

SENDER:

- Complete items 1 and/or 2 for additional services.
- Complete items 3, and 4a & b.
- Print your name and address on the reverse of this form so that we can return this card to you.
- Attach this form to the front of the mailpiece, or on the back if space does not permit.
- Write "Return Receipt Requested" on the mailpiece below the article number.
- The Return Receipt will show to whom the article was delivered and the date delivered.

I also wish to receive the following services (for an extra fee):

- ☐ Addressee's Address
- ☐ Restricted Delivery

Consult postmaster for fee.

3. Article Addressed to:
Bank IV Kansas- Topeka
Trust Dept. Trustee for the
Julie J. (Bistline) Martin Jr.
P.O. Box 48348
Wichita, KS 67201-8348

4a. Article Number
P 143 453 939

- 4b. Service Type
- | | |
|---|---|
| <input type="checkbox"/> Registered | <input type="checkbox"/> Insured |
| <input checked="" type="checkbox"/> Certified | <input type="checkbox"/> COD |
| <input type="checkbox"/> Express Mail | <input type="checkbox"/> Return Receipt for Merchandise |

7. Date of Delivery
FEB 13 1995

5. Signature (Addressee)

8. Addressee's Address (Only if requested and fee is paid)

6. Signature (Agent)

PS Form 3811, December 1991 U.S. GPO: 1993-352-714

DOMESTIC RETURN RECEIPT

Thank you for using Return Receipt Service.

P 143 453 939

RECEIPT FOR CERTIFIED MAIL

NO INSURANCE COVERAGE PROVIDED
NOT FOR INTERNATIONAL MAIL
(See Reverse)

Sent to Julie J. (Bistline) Martin Jr.	
Street and Apt. P.O. Box 48348	
P.O. State and ZIP Code Wichita, KS 67201-8348	
Postage	
Combined	
Special Delivery Fee	
Restricted Delivery Fee	
Return Receipt showing to whom and Date Delivered	
Return Receipt showing to whom, Date, and Address of Delivery	
TOTAL Postage and Fees	\$
Postmark or Date Wichita, KS State 36 #1 FEB 09 1995	

PS Form 3800, June 1985

Is your RETURN ADDRESS completed on the reverse side?

SENDER:

- Complete items 1 and/or 2 for additional services.
- Complete items 3, and 4a & b.
- Print your name and address on the reverse of this form so that we can return this card to you.
- Attach this form to the front of the mailpiece, or on the back if space does not permit.
- Write "Return Receipt Requested" on the mailpiece below the article number.
- The Return Receipt will show to whom the article was delivered and the date delivered.

I also wish to receive the following services (for an extra fee):

1. ☐ Addressee's Address
2. ☐ Restricted Delivery

Consult postmaster for fee.

3. Article Addressed to:
*Chalmers A Loughridge
Executor of the Estate of
George A Loughridge
3901 Rive Drive
Alexandria, VA 22304-3053*

4a. Article Number:
P 219 763 473

4b. Service Type
☐ Registered ☐ Insured
☒ Certified ☐ COD
☐ Express Mail ☐ Return Receipt for Merchandise

7. Date of Delivery
2-13-95

5. Signature (Addressee)
Chalmers A Loughridge

8. Addressee's Address (Only if requested and fee is paid)

6. Signature (Agent)

PS Form 3811, December 1991 *U.S. GPO: 1993-352-714

DOMESTIC RETURN RECEIPT

Thank you for using Return Receipt Service

P 219 763 473



Receipt for Certified Mail

No Insurance Coverage Provided
Do not use for International Mail
(See Reverse)

Sent to <i>Chalmers A Loughridge Exec of Est Dec A Loughridge</i>	
Street and No. <i>3901 Rive</i>	
P.O. State and ZIP Code <i>Alexandria VA 22304-3053</i>	
Postage	\$
Certified Fee	
Special Delivery Fee	
Restricted Delivery Fee	
Return Receipt Showing to Whom & Date Delivered	
Return Receipt Showing to Whom, Date, and Addressee's Address	
TOTAL Postage & Fees	\$
Postmark, or Date <i>Waiver of Objection State 36# FEB 09 1995</i>	

PS Form 3800, June 1991

Is your RETURN ADDRESS completed on the reverse side?

SENDER:

- Complete items 1 and/or 2 for additional services.
- Complete items 3, and 4a & b.
- Print your name and address on the reverse of this form so that we can return this card to you.
- Attach this form to the front of the mailpiece, or on the back if space does not permit.
- Write "Return Receipt Requested" on the mailpiece below the article number.
- The Return Receipt will show to whom the article was delivered and the date delivered.

3. Article Addressed to:
Mary Jane Taylor Est
Neil Martin, Executor
1306 Yucca
Artesia, NM 88210

5. Signature (Addressee)
833

6. Signature (Agent)
Neil Martin

PS Form 3811, December 1991 U.S. GPO: 1993-352-714

I also wish to receive the following services (for an extra fee):

1. ☐ Addressee's Address
2. ☐ Restricted Delivery

Consult postmaster for fee.

4a. Article Number
P684 782 029

4b. Service Type
☐ Registered ☐ Insured
☒ Certified ☐ COD
☐ Express Mail ☐ Return Receipt for Merchandise

7. Date of Delivery
2-14-95

8. Addressee's Address (Only if requested and fee is paid)

Thank you for using Return Receipt Service.

P 684 782 029



Certified Mail Receipt

No Insurance Coverage Provided
Do not use for International Mail
(See Reverse)

Sent to: Mary Jane Taylor Est. Neil Martin, Executor	
Street & No. 1306 Yucca	
P.O. State & ZIP Code Artesia, NM 88210	
Postage	\$
Certified Fee	
Special Delivery Fee	
Restricted Delivery Fee	
Return Receipt Showing to Whom & Date Delivered	
Return Receipt Showing to Whom, Date, & Address of Delivery	
TOTAL Postage & Fees	\$ 2.92
Postmark or Date Artesia NM State 36 #1 FEB 13 1995	

PS Form 3800, June 1990

Is your RETURN ADDRESS completed on the reverse side?

SENDER: • Complete items 1 and/or 2 for additional services. • Complete items 3, and 4a & b. • Print your name and address on the reverse of this form so that we can return this card to you. • Attach this form to the front of the mailpiece, or on the back if space does not permit. • Write "Return Receipt Requested" on the mailpiece below the article number. • The Return Receipt will show to whom the article was delivered and the date delivered.		I also wish to receive the following services (for an extra fee): 1. <input type="checkbox"/> Addressee's Address 2. <input type="checkbox"/> Restricted Delivery Consult postmaster for fee.	
3. Article Addressed to: <i>Lawrence A. Dext + Mary Slocomb</i> <i>3658 Weynoka Ave.</i> <i>Memphis, TN 38111</i>		4a. Article Number: <i>P 143 453 934</i>	
5. Signature (Addressee): <i>[Signature]</i>		4b. Service Type: <input type="checkbox"/> Registered <input type="checkbox"/> Insured <input checked="" type="checkbox"/> Certified <input type="checkbox"/> COD <input type="checkbox"/> Express Mail <input type="checkbox"/> Return Receipt for Merchandise	
6. Signature (Agent): <i>[Signature]</i>		7. Date of Delivery: <div style="border: 2px solid black; border-radius: 50%; padding: 10px; text-align: center; width: 100px; margin: 0 auto;"> U.S. MAIL RECEIVED FEB 08 1995 MEMPHIS, TN </div>	
		8. Addressee's Address (Only if requested and fee is paid):	
PS Form 3811, December 1991 U.S. GPO: 1993-352-714 DOMESTIC RETURN RECEIPT			

Thank you for using Return Receipt Service

P 143 453 934

RECEIPT FOR CERTIFIED MAIL

NO INSURANCE COVERAGE PROVIDED
 NOT FOR INTERNATIONAL MAIL
 (See Reverse)

Sent to: <i>Lawrence A. Dext + Mary</i> Street and No. <i>Slocumb - 3658 Weynoka Ave</i> P.O., State and ZIP Code <i>Memphis, TN 38111</i>	
Postage:	
Certified Fee:	
Special Delivery Fee:	
Restricted Delivery Fee:	
Return Receipt showing to whom and Date Delivered:	
Return Receipt showing to whom, Date, and Address of Delivery:	
TOTAL Postage and Fees:	\$
Postmark or Date: <i>Waiver of Objection</i> <i>State 36 #1</i> FEB 08 1995	

PS Form 3800, June 1985

P 143 453 925

RECEIPT FOR CERTIFIED MAIL

NO INSURANCE COVERAGE PROVIDED
NOT FOR INTERNATIONAL MAIL
(See Reverse)

Sent to <i>Louis Meidell</i>	
Street and No. <i>2811 Columbine St.</i>	
P.O., State and ZIP Code <i>Wichita, KS 67204</i>	
Postage	\$
Certified Fee	
Special Delivery Fee	
Restricted Delivery Fee	
Return Receipt showing to whom and Date Delivered	
Return Receipt showing to whom, Date, and Address of Delivery	
TOTAL Postage and Fees	\$
Postmark or Date <i>Wichita 36 #1</i> FEB 09 1995	

PS Form 3800, June 1985

SENDER:
 • Complete items 1 and/or 2 for additional services.
 • Complete items 3, and 4a & b.
 • Print your name and address on the reverse of this form so that we can return this card to you.
 • Attach this form to the front of the mailpiece, or on the back if space does not permit.
 • Write "Return Receipt Requested" on the mailpiece below the article number.
 • The Return Receipt will show to whom the article was delivered and the date delivered.

I also wish to receive the following services (for an extra fee):
 1. ☐ Addressee's Address
 2. ☒ Restricted Delivery
 Consult postmaster for fee.

Thank you for using Return Receipt Service

3. Article Addressed to:
Louis Meidell
2811 Columbine St
Wichita, KS 67204

4a. Article Number
P 143 453 925
 4b. Service Type
☒ Registered ☐ Insured
☒ Certified ☐ COD
☐ Express Mail ☐ Return Receipt for Merchandise
 7. Date of Delivery
2/13/95

5. Signature (Addressee)
Louis Meidell
 6. Signature (Agent)

8. Addressee's Address (Only if requested and fee is paid)

P 143 453 924

RECEIPT FOR CERTIFIED MAIL

NO INSURANCE COVERAGE PROVIDED
NOT FOR INTERNATIONAL MAIL

(See Reverse)

Sent to <i>Chevron U.S.A.</i>	
Street and No. <i>P.O. Box 1150</i>	
P.O. State and ZIP Code <i>Midland, TX 79702</i>	
Postage	\$
Certified Fee	
Special Delivery Fee	
Restricted Delivery Fee	
Return Receipt showing to whom and Date Delivered	
Return Receipt showing to whom, Date, and Address of Delivery	
TOTAL Postage and Fees	\$
Postmark or Date <i>Under of Objection</i> <i>State 36 #1</i> FEB 03 1995	

PS Form 3800, June 1985

Thank you for using Return Receipt Service

SENDER:

- Complete items 1 and/or 2 for additional services.
- Complete items 3, and 4a & b.
- Print your name and address on the reverse of this form so that we can return this card to you.
- Attach this form to the front of the mailpiece, or on the back if space does not permit.
- Write "Return Receipt Requested" on the mailpiece below the article number.
- The Return Receipt will show to whom the article was delivered and the date delivered.

I also wish to receive the following services (for an extra fee):

- ☐ Addressee's Address
- ☒ Restricted Delivery

Consult postmaster for fee.

3. Article Addressed to:

Chevron U.S.A.
P.O. Box 1150
Midland, TX 79702

4a. Article Number

P143 453 924

4b. Service Type

- ☐ Registered ☐ Insured
☒ Certified ☐ COD
☐ Express Mail ☐ Return Receipt for Merchandise

7. Date of Delivery

FEB 18 1995

5. Signature (Addressee)

8. Addressee's Address (Only if requested and fee is paid)

6. Signature (Agent)

PS Form 3811, December 1991

U.S. GPO: 1993-352-714

DOMESTIC RETURN RECEIPT

Is your RETURN ADDRESS completed on the reverse side?

SENDER:

- Complete items 1 and/or 2 for additional services.
- Complete items 3 and 4a & b.
- Print your name and address on the reverse of this form so that we can return this card to you.
- Attach this form to the front of the mailpiece, or on the back if space does not permit.
- Write "Return Receipt Requested" on the mailpiece below the article number.
- The Return Receipt will show to whom the article was delivered and the date delivered.

I also wish to receive the following services (for an extra fee):

- ☐ Addressee's Address
- ☐ Restricted Delivery

Consult postmaster for fee.

3. Article Addressed to:

Yates Petroleum
105 S. 4th St
Artesia, NM 88210

4a. Article Number
P 143 453 923

4b. Service Type:

<input checked="" type="checkbox"/> Registered	<input type="checkbox"/> Insured
<input checked="" type="checkbox"/> Certified	<input type="checkbox"/> COD
<input type="checkbox"/> Express Mail	<input type="checkbox"/> Return Receipt for Merchandise

7. Date of Delivery
2-10-95

5. Signature (Addressee)
X J. Rayos

8. Addressee's Address (Only if requested and fee is paid)

6. Signature (Agent)

PS Form 3811, December 1991 • U.S. GPO: 1993-352-714 **DOMESTIC RETURN RECEIPT**

Thank you for using Return Receipt Service

P 143 453 923

RECEIPT FOR CERTIFIED MAIL

NO INSURANCE COVERAGE PROVIDED
NOT FOR INTERNATIONAL MAIL
(See Reverse)

Sent to <i>Yates Petroleum</i>	
Street and No. <i>105 S. 4th St.</i>	
P.O. State and ZIP Code <i>Artesia, NM 88210</i>	
Postage	\$
Certified Fee	
Special Delivery Fee	
Restricted Delivery Fee	
Return Receipt showing to whom and Date Delivered	
Return Receipt showing to whom, Date, and Address of Delivery	
TOTAL Postage and Fees	\$
Postmark or Date <i>Artesia, NM</i> <i>State 36 #1</i> FEB 09 1995	

PS Form 3800, June 1985

SENDER:

- Complete items 1 and/or 2 for additional services.
- Complete items 3, and 4a & b.
- Print your name and address on the reverse of this form so that we can return this card to you.
- Attach this form to the front of the mailpiece, or on the back if space does not permit.
- Write "Return Receipt Requested" on the mailpiece below the article number.
- The Return Receipt will show to whom the article was delivered and the date delivered.

I also wish to receive the following services (for an extra fee):

- ☐ Addressee's Address
 - ☐ Restricted Delivery
- Consult postmaster for fee.

3. Article Addressed to:

Moraca H. Dempsey
1419 James Ct.
Libertyville, IL 60048

5. Signature (Addressee)

6. Signature (Agent)

4a. Article Number

P 175-145-719

4b. Service Type

☐ Registered ☐ Insured

☒ Certified ☐ COD

☐ Express Mail ☐ Return Receipt for Merchandise

7. Date of Delivery

2/2/95

8. Addressee's Address (Only if requested and fee is paid)

Thank you for using Return Receipt Service.

P 175 145 719



Receipt for Certified Mail

No Insurance Coverage Provided
Do not use for International Mail
(See Reverse)

Sent to

Moraca H. Dempsey

Street and No.

1419 James Ct.

P.O. State and ZIP Code

Libertyville, IL 60048

Postage

\$

Certified Fee

\$

Special Delivery Fee

\$

Restricted Delivery Fee

\$

Return Receipt Showing to Whom & Date Delivered

Return Receipt Showing to Whom, Date, and Addressee's Address

TOTAL Postage & Fees

\$

Postmark or Date

Waiver of Objection

State 36 #1

FEB 21 1995

PS Form 3800, June 1991

BARBARA FASKEN
FASKEN OIL AND RANCH INTERESTS

303 WEST WALL AVENUE, SUITE 1900
MIDLAND, TEXAS 79701-5116
(915) 687-1777

RECEIVED

MAR 17 1995

Oil Conservation Division

March 9, 1995

Mr. Michael Stogner
Chief Hearing Examiner
Oil Conservation Division
P. O. Box 2088
Santa Fe, New Mexico 87504-2088

Re: Unorthodox Location Exception
Barbara Fasken - Operator
State "36" No. 1
990' FSL & 1650' FWL
Sec 36, T17S, R26E
Eddy County, New Mexico

Dear Sir:

Enclosed are five (5) additional waivers of objection to the above referenced application.

Thank you for your help in this matter.

Sincerely,

Carl W. Brown

Carl W. Brown
Petroleum Engineer

CWB/cb
cc: file

add your name
by means of the signature
the RETURN RECEIPT label
an authorized agent of the addressee, endorse
date spaces on the front of this receipt. If return
gain 1 of Form 3811.
U.S.G.P.O. 1993

Is your RETURN ADDRESS completed on the reverse side?

SENDER:

- Complete items 1 and/or 2 for additional services.
- Complete items 3, and 4a & b.
- Print your name and address on the reverse of this form so that we can return this card to you.
- Attach this form to the front of the mailpiece, or on the back if space does not permit.
- Write "Return Receipt Requested" on the mailpiece below the article number.
- The Return Receipt will show to whom the article was delivered and the date delivered.

3 Article Addressed to:
Jimmy Lee Collier
Eftel C. of the Est. of
James A. Collier
P.O. Box 63
Elgin, OK 73538

4a Article Number
P143 453 932

4b. Service Type
☐ Registered ☐ Insured
☒ Certified ☐ COD
☒ Express Mail ☐ Return Receipt for Merchandise

7. Date of Delivery
2/22/95

5. Signature (Addressee)
Jimmy Lee Collier

6. Signature (Agent)
Jimmy Lee Collier

8. Addressee's Address (Only if requested and fee is paid)

1 also wish to receive the following services (for an additional fee):
1. ☐ Addressee's Address
2. ☐ Restricted Delivery
Consult postmaster for fee.

PS Form 3811, December 1991 *U.S. GPO: 1993-352-714

DOMESTIC RETURN RECEIPT

Thank you for using Return Receipt Service

MAR 03 1995

New Mexico Oil Conservation Division
P.O. Box 2208
Santa Fe, New Mexico 87501

Re: Waiver of Objection to
Unorthodox Location
Barbara Fasken - Operator
State "36" No. 1
990' FSL & 1650' FWL
Sec. 36, T17S, R26E
Eddy County, New Mexico

Dear Sirs:

As an offset operator or mineral interest owner to the above referenced location, objection is hereby waived to the application of Barbara Fasken to drill the above referenced well as an unorthodox gas well location in the Atoka (Penn) gas pool to a total depth of 9200'. The Atoka (Penn) special field rules call for 320 acre gas proration units with locations in the northwest quarter or the southeast quarter of the section. It is noted that the southeast quarter of section 36 has been tested with the Yates Big Boggy State #1-Y drilled and abandoned as a dry hole at a total depth of 9120 feet.

MARSHALL & WINSTON, INC.

By: [Signature]

Title: President

Date: 3-2-95

SENDER: <ul style="list-style-type: none">• Complete items 1 and/or 2 for additional services.• Complete items 3, and 4a & b.• Print your name and address on the reverse of this form so that we can return this card to you.• Attach this form to the front of the mailpiece, or on the back if space does not permit.• Write "Return Receipt Requested" on the mailpiece below the article number.• The Return Receipt will show to whom the article was delivered and the date delivered.		I also wish to receive the following services (for an extra fee): <ul style="list-style-type: none">1. <input type="checkbox"/> Addressee's Address2. <input type="checkbox"/> Restricted Delivery Consult postmaster for fee.	
3. Article Addressed to: MARSHALL & WINSTON, INC PO BOX 50880 MIDLAND TX 79710-0880		4a. Article Number Z 112 320 125	
5. Signature (Addressee) <u>[Signature]</u>		4b. Service Type <ul style="list-style-type: none"><input checked="" type="checkbox"/> Registered <input checked="" type="checkbox"/> Insured<input checked="" type="checkbox"/> Certified <input type="checkbox"/> COD<input type="checkbox"/> Express Mail <input type="checkbox"/> Return Receipt for Merchandise	
6. Signature (Agent) <u>[Signature]</u>		7. Date of Delivery MAR - 2 1995	
		8. Addressee's Address (Only if requested and fee is paid)	

is your RETURN ADDRESS completed on the reverse side?

Thank you for using Return Receipt Service.

PS Form 3811, December 1991 ☆U.S. GPO: 1992-323-402 DOMESTIC RETURN RECEIPT

MAR 03 1995

New Mexico Oil Conservation Division
P.O. Box 2208
Santa Fe, New Mexico 87501

Re: Waiver of Objection to
Unorthodox Location
Barbara Fasken - Operator
State "36" No. 1
990' FSL & 1650' FWL
Sec. 36, T17S, R26E
Eddy County, New Mexico

Dear Sirs:

As an offset operator or mineral interest owner to the above referenced location, objection is hereby waived to the application of Barbara Fasken to drill the above referenced well as an unorthodox gas well location in the Atoka (Penn) gas pool to a total depth of 9200'. The Atoka (Penn) special field rules call for 320 acre gas proration units with locations in the northwest quarter or the southeast quarter of the section. It is noted that the southeast quarter of section 36 has been tested with the Yates Big Boggy State #1-Y drilled and abandoned as a dry hole at a total depth of 9120 feet.

DARLENE PEARSON

By: Darlene Pearson

Title: _____

Date: 2-15-95

Is your RETURN ADDRESS completed on the reverse side?	SENDER: <ul style="list-style-type: none">• Complete items 1 and/or 2 for additional services.• Complete items 3, and 4a & b.• Print your name and address on the reverse of this form so that we can return this card to you.• Attach this form to the front of the mailpiece, or on the back if space does not permit.• Write "Return Receipt Requested" on the mailpiece below the article number.• The Return Receipt will show to whom the article was delivered and the date delivered.		I also wish to receive the following services (for an extra fee): <ul style="list-style-type: none">1. <input type="checkbox"/> Addressee's Address2. <input type="checkbox"/> Restricted Delivery Consult postmaster for fee.	
	3. Article Addressed to: <u>Darlene Pearson</u> <u>2706 Fort</u> <u>Hays, KS 67601</u>		4a. Article Number <u>219 763 476</u>	
	5. Signature (Addressee) <u>Darlene Pearson</u>		4b. Service Type <ul style="list-style-type: none"><input type="checkbox"/> Registered <input type="checkbox"/> Insured<input checked="" type="checkbox"/> Certified <input type="checkbox"/> COD<input type="checkbox"/> Express Mail <input type="checkbox"/> Return Receipt for Merchandise	
	6. Signature (Agent)		7. Date of Delivery <u>2-14-95</u>	
		8. Addressee's Address (Only if requested and fee is paid)		

Thank you for using Return Receipt Service.

RECEIVED

MAR - 6 1995

FASKEN OIL AND
RANCH INTEREST

New Mexico Oil Conservation Division
P.O. Box 2208
Santa Fe, New Mexico 87501

Re: Waiver of Objection to
Unorthodox Location
Barbara Fasken - Operator
State "36" No. 1
990' FSL & 1650' FWL
Sec. 36, T17S, R26E
Eddy County, New Mexico

Dear Sirs:

As an offset operator or mineral interest owner to the above referenced location, objection is hereby waived to the application of Barbara Fasken to drill the above referenced well as an unorthodox gas well location in the Atoka (Penn) gas pool to a total depth of 9200'. The Atoka (Penn) special field rules call for 320 acre gas proration units with locations in the northwest quarter or the southeast quarter of the section. It is noted that the southeast quarter of section 36 has been tested with the Yates Big Boggy State #1-Y drilled and abandoned as a dry hole at a total depth of 9120 feet.

SCOPE ENERGY RESOURCES, INC.

By: William J. Dannon

Title: _____

Date: 3-3-95

<p>SENDER:</p> <ul style="list-style-type: none"> • Complete items 1 and/or 2 for additional services. • Complete items 3, and 4a & b. • Print your name and address on the reverse of this form so that we can return this card to you. • Attach this form to the front of the mailpiece, or on the back if space does not permit. • Write "Return Receipt Requested" on the mailpiece below the article number. • The Return Receipt will show to whom the article was delivered and the date delivered. 		<p>I also wish to receive the following services (for an extra fee):</p> <p>1. <input type="checkbox"/> Addressee's Address</p> <p>2. <input type="checkbox"/> Restricted Delivery</p> <p>Consult postmaster for fee.</p>	
<p>3. Article Addressed to:</p> <p>Scope Energy Resources Inc 233 Wilshire Blvd Suite 790 Santa Monica, CA 90401</p>		<p>4a. Article Number</p> <p>219-743-482</p>	
<p>5. Signature (Addressee)</p> <p><u>[Signature]</u></p>		<p>4b. Service Type</p> <p><input type="checkbox"/> Registered <input type="checkbox"/> Insured</p> <p><input checked="" type="checkbox"/> Certified <input type="checkbox"/> COD</p> <p><input type="checkbox"/> Express Mail <input type="checkbox"/> Return Receipt for Merchandise</p>	
<p>6. Signature (Agent)</p> <p><u>[Signature]</u></p>		<p>7. Date of Delivery</p> <p>2/13/95</p>	
		<p>8. Addressee's Address (Only if requested and fee is paid)</p>	

Is your RETURN ADDRESS completed on the reverse side?

Thank you for using Return Receipt Service.

PS Form 3811, December 1991 ★U.S. GPO: 1993-352-714 DOMESTIC RETURN RECEIPT

MAR 06 1995

JFG
CWB
ST
well file

New Mexico Oil Conservation Division
P.O. Box 2208
Santa Fe, New Mexico 87501

Re: Waiver of Objection to
Unorthodox Location
Barbara Fasken - Operator
State "36" No. 1
990' FSL & 1650' FWL
Sec. 36, T17S, R26E
Eddy County, New Mexico

Dear Sirs:

As an offset operator or mineral interest owner to the above referenced location, objection is hereby waived to the application of Barbara Fasken to drill the above referenced well as an unorthodox gas well location in the Atoka (Penn) gas pool to a total depth of 9200'. The Atoka (Penn) special field rules call for 320 acre gas proration units with locations in the northwest quarter or the southeast quarter of the section. It is noted that the southeast quarter of section 36 has been tested with the Yates Big Boggy State #1-Y drilled and abandoned as a dry hole at a total depth of 9120 feet.

MONACA H. DEMPSEY

By: Monica Holm Dempsey

Title: _____

Date: 3-3-95

your RETURN ADDRESS completed on the reverse side?	SENDER: <ul style="list-style-type: none">• Complete items 1 and/or 2 for additional services.• Complete items 3, and 4a & b.• Print your name and address on the reverse of this form so that we can return this card to you.• Attach this form to the front of the mailpiece, or on the back if space does not permit.• Write "Return Receipt Requested" on the mailpiece below the article number.• The Return Receipt will show to whom the article was delivered and the date delivered.		I also wish to receive the following services (for an extra fee): <ul style="list-style-type: none">1. <input type="checkbox"/> Addressee's Address2. <input type="checkbox"/> Restricted Delivery Consult postmaster for fee.	
	3. Article Addressed to: <u>Monaca H. Dempsey</u> <u>1419 James Ct.</u> <u>Libertyville, IL 60048</u>		4a. Article Number <u>P 175-145 719</u>	
	4b. Service Type <ul style="list-style-type: none"><input type="checkbox"/> Registered<input checked="" type="checkbox"/> Certified<input type="checkbox"/> Express Mail<input type="checkbox"/> Insured<input type="checkbox"/> COD<input type="checkbox"/> Return Receipt for Merchandise		7. Date of Delivery <u>29/49</u>	
	5. Signature (Addressee) <u>[Signature]</u>		8. Addressee's Address (Only if requested and fee is paid)	
6. Signature (Agent) <u>[Signature]</u>				

PS Form 3811, December 1991 ☆U.S. GPO: 1993-352-714 DOMESTIC RETURN RECEIPT

Thank you for using Return Receipt Service.

MAR 09 1995

New Mexico Oil Conservation Division
P.O. Box 2208
Santa Fe, New Mexico 87501

Re: Waiver of Objection to
Unorthodox Location
Barbara Fasken - Operator
State "36" No. 1
990' FSL & 1650' FWL
Sec. 36, T17S, R26E
Eddy County, New Mexico

Dear Sirs:

As an offset operator or mineral interest owner to the above referenced location, objection is hereby waived to the application of Barbara Fasken to drill the above referenced well as an unorthodox gas well location in the Atoka (Penn) gas pool to a total depth of 9200'. The Atoka (Penn) special field rules call for 320 acre gas proration units with locations in the northwest quarter or the southeast quarter of the section. It is noted that the southeast quarter of section 36 has been tested with the Yates Big Boggy State #1-Y drilled and abandoned as a dry hole at a total depth of 9120 feet.

JOHN COLLIER MAJOR AND STEPHEN ALFRED MAJOR

By: John C. Meyer

Title: Truster

Date: February 27, 1995

SENDER: <ul style="list-style-type: none">• Complete items 1 and/or 2 for additional services.• Complete items 3, and 4a & b.• Print your name and address on the reverse of this form so that we can return this card to you.• Attach this form to the front of the mailpiece, or on the back if space does not permit.• Write "Return Receipt Requested" on the mailpiece below the article number.• The Return Receipt will show to whom the article was delivered and the date delivered.		1. also wish to receive the following services (for an extra fee): <ul style="list-style-type: none">1. <input type="checkbox"/> Addressee's Address2. <input type="checkbox"/> Restricted Delivery Consult postmaster for fee.	
3. Article Addressed to: <u>John Collier Major &</u> <u>Stephen Alfred Major</u> <u>PO Box 50</u> <u>Mooreland OK 73852</u>		4a. Article Number <u>P219 763 485</u>	
5. Signature (Addressee) <u>John Meyer</u>		4b. Service Type <ul style="list-style-type: none"><input type="checkbox"/> Registered <input type="checkbox"/> Insured<input checked="" type="checkbox"/> Certified <input type="checkbox"/> COD<input type="checkbox"/> Express Mail <input type="checkbox"/> Return Receipt for Merchandise	
6. Signature (Agent) <u>John Meyer</u>		7. Date of Delivery <u>2/13/95</u>	
		8. Addressee's Address (Only if requested and fee is paid)	

your RETURN ADDRESS completed on the reverse side?

Thank you for using Return Receipt Service.