

# SHAHARA OIL CORPORATION

September 28, 1995

OIL CONSERVATION DIVISION  
RECEIVED  
"05 00" 4 PM 8 52

Mr. Mike Stogner  
Oil Conservation Division  
PO Box 2088  
Santa Fe, NM 87504-2088

Re: Unorthodox Locations  
Maljamar Grayburg Unit Waterflood Project  
Maljamar Grayburg San Andres Field  
Lea County, New Mexico

Dear Mr. Stogner:

The Wiser Oil Company requests approval for one inside unorthodox location and one outside location on the subject waterflood unit. These locations designated Maljamar Grayburg Unit Wells No. 79 & 87 are shown on the attached map. The locations of these wells are as follows:

Maljamar Grayburg Unit #79  
1300' FNL & 1417' FWL, Unit C  
Section 4-T17S-R32E

Maljamar Grayburg Unit #87  
2623' FNL & 1571' FWL, Unit F  
Section 4-T17S-R32E

These wells will more efficiently and effectively establish the pattern of the waterflood as set out by Order No. R-2777.

The offset operator of Maljamar Grayburg Unit #79 appears to be Hudson & Hudson. The attached map does not indicate that there is not any offset production. Therefore, we have not notified Hudson & Hudson.

Attached are copies of the C-101, C-102, a map showing proposed access roads, a map showing existing wells, proposed wells and plat of the waterflood area showing the original 80-acre 5-spot waterflood patterns. It is anticipated that the injection pattern will become a 40-acre 5-spot pattern.

Your earliest consideration of this request will be appreciated. Should you have any questions or require additional data, please contact the undersigned in Carlsbad at 885-5433.

Sincerely,



Perry L. Hughes  
Agent for  
The Wiser Oil Company

PLH/jh  
Enclosures

cc: OCD Hobbs



**REDEVELOPMENT PLAN  
 PHASE I AND PHASE II**  
**THE WISER OIL COMPANY**  
 MALAMAR GRAYBURG UNIT  
 MALAMAR (GRAYBURG SAN ANDRES) FIELD  
 LEA CO., NEW MEXICO

● Producer  
 ○ Shut-in  
 ▲ Injector  
 ▲ Active  
 ▲ Former Injector  
 ○ Proposed Producer  
 ○ Proposed Location  
 ▲ Proposed Conversion  
 ▲ Former Injector

0 1000' 2000' 3000' 4000'

FIGURE NO. 19



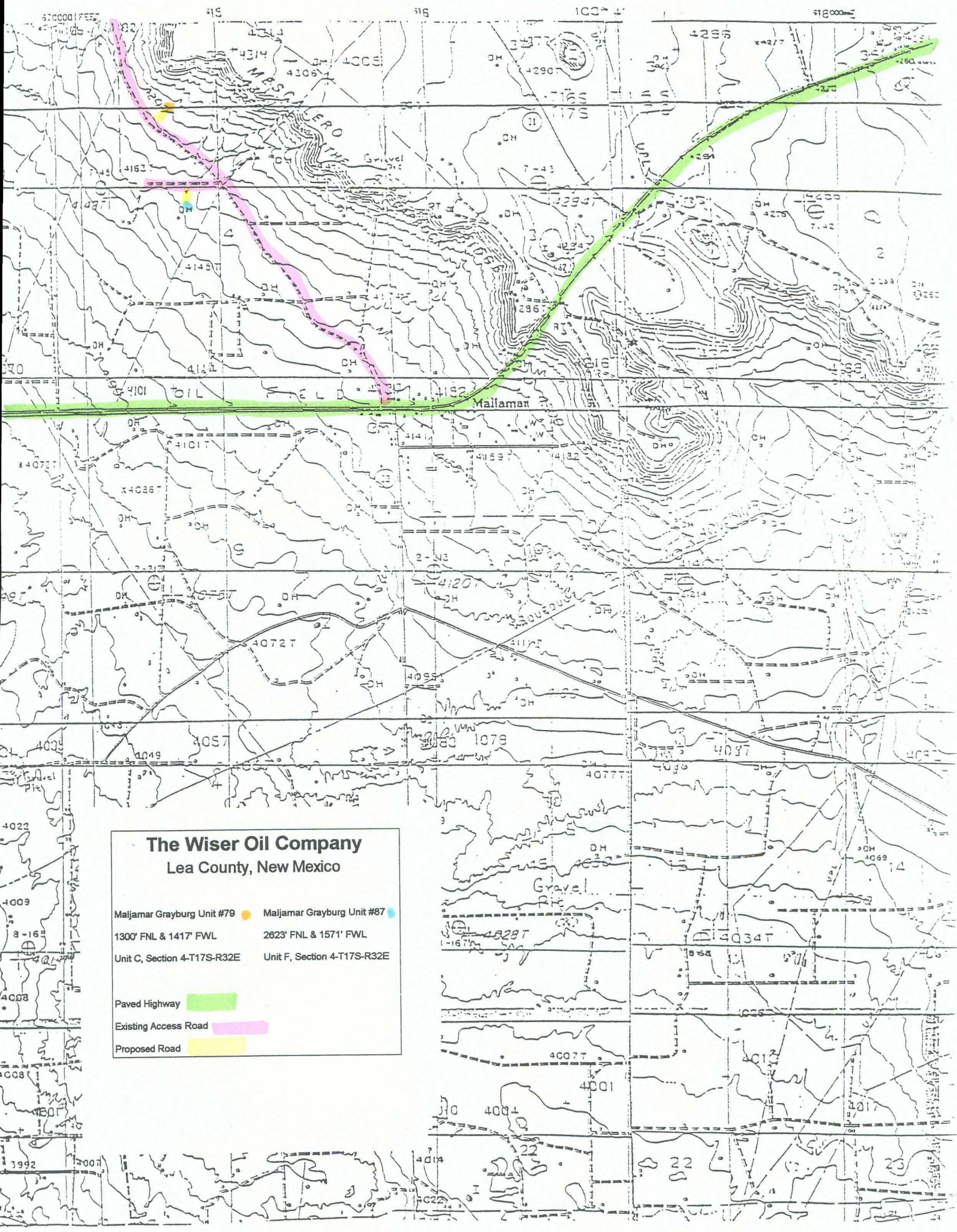

**The Wiser Oil Company**

Lea County, New Mexico

- |                             |   |                             |   |
|-----------------------------|---|-----------------------------|---|
| Maljamar Grayburg Unit #79  | ● | Maljamar Grayburg Unit #87  | ● |
| 1300' FNL & 1417' FWL       |   | 2623' FNL & 1571' FWL       |   |
| Unit C, Section 4-T17S-R32E |   | Unit F, Section 4-T17S-R32E |   |
| Paved Highway               |   |                             |   |
| Existing Access Road        |   |                             |   |
| Proposed Road               |   |                             |   |



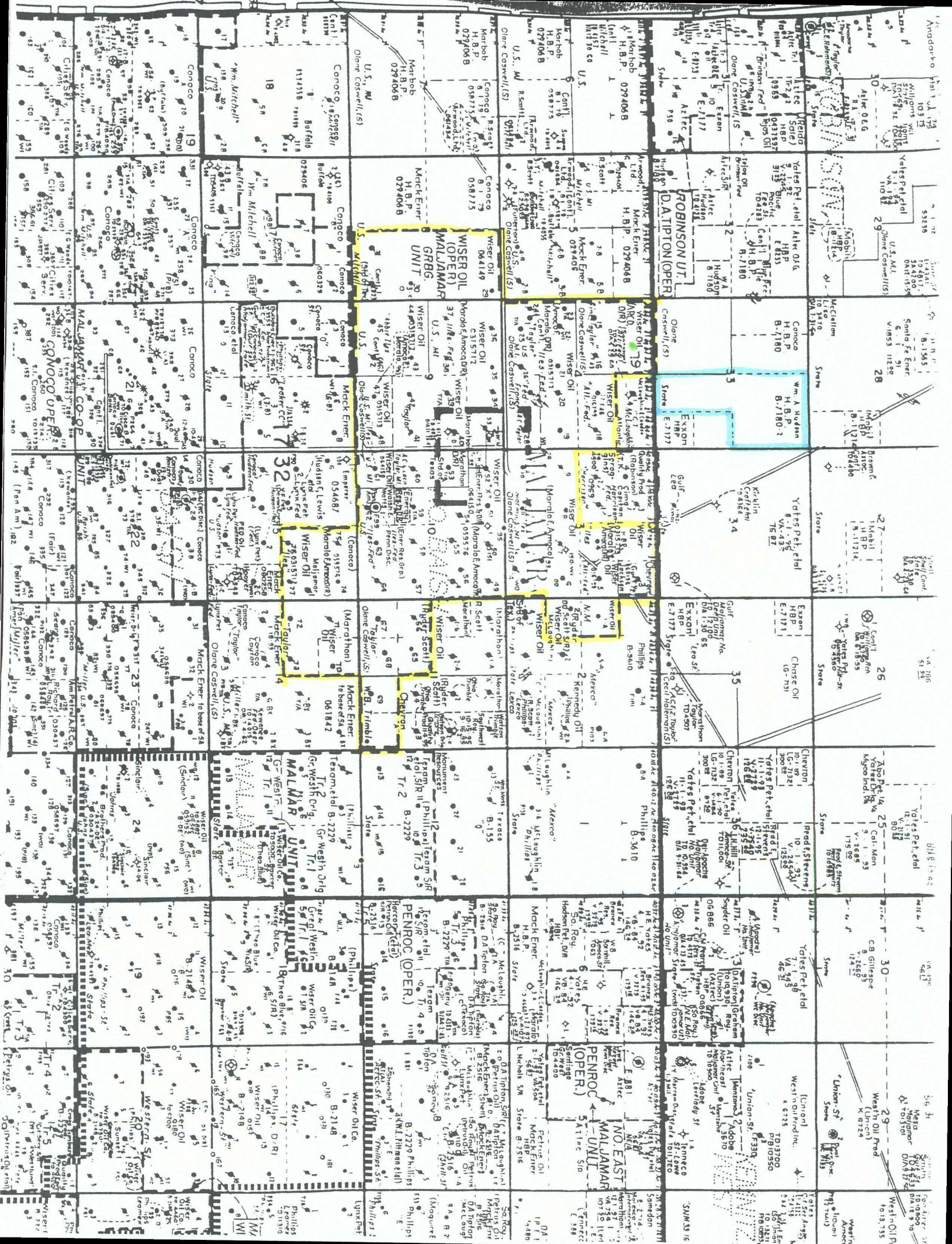



State of New Mexico  
Energy, Minerals & Natural Resources Department

Form C-101

Revised February 10, 1994

Instructions on back

Submit to Appropriate District Office

State Lease - 6 Copies

Fee Lease - 5 Copies

\_\_\_\_\_ AMENDED REPORT

District I

PO Box 1980, Hobbs, NM 88241-1980

District II

PO Drawer DD, Artesia, NM 88211-0719

District III

1000 Rio Brazos Rd., Aztec, NM 87410

District IV

PO Box 2088, Santa Fe, NM 87504-2088

OIL CONSERVATION DIVISION  
PO Box 2088  
Santa Fe, NM 97504-2088

APPLICATION FOR PERMIT TO DRILL, RE-ENTER, DEEPEN, PLUGBACK OR ADD A ZONE

1. Operator Name and Address <b>The Wiser Oil Company 207 West McKay Carlsbad, NM 88220</b>		2. OGRID Number <b>022922</b>
		3. API Number <b>30-025-</b>
4. Property Code <b>011844</b>	5. Property Name <b>Maljamar Grayburg Unit</b>	6. Well No. <b>79</b>

7. Surface Location									
UL or lot no.	Section	Township	Range	Lot Idn.	Feet From the	North/South Line	Feet From the	East/West Line	County
<b>C</b>	<b>4</b>	<b>17S</b>	<b>33E</b>		<b>1300</b>	<b>N</b>	<b>1417</b>	<b>W</b>	<b>Lea</b>

8. Proposed Bottom Hole Location If Different From Surface									
UL or lot no.	Section	Township	Range	Lot Idn.	Feet From the	North/South Line	Feet From the	East/West Line	County
9. Proposed Pool 1 <b>Maljamar Grayburg San Andres</b>					10. Proposed Pool 2				

11. Work Type Code <b>N</b>	12. Well Type Code <b>O</b>	13. Cable/Rotary <b>Rotary</b>	14. Lease Type Code <b>P</b>	15. Ground Level Elevation <b>4142</b>
16. Multiple <b>N</b>	17. Proposed Depth <b>5000</b>	18. Formation <b>Grayburg &amp; SA</b>	19. Contractor <b>L &amp; M Drilling Co.</b>	20. Spud Date <b>11/01/95</b>

21. Proposed Casing and Cement Program					
Hole Size	Casing Size	Casing weight/foot	Setting Depth	Sacks of Cement	Estimated TOC
<b>12 1/4</b>	<b>8 5/8</b>	<b>24#</b>	<b>1200'</b>	<b>650</b>	<b>Circ</b>
<b>7 7/8</b>	<b>5 1/2</b>	<b>17#</b>	<b>5000'</b>	<b>1100</b>	<b>900' (300' inside 8 5/8" casing)</b>

22. Describe the proposed program. If this application is to DEEPEN or PLUG BACK, give the data on the present productive zone and proposed new productive zone. Describe the blowout prevention program, if any. Use additional sheets if necessary.

It is proposed to drill the above captioned well to a total depth of 5000' with rotary tools.  
If commercial production is indicated, the well will be perforated and stimulated as necessary.

Blow Out Prevention: 10" Series 900 Type "E" Shaffer Hydraulic BOP

23. I hereby certify that the information given above is true and complete to the best of my knowledge and belief.		OIL CONSERVATION DIVISION	
Signature: <i>Perry L. Hughes</i>		Approved by:	
Printed Name: <b>Perry L. Hughes</b>		Title:	
Title: <b>Agent</b>		Approval Date:	
Date: <b>09/28/95</b>	Phone: <b>505/885-5433</b>	Conditions of Approval:	
		Attached: _____	

District I  
PO Box 1980, Hobbs, NM 88241-1980  
District II  
PO Drawer DD, Artesia, NM 88211-0719  
District III  
1000 Rio Brazos Rd., Aztec, NM 87410  
District IV  
PO Box 2088, Santa Fe, NM 87504-2088

State of New Mexico  
Energy, Minerals & Natural Resources Department

OIL CONSERVATION DIVISION  
PO Box 2088  
Santa Fe, NM 87504-2088

Form C-102  
Revised February 10, 1994  
Instructions on back  
Submit to Appropriate District Office  
State Lease - 4 Copies  
Fee Lease - 3 Copies

☐ AMENDED REPORT

WELL LOCATION AND ACREAGE DEDICATION PLAT

* API Number		* Pool Code		* Pool Name	
* Property Code		* Property Name			* Well Number
		Maljamar Grayburg Unit			79
* OGRID No.		* Operator Name			* Elevation
		The Wiser Compny			4164

<sup>10</sup> Surface Location

UL or lot no.	Section	Township	Range	Lot Ida	Feet from the	North/South line	Feet from the	East/West line	County
C	4	17 S	32 E		1300	North	1417	West	Lea

<sup>11</sup> Bottom Hole Location If Different From Surface

UL or lot no.	Section	Township	Range	Lot Ida	Feet from the	North/South line	Feet from the	East/West line	County

<sup>12</sup> Dedicated Acres	<sup>13</sup> Joint or Infill	<sup>14</sup> Consolidation Code	<sup>15</sup> Order No.

NO ALLOWABLE WILL BE ASSIGNED TO THIS COMPLETION UNTIL ALL INTERESTS HAVE BEEN CONSOLIDATED  
OR A NON-STANDARD UNIT HAS BEEN APPROVED BY THE DIVISION

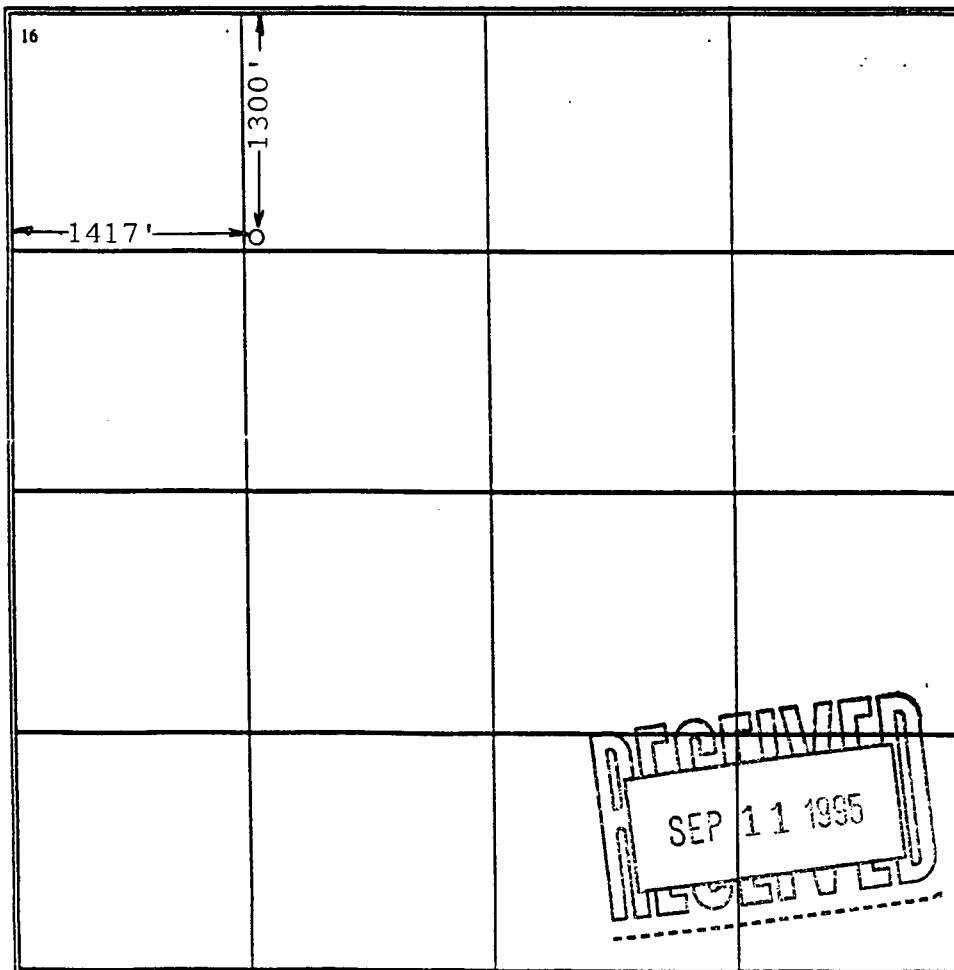
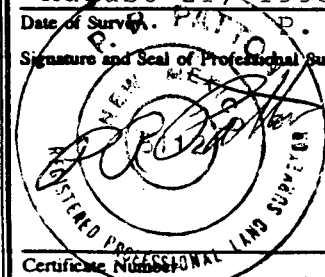
<div>16</div> 	<div>17 OPERATOR CERTIFICATION</div> <p>I hereby certify that the information contained herein is true and complete to the best of my knowledge and belief</p> <p>Signature _____</p> <p>Printed Name _____</p> <p>Title _____</p> <p>Date _____</p>	
	<div>18 SURVEYOR CERTIFICATION</div> <p>I hereby certify that the well location shown on this plat was plotted from field notes of actual surveys made by me or under my supervision, and that the same is true and correct to the best of my belief.</p> <p>August 21, 1995</p> <p>Date of Survey: P. R. Patton</p> <p>Signature and Seal of Professional Surveyor: </p> <p>Certificate Number 8112</p>	
	<div>RECEIVED</div> <p>SEP 11 1995</p>	

State of New Mexico  
Energy, Minerals & Natural Resources Department

District I  
PO Box 1980, Hobbs, NM 88241-1980

District II  
PO Drawer DD, Artesia, NM 88211-0719

District III  
1000 Rio Brazos Rd., Aztec, NM 87410

District IV  
PO Box 2088, Santa Fe, NM 87504-2088

Form C-101  
Revised February 10, 1994  
Instructions on back  
Submit to Appropriate District Office  
State Lease - 6 Copies  
Fee Lease - 5 Copies

**OIL CONSERVATION DIVISION**  
**PO Box 2088**  
**Santa Fe, NM 97504-2088**

\_\_\_\_\_ AMENDED REPORT

**APPLICATION FOR PERMIT TO DRILL, RE-ENTER, DEEPEN, PLUGBACK OR ADD A ZONE**

1. Operator Name and Address  <b>The Wiser Oil Company</b> <b>207 West McKay</b> <b>Carlsbad, NM 88220</b>		2. OGRID Number  <b>022922</b>
3. API Number  <b>30-025-</b>		
4. Property Code  <b>011844</b>	5. Property Name  <b>Maljamar Grayburg Unit</b>	
6. Well No.  <b>87</b>		

7. Surface Location									
UL or lot no. <b>F</b>	Section <b>4</b>	Township <b>17S</b>	Range <b>33E</b>	Lot Idn.	Feet From the <b>2623</b>	North/South Line <b>N</b>	Feet From the <b>1571</b>	East/West Line <b>W</b>	County <b>Lea</b>

8. Proposed Bottom Hole Location If Different From Surface									
UL or lot no.	Section	Township	Range	Lot Idn.	Feet From the	North/South Line	Feet From the	East/West Line	County
9. Proposed Pool 1 <b>Maljamar Grayburg San Andres</b>					10. Proposed Pool 2				

11. Work Type Code <b>N</b>	12. Well Type Code <b>O</b>	13. Cable/Rotary <b>Rotary</b>	14. Lease Type Code <b>P</b>	15. Ground Level Elevation <b>4142</b>
16. Multiple <b>N</b>	17. Proposed Depth <b>5000</b>	18. Formation <b>Grayburg &amp; SA</b>	19. Contractor <b>L &amp; M Drilling Co.</b>	20. Spud Date <b>11/01/95</b>

21. Proposed Casing and Cement Program					
Hole Size	Casing Size	Casing weight/foot	Setting Depth	Sacks of Cement	Estimated TOC
<b>12 1/4</b>	<b>8 5/8</b>	<b>24#</b>	<b>1200'</b>	<b>650</b>	<b>Circ</b>
<b>7 7/8</b>	<b>5 1/2</b>	<b>17#</b>	<b>5000'</b>	<b>1100</b>	<b>900' (300' inside 8 5/8" casing)</b>

22. Describe the proposed program. If this application is to DEEPEN or PLUG BACK, give the data on the present productive zone and proposed new productive zone. Describe the blowout prevention program, if any. Use additional sheets if necessary.

It is proposed to drill the above captioned well to a total depth of 5000' with rotary tools. If commercial production is indicated, the well will be perforated and stimulated as necessary.

Blow Out Prevention: 10" Series 900 Type "E" Shaffer Hydraulic BOP

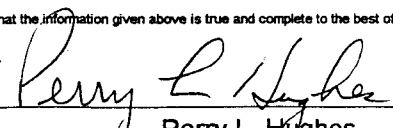
23. I hereby certify that the information given above is true and complete to the best of my knowledge and belief.  Signature:  Printed Name: <b>Perry L. Hughes</b> Title: <b>Agent</b> Date: <b>09/28/95</b>		<b>OIL CONSERVATION DIVISION</b> Approved by: _____ Title: _____ Approval Date: _____ Conditions of Approval: _____ Attached: _____	
Phone: <b>505/885-5433</b>			

District I  
PO Box 1980, Hobbs, NM 88241-1980  
District II  
PO Drawer DD, Artesia, NM 88211-0719  
District III  
1000 Rio Brazos Rd., Aztec, NM 87410  
District IV  
PO Box 2088, Santa Fe, NM 87504-2088

State of New Mexico  
Energy, Minerals & Natural Resources Department

OIL CONSERVATION DIVISION  
PO Box 2088  
Santa Fe, NM 87504-2088

Form C-102  
Revised February 10, 1994  
Instructions on back  
Submit to Appropriate District Office  
State Lease - 4 Copies  
Fee Lease - 3 Copies

☐ AMENDED REPORT

WELL LOCATION AND ACREAGE DEDICATION PLAT

API Number		Pool Code		Pool Name	
Property Code		Property Name			Well Number
		Maljamar Grayburg Unit			87
OGRID No.		Operator Name			Elevation
		The Wiser Company			4142

<sup>10</sup> Surface Location

UL or lot no.	Section	Township	Range	Lot Ida	Feet from the	North/South line	Feet from the	East/West line	County
F	4	17 S	32 E		2623	North	1571	West	Lea

<sup>11</sup> Bottom Hole Location If Different From Surface

UL or lot no.	Section	Township	Range	Lot Ida	Feet from the	North/South line	Feet from the	East/West line	County

<sup>12</sup> Dedicated Acres	<sup>13</sup> Joint or Infill	<sup>14</sup> Consolidation Code	<sup>15</sup> Order No.

NO ALLOWABLE WILL BE ASSIGNED TO THIS COMPLETION UNTIL ALL INTERESTS HAVE BEEN CONSOLIDATED  
OR A NON-STANDARD UNIT HAS BEEN APPROVED BY THE DIVISION

<div>16</div> <p>2623'</p> <p>1571'</p>	<div>17 OPERATOR CERTIFICATION</div> <p>I hereby certify that the information contained herein is true and complete to the best of my knowledge and belief</p> <p>Signature _____</p> <p>Printed Name _____</p> <p>Title _____</p> <p>Date _____</p>	
	<div>18 SURVEYOR CERTIFICATION</div> <p>I hereby certify that the well location shown on this plat was plotted from field notes of actual surveys made by me or under my supervision, and that the same is true and correct to the best of my belief.</p> <p>August 21, 1995</p> <p>Date of Survey: <u>PATTON</u> Patton</p> <p>Signature and Seal of Professional Surveyor: </p> <p>Certificate Number <u>8112</u></p>	
	<div>RECEIVED</div> <p>SEP 11 1995</p>	



CMD :  
OG5SECT

ONGARD  
INQUIRE LAND BY SECTION

10/12/95 10:30:08  
OGOMES -EMFB  
PAGE NO: 1

Sec : 04 Twp : 17S Rng : 32E Section Type : NORMAL

4 40.04  Federal owned U	3 40.04  Federal owned U	2 40.04  Federal owned	1 40.04  Federal owned
E 40.00  Fee owned U A	F 40.00  Fee owned U A A	G 40.00  Federal owned U A	H 40.00  Federal owned U A A

PF01 HELP  
PF07 BKWD

PF02  
PF08 FWD

PF03 EXIT  
PF09 PRINT

PF04 GoTo  
PF10 SDIV

PF05  
PF11

PF06  
PF12