

TOE
H
L
ELLEDGE

OIL CONSERVATION DIVISION
RECEIVED

'96 APR 12 AM 8 52

P.O. Box 111
Farmington, New Mexico 87499
(505) 327-9267
(505) 325-1873 (car 2893)

OIL and GAS PROPERTY MANAGEMENT

March 27, 1996

New Mexico Oil Conservation Division
P.O. Box 2088
Santa Fe, NM 87503

Re: Fairfield #3, Fruitland Sand PC Section 14 Township 27N Range 13W
Rocanville Corporation, P.O. Box 2088, Santa Fe, NM 87503

Dear Sirs,

Administrative approval is hereby requested for a WAW Fruitland Sand PC extension in an unorthodox location.

The Fairfield #3 was completed in 1963 in the Basin Dakota formation. The well has been plugged back from the Basin Dakota formation to the Fruitland Sand and perforated for a natural gas production test.

Waivers of Objection are being sent certified mail to offset operators requesting that they return one copy to NMOCD, Santa Fe office and one copy to our office.

Attached are copies of location plats for this well, and a plat showing offset ownership wells. If further information is required, please let us know. Thank you.

Sincerely,



Randy J. Elledge

Encl.

New Mexico Oil Conservation Division
P.O. Box 2088
Santa Fe, NM 87503

We hereby waive objection to the application request for an unorthodox location for the Fairfield #3 operated by Rocanville Corporation. This is an existing Basin Dakota location plugged back to the WAW Fruitland Sand PC.

Signature: _____

Date: _____

cc. Meridian Oil, Inc.
P.O. Box 4289
Farmington, NM 87499

Dugan Production
P.O. Box 420
Farmington, NM 87499

Little Oil & Gas
P.O. Box 1258
Farmington, NM 87499

Amoco Production Company
200 Amoco Court
Farmington, NM 87401

BMG Drilling Corp.
501 Airport Drive
Farmington, NM 87401

Jack Cole
3001 Northridge Drive
Farmington, NM 87401

Submit to Appropriate
District Office
State Lease - 4 copies
Fee Lease - 3 copies

State of New Mexico
Energy, Minerals and Natural Resources Department

Form C-102
Revised 1-1-89

OIL CONSERVATION DIVISION

P.O. Box 2088
Santa Fe, New Mexico 87504-2088

DISTRICT I
P.O. Box 1980, Hobbs, NM 88240

DISTRICT II
P.O. Drawer DD, Artesia, NM 88210

DISTRICT III
1000 Rio Brazos Rd., Aztec, NM 87410

WELL LOCATION AND ACREAGE DEDICATION PLAT

All Distances must be from the outer boundaries of the section

Operator Rocanville Corporation			Lease Fairfield		Well No. 3
Unit Letter F	Section 14	Township 27N	Range 13W	NMPM	County San Juan
Actual Footage Location of Well: 2110 feet from the North line and 1850 feet from the West line					
Ground level Elev. 5906	Producing Formation WAW		Pool Fruitland Sand PC		Dedicated Acreage: 160 Acres

1. Outline the acreage dedicated to the subject well by colored pencil or hachure marks on the plat below.

2. If more than one lease is dedicated to the well, outline each and identify the ownership thereof (both as to working interest and royalty).

3. If more than one lease of different ownership is dedicated to the well, have the interest of all owners been consolidated by communitization, unitization, force-pooling, etc.?

☒ Yes

☐ No

If answer is "yes" type of consolidation Rocanville only owner

If answer is "no" list the owners and tract descriptions which have actually been consolidated. (Use reverse side of this form if necessary.)

No allowable will be assigned to the well until all interests have been consolidated (by communitization, unitization, forced-pooling, or otherwise) or until a non-standard unit, eliminating such interest, has been approved by the Division.

Section B

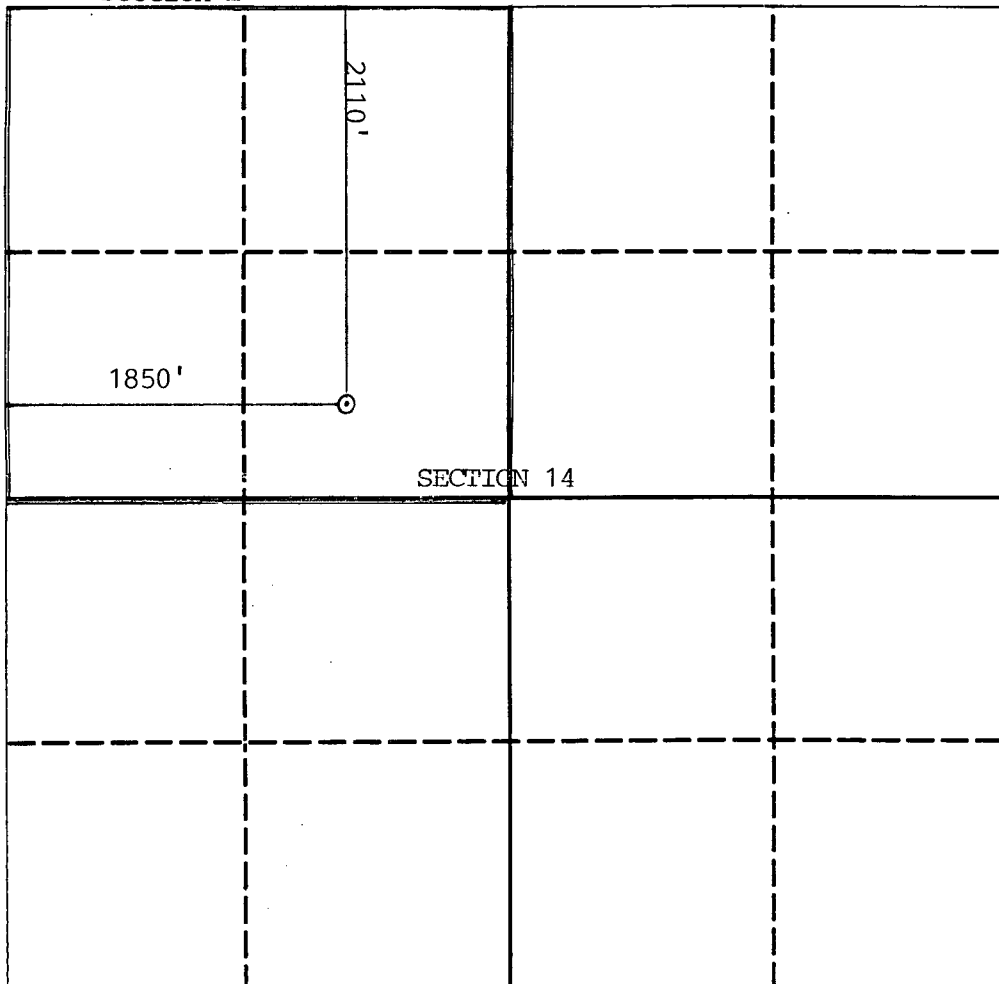

OPERATOR CERTIFICATION

I hereby certify that the information contained herein in true and complete to the best of my knowledge and belief.

Signature

Randy J. Elledge

Printed Name

Agent

Position

Rocanville Corp.

Company

March 27, 1996

Date

SURVEYOR CERTIFICATION

I hereby certify that the well location shown on this plat was plotted from field notes of actual surveys made by me or under my supervision, and that the same is true and correct to the best of my knowledge and belief.

August 8, 1963

Date Surveyed

Stephen H. Kinney

Signature & Seal of
Professional Surveyor

803

Certificate No.

0 330 660 990 1320 1650 1980 2310 2640 2000 1500 1000 500 0

NEW MEXICO OIL CONSERVATION COMMISSION
Well Location and Acreage Dedication Plat

Section A.

Date _____

Operator W. H. HUDSON Lease FAIRFIELD
Well No. 3 Unit Letter F Section 14 Township 27 N Range 13 W MMPM
Located 2110 Feet From north Line, 1850 Feet From west Line
County San Juan G. L. Elevation 5906 Dedicated Acreage 320 (W $\frac{1}{2}$) Acres
Name of Producing Formation Dakota Pool Basin Dakota

1. Is the Operator the only owner* in the dedicated acreage outlined on the plat below?
Yes X No _____.
2. If the answer to question one is "no," have the interests of all the owners been consolidated by communitization agreement or otherwise? Yes _____ No _____. If answer is "yes," Type of Consolidation _____
3. If the answer to question two is "no," list all the owners and their respective interests below:

Owner

Land Description

Section B

UNITED NATIONS SURVEY
NEW MEXICO

This is to certify that the information in Section A above is true and complete to the best of my knowledge and belief.

W. H. Hudson

(Operator)

J. B. Avant

(Representative) J. B. Avant
1126 Mercantile Securities Bldg.
Dallas 1, Texas

Address

This is to certify that the well location shown on the plat in Section B was plotted from field notes of actual surveys made by me or under my supervision and that the same is true and correct to the best of my knowledge and belief.

Date Surveyed Aug. 8, 1963

Stephen H. Kinney
STEPHEN H. KINNEY,

Registered Professional
Engineer and/or Land Surveyor.

Certificate No. 802

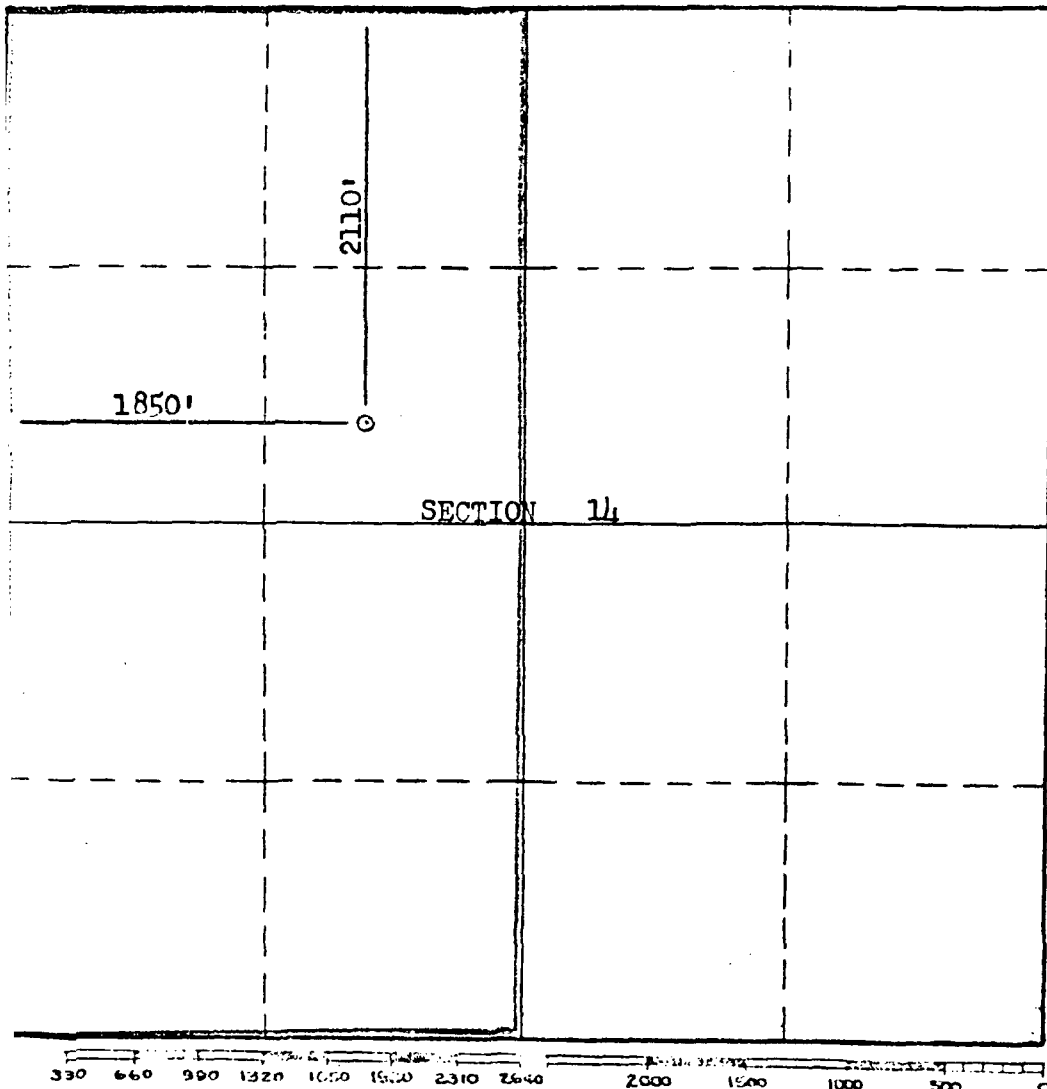

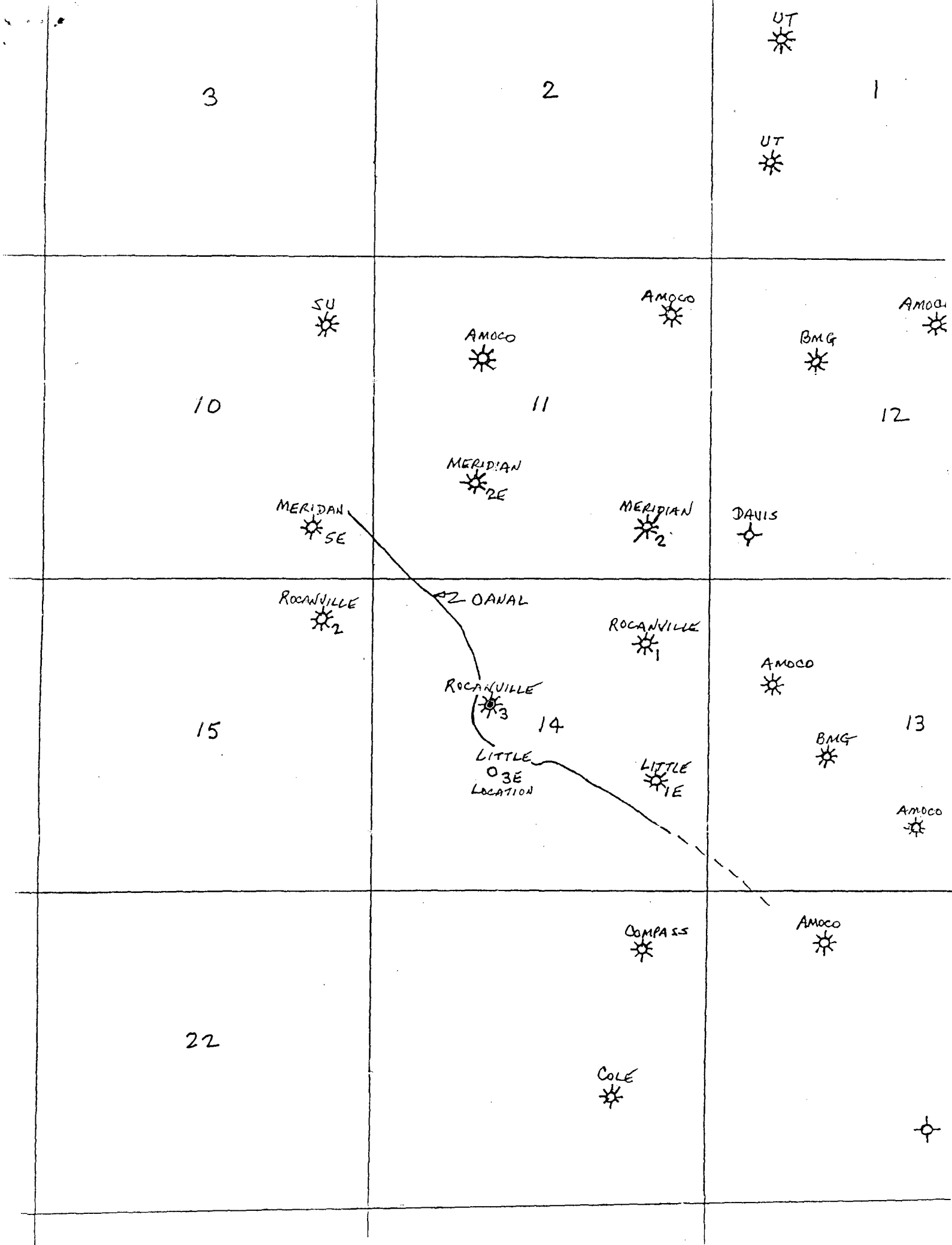

NEW MEXICO 12 AM 8 52

New Mexico Oil Conservation Division
P.O. Box 2088
Santa Fe, NM 87503

We hereby waive objection to the application request for an unorthodox location for the Fairfield #3 operated by Rocanville Corporation. This is an existing Basin Dakota location plugged back to the WAW Fruitland Sand PC.

Signature:

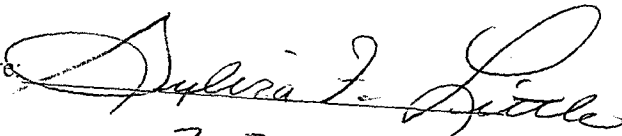

Date:

3-27-96

cc. Meridian Oil, Inc.
P.O. Box 4289
Farmington, NM 87499

Dugan Production
P.O. Box 420
Farmington, NM 87499

Little Oil & Gas
P.O. Box 1258
Farmington, NM 87499

Amoco Production Company
200 Amoco Court
Farmington, NM 87401

BMG Drilling Corp.
501 Airport Drive
Farmington, NM 87401

Jack Cole
3001 Northridge Drive
Farmington, NM 87401

COUNTY San Juan

POOL

Waw - Pictured Cliffs

Fruitland & Pictured Cliffs

TOWNSHIP 27 North

RANGE

13 West

NMPM

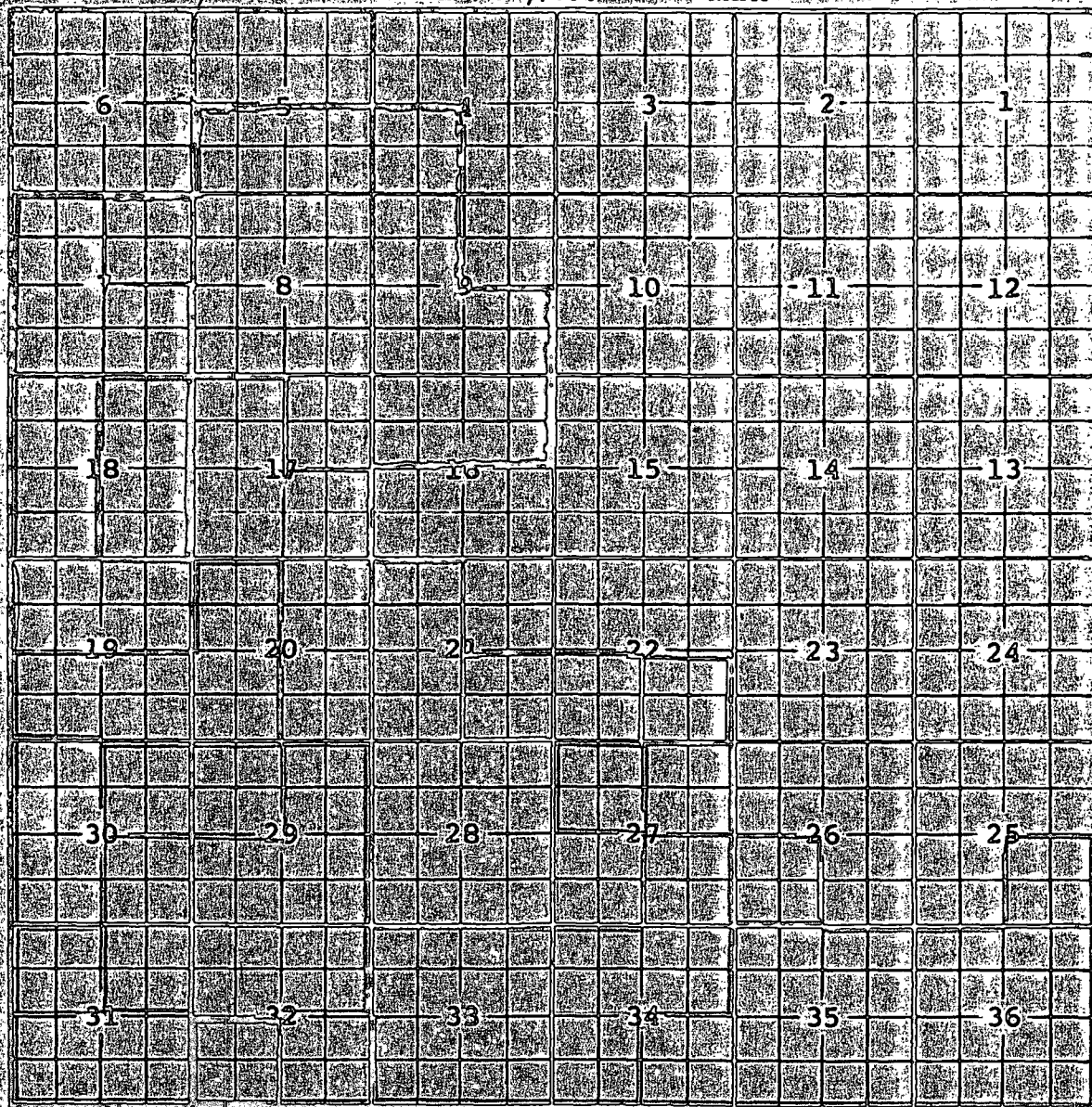

Description: $\frac{SE}{4}$ Sec 32 (R-4760, 3-1-72) Ext: $\frac{E}{2}$ & $\frac{SW}{4}$ Sec 29, $\frac{SE}{4}$ Sec 30, -
 - $\frac{NE}{4}$ Sec 31, $\frac{N}{2}$ Sec 32 (R-5129, 1-1-76) Ext: $\frac{SE}{4}$ Sec 27, $\frac{NW}{4}$ Sec 29, -
 - $\frac{NE}{4}$ Sec 30, $\frac{NW}{4}$ Sec 31, All Sec 33, $\frac{SW}{4}$ & $\frac{N}{2}$ Sec 34 (R-5339, 2-1-77)
 Ext: $\frac{SW}{4}$ Sec 26 (R-5470, 7-1-77) Ext: $\frac{S}{2}$ Sec 31 and vertical limits
 extended to include Fruitland Formation. Pool redesignated
 W.A.W - Fruitland - Pictured Cliffs Pool (R-5596, 1-1-78)
 Ext: $\frac{S}{2}$ Sec 19, $\frac{W}{2}$ Sec 20, $\frac{NE}{4}$ Sec 27, $\frac{SE}{4}$ Sec 32 (R-5772, 7-1-78)
 Ext: $\frac{W}{2}$ Sec 18, $\frac{N}{2}$ Sec 19, $\frac{SE}{4}$ Sec 25, $\frac{NW}{4}$ Sec 27, $\frac{W}{2}$ Sec 30, $\frac{SE}{4}$ Sec 34, -
 - All Secs 35 & 36 (R-5779, 8-1-78) Ext: $\frac{SW}{4}$ Sec 27 (R-5843, 12-1-78)
 Ext: $\frac{E}{2}$ Sec 18 (R-6180, 11-1-79) Ext: $\frac{W}{2}$ & $\frac{SE}{4}$ Sec 7, $\frac{W}{2}$ & $\frac{SE}{4}$ Sec 17
 $\frac{E}{2}$ Sec 10, $\frac{W}{2}$ Sec 21, All Sec 28 (R-6327, 5-1-80) Ext: $\frac{SW}{4}$ Sec 4,
 $\frac{S}{2}$ Sec 5, $\frac{NE}{4}$ Sec 7, All Sec 8, $\frac{W}{2}$ & $\frac{SE}{4}$ Sec 9, $\frac{N}{2}$ Sec 16, $\frac{NE}{4}$ Sec 17
 (R-6886, 1-22-82) Ext: $\frac{SE}{4}$ Sec 21, $\frac{SW}{4}$ Sec 22 (R-7277, 5-5-83)
 Ext: $\frac{SE}{4}$ Sec 22 (R-7495, 4-5-84) REDESIGNATED (R-8769, 10-1-86)

Mike Stogner

attn: Mike Stogner

From: Ernie Busch
To: Mike Stogner
Subject: JOE ELLEDGE(NSL)
Date: Wednesday, May 08, 1996 7:06AM
Priority: High

FAIRFIELD #3
2110' FNL; 1850' FWL
F-14-27N-13W
RECOMMEND: APPROVAL

RECEIVED
AUG 14 1996

RECEIVED
AUG 13 1996
OIL CON. DIV.
DIST. 3

8-9-96

Ernie

*I have yet to
see anything on this,
no abduction, no phone
call, no nothing.*

Mike Stogner

Mike,

*Looks like it was probably sent to the wrong
address — E*

Ernie Busch

From: Ernie Busch
To: Mike Stogner
Subject: JOE ELLEDGE(NSL)
Date: Wednesday, May 08, 1996 7:06AM
Priority: High

FAIRFIELD #3
2110' FNL; 1850' FWL
F-14-27N-13W
RECOMMEND: APPROVAL

OPERATORS MONTHLY REPORT

Form C115-Revised 1/1/89

See Distribution and Code

Information Bottom of Page

P.O. Box 2088

Santa Fe, New Mexico 87504-2088

Company

or Operator GIANT EXPL. & PROD COMPANY

Address P. O. BOX 2810, Farmington, NM Zip 87499

Year OCTOBER

Page 9 of 46

BISTI LOWER GALLUP

CARSON UNIT 10

30-045-05452 #34	O 10-25N-12W	S	0	0	0	0
30-045-05481 #43	I 10-25N-12W	P	64	162	316	30
30-045-05463 #44	P 10-25N-12W	S	0	0	0	0

CARSON UNIT 13

30-045-05407 #12	E 13-25N-12W	P	0	0	0	0
30-045-05344 #14	M 13-25N-12W	P	0	0	0	0
30-045-05431 #31	B 13-25N-12W	T	0	0	0	0
30-045-05401 #32	G 13-25N-12W	P	70	1529	319	31
30-045-05378 #33	J 13-25N-12W	T	0	0	0	0
30-045-13277 #42	H 13-25N-12W	P	33	850	51	31
30-045-05364 #43	I 13-25N-12W	P	140	68	178	31
30-045-05353 #44	P 13-25N-12W	T	0	0	0	0

DISTRIBUTION		STATUS CODE	OTHER GAS DISPOSITION CODE	OTHER OIL DISPOSITION CODE	I HEREBY CERTIFY THAT THE INFORMATION GIVEN IS TRUE	
ORIGINAL OCD SANTA FE	F...FLOWING	X...USE OFF LEASE	C...CIRCULATING OIL	AND COMPLETE TO THE BEST OF MY KNOWLEDGE		
ONE COPY OCD DIST. OFFICE	P...PUMPING	D...USED FOR DRILLING	L...LOST	Diane Jaramillo (505) 326-3325		
IN WHICH LEASE IS LOCATED	G...GAS LIFT	G...GAS LIFT	S...SEDIMENTATION BS&W	TYPED NAME PHONE NUMBER		
ONE COPY TO TRANSPORTER(S)	S...SHUT IN	L...LOST (MCF)/EST.	E...EXPLANATION ATTACHED	ADMINISTRATIVE MANAGER		
DATE DUE	T...TEMP ABANDONED	E...EXPLANATION ATTACHED	T...THEFT	POSITION		
TO BE POSTMARKED BY 24TH	I...INJECTION	R...REPRESSURING OR				
DAY OF NEXT SUCCEEDING MONTH	D...DISCONTINUED	PRESSURE MAINTENANCE				
	V...VENTED, U...USED ON LEASE					
				DATE		
				SIGNATURE		