

**Shell Western E&P Inc.**

An affiliate of Shell Oil Company



P. O. Box 576  
Houston, TX 77001

11-27

November 26, 1996

Mr. Michael E. Stogner  
State of New Mexico  
Energy, Minerals & Natural Resources Dept.  
Oil Conservation Division  
2040 South Pacheco  
Santa Fe NM 87505

RE: Application for Administrative Approval of an  
Unorthodox well location  
Silurian - Wildcat, Strawn - Wildcat,  
Oil Center - Blinebry Pool,  
Tubb Drinkard - Wildcat, Abo - Wildcat,  
Wolfcamp - Wildcat & Glorietta - Wildcat  
State P.C. Com well #1  
Section 32, T20S, R37E  
Lea County, New Mexico

Dear Mr. Stogner:

30-025-33672

Your office has previously approved an unorthodox location (NSL-3733) 1000' FSL and 2370' FEL of Section 32 as to the Ellenburger and McKee (Simpson) zones for possible gas production. We come to you now regarding the Silurian, Strawn, Blinebry, Tubb Drinkard, Abo, Wolfcamp and Glorietta zones and likewise request your approval of the aforementioned location so that, if necessary, we might produce from any of these zones from the State P.C. Com well #1, if necessary.

From our research, it appears that all of the captioned zones are classified Wildcat in this location, save and except the Blinebry, for which we find the Oil Center - Blinebry Pool rules apply i.e., 80-acres, 330' from boundaries, wells in NW and/or SE of each quarter section. We are unable to comply with the NW/SE of each quarter section as the Blinebry is certainly not a primary objective in this wellbore however, as stated below, we believe we can substantiate our reasoning as to the 330' from boundaries problem in the Blinebry Pool and the other Wildcat zones.

Enclosed please find Forms C-101 and C-102, a topographic survey from John W. West Engineering Company, together with vicinity, location and drill pad plats. As outlined in our request for permit dated October 29, 1996 for the Ellenburger and McKee/Simpson gas zones, we have selected the location shown above due to the fact

Page 2  
Mr. Michael E. Stogner  
November 26, 1996

that there are five buried pipelines located where the captioned zones would have been orthodox together with geological considerations for remaining structurally updip on the west side of the SW/4 SE/4 of Section 32.

As you have previously approved this well's unorthodox location as to its primary objectives by NSL-3733, we hereby request administrative approval of the unorthodox location for the oil zones. Due to the above, we request that you waive the notification and 20-day waiting period for this administrative approval.

If you have any questions or need additional information, do not hesitate to contact the undersigned at 281-544-3226. In fact, if you wouldn't mind, I would appreciate an opportunity to chat with you concerning this application. It is one of the more complicated I've faced in my short tenure here at Shell.

Yours very truly,

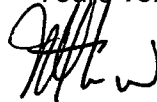

Jeff A. Dethrow CPL  
Contract Landman  
Western Asset Administration  
Continental Division

attach

xc w/ attach: Mr. Jerry Sexton  
State of New Mexico  
Oil Conservation District  
P.O. Box 1980  
Hobbs NM 88241-1980

District I  
PO Box 1980, Hobbs, NM 88241-1980  
District II  
PO Drawer DD, Artesia, NM 88211-0719  
District III  
1000 Rio Brazos Rd., Aztec, NM 87410  
District IV  
PO Box 2088, Santa Fe, NM 87504-2088

**OIL CONSERVATION DIVISION**  
**P.O. Box 2088**  
**Santa Fe, NM 87504-2088**

Instructions on back  
Submit to Appropriate District Office  
State Lease - 6 Copies  
Fee Lease - 5 Copies

☒ **AMENDED REPORT**

**APPLICATION FOR PERMIT TO DRILL, RE-ENTER, DEEPEN, PLUGBACK, OR ADD A ZONE**

<sup>1</sup> Operator name and Address <b>Shell Western E&amp;P Inc. P.O. Box 576 Houston, TX 77001</b>		<sup>2</sup> OGRID Number <b>020676</b>
		<sup>3</sup> API Number 30-0 <b>30-025-33672</b>
<sup>4</sup> Property Code <b>19945</b>	<sup>5</sup> Property Name <b>STATE P.C. COM</b>	<sup>6</sup> Well Number <b>1</b>

<sup>7</sup> Surface Location									
UL or lot no.	Section	Township	Range	Lot. Idn	Feet from the	North/South Line	Feet from the	East/West line	County
<b>0</b>	<b>32</b>	<b>T20S</b>	<b>R37E</b>		<b>1000</b>	<b>SOUTH</b>	<b>2370</b>	<b>EAST</b>	<b>LEA</b>

<sup>8</sup> Proposed Bottom Hole Location If Different From Surface									
UL or lot no.	Section	Township	Range	Lot. Idn	Feet from the	North/South Line	Feet from the	East/West line	County
<sup>9</sup> Proposed Pool 1 <b>SILURIAN - WILDCAT</b>					<sup>10</sup> Proposed Pool 2 <b>STRAWN - WILDCAT</b>				

<sup>11</sup> Work Type Code <b>N</b>	<sup>12</sup> Well Type Code <b>G</b>	<sup>13</sup> Cable/Rotary <b>R</b>	<sup>14</sup> Lease Type Code <b>S</b>	<sup>15</sup> Ground Level Elevation <b>3529' GL</b>
<sup>16</sup> Multiple <b>N</b>	<sup>17</sup> Proposed Depth <b>12,300'</b>	<sup>18</sup> Formations <b>*</b>	<sup>19</sup> Contractor <b>NORTON</b>	<sup>20</sup> Spud Date <b>12/21/96</b>

<sup>21</sup> Proposed Casing and Cement Program					
Hole Size	Casing Size	Casing weight/foot	Setting Depth	Sacks of Cement	Estimated TOC
<b>24"</b>	<b>20"</b>	<b>CONDR</b>	<b>40'</b>	<b>60</b>	<b>SURF</b>
<b>17-1/2"</b>	<b>13-3/8"</b>	<b>48#</b>	<b>1230'</b>	<b>900</b>	<b>SURF</b>
<b>12-1/4"</b>	<b>9-5/8"</b>	<b>36"</b>	<b>5300'</b>	<b>1000</b>	<b>SURF</b>
<b>8-3/4"</b>	<b>7"</b>	<b>26#&amp;29#</b>	<b>11000'</b>	<b>1300</b>	<b>4300'f/SFC</b>
<b>6-1/8"</b>	<b>5"</b>	<b>18#</b>	<b>12300'</b>	<b>75</b>	<b>11000</b>

<sup>22</sup> Describe the proposed program. If this application is to DEEPEN or PLUG BACK give the data on the present productive zone and proposed new productive zone. Describe the blowout prevention program, if any. Use additional sheets if necessary

**BOP Program 2000# Ram Preventer.**  
**Expected spud 12/21/96**

Previously received approval for this unorthodox location as to the Ellenburger - Wildcat and McKee - Wildcat gas zones (NSL-3733). The following zones are being permitted in the event the Ellenburger/McKee zones do not pan out as anticipated:

\*Silurian - Wildcat; Strawn - Wildcat; Oil Center - Blinbry; Tubb Drinkard - Wildcat; Abo - Wildcat; Wolfcamp - Wildcat & Glorietta - Wildcat.

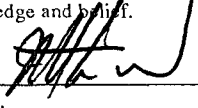
<sup>23</sup> I hereby certify that the information given above is true and complete to the best of my knowledge and belief. Signature: 		<b>OIL CONSERVATION DIVISION</b>	
Printed name: <b>Jeff A. Dethrow CPL</b>		Approved by:	
Title: <b>Contract Landman</b>		Title:	
Date: <b>11/26/96</b>		Approval Date:	Expiration Date:
Phone: <b>(713) 544-4589</b>		Conditions of Approval: Attached <input type="checkbox"/>	

DISTRICT I  
P.O. Box 1980, Hobbs, NM 88241-1980

State of New Mexico  
Energy, Minerals and Natural Resources Department

Form C-102  
Revised February 10, 1994  
Submit to Appropriate District Office  
State Lease - 4 Copies  
Fee Lease - 3 Copies

DISTRICT II  
P.O. Drawer DD, Artesia, NM 88211-0719

DISTRICT III  
1000 Rio Brazos Rd., Artec, NM 87410

DISTRICT IV  
P.O. BOX 2088, SANTA FE, N.M. 87504-2088

OIL CONSERVATION DIVISION

P.O. Box 2088  
Santa Fe, New Mexico 87504-2088

☐ AMENDED REPORT

WELL LOCATION AND ACREAGE DEDICATION PLAT

API Number 30-025-33672	Pool Code	Pool Name SILURIAN - WILDCAT
Property Code 19945	Property Name STATE P.C. COM	Well Number 1
OGRID No. 020676	Operator Name SHELL WESTERN E. & P. INC.	Elevation 3529'

Surface Location

UL or lot No. 0	Section 32	Township 20 S	Range 37 E	Lot Idn	Feet from the 1000	North/South Line SOUTH	Feet from the 2370	East/West Line EAST	County LEA
--------------------	---------------	------------------	---------------	---------	-----------------------	---------------------------	-----------------------	------------------------	---------------

Bottom Hole Location If Different From Surface

UL or lot No.	Section	Township	Range	Lot Idn	Feet from the	North/South Line	Feet from the	East/West Line	County
Dedicated Acres	Joint or Infill	Consolidation Code	Order No.						

NO ALLOWABLE WILL BE ASSIGNED TO THIS COMPLETION UNTIL ALL INTERESTS HAVE BEEN CONSOLIDATED  
OR A NON-STANDARD UNIT HAS BEEN APPROVED BY THE DIVISION

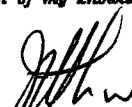
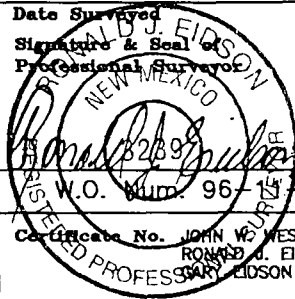
				<b>OPERATOR CERTIFICATION</b>  <i>I hereby certify the the information contained herein is true and complete to the best of my knowledge and belief.</i>   Signature JEFF A DETHROW CPL Printed Name CONTRACT LANDMAN Title 11/26/96 Date	
				<b>SURVEYOR CERTIFICATION</b>  <i>I hereby certify that the well location shown on this plat was plotted from field notes of actual surveys made by me or under my supervision, and that the same is true and correct to the best of my belief.</i>  OCTOBER 3, 1996 Date Surveyed Signature & Seal of Professional Surveyor  RES 10-04-96 W.O. Num. 96-1221 Certificate No. JOHN W. WEST RONALD J. EIDSON PROFESSIONAL SURVEYOR 678 3239 12641	
SHELL	SHELL	SHELL	SHELL	2370'	
SHELL	SHELL	SHELL	SHELL	1000'	

## DISTRICT I

P.O. Box 1900, Hobbs, NM 88241-1900

## DISTRICT II

P.O. Drawer DD, Artesia, NM 88211-0719

## DISTRICT III

1000 Rio Brazos Rd., Artec, NM 87410

## DISTRICT IV

P.O. BOX 2088, SANTA FE, N.M. 87504-2088

## State of New Mexico

Energy, Minerals and Natural Resources Department

Form C-102

Revised February 10, 1994

Submit to Appropriate District Office

State Lease - 4 Copies

Fee Lease - 3 Copies

## OIL CONSERVATION DIVISION

P.O. Box 2088

Santa Fe, New Mexico 87504-2088

☐ AMENDED REPORT

## WELL LOCATION AND ACREAGE DEDICATION PLAT

API Number 30-025-33672	Pool Code	Pool Name STRAWN - WILDCAT
Property Code 19945	Property Name STATE P.C. COM	Well Number 1
OGRID No. 020676	Operator Name SHELL WESTERN E. & P. INC.	Elevation 3529'

## Surface Location

UL or lot No.	Section	Township	Range	Lot Idn	Feet from the	North/South line	Feet from the	East/West line	County
0	32	20 S	37 E		1000	SOUTH	2370	EAST	LEA

## Bottom Hole Location If Different From Surface

UL or lot No.	Section	Township	Range	Lot Idn	Feet from the	North/South line	Feet from the	East/West line	County
Dedicated Acres	Joint or Infill	Consolidation Code	Order No.						

NO ALLOWABLE WILL BE ASSIGNED TO THIS COMPLETION UNTIL ALL INTERESTS HAVE BEEN CONSOLIDATED  
OR A NON-STANDARD UNIT HAS BEEN APPROVED BY THE DIVISION

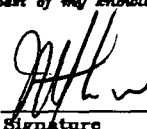
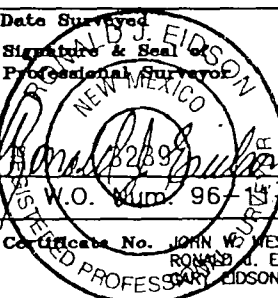
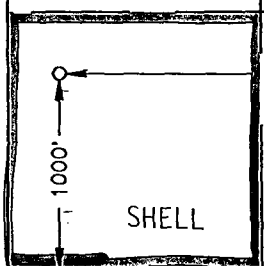
				<b>OPERATOR CERTIFICATION</b> I hereby certify the the information contained herein is true and complete to the best of my knowledge and belief.  Signature JEFF A DETHROW CPL Printed Name CONTRACT LANDMAN Title 11/26/96 Date	
				<b>SURVEYOR CERTIFICATION</b> I hereby certify that the well location shown on this plat was plotted from field notes of actual surveys made by me or under my supervision, and that the same is true and correct to the best of my belief. OCTOBER 3, 1996 Date Surveyed Signature & Seal of Professional Surveyor  W.O. Num. 96-13-1221 Certificate No. JOHN W. WEST 678 RONALD J. EIDSON 3239 PROFESSIONAL SURVEYOR EIDSON 12641	
SHELL SHELL SHELL SHELL  SHELL SHELL SHELL SHELL					

DISTRICT I  
P.O. Box 1880, Hobbs, NM 88241-1880

DISTRICT II  
P.O. Drawer DD, Artesia, NM 88211-0719

DISTRICT III  
1000 Elia Braxos Rd., Artec, NM 87410

DISTRICT IV  
P.O. BOX 2088, SANTA FE, N.M. 87504-2088

State of New Mexico  
Energy, Minerals and Natural Resources Department

Form C-102  
Revised February 10, 1994  
Submit to Appropriate District Office  
State Lease - 4 Copies  
Fee Lease - 3 Copies

OIL CONSERVATION DIVISION

P.O. Box 2088  
Santa Fe, New Mexico 87504-2088

☐ AMENDED REPORT

WELL LOCATION AND ACREAGE DEDICATION PLAT

API Number 30-025-33672	Pool Code	Pool Name OIL CENTER - BLINEBRY
Property Code 19945	Property Name STATE P.C. COM	Well Number 1
OGRID No. 020676	Operator Name SHELL WESTERN E. & P. INC.	Elevation 3529'

Surface Location

UL or lot No. 0	Section 32	Township 20 S	Range 37 E	Lot Idn	Feet from the 1000	North/South line SOUTH	Feet from the 2370	East/West line EAST	County LEA
--------------------	---------------	------------------	---------------	---------	-----------------------	---------------------------	-----------------------	------------------------	---------------

Bottom Hole Location If Different From Surface

UL or lot No.	Section	Township	Range	Lot Idn	Feet from the	North/South line	Feet from the	East/West line	County
Dedicated Acres		Joint or Infill	Consolidation Code	Order No.					

NO ALLOWABLE WILL BE ASSIGNED TO THIS COMPLETION UNTIL ALL INTERESTS HAVE BEEN CONSOLIDATED  
OR A NON-STANDARD UNIT HAS BEEN APPROVED BY THE DIVISION

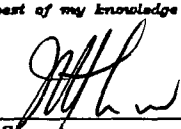
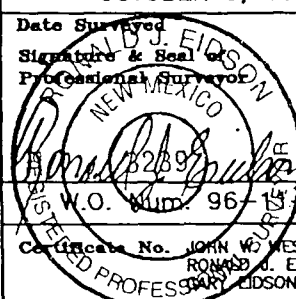
				<b>OPERATOR CERTIFICATION</b> <i>I hereby certify the information contained herein is true and complete to the best of my knowledge and belief.</i>  Signature JEFF A DETHROW CPL Printed Name CONTRACT LANDMAN Title 11/26/96 Date	
				<b>SURVEYOR CERTIFICATION</b> <i>I hereby certify that the well location shown on this plat was plotted from field notes of actual surveys made by me or under my supervision, and that the same is true and correct to the best of my belief.</i> OCTOBER 3, 1996 Date Surveyed Signature & Seal of Professional Surveyor  RES W.O. Num. 96-15-1221 Certificate No. JOHN W. WEST 678 RONALD J. EIDSON 3239 PROFESSIONAL SURVEYOR EIDSON 12641	
SHELL	SHELL	SHELL	SHELL	2370'	
SHELL	SHELL	SHELL	SHELL	1000'	

DISTRICT I  
P.O. Box 1990, Hobbs, NM 88241-1990

DISTRICT II  
P.O. Drawer DD, Artesia, NM 88211-0719

DISTRICT III  
1000 Rio Brazos Ed., Artesia, NM 87410

DISTRICT IV  
P.O. BOX 2068, SANTA FE, N.M. 87504-2068

State of New Mexico  
Energy, Minerals and Natural Resources Department

Form C-102  
Revised February 10, 1994  
Submit to Appropriate District Office  
State Lease - 4 Copies  
Fee Lease - 3 Copies

OIL CONSERVATION DIVISION

P.O. Box 2088  
Santa Fe, New Mexico 87504-2088

☐ AMENDED REPORT

WELL LOCATION AND ACREAGE DEDICATION PLAT

API Number 30-025-33672	Pool Code	Pool Name TUBB DRINKARD - WILDCAT
Property Code 19945	Property Name STATE P.C. COM	Well Number 1
OGRID No. 020676	Operator Name SHELL WESTERN E. & P. INC.	Elevation 3529'

Surface Location

UL or lot No. 0	Section 32	Township 20 S	Range 37 E	Lot Idn	Feet from the 1000	North/South line SOUTH	Feet from the 2370	East/West line EAST	County LEA
--------------------	---------------	------------------	---------------	---------	-----------------------	---------------------------	-----------------------	------------------------	---------------

Bottom Hole Location If Different From Surface

UL or lot No.	Section	Township	Range	Lot Idn	Feet from the	North/South line	Feet from the	East/West line	County
Dedicated Acres		Joint or Infill		Consolidation Code		Order No.			

NO ALLOWABLE WILL BE ASSIGNED TO THIS COMPLETION UNTIL ALL INTERESTS HAVE BEEN CONSOLIDATED  
OR A NON-STANDARD UNIT HAS BEEN APPROVED BY THE DIVISION

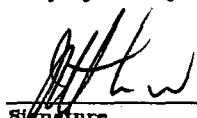
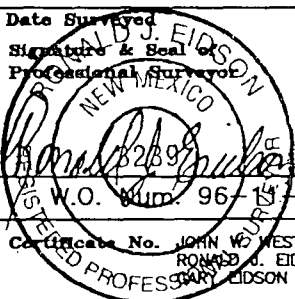
				<b>OPERATOR CERTIFICATION</b>  I hereby certify the the information contained herein is true and complete to the best of my knowledge and belief.   Signature JEFF A DETHROW CPL Printed Name CONTRACT LANDMAN Title 11/26/96 Date	
				<b>SURVEYOR CERTIFICATION</b>  I hereby certify that the well location shown on this plat was plotted from field notes of actual surveys made by me or under my supervision, and that the same is true and correct to the best of my belief.  OCTOBER 3, 1996 Date Surveyed Signature & Seal of Professional Surveyor  RES W.O. Num. 96-13-1221 Certificate No. JOHN W. WEST 676 RONALD J. EIDSON 3239 GARY EIDSON 12641	
SHELL	SHELL	SHELL	SHELL	2370'	
SHELL	SHELL	SHELL	SHELL	1000'	

DISTRICT I  
P.O. Box 1980, Hobbs, NM 88241-1980

State of New Mexico  
Energy, Minerals and Natural Resources Department

Form C-102  
Revised February 10, 1994  
Submit to Appropriate District Office  
State Lease - 4 Copies  
Fee Lease - 3 Copies

DISTRICT II  
P.O. Drawer DD, Artesia, NM 86211-0719

DISTRICT III  
1000 Rio Brazos Rd., Artesia, NM 87410

DISTRICT IV  
P.O. BOX 2088, SANTA FE, N.M. 87504-2088

OIL CONSERVATION DIVISION

P.O. Box 2088  
Santa Fe, New Mexico 87504-2088

☐ AMENDED REPORT

WELL LOCATION AND ACREAGE DEDICATION PLAT

API Number 30-025-33672	Pool Code	Pool Name ABO - WILDCAT
Property Code 19945	Property Name STATE P.C. COM	Well Number 1
OGRID No. 020676	Operator Name SHELL WESTERN E. & P. INC.	Elevation 3529'

Surface Location

UL or lot No. 0	Section 32	Township 20 S	Range 37 E	Lot Idn	Feet from the 1000	North/South line SOUTH	Feet from the 2370	East/West line EAST	County LEA
--------------------	---------------	------------------	---------------	---------	-----------------------	---------------------------	-----------------------	------------------------	---------------

Bottom Hole Location If Different From Surface

UL or lot No.	Section	Township	Range	Lot Idn	Feet from the	North/South line	Feet from the	East/West line	County
Dedicated Acres	Joint or Infill	Consolidation Code	Order No.						

NO ALLOWABLE WILL BE ASSIGNED TO THIS COMPLETION UNTIL ALL INTERESTS HAVE BEEN CONSOLIDATED  
OR A NON-STANDARD UNIT HAS BEEN APPROVED BY THE DIVISION

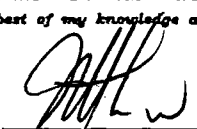
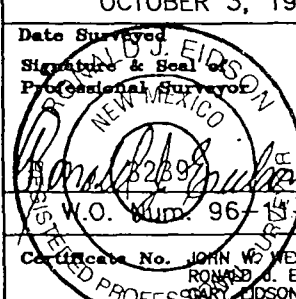
				<b>OPERATOR CERTIFICATION</b>  I hereby certify the the information contained herein is true and complete to the best of my knowledge and belief.   Signature JEFF A DETHROW CPL Printed Name CONTRACT LANDMAN Title 11/26/96 Date	
				<b>SURVEYOR CERTIFICATION</b>  I hereby certify that the well location shown on this plat was plotted from field notes of actual surveys made by me or under my supervision, and that the same is true and correct to the best of my belief.  OCTOBER 3, 1996 Date Surveyed Signature & Seal of Professional Surveyor  RES W.O. Num. 96-1221 Certificate No. JOHN W. WEST 678 RONALD J. EIDSON 3239 PROFESSIONAL SURVEYOR EIDSON 12641	
SHELL	SHELL	SHELL	SHELL	2370'	
SHELL	SHELL	SHELL	SHELL	1000'	



DISTRICT I  
P.O. Box 1980, Hobbs, NM 88241-1980

State of New Mexico  
Energy, Minerals and Natural Resources Department

Form C-102  
Revised February 10, 1994  
Submit to Appropriate District Office  
State Lease - 4 Copies  
Fee Lease - 3 Copies

DISTRICT II  
P.O. Drawer DD, Artesia, NM 88211-0719

DISTRICT III  
1000 El Estero Rd., Artesia, NM 87410

DISTRICT IV  
P.O. Box 2088, Santa Fe, N.M. 87504-2088

OIL CONSERVATION DIVISION

P.O. Box 2088  
Santa Fe, New Mexico 87504-2088

☐ AMENDED REPORT

WELL LOCATION AND ACREAGE DEDICATION PLAT

API Number 30-025-33672	Pool Code	Pool Name WOLFCAMP - WILDCAT
Property Code 19945	Property Name STATE P.C. COM	Well Number 1
OGRID No. 020676	Operator Name SHELL WESTERN E. & P. INC.	Elevation 3529'

Surface Location

UL or lot No. 0	Section 32	Township 20 S	Range 37 E	Lot Idn	Feet from the 1000	North/South line SOUTH	Feet from the 2370	East/West line EAST	County LEA
--------------------	---------------	------------------	---------------	---------	-----------------------	---------------------------	-----------------------	------------------------	---------------

Bottom Hole Location If Different From Surface

UL or lot No.	Section	Township	Range	Lot Idn	Feet from the	North/South line	Feet from the	East/West line	County
Dedicated Acres	Joint or Infill	Consolidation Code	Order No.						

NO ALLOWABLE WILL BE ASSIGNED TO THIS COMPLETION UNTIL ALL INTERESTS HAVE BEEN CONSOLIDATED  
OR A NON-STANDARD UNIT HAS BEEN APPROVED BY THE DIVISION

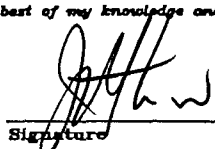
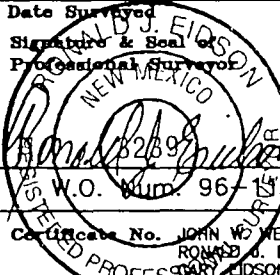
				<b>OPERATOR CERTIFICATION</b>  I hereby certify the information contained herein is true and complete to the best of my knowledge and belief.   Signature JEFF A DETHROW CPL Printed Name CONTRACT LANDMAN Title 11/26/96 Date	
				<b>SURVEYOR CERTIFICATION</b>  I hereby certify that the well location shown on this plat was plotted from field notes of actual surveys made by me or under my supervision, and that the same is true and correct to the best of my belief.  OCTOBER 3, 1996 Date Surveyed Signature & Seal of Professional Surveyor  RES 10-04-96 W.O. MUD. 96-1221 Certificate No. JOHN W. WEST 678 RONALD J. EIDSON 3239 PROFESSIONAL SURVEYOR 12641	
SHELL	SHELL	SHELL	SHELL	2370'	
SHELL	SHELL	SHELL	SHELL	1000'	

DISTRICT I  
P.O. Box 1880, Hobbs, NM 88241-1880

DISTRICT II  
P.O. Drawer DD, Artesia, NM 88211-0719

DISTRICT III  
1000 Rio Brazos Rd., Artesia, NM 87410

DISTRICT IV  
P.O. BOX 2088, SANTA FE, N.M. 87504-2088

State of New Mexico  
Energy, Minerals and Natural Resources Department

Form C-102  
Revised February 10, 1994  
Submit to Appropriate District Office  
State Lease - 4 Copies  
Fee Lease - 3 Copies

OIL CONSERVATION DIVISION

P.O. Box 2088  
Santa Fe, New Mexico 87504-2088

☐ AMENDED REPORT

WELL LOCATION AND ACREAGE DEDICATION PLAT

API Number 30-025-33672	Pool Code	Pool Name GLORIETTA - WILDCAT
Property Code 19945	Property Name STATE P.C. COM	Well Number 1
OGRID No. 020676	Operator Name SHELL WESTERN E. & P. INC.	Elevation 3529'

Surface Location

UL or lot No.	Section	Township	Range	Lot Idn	Feet from the	North/South line	Feet from the	East/West line	County
0	32	20 S	37 E		1000	SOUTH	2370	EAST	LEA

Bottom Hole Location If Different From Surface

UL or lot No.	Section	Township	Range	Lot Idn	Feet from the	North/South line	Feet from the	East/West line	County
Dedicated Acres	Joint or Infill	Consolidation Code	Order No.						

NO ALLOWABLE WILL BE ASSIGNED TO THIS COMPLETION UNTIL ALL INTERESTS HAVE BEEN CONSOLIDATED  
OR A NON-STANDARD UNIT HAS BEEN APPROVED BY THE DIVISION

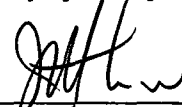
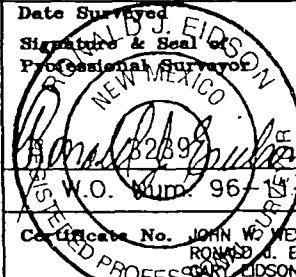
				<b>OPERATOR CERTIFICATION</b> <i>I hereby certify the the information contained herein is true and complete to the best of my knowledge and belief.</i>  Signature JEFF A DETHROW CPL Printed Name CONTRACT LANDMAN Title 11/26/96 Date
				<b>SURVEYOR CERTIFICATION</b> <i>I hereby certify that the well location shown on this plat was plotted from field notes of actual surveys made by me or under my supervision, and that the same is true and correct to the best of my belief.</i> OCTOBER 3, 1996 Date Surveyed Signature & Seal of Professional Surveyor  RES 10-04-96 W.O. Num. 96-1221 Certificate No. JOHN W. WEST 676 RONALD A. EIDSON 3239 PROFESSIONAL SURVEYOR EIDSON 12641
SHELL	SHELL	SHELL	SHELL	
SHELL	SHELL	SHELL	SHELL	

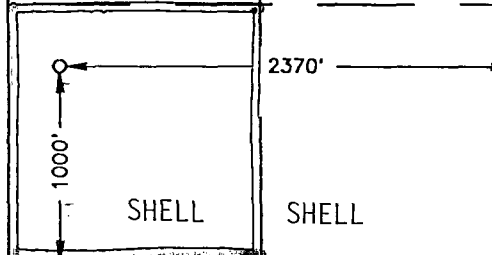

**SECTION 32, TOWNSHIP 20 SOUTH, RANGE 37 EAST, N.M.P.M.**  
**LEA COUNTY, NEW MEXICO**

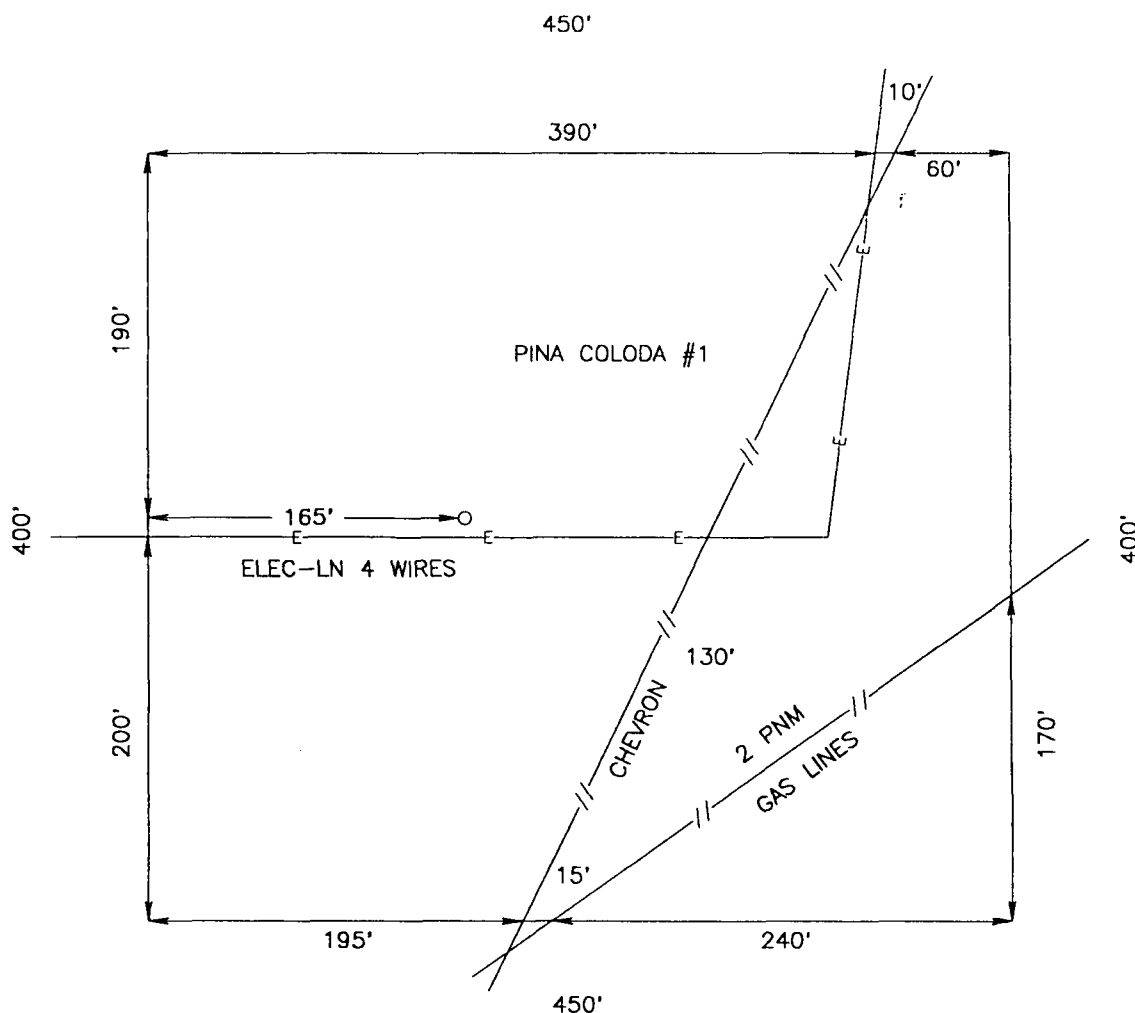

**SHELL WESTERN E & P, INC.**

THE PINA COLODA NO. 1 IS LOCATED 1000 FEET FROM THE SOUTH LINE AND 2370 FEET FROM THE EAST LINE OF SECTION 32, TOWNSHIP 20 SOUTH, RANGE 37 EAST, N.M.P.M., LEA COUNTY, NEW MEXICO.

Survey Date: 10-03-1996	Sheet 1 of 1 Sheets
W.O. Number: 96-11-1221	Drawn By: RES
Date: 10-04-96	61111221
BS-14	Scale: 1" = 100'

# LOCATION VERIFICATION MAP

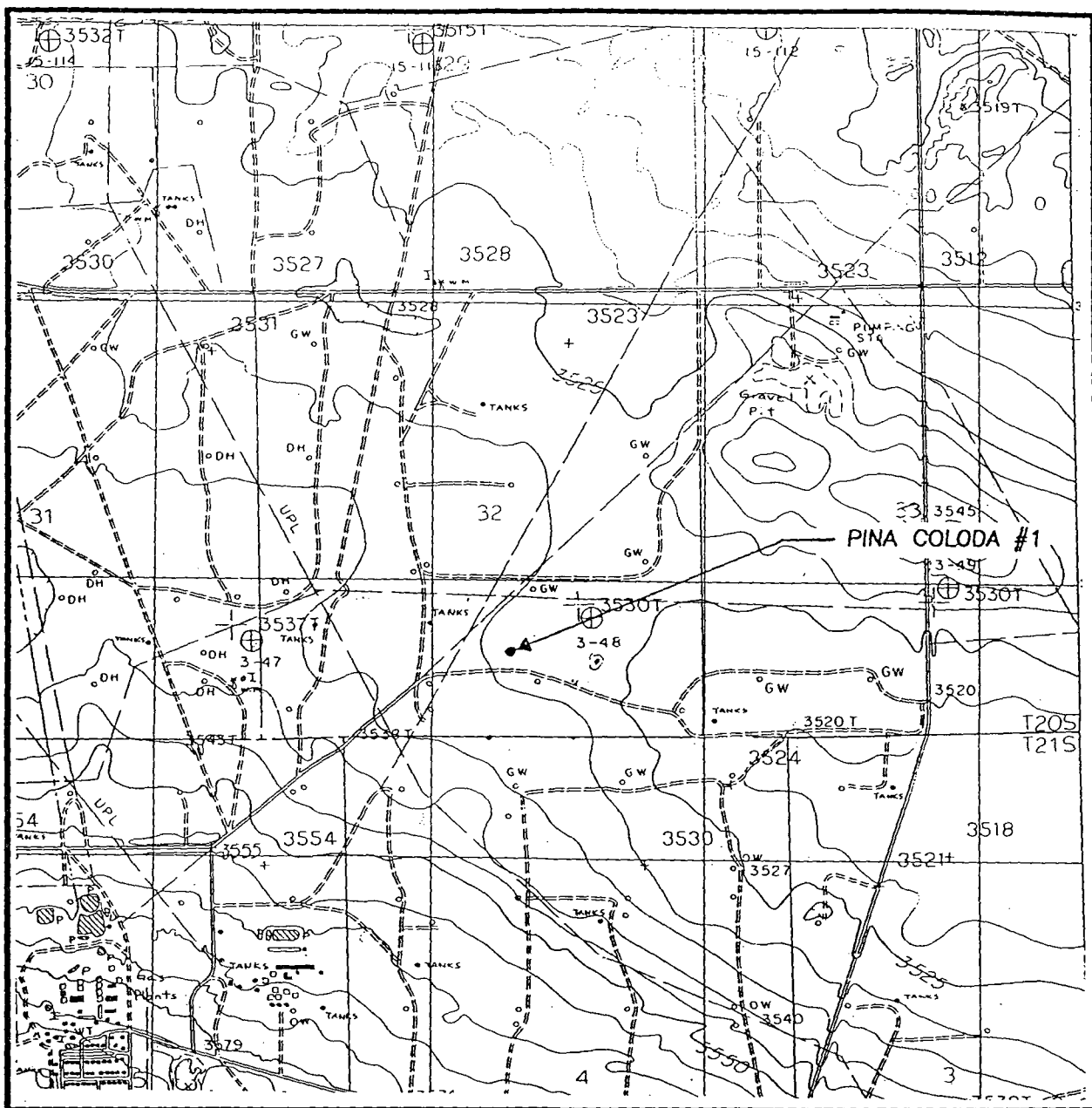

SCALE: 1" = 2000'

CONTOUR INTERVAL:  
MONUMENT SOUTH - 5'

SEC. 32 TWP. 20-S RGE. 37-E

SURVEY N.M.P.M.

COUNTY LEA

DESCRIPTION 1000' FSL & 2370' FEL

ELEVATION 3529'

OPERATOR SHELL WESTERN E. & P. INC.

LEASE PINA COLODA

U.S.G.S. TOPOGRAPHIC MAP

MONUMENT SOUTH, N. MEX.

**JOHN WEST ENGINEERING**  
**HOBBS, NEW MEXICO**

**(505) 393-3117**

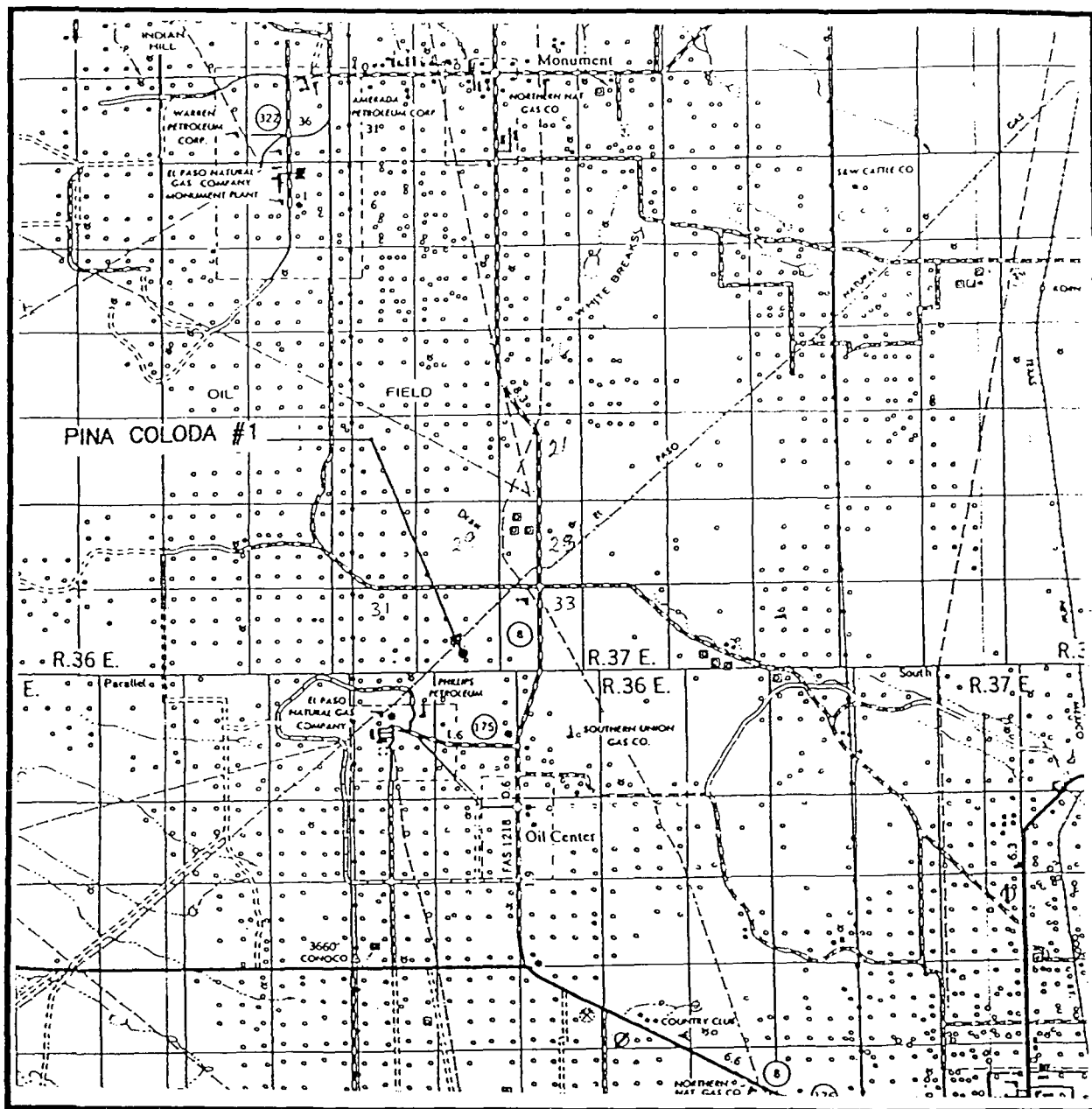

SEC. 32 TWP. 20-S RGE. 37-E

SURVEY \_\_\_\_\_ N.M.P.M. \_\_\_\_\_

COUNTY \_\_\_\_\_ LEA \_\_\_\_\_

DESCRIPTION 1000' FSL & 2370' FEL

ELEVATION 3529'

OPERATOR SHELL WESTERN E. & P. INC.

LEASE                      PINA COLODA

**JOHN WEST ENGINEERING  
HOBBS, NEW MEXICO  
(505) 393-3117**

SECTION 32, TOWNSHIP 20 SOUTH, RANGE 37 EAST, N.M.P.M.,  
LEA COUNTY, NEW MEXICO

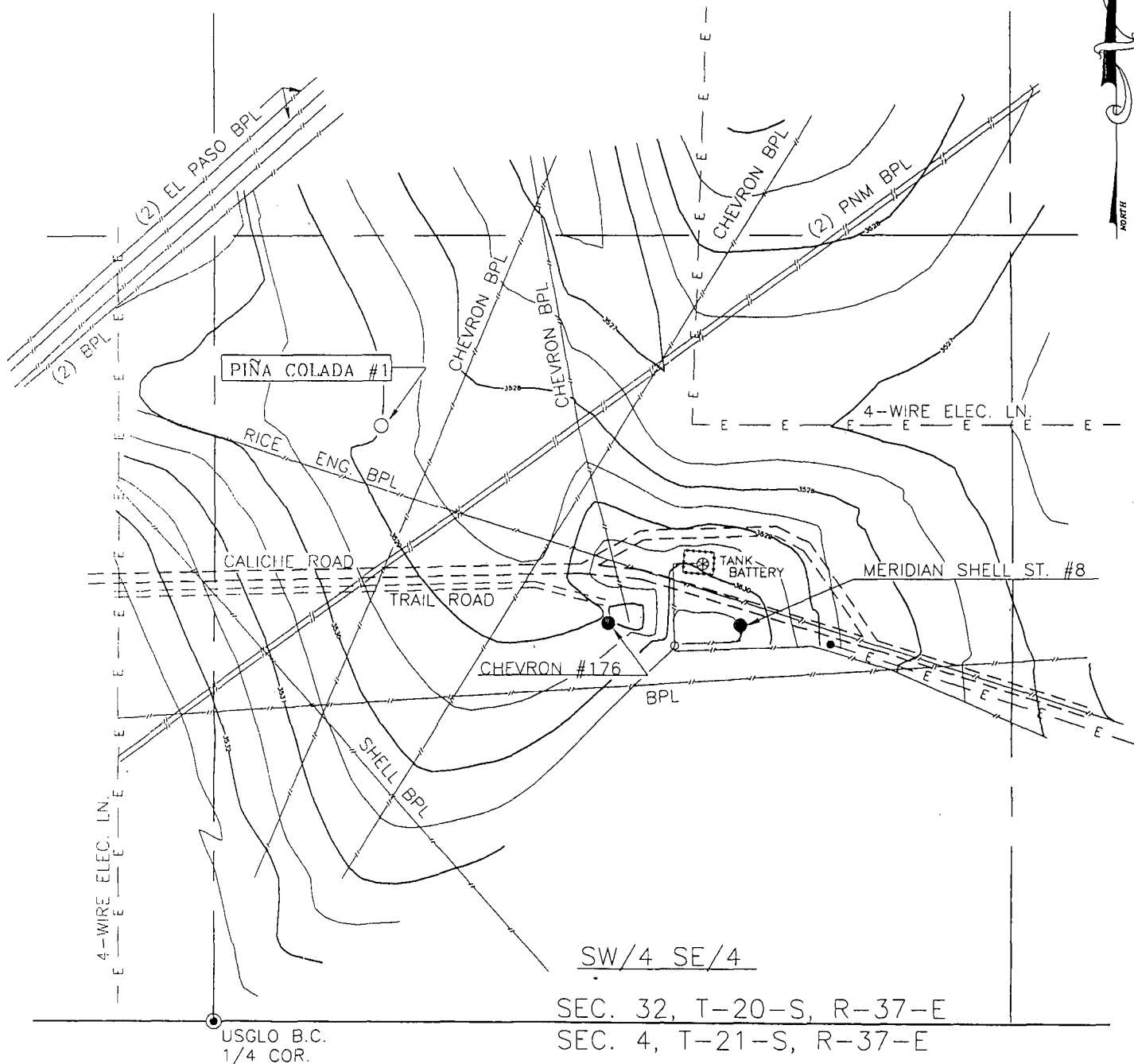

I HEREBY CERTIFY THAT THIS PLAT WAS PREPARED  
FROM FIELD NOTES OF AN ACTUAL SURVEY AND  
MEETS OR EXCEEDS ALL REQUIREMENTS FOR LAND  
SURVEY AS PRESCRIBED BY THIS STATE.

*Ronald E. Eidson* 10-28-96  
JOHN W. WEST, N.M. P.E. & P.S. No. 676  
RONALD E. EIDSON, N.M. P.S. No. 1138  
GARY D. EIDSON, N.M. P.S. No. 3239  
GARY D. EIDSON, TEXAS P.L.S. No. 1883  
GARY D. EIDSON, TEXAS P.L.S. No. 12641  
GARY D. EIDSON, TEXAS P.L.S. No. 4735

JOHN W. WEST ENGINEERING COMPANY  
CONSULTING ENGINEERS & SURVEYORS - HOBBS, NEW MEXICO

200' 0 200' 400'  
SCALE: 1"=200'

 SHELL WESTERN E & P INC.

TOPOGRAPHIC SURVEY FOR THE PINA COLADA #1  
1000 FSL, 2370 FEL, SECTION 32, TOWNSHIP 20 SOUTH  
RANGE 37 EAST, N.M.P.M., LEA COUNTY, NEW MEXICO.

Survey Date: 10-22-96	Sheet 1 of 1 Sheets
W.O. Number: 96-11-1355	Drawn By: CDG
Date: 10-24-96	Disk: SHELL2
SWEPI355	Scale: 1"=200'



STATE OF NEW MEXICO  
ENERGY, MINERALS AND NATURAL RESOURCES DEPARTMENT

OIL CONSERVATION DIVISION  
2040 S. PACHECO  
SANTA FE, NEW MEXICO 87505  
(505) 827-7131

November 4, 1996

Shell Western E & P, Inc.  
P. O. Box 576  
Houston, Texas 77001  
Attention: Jeff A. Dethrow

*Administrative Order NSL-3733*

Dear Mr. Dethrow:

Reference is made to your application dated October 29, 1996 for approval to drill the State P. C. Com Well No. 1 at an unorthodox gas well location to test both the McKee (Simpson) and Ellenburger formations 1000 feet from the South line and 2370 feet from the East line (Unit O) of Section 32, Township 20 South, Range 37 East, NMPM, Lea County, New Mexico. The S/2 of said Section 32 to be dedicated to said well to form a standard 320-acre gas spacing and proration unit for both intervals.

The application has been duly filed under the provisions of Rule 104.F of the General Rules and Regulations of the New Mexico Oil Conservation Division ("Division"), revised by Division Order No. R-10533, issued by the Oil Conservation Commission in Case 11,351 on January 18, 1996.

By the authority granted me under the provisions of Division General Rule 104.F(2), the above-described unorthodox gas well location is hereby approved.

Sincerely,

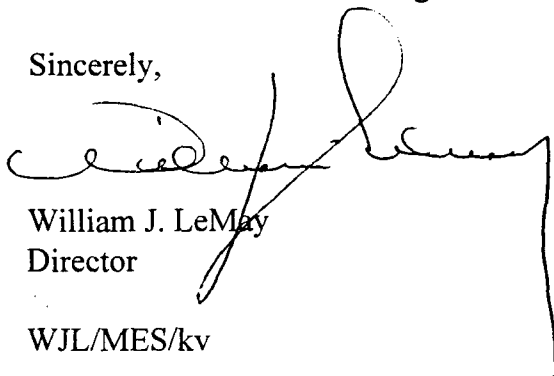

William J. LeMay  
Director

WJL/MES/kv

cc: Oil Conservation Division - Hobbs  
New Mexico State Land Office - Santa Fe

(Formerly the Hardy Drinkard Pool -) Tdbb extended by R-8626

COUNTY LEA

POOL HARDY TUBB-DRINKARD

TOWNSHIP 21 S

RANGE 36 E

NMPM

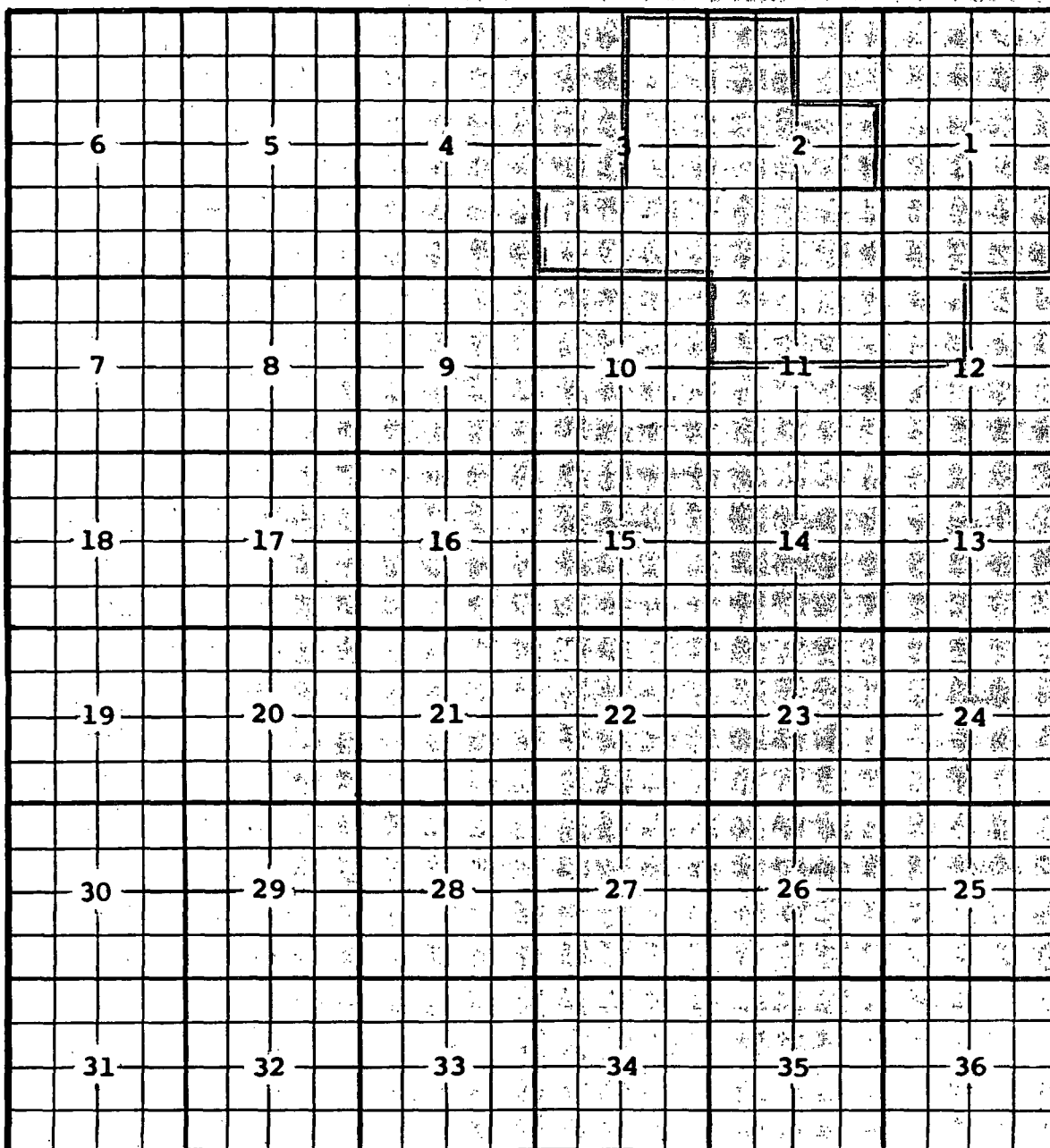

DESC: SE $\frac{1}{4}$  SEC 2, NE $\frac{1}{4}$  SEC 11 (R-6328, 5-1-80) EXT: NW $\frac{1}{4}$  SEC 12 (R-6449, 9-1-80)  
EXT: S $\frac{1}{2}$  SEC 1 (R-6536, 12-1-80) EXT: SW $\frac{1}{4}$  SEC 2 (R-7917, 5-13-85)  
EXT: SE $\frac{1}{4}$  SEC 3 (R-8193, 3-21-86) REDESIGNATED + EXT: SEC 2: LOTS 3,  
4, 5, 6, 9, 10, 11, 12, 13, 14, 15, 16, SEC 3: LOTS 1, 2, 7, 8, + SW $\frac{1}{4}$ , NW $\frac{1}{4}$  SEC 11  
(R-8626, 4/1/88) EXT: SEC 3: LOTS 9, 10, 15 + 16 (R-8668, 6/10/88)



COUNTY Lea POOL Oil Center - Blinberry

POOL

Oil Center - Blinberry

TOWNSHIP

TOWNSHIP 20 South RANGE 37 East

**NMPM**

A 36x36 grid with numbers 1-36 placed in specific cells, likely representing a calendar or a data table. The numbers are arranged in a pattern that suggests a 6x6 grid of 6x6 sub-grids. The numbers are placed in the top-left corner of each 6x6 sub-grid, starting from 1 in the top-left and ending at 36 in the bottom-right.

Ext: <sup>SW</sup>/<sub>4</sub> Sec. 32 (R-269251-64)

Extend vertical limits to include 120 feet above Blinbry marker.  
(R-7396, 12-8-83)

CMD :  
OG5SECT

ONGARD  
INQUIRE LAND BY SECTION

12/18/96 07:30:05  
OGOMES -EMGR  
PAGE NO: 2

Sec : 32 Twp : 20S Rng : 37E Section Type : NORMAL

L 40.00 CS B02406 1 01/39 ATLANTIC RICHFIEL C U A	K 40.00 CS B01167 60 09/42 SHELL WESTERN E & C U A A	J 40.00 CS B01167 60 09/42 SHELL WESTERN E & U A	I 40.00 CS B01167 60 09/42 SHELL WESTERN E & U A
M 40.00 CS B02406 1 01/39 ATLANTIC RICHFIEL C U A A	N 40.00 CS B01167 60 09/42 SHELL WESTERN E & C U A A	O 40.00 CS B01167 60 09/42 SHELL WESTERN E & U A A A	P 40.00 CS B01167 60 09/42 SHELL WESTERN E & U A

PF01 HELP  
PF07 BKWD

PF02  
PF08 FWD

PF03 EXIT  
PF09 PRINT

PF04 GoTo  
PF10 SDIV

PF05  
PF11

PF06  
PF12

CMD :  
OG5SECT

ONGARD  
INQUIRE LAND BY SECTION

12/18/96 07:29:51  
OGOMES -EMGR  
PAGE NO: 1

Sec : 32 Twp : 20S Rng : 37E Section Type : NORMAL

D 40.00 CS B02288 3 12/38 ATLANTIC RICHFIEL U A	C 40.00 CS B01463 3 01/39 BERT FIELDS JR U A	B 40.00 CS B01463 3 01/39 BERT FIELDS JR U	A 40.00 CS B02366 12 01/39 TEXACO EXPLORATIO U
E 40.00 CS B02288 3 12/38 ATLANTIC RICHFIEL U A A	F 40.00 CS B01463 3 01/39 BERT FIELDS JR U A A	G 40.00 CS B01463 3 01/39 BERT FIELDS JR U A	H 40.00 CS B02366 12 01/39 TEXACO EXPLORATIO U A

PF01 HELP	PF02	PF03 EXIT	PF04 GoTo	PF05	PF06
PF07 BKWD	PF08 FWD	PF09 PRINT	PF10 SDIV	PF11	PF12



[illegible]