



NSL

4/22/97

Midland Division  
Exploration Production

Conoco Inc.  
10 Desta Drive, Suite 100W  
Midland, TX 79705-4500  
(915) 686-5400

March 31, 1997

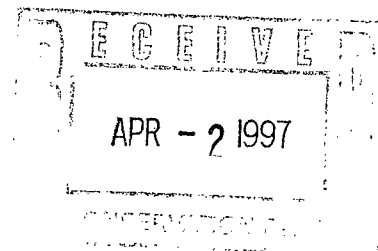

Mr. Michael Stogner  
New Mexico Oil Conservation Division  
2040 S. Pacheco  
Santa Fe, New Mexico 87504

RE: Application for Non-Standard Location  
for San Juan 28-7 Unit No. 232M to  
Avoid Disturbance of Archaeological Sites

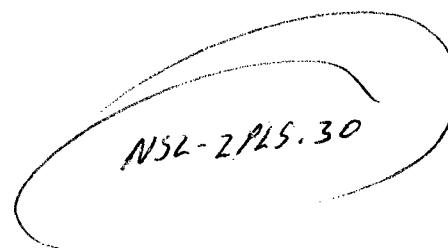

Dear Mr. Stogner:

As requested in your letter of March 25, 1997 (copied attached), I have added a 9-section map of the subject area to our application for an unorthodox location "infill" gas well location for the San Juan 28-7 Unit No. 232M. As this map shows, within the Conoco-operated San Juan 28-7 Unit, Conoco is the offset operator of all the tracts surrounding the subject spacing unit. Therefore, no notification of offset operators was required. I apologize for not including the map initially to clarify this fact.

I have also sent a copy of this revised application to the Aztec Oil Conservation Office. I trust this will clear the way for approval of this application.

If there are any further questions concerning this application please call me at (915) 686-6548.

Very truly yours,

Jerry W. Hoover  
Sr. Conservation Coordinator

cc: Oil Conservation Division - Aztec  
William J. LeMay, Director - OCD, Santa Fe



NEW MEXICO ENERGY, MINERALS  
& NATURAL RESOURCES DEPARTMENT

OIL CONSERVATION DIVISION  
2040 South Pacheco Street  
Santa Fe, New Mexico 87505  
(505) 827-7131

March 25, 1997

Conoco, Inc.  
10 Desta Drive - Suite 100W  
Midland, Texas 79705-4500

Attention: Jerry W. Hoover

Re: *Application for administrative approval to drill the San Juan "28-7" Unit Well No. 232-M at an unorthodox "infill" gas well location 2425 feet from the South line and 500 feet from the East line (Unit I) of Section 20, Township 28 North, Range 7 West, NMPM, Basin Dakota/Blanco-Mesaverde Pools, Rio Arriba County, New Mexico.*

Dear Mr. Hoover:

I am returning the subject application as incomplete, no plat was included identifying all off-set operators effected by the unorthodox location [as required by Rule 2(d) of the "General Rules For The Prorated Gas Pools of New Mexico/Special Rules and Regulations For The Blanco-Mesaverde Pool/Special Rules and Regulations For The Basin-Dakota Pool", as promulgated by Division Order No. R-8170, as amended, and Division General Rule 104.F(3)]. If required, was appropriate notification pursuant to Rule 104.F(3) provided these operators or affected parties (other than Conoco of course).

Further, please provide information on all other producing Basin-Dakota and Blanco-Mesaverde well(s) within the subject 320-acre unit [this information will serve to help expedite in the preparation of an order, will serve to add integrity to any order issued by including valuable information within the order for all concerned, and is required pursuant to said Rule 104.F(3)].

The District Offices of the Division has requested that it be provided copies of such applications for administrative approval filed with Santa Fe (this informs the District offices of any pending applications and is a way for them to convey to the Santa Fe office or operator of any potential problems in a particular area).

Thank you for your cooperation in this matter.

Sincerely,

Michael E. Stogner  
Chief Hearing Officer/Engineer

cc: Oil Conservation Division - Aztec  
William J. LeMay, Director - OCD, Santa Fe  
W. Thomas Kellahin - Santa Fe

Mid-Continent Region  
Exploration/Production

NSL 4/13/97  
Conoco Inc.  
10 Desta Drive, Suite 100W  
Midland, TX 79705-4500  
(915) 686-5400

March 20, 1997

Mr. Michael Stogner  
New Mexico Oil Conservation Division  
2040 S. Pacheco  
Santa Fe, New Mexico 87504

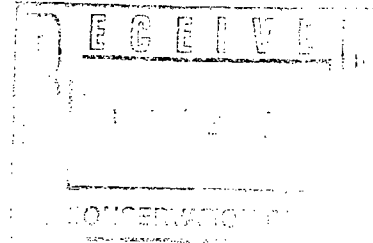

RE: Application for Non-Standard Location  
for San Juan 28-7 Unit No. 232M to  
Avoid Disturbance of Archaeological Sites

Dear Mr. Stogner:

This proposed Mesaverde/Dakota well has been staked at a non-standard location of 2425' FSL & 500' FEL, Sec. 20, T-28N, R-7W, Rio Arriba County as shown by the attached C-102. Blanco Mesaverde and Basin Dakota pool rules require a standard location to be located no closer than 790' to the east/west quarter-section line and no closer than 790' to the east section line. This staked location is only 215' from the quarter-section line and 500' from the east section line.

Figure 2a is a topo map showing previously recorded archaeological sites and topographical features in the area. This plat shows that S/2 of the SE/4 of Section 20 is dominated by the Carrizo Creek and Carrizo Canyon. A large site (NM-01-32135) overlaps the most feasible standard location area just to the north of the canyon rim. Therefore, efforts to stake in this vicinity were abandoned. The Project Survey Area was then moved to the north as shown on the Figure 2a.

Figure 2 is a second topo map showing the same survey area as Figure 2a and the identification of seven new sites as recorded in the LAC Report 9642d. Although surrounded by numerous small sites a well location was agreed upon with the BLM at the above proposed location. Also attached is a copy of a letter from the La Plata Archaeological Consultants documenting their process of attempting to find a usable location in the SE/4 of Section 20. As the letter notes, it was the opinion of the archaeologists that this was the only possible location that would be feasible and acceptable to the BLM.

Therefore, a nonstandard location order is requested for the drilling of this well which is planned for April, 1997. If there are any further questions concerning this application please call me at (915) 686-6548.

Very truly yours,

Jerry W. Hoover  
Sr. Conservation Coordinator

District I  
PO Box 1980, Hobbs, NM 88241-1980  
District II  
PO Drawer DD, Artesia, NM 88211-0719  
District III  
1000 Rio Brazos Rd., Aztec, NM 87410  
District IV  
PO Box 2088, Santa Fe, NM 87504-2088

State of New Mexico  
Energy, Minerals & Natural Resources Department

OIL CONSERVATION DIVISION  
PO Box 2088  
Santa Fe, NM 87504-2088

Form C-102  
Revised February 21, 1994  
Instructions on back  
Submit to Appropriate District Office  
State Lease - 4 Copies  
Fee Lease - 3 Copies

☐ AMENDED REPORT

WELL LOCATION AND ACREAGE DEDICATION PLAT

API Number		Pool Code	Pool Name
		72319/71599	Blanco Mesaverde/Basin Dakota
Property Code	Property Name		Well Number
016608	San Juan 28-7 Unit		232M
OGRID No.	Operator Name		Elevation
05073	CONOCO, INC.		6108'

<sup>10</sup> Surface Location

UL or lot no.	Section	Township	Range	Lot Idn	Feet from the	North/South line	Feet from the	East/West line	County
I	20	28-N	7-W		2425	South	500	East	R.A.

<sup>11</sup> Bottom Hole Location If Different From Surface

UL or lot no.	Section	Township	Range	Lot Idn	Feet from the	North/South line	Feet from the	East/West line	County

<sup>12</sup> Dedicated Acres	<sup>13</sup> Joint or Infill	<sup>14</sup> Consolidation Code	<sup>15</sup> Order No.
E/320			

NO ALLOWABLE WILL BE ASSIGNED TO THIS COMPLETION UNTIL ALL INTERESTS HAVE BEEN CONSOLIDATED  
OR A NON-STANDARD UNIT HAS BEEN APPROVED BY THE DIVISION



16	5280.00'		17 OPERATOR CERTIFICATION
			I hereby certify that the information contained herein is true and complete to the best of my knowledge and belief
			
			Signature
			Jerry W. Hoover
			Printed Name
			Sr. Conservation Coordinator
			Title
			3/20/97
			Date
			18 SURVEYOR CERTIFICATION
			I hereby certify that the well location shown on this plat was plotted from field notes of actual surveys made by me or under my supervision, and that the same is true and correct to the best of my belief.
			11/02/96
			Date of Survey
			Signature and Seal of Professional Surveyor
			
			6857
			Certificate Number



Figure 2. Project area  
USGS Delgadita Mesa, NM  
7.5' 1985 (Provisional edition)  
T28N, R7W, Section 20  
Rio Arriba County, NM

TATES GEOLOGICAL SURVEY  
USGS, NOS/NOAA  
TAKEN ..... 1977  
81. MAP EDITED ..... 1985  
..... TRANSVERSE MERCATOR  
SE MERCATOR ..... ZONE 13  
..... NEW MEXICO, CENTRAL  
..... AND WEST ZONES  
..... 1°32' WEST  
..... 13° EAST  
..... GEODETIC VERTICAL DATUM OF 1929  
..... 1927 NORTH AMERICAN DATUM  
..... North American Datum of 1983,  
shown by dashed corner ticks

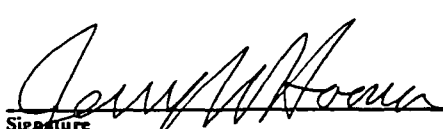
# PROVISIONAL MAP

Produced from original  
manuscript drawings. Informa-

CONTOUR INTERVAL

SCALE 1:2

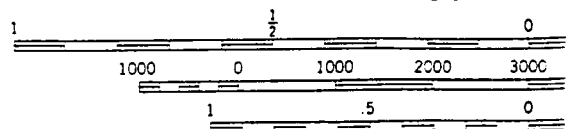

100 000, FEET

267

268

35'

270

TATES GEOLOGICAL SURVEY  
USGS, NOS/NOAA  
TAKEN ..... 1977  
81. MAP EDITED ..... 1985  
..... TRANSVERSE MERCATOR  
SE MERCATOR ..... ZONE 13  
..... NEW MEXICO, CENTRAL  
..... AND WEST ZONES  
..... 1°32' WEST  
..... 13° EAST  
..... GEODETIC VERTICAL DATUM OF 1929  
..... 1927 NORTH AMERICAN DATUM  
..... North American Datum of 1983,  
shown by dashed corner ticks

# PROVISIONAL MAP

Produced from original  
manuscript drawings. Informa-

CONTOUR INTERVAL

SCALE 1:2

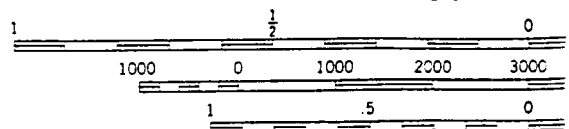

100 000, FEET

267

268

35'

270

**LA PLATA ARCHAEOLOGICAL CONSULTANTS**

26851 County Road P, Dolores, Colorado 81323

Office Phone: (970) 565-8708

Fax Phone: (970) 882-2224

January 14, 1997

Mr. Ellis Gray  
Conoco Incorporated  
10 Desta Drive, Suite 550E  
Midland, TX 79705-4500

RECEIVED

JAN 21 1997

CONOCO  
ROW&C

RE: San Juan 28-7 No. 232M well location

Dear Mr. Gray:

The SJ 28-7 No. 232M well pad was staked by NCE surveys and examined by Fred Harden of our office in November, 1996. Prior to the staking, it was noted that one fairly large, previously recorded archaeological site (NM-01-32135) was situated within the legal window for this location. Although the site was not rerecorded or reexamined, it probably overlaps the most feasible spot to construct a well location. Consequently, the well was staked further to the northeast in an area where several smaller archaeological sites exist. A total of eight archaeological sites were encountered and recorded in the vicinity of the actual staked well pad and access road and these are described in the archaeological report for this well location (LAC Report 9642d). The eight sites are fairly evenly distributed around the four sides of the well pad and on both sides of the proposed access road.

Given the high density of archaeological sites that are located specifically in proximity to the staked location, the known large site previously recorded to the southwest of the staked location, and the probable high density of other sites expected to be within this locale, it is not likely that another well location could be found and staked without encountering problems with the presence of archaeological sites. Due to these circumstances, it is unlikely that another well location can be found within the SE¼ of Section 20 that would be better than the currently staked location.

If you have any further questions concerning this well location, please let me know.

Sincerely,

  
Steven L. Fuller

cc: Rueben Sanchez, BLM Farmington  
Deb Bemenderfer, Trigon Engineering

District I  
PO Box 1980, Hobbs, NM 88241-1980  
District II  
PO Drawer DD, Artesia, NM 88211-0719  
District III  
1000 Rio Brazos Rd., Aztec, NM 87410  
District IV  
PO Box 2088, Santa Fe, NM 87504-2088

State of New Mexico  
Energy, Minerals & Natural Resources Department

OIL CONSERVATION DIVISION  
PO Box 2088  
Santa Fe, NM 87504-2088

Form C-102  
Revised February 21, 1994  
Instructions on back  
Submit to Appropriate District Office  
State Lease - 4 Copies  
Fee Lease - 3 Copies

☐ AMENDED REPORT

WELL LOCATION AND ACREAGE DEDICATION PLAT

API Number		Pool Code	Pool Name
		72319/71599	Blanco Mesaverde/Basin Dakota
Property Code	Property Name		Well Number
016608	San Juan 28-7 Unit		232M
OGRID No.	Operator Name		Elevation
05073	CONOCO, INC.		6108'

<sup>10</sup> Surface Location

UL or lot no.	Section	Township	Range	Lot Idn	Feet from the	North/South line	Feet from the	East/West line	County
I	20	28-N	7-W		2425	South	500	East	R.A.

<sup>11</sup> Bottom Hole Location If Different From Surface

UL or lot no.	Section	Township	Range	Lot Idn	Feet from the	North/South line	Feet from the	East/West line	County

<sup>12</sup> Dedicated Acres	<sup>13</sup> Joint or Infill	<sup>14</sup> Consolidation Code	<sup>15</sup> Order No.
E/320			

NO ALLOWABLE WILL BE ASSIGNED TO THIS COMPLETION UNTIL ALL INTERESTS HAVE BEEN CONSOLIDATED  
OR A NON-STANDARD UNIT HAS BEEN APPROVED BY THE DIVISION

16	5280.00'		17 OPERATOR CERTIFICATION I hereby certify that the information contained herein is true and complete to the best of my knowledge and belief  Signature: <u>Jerry W. Hoover</u> Printed Name: <u>Jerry W. Hoover</u> Title: <u>Sr. Conservation Coordinator</u> Date: <u>3/20/97</u>
	Conoco, Inc. San Juan "28-7" Unit Well No. 47 30-039-07389 817' FNL - 838' FEL Blanco - Mesaverde Compl.		
5280.00'	20		18 SURVEYOR CERTIFICATION I hereby certify that the well location shown on this plat was plotted from field notes of actual surveys made by me or under my supervision, and that the same is true and correct to the best of my belief. 11/02/96 Date of Survey: <u>11/02/96</u> Signature and Seal of Professional Surveyor: <u>NEALE C. EDWARDS</u> Certificate Number: <u>6857</u>
	Conoco, Inc. San Juan "28-7" Unit Well No. 232 30-039-20993 1765' FNL - 1490' FEL Basin Dakota completion E/z dedication		
5280.60'		2425'	



CMD :  
OG55ECT

ONGARD  
INQUIRE LAND BY SECTION

03/25/97 07:41:31  
OGOMES -EMFM  
PAGE NO: 2

Sec : 20 Twp : 28N Rng : 07W Section Type : NORMAL

L 40.00  Federal owned U	K 40.00  Federal owned U	J 40.00  Federal owned U	I 40.00  Federal owned U
M 40.00  Federal owned U	N 40.00  Federal owned U A A	O 40.00  Federal owned U	P 40.00  Federal owned U

PF01 HELP	PF02	PF03 EXIT	PF04 GoTo	PF05	PF06
PF07 BKWD	PF08 FWD	PF09 PRINT	PF10 SDIV	PF11	PF12

CMD :  
OG5SECT

ONGARD  
INQUIRE LAND BY SECTION

03/25/97 07:41:16  
OGOMES -EMFM  
PAGE NO: 1

Sec : 20 Twp : 28N Rng : 07W Section Type : NORMAL

D 40.00  Federal owned U A	C 40.00  Federal owned U A	B 40.00  Federal owned U	A 40.00  Federal owned U A
E 40.00  Federal owned U	F 40.00  Federal owned U	G 40.00  Federal owned U A	H 40.00  Federal owned U

PF01 HELP	PF02	PF03 EXIT	PF04 GoTo	PF05	PF06
PF07 BKWD	PF08 FWD	PF09 PRINT	PF10 SDIV	PF11	PF12



Midland Division  
Exploration Production

Conoco Inc.  
10 Desta Drive, Suite 100W  
Midland, TX 79705-4500  
(915) 686-5400

March 20, 1997

Mr. Michael Stogner  
New Mexico Oil Conservation Division  
2040 S. Pacheco  
Santa Fe, New Mexico 87504

RE: Application for Non-Standard Location  
for San Juan 28-7 Unit No. 232M to  
Avoid Disturbance of Archaeological Sites

Dear Mr. Stogner:

This proposed Mesaverde/Dakota well has been staked at a non-standard location of 2425' FSL & 500' FEL, Sec. 20, T-28N, R-7W, Rio Arriba County as shown by the attached C-102. Blanco Mesaverde and Basin Dakota pool rules require a standard location to be located no closer than 790' to the east/west quarter-section line and no closer than 790' to the east section line. This staked location is only 215' from the quarter-section line and 500' from the east section line.

Figure 2a is a topo map showing previously recorded archaeological sites and topographical features in the area. This plat shows that S/2 of the SE/4 of Section 20 is dominated by the Carrizo Creek and Carrizo Canyon. A large site (NM-01-32135) overlaps the most feasible standard location area just to the north of the canyon rim. Therefore, efforts to stake in this vicinity were abandoned. The Project Survey Area was then moved to the north as shown on the Figure 2a.

Figure 2 is a second topo map showing the same survey area as Figure 2a and the identification of seven new sites as recorded in the LAC Report 9642d. Although surrounded by numerous small sites a well location was agreed upon with the BLM at the above proposed location. Also attached is a copy of a letter from the La Plata Archaeological Consultants documenting their process of attempting to find a usable location in the SE/4 of Section 20. As the letter notes, it was the opinion of the archaeologists that this was the only possible location that would be feasible and acceptable to the BLM.

Reference to the attached 9-section map shows that the original Dakota and Mesaverde wells located in the subject spacing unit (E/2, Section 20) are the San Juan 28-7 Unit Well Nos. 232 and 47 respectively. The proposed Well No. 232M will be completed and tested separately in the Mesaverde and Dakota formations and eventually downhole commingled following adequate testing and approval for commingling. The map also shows that this spacing unit is in the interior of the San Juan 28-7 Unit of which Conoco is the operator. There are no other offset operators that would be affected by this unorthodox Mesaverde/Dakota location.

Therefore, a nonstandard location order is requested for the drilling of this well which is planned for April, 1997. If there are any further questions concerning this application please call me at (915) 686-6548.

Very truly yours,

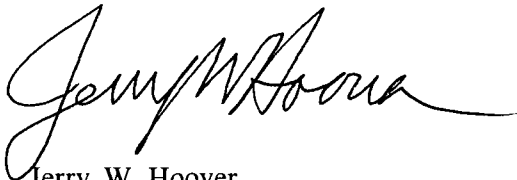
A handwritten signature in cursive script, appearing to read "Jerry W. Hoover". The signature is fluid and extends to the right.

Jerry W. Hoover  
Sr. Conservation Coordinator

cc: Oil Conservation Division - Aztec  
William J. LeMay, Director - OCD, Santa Fe

District I  
PO Box 1980, Hobbs, NM 88241-1980  
District II  
PO Drawer DD, Artesia, NM 88211-0719  
District III  
1000 Rio Brazos Rd., Aztec, NM 87410  
District IV  
PO Box 2088, Santa Fe, NM 87504-2088

State of New Mexico  
Energy, Minerals & Natural Resources Department

OIL CONSERVATION DIVISION  
PO Box 2088  
Santa Fe, NM 87504-2088

Form C-102  
Revised February 21, 1994  
Instructions on back  
Submit to Appropriate District Office  
State Lease - 4 Copies  
Fee Lease - 3 Copies

☐ AMENDED REPORT

WELL LOCATION AND ACREAGE DEDICATION PLAT

' APT Number		' Pool Code 72319/71599		' Pool Name Blanco Mesaverde/Basin Dakota	
' Property Code 016608		' Property Name San Juan 28-7 Unit			' Well Number 232M
' OGRID No. 05073		' Operator Name CONOCO, INC.			' Elevation 6108'

<sup>10</sup> Surface Location

UL or lot no.	Section	Township	Range	Lot Idn	Feet from the	North/South line	Feet from the	East/West line	County
I	20	28-N	7-W		2425	South	500	East	R.A.

<sup>11</sup> Bottom Hole Location If Different From Surface

UL or lot no.	Section	Township	Range	Lot Idn	Feet from the	North/South line	Feet from the	East/West line	County

<sup>12</sup> Dedicated Acres E/320	<sup>13</sup> Joint or Infill	<sup>14</sup> Consolidation Code	<sup>15</sup> Order No.
--	-------------------------------	----------------------------------	-------------------------

NO ALLOWABLE WILL BE ASSIGNED TO THIS COMPLETION UNTIL ALL INTERESTS HAVE BEEN CONSOLIDATED  
OR A NON-STANDARD UNIT HAS BEEN APPROVED BY THE DIVISION

16	5280.00'	20	5280.00'	500'	2425'	5280.00'	5280.60'
<sup>17</sup> OPERATOR CERTIFICATION I hereby certify that the information contained herein is true and complete to the best of my knowledge and belief  Signature <u>Jerry W. Hoover</u> Printed Name <u>Jerry W. Hoover</u> Title <u>Sr. Conservation Coordinator</u> Date <u>3/20/97</u>							
<sup>18</sup> SURVEYOR CERTIFICATION I hereby certify that the well location shown on this plat was plotted from field notes of actual surveys made by me or under my supervision, and that the same is true and correct to the best of my belief. 11/02/96 Date of Survey Signature and Seal of Professional Surveyor  6857 Certificate Number							

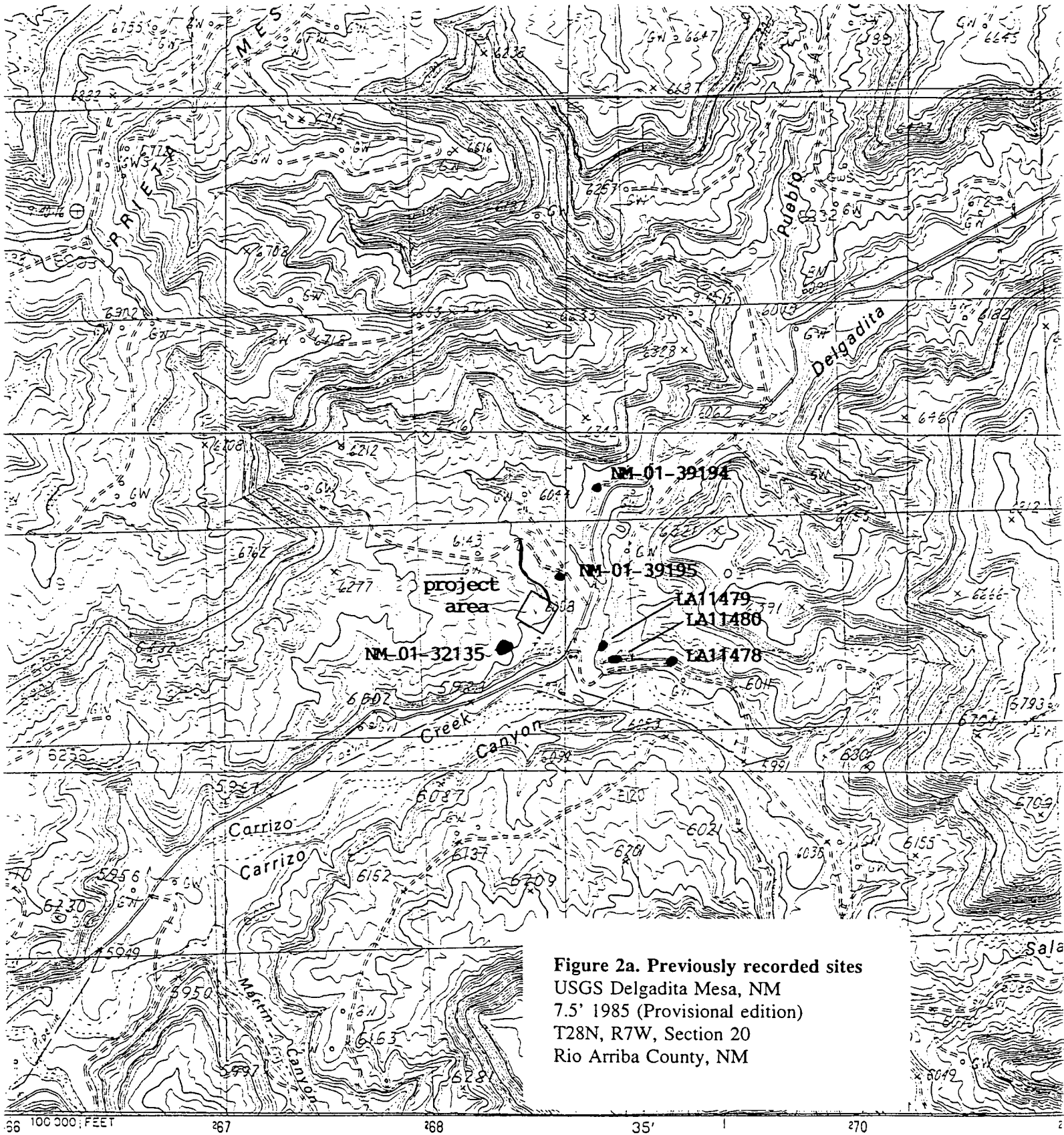

**Figure 2a. Previously recorded sites**  
 USGS Delgadita Mesa, NM  
 7.5' 1985 (Provisional edition)  
 T28N, R7W, Section 20  
 Rio Arriba County, NM

STATES GEOLOGICAL SURVEY  
 USGS, NOS. NOAA  
 S TAKEN ..... 1977  
 1981. MAP EDITED ..... 1985  
 ..... TRANSVERSE MERCATOR  
 ERSE MERCATOR ..... ZONE 13  
 ..... NEW MEXICO, CENTRAL  
 ..... AND WEST ZONES  
 ..... 1°32' WEST  
 ..... 13° EAST  
 AL GEODETIC VERTICAL DATUM OF 1929  
 ..... 1927 NORTH AMERICAN DATUM  
 rth American Datum of 1983,  
 shown by dashed corner ticks  
 :)  
 s within the boundaries of any

**PROVISIONAL MAP**  
 Produced from original  
 manuscript drawings. Infor-  
 mation shown as of date of

CONTOUR INTERVAL

**Figure 2. Project area**  
 USGS Delgadita Mesa, NM  
 7.5' 1985 (Provisional edition)  
 T28N, R7W, Section 20  
 Rio Arriba County, NM

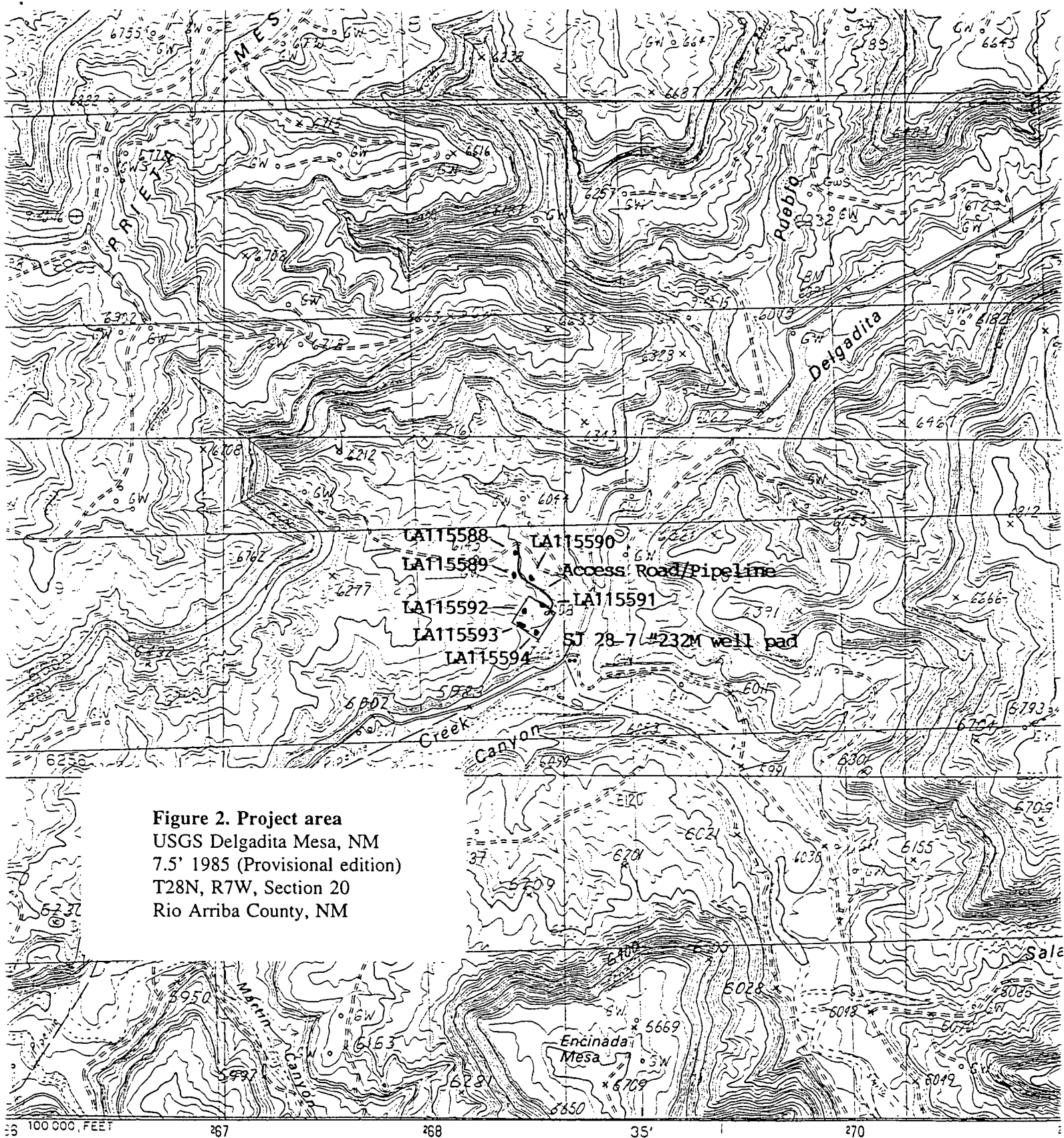

100 000, FEET 267 268 35' 270

STATES GEOLOGICAL SURVEY  
 USGS, NOS/NOAA  
 TAKEN 1977  
 1981. MAP EDITED 1985  
 TRANSVERSE MERCATOR  
 MERCATOR ZONE 13  
 NEW MEXICO, CENTRAL  
 AND WEST ZONES  
 1°32' WEST  
 13° EAST  
 GEODETIC VERTICAL DATUM OF 1929  
 1927 NORTH AMERICAN DATUM  
 North American Datum of 1983,  
 shown by dashed corner ticks  
 within the boundaries of any

NORTH

SCALE 1:2  
 1000 0 1000 2000 3000  
 1 5 0

CONTOUR INTERVAL

**PROVISIONAL MAP**  
 Produced from original  
 manuscript drawings. Infor-  
 mation shown as of date of

3

**LA PLATA ARCHAEOLOGICAL CONSULTANTS**

26851 County Road P, Dolores, Colorado 81323

Office Phone: (970) 565-8708

Fax Phone: (970) 882-2224

January 14, 1997

Mr. Ellis Gray  
Conoco Incorporated  
10 Desta Drive, Suite 550E  
Midland, TX 79705-4500

**RECEIVED**

**JAN 21 1997**

**CONOCO  
ROW&C**

RE: San Juan 28-7 No. 232M well location

Dear Mr. Gray:

The SJ 28-7 No. 232M well pad was staked by NCE surveys and examined by Fred Harden of our office in November, 1996. Prior to the staking, it was noted that one fairly large, previously recorded archaeological site (NM-01-32135) was situated within the legal window for this location. Although the site was not rerecorded or reexamined, it probably overlaps the most feasible spot to construct a well location. Consequently, the well was staked further to the northeast in an area where several smaller archaeological sites exist. A total of eight archaeological sites were encountered and recorded in the vicinity of the actual staked well pad and access road and these are described in the archaeological report for this well location (LAC Report 9642d). The eight sites are fairly evenly distributed around the four sides of the well pad and on both sides of the proposed access road.

Given the high density of archaeological sites that are located specifically in proximity to the staked location, the known large site previously recorded to the southwest of the staked location, and the probable high density of other sites expected to be within this locale, it is not likely that another well location could be found and staked without encountering problems with the presence of archaeological sites. Due to these circumstances, it is unlikely that another well location can be found within the SE $\frac{1}{4}$  of Section 20 that would be better than the currently staked location.

If you have any further questions concerning this well location, please let me know.

Sincerely,

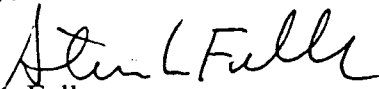
  
Steven L. Fuller

cc: Rueben Sanchez, BLM Farmington  
Deb Bemenderfer, Trigon Engineering



# CONOCO SAN JUAN 28-7 #232M

BLANCO MESA VERDE / BASIN DAKOTA FORMATION GAS WELL  
EXISTING ADJACENT GAS WELLS WITHIN A 1 MILE RADIUS

SE/4 SECTION 20, TOWNSHIP 28 NORTH, RANGE 7 WEST  
RIO ARriba COUNTY, NEW MEXICO

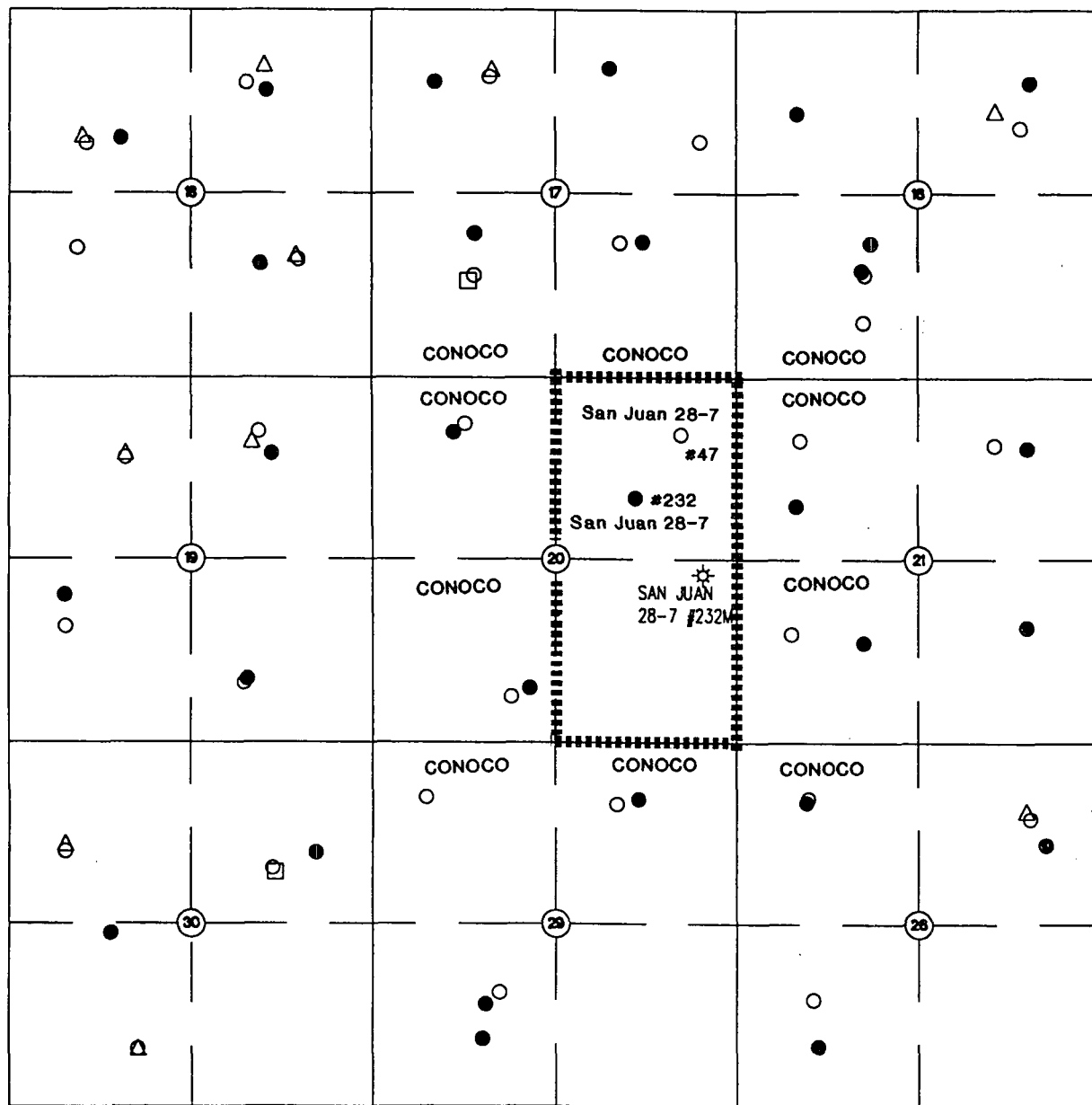

## LEGEND

- BLANCO MESA VERDE FORMATION
- △ BLANCO PICTURED CLIFFS
- BASIN DAKOTA FORMATION
- BASIN FRUITLAND COAL FORMATION
- ★ SAN JUAN 28-7 #232M

SCALE : NTS

REVISION: NONE

DRAWN BY: J. BISLAND

DATE DRAWN: 12/6/96

FILE NAME: 763VADJ

CLIENT



FARMINGTON, NEW MEXICO

PREPARED BY



TRIGON ENGINEERING INC  
DENVER COLORADO  
FARMINGTON NEW MEXICO

CMD :  
OG6IWCM

ONGARD  
INQUIRE WELL COMPLETIONS

04/03/97 18:16:45  
OGOMES -EMEI

API Well No : 30 39 20993 Eff Date : 03-01-1995 WC Status : A  
Pool Idn : 71599 BASIN DAKOTA (PRORATED GAS)  
OGRID Idn : 5073 CONOCO INC  
Prop Idn : 16608 SAN JUAN 28 7 UNIT

Well No : 232  
GL Elevation: 99999

	U/L	Sec	Township	Range	North/South	East/West	Prop/Act (P/A)
	---	---	-----	-----	-----	-----	-----
B.H. Locn : G	20	28N	07W	FTG	999 F S	FTG 999 F E	P

Lot Identifier:

Dedicated Acre: 320.00

Lease Type : F

Type of consolidation (Comm, Unit, Forced Pooling - C/U/F/O) :

M0025: Enter PF keys to scroll

PF01 HELP	PF02	PF03 EXIT	PF04 GoTo	PF05	PF06
PF07	PF08	PF09	PF10 NEXT-WC	PF11 HISTORY	PF12 NXTREC

CMD :  
OG6IWCM

ONGARD  
INQUIRE WELL COMPLETIONS

04/03/97 18:13:27  
OGOMES -EMEI

API Well No : 30 39 7389 Eff Date : 03-01-1995 WC Status : A  
Pool Idn : 72319 BLANCO-MESAVERDE (PRORATED GAS)  
OGRID Idn : 5073 CONOCO INC  
Prop Idn : 16608 SAN JUAN 28 7 UNIT

Well No : 047  
GL Elevation: 99999

	U/L	Sec	Township	Range	North/South	East/West	Prop/Act (P/A)
	---	---	-----	-----	-----	-----	-----
B.H. Locn : A	20	28N	07W	FTG	999 F S	FTG 999 F E	P

Lot Identifier:

Dedicated Acre: 320.00

Lease Type : F

Type of consolidation (Comm, Unit, Forced Pooling - C/U/F/O) :

M0025: Enter PF keys to scroll

PF01 HELP	PF02	PF03 EXIT	PF04 GoTo	PF05	PF06
PF07	PF08	PF09	PF10 NEXT-WC	PF11 HISTORY	PF12 NXTREC



STATE OF NEW MEXICO  
ENERGY, MINERALS AND NATURAL RESOURCES DEPARTMENT

OIL CONSERVATION DIVISION  
2040 S. PACHECO  
SANTA FE, NEW MEXICO 87505  
(505) 827-7131

April 3, 1997

RECEIVED  
APR - 9 1997

OIL CON. DIV.  
DIST. 3

Conoco, Inc.  
10 Desta Drive - Suite 100W  
Midland, Texas 79705-4500  
Attention: Jerry W. Hoover

Administrative Order NSL-3784

Dear Mr. Hoover:

Reference is made to: (i) your original application dated March 20, 1997; (ii) my letter dated March 25, 1997 withdrawing this application; and, (iii) your re-submittal of this application with supplemental data dated March 31, 1997, all of which refer to Conoco's request for an unorthodox "infill" gas well location for both the Blanco-Mesaverde and Basin-Dakota Pools for the proposed San Juan "28-7" Unit Well No. 232-M to be drilled 2425 feet from the South line and 500 feet from the East line (Unit I) of Section 20, Township 28 North, Range 7 West, NMPM, Rio Arriba County, New Mexico.

Production from both pools from said well is to be included to the existing standard 320-acre gas spacing and proration units comprising the E/2 of said Section 20, which the Mesaverde production is currently dedicated to Conoco's San Juan "28-7" Unit Well No. 47 (API No. 30-039-07389), located at a standard gas well location 817 feet from the North line and 838 feet from the East line (Unit A) of said Section 20 and the Dakota production is currently dedicated to the San Juan "28-7" Unit Well No. 232 (API No. 30-039-20993), located at a standard gas well location 1765 feet from the North line and 1490 feet from the East line (Unit G) of said Section 20.

By the authority granted me under the provisions of Rule 2(d) of the "General Rules For The Prorated Gas Pools of New Mexico/Special Rules and Regulations For The Blanco-Mesaverde Pool/Special Rules and Regulations for the Basin-Dakota Pool", as promulgated by Division Order No. R-8170, as amended, the above-described unorthodox "infill" Dakota/Mesaverde gas well location for the San Juan "28-7" Unit Well No. 232-M is hereby approved.

Sincerely,

William J. LeMay  
Director

WJL/MES/kv

cc: Oil Conservation Division - Aztec  
U. S. Bureau of Land Management - Farmington

Post-It™ brand fax transmittal memo 7671

# of pages 1

To	From
DAVE CATANACH	ERNEST BUECH
Co.	Co.
Dept.	Phone #
Fax #	Fax #