

ABOVE THIS LINE FOR DIVISION USE ONLY

NEW MEXICO OIL CONSERVATION DIVISION

- Engineering Bureau -

GCU #242

ADMINISTRATIVE APPLICATION COVERSHEET

THIS COVERSHEET IS MANDATORY FOR ALL ADMINISTRATIVE APPLICATIONS FOR EXCEPTIONS TO DIVISION RULES AND REGULATIONS

Application Acronyms:

[NSP-Non-Standard Proration Unit] [NSL-Non-Standard Location]
 [DD-Directional Drilling] [SD-Simultaneous Dedication]
 [DHC-Downhole Commingling] [CTB-Lease Commingling] [PLC-Pool/Lease Commingling]
 [PC-Pool Commingling] [OLS - Off-Lease Storage] [OLM-Off-Lease Measurement]
 [WFX-Waterflood Expansion] [PMX-Pressure Maintenance Expansion]
 [SWD-Salt Water Disposal] [IPI-Injection Pressure Increase]
 [EOR-Qualified Enhanced Oil Recovery Certification] [PPR-Positive Production Response]

[1] TYPE OF APPLICATION - Check Those Which Apply for [A]

[A] Location - Spacing Unit - Directional Drilling

☒ NSL ☐ NSP ☐ DD ☐ SD

Check One Only for [B] or [C]

[B] Commingling - Storage - Measurement

☐ DHC ☐ CTB ☐ PLC ☐ PC ☐ OLS ☐ OLM

[C] Injection - Disposal - Pressure Increase - Enhanced Oil Recovery

☐ WFX ☐ PMX ☐ SWD ☐ IPI ☐ EOR ☐ PPR

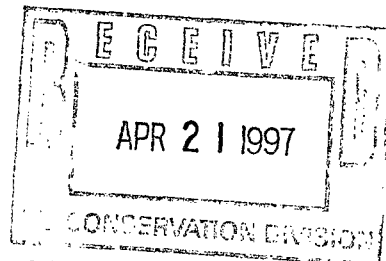

[2] NOTIFICATION REQUIRED TO: - Check Those Which Apply, or ☒ Does Not Apply

[A] ☐ Working, Royalty or Overriding Royalty Interest Owners

UNIT
ALL OFFSETS = AMOCO

[B] ☐ Offset Operators, Leaseholders or Surface Owner

[C] ☐ Application is One Which Requires Published Legal Notice

[D] ☐ Notification and/or Concurrent Approval by BLM or SLO

U.S. Bureau of Land Management - Commissioner of Public Lands, State Land Office

[E] ☐ For all of the above, Proof of Notification or Publication is Attached, and/or,

[F] ☐ Waivers are Attached

[3] INFORMATION / DATA SUBMITTED IS COMPLETE - Statement of Understanding

I hereby certify that I, or personnel under my supervision, have read and complied with all applicable Rules and Regulations of the Oil Conservation Division. Further, I assert that the attached application for administrative approval is accurate and complete to the best of my knowledge and where applicable, verify that all interest (WI, RI, ORRI) is common. I further verify that all applicable API Numbers are included. I understand that any omission of data, information or notification is cause to have the application package returned with no action taken.

Note: Statement must be completed by an individual with supervisory capacity.

PAMELA W. STALEY

Print or Type Name

Pamela W. Staley
Signature

REGULATORY AFFAIRS ENGR.

Title

4/15/97
Date

API Well No : 30 45 11736 Eff Date : 01-01-1900 WC Status : A
Pool Idn : 71599 BASIN DAKOTA (PRORATED GAS)
OGRID Idn : 778 AMOCO PRODUCTION CO
Prop Idn : 570 GALLEGOS CANYON UNIT

Well No : 242
GL Elevation: 99999

	U/L	Sec	Township	Range	North/South	East/West	Prop/Act (P/A)
	---	---	-----	-----	-----	-----	-----
B.H. Locn : F	24	28N	12W	FTG	999 F S	FTG 999 F E	P
Lot Identifier:							
Dedicated Acre: 320.00							
Lease Type : F							
Type of consolidation (Comm, Unit, Forced Pooling - C/U/F/O) :							

M0025: Enter PF keys to scroll

PF01 HELP	PF02	PF03 EXIT	PF04 GoTo	PF05	PF06
PF07	PF08	PF09	PF10 NEXT-WC	PF11 HISTORY	PF12 NXTREC

CMD :
OG5SECT

ONGARD
INQUIRE LAND BY SECTION

04/28/97 09:38:27
OGOMES -EMGN
PAGE NO: 1

Sec : 24 Twp : 28N Rng : 12W Section Type : NORMAL

D 40.00 Indian owned U	C 40.00 Federal owned U A	B 40.00 Federal owned U A	A 40.00 Federal owned U A
E 40.00 Indian owned U	F 40.00 Indian owned U A	G 40.00 Federal owned U	H 40.00 Federal owned U

PF01 HELP	PF02	PF03 EXIT	PF04 GoTo	PF05	PF06
PF07 BKWD	PF08 FWD	PF09 PRINT	PF10 SDIV	PF11	PF12



**Amoco Production Company
San Juan Business Unit**

1670 Broadway
Post Office Box 800
Denver, Colorado 80201
303-830-4040

April 15, 1997

Mr. William J. LeMay, Director
New Mexico Oil Conservation Division
2040 S. Pacheco Street
P.O. Box 6429
Santa Fe, NM 87505

**Application For Unorthodox Location
Gallegos Canyon Unit Well No. 242
1850' FWL, 1500' FNL, Unit F Section 24-T28N-R12W
Basin Fruitland Coal Pool
San Juan County, New Mexico**

Amoco Production Company hereby requests administrative approval for an unorthodox well location for the Gallegos Canyon Unit Well No. 242 well in the Basin Fruitland Coal Pool. Amoco plans to recompleteness this well from the Dakota formation to the Basin Fruitland Coal. This well is at an orthodox location for the Dakota, however, the Basin Fruitland Coal Pool Rules require all Fruitland wells to be in the Northeast or Southwest quarter of the section. Because of the recompleteness of this well from the Dakota, it will be in an unorthodox location in the Fruitland. Attached is a copy of the C-102 for the Fruitland Coal formation.

Amoco is the only offset operator in the Fruitland Coal formation, so no notice is necessary to Offset Operators. Attached are plats showing the location of the well, all wells drilled in the area and the C-102 described above. Should you have questions regarding this application, do not hesitate to call me at (303) 830-5344

Pamela W. Staley
Regulatory Affairs Engineer

Attachments

cc: Frank Chavez, Supervisor
NMOCD District III
1000 Rio Brazos Road
Aztec, NM 87410

Mark Yamasaki, Amoco
Nancy Whitaker, Amoco
Irina Mitselmakher, Amoco
Wellfile
Proration Files - NM

APPLICATION FOR APPROVAL OF UNORTHODOX LOCATION UNDER RULE 104-F

**Gallegos Canyon Unit Well No. 242
1850' FWL, 1500' FNL, Unit F Section 24-T28N-R12W
Basin Fruitland Coal Pool**

ATTACHMENTS:

- 9-SECTION PLAT SHOWING LOCATION OF ALL OFFSET WELLS
- FORM C-102 FOR FRUITLAND COAL FORMATION

DISTRICT I
P.O. Box 1980, Hgbbs, NM 88240

DISTRICT II
311 South First., Artesia, NM 88210

DISTRICT III
1000 Rio Brazos Rd., Aztec, NM 87410

DISTRICT IV
2040 South Pacheco, Sante Fe, NM 87505

State of New Mexico
Energy, Minerals and Natural Resources Department

OIL CONSERVATION DIVISION
2040 South Pacheco
Santa Fe, New Mexico 87505

Form C-102
Revised October 18, 1994
Submit to Appropriate District Office
State Lease - 4 Copies
Fee Lease - 3 Copies

WELL LOCATION AND ACREAGE DEDICATION PLAT

API Number 3004511736	Pool Code 71629	Pool Name BASIN FRUITLAND COAL GAS
Property Code 000570	Property Name GALLEGOS CANYON UNIT	Well Number 242
OGRID No. 000778	Operator Name AMOCO PRODUCTION COMPANY	Elevation 5707 RDB

Surface Location

UL or lot no.	Section	Township	Range	Lot. Idn	Feet from the	North/South Line	Feet from the	East/West Line	County
UNIT F	24	28N	12W		1500	NORTH	1850	WEST	San Juan

Bottom Hole Location If Different From Surface

UL or lot no.	Section	Township	Range	Lot. Idn	Feet from the	North/South Line	Feet from the	East/West Line	County

Dedicated Acreage: 320	Joint or Infill	Consolidation Code	Order No.
---------------------------	-----------------	--------------------	-----------

**NO ALLOWABLE WILL BE ASSIGNED TO THIS COMPLETION UNTIL ALL INTERESTS HAVE BEEN CONSOLIDATED
OR A NON-STANDARD UNIT HAS BEEN APPROVED BY THE DIVISION**

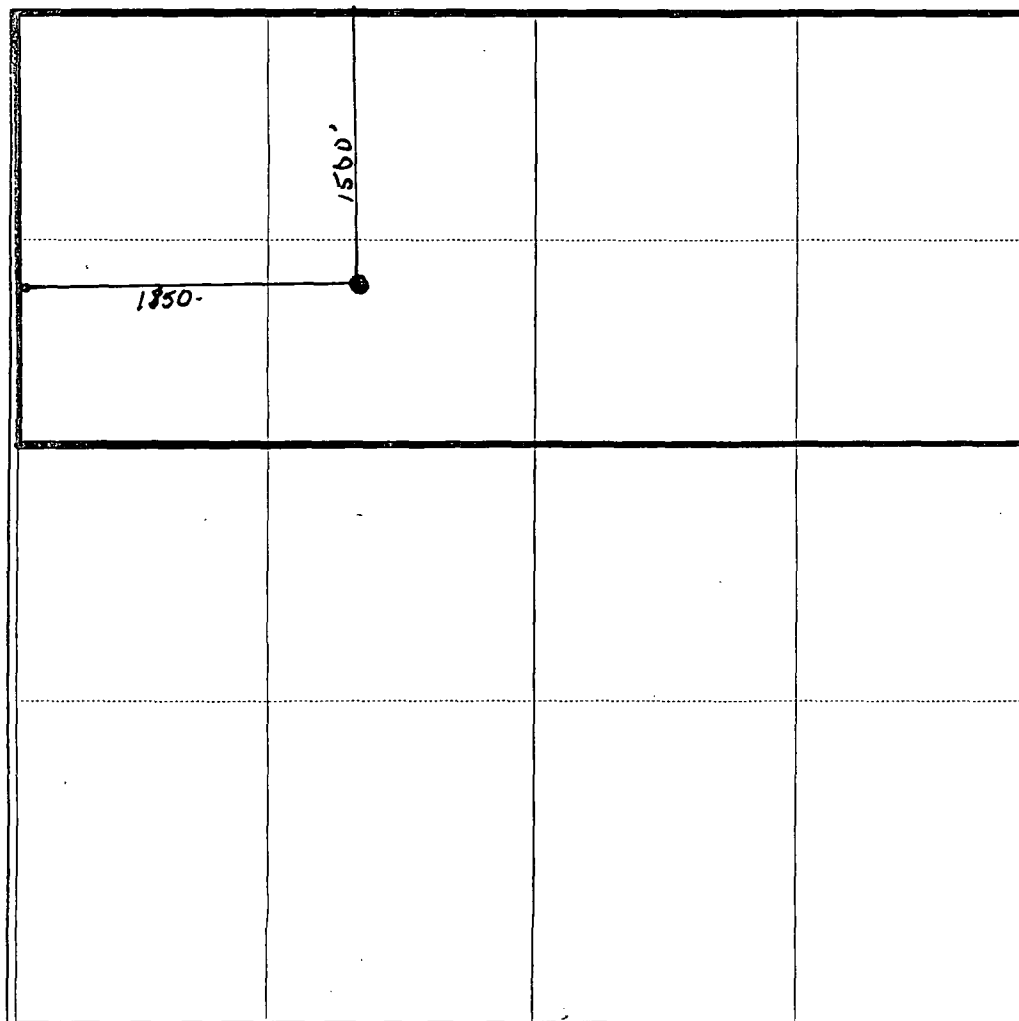

OPERATOR CERTIFICATION

I hereby certify that the information contained herein is true and complete to the best of my knowledge and belief

Signature

Nancy I. Whitaker

Printed Name

Nancy I. Whitaker

Position

Staff Assistant

Date

01/23/1997

SURVEY CERTIFICATION

I hereby certify that the well location shown on this plat was plotted from field notes of actual surveys made by me or under my supervision, and that the same is true and correct to the best of my knowledge and belief.

03/07/1966

Date of Survey

Signature & Seal of Professional Surveyor

JAMES P. LEESE

Certificate No.

1463