

EGO

A
RAND
PAULSON
EXPLORATORY
GAS & OIL
COMPANY

June 18, 1997

State of New Mexico
Oil Conservation Division
2040 South Pacheco
Santa Fe, New Mexico 87505
Attn: Mr. Michael Stogner

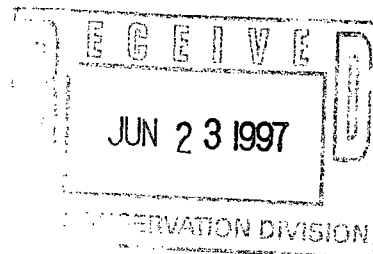

RE: Non Standard Location Exception

Subject: Well Rand Paulson Estacado 27 State #1
Loc SE NE SW/4 Section 27 T-14-S R-34-E
✓API 30-025-33849
✓Pool 31055
Acreage 640 Acre Lease "State"

(Unit K)

This request is to grant approval of the non-standard location. Said well was permitted as a wildcat to test Atoka at $\pm 12500'$. A loss zone was encountered in the Cisco $\pm 10640'$. The well was plugged back and completed in the middle early Wolfcamp $\pm 10360' - 10380'$.

OCD-Hobbs placed this well into a spaced "High Plains; Permo Penn Pool". This pool allows for 660' outer boundary in 160 acre governmental quarter units. The well is located at 145' irregular. Please allow Rand Paulson Oil Company, Inc. a non-standard location exception and inform Rand Paulson Oil Company, Inc. of the daily allowable.

Sincerely,

R. A. Wiesner
Exploration Manager

Encl. plats 1,2

R-2874 - Establish 160-acre spacing
R-2874-C^{Re} - Est. footage requirements
660 Feet From outer boundary of proration unit
& 330 feet to any 1/4 1/4 sec. line.

DISTRICT I
P.O. Box 1980, Hobbs, NM 88241-1980

DISTRICT II
P.O. Drawer DD, Artesia, NM 88211-0719

DISTRICT III
1000 Rio Brazos Rd., Aztec, NM 87410

DISTRICT IV
P.O. BOX 2088, SANTA FE, N.M. 87504-2088

State of New Mexico
Energy, Minerals and Natural Resources Department

Form C-102
Revised February 10, 1994
Submit to Appropriate District Office
State Lease - 4 Copies
Fee Lease - 3 Copies

OIL CONSERVATION DIVISION

P.O. Box 2088
Santa Fe, New Mexico 87504-2088

☐ AMENDED REPORT

WELL LOCATION AND ACREAGE DEDICATION PLAT

| | | |
|---------------------|---|--------------------|
| API Number | Pool Code | Pool Name |
| Property Code | Property Name ESTACADO 27 STATE | Well Number 1 |
| OGRID No. 159123 | Operator Name RAND PAULSON OIL CO., INC. | Elevation 4103' |

Surface Location

| | | | | | | | | | |
|---------------|---------|----------|-------|---------|---------------|------------------|---------------|----------------|--------|
| UL or lot No. | Section | Township | Range | Lot Idn | Feet from the | North/South line | Feet from the | East/West line | County |
| K | 27 | 14 S | 34 E | | 1650 | SOUTH | 2125 | WEST | LEA |

Bottom Hole Location If Different From Surface

| | | | | | | | | | |
|---------------------------|----------------------|--------------------|-----------|---------|---------------|------------------|---------------|----------------|--------|
| UL or lot No. | Section | Township | Range | Lot Idn | Feet from the | North/South line | Feet from the | East/West line | County |
| Dedicated Acres 80/160 | Joint or Infill N | Consolidation Code | Order No. | | | | | | |

NO ALLOWABLE WILL BE ASSIGNED TO THIS COMPLETION UNTIL ALL INTERESTS HAVE BEEN CONSOLIDATED
OR A NON-STANDARD UNIT HAS BEEN APPROVED BY THE DIVISION

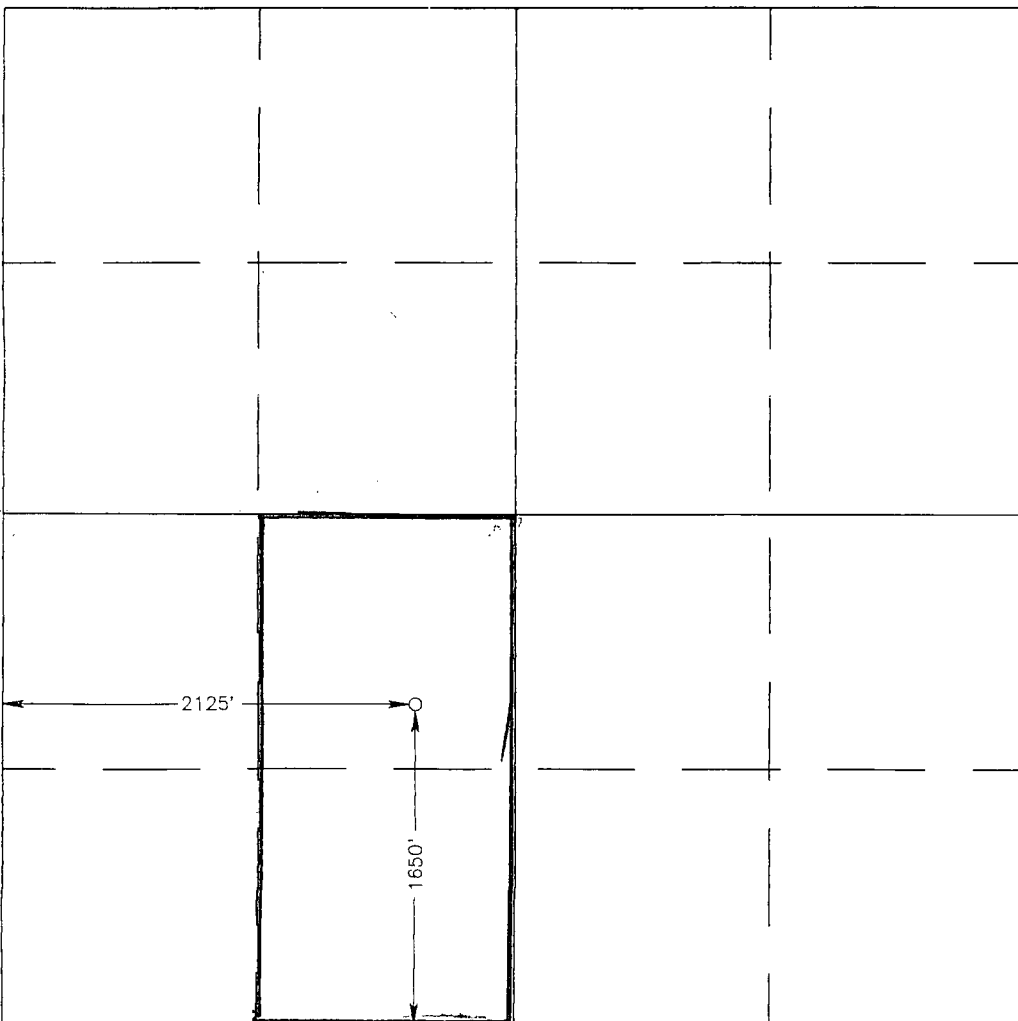
| | |
|---|--|
|  | <p>OPERATOR CERTIFICATION</p> <p>I hereby certify the the information contained herein is true and complete to the best of my knowledge and belief.</p> <p><i>O.H. Routh</i> Signature O.H. ROUTH Printed Name AGENT Title 2-17-97 Date</p> |
| | <p>SURVEYOR CERTIFICATION</p> <p>I hereby certify that the well location shown on this plat was plotted from field notes of actual surveys made by me or under my supervision, and that the same is true and correct to the best of my belief.</p> <p>FEBRUARY 11, 1997</p> <p>Date Surveyed Signature & Seal of Professional Surveyor Professional Surveyor 2-12-97 Certification No. JOHN W. WEST 676 RONALD J. EIDSON 3239 EIDSON 12641</p> |

COUNTY LeaPOOL High Plains ^{Permo} PennsylvanianTOWNSHIP 14 SouthRANGE 34 East

NMPM

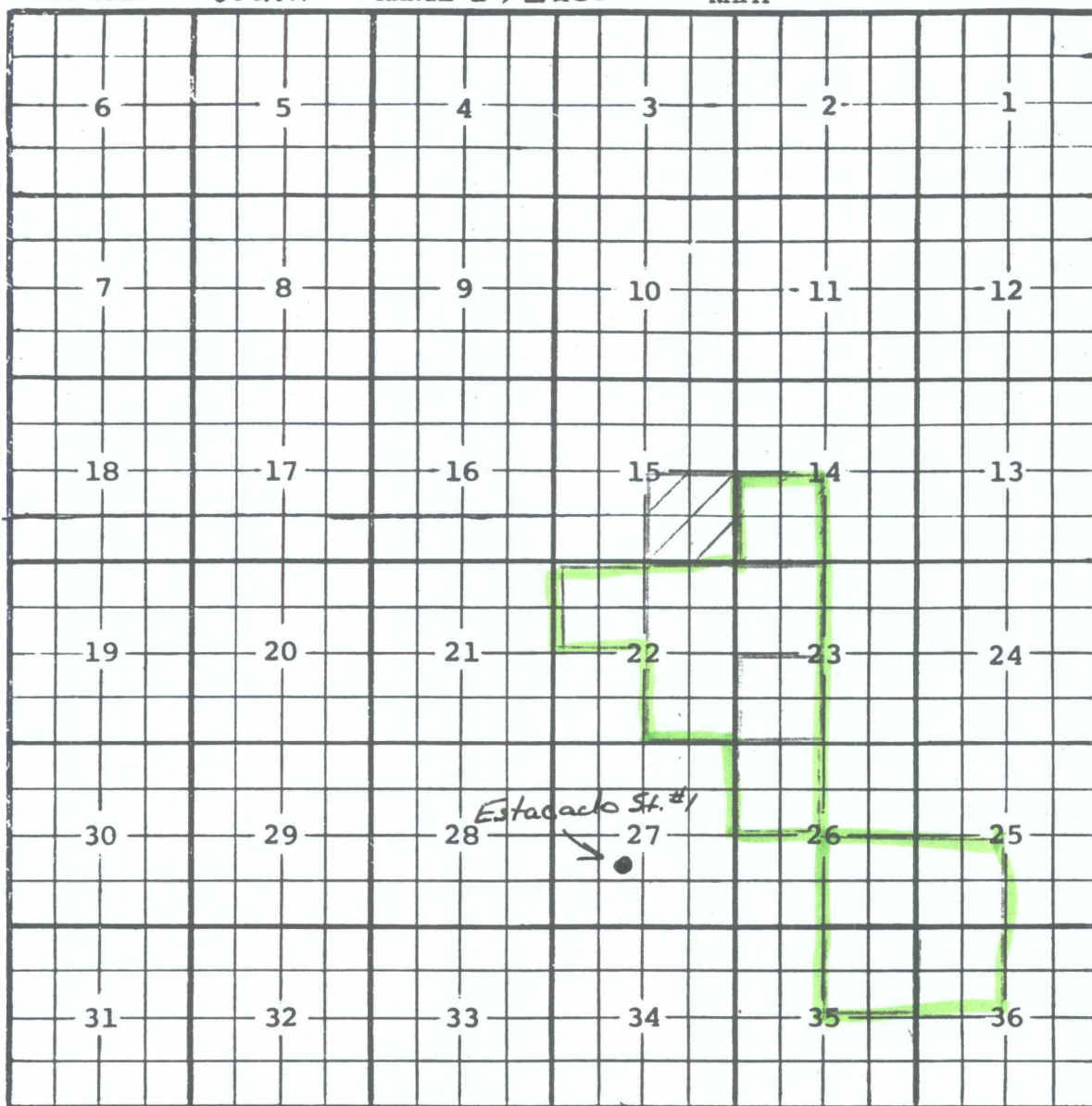
Description: SW 1/4 Sec. 23 (R-2507, 7-1-63)Ext: SW 1/4 Sec. 14; SE 1/4 Sec. 15; E 1/2 Sec. 22; NW 1/4 Sec. 23 (R-2874, 3-5-65)Deletion: SW 1/4 Sec. 14; SE 1/4 Sec. 15 (R-3801, 7-23-69)Ext: SW 1/4 Sec. 14 (R-3995, 8-1-70); Ext: NW 1/4 Sec. 26 (R-4665, 12-1-73)Ext: SW 1/4 Sec. 26 (R-5143, 2-1-76)Extend vertical limits to include Wolfcamp formation and redesignate as High Plains-Permo Pennsylvanian Pool. Ext: NW 1/4 Sec. 22 (A-7763, 1-8-85)Ext: SW 1/4 Sec. 25, SE 1/4 Sec. 26, NW 1/4 Sec. 36 (A-7955, 6-12-85)Ext: NE 1/4 Sec. 35 (A-8149, 2-14-86)

CMD :
OG5SECT

ONGARD
INQUIRE LAND BY SECTION

07/01/97 09:00:31
OGOREJ -EMEL
PAGE NO: 2

Sec : 27 Twp : 14S Rng : 34E Section Type : NORMAL

| | | | |
|------------------|------------------|------------------|------------------|
| L | K | J | I |
| 40.00 | 40.00 | 40.00 | 40.00 |
| CS | CS | CS | CS |
| VA1172 1 04/99 | VA1172 1 04/99 | VA1172 1 04/99 | VA1172 1 04/99 |
| RAND PAULSON OIL | RAND PAULSON OIL | RAND PAULSON OIL | RAND PAULSON OIL |
| | A | | |
| M | N | O | P |
| 40.00 | 40.00 | 40.00 | 40.00 |
| CS | CS | CS | CS |
| VA1172 1 04/99 | VA1172 1 04/99 | VA1172 1 04/99 | VA1172 1 04/99 |
| RAND PAULSON OIL | RAND PAULSON OIL | RAND PAULSON OIL | RAND PAULSON OIL |

| | | | | | |
|-----------|----------|------------|-----------|------|------|
| PF01 HELP | PF02 | PF03 EXIT | PF04 GoTo | PF05 | PF06 |
| PF07 BKWD | PF08 FWD | PF09 PRINT | PF10 SDIV | PF11 | PF12 |

CMD :
OG5SECT

ONGARD
INQUIRE LAND BY SECTION

07/01/97 08:46:07
OGOREJ -EMEL
PAGE NO: 1

Sec : 27 Twp : 14S Rng : 34E Section Type : NORMAL

| | | | |
|--|---|---|---|
| D 40.00 CS VA0998 1 08/98 RAND PAULSON OIL | C 40.00 CS VA0998 1 08/98 RAND PAULSON OIL | B 40.00 CS VA0998 1 08/98 RAND PAULSON OIL | A 40.00 CS VA1172 1 04/99 RAND PAULSON OIL P |
| E 40.00 CS VA0998 1 08/98 RAND PAULSON OIL | F 40.00 CS VA0998 1 08/98 RAND PAULSON OIL A | G 40.00 CS VA0998 1 08/98 RAND PAULSON OIL A | H 40.00 CS VA1172 1 04/99 RAND PAULSON OIL |

| | | | | | |
|-----------|----------|------------|-----------|------|------|
| PF01 HELP | PF02 | PF03 EXIT | PF04 GoTo | PF05 | PF06 |
| PF07 BKWD | PF08 FWD | PF09 PRINT | PF10 SDIV | PF11 | PF12 |

BEFORE THE OIL CONSERVATION COMMISSION
OF THE STATE OF NEW MEXICO

IN THE MATTER OF THE HEARING
CALLED BY THE OIL CONSERVATION
COMMISSION OF NEW MEXICO FOR
THE PURPOSE OF CONSIDERING:

CASE No. 3206
Order No. R-2874
NOMENCLATURE

APPLICATION OF APACHE CORPORATION
FOR A POOL EXTENSION AND SPECIAL
POOL RULES, LEA COUNTY, NEW MEXICO.

ORDER OF THE COMMISSION

BY THE COMMISSION:

This cause came on for hearing at 9 o'clock a.m. on February 10, 1965, at Santa Fe, New Mexico, before Examiner Daniel S. Nutter.

NOW, on this 5th day of March, 1965, the Commission, a quorum being present, having considered the testimony, the record, and the recommendations of the Examiner, and being fully advised in the premises,

FINDS:

(1) That due public notice having been given as required by law, the Commission has jurisdiction of this cause and the subject matter thereof.

(2) That the applicant, Apache Corporation, seeks the extension of the horizontal limits of the High Plains-Pennsylvanian Pool in Lea County, New Mexico, to include the following-described area:

TOWNSHIP 14 SOUTH, RANGE 34 EAST, NMPM

Section 14: SW/4

Section 15: SE/4

Section 22: E/2

Section 23: NW/4

(3) That the horizontal limits of the High Plains-Pennsylvanian Pool should be extended to include the above-described area.

(4) That the applicant also seeks the promulgation of temporary special rules and regulations governing said pool, including a provision for 160-acre spacing units.

(5) That in order to prevent the economic loss caused by the drilling of unnecessary wells, to avoid the augmentation of risk arising from the drilling of an excessive number of wells, to prevent reduced recovery which might result from the drilling of too few wells, and to otherwise prevent waste and protect correlative rights, temporary special rules and regulations providing for 160-acre spacing units should be promulgated for the High Plains-Pennsylvanian Pool.

(6) That the temporary special rules and regulations should provide for limited well locations in order to assure orderly development of the pool and protect correlative rights.

(7) That the temporary special rules and regulations should be established for a one-year period in order to allow the operators in the subject pool to gather reservoir information to establish the area that can be efficiently and economically drained and developed by one well.

(8) That this case should be reopened at an examiner hearing in March, 1966, at which time the operators in the subject pool should be prepared to appear and show cause why the High Plains-Pennsylvanian Pool should not be developed on 80-acre or 40-acre spacing units.

IT IS THEREFORE ORDERED:

(1) That the horizontal limits of the High Plains-Pennsylvanian Pool in Lea County, New Mexico, are hereby extended to include the following-described area:

TOWNSHIP 14 SOUTH, RANGE 34 EAST, NMPM

Section 14: SW/4

Section 15: SE/4

Section 22: E/2

Section 23: NW/4

(2) That temporary Special Rules and Regulations for the High Plains-Pennsylvanian Pool are hereby promulgated as follows:

SPECIAL RULES AND REGULATIONS
FOR THE
HIGH PLAINS-PENNSYLVANIAN POOL

RULE 1. Each well completed or recompleted in the High Plains-Pennsylvanian Pool or in the Pennsylvanian formation within one mile thereof, and not nearer to or within the limits of another designated Pennsylvanian pool, shall be spaced, drilled, operated, and produced in accordance with the Special Rules and Regulations hereinafter set forth.

RULE 2. Each well shall be located on a standard unit containing 160 acres, more or less, comprising a governmental quarter section.

RULE 3. The Secretary-Director of the Commission may grant an exception to the requirements of Rule 2 without notice and hearing when an application has been filed for a non-standard unit consisting of less than 160 acres or the unorthodox size or shape of the tract is due to a variation in the legal subdivision of the United States Public Land Surveys. All operators offsetting the proposed non-standard unit shall be notified of the application by registered or certified mail, and the application shall state that such notice has been furnished. The Secretary-Director may approve the application upon receipt of written waivers from all offset operators or if no offset operator has entered an objection to the formation of the non-standard unit within 30 days after the Secretary-Director has received the application.

RULE 4. Each well shall be located within 150 feet of the center of either the northeast quarter or the southwest quarter of a governmental quarter section.

RULE 5. The Secretary-Director may grant an exception to the footage requirements of Rule 4 without notice and hearing when an application has been filed for an unorthodox location necessitated by topographical conditions or the recompletion of a well previously drilled to another horizon, provided the well will be located no nearer than 330 feet to the outer boundary of the unit. All operators offsetting the proposed unorthodox location shall be notified of the application by registered or certified mail, and the application shall state that such notice has been

-4-

CASE No. 3206

Order No. R-2874

furnished. The Secretary-Director may approve the application upon receipt of written waivers from all offset operators or if no offset operator has entered an objection to the unorthodox location within 20 days after the Secretary-Director has received the application.

RULE 6. A standard proration unit (158 through 162 acres) shall be assigned a 160-acre proportional factor of 7.67 for allowable purposes, and in the event there is more than one well on a 160-acre proration unit, the operator may produce the allowable assigned to the unit from the wells on the unit in any proportion.

The allowable assigned to a non-standard proration unit shall bear the same ratio to a standard allowable as the acreage in such non-standard unit bears to 160 acres.

IT IS FURTHER ORDERED:

(1) That any well presently drilling to or completed in the High Plains-Pennsylvanian Pool or in the Pennsylvanian formation within one mile thereof that will not comply with the well location requirements of Rule 4 is hereby granted an exception to the requirements of said rule. The operator shall notify the Hobbs District Office of the Commission in writing of the name and location of the well on or before April 1, 1965.

(2) That each well presently drilling to or completed in the High Plains-Pennsylvanian Pool or in the Pennsylvanian formation within one mile thereof shall receive a 40-acre allowable until a Form C-102 dedicating 160 acres to the well has been filed with the Commission.

(3) That this case shall be reopened at an examiner hearing in March, 1965, at which time the operators in the subject pool may appear and show cause why the High Plains-Pennsylvanian Pool should not be developed on 80-acre or 40-acre spacing units.

(4) That jurisdiction of this cause is retained for the entry of such further orders as the Commission may deem necessary.

-5-

CASE No. 3206

Order No. R-2874

DONE at Santa Fe, New Mexico, on the day and year herein-
above designated.

STATE OF NEW MEXICO
OIL CONSERVATION COMMISSION

JACK M. CAMPBELL, Chairman

GUYTON B. HAYS, Member

A. L. PORTER, Jr., Member & Secretary

S E A L

esr/

BEFORE THE OIL CONSERVATION COMMISSION
OF THE STATE OF NEW MEXICO

IN THE MATTER OF THE HEARING
CALLED BY THE OIL CONSERVATION
COMMISSION OF NEW MEXICO FOR
THE PURPOSE OF CONSIDERING:

CASE No. 3206
Order No. R-2874-A

APPLICATION OF APACHE CORPORATION
FOR A POOL EXTENSION AND SPECIAL
POOL RULES, LEA COUNTY, NEW MEXICO.

Also see

R-2874-B

R-2874

R-2874-C

ORDER OF THE COMMISSION

BY THE COMMISSION:

This cause came on for hearing at 9 a.m. on March 9, 1966,
at Santa Fe, New Mexico, before Examiner Elvis A. Utz.

NOW, on this 16th day of March, 1966, the Commission, a
quorum being present, having considered the testimony, the record,
and the recommendations of the Examiner, and being fully advised
in the premises,

FINDS:

- (1) That due public notice having been given as required by
law, the Commission has jurisdiction of this cause and the subject
matter thereof.
- (2) That by Order No. R-2874, dated March 5, 1965, temporary
Special Rules and Regulations were promulgated for the High Plains-
Pennsylvanian Pool, Lea County, New Mexico.
- (3) That pursuant to the provisions of Order No. R-2874,
this case was reopened to allow the operators in the subject pool
to appear and show cause why the High Plains-Pennsylvanian Pool
should not be developed on 80-acre or 40-acre spacing units.
- (4) That the temporary Special Rules and Regulations for
the High Plains-Pennsylvanian Pool, promulgated by Order No.
R-2874, should be continued in effect for an additional one-year
period in order to allow the operators in the subject pool

-2-

CASE No. 3206

Order No. R-2874-A

sufficient time to gather additional information concerning the reservoir characteristics of the pool.

(5) That this case should be reopened at an examiner hearing in March, 1967, at which time the applicant and all interested parties should appear and show cause why the High Plains-Pennsylvanian Pool should not be developed on 80-acre or 40-acre spacing units.

IT IS THEREFORE ORDERED:

(1) That the temporary Special Rules and Regulations for the High Plains-Pennsylvanian Pool promulgated by Order No. R-2874 are hereby continued in full force and effect for an additional one-year period.

(2) That this case shall be reopened at an examiner hearing in March, 1967, at which time the applicant and all interested parties may appear and show cause why the High Plains-Pennsylvanian Pool should not be developed on 80-acre or 40-acre spacing units.

(3) That jurisdiction of this cause is retained for the entry of such further orders as the Commission may deem necessary.

DONE at Santa Fe, New Mexico, on the day and year hereinabove designated.

STATE OF NEW MEXICO
OIL CONSERVATION COMMISSION

JACK M. CAMPBELL, Chairman

GUYTON B. HAYS, Member

A. L. PORTER, Jr., Member & Secretary

S E A L

esr/

BEFORE THE OIL CONSERVATION COMMISSION
OF THE STATE OF NEW MEXICO

IN THE MATTER OF THE HEARING
CALLED BY THE OIL CONSERVATION
COMMISSION OF NEW MEXICO FOR
THE PURPOSE OF CONSIDERING:

CASE No. 3206
Order No. R-2874-B

APPLICATION OF APACHE CORPORATION
FOR A POOL EXTENSION AND SPECIAL
POOL RULES, LEA COUNTY, NEW MEXICO.

*See Also
Order No.
R-2874-
R-2874-A
R-2874-C*

ORDER OF THE COMMISSION

BY THE COMMISSION:

This cause came on for hearing at 9 a.m. on March 8, 1967,
at Santa Fe, New Mexico, before Examiner Daniel S. Nutter.

NOW, on this 14th day of March, 1967, the Commission, a
quorum being present, having considered the testimony, the record,
and the recommendations of the Examiner, and being fully advised
in the premises,

FINDS:

(1) That due public notice having been given as required by
law, the Commission has jurisdiction of this cause and the subject
matter thereof.

(2) That by Order No. R-2874, dated March 5, 1965, temporary
Special Rules and Regulations were promulgated for the High Plains-
Pennsylvanian Pool, Lea County, New Mexico.

(3) That by Order No. R-2874-A, dated March 16, 1966, said
temporary Special Rules and Regulations were continued in full
force and effect for an additional one-year period.

(4) That pursuant to the provisions of Order No. R-2874-A,
this case was reopened to allow the operators in the subject pool
to appear and show cause why the High Plains-Pennsylvanian Pool
should not be developed on 80-acre or 40-acre spacing units.

(5) That the evidence establishes that one well in the High
Plains-Pennsylvanian Pool can efficiently and economically drain
and develop 160 acres.

(6) That the Special Rules and Regulations promulgated by Orders Nos. R-2874 and R-2874-A have afforded and will afford to the owner of each property in the pool the opportunity to produce his just and equitable share of the oil in the pool.

(7) That in order to prevent the economic loss caused by the drilling of unnecessary wells, to avoid the augmentation of risk arising from the drilling of an excessive number of wells, to prevent reduced recovery which might result from the drilling of too few wells, and to otherwise prevent waste and protect correlative rights, the Special Rules and Regulations promulgated by Orders Nos. R-2874 and R-2874-A should be continued in full force and effect until further order of the Commission.

IT IS THEREFORE ORDERED:

(1) That the Special Rules and Regulations governing the High Plains-Pennsylvanian Pool, promulgated by Orders Nos. R-2874 and R-2874-A, are hereby continued in full force and effect until further order of the Commission.

(2) That jurisdiction of this cause is retained for the entry of such further orders as the Commission may deem necessary.

DONE at Santa Fe, New Mexico, on the day and year hereinabove designated.

STATE OF NEW MEXICO
OIL CONSERVATION COMMISSION

DAVID F. CARGO, Chairman

GUYTON B. HAYS, Member

A. L. PORTER, Jr., Member & Secretary

S E A L

esr/

STATE OF NEW MEXICO
ENERGY AND MINERALS DEPARTMENT
OIL CONSERVATION DIVISION

IN THE MATTER OF THE HEARING
CALLED BY THE OIL CONSERVATION
DIVISION FOR THE PURPOSE OF
CONSIDERING:

CASE NO. 8701
Order No. R-2874-C

APPLICATION OF WAYNE NEWKUMET FOR
AMENDMENT OF DIVISION ORDER NO.
R-2874, AS AMENDED, LEA COUNTY,
NEW MEXICO.

*See Also Division
Order Nos. R-2874
R-2874-A
R-2874-B*

ORDER OF THE DIVISION

BY THE DIVISION:

This cause came on for hearing at 8 a.m. on September 11, 1985, at Santa Fe, New Mexico, before Examiner Gilbert P. Quintana.

NOW, on this 27th day of September, 1985, the Division Director, having considered the testimony, the record, and the recommendations of the Examiner, and being fully advised in the premises,

FINDS THAT:

- (1) Due public notice having been given as required by law, the Division has jurisdiction of this cause and the subject matter thereof.
- (2) The applicant, Wayne Newkumet, is the owner of substantial interests in the High Plains Permo-Pennsylvanian Pool, Lea County, New Mexico.
- (3) The applicant seeks the amendment of the Special Pool Rules for the High Plains Permo-Pennsylvanian Pool, as promulgated by Division Order No. R-2874, as amended, to permit certain flexibility in the location of wells drilled to and completed in said pool, which is in the late stage of development.
- (4) Rule 4 of the special pool rules requires that wells drilled to and completed in the subject pool be located within 150 feet of the center of the northeast quarter or the southwest quarter of a governmental quarter section.

(5) Specified quarter-quarter sections for the location of wells in 160-acre spaced pools are satisfactory during the early development, particularly through the fairway, of a pool but do not provide sufficient flexibility to maximize additional drilling of the perimeter of the pool during later stages of development.

(6) The applicant proposes that Rule 4 of the special rules for the subject pool be amended to read in its entirety as follows:

"RULE 4. Each well shall be located no nearer than 660 feet to the outer boundary of the proration unit nor nearer than 330 feet to any governmental quarter-quarter section line."

(7) The amendment of Rule 4 of the Special Rules and Regulations for the High Plains Permo-Pennsylvanian Pool as described in Finding No. (6) above will not violate correlative rights nor cause waste, but will in fact prevent waste by permitting additional wells to be drilled and additional reserves to be produced, and should be approved.

IT IS THEREFORE ORDERED THAT:

(1) Rule 4 of the Special Rules and Regulations for the High Plains Permo-Pennsylvanian Pool as promulgated by Division Order No. R-2874, as amended, is hereby amended to read in its entirety as follows:

"RULE 4. Each well shall be located no nearer than 660 feet to the outer boundary of the proration unit nor nearer than 330 feet to any governmental quarter-quarter section line."

(2) Jurisdiction of this cause is retained for the entry of such further orders as the Division may deem necessary.

DONE at Santa Fe, New Mexico, on the day and year hereinabove designated.

STATE OF NEW MEXICO
OIL CONSERVATION DIVISION

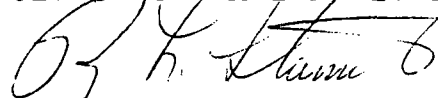

R. L. STAMETS
Director

S E A L
fd/

PETROLEUM INFORMATION/DWIGHTS MIDLAND REGION REPORT

SECTION III - 07/07/97

PAGE

NEW MEXICO DRILLING PROGRESS LEA COUNTY CONTINUED

| | | | |
|---|---|--|------------|
| COBRA O&G 1 STATE '3' API 30-025-33721 CONTR: ZIADRIL INC, RIG #7; SPUD: 12/15/96, DST # 1, TITE; DRLG COMMENTS: MAY CONVERT TO WDW RIG REL: 02/02/97; ... 12324 TD, SI EVAL (LDIR 05/28/97) | 3-10S-36E 2310 FNL 1650 FWL SEC IC 300257069796 | CROSSROADS SOUTH; 12500 DEVONIAN, (FR 12/11/96MD) OPER ADD: BOX 8206, WICHITA FALLS, TX, 76307-8206 PHONE (817) 723-4331; EL: 4021 GR; LOCATION DATA: 6 MI SE CROSSROADS, NM; (VERTICAL) CONTR: DRLG COMMENTS: MAY CONVERT TO WDW RIG REL: 02/02/97; ... 12324 TD, SI EVAL (LDIR 05/28/97) | D |
| TIPPERARY O&G 1 TIPPERARY '22' STATE API 30-025-28799-0001 | 22-11S-33E 660 FNL 1980 FWL SEC IC 300257043696 | WILDCAT; 11300 DEVONIAN, (FR 08/12/96MD) OPER ADD: 800 N MARIENFELD, STE 100, MIDLAND, TX, 79701 PHONE (915) 683-5203; EL: 4259 GR; LOCATION DATA: 7 MI SE CAPROCK, NM .25 MI N/9102 (PSLVU) OIL PROD IN LEA FIELD; (VERTICAL) OWDD: OLD INFO: FORMERLY TIPPERARY O&G 1 TIPPERARY '22' STATE. ELEV 4259 GR. SPUD 7/11/84. 13 3/8 @ 375 SX, 9 5/8 3750 W/600 SX, 7 @ 10658 W/1200 SX. OTD 10660. PB 10253. COMP 10/31/84. IPP 28 BO, 75 BWPD. PROD ZONE: PENNSYLVANIAN UPPER 9258-9900; | WDD |
| LOC; | | | |
| COX JOHN L 1 STATE '14' API 30-025-33817 | 14-12S-33E 1310 FSL 1310 FEL SEC IC 300257010297 | HIGHTOWER; 11200 DEVONIAN, (FR 02/06/97MD) OPER ADD: BOX 2217, MIDLAND, TX, 79702 PHONE (915) 682-9435; EL: 4244 GR; LOCATION DATA: 11 MI SE CAPROCK, NM; (VERTICAL) | D |
| CONTR: ZIADRIL INC, RIG #7; SPUD: 03/27/97, CSG: 13 3/8 @ 285 W/500 SX, 8 5/8 @ 4125 W/900 SX; DST # 1 8635-8709, OP 30 MIN, SI 1 HR, OP 1 HR, REC: 180 FT SGCM, IFP 146, FFP 188, IFP 83, FFP 146, ISIP 419, FSIP 755, DST # 2 9280-9340, OP 30 MIN, SI 1 HR, OP 1 HR, SI 2 HR, REC: 180 FT SGCM, IFP 131, FFP 99, IFP 99, FFP 101, ISIP 137, FSIP 138, DST # 3, NO DETAILS; SET WHIPSTOCK @ 5625 PB & DRLD OFF RIG REL: 06/03/97; ... 11161 TD, D&A 6/3/97 (LDIR 06/06/97) | | | |
| J P H OIL 1 FIELD API 30-025-33892 | 22-12S-38E 990 FSL 1650 FEL SEC IC 300257022397 | WILDCAT; 12200, (FR 03/27/97MD) OPER ADD: BOX 565, LOVINGTON, NM, 88260 PHONE (505) 396-2837; EL: 3798 GR; LOCATION DATA: 6 MI E GLADIOLA, NM 1 MI SE/9510 (WFMP) OIL PROD IN UNNAMED FIELD; (VERTICAL) | WD |
| LOC; | | | |
| J P H OIL 1 HODGE J P API 30-025-33492 | 27-12S-38E 550 FSL 430 FWL SEC IC 300257035896 | WILDCAT; 12200, (FR 07/02/96MD) OPER ADD: BOX 565, LOVINGTON, NM, PHONE (505) 396-2837; EL: 3805 GR; LOCATION DATA: 6 MI E GLADIOLA, NM APPROX 1200 FT E/9560 (WFMP) OIL PROD IN UNNAMED FLD; (VERTICAL) | WD |
| LOC; | | | |
| J & G ENTERPRISE 1 RESISTOL API 30-025-00210-0001 | 3-13S-32E 653 FNL 1980 FWL SEC IC 300257038997 | WILDCAT; 11250 MORROW, (FR 06/16/97MD) OPER ADD: BOX 100, ARTESIA, NM, 88211 PHONE (505) 746-9680; EL: 4337 GR; LOCATION DATA: 12 MI S CAPROCK, NM 1.50 MI SW/11204 (ATOK) OIL PROD IN UNNAMED FLD; (VERTICAL) OWWO: OLD INFO: FORMERLY AMERADA HESS CORP, 1 STATE-CAPROCK B. ELEV 4347 DF. SPUD 1/14/62. 13 3/8 @ 348 W/350 SX, 8 5/8 @ 3755 W/1500 SX. LOG TOPS: MISSISSIPPIAN LOWER 11640, WOODFORD SH 12208, DEVONIAN 12268. OTD 12440. COMP 4/2/62. D&A; | WDX |
| LOC; | | | |
| RAND PAULSON OIL 1 ESTACADO '14' STATE API 30-025-34002 | 14-14S-34E 1980 FNL 1980 FEL SEC IC 300257038297 | WILDCAT; 12500 ATOKA, (FR 06/09/97MD) (ST APPD PMT: 06/06/97) OPER ADD: 4950 N OCONNOR BLVD, STE 270, IRVING, TX, 75062 PHONE (972) 717-9796; EL: 4097 GR; LOCATION DATA: 24 MI SE CAPROCK, NM 1 MI NE/10438 (WFMP) OIL PROD IN LEA FIELD; (VERTICAL) | WD |
| CONTR: TMBR SHARP DRLG, RIG #23; SPUD: 06/06/97, CSG: 13 3/8 @ 450; ... DRLG AHEAD (LDIR 06/26/97) | | | |
| RAND PAULSON OIL 1 ESTACADO '27' STATE API 30-025-33849 | 27-14S-34E 1650 FSL 2125 FWL SEC IC 300257015097 | WILDCAT; 12500 ATOKA, (FR 03/03/97MD) (ST APPD PMT: 02/28/97) OPER ADD: 4950 N OCONNOR BLVD, STE 270, IRVING, TX, 75062 PHONE (214) 717-9796; EL: 4103 GR; LOCATION DATA: 26 MI SE CAPROCK, NM .75 MI NE/10428 (PSLV) OIL PROD IN TRES PAPALOTES FIELD; (VERTICAL) | WD |
| CONTR: TMBR SHARP DRLG, RIG #24; SPUD: 03/06/97, CSG: 13 3/8 @ 443, 5 1/2 @ 10639; DST # 1, NO DETAILS DST # 2, NO DETAILS; RIG REL: 04/05/97; PROD TEST(S): PERF, 10448-10482, W/36 SHOTS, ACID (10448-10482) W/ 750 GALS, F 600 BOPD, 24 HR, ... 10639 TD, WO STATE FORMS (LDIR 06/20/97) | | | |
| RAND PAULSON OIL 2 ESTACADO '27' STATE API 30-025-33922 | 27-14S-34E 2040 FNL 2040 FEL SEC IC 300257025897 | WILDCAT; 12500 ATOKA, (FR 04/14/97MD) (ST APPD PMT: 04/11/97) OPER ADD: 4950 N OCONNOR BLVD, STE 270, IRVING, TX, 75062 PHONE (214) 717-9796; EL: 4104 GR; LOCATION DATA: 26 MI SE CAPROCK, NM .75 MI SW/10463 (PSLV) OIL PROD IN HIGH PLAINS FLD; (VERTICAL) | WD |
| CONTR: TMBR SHARP DRLG, RIG #24; SPUD: 04/08/97, CSG: 13 3/8 @ 400, 8 5/8 @ 6180, 5 1/2 @ 10650; DST # 1, NO DETAILS DST # 2, NO DETAILS; RIG REL: 05/25/97; PROD TEST(S): PERF (WOLFCAMP B) 10457-10514 W/72 SHOTS, ACID (10457-10514) W/ 3750 GALS, SWBD SWTR W/SSO ... 12700 TD, PB 10650, WOO (LDIR 06/11/97) | | | |
| RAND PAULSON OIL 3 ESTACADO '27' STATE API 30-025-33923 | 27-14S-34E 1980 FNL 1980 FWL SEC IC 300257025997 | WILDCAT; 12500 ATOKA, (FR 04/14/97MD) (ST APPD PMT: 04/11/97) OPER ADD: 4950 N OCONNOR BLVD, STE 270, IRVING, TX, 75062 PHONE (214) 717-9796; EL: 4106 GR; LOCATION DATA: 26 MI SE CAPROCK, NM .75 MI NE/10428 (PSLV) OIL PROD IN TRES PAPALOTES FLD; (VERTICAL) | WD |
| CONTR: DEL MAR DRLG, RIG #6; SPUD: 04/29/97, CSG: 13 3/8 @ 400, 8 5/8 @ 6193; DRLG PROBLEMS GOT STUCK IN RDBD, REC FISH ... DRLG 11699 (LDIR 06/26/97) | | | |