

DATE IN 7/28/08	SUSPENSE	ENGINEER Brooks	LOGGED IN 7/29/08	TYPE SD	APP NO. PKVR0821132411
-----------------	----------	-----------------	-------------------	---------	------------------------

ABOVE THIS LINE FOR DIVISION USE ONLY

NEW MEXICO OIL CONSERVATION DIVISION
 - Engineering Bureau -
 1220 South St. Francis Drive, Santa Fe, NM 87505



EOG Resources Inc
 Brazos B 11 FDR # 1H
 24

ADMINISTRATIVE APPLICATION CHECKLIST

THIS CHECKLIST IS MANDATORY FOR ALL ADMINISTRATIVE APPLICATIONS FOR EXCEPTIONS TO DIVISION RULES AND REGULATIONS WHICH REQUIRE PROCESSING AT THE DIVISION LEVEL IN SANTA FE

Application Acronyms:

[NSL-Non-Standard Location] [NSP-Non-Standard Proration Unit] [SD-Simultaneous Dedication]
[DHC-Downhole Commingling] [CTB-Lease Commingling] [PLC-Pool/Lease Commingling]
[PC-Pool Commingling] [OLS - Off-Lease Storage] [OLM-Off-Lease Measurement]
[WFX-Waterflood Expansion] [PMX-Pressure Maintenance Expansion]
[SWD-Salt Water Disposal] [IPI-Injection Pressure Increase]
[EOR-Qualified Enhanced Oil Recovery Certification] [PPR-Positive Production Response]

[1] TYPE OF APPLICATION - Check Those Which Apply for [A]

[A] Location - Spacing Unit - Simultaneous Dedication
☐ NSL ☐ NSP ☒ SD

Check One Only for [B] or [C]

[B] Commingling - Storage - Measurement
☐ DHC ☐ CTB ☐ PLC ☐ PC ☐ OLS ☐ OLM

[C] Injection - Disposal - Pressure Increase - Enhanced Oil Recovery
☐ WFX ☐ PMX ☐ SWD ☐ IPI ☐ EOR ☐ PPR

[D] Other: Specify _____

[2] NOTIFICATION REQUIRED TO: - Check Those Which Apply, or Does Not Apply

[A] ☐ Working, Royalty or Overriding Royalty Interest Owners

[B] ☐ Offset Operators, Leaseholders or Surface Owner

[C] ☐ Application is One Which Requires Published Legal Notice

[D] ☐ Notification and/or Concurrent Approval by BLM or SLO
 U.S. Bureau of Land Management - Commissioner of Public Lands, State Land Office

[E] ☐ For all of the above, Proof of Notification or Publication is Attached, and/or,

[F] ☐ Waivers are Attached

[3] SUBMIT ACCURATE AND COMPLETE INFORMATION REQUIRED TO PROCESS THE TYPE OF APPLICATION INDICATED ABOVE.

[4] CERTIFICATION: I hereby certify that the information submitted with this application for administrative approval is **accurate** and **complete** to the best of my knowledge. I also understand that **no action** will be taken on this application until the required information and notifications are submitted to the Division.

Note: Statement must be completed by an individual with managerial and/or supervisory capacity.

Ocean Munds-Dry
 Print or Type Name

Ocean Munds-Dry
 Signature

Attorney
 Title

7-28-08
 Date

omundsdry@hollandhart.com
 e-mail Address

RECEIVED
 2008 JUL 28 PM 2 01



July 28, 2008

HAND-DELIVERED

Mark E. Fesmire, P. E.
Director
Oil Conservation Division
New Mexico Department of Energy,
Minerals and Natural Resources
1220 South Saint Francis Drive
Santa Fe, New Mexico 87505

Re: Application of EOG Resources, Inc. to amend Administrative Order SD-2007-22 for Administrative Approval of the Simultaneous Dedication of the S/2 of Section 11, Township 16 South, Range 24 East, N.M.P.M., Eddy County, New Mexico to its proposed Brazos "B" 11 Fee Well No. 2H and the existing Brazos "B" 11 Fee Well No. 1H.

Dear Mr. Fesmire:

EOG Resources, Inc. seeks administrative approval to amend Administrative Order SD-2007-22 which approved the simultaneous dedication of a standard 320-acre gas spacing unit to the Brazos "B" 11 Fee Well No. 1H (API No. 30-015-34483) from a surface location 1730 feet from the South line and 660 feet from the East line to a bottomhole location 1880 feet from the South line and 660 feet from the West line of Section 11, Township 16 South, Range 24 East, NMPM and the Brazos B 11 Fee Well No. 2H (API No. 30-015-34482) as originally proposed to be drilled from a surface location 660 feet from the South line and 660 feet from the East line to a bottomhole location 760 feet from the South line and 660 feet from the West line of said Section 11.

EOG has moved the surface location of the Brazos "B" 11 Fee Well 2H at the surface owner's request. The surface owner has requested that EOG move its proposed surface location to accommodate the surface owner's future uses. EOG therefore has moved the surface location to 560 feet from the South line and 200 feet from the East line of Section 11, Township 16 South, Range 24 East, NMPM, Eddy County, New Mexico. The penetration point and the bottomhole location remain the same. **Exhibit A** is the revised C-102 showing the correct location for the well.

Therefore, EOG respectfully requests that Administrative Order SD-2007-22 be amended to reflect the change in the surface location for the Brazos "B" 11 Fee Well

HOLLAND & HART^{LLP}



No. 2H at 560 feet from the South line and 200 feet from the East line and a bottomhole location 760 feet from the South line and 660 feet from the West line of Section 11, Township 16 South, Range 24 East, NMPM, Eddy County, New Mexico.

Your attention to this application is appreciated.

Sincerely,

Ocean Munds-Dry
Ocean Munds-Dry
Attorney for EOG Resources, Inc.

Enclosures

District I
1625 N. French Dr., Hobbs, NM 88240
District II
1301 W. Grand Avenue, Artesia, NM 88210
District III
1000 Rio Brazos Rd., Aztec, NM 87410
District IV
1220 S. St. Francis Dr., Santa Fe, NM 87505

State of New Mexico
Energy, Minerals & Natural Resources Department
OIL CONSERVATION DIVISION
1220 South St. Francis Dr.
Santa Fe, NM 87505

Form C-102
Revised October 12, 2005
Submit to Appropriate District Office
State Lease- 4 Copies
Fee Lease- 3 Copies

☐ AMENDED REPORT

WELL LOCATION AND ACREAGE DEDICATION PLAT

API Number 30-015-34482	Pool Code 75260	Pool Name Cottonwood Creek ; Wc West (Gas)
Property Code	Property Name BRAZOS "B" 11 FEE	Well Number 2H
GRID No. 7377	Operator Name EOG RESOURCES, INC.	Elevation 3569.7'

Surface Location

UL or lot no.	Section	Township	Range	Lot Idn	Feet from the	North/South line	Feet from the	East/West line	County
P	11	16 SOUTH	24 EAST, N.M.P.M.		560'	SOUTH	200'	EAST	EDDY

Bottom Hole Location If Different From Surface

UL or lot no.	Section	Township	Range	Lot Idn	Feet from the	North/South line	Feet from the	East/West line	County
M	11	16 SOUTH	24 EAST, N.M.P.M.		760'	SOUTH	660'	WEST	EDDY

Dedicated Acres 320	Joint or Infill	Consolidation Code	Order No.
-------------------------------	-----------------	--------------------	-----------

No allowable will be assigned to this completion until all interests have been consolidated or a non-standard unit has been approved by the division.

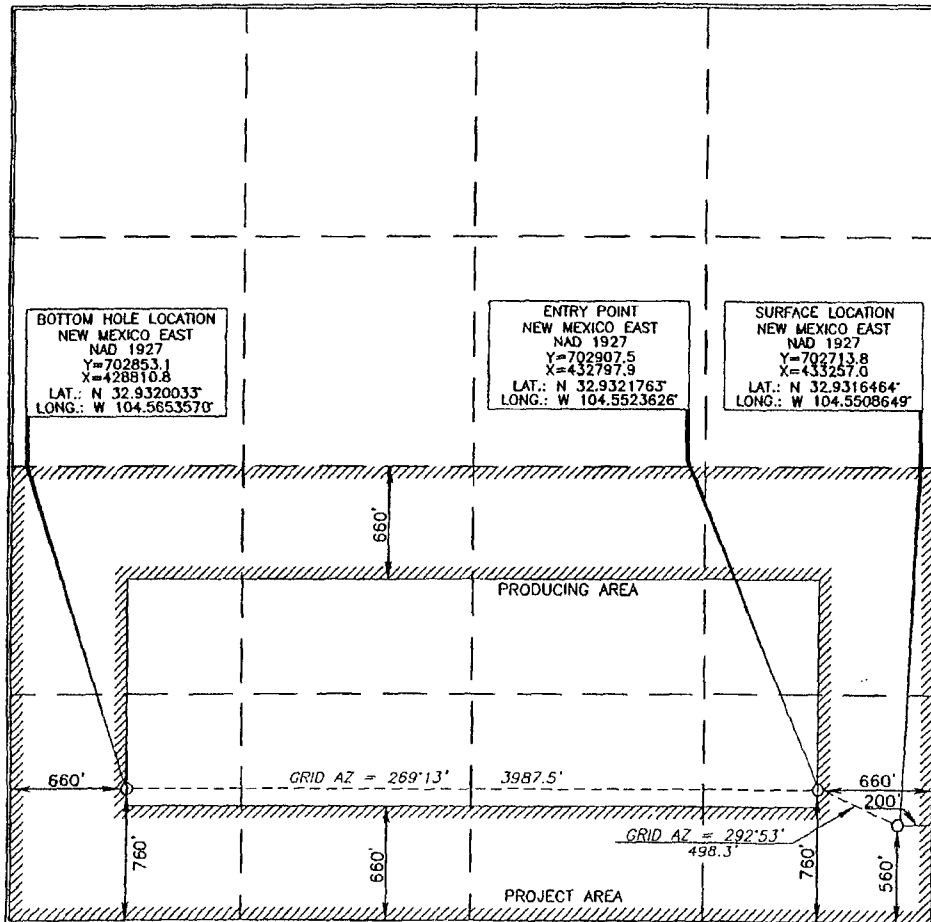

OPERATOR CERTIFICATION

I hereby certify that the information contained herein is true and complete to the best of my knowledge and belief, and that this organization either owns a working interest or unleased mineral interest in the land including the proposed bottom hole location or has a right to drill this well at this location pursuant to a contract with an owner of such a mineral or working interest, or to a voluntary pooling agreement or a compulsory pooling order heretofore entered by the division.

Donny G. Glanton 7/9/08
Signature Date
Donny G. Glanton
Printed Name

SURVEYOR CERTIFICATION

I hereby certify that the well location shown on this plat was located from field notes and/or aerial surveys made by me or under my supervision and that the same is true and correct to the best of my belief.

Terry J. Paul 7/13/2008
Date of Survey Signature and Date of Professional Surveyor
Certificate Number **15079**

WO# 080702WL (KA)

EXHIBIT

tabbles

A

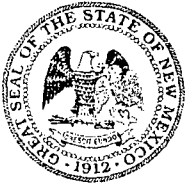

NEW MEXICO ENERGY, MINERALS and NATURAL RESOURCES DEPARTMENT

BILL RICHARDSON

Governor

Joanna Prukop

Cabinet Secretary

Mark E. Fesmire, P.E.

Director

Oil Conservation Division

August 14, 2007

EOG Resources, Inc.
c/o Holland & Hart, LLP
P.O. Box 2208
Santa Fe, New Mexico 87504-2208

Attn: Ms. Ocean Munds-Dry, Attorney

Administrative Order SD-200722

**RE: Simultaneous Dedication of a Gas Spacing
Unit Comprising the S/2 of Section 11,
T-16 South, R-24 East, NMPM, Eddy County, N.M.
West Cottonwood Creek-Wolfcamp Gas Pool (Gas - 75260)**

Existing horizontal well:

Brazos B 11 Fee Well No. 1H (API No. 30-015-34483)
Surface Location: 1730' FSL & 660' FEL, Unit I,
Bottomhole Location: 1880' FSL & 660' FWL, Unit L;

Proposed horizontal well:

Brazos B 11 Fee Well No. 2H (API No. 30-015-34482)
Surface Location: 660' FSL & 660' FEL, Unit P,
Bottomhole Location: 760' FSL & 660' FWL, Unit M;

Dear Ms Munds-Dry:

Reference is made to the following:

- (a) your application on behalf of EOG Resources, Inc. ("EOG")
(**administrative application reference No. pCLP0719943430**) that was
submitted to the New Mexico Oil Conservation Division ("Division") in
Santa Fe, New Mexico on July 17, 2007; and
- (b) the Division's records pertinent to EOG's request.

The West Cottonwood Creek-Wolfcamp Gas Pool is currently governed by Division Rule 19.15.3.104(C) which requires standard 320-acre gas spacing and proration units with wells to be located no closer than 660 feet to the outer boundary of the quarter section on which the well is located and no closer than 10 feet to any quarter-quarter section line or subdivision inner boundary. These rules further authorize the drilling of an infill well on a standard 320-acre unit provided that the infill well is not located within the same quarter section as the parent well. Because both the proposed horizontal well and the existing horizontal well will be completed within both quarter sections of this 320-acre unit, Division approval for simultaneous dedication is required.

Your application on behalf of EOG has been duly filed under the provisions of Division Rules 19.15.3.104.D(3) and 19.15.14.1210.A.

The data presented with your application demonstrates that the horizontal (producing) portion of the wellbores will be fully contained within the "producing area", as this term is defined by Division Rule 19.15.3.111.

It is our understanding that EOG has proposed the simultaneous dedication of this unit to the above-described wells for geologic reasons, in order to prevent waste and maximize production from this unit.

The applicant provided notice of this application to all affected offset operators and/or interest owners. No interest owner objected to this application.

Pursuant to the authority granted to the Division by Rule 19.15.3.104.D(3), the above-described simultaneous dedication is hereby approved.

Sincerely,

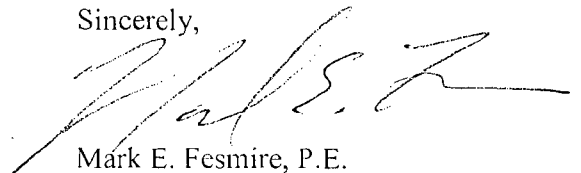

Mark E. Fesmire, P.E.
Director

MEF/drc

cc: OCD - Artesia