

1R - 454

REPORTS

DATE:

Sept. 2008



RECEIVED
2008 SEP 15 PM 2 40

SITE CLOSURE REQUEST

DENTON GATHERING
SECTION 11, TOWNSHIP 15 SOUTH, RANGE 37 EAST
NORTHEAST OF LOVINGTON
LEA COUNTY, NEW MEXICO

NMOCD Reference No. 1R-454

Prepared for:

Centurion Pipeline L.P.
6 Desta Drive, Suite 5050
Midland, Texas 79705



Prepared by:

NOVA Safety and Environmental
2057 Commerce Drive
Midland, Texas 79703

September 2008

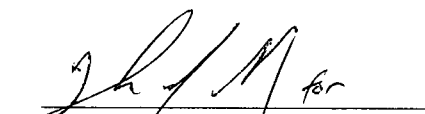
Ronald K. Rounsaville
Project Manager



Todd K. Choban, P.G.
Vice President, Technical Services

TABLE OF CONTENTS

1.0	INTRODUCTION AND SITE BACKGROUND	1
2.0	NMOC SITE CLASSIFICATION	1
3.0	SUMMARY OF FIELD ACTIVITIES	2
4.0	SITE CLOSURE REQUEST	2
5.0	LIMITATIONS	3
6.0	DISTRIBUTION	4

FIGURES

- Figure 1: Site Location Map
Figure 2: Site Details Map and Sample Locations

TABLES

- Table 1: Confirmation Soil Sample Analytical Results

APPENDICES

- Appendix A: Laboratory Reports
Appendix B: Site Photographs

1.0 INTRODUCTION AND SITE BACKGROUND

On behalf of Centurion Pipeline L.P. (Centurion), NOVA Safety and Environmental (NOVA) has prepared this Site Closure Request for the site known as Denton Gathering. The Denton Gathering pipeline is an inactive 6-inch crude oil pipeline operated by Centurion Pipeline. The release site is located in Section 11, Township 15 South, Range 37 East, Lea County, New Mexico. A site location map is provided as Figure 1.

On March 7, 2003, BP (former owner of the line) reported a release of crude oil from a 6-inch gathering pipeline located approximately 15 miles northeast of Lovington, New Mexico on property owned by Mr. Darr Angell. Following line repairs, the initial excavation activities removed visibly affected soil. From April 1 through August 20, 2003, several episodes of over-excavation and confirmation soil sampling were conducted. Final soil sample results indicated all crude oil affected soils above NMOCD cleanup standards were removed from the excavation and stockpiled on-site for remediation.

On September 30, 2003, a Soil Assessment Report and Remedial Work Plan was submitted to the NMOCD for review. On February 25, 2004, a Workplan for monitor well installation was submitted to the NMOCD and subsequently approved on April 13, 2004. In June 2004, four monitor wells were installed at the site and groundwater samples collected. Laboratory analytical results on groundwater samples collected indicated the groundwater beneath the site was not impacted by the release. In August 2004, a Site Investigation Report was submitted to the NMOCD documenting the assessment and remediation activities conducted at the site. On November 15, 2004, Delta Environmental submitted a Request for Closure Workplan to the NMOCD summarizing the soil excavation, sampling activities and groundwater monitoring activities and requested NMOCD approval to close the groundwater investigation. The Closure Workplan requested a resolution the issue of the 5,000 cubic yards of impacted soil stockpiled at the site based on three scenarios: Off-site disposal of impacted soils, installation of a poly-liner, or mixing and blending of impacted soils to below 100 mg/Kg. In a letter dated November 22, 2005 from the NMOCD, approval was granted for the plugging and abandonment of the four existing monitor wells along with the soil blending option for soil remediation.

2.0 NMOCD SITE CLASSIFICATION

The groundwater investigation activities conducted at the site indicated that groundwater is approximately 60 feet below ground surface (bgs). This depth to groundwater results in a score of 20 being assigned to this site based on the NMOCD ranking criteria. The distance to the nearest water source exceeds 1,000 feet, resulting in zero points being assigned to the site on this ranking criterion. There is no surface water body located with 1,000 feet of the site, resulting in no points being assigned on this ranking criterion.

The NMOCD's *Guidelines for Remediation of Leaks, Spills and Releases* (NMOCD, 1993), indicates the Denton Gathering site has a ranking score of 20 points. The soil cleanup levels for a site with a ranking of 20 require benzene concentrations below 10 mg/Kg, total benzene, toluene, ethylbenzene and xylene (BTEX) concentrations below 50 mg/Kg and total petroleum

hydrocarbons gasoline range organics / diesel range organics (TPH-GRO/DRO) concentrations below 100 mg/Kg.

On February 26, 2008, Centurion was granted approval, in an e-mail correspondence with Mr. Wayne Price of the NMOCD, to backfill the existing excavation area upon receipt of laboratory analytical results confirming that the blended soil stockpiles were below the NMOCD regulatory guideline of 100 mg/Kg requirement.

3.0 SUMMARY OF FIELD ACTIVITIES

On May 19, 2008, soil blending activities began on the three existing soil stockpiles totaling approximately 5,000 cubic yards (cy) of hydrocarbon impacted soil previously excavated from the site. The excavated soil was staged on site pending final disposition. A Site Details Map indicating sample locations and other site details is provided as Figure 2.

The southeast and southwest soil stockpiles, each consisting of approximately 1,500 cy, along with the north soil stockpile, approximately 2,000 cy, were separated into several piles, tilled and spread in lifts of approximately 2 feet thick and allowed to aerate. Non-impacted soil surrounding the excavation area was used to blend with the impacted soil. From May 27 through June 24, 2008, as blending and mixing activities continued, NOVA personnel collected composite soil samples from each of the separately blended soil stockpiles and submitted the soil samples for laboratory analysis for TPH-GRO/DRO by EPA Method 8015M.

Based on results of laboratory analyzed confirmation soil samples obtained from the remediated soil piles, the NMOCD approved the backfilling of the excavation area with remediated soil. Backfilling of the excavation commenced on June 26, 2008. The blended soil stockpile was placed in the excavation in twelve-inch lifts and compacted. A water truck was used to supply moisture to the soil to provide adequate moisture required for proper compaction.

On July 1, 2008, backfilling activities were completed and the disturbed area was contoured to fit the surrounding topography. On July 23, 2008, the disturbed area was reseeded with a grass seed mixture as requested by the property owner.

4.0 SITE CLOSURE REQUEST

In summary, the analytical results of final confirmation soil samples collected from the remediated soil stockpiles indicate TPH concentrations are below the required NMOCD regulatory levels of 100 mg/Kg. Based on the analytical results of confirmation soil samples NOVA recommends that Centurion provide the NMOCD a copy of this *Site Closure Request* and request the NMOCD grant closure to the Denton Gathering release site of March 7, 2003.

5.0 LIMITATIONS

NOVA has prepared this *Site Closure Request* to the best of its ability. No other warranty, expressed or implied, is made or intended. NOVA has examined and relied upon documents referenced in the report and has relied on oral statements made by certain individuals. NOVA has not conducted an independent examination of the facts contained in referenced materials and statements. We have presumed the genuineness of the documents and that the information provided in documents or statements is true and accurate. NOVA has prepared this report in a professional manner, using the degree of skill and care exercised by similar environmental consultants. NOVA also notes that the facts and conditions referenced in this report may change over time and the conclusions and recommendations set forth herein are applicable only to the facts and conditions as described at the time of this report.

This *Site Closure Request* has been prepared for the benefit of Centurion. The information contained in this report including all exhibits and attachments may not be used by any other party without the express written consent of NOVA and/or Centurion.

6.0 DISTRIBUTION

- Copy 1: Ed Hansen
New Mexico Energy, Minerals and Natural Resources Department
Oil Conservation Division
1220 South St. Francis Drive
Santa Fe, NM 87505
- Copy 2: Larry Johnson
New Mexico Energy, Minerals and Natural Resources Department
Oil Conservation Division (District 1)
1625 French Drive
Hobbs, NM 88240
- Copy 3: Darrel Lester
Centurion Pipeline L.P.
P.O. Box 51790
Midland, Texas 79710
Darrel_Lester@Oxy.com
- Copy 4: NOVA Safety and Environmental.
2057 Commerce Drive
Midland, Texas 79703
rrounsaville@novatraining.cc

FIGURES

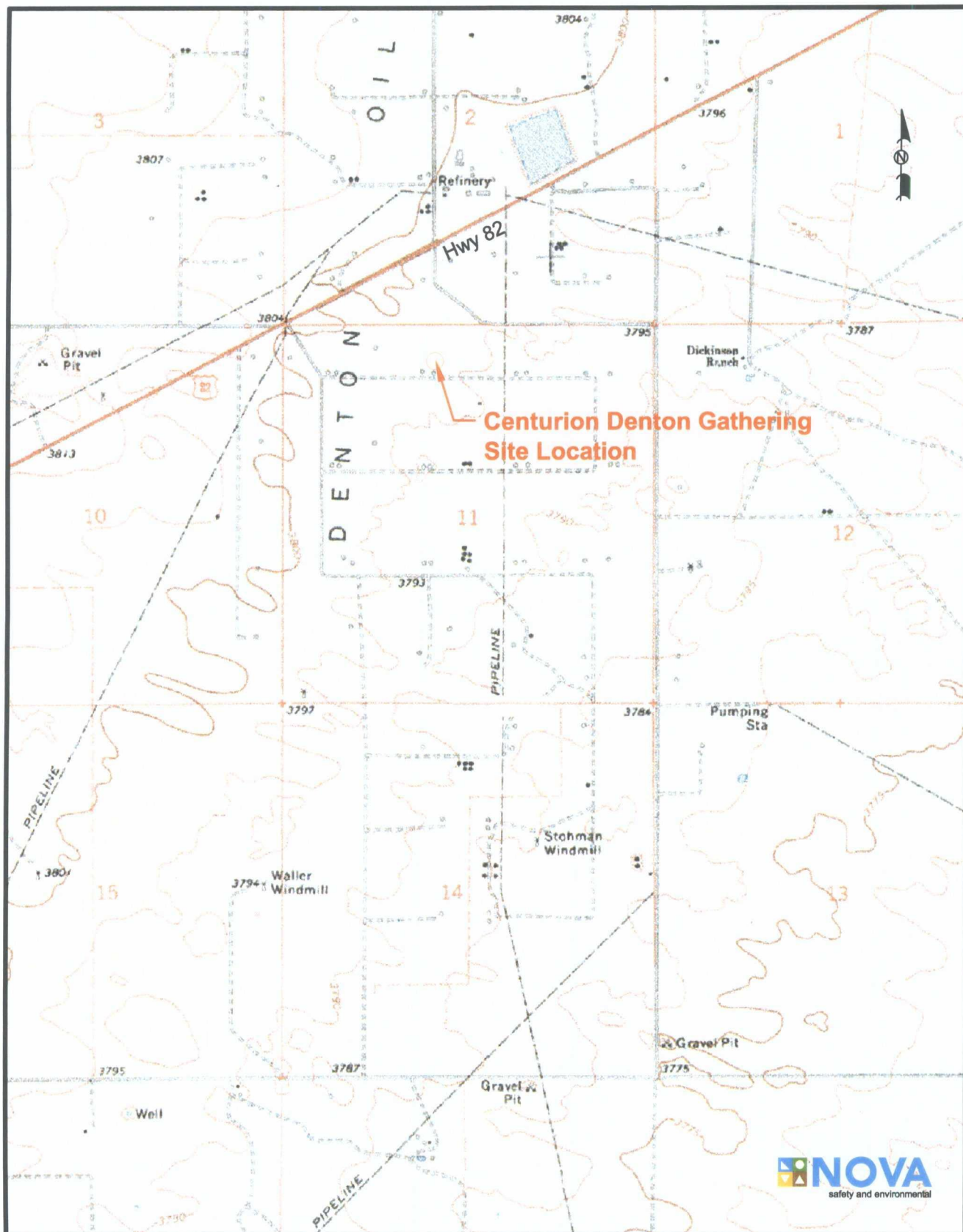
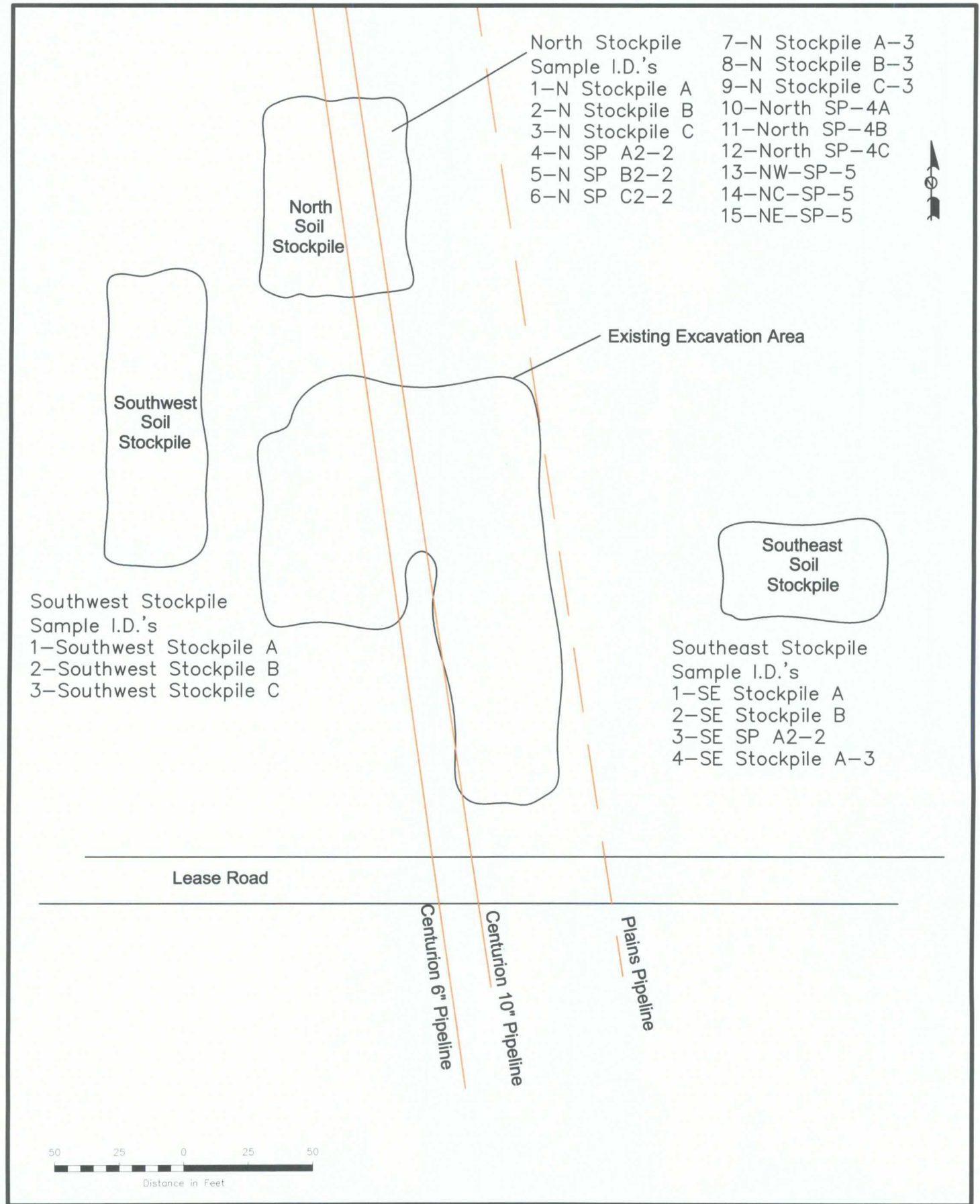

Figure 1
Site Location Map
Denton Gathering
Centurion Pipeline, L.P.
Lea County, NM

NOVA Safety and Environmental

Scale: 1"=2000'	CAD By: DGC	Checked By: RKR
August 26, 2008		



Legend

- Pipeline
- ▲ Sample Location

Figure 2
Site Details Map with
Confirmation Soil Sample Locations
Denton Gathering
Centurion Pipeline, L.P.
Lea County, NM

NOVA Safety and Environmental



Scale: 1" = 50'
August 26, 2008

Prep By: DGC

Checked By: RKR

TABLES

TABLE 1
Analytical Results - Confirmation Soil Samples
Centurion, Denton Gathering
Lovington, Lea Country, New Mexico
Centurion Pipeline, LP

				TPH Analyzed By Method 8015B		
SAMPLE DATE	SAMPLE IDENTIFICATION	SAMPLE DEPTH	SOIL STATUS	GRO C6-C12 mg/Kg	DRO >C12-C35 mg/Kg	Total TPH C6-C35 mg/Kg
NMOCD REGULATORY STANDARDS						100
05/27/08	SW Stockpile A	Stockpile	Backfill	<1.00	58.2	58.2
05/27/08	SW Stockpile B	Stockpile	Backfill	<1.00	<50.0	<50.0
05/27/08	SW Stockpile C	Stockpile	Backfill	<1.00	<50.0	<50.0
05/27/08	SE Stockpile A	Stockpile	Backfill	<1.00	101	101
05/27/08	SE Stockpile B	Stockpile	Backfill	<1.00	72.8	72.8
05/29/08	N. Stockpile A	Stockpile	Backfill	7.38	243	250.4
05/29/08	N. Stockpile B	Stockpile	Backfill	60.7	250	311
05/29/08	N. Stockpile C	Stockpile	Backfill	39.9	377	417
06/05/08	SE-SP A2-2	Stockpile	Backfill	<1.00	126	126
06/05/08	N-SP A2-2	Stockpile	Backfill	13.6	244	257.6
06/05/08	N-SP B2-2	Stockpile	Backfill	22.6	323	345.6
06/05/08	N-SP C2-2	Stockpile	Backfill	8.9	224	233
06/11/08	N. Stockpile A-3	Stockpile	Backfill	<1.00	287	287
06/11/08	N. Stockpile B-3	Stockpile	Backfill	3.94	189	193
06/11/08	N. Stockpile C-3	Stockpile	Backfill	1.48	145	146.5
06/11/08	SE. Stockpile A-3	Stockpile	Backfill	<1.00	89.3	89.3
06/19/08	North SP -4A	Stockpile	Backfill	<1.00	206	206
06/19/08	North SP -4B	Stockpile	Backfill	<1.00	121	121
06/19/08	North SP -4C	Stockpile	Backfill	<1.00	141	141
06/24/08	NW-SP-5	Stockpile	Backfill	<1.00	51.3	51.3
06/24/08	NC-SP-5	Stockpile	Backfill	<1.00	<50.0	<50.0
06/24/08	NE-SP-5	Stockpile	Backfill	<1.00	<50.0	<50.0

Bold: Indicates TPH concentration above regulatory guidelines

APPENDICES



APPENDIX A

TRACEANALYSIS, INC.

6701 Aberdeen Avenue, Suite 9
200 East Sunset Road, Suite E
5002 Basin Street, Suite A1
6015 Harris Parkway, Suite 110

Lubbock, Texas 79424
El Paso, Texas 79922
Midland, Texas 79703
Ft. Worth, Texas 76132

800•378•1296
888•588•3443
E-Mail: lab@traceanalysis.com

806•794•1296
915•585•3443
432•689•6301
817•201•5260

FAX 806•794•1298
FAX 915•585•4944
FAX 432•689•6313

Analytical and Quality Control Report

Ron Rounsaville
Nova Safety & Environmental
2057 Commerce St.
Midland, TX, 79703

Report Date: June 2, 2008

Work Order: 8052742



Project Location: Lea County, NM
Project Name: Denton Gathering Line
Project Number: Denton Gathering Line

Enclosed are the Analytical Report and Quality Control Report for the following sample(s) submitted to TraceAnalysis, Inc.

Sample	Description	Matrix	Date Taken	Time Taken	Date Received
161350	SW Stockpile A	soil	2008-05-27	12:10	2008-05-27
161351	SW Stockpile B	soil	2008-05-27	12:15	2008-05-27
161352	SW Stockpile C	soil	2008-05-27	12:20	2008-05-27
161353	SE Stockpile A	soil	2008-05-27	12:00	2008-05-27
161354	SE Stockpile B	soil	2008-05-27	12:05	2008-05-27

These results represent only the samples received in the laboratory. The Quality Control Report is generated on a batch basis. All information contained in this report is for the analytical batch(es) in which your sample(s) were analyzed.

This report consists of a total of 11 pages and shall not be reproduced except in its entirety, without written approval of TraceAnalysis, Inc.

Blair Leftwich

Dr. Blair Leftwich, Director

Certifications

Lubbock - NELAP T104704219-08-TX

El Paso - NELAP T104704221-08-TX

Standard Flags

B - The sample contains less than ten times the concentration found in the method blank.

Case Narrative

Samples for project Denton Gathering Line were received by TraceAnalysis, Inc. on 2008-05-27 and assigned to work order 8052742. Samples for work order 8052742 were received intact at a temperature of 3.5 deg C.

Samples were analyzed for the following tests using their respective methods.

Test	Method
TPH DRO	Mod. 8015B
TPH GRO	S 8015B

Results for these samples are reported on a wet weight basis unless data package indicates otherwise.

A matrix spike (MS) and matrix spike duplicate (MSD) sample is chosen at random from each preparation batch. The MS and MSD will indicate if a site specific matrix problem is occurring, however, it may not pertain to the samples for work order 8052742 since the sample was chosen at random. Therefore, the validity of the analytical data reported has been determined by the laboratory control sample (LCS) and the method blank (MB). These quality control measures are performed with each preparation batch to ensure data integrity.

All other exceptions associated with this report have been footnoted on the appropriate analytical page to assist in general data comprehension. Please contact the laboratory directly if there are any questions regarding this project.

Report Date: June 2, 2008
Denton Gathering Line

Work Order: 8052742
Denton Gathering Line

Page Number: 4 of 11
Lea County, NM

Analytical Report

Sample: 161350 - SW Stockpile A

Laboratory: Midland
Analysis: TPH DRO
QC Batch: 48921
Prep Batch: 42039

Analytical Method: Mod. 8015B
Date Analyzed: 2008-05-30
Sample Preparation: 2008-05-30

Prep Method: N/A
Analyzed By: LD
Prepared By: LD

Parameter	Flag	RL Result	Units	Dilution	RL
DRO	B	58.2	mg/Kg	1	50.0

Surrogate	Flag	Result	Units	Dilution	Spike Amount	Percent Recovery	Recovery Limits
n-Triacontane		161	mg/Kg	1	100	161	10 - 250.4

Sample: 161350 - SW Stockpile A

Laboratory: Midland
Analysis: TPH GRO
QC Batch: 48934
Prep Batch: 42034

Analytical Method: S 8015B
Date Analyzed: 2008-05-31
Sample Preparation: 2008-05-30

Prep Method: S 5035
Analyzed By: DC
Prepared By: DC

Parameter	Flag	RL Result	Units	Dilution	RL
GRO		<1.00	mg/Kg	1	1.00

Surrogate	Flag	Result	Units	Dilution	Spike Amount	Percent Recovery	Recovery Limits
Trifluorotoluene (TFT)		1.03	mg/Kg	1	1.00	103	70 - 130
4-Bromofluorobenzene (4-BFB)		1.10	mg/Kg	1	1.00	110	70 - 130

Sample: 161351 - SW Stockpile B

Laboratory: Midland
Analysis: TPH DRO
QC Batch: 48921
Prep Batch: 42039

Analytical Method: Mod. 8015B
Date Analyzed: 2008-05-30
Sample Preparation: 2008-05-30

Prep Method: N/A
Analyzed By: LD
Prepared By: LD

Parameter	Flag	RL Result	Units	Dilution	RL
DRO		<50.0	mg/Kg	1	50.0

Report Date: June 2, 2008
Denton Gathering Line

Work Order: 8052742
Denton Gathering Line

Page Number: 5 of 11
Lea County, NM

Surrogate	Flag	Result	Units	Dilution	Spike Amount	Percent Recovery	Recovery Limits
n-Triacontane		95.9	mg/Kg	1	100	96	10 - 250.4

Sample: 161351 - SW Stockpile B

Laboratory: Midland
Analysis: TPH GRO
QC Batch: 48934
Prep Batch: 42034

Analytical Method: S 8015B
Date Analyzed: 2008-05-31
Sample Preparation: 2008-05-30

Prep Method: S 5035
Analyzed By: DC
Prepared By: DC

Parameter	Flag	RL Result	Units	Dilution	RL
GRO		<1.00	mg/Kg	1	1.00

Surrogate	Flag	Result	Units	Dilution	Spike Amount	Percent Recovery	Recovery Limits
Trifluorotoluene (TFT)		1.03	mg/Kg	1	1.00	103	70 - 130
4-Bromofluorobenzene (4-BFB)		1.06	mg/Kg	1	1.00	106	70 - 130

Sample: 161352 - SW Stockpile C

Laboratory: Midland
Analysis: TPH DRO
QC Batch: 48921
Prep Batch: 42039

Analytical Method: Mod. 8015B
Date Analyzed: 2008-05-30
Sample Preparation: 2008-05-30

Prep Method: N/A
Analyzed By: LD
Prepared By: LD

Parameter	Flag	RL Result	Units	Dilution	RL
DRO		<50.0	mg/Kg	1	50.0

Surrogate	Flag	Result	Units	Dilution	Spike Amount	Percent Recovery	Recovery Limits
n-Triacontane		111	mg/Kg	1	100	111	10 - 250.4

Sample: 161352 - SW Stockpile C

Laboratory: Midland
Analysis: TPH GRO
QC Batch: 48934
Prep Batch: 42034

Analytical Method: S 8015B
Date Analyzed: 2008-05-31
Sample Preparation: 2008-05-30

Prep Method: S 5035
Analyzed By: DC
Prepared By: DC

continued ...

Report Date: June 2, 2008
Denton Gathering Line

Work Order: 8052742
Denton Gathering Line

Page Number: 6 of 11
Lea County, NM

sample 161352 continued ...

Parameter	Flag	RL Result	Units	Dilution	RL
Parameter	Flag	RL Result	Units	Dilution	RL
GRO		<1.00	mg/Kg	1	1.00

Surrogate	Flag	Result	Units	Dilution	Spike Amount	Percent Recovery	Recovery Limits
Trifluorotoluene (TFT)		1.02	mg/Kg	1	1.00	102	70 - 130
4-Bromofluorobenzene (4-BFB)		1.01	mg/Kg	1	1.00	101	70 - 130

Sample: 161353 - SE Stockpile A

Laboratory: Midland
Analysis: TPH DRO
QC Batch: 48921
Prep Batch: 42039

Analytical Method: Mod. 8015B
Date Analyzed: 2008-05-30
Sample Preparation: 2008-05-30

Prep Method: N/A
Analyzed By: LD
Prepared By: LD

Parameter	Flag	RL Result	Units	Dilution	RL
DRO	B	101	mg/Kg	1	50.0

Surrogate	Flag	Result	Units	Dilution	Spike Amount	Percent Recovery	Recovery Limits
n-Triacontane		106	mg/Kg	1	100	106	10 - 250.4

Sample: 161353 - SE Stockpile A

Laboratory: Midland
Analysis: TPH GRO
QC Batch: 48934
Prep Batch: 42034

Analytical Method: S 8015B
Date Analyzed: 2008-05-31
Sample Preparation: 2008-05-30

Prep Method: S 5035
Analyzed By: DC
Prepared By: DC

Parameter	Flag	RL Result	Units	Dilution	RL
GRO		<1.00	mg/Kg	1	1.00

Surrogate	Flag	Result	Units	Dilution	Spike Amount	Percent Recovery	Recovery Limits
Trifluorotoluene (TFT)		1.03	mg/Kg	1	1.00	103	70 - 130
4-Bromofluorobenzene (4-BFB)		1.04	mg/Kg	1	1.00	104	70 - 130

Report Date: June 2, 2008
Denton Gathering Line

Work Order: 8052742
Denton Gathering Line

Page Number: 7 of 11
Lea County, NM

Sample: 161354 - SE Stockpile B

Laboratory: Midland
Analysis: TPH DRO
QC Batch: 48921
Prep Batch: 42039

Analytical Method: Mod. 8015B
Date Analyzed: 2008-05-30
Sample Preparation: 2008-05-30

Prep Method: N/A
Analyzed By: LD
Prepared By: LD

Parameter	Flag	RL Result	Units	Dilution	RL
DRO	B	72.8	mg/Kg	1	50.0

Surrogate	Flag	Result	Units	Dilution	Spike Amount	Percent Recovery	Recovery Limits
n-Triacontane		102	mg/Kg	1	100	102	10 - 250.4

Sample: 161354 - SE Stockpile B

Laboratory: Midland
Analysis: TPH GRO
QC Batch: 48934
Prep Batch: 42034

Analytical Method: S 8015B
Date Analyzed: 2008-05-31
Sample Preparation: 2008-05-30

Prep Method: S 5035
Analyzed By: DC
Prepared By: DC

Parameter	Flag	RL Result	Units	Dilution	RL
GRO		<1.00	mg/Kg	1	1.00

Surrogate	Flag	Result	Units	Dilution	Spike Amount	Percent Recovery	Recovery Limits
Trifluorotoluene (TFT)		0.985	mg/Kg	1	1.00	98	70 - 130
4-Bromofluorobenzene (4-BFB)		0.980	mg/Kg	1	1.00	98	70 - 130

Method Blank (1) QC Batch: 48921

QC Batch: 48921
Prep Batch: 42039

Date Analyzed: 2008-05-30
QC Preparation: 2008-05-30

Analyzed By: LD
Prepared By: LD

Parameter	Flag	MDL Result	Units	RL
DRO		19.0	mg/Kg	50

Surrogate	Flag	Result	Units	Dilution	Spike Amount	Percent Recovery	Recovery Limits
n-Triacontane		104	mg/Kg	1	100	104	30.9 - 146.4

Report Date: June 2, 2008
Denton Gathering Line

Work Order: 8052742
Denton Gathering Line

Page Number: 8 of 11
Lea County, NM

Method Blank (1) QC Batch: 48934

QC Batch: 48934
Prep Batch: 42034

Date Analyzed: 2008-05-31
QC Preparation: 2008-05-30

Analyzed By: DC
Prepared By: DC

Parameter	Flag	MDL Result	Units	RL
GRO		<0.739	mg/Kg	1

Surrogate	Flag	Result	Units	Dilution	Spike Amount	Percent Recovery	Recovery Limits
Trifluorotoluene (TFT)		1.02	mg/Kg	1	1.00	102	70 - 130
4-Bromofluorobenzene (4-BFB)		0.970	mg/Kg	1	1.00	97	70 - 130

Laboratory Control Spike (LCS-1)

QC Batch: 48921
Prep Batch: 42039

Date Analyzed: 2008-05-30
QC Preparation: 2008-05-30

Analyzed By: LD
Prepared By: LD

Param	LCS Result	Units	Dil.	Spike Amount	Matrix Result	Rec.	Rec. Limit
DRO	234	mg/Kg	1	250	19	86	27.8 - 152.1

Percent recovery is based on the spike result. RPD is based on the spike and spike duplicate result.

Param	LCSD Result	Units	Dil.	Spike Amount	Matrix Result	Rec.	Rec. Limit	RPD	RPD Limit
DRO	232	mg/Kg	1	250	19	85	27.8 - 152.1	1	20

Percent recovery is based on the spike result. RPD is based on the spike and spike duplicate result.

Surrogate	LCS Result	LCSD Result	Units	Dil.	Spike Amount	LCS Rec.	LCSD Rec.	Rec. Limit
n-Triacontane	75.4	75.4	mg/Kg	1	100	75	75	38 - 130.4

Laboratory Control Spike (LCS-1)

QC Batch: 48934
Prep Batch: 42034

Date Analyzed: 2008-05-31
QC Preparation: 2008-05-30

Analyzed By: DC
Prepared By: DC

Param	LCS Result	Units	Dil.	Spike Amount	Matrix Result	Rec.	Rec. Limit
GRO	7.97	mg/Kg	1	10.0	<0.739	80	70 - 130

Percent recovery is based on the spike result. RPD is based on the spike and spike duplicate result.

Report Date: June 2, 2008
Denton Gathering Line

Work Order: 8052742
Denton Gathering Line

Page Number: 9 of 11
Lea County, NM

Param	LCSD Result	Units	Dil.	Spike Amount	Matrix Result	Rec.	Rec. Limit	RPD	RPD Limit
GRO	8.34	mg/Kg	1	10.0	<0.739	83	70 - 130	4	20

Percent recovery is based on the spike result. RPD is based on the spike and spike duplicate result.

Surrogate	LCS Result	LCSD Result	Units	Dil.	Spike Amount	LCS Rec.	LCSD Rec.	Rec. Limit
Trifluorotoluene (TFT)	1.03	1.04	mg/Kg	1	1.00	103	104	70 - 130
4-Bromofluorobenzene (4-BFB)	1.02	1.00	mg/Kg	1	1.00	102	100	70 - 130

Matrix Spike (MS-1) Spiked Sample: 161350

QC Batch: 48921
Prep Batch: 42039

Date Analyzed: 2008-05-30
QC Preparation: 2008-05-30

Analyzed By: LD
Prepared By: LD

Param	MS Result	Units	Dil.	Spike Amount	Matrix Result	Rec.	Rec. Limit
DRO	735	mg/Kg	1	250	58.18	271	18 - 179.5

Percent recovery is based on the spike result. RPD is based on the spike and spike duplicate result.

Param	MSD Result	Units	Dil.	Spike Amount	Matrix Result	Rec.	Rec. Limit	RPD	RPD Limit
DRO	516	mg/Kg	1	250	58.18	183	18 - 179.5	35	20

Percent recovery is based on the spike result. RPD is based on the spike and spike duplicate result.

Surrogate	MS Result	MSD Result	Units	Dil.	Spike Amount	MS Rec.	MSD Rec.	Rec. Limit
n-Triacontane	128	100	mg/Kg	1	100	128	100	34.1 - 158

Matrix Spike (MS-1) Spiked Sample: 161565

QC Batch: 48934
Prep Batch: 42034

Date Analyzed: 2008-05-31
QC Preparation: 2008-05-30

Analyzed By: DC
Prepared By: DC

Param	MS Result	Units	Dil.	Spike Amount	Matrix Result	Rec.	Rec. Limit
GRO	54.2	mg/Kg	1	10.0	39.8607	143	70 - 130

Percent recovery is based on the spike result. RPD is based on the spike and spike duplicate result.

continued ...

¹Matrix spike recovery out of control limits due to peak interference. Use LCS/LCSD to demonstrate analysis is under control.

²Matrix spike recovery out of control limits due to peak interference. Use LCS/LCSD to demonstrate analysis is under control.

³Matrix spike recovery out of control limits due to peak interference. Use LCS/LCSD to demonstrate analysis is under control.

Report Date: June 2, 2008
Denton Gathering Line

Work Order: 8052742
Denton Gathering Line

Page Number: 10 of 11
Lea County, NM

matrix spikes continued ...

Param	MSD Result	Units	Dil.	Spike Amount	Matrix Result	Rec.	Rec. Limit	RPD	RPD Limit
Param	MSD Result	Units	Dil.	Spike Amount	Matrix Result	Rec.	Rec. Limit	RPD	RPD Limit
GRO	52.3	mg/Kg	1	10.0	39.8607	124	70 - 130	4	20

Percent recovery is based on the spike result. RPD is based on the spike and spike duplicate result.

Surrogate	MS Result	MSD Result	Units	Dil.	Spike Amount	MS Rec.	MSD Rec.	Rec. Limit
Trifluorotoluene (TFT)	0.961	0.919	mg/Kg	1	1	96	92	70 - 130
4-Bromofluorobenzene (4-BFB)	1.03	0.944	mg/Kg	1	1	103	94	70 - 130

Standard (ICV-1)

QC Batch: 48921

Date Analyzed: 2008-05-30

Analyzed By: LD

Param	Flag	Units	ICVs True Conc.	ICVs Found Conc.	ICVs Percent Recovery	Percent Recovery Limits	Date Analyzed
DRO		mg/Kg	250	257	103	85 - 115	2008-05-30

Standard (CCV-1)

QC Batch: 48921

Date Analyzed: 2008-05-30

Analyzed By: LD

Param	Flag	Units	CCVs True Conc.	CCVs Found Conc.	CCVs Percent Recovery	Percent Recovery Limits	Date Analyzed
DRO		mg/Kg	250	236	94	85 - 115	2008-05-30

Standard (ICV-1)

QC Batch: 48934

Date Analyzed: 2008-05-31

Analyzed By: DC

Param	Flag	Units	ICVs True Conc.	ICVs Found Conc.	ICVs Percent Recovery	Percent Recovery Limits	Date Analyzed
GRO		mg/Kg	1.00	0.949	95	85 - 115	2008-05-31

Standard (CCV-1)

QC Batch: 48934

Date Analyzed: 2008-05-31

Analyzed By: DC

Report Date: June 2, 2008
Denton Gathering Line

Work Order: 8052742
Denton Gathering Line

Page Number: 11 of 11
Lea County, NM

Param	Flag	Units	CCVs True Conc.	CCVs Found Conc.	CCVs Percent Recovery	Percent Recovery Limits	Date Analyzed
GRO		mg/Kg	1.00	0.941	94	85 - 115	2008-05-31

TraceAnalysis, Inc.

email: lab@traceanalysis.com

6701 Aberdeen Avenue, Suite 9
Lubbock, Texas 79424
Tel (806) 794-1296
Fax (806) 794-1298
1 (800) 378-1296

5002 Basin Street, Suite A1
Midland, Texas 79703
Tel (432) 689-6301
Fax (432) 689-6313

200 East Sunset Rd., Suite E
El Paso, Texas 79922
Tel (915) 585-3443
Fax (915) 585-4944
1 (888) 588-3443

6015 Harris Pkwy., Suite 110
Ft. Worth, Texas 76132
T-1 (817) 201-5260

Company Name:	NOVA	Phone #:	520-7720
Address:	(Street, City, Zip)	Fax #:	

Contact Person: <u>Don Rounsaville</u> E-mail: <u>rrounsaville@novadrumming.cc</u>

(If different from above)	Centurian
Project #:	Project Name:

Project Location (including state): LEA County NM

[illegible][illegible]

ANALYSIS REQUEST
(Circle or Specify Method No.)

	MTBE	8021B / 602 / 8260B / 624
	BTEX	8021B / 602 / 8260B / 624
	TPH	418.1 / TX1005 / TX1005 Ext(C35)
X	TPH	8015 GRO / DRO TVHC
X	PAH	8270C / 625
X	Total Metals	Ag As Ba Cd Cr Pb Se Hg 6010B/200.7
X	TCLP Metals	Ag As Ba Cd Cr Pb Se Hg
	TCLP Volatiles	
	TCLP Semi Volatiles	
	TCLP Pesticides	
	RCI	
	GC/MS Vol.	8260B / 624
	GC/MS Semi. Vol.	8270C / 625
	PCBs	8082 / 608
	Pesticides	8081A / 608
	BOD, TSS, pH	
	Moisture Content	
	Turn Around Time	If different from standard
	Hold	

Relinquished by: <i>Paul Randall</i>	Date: <i>5/27/08</i>	Time: <i>1655</i>	Received by: <i>Blondelle</i>	Date: <i>5/27/08</i>	Time: <i>1655</i>
Relinquished by:	Date:	Time:	Received by:	Date:	Time:
Relinquished by:	Date:	Time:	Received at Laboratory by:	Date:	Time:

LAB USE ONLY Infract <u>Y / N</u> (N) Headspace <u>Y / N</u> (N) Temp <u>3.5</u> Log-in-Review <u>12</u>	REMARKS: all tests - Medland
	<input type="checkbox"/> Dry Weight Basis Required
	<input type="checkbox"/> TRRP Report Required
	<input type="checkbox"/> Check If Special Reporting Limits Are Needed



6701 Aberdeen Avenue, Suite 9 Lubbock, Texas 79424 800•378•1296 806•794•1296 FAX 806•794•1298
200 East Sunset Road, Suite E El Paso, Texas 79922 888•588•3443 915•585•3443 FAX 915•585•4944
5002 Basin Street, Suite A1 Midland, Texas 79703 432•689•6301 FAX 432•689•6313
6015 Harris Parkway, Suite 110 Ft. Worth, Texas 76132 817•201•5260
E-Mail: lab@traceanalysis.com

Analytical and Quality Control Report

Ron Rounsaville
Nova Safety & Environmental
2057 Commerce St.
Midland, TX, 79703

Report Date: June 2, 2008

Work Order: 8052943



Project Location: Lea County, NM
Project Name: Denton Gathering Line
Project Number: Denton Gathering Line

Enclosed are the Analytical Report and Quality Control Report for the following sample(s) submitted to TraceAnalysis, Inc.

Sample	Description	Matrix	Date Taken	Time Taken	Date Received
161563	N. Stockpile A	soil	2008-05-29	12:35	2008-05-29
161564	N. Stockpile B	soil	2008-05-29	12:40	2008-05-29
161565	N. Stockpile C	soil	2008-05-29	12:45	2008-05-29

These results represent only the samples received in the laboratory. The Quality Control Report is generated on a batch basis. All information contained in this report is for the analytical batch(es) in which your sample(s) were analyzed.

This report consists of a total of 9 pages and shall not be reproduced except in its entirety, without written approval of TraceAnalysis, Inc.

Dr. Blair Leftwich, Director

Certifications

Lubbock - NELAP T104704219-08-TX
El Paso - NELAP T104704221-08-TX

Standard Flags

B - The sample contains less than ten times the concentration found in the method blank.

Case Narrative

Samples for project Denton Gathering Line were received by TraceAnalysis, Inc. on 2008-05-29 and assigned to work order 8052943. Samples for work order 8052943 were received intact at a temperature of 4.0 deg C.

Samples were analyzed for the following tests using their respective methods.

Test	Method
TPH DRO	Mod. 8015B
TPH GRO	S 8015B

Results for these samples are reported on a wet weight basis unless data package indicates otherwise.

A matrix spike (MS) and matrix spike duplicate (MSD) sample is chosen at random from each preparation batch. The MS and MSD will indicate if a site specific matrix problem is occurring, however, it may not pertain to the samples for work order 8052943 since the sample was chosen at random. Therefore, the validity of the analytical data reported has been determined by the laboratory control sample (LCS) and the method blank (MB). These quality control measures are performed with each preparation batch to ensure data integrity.

All other exceptions associated with this report have been footnoted on the appropriate analytical page to assist in general data comprehension. Please contact the laboratory directly if there are any questions regarding this project.

Report Date: June 2, 2008
Denton Gathering Line

Work Order: 8052943
Denton Gathering Line

Page Number: 4 of 9
Lea County, NM

Analytical Report

Sample: 161563 - N. Stockpile A

Laboratory: Midland
Analysis: TPH DRO
QC Batch: 48921
Prep Batch: 42039

Analytical Method: Mod. 8015B
Date Analyzed: 2008-05-30
Sample Preparation: 2008-05-30

Prep Method: N/A
Analyzed By: LD
Prepared By: LD

Parameter	Flag	RL Result	Units	Dilution	RL
DRO		243	mg/Kg	1	50.0

Surrogate	Flag	Result	Units	Dilution	Spike Amount	Percent Recovery	Recovery Limits
n-Triacontane		133	mg/Kg	1	100	133	10 - 250.4

Sample: 161563 - N. Stockpile A

Laboratory: Midland
Analysis: TPH GRO
QC Batch: 48934
Prep Batch: 42034

Analytical Method: S 8015B
Date Analyzed: 2008-05-31
Sample Preparation: 2008-05-30

Prep Method: S 5035
Analyzed By: DC
Prepared By: DC

Parameter	Flag	RL Result	Units	Dilution	RL
GRO		7.38	mg/Kg	1	1.00

Surrogate	Flag	Result	Units	Dilution	Spike Amount	Percent Recovery	Recovery Limits
Trifluorotoluene (TFT)		0.991	mg/Kg	1	1.00	99	70 - 130
4-Bromofluorobenzene (4-BFB)		1.14	mg/Kg	1	1.00	114	70 - 130

Sample: 161564 - N. Stockpile B

Laboratory: Midland
Analysis: TPH DRO
QC Batch: 48921
Prep Batch: 42039

Analytical Method: Mod. 8015B
Date Analyzed: 2008-05-30
Sample Preparation: 2008-05-30

Prep Method: N/A
Analyzed By: LD
Prepared By: LD

Parameter	Flag	RL Result	Units	Dilution	RL
DRO		250	mg/Kg	1	50.0

Report Date: June 2, 2008
Denton Gathering Line

Work Order: 8052943
Denton Gathering Line

Page Number: 5 of 9
Lea County, NM

Surrogate	Flag	Result	Units	Dilution	Spike Amount	Percent Recovery	Recovery Limits
n-Triacontane		127	mg/Kg	1	100	127	10 - 250.4

Sample: 161564 - N. Stockpile B

Laboratory: Midland
Analysis: TPH GRO
QC Batch: 48934
Prep Batch: 42034

Analytical Method: S 8015B
Date Analyzed: 2008-05-31
Sample Preparation: 2008-05-30

Prep Method: S 5035
Analyzed By: DC
Prepared By: DC

Parameter	Flag	RL Result	Units	Dilution	RL
GRO		60.7	mg/Kg	1	1.00

Surrogate	Flag	Result	Units	Dilution	Spike Amount	Percent Recovery	Recovery Limits
Trifluorotoluene (TFT)		0.919	mg/Kg	1	1.00	92	70 - 130
4-Bromofluorobenzene (4-BFB)		1.05	mg/Kg	1	1.00	105	70 - 130

Sample: 161565 - N. Stockpile C

Laboratory: Midland
Analysis: TPH DRO
QC Batch: 48921
Prep Batch: 42039

Analytical Method: Mod. 8015B
Date Analyzed: 2008-05-30
Sample Preparation: 2008-05-30

Prep Method: N/A
Analyzed By: LD
Prepared By: LD

Parameter	Flag	RL Result	Units	Dilution	RL
DRO		377	mg/Kg	1	50.0

Surrogate	Flag	Result	Units	Dilution	Spike Amount	Percent Recovery	Recovery Limits
n-Triacontane		165	mg/Kg	1	100	165	10 - 250.4

Sample: 161565 - N. Stockpile C

Laboratory: Midland
Analysis: TPH GRO
QC Batch: 48934
Prep Batch: 42034

Analytical Method: S 8015B
Date Analyzed: 2008-05-31
Sample Preparation: 2008-05-30

Prep Method: S 5035
Analyzed By: DC
Prepared By: DC

continued ...

Report Date: June 2, 2008
Denton Gathering Line

Work Order: 8052943
Denton Gathering Line

Page Number: 6 of 9
Lea County, NM

sample 161565 continued ...

Parameter	Flag	RL Result	Units	Dilution	RL
-----------	------	--------------	-------	----------	----

Parameter	Flag	RL Result	Units	Dilution	RL
GRO		39.9	mg/Kg	1	1.00

Surrogate	Flag	Result	Units	Dilution	Spike Amount	Percent Recovery	Recovery Limits
Trifluorotoluene (TFT)		0.955	mg/Kg	1	1.00	96	70 - 130
4-Bromofluorobenzene (4-BFB)		0.964	mg/Kg	1	1.00	96	70 - 130

Method Blank (1) QC Batch: 48921

QC Batch: 48921
Prep Batch: 42039

Date Analyzed: 2008-05-30
QC Preparation: 2008-05-30

Analyzed By: LD
Prepared By: LD

Parameter	Flag	MDL Result	Units	RL
DRO		19.0	mg/Kg	50

Surrogate	Flag	Result	Units	Dilution	Spike Amount	Percent Recovery	Recovery Limits
n-Triacontane		104	mg/Kg	1	100	104	30.9 - 146.4

Method Blank (1) QC Batch: 48934

QC Batch: 48934
Prep Batch: 42034

Date Analyzed: 2008-05-31
QC Preparation: 2008-05-30

Analyzed By: DC
Prepared By: DC

Parameter	Flag	MDL Result	Units	RL
GRO		<0.739	mg/Kg	1

Surrogate	Flag	Result	Units	Dilution	Spike Amount	Percent Recovery	Recovery Limits
Trifluorotoluene (TFT)		1.02	mg/Kg	1	1.00	102	70 - 130
4-Bromofluorobenzene (4-BFB)		0.970	mg/Kg	1	1.00	97	70 - 130

Report Date: June 2, 2008
Denton Gathering Line

Work Order: 8052943
Denton Gathering Line

Page Number: 7 of 9
Lea County, NM

Laboratory Control Spike (LCS-1)

QC Batch: 48921
Prep Batch: 42039

Date Analyzed: 2008-05-30
QC Preparation: 2008-05-30

Analyzed By: LD
Prepared By: LD

Param	LCS Result	Units	Dil.	Spike Amount	Matrix Result	Rec.	Rec. Limit
DRO	234	mg/Kg	1	250	19	86	27.8 - 152.1

Percent recovery is based on the spike result. RPD is based on the spike and spike duplicate result.

Param	LCSD Result	Units	Dil.	Spike Amount	Matrix Result	Rec.	Rec. Limit	RPD	RPD Limit
DRO	232	mg/Kg	1	250	19	85	27.8 - 152.1	1	20

Percent recovery is based on the spike result. RPD is based on the spike and spike duplicate result.

Surrogate	LCS Result	LCSD Result	Units	Dil.	Spike Amount	LCS Rec.	LCSD Rec.	Rec. Limit
n-Triacontane	75.4	75.4	mg/Kg	1	100	75	75	38 - 130.4

Laboratory Control Spike (LCS-1)

QC Batch: 48934
Prep Batch: 42034

Date Analyzed: 2008-05-31
QC Preparation: 2008-05-30

Analyzed By: DC
Prepared By: DC

Param	LCS Result	Units	Dil.	Spike Amount	Matrix Result	Rec.	Rec. Limit
GRO	7.97	mg/Kg	1	10.0	<0.739	80	70 - 130

Percent recovery is based on the spike result. RPD is based on the spike and spike duplicate result.

Param	LCSD Result	Units	Dil.	Spike Amount	Matrix Result	Rec.	Rec. Limit	RPD	RPD Limit
GRO	8.34	mg/Kg	1	10.0	<0.739	83	70 - 130	4	20

Percent recovery is based on the spike result. RPD is based on the spike and spike duplicate result.

Surrogate	LCS Result	LCSD Result	Units	Dil.	Spike Amount	LCS Rec.	LCSD Rec.	Rec. Limit
Trifluorotoluene (TFT)	1.03	1.04	mg/Kg	1	1.00	103	104	70 - 130
4-Bromofluorobenzene (4-BFB)	1.02	1.00	mg/Kg	1	1.00	102	100	70 - 130

Matrix Spike (MS-1) Spiked Sample: 161350

QC Batch: 48921
Prep Batch: 42039

Date Analyzed: 2008-05-30
QC Preparation: 2008-05-30

Analyzed By: LD
Prepared By: LD

Report Date: June 2, 2008
Denton Gathering Line

Work Order: 8052943
Denton Gathering Line

Page Number: 8 of 9
Lea County, NM

Param	MS Result	Units	Dil.	Spike Amount	Matrix Result	Rec.	Rec. Limit
DRO	¹ 735	mg/Kg	1	250	58.18	271	18 - 179.5

Percent recovery is based on the spike result. RPD is based on the spike and spike duplicate result.

Param	MSD Result	Units	Dil.	Spike Amount	Matrix Result	Rec.	Rec. Limit	RPD	RPD Limit
DRO	² 516	mg/Kg	1	250	58.18	183	18 - 179.5	35	20

Percent recovery is based on the spike result. RPD is based on the spike and spike duplicate result.

Surrogate	MS Result	MSD Result	Units	Dil.	Spike Amount	MS Rec.	MSD Rec.	Rec. Limit
n-Triacontane	128	100	mg/Kg	1	100	128	100	34.1 - 158

Matrix Spike (MS-1) Spiked Sample: 161565

QC Batch: 48934
Prep Batch: 42034

Date Analyzed: 2008-05-31
QC Preparation: 2008-05-30

Analyzed By: DC
Prepared By: DC

Param	MS Result	Units	Dil.	Spike Amount	Matrix Result	Rec.	Rec. Limit
GRO	³ 54.2	mg/Kg	1	10.0	39.8607	143	70 - 130

Percent recovery is based on the spike result. RPD is based on the spike and spike duplicate result.

Param	MSD Result	Units	Dil.	Spike Amount	Matrix Result	Rec.	Rec. Limit	RPD	RPD Limit
GRO	52.3	mg/Kg	1	10.0	39.8607	124	70 - 130	4	20

Percent recovery is based on the spike result. RPD is based on the spike and spike duplicate result.

Surrogate	MS Result	MSD Result	Units	Dil.	Spike Amount	MS Rec.	MSD Rec.	Rec. Limit
Trifluorotoluene (TFT)	0.961	0.919	mg/Kg	1	1	96	92	70 - 130
4-Bromofluorobenzene (4-BFB)	1.03	0.944	mg/Kg	1	1	103	94	70 - 130

Standard (CCV-1)

QC Batch: 48921

Date Analyzed: 2008-05-30

Analyzed By: LD

Param	Flag	Units	CCVs True Conc.	CCVs Found Conc.	CCVs Percent Recovery	Percent Recovery Limits	Date Analyzed
DRO		mg/Kg	250	236	94	85 - 115	2008-05-30

¹Matrix spike recovery out of control limits due to peak interference. Use LCS/LCSD to demonstrate analysis is under control.

²Matrix spike recovery out of control limits due to peak interference. Use LCS/LCSD to demonstrate analysis is under control.

³Matrix spike recovery out of control limits due to peak interference. Use LCS/LCSD to demonstrate analysis is under control.

Report Date: June 2, 2008
Denton Gathering Line

Work Order: 8052943
Denton Gathering Line

Page Number: 9 of 9
Lea County, NM

Standard (CCV-2)

QC Batch: 48921

Date Analyzed: 2008-05-30

Analyzed By: LD

Param	Flag	Units	CCVs True Conc.	CCVs Found Conc.	CCVs Percent Recovery	Percent Recovery Limits	Date Analyzed
DRO		mg/Kg	250	214	86	85 - 115	2008-05-30

Standard (ICV-1)

QC Batch: 48934

Date Analyzed: 2008-05-31

Analyzed By: DC

Param	Flag	Units	ICVs True Conc.	ICVs Found Conc.	ICVs Percent Recovery	Percent Recovery Limits	Date Analyzed
GRO		mg/Kg	1.00	0.949	95	85 - 115	2008-05-31

Standard (CCV-1)

QC Batch: 48934

Date Analyzed: 2008-05-31

Analyzed By: DC

Param	Flag	Units	CCVs True Conc.	CCVs Found Conc.	CCVs Percent Recovery	Percent Recovery Limits	Date Analyzed
GRO		mg/Kg	1.00	0.941	94	85 - 115	2008-05-31



6701 Aberdeen Avenue, Suite 9 Lubbock, Texas 79424 800•378•1296 806•794•1296 FAX 806•794•1296
200 East Sunset Road, Suite E El Paso, Texas 79922 888•588•3443 915•585•3443 FAX 915•595•4944
5002 Basin Street, Suite A1 Midland, Texas 79703 432•689•6301 FAX 432•689•6313
6015 Harris Parkway, Suite 110 Ft. Worth, Texas 76132 817•201•5260
E-Mail: lab@traceanalysis.com

Analytical and Quality Control Report

Ron Rounsaville
Nova Safety & Environmental
2057 Commerce St.
Midland, TX, 79703

Report Date: June 12, 2008

Work Order: 8060602



Project Location: Lea County, NM
Project Name: Denton Gathering
Project Number: Denton Gathering

Enclosed are the Analytical Report and Quality Control Report for the following sample(s) submitted to TraceAnalysis, Inc.

Sample	Description	Matrix	Date Taken	Time Taken	Date Received
162074	SE-SP A2-2	soil	2008-06-05	11:20	2008-06-05
162075	N-SP A2-2	soil	2008-06-05	11:50	2008-06-05
162076	N-SP B2-2	soil	2008-06-05	11:30	2008-06-05
162077	N-SP C2-2	soil	2008-06-05	11:40	2008-06-05

These results represent only the samples received in the laboratory. The Quality Control Report is generated on a batch basis. All information contained in this report is for the analytical batch(es) in which your sample(s) were analyzed.

This report consists of a total of 11 pages and shall not be reproduced except in its entirety, without written approval of TraceAnalysis, Inc.

Dr. Blair Leftwich, Director

Certifications

Lubbock - NELAP T104704219-08-TX

El Paso - NELAP T104704221-08-TX

Standard Flags

B - The sample contains less than ten times the concentration found in the method blank.

Case Narrative

Samples for project Denton Gathering were received by TraceAnalysis, Inc. on 2008-06-05 and assigned to work order 8060602. Samples for work order 8060602 were received intact at a temperature of 3.0 deg C.

Samples were analyzed for the following tests using their respective methods.

Test	Method
TPH DRO	Mod. 8015B
TPH GRO	S 8015B

Results for these samples are reported on a wet weight basis unless data package indicates otherwise.

A matrix spike (MS) and matrix spike duplicate (MSD) sample is chosen at random from each preparation batch. The MS and MSD will indicate if a site specific matrix problem is occurring, however, it may not pertain to the samples for work order 8060602 since the sample was chosen at random. Therefore, the validity of the analytical data reported has been determined by the laboratory control sample (LCS) and the method blank (MB). These quality control measures are performed with each preparation batch to ensure data integrity.

All other exceptions associated with this report have been footnoted on the appropriate analytical page to assist in general data comprehension. Please contact the laboratory directly if there are any questions regarding this project.

Report Date: June 12, 2008
Denton Gathering

Work Order: 8060602
Denton Gathering

Page Number: 4 of 11
Lea County, NM

Analytical Report

Sample: 162074 - SE-SP A2-2

Laboratory: Midland
Analysis: TPH DRO
QC Batch: 49132
Prep Batch: 42187

Analytical Method: Mod. 8015B
Date Analyzed: 2008-06-06
Sample Preparation: 2008-06-06

Prep Method: N/A
Analyzed By: LD
Prepared By: LD

Parameter	Flag	RL Result	Units	Dilution	RL
DRO		126	mg/Kg	1	50.0

Surrogate	Flag	Result	Units	Dilution	Spike Amount	Percent Recovery	Recovery Limits
n-Triacontane		122	mg/Kg	1	100	122	10 - 250.4

Sample: 162074 - SE-SP A2-2

Laboratory: Midland
Analysis: TPH GRO
QC Batch: 49181
Prep Batch: 42245

Analytical Method: S 8015B
Date Analyzed: 2008-06-09
Sample Preparation: 2008-06-09

Prep Method: S 5035
Analyzed By: DC
Prepared By: DC

Parameter	Flag	RL Result	Units	Dilution	RL
GRO		<1.00	mg/Kg	1	1.00

Surrogate	Flag	Result	Units	Dilution	Spike Amount	Percent Recovery	Recovery Limits
Trifluorotoluene (TFT)		0.928	mg/Kg	1	1.00	93	67.5 - 135.2
4-Bromofluorobenzene (4-BFB)		1.00	mg/Kg	1	1.00	100	63.8 - 141

Sample: 162075 - N-SP A2-2

Laboratory: Midland
Analysis: TPH DRO
QC Batch: 49132
Prep Batch: 42187

Analytical Method: Mod. 8015B
Date Analyzed: 2008-06-06
Sample Preparation: 2008-06-06

Prep Method: N/A
Analyzed By: LD
Prepared By: LD

Parameter	Flag	RL Result	Units	Dilution	RL
DRO		244	mg/Kg	1	50.0

Report Date: June 12, 2008
Denton Gathering

Work Order: 8060602
Denton Gathering

Page Number: 5 of 11
Lea County, NM

Surrogate	Flag	Result	Units	Dilution	Spike Amount	Percent Recovery	Recovery Limits
n-Triacontane		164	mg/Kg	1	100	164	10 - 250.4

Sample: 162075 - N-SP A2-2

Laboratory: Midland
Analysis: TPH GRO
QC Batch: 49181
Prep Batch: 42245

Analytical Method: S 8015B
Date Analyzed: 2008-06-09
Sample Preparation: 2008-06-09

Prep Method: S 5035
Analyzed By: DC
Prepared By: DC

Parameter	Flag	RL Result	Units	Dilution	RL
GRO		13.6	mg/Kg	1	1.00

Surrogate	Flag	Result	Units	Dilution	Spike Amount	Percent Recovery	Recovery Limits
Trifluorotoluene (TFT)		0.945	mg/Kg	1	1.00	94	67.5 - 135.2
4-Bromofluorobenzene (4-BFB)		1.11	mg/Kg	1	1.00	111	63.8 - 141

Sample: 162076 - N-SP B2-2

Laboratory: Midland
Analysis: TPH DRO
QC Batch: 49132
Prep Batch: 42187

Analytical Method: Mod. 8015B
Date Analyzed: 2008-06-06
Sample Preparation: 2008-06-06

Prep Method: N/A
Analyzed By: LD
Prepared By: LD

Parameter	Flag	RL Result	Units	Dilution	RL
DRO		323	mg/Kg	1	50.0

Surrogate	Flag	Result	Units	Dilution	Spike Amount	Percent Recovery	Recovery Limits
n-Triacontane		148	mg/Kg	1	100	148	10 - 250.4

Sample: 162076 - N-SP B2-2

Laboratory: Midland
Analysis: TPH GRO
QC Batch: 49181
Prep Batch: 42245

Analytical Method: S 8015B
Date Analyzed: 2008-06-09
Sample Preparation: 2008-06-09

Prep Method: S 5035
Analyzed By: DC
Prepared By: DC

continued ...

Report Date: June 12, 2008
Denton Gathering

Work Order: 8060602
Denton Gathering

Page Number: 6 of 11
Lea County, NM

sample 162076 continued ...

Parameter	Flag	RL Result	Units	Dilution	RL
Parameter	Flag	RL Result	Units	Dilution	RL
GRO		22.6	mg/Kg	1	1.00

Surrogate	Flag	Result	Units	Dilution	Spike Amount	Percent Recovery	Recovery Limits
Trifluorotoluene (TFT)		0.952	mg/Kg	1	1.00	95	67.5 - 135.2
4-Bromofluorobenzene (4-BFB)		1.18	mg/Kg	1	1.00	118	63.8 - 141

Sample: 162077 - N-SP C2-2

Laboratory: Midland
Analysis: TPH DRO
QC Batch: 49132
Prep Batch: 42187

Analytical Method: Mod. 8015B
Date Analyzed: 2008-06-06
Sample Preparation: 2008-06-06

Prep Method: N/A
Analyzed By: LD
Prepared By: LD

Parameter	Flag	RL Result	Units	Dilution	RL
DRO		224	mg/Kg	1	50.0

Surrogate	Flag	Result	Units	Dilution	Spike Amount	Percent Recovery	Recovery Limits
n-Triacontane		148	mg/Kg	1	100	148	10 - 250.4

Sample: 162077 - N-SP C2-2

Laboratory: Midland
Analysis: TPH GRO
QC Batch: 49233
Prep Batch: 42289

Analytical Method: S 8015B
Date Analyzed: 2008-06-10
Sample Preparation: 2008-06-10

Prep Method: S 5035
Analyzed By: DC
Prepared By: DC

Parameter	Flag	RL Result	Units	Dilution	RL
GRO		8.90	mg/Kg	1	1.00

Surrogate	Flag	Result	Units	Dilution	Spike Amount	Percent Recovery	Recovery Limits
Trifluorotoluene (TFT)		0.923	mg/Kg	1	1.00	92	67.5 - 135.2
4-Bromofluorobenzene (4-BFB)		1.10	mg/Kg	1	1.00	110	63.8 - 141

Report Date: June 12, 2008
Denton Gathering

Work Order: 8060602
Denton Gathering

Page Number: 7 of 11
Lea County, NM

Method Blank (1) QC Batch: 49132

QC Batch: 49132
Prep Batch: 42187

Date Analyzed: 2008-06-06
QC Preparation: 2008-06-06

Analyzed By: LD
Prepared By: LD

Parameter	Flag	MDL Result	Units	RL
DRO		<15.8	mg/Kg	50

Surrogate	Flag	Result	Units	Dilution	Spike Amount	Percent Recovery	Recovery Limits
n-Triacontane		81.1	mg/Kg	1	100	81	30.9 - 146.4

Method Blank (1) QC Batch: 49181

QC Batch: 49181
Prep Batch: 42245

Date Analyzed: 2008-06-09
QC Preparation: 2008-06-09

Analyzed By: DC
Prepared By: DC

Parameter	Flag	MDL Result	Units	RL
GRO		<0.739	mg/Kg	1

Surrogate	Flag	Result	Units	Dilution	Spike Amount	Percent Recovery	Recovery Limits
Trifluorotoluene (TFT)		1.02	mg/Kg	1	1.00	102	39.2 - 135.2
4-Bromofluorobenzene (4-BFB)		0.988	mg/Kg	1	1.00	99	16.8 - 138.1

Method Blank (1) QC Batch: 49233

QC Batch: 49233
Prep Batch: 42289

Date Analyzed: 2008-06-10
QC Preparation: 2008-06-10

Analyzed By: DC
Prepared By: DC

Parameter	Flag	MDL Result	Units	RL
GRO		<0.739	mg/Kg	1

Surrogate	Flag	Result	Units	Dilution	Spike Amount	Percent Recovery	Recovery Limits
Trifluorotoluene (TFT)		0.959	mg/Kg	1	1.00	96	39.2 - 135.2
4-Bromofluorobenzene (4-BFB)		0.933	mg/Kg	1	1.00	93	16.8 - 138.1

Report Date: June 12, 2008
Denton Gathering

Work Order: 8060602
Denton Gathering

Page Number: 8 of 11
Lea County, NM

Laboratory Control Spike (LCS-1)

QC Batch: 49132
Prep Batch: 42187

Date Analyzed: 2008-06-06
QC Preparation: 2008-06-06

Analyzed By: LD
Prepared By: LD

Param	LCS Result	Units	Dil.	Spike Amount	Matrix Result	Rec.	Rec. Limit
DRO	197	mg/Kg	1	250	<15.8	79	27.8 - 152.1

Percent recovery is based on the spike result. RPD is based on the spike and spike duplicate result.

Param	LCSD Result	Units	Dil.	Spike Amount	Matrix Result	Rec.	Rec. Limit	RPD	RPD Limit
DRO	208	mg/Kg	1	250	<15.8	83	27.8 - 152.1	5	20

Percent recovery is based on the spike result. RPD is based on the spike and spike duplicate result.

Surrogate	LCS Result	LCSD Result	Units	Dil.	Spike Amount	LCS Rec.	LCSD Rec.	Rec. Limit
n-Triacontane	81.6	83.1	mg/Kg	1	100	82	83	38 - 130.4

Laboratory Control Spike (LCS-1)

QC Batch: 49181
Prep Batch: 42245

Date Analyzed: 2008-06-09
QC Preparation: 2008-06-09

Analyzed By: DC
Prepared By: DC

Param	LCS Result	Units	Dil.	Spike Amount	Matrix Result	Rec.	Rec. Limit
GRO	9.65	mg/Kg	1	10.0	<0.739	96	57.5 - 106.4

Percent recovery is based on the spike result. RPD is based on the spike and spike duplicate result.

Param	LCSD Result	Units	Dil.	Spike Amount	Matrix Result	Rec.	Rec. Limit	RPD	RPD Limit
GRO	10.2	mg/Kg	1	10.0	<0.739	102	57.5 - 106.4	6	20

Percent recovery is based on the spike result. RPD is based on the spike and spike duplicate result.

Surrogate	LCS Result	LCSD Result	Units	Dil.	Spike Amount	LCS Rec.	LCSD Rec.	Rec. Limit
Trifluorotoluene (TFT)	1.05	1.06	mg/Kg	1	1.00	105	106	63.8 - 134.3
4-Bromofluorobenzene (4-BFB)	1.04	1.05	mg/Kg	1	1.00	104	105	53.3 - 123.6

Laboratory Control Spike (LCS-1)

QC Batch: 49233
Prep Batch: 42289

Date Analyzed: 2008-06-10
QC Preparation: 2008-06-10

Analyzed By: DC
Prepared By: DC

Report Date: June 12, 2008
Denton Gathering

Work Order: 8060602
Denton Gathering

Page Number: 9 of 11
Lea County, NM

Param	LCS Result	Units	Dil.	Spike Amount	Matrix Result	Rec.	Rec. Limit
GRO	7.67	mg/Kg	1	10.0	<0.739	77	57.5 - 106.4

Percent recovery is based on the spike result. RPD is based on the spike and spike duplicate result.

Param	LCSD Result	Units	Dil.	Spike Amount	Matrix Result	Rec.	Rec. Limit	RPD	RPD Limit
GRO	7.74	mg/Kg	1	10.0	<0.739	77	57.5 - 106.4	1	20

Percent recovery is based on the spike result. RPD is based on the spike and spike duplicate result.

Surrogate	LCS Result	LCSD Result	Units	Dil.	Spike Amount	LCS Rec.	LCSD Rec.	Rec. Limit
Trifluorotoluene (TFT)	0.906	0.925	mg/Kg	1	1.00	91	92	63.8 - 134.3
4-Bromofluorobenzene (4-BFB)	0.905	0.913	mg/Kg	1	1.00	90	91	53.3 - 123.6

Matrix Spike (MS-1) Spiked Sample: 162074

QC Batch: 49132
Prep Batch: 42187

Date Analyzed: 2008-06-06
QC Preparation: 2008-06-06

Analyzed By: LD
Prepared By: LD

Param	MS Result	Units	Dil.	Spike Amount	Matrix Result	Rec.	Rec. Limit
DRO	395	mg/Kg	1	250	125.86	108	18 - 179.5

Percent recovery is based on the spike result. RPD is based on the spike and spike duplicate result.

Param	MSD Result	Units	Dil.	Spike Amount	Matrix Result	Rec.	Rec. Limit	RPD	RPD Limit
DRO	336	mg/Kg	1	250	125.86	84	18 - 179.5	16	20

Percent recovery is based on the spike result. RPD is based on the spike and spike duplicate result.

Surrogate	MS Result	MSD Result	Units	Dil.	Spike Amount	MS Rec.	MSD Rec.	Rec. Limit
n-Triacontane	141	138	mg/Kg	1	100	141	138	34.1 - 158

Matrix Spike (MS-1) Spiked Sample: 161949

QC Batch: 49181
Prep Batch: 42245

Date Analyzed: 2008-06-09
QC Preparation: 2008-06-09

Analyzed By: DC
Prepared By: DC

Param	MS Result	Units	Dil.	Spike Amount	Matrix Result	Rec.	Rec. Limit
GRO	11.6	mg/Kg	1	10.0	<0.739	116	10 - 139.3

Percent recovery is based on the spike result. RPD is based on the spike and spike duplicate result.

Report Date: June 12, 2008
Denton Gathering

Work Order: 8060602
Denton Gathering

Page Number: 10 of 11
Lea County, NM

Param	MSD Result	Units	Dil.	Spike Amount	Matrix Result	Rec.	Rec. Limit	RPD	RPD Limit
GRO	20.4	mg/Kg	1	10.0	<0.739	204	10 - 139.3	55	20

Percent recovery is based on the spike result. RPD is based on the spike and spike duplicate result.

Surrogate	MS Result	MSD Result	Units	Dil.	Spike Amount	MS Rec.	MSD Rec.	Rec. Limit
Trifluorotoluene (TFT)	1.08	1.09	mg/Kg	1	1	108	109	21.3 - 119
4-Bromofluorobenzene (4-BFB)	1.05	1.06	mg/Kg	1	1	105	106	52.5 - 154

Matrix Spike (MS-1) Spiked Sample: 162290

QC Batch: 49233
Prep Batch: 42289

Date Analyzed: 2008-06-10
QC Preparation: 2008-06-10

Analyzed By: DC
Prepared By: DC

Param	MS Result	Units	Dil.	Spike Amount	Matrix Result	Rec.	Rec. Limit
GRO	10.4	mg/Kg	1	10.0	<0.739	104	10 - 139.3

Percent recovery is based on the spike result. RPD is based on the spike and spike duplicate result.

Param	MSD Result	Units	Dil.	Spike Amount	Matrix Result	Rec.	Rec. Limit	RPD	RPD Limit
GRO	10.3	mg/Kg	1	10.0	<0.739	103	10 - 139.3	1	20

Percent recovery is based on the spike result. RPD is based on the spike and spike duplicate result.

Surrogate	MS Result	MSD Result	Units	Dil.	Spike Amount	MS Rec.	MSD Rec.	Rec. Limit
Trifluorotoluene (TFT)	0.900	0.908	mg/Kg	1	1	90	91	21.3 - 119
4-Bromofluorobenzene (4-BFB)	0.975	0.975	mg/Kg	1	1	98	98	52.5 - 154

Standard (ICV-1)

QC Batch: 49132

Date Analyzed: 2008-06-06

Analyzed By: LD

Param	Flag	Units	ICVs True Conc.	ICVs Found Conc.	ICVs Percent Recovery	Percent Recovery Limits	Date Analyzed
DRO		mg/Kg	250	212	85	85 - 115	2008-06-06

Standard (CCV-1)

QC Batch: 49132

Date Analyzed: 2008-06-06

Analyzed By: LD

¹Matrix spike recovery out of control limits due to matrix interference. Use LCS/LCSD to demonstrate analysis is under control.

Report Date: June 12, 2008
Denton Gathering

Work Order: 8060602
Denton Gathering

Page Number: 11 of 11
Lea County, NM

Param	Flag	Units	CCVs True Conc.	CCVs Found Conc.	CCVs Percent Recovery	Percent Recovery Limits	Date Analyzed
DRO		mg/Kg	250	225	90	85 - 115	2008-06-06

Standard (ICV-1)

QC Batch: 49181

Date Analyzed: 2008-06-09

Analyzed By: DC

Param	Flag	Units	ICVs True Conc.	ICVs Found Conc.	ICVs Percent Recovery	Percent Recovery Limits	Date Analyzed
GRO		mg/Kg	1.00	1.08	108	85 - 115	2008-06-09

Standard (CCV-1)

QC Batch: 49181

Date Analyzed: 2008-06-09

Analyzed By: DC

Param	Flag	Units	CCVs True Conc.	CCVs Found Conc.	CCVs Percent Recovery	Percent Recovery Limits	Date Analyzed
GRO		mg/Kg	1.00	0.939	94	85 - 115	2008-06-09

Standard (ICV-1)

QC Batch: 49233

Date Analyzed: 2008-06-10

Analyzed By: DC

Param	Flag	Units	ICVs True Conc.	ICVs Found Conc.	ICVs Percent Recovery	Percent Recovery Limits	Date Analyzed
GRO		mg/Kg	1.00	0.996	100	85 - 115	2008-06-10

Standard (CCV-1)

QC Batch: 49233

Date Analyzed: 2008-06-10

Analyzed By: DC

Param	Flag	Units	CCVs True Conc.	CCVs Found Conc.	CCVs Percent Recovery	Percent Recovery Limits	Date Analyzed
GRO		mg/Kg	1.00	0.948	95	85 - 115	2008-06-10

TraceAnalysis, Inc.

email: lab@traceanalysis.com

6701 Aberdeen Avenue, Suite 9
Lubbock, Texas 79424
Tel (806) 794-1296
Fax (806) 794-1298
T (800) 378-1296

5002 Basin Street, Suite A1
Midland, Texas 79703
Tel (432) 688-6301
Fax (432) 688-6313

200 East Sunset Rd., Suite E
El Paso, Texas 79922
Tel (915) 585-3443
Fax (915) 585-4944
T (888) 588-3443

Page 1 of 1

LAB Order ID # 8060602

Company Name: NOVA Environmental Phone #: 520-7720

Address: (Street, City, Zip) Fax #:

Contact Person: Ron Rounsaville Email: rounsaville@novatrainig.cc

Invoice to: (If different from above) Centurion

Project #: Project Name: Denton Gutierrez

Project Location (including state): LISA County, NM Sampler Signature:

FIELD CODE	# CONTAINERS	Volume / Amount	MATRIX				PRESERVATIVE METHOD						SAMPLING		Turn Around Time if d	Hold
			WATER	SOIL	AIR	SLUDGE	HCl	HNO ₃	H ₂ SO ₄	NaOH	ICE	NONE	DATE	TIME		
162074 SE-SP A2-2	1	4oz.	X							X		6-5	11:20			
075 N-SP A2-2	1	}	X							X		6-5	11:50			
076 N-SP B2-2	1	}	X							X		6-5	11:30			
077 N-SP C2-2	1	}	X							X		6-5	11:40			

Relinquished by: <i>[Signature]</i>	Company: <i>Trace</i>	Date: 6/5/04	Time: 1700	Received by: <i>[Signature]</i>	Company: <i>Trace</i>	Date: 6/5/04	Time: 11:00	Temp °C: 3.4 °C
Relinquished by: <i>[Signature]</i>	Company: <i>Trace</i>	Date: 6/5/04	Time: 1700	Received by: <i>[Signature]</i>	Company: <i>Trace</i>	Date: 6/5/04	Time: 11:00	Temp °C: 3.4 °C
Relinquished by: <i>[Signature]</i>	Company: <i>Trace</i>	Date: 6/5/04	Time: 1700	Received by: <i>[Signature]</i>	Company: <i>Trace</i>	Date: 6/5/04	Time: 11:00	Temp °C: 3.4 °C

ANALYSIS REQUEST (Circle or Specify Method No.)

MTBE 8021B / 602 / 8260B / 624	TPH 418.1 / TX1005 / TX1005 Ext(C35)	TPH 8015 GRO / DRO TVHC	PAH 8270C / 625	Total Metals Ag As Ba Cd Cr Pb Se Hg 6010B/200.7	TCLP Metals Ag As Ba Cd Cr Pb Se Hg	TCLP Volatiles	TCLP Semi Volatiles	TCLP Pesticides	RCI	GC/MS Vol. 8260B / 624	GC/MS Semi. Vol. 8270C / 625	PCBs 8082 / 608	Pesticides 8081A / 608	BOD, TSS, pH	Moisture Content	Turn Around Time if different from standard
--------------------------------	--------------------------------------	-------------------------	-----------------	--	-------------------------------------	----------------	---------------------	-----------------	-----	------------------------	------------------------------	-----------------	------------------------	--------------	------------------	---

REMARKS: All tests - Midland

☐ Dry Weight Basis Required
☐ TRRP Report Required
☐ Check if Special Reporting Limits Are Needed

Submittal of samples constitutes agreement to Terms and Conditions listed on reverse side of C. O. C.

ORIGINAL COPY

Carrier # *Car*



6701 Aberdeen Avenue, Suite 9. Lubbock, Texas 79424 800•378•1296 806•794•1296 FAX 806•794•1298
200 East Sunset Road, Suite E El Paso, Texas 79922 888•588•3443 915•585•3443 FAX 915•585•4944
5002 Basin Street, Suite A1 Midland, Texas 79703 432•689•6301 FAX 432•689•6313
6015 Harris Parkway, Suite 110 Ft. Worth, Texas 76132 817•201•5250
E-Mail: lab@traceanalysis.com

Analytical and Quality Control Report

Ron Rounsaville
Nova Safety & Environmental
2057 Commerce St.
Midland, TX, 79703

Report Date: June 19, 2008

Work Order: 8061238



Project Location: Lea County, NM
Project Name: Denton Gathering
Project Number: Denton Gathering

Enclosed are the Analytical Report and Quality Control Report for the following sample(s) submitted to TraceAnalysis, Inc.

Sample	Description	Matrix	Date Taken	Time Taken	Date Received
162999	N. Stockpile A-3	soil	2008-06-11	12:05	2008-06-12
163000	N. Stockpile B-3	soil	2008-06-11	12:10	2008-06-12
163001	N. Stockpile C-3	soil	2008-06-11	12:15	2008-06-12
163002	SE Stockpile A-3	soil	2008-06-11	12:00	2008-06-12

These results represent only the samples received in the laboratory. The Quality Control Report is generated on a batch basis. All information contained in this report is for the analytical batch(es) in which your sample(s) were analyzed.

This report consists of a total of 10 pages and shall not be reproduced except in its entirety, without written approval of TraceAnalysis, Inc.

Dr. Blair Leftwich, Director

Certifications

Lubbock - NELAP T104704219-08-TX

El Paso - NELAP T104704221-08-TX

Standard Flags

B - The sample contains less than ten times the concentration found in the method blank.

Case Narrative

Samples for project Denton Gathering were received by TraceAnalysis, Inc. on 2008-06-12 and assigned to work order 8061238. Samples for work order 8061238 were received intact at a temperature of 3.4 deg C.

Samples were analyzed for the following tests using their respective methods.

Test	Method
TPH DRO	Mod. 8015B
TPH GRO	S 8015B

Results for these samples are reported on a wet weight basis unless data package indicates otherwise.

A matrix spike (MS) and matrix spike duplicate (MSD) sample is chosen at random from each preparation batch. The MS and MSD will indicate if a site specific matrix problem is occurring, however, it may not pertain to the samples for work order 8061238 since the sample was chosen at random. Therefore, the validity of the analytical data reported has been determined by the laboratory control sample (LCS) and the method blank (MB). These quality control measures are performed with each preparation batch to ensure data integrity.

All other exceptions associated with this report have been footnoted on the appropriate analytical page to assist in general data comprehension. Please contact the laboratory directly if there are any questions regarding this project.

Report Date: June 19, 2008
Denton Gathering

Work Order: 8061238
Denton Gathering

Page Number: 4 of 10
Lea County, NM

Analytical Report

Sample: 162999 - N. Stockpile A-3

Laboratory: Midland
Analysis: TPH DRO
QC Batch: 49287
Prep Batch: 42344

Analytical Method: Mod. 8015B
Date Analyzed: 2008-06-12
Sample Preparation: 2008-06-12

Prep Method: N/A
Analyzed By: LD
Prepared By: LD

Parameter	Flag	RL Result	Units	Dilution	RL
DRO		287	mg/Kg	1	50.0

Surrogate	Flag	Result	Units	Dilution	Spike Amount	Percent Recovery	Recovery Limits
n-Triacontane	1	270	mg/Kg	1	100	270	10 - 250.4

Sample: 162999 - N. Stockpile A-3

Laboratory: Midland
Analysis: TPH GRO
QC Batch: 49451
Prep Batch: 42420

Analytical Method: S 8015B
Date Analyzed: 2008-06-17
Sample Preparation: 2008-06-16

Prep Method: S 5035
Analyzed By: DC
Prepared By: DC

Parameter	Flag	RL Result	Units	Dilution	RL
GRO		<1.00	mg/Kg	1	1.00

Surrogate	Flag	Result	Units	Dilution	Spike Amount	Percent Recovery	Recovery Limits
Trifluorotoluene (TFT)		0.900	mg/Kg	1	1.00	90	67.5 - 135.2
4-Bromofluorobenzene (4-BFB)		0.899	mg/Kg	1	1.00	90	63.8 - 141

Sample: 163000 - N. Stockpile B-3

Laboratory: Midland
Analysis: TPH DRO
QC Batch: 49287
Prep Batch: 42344

Analytical Method: Mod. 8015B
Date Analyzed: 2008-06-12
Sample Preparation: 2008-06-12

Prep Method: N/A
Analyzed By: LD
Prepared By: LD

Parameter	Flag	RL Result	Units	Dilution	RL
DRO		189	mg/Kg	1	50.0

¹High surrogate recovery due to peak interference.

Report Date: June 19, 2008
Denton Gathering

Work Order: 8061238
Denton Gathering

Page Number: 5 of 10
Lea County, NM

Surrogate	Flag	Result	Units	Dilution	Spike Amount	Percent Recovery	Recovery Limits
n-Triacontane		219	mg/Kg	1	100	219	10 - 250.4

Sample: 163000 - N. Stockpile B-3

Laboratory: Midland
Analysis: TPH GRO
QC Batch: 49451
Prep Batch: 42420

Analytical Method: S 8015B
Date Analyzed: 2008-06-17
Sample Preparation: 2008-06-16

Prep Method: S 5035
Analyzed By: DC
Prepared By: DC

Parameter	Flag	RL Result	Units	Dilution	RL
GRO		3.94	mg/Kg	1	1.00

Surrogate	Flag	Result	Units	Dilution	Spike Amount	Percent Recovery	Recovery Limits
Trifluorotoluene (TFT)		0.902	mg/Kg	1	1.00	90	67.5 - 135.2
4-Bromofluorobenzene (4-BFB)		0.946	mg/Kg	1	1.00	95	63.8 - 141

Sample: 163001 - N. Stockpile C-3

Laboratory: Midland
Analysis: TPH DRO
QC Batch: 49287
Prep Batch: 42344

Analytical Method: Mod. 8015B
Date Analyzed: 2008-06-12
Sample Preparation: 2008-06-12

Prep Method: N/A
Analyzed By: LD
Prepared By: LD

Parameter	Flag	RL Result	Units	Dilution	RL
DRO		145	mg/Kg	1	50.0

Surrogate	Flag	Result	Units	Dilution	Spike Amount	Percent Recovery	Recovery Limits
n-Triacontane		162	mg/Kg	1	100	162	10 - 250.4

Sample: 163001 - N. Stockpile C-3

Laboratory: Midland
Analysis: TPH GRO
QC Batch: 49451
Prep Batch: 42420

Analytical Method: S 8015B
Date Analyzed: 2008-06-17
Sample Preparation: 2008-06-16

Prep Method: S 5035
Analyzed By: DC
Prepared By: DC

continued ...

Report Date: June 19, 2008
Denton Gathering

Work Order: 8061238
Denton Gathering

Page Number: 6 of 10
Lea County, NM

sample 163001 continued ...

Parameter	Flag	RL Result	Units	Dilution	RL
Parameter	Flag	RL Result	Units	Dilution	RL
GRO		1.48	mg/Kg	1	1.00

Surrogate	Flag	Result	Units	Dilution	Spike Amount	Percent Recovery	Recovery Limits
Trifluorotoluene (TFT)		0.960	mg/Kg	1	1.00	96	67.5 - 135.2
4-Bromofluorobenzene (4-BFB)		1.02	mg/Kg	1	1.00	102	63.8 - 141

Sample: 163002 - SE Stockpile A-3

Laboratory: Midland
Analysis: TPH DRO
QC Batch: 49287
Prep Batch: 42344

Analytical Method: Mod. 8015B
Date Analyzed: 2008-06-12
Sample Preparation: 2008-06-12

Prep Method: N/A
Analyzed By: LD
Prepared By: LD

Parameter	Flag	RL Result	Units	Dilution	RL
DRO		89.3	mg/Kg	1	50.0

Surrogate	Flag	Result	Units	Dilution	Spike Amount	Percent Recovery	Recovery Limits
n-Triacontane		128	mg/Kg	1	100	128	10 - 250.4

Sample: 163002 - SE Stockpile A-3

Laboratory: Midland
Analysis: TPH GRO
QC Batch: 49451
Prep Batch: 42420

Analytical Method: S 8015B
Date Analyzed: 2008-06-17
Sample Preparation: 2008-06-16

Prep Method: S 5035
Analyzed By: DC
Prepared By: DC

Parameter	Flag	RL Result	Units	Dilution	RL
GRO		<1.00	mg/Kg	1	1.00

Surrogate	Flag	Result	Units	Dilution	Spike Amount	Percent Recovery	Recovery Limits
Trifluorotoluene (TFT)		0.903	mg/Kg	1	1.00	90	67.5 - 135.2
4-Bromofluorobenzene (4-BFB)		0.947	mg/Kg	1	1.00	95	63.8 - 141

Report Date: June 19, 2008
Denton Gathering

Work Order: 8061238
Denton Gathering

Page Number: 7 of 10
Lea County, NM

Method Blank (1) QC Batch: 49287

QC Batch: 49287
Prep Batch: 42344

Date Analyzed: 2008-06-12
QC Preparation: 2008-06-12

Analyzed By: LD
Prepared By: LD

Parameter	Flag	MDL Result	Units	RL
DRO		<15.8	mg/Kg	50

Surrogate	Flag	Result	Units	Dilution	Spike Amount	Percent Recovery	Recovery Limits
n-Triacontane		135	mg/Kg	1	100	135	30.9 - 146.4

Method Blank (1) QC Batch: 49451

QC Batch: 49451
Prep Batch: 42420

Date Analyzed: 2008-06-17
QC Preparation: 2008-06-16

Analyzed By: DC
Prepared By: DC

Parameter	Flag	MDL Result	Units	RL
GRO		<0.739	mg/Kg	1

Surrogate	Flag	Result	Units	Dilution	Spike Amount	Percent Recovery	Recovery Limits
Trifluorotoluene (TFT)		0.891	mg/Kg	1	1.00	89	39.2 - 135.2
4-Bromofluorobenzene (4-BFB)		0.883	mg/Kg	1	1.00	88	16.8 - 138.1

Laboratory Control Spike (LCS-1)

QC Batch: 49287
Prep Batch: 42344

Date Analyzed: 2008-06-12
QC Preparation: 2008-06-12

Analyzed By: LD
Prepared By: LD

Param	LCS Result	Units	Dil.	Spike Amount	Matrix Result	Rec.	Rec. Limit
DRO	235	mg/Kg	1	250	<15.8	94	27.8 - 152.1

Percent recovery is based on the spike result. RPD is based on the spike and spike duplicate result.

Param	LCSD Result	Units	Dil.	Spike Amount	Matrix Result	Rec.	Rec. Limit	RPD	RPD Limit
DRO	232	mg/Kg	1	250	<15.8	93	27.8 - 152.1	1	20

Percent recovery is based on the spike result. RPD is based on the spike and spike duplicate result.

continued ...

Report Date: June 19, 2008
Denton Gathering

Work Order: 8061238
Denton Gathering

Page Number: 8 of 10
Lea County, NM

control spikes continued ...

Surrogate	LCS Result	LCSD Result	Units	Dil.	Spike Amount	LCS Rec.	LCSD Rec.	Rec. Limit
Surrogate	LCS Result	LCSD Result	Units	Dil.	Spike Amount	LCS Rec.	LCSD Rec.	Rec. Limit
n-Triacontane	101	95.3	mg/Kg	1	100	101	95	38 - 130.4

Laboratory Control Spike (LCS-1)

QC Batch: 49451
Prep Batch: 42420

Date Analyzed: 2008-06-17
QC Preparation: 2008-06-16

Analyzed By: DC
Prepared By: DC

Param	LCS Result	Units	Dil.	Spike Amount	Matrix Result	Rec.	Rec. Limit
GRO	8.16	mg/Kg	1	10.0	<0.739	82	57.5 - 106.4

Percent recovery is based on the spike result. RPD is based on the spike and spike duplicate result.

Param	LCSD Result	Units	Dil.	Spike Amount	Matrix Result	Rec.	Rec. Limit	RPD	RPD Limit
GRO	8.25	mg/Kg	1	10.0	<0.739	82	57.5 - 106.4	1	20

Percent recovery is based on the spike result. RPD is based on the spike and spike duplicate result.

Surrogate	LCS Result	LCSD Result	Units	Dil.	Spike Amount	LCS Rec.	LCSD Rec.	Rec. Limit
Trifluorotoluene (TFT)	0.892	0.895	mg/Kg	1	1.00	89	90	63.8 - 134.3
4-Bromofluorobenzene (4-BFB)	0.915	0.919	mg/Kg	1	1.00	92	92	53.3 - 123.6

Matrix Spike (MS-1) Spiked Sample: 162864

QC Batch: 49287
Prep Batch: 42344

Date Analyzed: 2008-06-12
QC Preparation: 2008-06-12

Analyzed By: LD
Prepared By: LD

Param	MS Result	Units	Dil.	Spike Amount	Matrix Result	Rec.	Rec. Limit
DRO	1300	mg/Kg	1	250	1230	28	18 - 179.5

Percent recovery is based on the spike result. RPD is based on the spike and spike duplicate result.

Param	MSD Result	Units	Dil.	Spike Amount	Matrix Result	Rec.	Rec. Limit	RPD	RPD Limit
DRO	1300	mg/Kg	1	250	1230	28	18 - 179.5	0	20

Percent recovery is based on the spike result. RPD is based on the spike and spike duplicate result.

Report Date: June 19, 2008
Denton Gathering

Work Order: 8061238
Denton Gathering

Page Number: 9 of 10
Lea County, NM

Surrogate	MS Result	MSD Result	Units	Dil.	Spike Amount	MS Rec.	MSD Rec.	Rec. Limit
n-Triacontane ^{2 3}	362	530	mg/Kg	1	100	362	530	34.1 - 158

Matrix Spike (MS-1) Spiked Sample: 162999

QC Batch: 49451
Prep Batch: 42420

Date Analyzed: 2008-06-17
QC Preparation: 2008-06-16

Analyzed By: DC
Prepared By: DC

Param	MS Result	Units	Dil.	Spike Amount	Matrix Result	Rec.	Rec. Limit
GRO	12.6	mg/Kg	1	10.0	<0.739	126	10 - 139.3

Percent recovery is based on the spike result. RPD is based on the spike and spike duplicate result.

Param	MSD Result	Units	Dil.	Spike Amount	Matrix Result	Rec.	Rec. Limit	RPD	RPD Limit
GRO	13.8	mg/Kg	1	10.0	<0.739	138	10 - 139.3	9	20

Percent recovery is based on the spike result. RPD is based on the spike and spike duplicate result.

Surrogate	MS Result	MSD Result	Units	Dil.	Spike Amount	MS Rec.	MSD Rec.	Rec. Limit
Trifluorotoluene (TFT)	0.879	0.886	mg/Kg	1	1	88	89	21.3 - 119
4-Bromofluorobenzene (4-BFB)	0.917	0.881	mg/Kg	1	1	92	88	52.5 - 154

Standard (ICV-1)

QC Batch: 49287

Date Analyzed: 2008-06-12

Analyzed By: LD

Param	Flag	Units	ICVs True Conc.	ICVs Found Conc.	ICVs Percent Recovery	Percent Recovery Limits	Date Analyzed
DRO		mg/Kg	250	234	94	85 - 115	2008-06-12

Standard (CCV-1)

QC Batch: 49287

Date Analyzed: 2008-06-12

Analyzed By: LD

Param	Flag	Units	CCVs True Conc.	CCVs Found Conc.	CCVs Percent Recovery	Percent Recovery Limits	Date Analyzed
DRO		mg/Kg	250	233	93	85 - 115	2008-06-12

²High surrogate recovery due to peak interference.

³High surrogate recovery due to peak interference.

Report Date: June 19, 2008
Denton Gathering

Work Order: 8061238
Denton Gathering

Page Number: 10 of 10
Lea County, NM

Standard (ICV-1)

QC Batch: 49451

Date Analyzed: 2008-06-17

Analyzed By: DC

Param	Flag	Units	ICVs True Conc.	ICVs Found Conc.	ICVs Percent Recovery	Percent Recovery Limits	Date Analyzed
GRO		mg/Kg	1.00	0.970	97	85 - 115	2008-06-17

Standard (CCV-1)

QC Batch: 49451

Date Analyzed: 2008-06-17

Analyzed By: DC

Param	Flag	Units	CCVs True Conc.	CCVs Found Conc.	CCVs Percent Recovery	Percent Recovery Limits	Date Analyzed
GRO		mg/Kg	1.00	0.960	96	85 - 115	2008-06-17



6701 Aberdeen Avenue, Suite 9 Lubbock, Texas 79424 800•378•1296 806•794•1296 FAX 806•794•1298
200 East Sunset Road, Suite E El Paso, Texas 79922 888•588•3443 915•585•3443 FAX 915•585•4944
5002 Basin Street, Suite A1 Midland, Texas 79703 432•689•6301 FAX 432•689•6313
6015 Harris Parkway, Suite 110 Ft. Worth, Texas 76132 817•201•5260
E-Mail: lab@traceanalysis.com

Analytical and Quality Control Report

Ron Rounsaville
Nova Safety & Environmental
2057 Commerce St.
Midland, TX, 79703

Report Date: June 24, 2008

Work Order: 8062031



Project Location: Lea County, NM
Project Name: Denton Gathering
Project Number: Denton Gathering

Enclosed are the Analytical Report and Quality Control Report for the following sample(s) submitted to TraceAnalysis, Inc.

Sample	Description	Matrix	Date Taken	Time Taken	Date Received
164280	North SP-4A	soil	2008-06-19	11:35	2008-06-20
164281	North SP-4B	soil	2008-06-19	11:30	2008-06-20
164282	North SP-4C	soil	2008-06-19	11:40	2008-06-20

These results represent only the samples received in the laboratory. The Quality Control Report is generated on a batch basis. All information contained in this report is for the analytical batch(es) in which your sample(s) were analyzed.

This report consists of a total of 9 pages and shall not be reproduced except in its entirety, without written approval of TraceAnalysis, Inc.

Dr. Blair Leftwich, Director

Certifications

Lubbock - NELAP T104704219-08-TX
El Paso - NELAP T104704221-08-TX

Standard Flags

B - The sample contains less than ten times the concentration found in the method blank.

Case Narrative

Samples for project Denton Gathering were received by TraceAnalysis, Inc. on 2008-06-20 and assigned to work order 8062031. Samples for work order 8062031 were received intact at a temperature of 3.8 deg C.

Samples were analyzed for the following tests using their respective methods.

Test	Method
TPH DRO	Mod. 8015B
TPH GRO	S 8015B

Results for these samples are reported on a wet weight basis unless data package indicates otherwise.

A matrix spike (MS) and matrix spike duplicate (MSD) sample is chosen at random from each preparation batch. The MS and MSD will indicate if a site specific matrix problem is occurring, however, it may not pertain to the samples for work order 8062031 since the sample was chosen at random. Therefore, the validity of the analytical data reported has been determined by the laboratory control sample (LCS) and the method blank (MB). These quality control measures are performed with each preparation batch to ensure data integrity.

All other exceptions associated with this report have been footnoted on the appropriate analytical page to assist in general data comprehension. Please contact the laboratory directly if there are any questions regarding this project.

Report Date: June 24, 2008
Denton Gathering

Work Order: 8062031
Denton Gathering

Page Number: 4 of 9
Lea County, NM

Analytical Report

Sample: 164280 - North SP-4A

Laboratory: Midland
Analysis: TPH DRO
QC Batch: 49614
Prep Batch: 42583

Analytical Method: Mod. 8015B
Date Analyzed: 2008-06-20
Sample Preparation: 2008-06-20

Prep Method: N/A
Analyzed By: LD
Prepared By: LD

Parameter	Flag	RL Result	Units	Dilution	RL
DRO	B	206	mg/Kg	1	50.0

Surrogate	Flag	Result	Units	Dilution	Spike Amount	Percent Recovery	Recovery Limits
n-Triacontane		138	mg/Kg	1	100	138	10 - 250.4

Sample: 164280 - North SP-4A

Laboratory: Midland
Analysis: TPH GRO
QC Batch: 49664
Prep Batch: 42653

Analytical Method: S 8015B
Date Analyzed: 2008-06-24
Sample Preparation: 2008-06-23

Prep Method: S 5035
Analyzed By: DC
Prepared By: DC

Parameter	Flag	RL Result	Units	Dilution	RL
GRO		<1.00	mg/Kg	1	1.00

Surrogate	Flag	Result	Units	Dilution	Spike Amount	Percent Recovery	Recovery Limits
Trifluorotoluene (TFT)		0.967	mg/Kg	1	1.00	97	67.5 - 135.2
4-Bromofluorobenzene (4-BFB)		0.980	mg/Kg	1	1.00	98	63.8 - 141

Sample: 164281 - North SP-4B

Laboratory: Midland
Analysis: TPH DRO
QC Batch: 49614
Prep Batch: 42583

Analytical Method: Mod. 8015B
Date Analyzed: 2008-06-20
Sample Preparation: 2008-06-20

Prep Method: N/A
Analyzed By: LD
Prepared By: LD

Parameter	Flag	RL Result	Units	Dilution	RL
DRO	B	121	mg/Kg	1	50.0

Report Date: June 24, 2008
Denton Gathering

Work Order: 8062031
Denton Gathering

Page Number: 5 of 9
Lea County, NM

Surrogate	Flag	Result	Units	Dilution	Spike Amount	Percent Recovery	Recovery Limits
n-Triacontane		120	mg/Kg	1	100	120	10 - 250.4

Sample: 164281 - North SP-4B

Laboratory: Midland
Analysis: TPH GRO
QC Batch: 49664
Prep Batch: 42653

Analytical Method: S 8015B
Date Analyzed: 2008-06-24
Sample Preparation: 2008-06-23

Prep Method: S 5035
Analyzed By: DC
Prepared By: DC

Parameter	Flag	RL Result	Units	Dilution	RL
GRO		<1.00	mg/Kg	1	1.00

Surrogate	Flag	Result	Units	Dilution	Spike Amount	Percent Recovery	Recovery Limits
Trifluorotoluene (TFT)		0.970	mg/Kg	1	1.00	97	67.5 - 135.2
4-Bromofluorobenzene (4-BFB)		1.01	mg/Kg	1	1.00	101	63.8 - 141

Sample: 164282 - North SP-4C

Laboratory: Midland
Analysis: TPH DRO
QC Batch: 49614
Prep Batch: 42583

Analytical Method: Mod. 8015B
Date Analyzed: 2008-06-20
Sample Preparation: 2008-06-20

Prep Method: N/A
Analyzed By: LD
Prepared By: LD

Parameter	Flag	RL Result	Units	Dilution	RL
DRO	B	141	mg/Kg	1	50.0

Surrogate	Flag	Result	Units	Dilution	Spike Amount	Percent Recovery	Recovery Limits
n-Triacontane		127	mg/Kg	1	100	127	10 - 250.4

Sample: 164282 - North SP-4C

Laboratory: Midland
Analysis: TPH GRO
QC Batch: 49664
Prep Batch: 42653

Analytical Method: S 8015B
Date Analyzed: 2008-06-24
Sample Preparation: 2008-06-23

Prep Method: S 5035
Analyzed By: DC
Prepared By: DC

continued ...

Report Date: June 24, 2008
Denton Gathering

Work Order: 8062031
Denton Gathering

Page Number: 6 of 9
Lea County, NM

sample 164282 continued ...

Parameter	Flag	RL Result	Units	Dilution	RL
Parameter	Flag	RL Result	Units	Dilution	RL
GRO		<1.00	mg/Kg	1	1.00

Surrogate	Flag	Result	Units	Dilution	Spike Amount	Percent Recovery	Recovery Limits
Trifluorotoluene (TFT)		0.925	mg/Kg	1	1.00	92	67.5 - 135.2
4-Bromofluorobenzene (4-BFB)		0.939	mg/Kg	1	1.00	94	63.8 - 141

Method Blank (1) QC Batch: 49614

QC Batch: 49614
Prep Batch: 42583

Date Analyzed: 2008-06-20
QC Preparation: 2008-06-20

Analyzed By: LD
Prepared By: LD

Parameter	Flag	MDL		Units	RL		
DRO		Result		44.9	mg/Kg	50	
Surrogate	Flag	Result	Units	Dilution	Spike Amount	Percent Recovery	Recovery Limits
n-Triacontane		121	mg/Kg	1	100	121	30.9 - 146.4

Method Blank (1) QC Batch: 49664

QC Batch: 49664
Prep Batch: 42653

Date Analyzed: 2008-06-24
QC Preparation: 2008-06-23

Analyzed By: DC
Prepared By: DC

Parameter	Flag	MDL Result	Units	RL
GRO		<0.739	mg/Kg	1

Surrogate	Flag	Result	Units	Dilution	Spike Amount	Percent Recovery	Recovery Limits
Trifluorotoluene (TFT)		0.978	mg/Kg	1	1.00	98	39.2 - 135.2
4-Bromofluorobenzene (4-BFB)		0.957	mg/Kg	1	1.00	96	16.8 - 138.1

Report Date: June 24, 2008
Denton Gathering

Work Order: 8062031
Denton Gathering

Page Number: 7 of 9
Lea County, NM

Laboratory Control Spike (LCS-1)

QC Batch: 49614
Prep Batch: 42583

Date Analyzed: 2008-06-20
QC Preparation: 2008-06-20

Analyzed By: LD
Prepared By: LD

Param	LCS Result	Units	Dil.	Spike Amount	Matrix Result	Rec.	Rec. Limit
DRO	260	mg/Kg	1	250	44.9	86	27.8 - 152.1

Percent recovery is based on the spike result. RPD is based on the spike and spike duplicate result.

Param	LCSD Result	Units	Dil.	Spike Amount	Matrix Result	Rec.	Rec. Limit	RPD	RPD Limit
DRO	267	mg/Kg	1	250	44.9	89	27.8 - 152.1	3	20

Percent recovery is based on the spike result. RPD is based on the spike and spike duplicate result.

Surrogate	LCS Result	LCSD Result	Units	Dil.	Spike Amount	LCS Rec.	LCSD Rec.	Rec. Limit
n-Triacontane	112	113	mg/Kg	1	100	112	113	38 - 130.4

Laboratory Control Spike (LCS-1)

QC Batch: 49664
Prep Batch: 42653

Date Analyzed: 2008-06-24
QC Preparation: 2008-06-23

Analyzed By: DC
Prepared By: DC

Param	LCS Result	Units	Dil.	Spike Amount	Matrix Result	Rec.	Rec. Limit
GRO	8.32	mg/Kg	1	10.0	<0.739	83	57.5 - 106.4

Percent recovery is based on the spike result. RPD is based on the spike and spike duplicate result.

Param	LCSD Result	Units	Dil.	Spike Amount	Matrix Result	Rec.	Rec. Limit	RPD	RPD Limit
GRO	8.51	mg/Kg	1	10.0	<0.739	85	57.5 - 106.4	2	20

Percent recovery is based on the spike result. RPD is based on the spike and spike duplicate result.

Surrogate	LCS Result	LCSD Result	Units	Dil.	Spike Amount	LCS Rec.	LCSD Rec.	Rec. Limit
Trifluorotoluene (TFT)	1.00	0.954	mg/Kg	1	1.00	100	95	63.8 - 134.3
4-Bromofluorobenzene (4-BFB)	0.992	0.962	mg/Kg	1	1.00	99	96	53.3 - 123.6

Matrix Spike (MS-1) Spiked Sample: 164280

QC Batch: 49614
Prep Batch: 42583

Date Analyzed: 2008-06-20
QC Preparation: 2008-06-20

Analyzed By: LD
Prepared By: LD

Report Date: June 24, 2008
Denton Gathering

Work Order: 8062031
Denton Gathering

Page Number: 8 of 9
Lea County, NM

Param	MS Result	Units	Dil.	Spike Amount	Matrix Result	Rec.	Rec. Limit
DRO	318	mg/Kg	1	250	205.8	45	18 - 179.5

Percent recovery is based on the spike result. RPD is based on the spike and spike duplicate result.

Param	MSD Result	Units	Dil.	Spike Amount	Matrix Result	Rec.	Rec. Limit	RPD	RPD Limit
DRO	307	mg/Kg	1	250	205.8	40	18 - 179.5	4	20

Percent recovery is based on the spike result. RPD is based on the spike and spike duplicate result.

Surrogate	MS Result	MSD Result	Units	Dil.	Spike Amount	MS Rec.	MSD Rec.	Rec. Limit
n-Triacontane	122	115	mg/Kg	1	100	122	115	34.1 - 158

Matrix Spike (MS-1) Spiked Sample: 164282

QC Batch: 49664
Prep Batch: 42653

Date Analyzed: 2008-06-24
QC Preparation: 2008-06-23

Analyzed By: DC
Prepared By: DC

Param	MS Result	Units	Dil.	Spike Amount	Matrix Result	Rec.	Rec. Limit
GRO	¹ 25.3	mg/Kg	1	10.0	<0.739	253	10 - 139.3

Percent recovery is based on the spike result. RPD is based on the spike and spike duplicate result.

Param	MSD Result	Units	Dil.	Spike Amount	Matrix Result	Rec.	Rec. Limit	RPD	RPD Limit
GRO	² 13.7	mg/Kg	1	10.0	<0.739	137	10 - 139.3	60	20

Percent recovery is based on the spike result. RPD is based on the spike and spike duplicate result.

Surrogate	MS Result	MSD Result	Units	Dil.	Spike Amount	MS Rec.	MSD Rec.	Rec. Limit
Trifluorotoluene (TFT)	1.02	0.955	mg/Kg	1	1	102	96	21.3 - 119
4-Bromofluorobenzene (4-BFB)	1.09	0.977	mg/Kg	1	1	109	98	52.5 - 154

Standard (CCV-1)

QC Batch: 49614

Date Analyzed: 2008-06-20

Analyzed By: LD

Param	Flag	Units	CCVs True Conc.	CCVs Found Conc.	CCVs Percent Recovery	Percent Recovery Limits	Date Analyzed
DRO		mg/Kg	250	242	97	85 - 115	2008-06-20

¹Matrix spike recovery out of control limits due to matrix interference. Use LCS/LCSD to demonstrate analysis is under control.

²MS/MSD RPD out of RPD Limits. Use LCS/LCSD to demonstrate analysis is under control.

Report Date: June 24, 2008
Denton Gathering

Work Order: 8062031
Denton Gathering

Page Number: 9 of 9
Lea County, NM

Standard (CCV-2)

QC Batch: 49614

Date Analyzed: 2008-06-20

Analyzed By: LD

Param	Flag	Units	CCVs True Conc.	CCVs Found Conc.	CCVs Percent Recovery	Percent Recovery Limits	Date Analyzed
DRO		mg/Kg	250	265	106	85 - 115	2008-06-20

Standard (ICV-1)

QC Batch: 49664

Date Analyzed: 2008-06-24

Analyzed By: DC

Param	Flag	Units	ICVs True Conc.	ICVs Found Conc.	ICVs Percent Recovery	Percent Recovery Limits	Date Analyzed
GRO		mg/Kg	1.00	0.979	98	85 - 115	2008-06-24

Standard (CCV-1)

QC Batch: 49664

Date Analyzed: 2008-06-24

Analyzed By: DC

Param	Flag	Units	CCVs True Conc.	CCVs Found Conc.	CCVs Percent Recovery	Percent Recovery Limits	Date Analyzed
GRO		mg/Kg	1.00	1.03	103	85 - 115	2008-06-24

email: lab@traceanalysis.com

ORIGINAL COPY

ANALYSIS REQUEST

[illegible]

REMARKS: All tests Millard

LABOR ONLY

Temp°C: 3.8

Time: 12: 30

Date: _____

Company: _____

y: 0

Received

Time: 1205

Date: 6/20/03

any:

Confidential

ished b

☐ Dry Weight Basis Required

☐ TRRP Report Required

☐ Check If Special Reporting Limits Are Needed

Carrier # 5000



6701 Aberdeen Avenue, Suite 9 Lubbock, Texas 79424 800•378•1296 806•794•1296 FAX: 806•794•1296
200 East Sunset Road, Suite E El Paso, Texas 79922 888•588•3443 915•585•3443 FAX: 915•585•4944
5002 Basin Street, Suite A1 Midland, Texas 79703 432•689•6301 FAX: 432•689•6313
6015 Harris Parkway, Suite 110 Ft. Worth, Texas 76132 817•201•5260
E-Mail: lab@traceanalysis.com

NELAP Certifications

Lubbock T104704219-08-TX El Paso T104704221-08-TX Midland T104704392-08-TX

Analytical and Quality Control Report

Ron Rounsaville
Nova Safety & Environmental
2057 Commerce St.
Midland, TX, 79703

Report Date: June 26, 2008

Work Order: 8062505



Project Location: East of Lovington, NM
Project Name: Centurion Denton Gathering
Project Number: Centurion Denton Gathering

Enclosed are the Analytical Report and Quality Control Report for the following sample(s) submitted to TraceAnalysis, Inc.

Sample	Description	Matrix	Date Taken	Time Taken	Date Received
164533	NW-SP-5	soil	2008-06-24	15:10	2008-06-25
164534	NC-SP-5	soil	2008-06-24	15:05	2008-06-25
164535	NE-SP-5	soil	2008-06-24	15:00	2008-06-25

These results represent only the samples received in the laboratory. The Quality Control Report is generated on a batch basis. All information contained in this report is for the analytical batch(es) in which your sample(s) were analyzed.

This report consists of a total of 9 pages and shall not be reproduced except in its entirety, without written approval of TraceAnalysis, Inc.

Michael Abel

Dr. Blair Leftwich, Director

Standard Flags

B - The sample contains less than ten times the concentration found in the method blank.

Case Narrative

Samples for project Centurion Denton Gathering were received by TraceAnalysis, Inc. on 2008-06-25 and assigned to work order 8062505. Samples for work order 8062505 were received intact at a temperature of 3.5 deg C.

Samples were analyzed for the following tests using their respective methods.

Test	Method
TPH DRO	Mod. 8015B
TPH GRO	S 8015B

Results for these samples are reported on a wet weight basis unless data package indicates otherwise.

A matrix spike (MS) and matrix spike duplicate (MSD) sample is chosen at random from each preparation batch. The MS and MSD will indicate if a site specific matrix problem is occurring, however, it may not pertain to the samples for work order 8062505 since the sample was chosen at random. Therefore, the validity of the analytical data reported has been determined by the laboratory control sample (LCS) and the method blank (MB). These quality control measures are performed with each preparation batch to ensure data integrity.

All other exceptions associated with this report have been footnoted on the appropriate analytical page to assist in general data comprehension. Please contact the laboratory directly if there are any questions regarding this project.

Report Date: June 26, 2008
Centurion Denton Gathering

Work Order: 8062505
Centurion Denton Gathering

Page Number: 4 of 9
East of Lovington, NM

Analytical Report

Sample: 164533 - NW-SP-5

Laboratory: Midland
Analysis: TPH DRO
QC Batch: 49716
Prep Batch: 42683

Analytical Method: Mod. 8015B
Date Analyzed: 2008-06-25
Sample Preparation: 2008-06-25

Prep Method: N/A
Analyzed By: LD
Prepared By: LD

Parameter	Flag	RL Result	Units	Dilution	RL
DRO	B	51.3	mg/Kg	1	50.0

Surrogate	Flag	Result	Units	Dilution	Spike Amount	Percent Recovery	Recovery Limits
n-Triacontane		97.4	mg/Kg	1	100	97	10 - 250.4

Sample: 164533 - NW-SP-5

Laboratory: Midland
Analysis: TPH GRO
QC Batch: 49738
Prep Batch: 42695

Analytical Method: S 8015B
Date Analyzed: 2008-06-25
Sample Preparation: 2008-06-25

Prep Method: S 5035
Analyzed By: DC
Prepared By: DC

Parameter	Flag	RL Result	Units	Dilution	RL
GRO		<1.00	mg/Kg	1	1.00

Surrogate	Flag	Result	Units	Dilution	Spike Amount	Percent Recovery	Recovery Limits
Trifluorotoluene (TFT)		0.930	mg/Kg	1	1.00	93	67.5 - 135.2
4-Bromofluorobenzene (4-BFB)		0.939	mg/Kg	1	1.00	94	63.8 - 141

Sample: 164534 - NC-SP-5

Laboratory: Midland
Analysis: TPH DRO
QC Batch: 49716
Prep Batch: 42683

Analytical Method: Mod. 8015B
Date Analyzed: 2008-06-25
Sample Preparation: 2008-06-25

Prep Method: N/A
Analyzed By: LD
Prepared By: LD

Parameter	Flag	RL Result	Units	Dilution	RL
DRO		<50.0	mg/Kg	1	50.0

Report Date: June 26, 2008
Centurion Denton Gathering

Work Order: 8062505
Centurion Denton Gathering

Page Number: 5 of 9
East of Lovington, NM

Surrogate	Flag	Result	Units	Dilution	Spike Amount	Percent Recovery	Recovery Limits
n-Triacontane		85.2	mg/Kg	1	100	85	10 - 250.4

Sample: 164534 - NC-SP-5

Laboratory: Midland
Analysis: TPH GRO
QC Batch: 49738
Prep Batch: 42695

Analytical Method: S 8015B
Date Analyzed: 2008-06-25
Sample Preparation: 2008-06-25

Prep Method: S 5035
Analyzed By: DC
Prepared By: DC

Parameter	Flag	RL Result	Units	Dilution	RL
GRO		<1.00	mg/Kg	1	1.00

Surrogate	Flag	Result	Units	Dilution	Spike Amount	Percent Recovery	Recovery Limits
Trifluorotoluene (TFT)		0.968	mg/Kg	1	1.00	97	67.5 - 135.2
4-Bromofluorobenzene (4-BFB)		0.931	mg/Kg	1	1.00	93	63.8 - 141

Sample: 164535 - NE-SP-5

Laboratory: Midland
Analysis: TPH DRO
QC Batch: 49716
Prep Batch: 42683

Analytical Method: Mod. 8015B
Date Analyzed: 2008-06-25
Sample Preparation: 2008-06-25

Prep Method: N/A
Analyzed By: LD
Prepared By: LD

Parameter	Flag	RL Result	Units	Dilution	RL
DRO		<50.0	mg/Kg	1	50.0

Surrogate	Flag	Result	Units	Dilution	Spike Amount	Percent Recovery	Recovery Limits
n-Triacontane		109	mg/Kg	1	100	109	10 - 250.4

Sample: 164535 - NE-SP-5

Laboratory: Midland
Analysis: TPH GRO
QC Batch: 49738
Prep Batch: 42695

Analytical Method: S 8015B
Date Analyzed: 2008-06-25
Sample Preparation: 2008-06-25

Prep Method: S 5035
Analyzed By: DC
Prepared By: DC

continued ...

Report Date: June 26, 2008
Centurion Denton Gathering

Work Order: 8062505
Centurion Denton Gathering

Page Number: 6 of 9
East of Lovington, NM

sample 164535 continued ...

Parameter	Flag	RL Result	Units	Dilution	RL
Parameter	Flag	RL Result	Units	Dilution	RL
GRO		<1.00	mg/Kg	1	1.00

Surrogate	Flag	Result	Units	Dilution	Spike Amount	Percent Recovery	Recovery Limits
Trifluorotoluene (TFT)		0.982	mg/Kg	1	1.00	98	67.5 - 135.2
4-Bromofluorobenzene (4-BFB)		0.951	mg/Kg	1	1.00	95	63.8 - 141

Method Blank (1) QC Batch: 49716

QC Batch: 49716
Prep Batch: 42683

Date Analyzed: 2008-06-25
QC Preparation: 2008-06-25

Analyzed By: LD
Prepared By: LD

Parameter	Flag	MDL Result	Units	RL
DRO		20.7	mg/Kg	50

Surrogate	Flag	Result	Units	Dilution	Spike Amount	Percent Recovery	Recovery Limits
n-Triacontane		132	mg/Kg	1	100	132	30.9 - 146.4

Method Blank (1) QC Batch: 49738

QC Batch: 49738
Prep Batch: 42695

Date Analyzed: 2008-06-25
QC Preparation: 2008-06-25

Analyzed By: DC
Prepared By: DC

Parameter	Flag	MDL Result	Units	RL
GRO		<0.739	mg/Kg	1

Surrogate	Flag	Result	Units	Dilution	Spike Amount	Percent Recovery	Recovery Limits
Trifluorotoluene (TFT)		0.980	mg/Kg	1	1.00	98	39.2 - 135.2
4-Bromofluorobenzene (4-BFB)		0.949	mg/Kg	1	1.00	95	16.8 - 138.1

Report Date: June 26, 2008
Centurion Denton Gathering

Work Order: 8062505
Centurion Denton Gathering

Page Number: 7 of 9
East of Lovington, NM

Laboratory Control Spike (LCS-1)

QC Batch: 49716
Prep Batch: 42683

Date Analyzed: 2008-06-25
QC Preparation: 2008-06-25

Analyzed By: LD
Prepared By: LD

Param	LCS Result	Units	Dil.	Spike Amount	Matrix Result	Rec.	Rec. Limit
DRO	246	mg/Kg	1	250	20.7	90	27.8 - 152.1

Percent recovery is based on the spike result. RPD is based on the spike and spike duplicate result.

Param	LCSD Result	Units	Dil.	Spike Amount	Matrix Result	Rec.	Rec. Limit	RPD	RPD Limit
DRO	249	mg/Kg	1	250	20.7	91	27.8 - 152.1	1	20

Percent recovery is based on the spike result. RPD is based on the spike and spike duplicate result.

Surrogate	LCS Result	LCSD Result	Units	Dil.	Spike Amount	LCS Rec.	LCSD Rec.	Rec. Limit
n-Triacontane	97.8	99.0	mg/Kg	1	100	98	99	38 - 130.4

Laboratory Control Spike (LCS-1)

QC Batch: 49738
Prep Batch: 42695

Date Analyzed: 2008-06-25
QC Preparation: 2008-06-25

Analyzed By: DC
Prepared By: DC

Param	LCS Result	Units	Dil.	Spike Amount	Matrix Result	Rec.	Rec. Limit
GRO	9.38	mg/Kg	1	10.0	<0.739	94	57.5 - 106.4

Percent recovery is based on the spike result. RPD is based on the spike and spike duplicate result.

Param	LCSD Result	Units	Dil.	Spike Amount	Matrix Result	Rec.	Rec. Limit	RPD	RPD Limit
GRO	9.71	mg/Kg	1	10.0	<0.739	97	57.5 - 106.4	3	20

Percent recovery is based on the spike result. RPD is based on the spike and spike duplicate result.

Surrogate	LCS Result	LCSD Result	Units	Dil.	Spike Amount	LCS Rec.	LCSD Rec.	Rec. Limit
Trifluorotoluene (TFT)	0.956	0.993	mg/Kg	1	1.00	96	99	63.8 - 134.3
4-Bromofluorobenzene (4-BFB)	0.974	0.988	mg/Kg	1	1.00	97	99	53.3 - 123.6

Matrix Spike (MS-1) Spiked Sample: 164533

QC Batch: 49716
Prep Batch: 42683

Date Analyzed: 2008-06-25
QC Preparation: 2008-06-25

Analyzed By: LD
Prepared By: LD

Report Date: June 26, 2008
Centurion Denton Gathering

Work Order: 8062505
Centurion Denton Gathering

Page Number: 8 of 9
East of Lovington, NM

Param	MS Result	Units	Dil.	Spike Amount	Matrix Result	Rec.	Rec. Limit
DRO	279	mg/Kg	1	250	51.3	91	18 - 179.5

Percent recovery is based on the spike result. RPD is based on the spike and spike duplicate result.

Param	MSD Result	Units	Dil.	Spike Amount	Matrix Result	Rec.	Rec. Limit	RPD	RPD Limit
DRO	297	mg/Kg	1	250	51.3	98	18 - 179.5	6	20

Percent recovery is based on the spike result. RPD is based on the spike and spike duplicate result.

Surrogate	MS Result	MSD Result	Units	Dil.	Spike Amount	MS Rec.	MSD Rec.	Rec. Limit
n-Triacontane	82.0	89.7	mg/Kg	1	100	82	90	34.1 - 158

Matrix Spike (MS-1) Spiked Sample: 164456

QC Batch: 49738
Prep Batch: 42695

Date Analyzed: 2008-06-25
QC Preparation: 2008-06-25

Analyzed By: DC
Prepared By: DC

Param	MS Result	Units	Dil.	Spike Amount	Matrix Result	Rec.	Rec. Limit
GRO	11.7	mg/Kg	1	10.0	1.0759	106	10 - 139.3

Percent recovery is based on the spike result. RPD is based on the spike and spike duplicate result.

Param	MSD Result	Units	Dil.	Spike Amount	Matrix Result	Rec.	Rec. Limit	RPD	RPD Limit
GRO	10.4	mg/Kg	1	10.0	1.0759	93	10 - 139.3	12	20

Percent recovery is based on the spike result. RPD is based on the spike and spike duplicate result.

Surrogate	MS Result	MSD Result	Units	Dil.	Spike Amount	MS Rec.	MSD Rec.	Rec. Limit
Trifluorotoluene (TFT)	0.931	0.947	mg/Kg	1	1	93	95	21.3 - 119
4-Bromofluorobenzene (4-BFB)	1.00	1.06	mg/Kg	1	1	100	106	52.5 - 154

Standard (ICV-1)

QC Batch: 49716

Date Analyzed: 2008-06-25

Analyzed By: LD

Param	Flag	Units	ICVs True Conc.	ICVs Found Conc.	ICVs Percent Recovery	Percent Recovery Limits	Date Analyzed
DRO		mg/Kg	250	247	99	85 - 115	2008-06-25

Report Date: June 26, 2008
Centurion Denton Gathering

Work Order: 8062505
Centurion Denton Gathering

Page Number: 9 of 9
East of Lovington, NM

Standard (CCV-1)

QC Batch: 49716

Date Analyzed: 2008-06-25

Analyzed By: LD

Param	Flag	Units	CCVs True Conc.	CCVs Found Conc.	CCVs Percent Recovery	Percent Recovery Limits	Date Analyzed
DRO		mg/Kg	250	258	103	85 - 115	2008-06-25

Standard (ICV-1)

QC Batch: 49738

Date Analyzed: 2008-06-25

Analyzed By: DC

Param	Flag	Units	ICVs True Conc.	ICVs Found Conc.	ICVs Percent Recovery	Percent Recovery Limits	Date Analyzed
GRO		mg/Kg	1.00	1.11	111	85 - 115	2008-06-25

Standard (CCV-1)

QC Batch: 49738

Date Analyzed: 2008-06-25

Analyzed By: DC

Param	Flag	Units	CCVs True Conc.	CCVs Found Conc.	CCVs Percent Recovery	Percent Recovery Limits	Date Analyzed
GRO		mg/Kg	1.00	1.05	105	85 - 115	2008-06-25

ORIGINAL COPY

APPENDIX B

Client: Centurion Pipeline, L.P.
Site Location: Lea County, New Mexico
Photograph Date: As Noted

Prepared by: NOVA
Photographer: Ron Rounsaville
Project Name: Denton Gathering

Photograph No. 1

Date: 05/25/08

Direction: Northeast

Description: View of impacted soil stockpiles being spread out for aeration.



Photograph No. 2

Date: 05/25/08

Direction: North

Description:
View of impacted soil stockpiles being spread out for aeration.



Client: Centurion Pipeline, L.P.
Site Location: Lea County, New Mexico
Photograph Date: As Noted

Prepared by: NOVA
Photographer: Ron Rounsaville
Project Name: Denton Gathering

Photograph No. 3

Date: 06/25/08

Direction: Northeast

Description: View of excavation area following backfilling activities.



Photograph No. 4

Date: 06/25/08

Direction: Southeast.

Description: View of excavation area following backfilling activities.



Client: Centurion Pipeline, L.P.
Site Location: Lea County, New Mexico
Photograph Date: As Noted

Prepared by: NOVA
Photographer: Ron Rounsaville
Project Name: Denton Gathering

Photograph No. 5

Date: 07/23/08

Direction: Northeast

Description: View of
backfilled excavation
area following reseeding
activities.



Photograph No. 6

Date: 07/23/08

Direction: East.

Description: View of
backfilled excavation
area following
reseeding.

