

10/24/08	SUSPENSE	WJS	LOGGED IN	DAC	WJS	0829858392
DATE IN		ENGINEER		TYPE	APP NO.	

ABOVE THIS LINE FOR DIVISION USE ONLY

## NEW MEXICO OIL CONSERVATION DIVISION

- Engineering Bureau -

1220 South St. Francis Drive, Santa Fe, NM 87505



### ADMINISTRATIVE APPLICATION CHECKLIST

THIS CHECKLIST IS MANDATORY FOR ALL ADMINISTRATIVE APPLICATIONS FOR EXCEPTIONS TO DIVISION RULES AND REGULATIONS WHICH REQUIRE PROCESSING AT THE DIVISION LEVEL IN SANTA FE

#### Application Acronyms:

[NSL-Non-Standard Location] [NSP-Non-Standard Proration Unit] [SD-Simultaneous Dedication]  
 [DHC-Downhole Commingling] [CTB-Lease Commingling] [PLC-Pool/Lease Commingling]  
 [PC-Pool Commingling] [OLS - Off-Lease Storage] [OLM-Off-Lease Measurement]  
 [WFX-Waterflood Expansion] [PMX-Pressure Maintenance Expansion]  
 [SWD-Salt Water Disposal] [IPI-Injection Pressure Increase]  
 [EOR-Qualified Enhanced Oil Recovery Certification] [PPR-Positive Production Response]

#### [1] TYPE OF APPLICATION - Check Those Which Apply for [A]

[A] Location - Spacing Unit - Simultaneous Dedication  
☐ NSL ☐ NSP ☐ SD

Check One Only for [B] or [C]

[B] Commingling - Storage - Measurement  
☒ DHC ☐ CTB ☐ PLC ☐ PC ☐ OLS ☐ OLM

[C] Injection - Disposal - Pressure Increase - Enhanced Oil Recovery  
☐ WFX ☐ PMX ☐ SWD ☐ IPI ☐ EOR ☐ PPR

[D] Other: Specify \_\_\_\_\_

#### [2] NOTIFICATION REQUIRED TO: - Check Those Which Apply, ☒ Does Not Apply

[A] ☐ Working, Royalty or Overriding Royalty Interest Owners

[B] ☐ Offset Operators, Leaseholders or Surface Owner

[C] ☐ Application is One Which Requires Published Legal Notice

[D] ☐ Notification and/or Concurrent Approval by BLM or SLO  
 U.S. Bureau of Land Management - Commissioner of Public Lands, State Land Office

[E] ☐ For all of the above, Proof of Notification or Publication is Attached, and/or,

[F] ☐ Waivers are Attached

#### [3] SUBMIT ACCURATE AND COMPLETE INFORMATION REQUIRED TO PROCESS THE TYPE OF APPLICATION INDICATED ABOVE.

[4] **CERTIFICATION:** I hereby certify that the information submitted with this application for administrative approval is **accurate** and **complete** to the best of my knowledge. I also understand that **no action** will be taken on this application until the required information and notifications are submitted to the Division.

Note: Statement must be completed by an individual with managerial and/or supervisory capacity.

Tamra Sessions

Print or Type Name

Signature

Staff Regulatory Technician

Title

10/24/2008

Date

sessitd@conocophillips.com

e-mail Address

District I  
1825 N. Fourth Drive, P.O. Box, Santa Fe, NM 87505

District II  
1304 W. Grand Avenue, Santa Fe, NM 87505

District III  
1840 R. Brown Road, Santa Fe, NM 87505

District IV  
1224 S. St. Francis Dr., Santa Fe, NM 87505

State of New Mexico  
Energy, Minerals and Natural Resources Department

Oil Conservation Division

1220 South St. Francis Dr.  
Santa Fe, New Mexico 87505

Revised

APPLICATION FOR DOWNHOLE COMMINGLING

Form C-107A  
Revised June 10, 2003

APPLICATION TYPE

☒ Single Well  
Establish Pre-Approved Pools  
EXISTING WELLBORE  
☒ Yes ☐ No

Burlington Resources Oil & Gas Company LP P.O. Box 4289 Farmington, NM 87499  
Operator Address

UTE MOUNTAIN UTE 44 Unit N, Sec. 9, 032N, 014W SAN JUAN  
Lease Well No. Unit Letter-Section-Township-Range County

OGRID No: 14538 Property Code 18725 API No. 30045294980000 Lease Type: ☒ Federal ☐ State ☐ Fee

DATA ELEMENT	UPPER ZONE	INTERMEDIATE ZONE	LOWER ZONE
Pool Name	WC BARKER DOME HERMOSA	BARKER DOME ISMAY (G)	BARKER DOME, DESERT CREEK (G)
Pool Code	97582	96354	96353
Top and Bottom of Pay Section (Perforated or Open-Hole Interval)	8461'-8475' Estimated	8526'-8566' Estimated	8526'-8566'
Method of Production (Flowing or Artificial Lift)	New Zone	New Zone	FLOWING
Bottomhole Pressure (Note: Pressure data will not be required if the bottom perforation in the lower zone is within 150% of the depth of the top perforation in the upper zone)	N/A - 150% Rule	N/A - 150% Rule	N/A - 150% Rule
Oil Gravity or Gas BTU (Degree API or Gas BTU)	BTU 1000	BTU 1000	BTU 1000
Producing, Shut-In or New Zone	New Zone	New Zone	PRODUCING
Date and Oil/Gas/Water Rates of Last Production. (Note: For new zones with no production history, applicant shall be required to attach production estimates and supporting data.)			Date: Dec 2007 Rates: 1 MCF
Fixed Allocation Percentage (Note: If allocation is based upon something other than current or past production, supporting data or explanation will be required.)	Oil Gas Will be supplied upon completion	Oil Gas Will be supplied upon completion	Oil Gas Will be supplied upon completion

ADDITIONAL DATA

Are all working, royalty and overriding royalty interests identical in all commingled zones?

Yes ☒ No ☐

If not, have all working, royalty and overriding royalty interest owners been notified by certified mail?

Yes ☐ No ☐

Are all produced fluids from all commingled zones compatible with each other?

Yes ☒ No ☐

Will commingling decrease the value of production?

Yes ☐ No ☒

If this well is on, or commingled with, state or federal lands, has either the Commissioner of Public Lands  
or the United States Bureau of Land Management been notified in writing of this application?

Yes ☒ No ☐

NMOCD Reference Case No. applicable to this well: \_\_\_\_\_

Attachments:

C-102 for each zone to be commingled showing its spacing unit and acreage dedication.

Production curve for each zone for at least one year. (If not available, attach explanation.)

For zones with no production history, estimated production rates and supporting data.

Data to support allocation method or formula.

Notification list of working, royalty and overriding royalty interests for uncommon interest cases.

Any additional statements, data or documents required to support commingling.

PRE-APPROVED POOLS

If application is to establish Pre-Approved Pools, the following additional information will be required:

List of other orders approving downhole commingling within the proposed Pre-Approved Pools

List of all operators within the proposed Pre-Approved Pools

Proof that all operators within the proposed Pre-Approved Pools were provided notice of this application.

Bottomhole pressure data.

I hereby certify that the information above is true and complete to the best of my knowledge and belief.

SIGNATURE Ryan Frost TITLE Engineer DATE 10/24/08

TYPE OR PRINT NAME Ryan Frost, Engineer TELEPHONE NO. (505) 326-9700

E-MAIL ADDRESS Ryan.M.Frost@conocophillips.com

Ute Mountain Ute 44  
Unit N, Section 9, T32N, R14W

The Ute Mountain Ute 44 is a Barker Dome Desert Creek, Ismay and Wildcat Hermosa recomplete. A cased hole neutron log will be run prior to completion to identify the Barker Dome Desert Creek, Ismay and Wildcat Hermosa zones. If the Barker Dome Desert Creek, Ismay and Wildcat Hermosa horizons can be isolated, a separator test will be performed and the allocation will be assigned with results using the subtraction method applied to the rate. In the event that the Barker Dome Desert Creek, Ismay and Wildcat Hermosa can not be tested separately, a volumetric calculation will be performed to determine the allocation percentages between the Barker Dome Desert Creek, Ismay and Wildcat Hermosa. All documentation will be submitted to the Aztec NMOC office.

Burlington Resources Oil & Gas Company LP  
3401 E. 30<sup>th</sup> St.  
P.O. Box 4289  
Farmington, NM 87499-4289

October 22, 2008

Subject well: Ute Mountain Ute 44

Please amend DHC-4044 to include the Barker Dome Ismay, 96354

Thank you,

Tamra Sessions  
Staff Regulatory Technician  
ConocoPhillips Company  
505-326-9834

Division I  
PO Box 1908, Hobbs, NM 88240-1908  
Division II  
PO Drawer 60, Artesia, NM 88211-0719  
Division III  
1028 N. Main St., Alamogordo, NM 88310  
Division IV  
PO Box 1038, Santa Fe, NM 87504-1038

State of New Mexico  
Energy, Minerals & Natural Resources Department

OIL CONSERVATION DIVISION  
PO Box 2088  
Santa Fe, NM 87504-2088

Form  
Revised February 11  
Instructions:  
Submit to Appropriate Division  
State License - \$4  
Fee License - \$4

☒ AMENDED REI

WELL LOCATION AND ACREAGE DEDICATION PLAT

API Number 30-045-2249	Well Name Barker Dome Desert Creek/Barker Dome ISMAJ
Property Code 18725	Property Name Uta Mountain Ute
OCALID No. 14538	Operator Name BURLINGTON RESOURCES OIL & GAS COMPANY LP
Well Number 44	Well Name Wilcat Hermosa 932N14N
Well Number 6867	

16 Surface Location

UT. or Sec. No.	Section	Township	Range	Lot No.	Feet from the	North/South Line	Feet from the	East/West Line	County
N	9	32-N	14-W		190	South	2355	West	S.J.

18 Bottom Hole Location If Different From Surface

UT. or Sec. No.	Section	Township	Range	Lot No.	Feet from the	North/South Line	Feet from the	East/West Line	County

Dedication or Fee 525/205/102.5	Consolidation Code	Order No. R-46-B	OIL CONS. DIV. DIST. 3
NO ALLOWABLE WILL BE ASSIGNED TO THIS COMPLETION UNTIL ALL INTERESTS HAVE BEEN CONSOLIDATED OR A NON-STANDARD UNIT HAS BEEN APPROVED BY THE DIVISION			

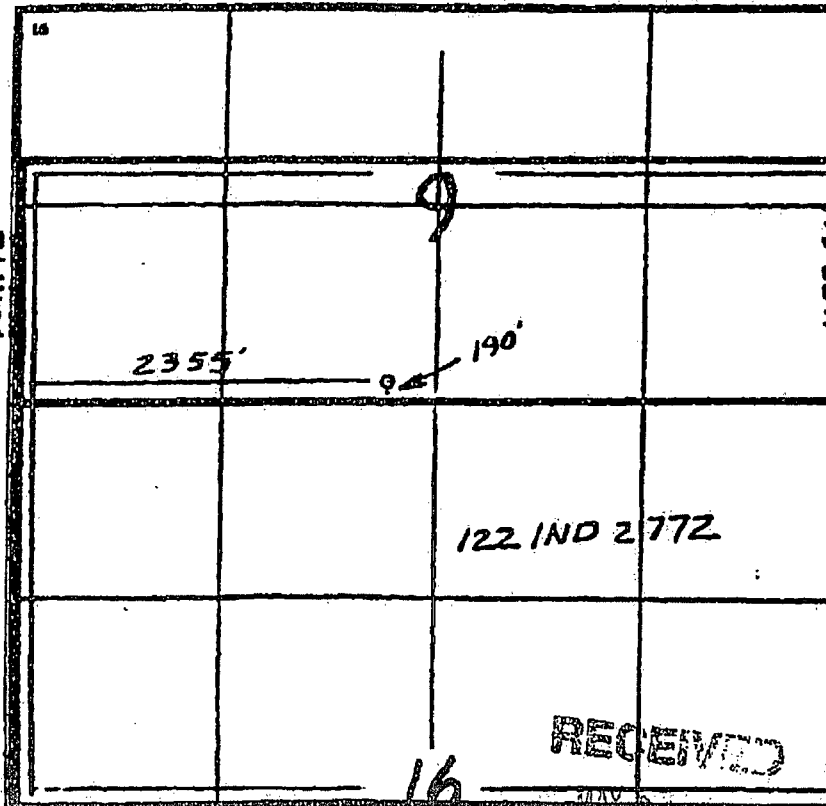

17 OPERATOR CERTIFICATION	
I hereby certify that the information contained herein is true and complete to the best of my knowledge and belief, and that this organization either owns a working interest or undivided mineral interest in the land including the proposed bottom hole location or has a right to drill that well at this location pursuant to a contract with an owner of such a mineral or working interest, or to a voluntary pooling agreement or a compulsory pooling order heretofore entered by the division.	
Signature Tracey N. Monore	Date 6/19/08
Printed Name	
18 SURVEYOR CERTIFICATION	
I hereby certify that the well location shown on this plat was plotted from field notes of actual surveys made by me or under my supervision, and that the same is true and correct to the best of my belief.	
4/16/97	
Date of Survey	
Signature and Seal of Professional Surveyor.	
6857	
Certificate Number	

Bureau of Land Management  
Department of the Interior

**Jones, William V., EMNRD**

---

**From:** Sessions, Tamra D [Tamra.D.Sessions@conocophillips.com]  
**Sent:** Friday, October 24, 2008 3:56 PM  
**To:** Jones, William V., EMNRD  
**Cc:** Clugston, Patricia L  
**Subject:** Ute Mountain Ute 44 C107A  
**Attachments:** Ute Mountain Ute 44 C107A Revised\_submitted.pdf

Please see attached C-107A for rush approval.

The Ute Mountain Ute 44 is an amend to the original DHC-4044 to include the Barker Dome Ismay. Any questions please let me know!

Thank you,

Tamra Sessions

Staff Regulatory Technician  
CONOCOPHILLIPS SJBU  
505-326-9834 Fax 599-4062  
[Tamra.D.Sessions@conocophillips.com](mailto:Tamra.D.Sessions@conocophillips.com)

---

This inbound email has been scanned by the MessageLabs Email Security System.

---

10/24/2008