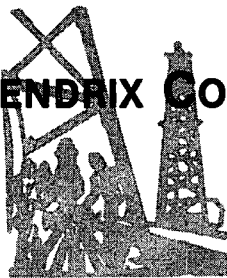

pKRV0306326715

WVJ N5L 3/23/03

AMEND
#722**JOHN H. HENDRIX CORPORATION**MAILING ADDRESS
P.O. BOX 3040
MIDLAND, TX 79702-3040(915) 684-6631
FAX (915) 684-7317
110 N. MARIENFELD, SUITE 400
MIDLAND, TEXAS 79701-4412

February 27, 2003

RECEIVED

MAR 03 2003

OIL CONSERVATION
DIVISION

Request for Administrative Approval
Unorthodox Well Location
Cossatot M No. 2
1110' FWL & 1120' FSL
Unit M, Section 11, T22S, R37E
Lea County, New Mexico

Lori Wrotenbery, Director
Oil Conservation Division
New Mexico Dep. Of Energy,
Minerals & Natural Resources
1220 S. St. Francis Dr.
Santa Fe, New Mexico 87504

Dear Ms. Wrotenbery:

This is a request for administrative approval to recomplete our Cossatot M Well No. 2 in the Abo as an unorthodox location. This well was approved as a unorthodox location September 16, 1975 under Administrative Order NLS-722. (Copy attached.) The well was completed as a Wantz Granite Wash completion 10/29/75.

62730

The Wantz Granite Wash is now uneconomic and we wish to recomplete the well in the Abo. The reasons necessary for unorthodox location were the following:

1. A railroad track runs in a northwest to southeast direction across the center of this 40 acre tract.

2. There are three wells located on this 40 acre tract to the west of the railroad. This being the John H. Hendrix Corporation's Thomas Long No. 2, (the well is not deep enough to test the Abo, plus the working interest is different than the Abo rights in the subject well.) There are also two plugged and abandoned wells west of the track, the R. L. Parker's No. 2, a plugged and abandoned well, and the John H. Hendrix Corporation Paddock Unit No. 89, a plugged and abandoned well.

February 27, 2003

3. There are two oil pipelines running east-west across the 40 acre tract plus numerous other flow lines.

4. John H. Hendrix Corporation is owner of the Abo rights in the 160 acres of the SW/4 of Section 11, T22S, R37E. The royalty interest in the 160 acre quarter section is also the same. No offset operators are being affected by this unorthodox location for recompletion in the Wantz Abo.

Also attached is the original C-102, a current C-102 to recomplete to the Wantz Abo, a map showing the 160 acre Wantz Abo rights and a Form C-101 on the Cossatot M No. 2 well.

Thank you for your assistance regarding this matter. If you have any questions please feel free to call.

Yours very truly,

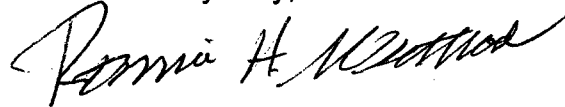
A handwritten signature in cursive script, appearing to read "Ronnie H. Westbrook".

Ronnie H. Westbrook
Vice President

RHW/ah

Enclosures

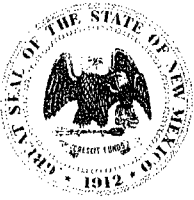

OIL CONSERVATION COMMISSION

STATE OF NEW MEXICO
P. O. BOX 2088 - SANTA FE
87501

DIRECTOR
JOE D. RAMEY

LAND COMMISSIONER
PHIL R. LUCERO



STATE GEOLOGIST
EMERY C. ARNOLD

September 16, 1975

John H. Hendrix
525 Midland Tower
Midland, Texas 79701

Administrative Order NSL-722

Dear Mr. Hendrix:

Reference is made to your application for approval of a non-standard location for your Cossatot M Well No. 2, located 1120 feet from the South line and 1110 feet from the West line of Section 11, Township 22 South, Range 37 East, NMPM, Wantz Granite Wash Pool, Lea County, New Mexico.

By authority granted me under the provisions of Rule 104 F of the Commission Rules and Regulations, the above-described unorthodox well is hereby approved.

Very truly yours,

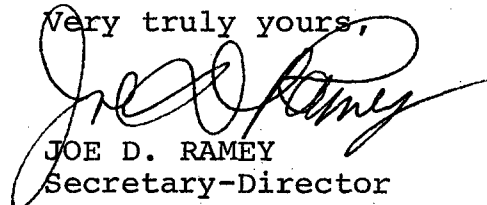

JOE D. RAMEY
Secretary-Director

JDR/JEK/dr

cc: Oil Conservation Commission - Hobbs
Oil & Gas Engineering Committee - Hobbs

SEP 16 1975

SEP 18 1975

AEK

MEXICO OIL CONSERVATION COMMISSION
WELL LOCATION AND ACREAGE DEDICATION PLAT

Form C-102
 Supersedes C-128
 Effective 1-1-65

All distances must be from the outer boundaries of the Section.

Operator John H. Hendrix			Lease Cossatot M		Well No. 2
Unit Letter M	Section 11	Township 22 South	Range 37 East	County Lea	
Actual Footage Location of Well: 1110 feet from the West line and 1120 feet from the South line					
Ground Level Elev. 3358	Producing Formation Granite Wash	Pool Wantz Granite Wash		Dedicated Acreage: 40 Acres	

1. Outline the acreage dedicated to the subject well by colored pencil or hachure marks on the plat below.
2. If more than one lease is dedicated to the well, outline each and identify the ownership thereof (both as to working interest and royalty).
3. If more than one lease of different ownership is dedicated to the well, have the interests of all owners been consolidated by communitization, unitization, force-pooling, etc?

☐ Yes ☐ No If answer is "yes," type of consolidation _____

If answer is "no," list the owners and tract descriptions which have actually been consolidated. (Use reverse side of this form if necessary.) _____

No allowable will be assigned to the well until all interests have been consolidated (by communitization, unitization, forced-pooling, or otherwise) or until a non-standard unit, eliminating such interests, has been approved by the Commission.

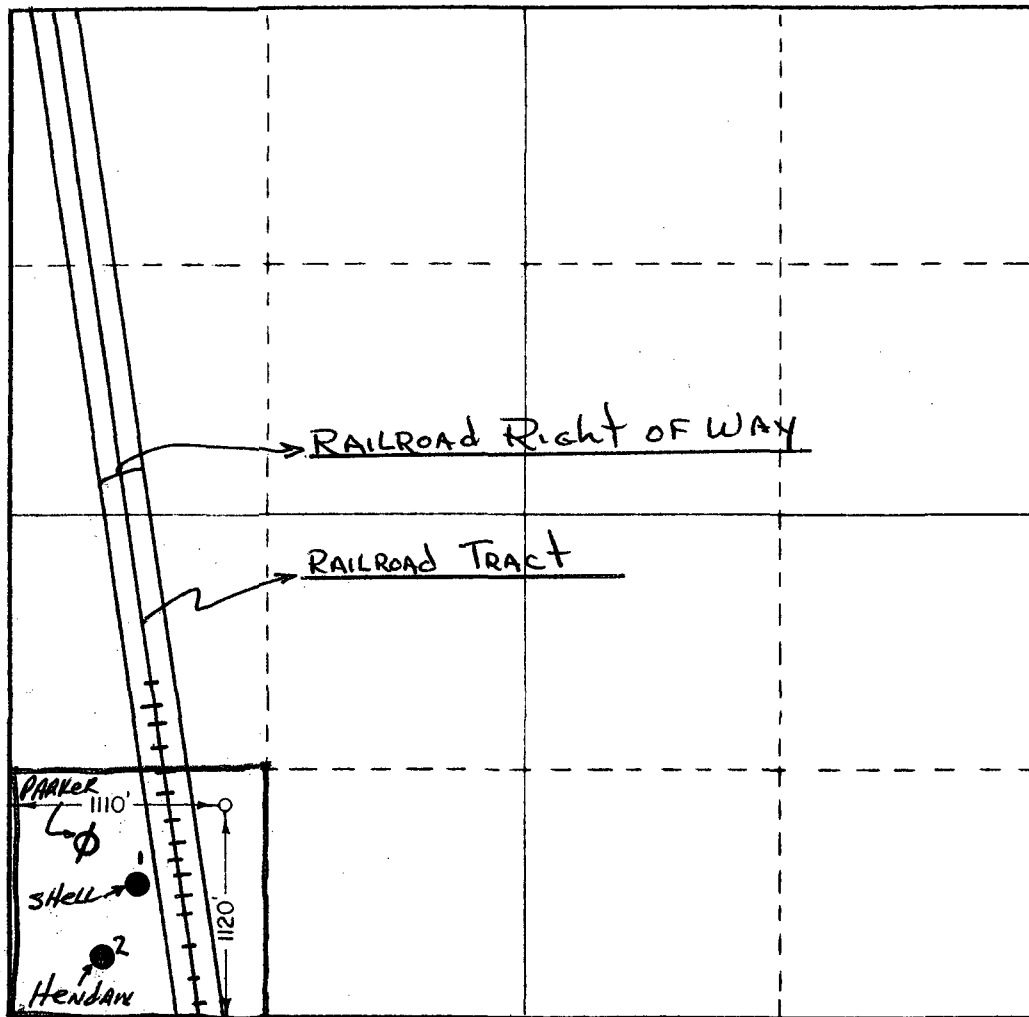

CERTIFICATION

I hereby certify that the information contained herein is true and complete to the best of my knowledge and belief.

Name

Owner - Operator

Position

John H. Hendrix

Company

August 12, 1975

Date

I hereby certify that the well location shown on this plat was plotted from field notes of actual surveys made by me or under my supervision, and that the same is true and correct to the best of my knowledge and belief.

Date

July 22, 1975

Registered Professional Engineer and Land Surveyor

W. WEST
 Certification No. **W. WEST**

District I
1625 N. French Dr., Hobbs, NM 88240
District II
811 South First, Artesia, NM 88210
District III
1000 Rio Brazos Rd., Aztec, NM 87410
District IV
2040 South Pacheco, Santa Fe, NM 87505

State of New Mexico
Energy, Minerals & Natural Resources Department

Form C-102
Revised August 15, 2000

OIL CONSERVATION DIVISION
2040 South Pacheco
Santa Fe, NM 87505

Submit to Appropriate District Office
State Lease - 4 Copies
Fee Lease - 3 Copies

☐ AMENDED REPORT

WELL LOCATION AND ACREAGE DEDICATION PLAT

¹ API Number 30-025-25095	² Pool Code 62700	³ Pool Name Wantz Abo
⁴ Property Code 005160	⁵ Property Name Cossatot M	⁶ Well Number 2
⁷ OGRID No. 012024	⁸ Operator Name John H. Hendrix Corporation	⁹ Elevation

¹⁰ Surface Location

UL or lot no.	Section	Township	Range	Lot Idn	Feet from the	North/South line	Feet from the	East/West line	County
M	11	22S	37E		1120	South	1110	West	Lea

¹¹ Bottom Hole Location If Different From Surface

UL or lot no.	Section	Township	Range	Lot Idn	Feet from the	North/South line	Feet from the	East/West line	County
¹² Dedicated Acres 40	¹³ Joint or Infill	¹⁴ Consolidation Code	¹⁵ Order No.						

NO ALLOWABLE WILL BE ASSIGNED TO THIS COMPLETION UNTIL ALL INTERESTS HAVE BEEN CONSOLIDATED OR A NON-STANDARD UNIT HAS BEEN APPROVED BY THE DIVISION

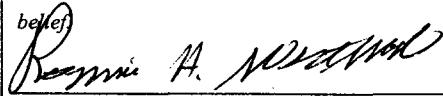
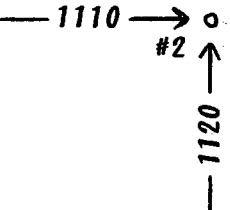
¹⁶				¹⁷ OPERATOR CERTIFICATION I hereby certify that the information contained herein is true and complete to the best of my knowledge and belief.  Signature Ronnie H. Westbrook Printed Name Vice President Title 02/27/2003 Date
				¹⁸ SURVEYOR CERTIFICATION I hereby certify that the well location shown on this plat was plotted from field notes of actual surveys made by me or under my supervision, and that the same is true and correct to the best of my belief. Date of Survey Signature and Seal of Professional Surveyor: Certificate Number
				

District I
1625 N. French Dr., Hobbs, NM 88240
District II
811 South First, Artesia, NM 88210
District III
1000 Rio Brazos Road, Aztec, NM 87410
District IV
2040 South Pacheco, Santa Fe, NM 87505

State of New Mexico
Energy Minerals and Natural Resources

Form C-101
Revised March 17, 1999

Oil Conservation Division
2040 South Pacheco
Santa Fe, NM 87505

Submit to appropriate District Office
State Lease - 6 Copies
Fee Lease - 5 Copies

☐ AMENDED REPORT

APPLICATION FOR PERMIT TO DRILL, RE-ENTER, DEEPEN, PLUGBACK, OR ADD A ZONE

¹ Operator Name and Address John H. Hendrix Corporation P. O. Box 3040 Midland TX 79702-3040		² OGRID Number 012024
		³ API Number 30-025-25095
⁴ Property Code 005160	⁵ Property Name Cossatot M	⁶ Well No. 2

⁷ Surface Location

UL or lot no.	Section	Township	Range	Lot Idn	Feet from the	North/South line	Feet from the	East/West line	County
M	11	22S	37E		1120	South	1110	West	Lea

⁸ Proposed Bottom Hole Location If Different From Surface

UL or lot no.	Section	Township	Range	Lot Idn	Feet from the	North/South line	Feet from the	East/West line	County

⁹ Proposed Pool 1 Wantz Abo	¹⁰ Proposed Pool 2
---	-------------------------------

¹¹ Work Type Code P	¹² Well Type Code O	¹³ Cable/Rotary	¹⁴ Lease Type Code P	¹⁵ Ground Level Elevation 3358' GR
¹⁶ Multiple	¹⁷ Proposed Depth	¹⁸ Formation	¹⁹ Contractor	²⁰ Spud Date

²¹ Proposed Casing and Cement Program

Hole Size	Casing Size	Casing weight/foot	Setting Depth	Sacks of Cement	Estimated TOC
		NC			

²² Describe the proposed program. If this application is to DEEPEN or PLUG BACK, give the data on the present productive zone and proposed new productive zone.

Describe the blowout prevention program, if any. Use additional sheets if necessary.

1. Set RBP at 7100' to TZ Wantz Granite Wash.
2. Perforate Abo - 6591 - 7038'. 34 shots.
3. Acidize w/ 10,000 gals.
4. Test well.

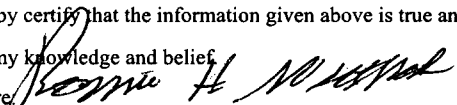
²³ I hereby certify that the information given above is true and complete to the best of my knowledge and belief. Signature: 		OIL CONSERVATION DIVISION	
Printed Name: Ronnie H. Westbrook		Approved by:	
Title: Vice President		Title:	
Date: 02/27/2003		Approval Date:	Expiration Date:
Phone: (915)684-6631		Conditions of Approval: Attached <input type="checkbox"/>	



COUNTY LeaPOOL Wantz-AboTOWNSHIP 22-South RANGE 37-East

NMPM ↑

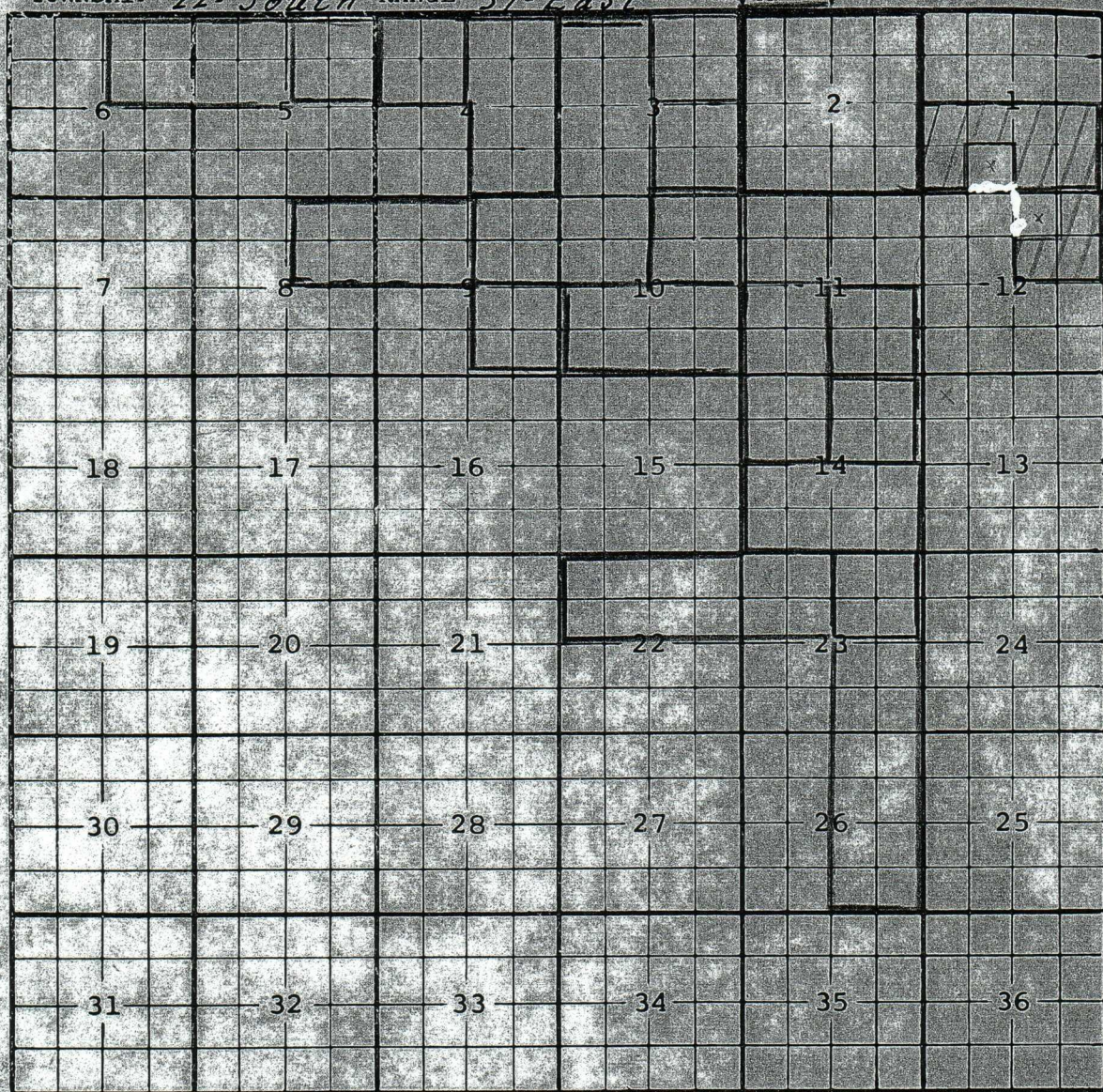

Description: $\frac{NW}{4}$ Sec. 4 (R-1797, 11-1-60).

Ext: All Sec. 2 (R-2485, 6-1-63) - $\frac{E}{2}$ Sec. 4 (R-3051, 4-1-66) - $\frac{S}{2}$ Sec. 1 (R-3818, 9-1-69)

- $\frac{NE}{4}$ Sec. 12 (R-4207, 11-1-71)

Contraction: $\frac{SE}{4}$ $\frac{SW}{4}$ Sec. 1, $\frac{NW}{4}$ $\frac{NE}{4}$ Sec. 12 (R-4734, 3-1-74)

Ext: $\frac{NW}{4}$ Sec. 11 (R-5456, 7-1-77) Ext: $\frac{NE}{4}$ Sec. 3 (R-5781, 9-1-78)

Ext: $\frac{SE}{4}$ Sec. 3 (R-6499, 11-1-80) Ext: $\frac{NE}{4}$ sec. 10 (R-6724, 7-16-81)

Ext: $\frac{SW}{4}$ sec. 11, $\frac{NW}{4}$ sec. 14 (R-6724, 7-16-81)

Ext: $\frac{S}{2}$ Sec. 14 (R-7419, 12-21-82) Ext: $\frac{NE}{4}$ Sec. 23 (R-7714, 11-7-84)

Ext: $\frac{NE}{4}$ Sec. 14 (R-8024, 8-30-85) DELE: $\frac{SE}{4}$, $\frac{W}{2}$ $\frac{SW}{4}$, & $\frac{NE}{4}$ $\frac{SW}{4}$ SEC. 1;

$\frac{S}{2}$ $\frac{NE}{4}$ & $\frac{NE}{4}$ $\frac{NE}{4}$ SEC. 12 (R-8593, 1-27-88) EXT: $\frac{N}{2}$ SEC. 22, $\frac{NW}{4}$ SEC. 23

(R-9144, 5-1-90) Ext: $\frac{SE}{4}$ Sec. 11 (R-9544, 7-1-91)

Ext: $\frac{S}{2}$ Sec. 10 (R-10641, 8-19-96) Ext: $\frac{W}{2}$ Sec. 3, $\frac{NE}{4}$ Sec. 9, $\frac{NW}{4}$ Sec. 10 (R-10922, 4-13-98)

Ext: $\frac{NE}{4}$ Sec. 8, $\frac{NW}{4}$ Sec. 9 (R-11116, 1-7-99)

Ext: $\frac{NE}{4}$ Sec. 5, $\frac{SE}{4}$ Sec. 9, $\frac{SE}{4}$ Sec. 23, $\frac{E}{2}$ Sec. 26 (R-11533, 1-8-01) Ext: $\frac{NW}{4}$ Sec. 5, $\frac{NE}{4}$ Sec. 6 (R-11633, 8-30-01)