

3R - 179

**ANNUAL
MONITORING
REPORT**

04/02/2008



MWH

BUILDING A BETTER WORLD

37179
RECEIVED

2008 APR 4 PM 1 38

April 2, 2008

Mr. Glenn von Gonten
New Mexico Oil Conservation Division (NMOCD)
1220 South St., Francis Drive
Santa Fe, New Mexico 87505

**RE: El Paso Tennessee Pipeline Company Pit Groundwater Remediation Sites
2007 Annual Reports**

Dear Mr. Von Gonten:

MWH Americas, Inc., on behalf of El Paso Tennessee Pipeline Company (EPTPC), is submitting the enclosed 2007 Annual Reports for each of EPTPC's 21 remaining San Juan River Basin pit groundwater remediation Sites. The reports present the 2007 sampling and product recovery data and include recommendations for 2008 activities at these Sites.

Copies of the reports for Sites located on Federal or Navajo lands are also being sent under separate cover to the Bureau of Land Management and the Navajo Nation Environmental Protection Agency.

If you have any questions concerning the enclosed reports, please call either Nancy Prince of EPTPC (719-520-4690) or me (303-291-2276).

Sincerely,

Jed Smith
Project Manager

cc: Brandon Powell – NMOCD, Aztec, NM
Nancy Prince – EPTPC
MWH Project File

**2007 ANNUAL GROUNDWATER REPORT
NON-FEDERAL SITES VOLUME II
EL PASO TENNESSEE PIPELINE COMPANY**

TABLE OF CONTENTS

METER or LINE ID	SITE NAME	TOWNSHIP	RANGE	SECTION	UNIT	
71669	State Gas Com N #1	31N	12W	16	H	3R239
93388	Horton #1E	31N	09W	28	H	3R192
72556	Knight #1	30N	13W	5	A	3R207
03906	GCU Com A #142E	29N	12W	25	G	3R179
70445	Standard Oil Com #1	29N	09W	36	N	3R074
LD087	K-31 Line Drip	25N	06W	16	N	3R205
94967	*Lindrith B #24	24N	03W	9	N	3R214

* Lindrith B#24 Site has been submitted for closure, and is pending approval from NMOCD.

OGRID 221654
181398



MWH

**EPTPC GROUNDWATER SITES
2007 ANNUAL GROUNDWATER REPORT**

3R179

**GCU Com A #142E
Meter Code: 03906**

SITE DETAILS

Legal Description:	Town: 29N	Range: 12W	Sec: 25	Unit: G
NMOCD Haz Ranking:	10	Land Type: Fee	Operator: BP / Amoco Production Company	

PREVIOUS ACTIVITIES

Site Assessment:	4/94	Excavation:	4/94 (20 cy)	Soil Boring:	10/95
Monitor Well:	2/97	Geoprobe:	12/96	Additional MWs:	12/01
Downgradient MWs:	12/01	Replace MW:	NA	Quarterly Initiated:	8/97
ORC Nutrient Injection:	NA	Re-Excavation:	10/96 (882 cy)	PSH Removal Initiated:	NA
Annual Initiated:	5/98	Quarterly Resumed:	NA	PSH Removal in 2007?	No

SUMMARY OF 2007 ACTIVITIES

MW-1: Annual groundwater sampling (June) and water level measurements were performed in 2007.

MW-2: Annual groundwater sampling (June) and water level measurements were performed in 2007.

Site-Wide Activities: No other Site activities were conducted in 2007.

SITE MAPS

A Site map (June) is attached as Figure 1.

SUMMARY TABLES AND GRAPHS

- Analytical results are summarized in Table 1 and presented graphically in Figures 3 and 4.
- Laboratory reports are presented in Attachment 1 (included on CD).
- Field documentation is presented in Attachment 2 (included on CD).

**EPTPC GROUNDWATER SITES
2007 ANNUAL GROUNDWATER REPORT**

**GCU Com A #142E
Meter Code: 03906**

GEOLOGIC LOGS AND WELL COMPLETION DIAGRAMS

No subsurface activities were conducted at the Site in 2007.

DISPOSITION OF GENERATED WASTES

All purge water was taken to the El Paso Natural Gas Rio Vista Compressor Station.

ISOCONCENTRATION MAPS

No isoconcentration maps were prepared for this Site; however, the attached Site map present the analytical data collected during 2007.

CONCLUSIONS

- The groundwater head gradient appears to be toward MW-2, or to the northeast. However, only two points were utilized, so this gradient direction is only approximate.
- In the samples collected at MW-1, concentrations of toluene, ethylbenzene and total xylenes were below NMWQCC-standards. The concentration of benzene was above its NMWQCC standard, with a result of 109 µg/L in June 2007.
- BTEX concentrations in monitoring well MW-2, located apparently downgradient from the former EPTPC pit, remained above the applicable standards, with benzene at 2,100 µg/L and total xylenes at 1,050 µg/L) in June 2007. Concentrations in MW-2 have historically been far greater than those measured in MW-1, and hydrocarbon impact is visible in this well.
- The long-term trends show that BTEX concentrations in both MW-1 and MW-2 appear to be slowly attenuating.

RECOMMENDATIONS

- EPTPC recommends that MW-1 continue to be sampled on an annual schedule. Sampling will continue until BTEX concentrations approach NMWQCC standards, at which time quarterly sampling will be initiated.
- EPTPC recommends that monitoring well MW-2, which is located adjacent to production equipment, continue to be sampled annually.

LEGEND

⊙ MW-1 Approximate Monitoring Well Location and Number

PW-3 ⊕ Piezometer Location
GWEL Groundwater Elevation (Relative)

B Benzene (μg/L)
T Toluene (μg/L)
E Ethylbenzene (μg/L)
X Total Xylenes (μg/L)

NM Not Measured
← Groundwater Flow Direction (Estimated)

NS Not Sampled
TOC Top of Casing
— Road
—x— Fence Line

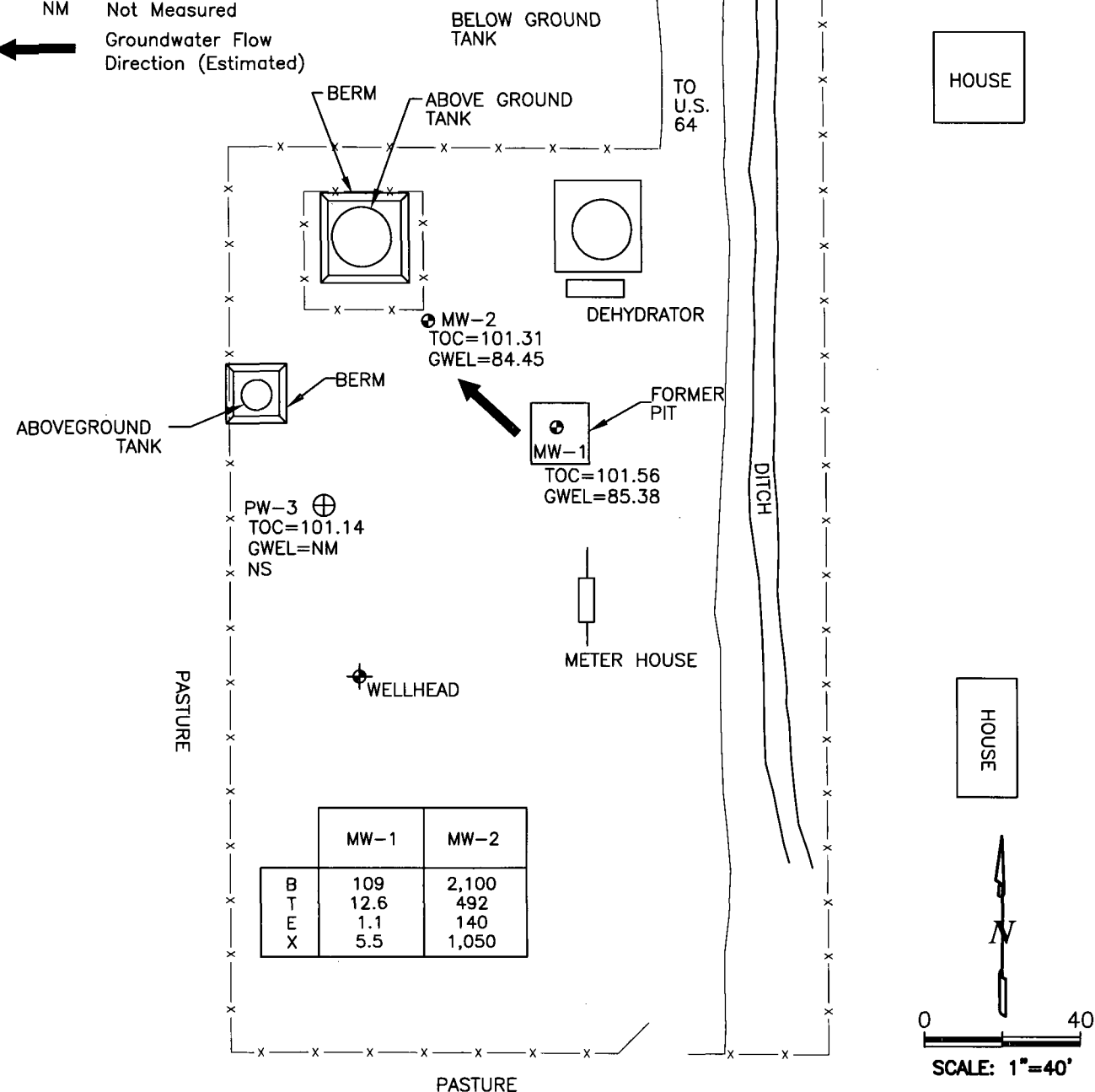

0	Issued to Report	06-07	J.Hurley	N.Day	J.Smith
REV. No.	REVISIONS	REV. DATE	DESIGN BY	DRAWN BY	REVIEWED AND SIGNED BY
PROJECT No.: 1005521.0601					
AutoCAD FILE: gallegos142e					
SCALE: As Shown			FIGURE No: 1		



EL PASO TENNESSEE PIPELINE COMPANY
GALLEGOS CANYON UNIT A142E, METER 03906

GROUNDWATER POTENTIOMETRIC SURFACE
CONTOURS AND BTEX CONCENTRATIONS
JUNE 2007

FIGURE 2
SUMMARY OF BTEX COMPOUNDS IN GROUNDWATER SAMPLES
GCU COM A #142E (METER #03906)
MW01

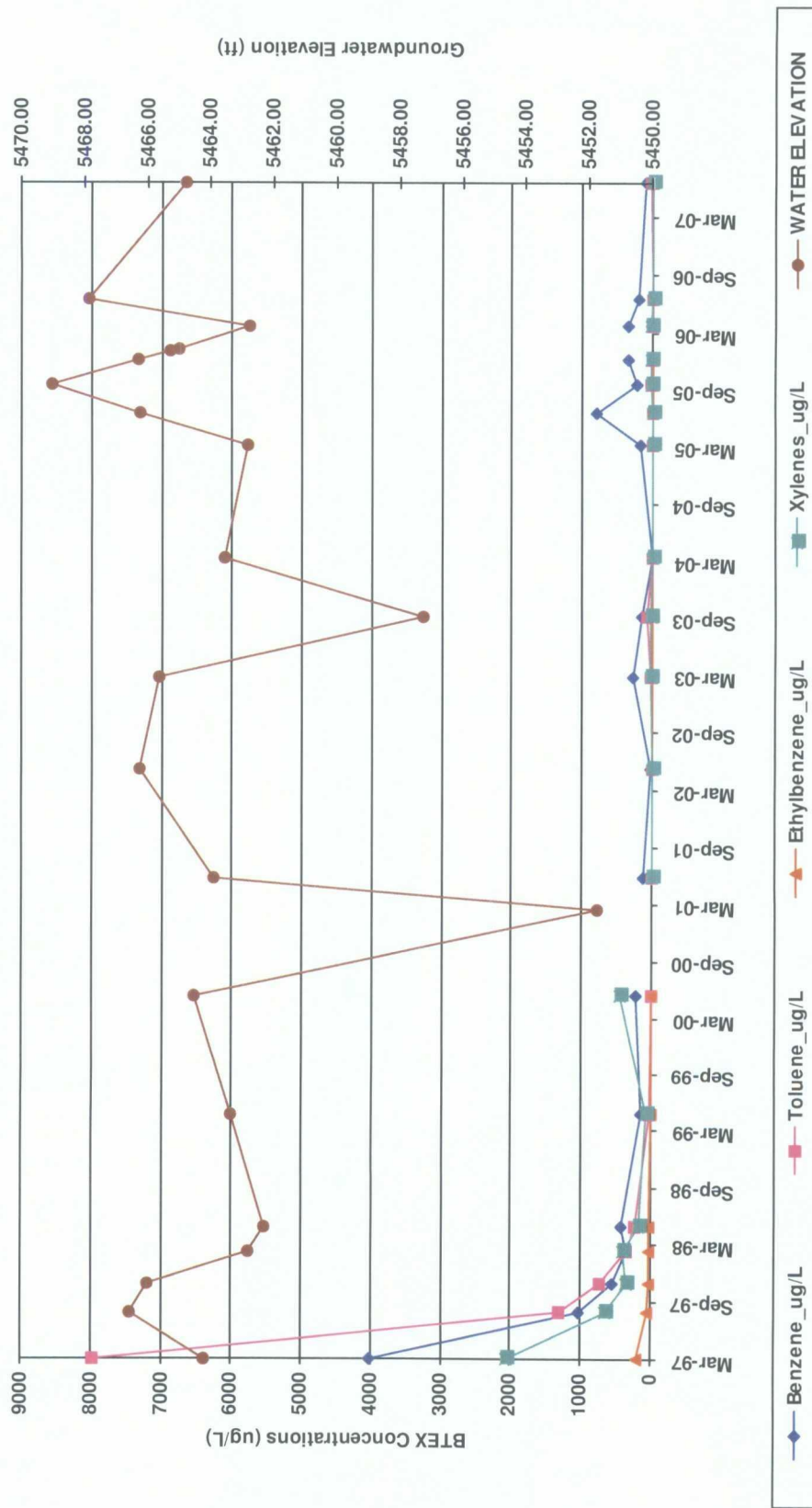

Note: Non Detects are represented by a value of 1.

FIGURE 3
SUMMARY OF BTEX COMPOUNDS IN GROUNDWATER SAMPLES
GCU COM A #142E (METER #03906)
MW02

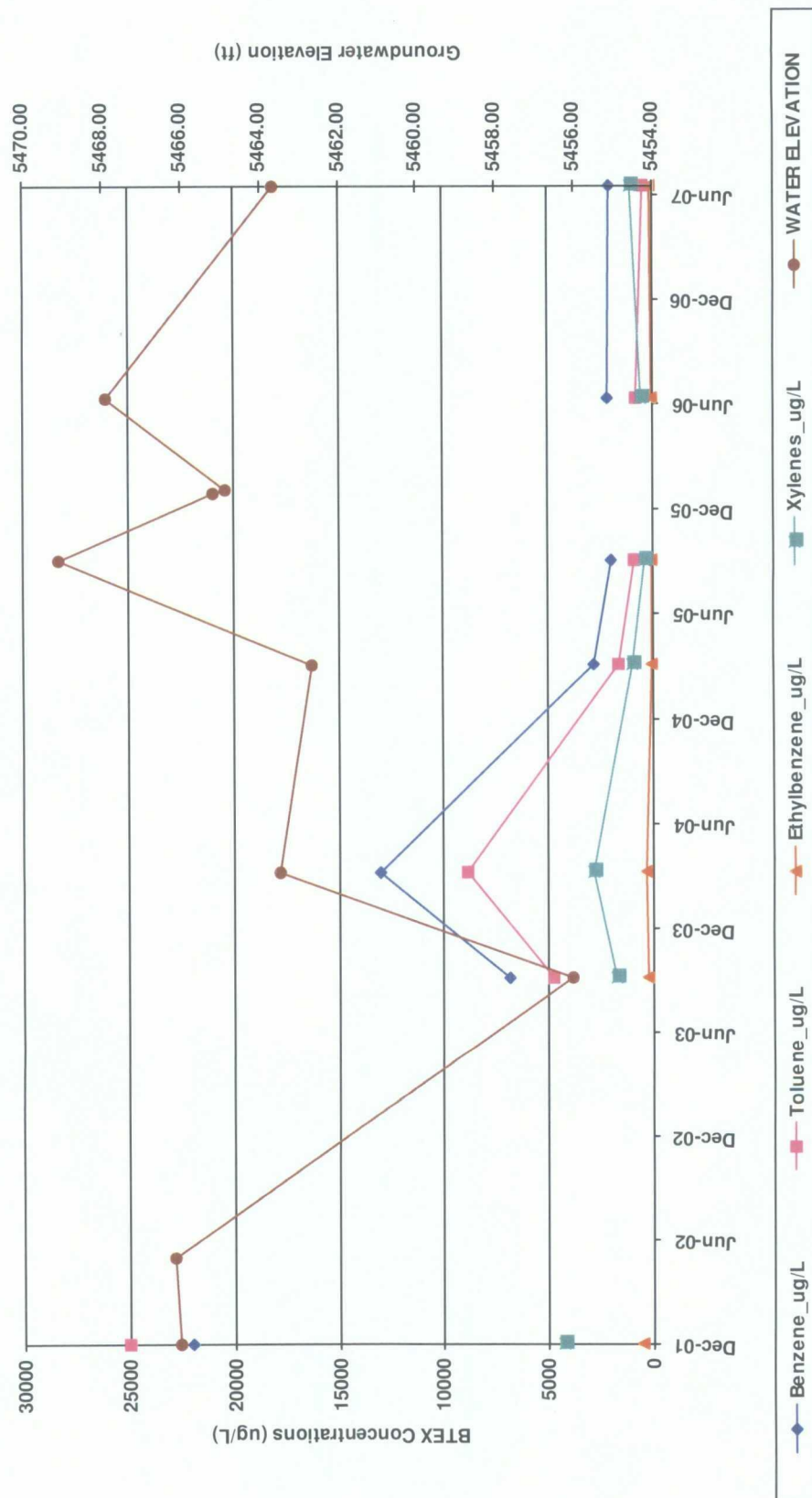

Note: Non Detects are represented by a value of 1.

TABLE 1

**SUMMARY OF BTEX COMPOUNDS IN GROUNDWATER SAMPLES
GCU COM A #142E (METER #03906)**

Monitoring Well	Sample Date	Benzene (ug/L)	Toluene (ug/L)	Ethylbenzene (ug/L)	Total Xylenes (ug/L)	Depth to Water (ft BTOC)
MW01	3/10/1997	4010	7960	213	2050	16.78
	8/6/1997	1040	1310	49.4	647	14.46
	11/5/1997	543	719	33.9	342	15.02
	2/13/1998	343	354	27.6	394	18.18
	5/6/1998	429	216	13.6	176	18.69
	5/4/1999	143	20.4	7.78	63.3	17.61
	5/25/2000	230	4.4	6	450	16.44
	6/1/2001	130	0.7	3.5	6.1	17.08
	5/14/2002	34	4.9	1	3.3	14.70
	3/7/2003	270	36.8	8.3	21.1	15.31
	9/17/2003	150	77	1.9	12.8	23.70
	3/22/2004	1.4	1	1	1	17.38
	3/17/2005	169	1.3	2.7	6.6	18.15
	6/23/2005	810	1.9	0.62	8.1	14.72
	9/26/2005	232	14.9	4	15.1	11.95
	12/14/2005	354	10.6	5.9	25.6	14.67
	3/28/2006	362	0.37	15	15.7	18.16
	6/23/2006	210	6.5	2.3	6.1	13.08
	6/28/2007	109	12.6	1.1	5.5	16.18
MW02	12/13/2001	22000	25000	500	4300	14.52
	9/17/2003	6890	4760	219	1770	24.50
	3/22/2004	13000	8880	321	2850	17.06
	3/17/2005	2800	1640	125	978	17.83
	9/14/2005	1980	915	63.8	391	11.45
	6/23/2006	2140	811	83.5	610	12.64
	6/28/2007	2100	492	140	1050	16.86

Note: Non Detects are represented by a value of 1.