

AMEND NSL

2/15/99

MARTIN YATES, III
1912 - 1985
FRANK W. YATES
1936 - 1986



105 SOUTH FOURTH STREET
ARTESIA, NEW MEXICO 88210
TELEPHONE (505) 748-1471

S. P. YATES
CHAIRMAN OF THE BOARD
JOHN A. YATES
PRESIDENT
PEYTON YATES
EXECUTIVE VICE PRESIDENT
RANDY G. PATTERSON
SECRETARY
DENNIS G. KINSEY
TREASURER

January 22, 1999

Mr. Michael E. Stogner
New Mexico Oil Conservation Division
2040 South Pacheco Street
Santa Fe, New Mexico 87505

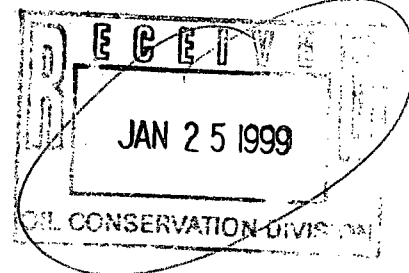

RE: Administrative Order NSL-4128
Sand Spring "ASU" St #1
Township 11 South, Range 34 East
Section 11: N/2
Lea County, New Mexico

Dear Mr. Stogner:

The administrative order granted to Yates by the Division on September 2, 1998 is in need of revision due to the fact that the well was re-completed as a Morrow gas producer rather than an Atoka producer in perforations from 12,100' to 12,130' and 12,172 to 12,188'.

All other facts on our application letter of August 26, 1998 remain the same including the fact that Yates Petroleum Corporation is the operator on all the offset spacing units.

The well is currently shut-in awaiting a revision of NSL-4128.

Please call me at (505) 748-4351 if you need further information

Thank you.

Very truly yours,

YATES PETROLEUM CORPORATION

Robert Bullock
Landman

RB:bn

PETROLEUM INFORMATION/DWIGHTS MIDLAND REGION REPORT

SECTION III - 11/20/98

PAGE 25

NEW MEXICO DRILLING PROGRESS LEA COUNTY CONTINUED

TIPPERARY O&G
1 QUEEN COM
API 30-025-22642-0001

20-11S-33E
1980 FSL 660 FWL SEC

WILDCAT; 6175 SAN ANDRES, (FR 10/28/98MD) (ST APPD PMT: 03/06/98)
OPER ADD: 633 17TH ST STE 1550, DENVER, CO, 80202 PHONE (303) 293-9379; **EL**: 4306 GR; **LOCATION DATA**: 5 MI SE CAPROCK, NM .25 MI E/9392 (BUGHC) OIL PROD IN BAGLEY NORTH FIELD; (VERTICAL)
OWWO: OLD INFO: FORMERLY STOLTZ & CO-CLARK 1 QUEEN COM. ELEV 4318 KB. SPUD 6/28/68. 13 3/8 @ 350 W/400 SX, 8 5/8 @ 3735 W/200 SX, 4 1/2 @ 10350 W/500 SX. OTD 10350. PB 10345. COMP 8/3/68. IPF 838 BOPD, 560 BWPD. PROD ZONE: PENNSYLVANIAN LOWER 10076-10256;

WSX

LOC;

YATES PET
1 SAND SPRING 'ASU' STATE
API 30-025-29843-0001

11-11S-34E
NE NW
330 FNL 1650 FWL SEC

SAND SPRINGS; 12200 ATOKA, (FR 08/12/98MD) **OPER ADD**: 105 S 4TH ST, ARTESIA, NM, 88210 PHONE (505) 748-1471; **EL**: 4145 GR; **LOCATION DATA**: 13 MI SE CAPROCK, NM; (VERTICAL) OWDD: OLD INFO: FORMERLY YATES PET 1 SAND SPRING 'AEH'. ELEV 4145 GR, 4161 KB. SPUD 12/9/87. 13 3/8 @ 410 W/425 SX, 8 5/8 @ 4208 W/1500 SX. LOG TOPS: BOUGH B 9891, BOUGH C 9944, RANGER LAKE 10190. OTD 10575. COMP 3/3/87 D&A;

D D

CONTR: KEY ENERGY DRLG, **RIG #37**; **SPUD**: 09/29/98, **CSG**: 5 1/2 @ 13300 W/2200 SX; **DST #** 1, **TITE**; **DRLG COMMENTS**: CO TO 10575 DEEPENED 10575 TO 13318 (TD REACHED: 11/ 03/98), **RIG REL**: 11/09/98; ... 13318 TD, WOCT (LDIR 11/12/98)

PETROLEUM DEV
1 PEDCO-STATE
API 30-025-07102-0101

16-11S-38E
660 FNL 1980 FWL SEC
IC 300257000498

ECHOLS EAST; 12200 DEVONIAN, (FR 01/06/98MD) (ST APPD PMT: 01/02/98) **OPER ADD**: 9720-B CANDELARIA NE, ALBUQUERQUE, NM, 87112 PHONE (505) 293-4044; **EL**: 3865 GR; **LOCATION DATA**: 9 MI NE GLADIOLA, NM; OLD RECORDS SHOW ELEV 3915 DF; **PBHL**: 1270 FNL 1520 FWL SEC, 16-11S-38E; (DEVIATED) OWST: OLD INFO: FORMERLY CITIES SERVICE OIL 1 STATE 'BE'. ELEV 3915 DF. SPUD 7/11/57. 13 3/8 @ 385 W/375 SX, 8 5/8 @ 4414 W/1535 SX, 5 1/2 @ 12089 W/600 SX. LOG TOPS: MISSISSIPPIAN 11432, WOODFORD SH 11921, DEVONIAN 12004. OTD 12089. COMP 10/23/57. IPF 172 BOPD. PROD ZONE: DEVONIAN 12004-12082. (PLUGGED PRODUCER 6/1/66);

D R

LOC;

TOCO LLC
1 TOWER
API 30-025-34526

23-12S-33E
SE SW
373 FSL 2035 FWL SEC

HIGHTOWER; 10200 DEVONIAN, (FR 11/04/98MD) **OPER ADD**: BOX 888, HOBBS, NM, 88241 PHONE (505) 393-2727; **EL**: 4244 GR; **LOCATION DATA**: 2 MI NE HALFWAY, NM; (VERTICAL)

D

CONTR: W E K DRLG, **RIG #4**; **SPUD**: 11/04/88, ... DRLG 4862 (LDIR 11/19/98)

J P H OIL PRODUCERS
1 HODGE
API 30-025-25321-0101

28-12S-38E
660 FSL 810 FEL SEC
IC 300257011398

WILDCAT; 12165 DEVONIAN, (FR 03/02/98MD) (ST APPD PMT: 02/27/98) **OPER ADD**: BOX 565, LOVINGTON, NM, 88260 PHONE (505) 396-2836; **EL**: 3812 GR; **LOCATION DATA**: 5 MI SE GLADIOLA, NM 800 FT SW/9560 (WFMP) OIL PROD IN UNNAMED FIELD; **PBHL**: 500 FSL 1680 FEL SEC, 28-12S-38E; (HORIZONTAL) OWHD: OLD INFO: FORMERLY WAINOCO, 1 HODGE ET AL. ELEV 3812 GR. SPUD 8/26/76. 13 3/8 @ 456 W/475 SX, 9 5/8 @ 4516 W/1500 SX, 5 1/2 @ 12219 W/300 SX. LOG TOPS: WOLFCAMP 9555, DEVONIAN 12212. OTD 12219. PB 9660. COMP 12/5/76. IPP 90 BOPD, 20 BWPD. PROD ZONE: WOLFCAMP 9560-9594;

WDR

LOC;

SABA ENERGY TEXAS
1 GUYE FERN
API 30-025-34488

5-13S-36E
SW SW
400 FSL 990 FWL SEC

WILDCAT; 11200 CISCO, (FR 08/19/98MD) **OPER ADD**: 1603 SE 19TH ST STE 202, EDMOND, OK, 73013 PHONE (405) 340-3600; **EL**: 4003 GR; **LOCATION DATA**: 2 MI S TATUM, NM .25 MI E/10285 (WFMP) OIL PROD IN TATUM FIELD; (VERTICAL)

WD

CONTR: NORTON DRLG, **RIG #8**; **SPUD**: 08/20/98, **CSG**: 5 1/2 @ 11220; (TD REACHED: 09/ 15/98), **RIG REL**: 09/17/98; ... 11220 TD, WOCT (LDIR 09/28/98)

MARKS & GARNER PROD
1 DUNCAN R W '1-6'
API 30-025-03665-0001

6-13S-36E
330 FSL 330 FEL SEC

WILDCAT; 14391 DEVONIAN, (FR 08/27/98MD) (ST APPD PMT: 08/25/98) **OPER ADD**: BOX 70, LOVINGTON, NM, 88260 PHONE (505) 396-5326; **EL**: 4018 DF; **LOCATION DATA**: 2 MI S TATUM, NM .50 MI N/13980 (DVNN) OIL PROD IN UNNAMED FIELD; (VERTICAL) OWWO: OLD INFO: FORMERLY UNION OIL OF CALIF 1 R W DUNCAN. ELEV 4018 DF. SPUD 4/16/57. 11 3/4 @ 306 W/350 SX, 8 5/8 @ 4525 W/500 SX, 5 1/2 @ 10486 W/400 SX. LOG TOPS: MISSISSIPPIAN 13211, WOODFORD 13979, DEVONIAN 14010. OTD 14393. PB 10410. COMP 11/13/57. IPF 240 BOPD. PROD ZONE: WOLFCAMP 10285-10364;

WFX

LOC;

SABA ENERGY TEXAS
1A MORRIS
API 30-025-29247-0101

8-13S-36E
660 FNL 660 FWL SEC

WILDCAT; 11150 CISCO-DOLO, (FR 07/23/98MD) (ST APPD PMT: 07/22/98) **OPER ADD**: 1603 SE 19TH ST STE 202, EDMOND, OK, 73013 PHONE (405) 340-3600; **EL**: 4001 GR; **LOCATION DATA**: 3 MI S TATUM, NM .25 MI SE/10285 (WFMP) OIL PROD IN TATUM FIELD; **PBHL**: 660 FNL 330 FWL SEC, 8-13S-36E; (DEVIATED) OWST: OLD INFO: FORMERLY HUBER J M CORP 1 MORRIS. ELEV 4001 GR. SPUD 5/26/85. 13 3/8 @ 409 W/630 SX, 8 5/8 @ 4451 W/1300 SX. LOG TOPS: GLORIETA 5912, ABO 8079, WOLFCAMP 9475. OTD 10500. COMP 6/25/85. D&A;

WDR

CONTR: NORTON DRLG, **RIG #8**; **SPUD**: 07/12/98, **CSG**: 5 1/2 @ 11214; **DRLG COMMENTS**: CO TO 9520 SET WS& KO INTO STH @ 9590 DRLD TO 11240 IN STH RAN 5 1/2 CSG (TD REACHED: 08/ 06/98), **RIG REL**: 08/08/98; ... 11240 TD, TSTG (LDIR 10/05/98)



NEW MEXICO ENERGY, MINERALS
& NATURAL RESOURCES DEPARTMENT

OIL CONSERVATION DIVISION
2040 South Pacheco Street
Santa Fe, New Mexico 87505
(505) 827-7131

September 2, 1998

Yates Petroleum Corporation
105 South Fourth Street
Artesia, New Mexico 88210
Attention: Robert Bullock

Administrative Order NSL-4128

Dear Mr. Bullock:

Reference is made to your application dated August 26, 1998 for an unorthodox Morrow gas well location for the plugged and abandoned Sand Springs "AEH" State Well No. 1 (API No. 30-025-29843), to be redesignated the Sand Springs "ASU" State Well No. 1, located 330 feet from the North line and 1650 feet from the West line (Unit C) of Section 11, Township 11 South, Range 34 East, NMPM, Lea County, New Mexico.

This well was originally drilled to a total depth of 10,575 feet in 1987 in order to test the Strawn formation for oil whereby it tested dry and was subsequently plugged and abandoned.

It is our understanding that Yates now intends to reenter the well and deepen it to an approximate depth of 12,200 feet in order to test the Undesignated Sand Springs-Atoka Gas Pool within a standard 320-acre gas spacing and proration unit comprising the N/2 of the Section 11.

The application has been duly filed under the provisions of Division General Rule 104.F of the General Rules and Regulations of the New Mexico Oil Conservation Division.

By the authority granted me under the provisions of Division General Rule 104.F(2), the above-described unorthodox gas well location is hereby approved.

Sincerely,

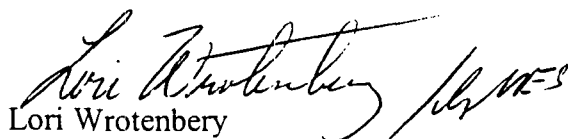
Lori Wrotenbery
Director

LW/MES/kv

cc: New Mexico Oil Conservation Division - Hobbs
New Mexico State Land Office - Santa Fe

District I
PO Box 1340, Hobbs, NM 88241-1900
District II
PO Drawer DD, Artesia, NM 88211-0719
District III
1000 Rio Branson Rd., Aztec, NM 87410
District IV
PO Box 2088, Santa Fe, NM 87504-2088

State of New Mexico
Energy, Minerals & Natural Resources Department

OIL CONSERVATION DIVISION
PO Box 2088
Santa Fe, NM 87504-2088

Form C-104
Revised February 10, 1994
Instructions on back
Submit to Appropriate District Office
5 Copies

☐ AMENDED REPORT

I. REQUEST FOR ALLOWABLE AND AUTHORIZATION TO TRANSPORT

Operator name and Address Yates Petroleum Corporation 105 South Fourth Street Artesia, NM 88210		OGRID Number 025575
		Reason for Filing Code RT of 25 BOPD & 1000 mcfpd from perfs 12110-12188 (Morrow) for Dec. 19
API Number 30 - 0 25-29843	Pool Name <i>Wildcat</i> Undesignated Morrow	Pool Code <i>96865</i>
Property Code 23599	Property Name Sand Springs ASU State	Well Number 1

II. ¹⁰ Surface Location

UL or lot no.	Section	Township	Range	Lot Ida	Feet from the	North/South Line	Feet from the	East/West line	County
C	11	11S	34E		330	North	1650	West	Lea

¹¹ Bottom Hole Location

UL or lot no.	Section	Township	Range	Lot Ida	Feet from the	North/South line	Feet from the	East/West line	County
Loc Code S	Producing Method Code F	Gas Connection Date 12-15-98	C-129 Permit Number	C-129 Effective Date	C-129 Expiration Date				

III. Oil and Gas Transporters

Transporter OGRID	Transporter Name and Address	POD	O/G	POD ULSTR Location and Description
138648	Amoco P/L Int. Trucking 502 N. West Avenue Levelland, TX 79336	<i>2822559</i>	O	Unit C - Section 11-T11S-R34E
025561	Yates Petroleum Corporation 105 South Fourth Street Artesia, NM 88210	<i>2822560</i>	G	Unit C - Section 11-T11S-R34E

IV. Produced Water

POD	POD ULSTR Location and Description
<i>2822561</i>	Unit C - Section 11-T11S-R34E

V. Well Completion Data

Spud Date	Ready Date	TD	PBTD	Perforations
Hole Size	Casing & Tubing Size	Depth Set	Sacks Cement	

VI. Well Test Data

Date New Oil	Gas Delivery Date	Test Date	Test Length	Tbg. Pressure	Csg. Pressure
Choke Size	Oil	Water	Gas	AOF	Test Method

I hereby certify that the rules of the Oil Conservation Division have been complied with and that the information given above is true and complete to the best of my knowledge and belief. Signature: <i>Rusty Klein</i>		OIL CONSERVATION DIVISION Approved by: <i>Chris Williams</i> Title: <i>DISTRICT SUPERVISOR</i> Approval Date: <i>DEC 23 1998</i>	
Printed name: Rusty Klein Title: Operations Technician Date: Dec. 16, 1998 Phone: 505-748-1471			
If this is a change of operator fill in the OGRID number and name of the previous operator			
Previous Operator Signature	Printed Name	Title	Date

District I
PO Box 1980, Hobbs, NM 88241-1980
District II
PO Drawer DD, Artesia, NM 88211-0719
District III
1000 Rio Brazos Rd., Aztec, NM 87410
District IV
PO Box 2088, Santa Fe, NM 87504-2088

State of New Mexico
Energy, Minerals & Natural Resources Department

OIL CONSERVATION DIVISION
PO Box 2088
Santa Fe, NM 87504-2088

Form C-102
Revised February 10, 1994
Instructions on back
Submit to Appropriate District Office
State Lease - 4 Copies
Fee Lease - 3 Copies

☐ AMENDED REPORT

WELL LOCATION AND ACREAGE DEDICATION PLAT

1 API Number 30-025-29843		2 Pool Code		3 Pool Name Undesignated Morrow	
4 Property Code 23599		5 Property Name Sand Springs ASU State			6 Well Number 1
7 OGRID No. 025575		8 Operator Name Yates Petroleum Corporation			9 Elevation 4145' GR

10 Surface Location

UL or lot no. C	Section 11	Township 11S	Range 34E	Lot Idn	Feet from the 330	North/South line North	Feet from the 1650	East/West line West	County Lea
--------------------	---------------	-----------------	--------------	---------	----------------------	---------------------------	-----------------------	------------------------	---------------

11 Bottom Hole Location If Different From Surface

UL or lot no.	Section	Township	Range	Lot Idn	Feet from the	North/South line	Feet from the	East/West line	County
---------------	---------	----------	-------	---------	---------------	------------------	---------------	----------------	--------

12 Dedicated Acres 320	13 Joint or Infill	14 Consolidation Code	15 Order No.
---------------------------	--------------------	-----------------------	--------------

NO ALLOWABLE WILL BE ASSIGNED TO THIS COMPLETION UNTIL ALL INTERESTS HAVE BEEN CONSOLIDATED
OR A NON-STANDARD UNIT HAS BEEN APPROVED BY THE DIVISION

16 11650'		17 OPERATOR CERTIFICATION	
		I hereby certify that the information contained herein is true and complete to the best of my knowledge and belief	
		Signature Rusty Klein	
		Printed Name Rusty Klein Operations Technician Title December 21, 1998 Date	
		18 SURVEYOR CERTIFICATION	
		I hereby certify that the well location shown on this plat was plotted from field notes of actual surveys made by me or under my supervision, and that the same is true and correct to the best of my belief.	
		REFER TO ORIGINAL PLAT Date of Survey	
		Signature and Seal of Professional Surveyer: Certificate Number	

District I
PO Box 1980, Hobbs, NM 88241-1980
District II
PO Drawer DD, Artesia, NM 88211-0719
District III
1000 Rio Brazos Rd., Aztec, NM 87410
District IV
PO Box 2088, Santa Fe, NM 87504-2088

State of New Mexico
Energy, Minerals & Natural Resources Department

OIL CONSERVATION DIVISION
PO Box 2088
Santa Fe, NM 87504-2088

Form C-102
Revised February 10, 1994
Instructions on back
Submit to Appropriate District Office
State Lease - 4 Copies
Fee Lease - 3 Copies

☐ AMENDED REPORT

WELL LOCATION AND ACREAGE DEDICATION PLAT

1 API Number 30-025-29843		2 Pool Code		3 Pool Name Undesignated Morrow	
4 Property Code 23599		5 Property Name Sand Springs ASU State			6 Well Number 1
7 OGRID No. 025575		8 Operator Name Yates Petroleum Corporation			9 Elevation 4145' GR

10 Surface Location

UL or lot no.	Section	Township	Range	Lot Ida	Feet from the	North/South line	Feet from the	East/West line	County
C	11	11S	34E		330	North	1650	West	Lea

11 Bottom Hole Location If Different From Surface

UL or lot no.	Section	Township	Range	Lot Ida	Feet from the	North/South line	Feet from the	East/West line	County

12 Dedicated Acres 320	13 Joint or Infill	14 Consolidation Code	15 Order No.
---------------------------	--------------------	-----------------------	--------------

NO ALLOWABLE WILL BE ASSIGNED TO THIS COMPLETION UNTIL ALL INTERESTS HAVE BEEN CONSOLIDATED
OR A NON-STANDARD UNIT HAS BEEN APPROVED BY THE DIVISION

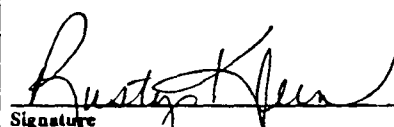
16 1650'				17 OPERATOR CERTIFICATION I hereby certify that the information contained herein is true and complete to the best of my knowledge and belief.  Signature Rusty Klein Printed Name Operations Technician Title December 21, 1998 Date
				18 SURVEYOR CERTIFICATION I hereby certify that the well location shown on this plat was plotted from field notes of actual surveys made by me or under my supervision, and that the same is true and correct to the best of my belief. REFER TO ORIGINAL PLAT Date of Survey Signature and Seal of Professional Surveyor: Certificate Number

DISTRICT I
P.O. Box 1980, Hobbs, NM 88240

DISTRICT II
P.O. Drawer DD, Artesia, NM 88210

DISTRICT III
1000 Rio Brazos Rd., Aztec, NM 87410

OIL CONSERVATION DIVISION

P.O. Box 2088
Santa Fe, New Mexico 87504-2088

WELL API NO. 30-025-29843
5. Indicate Type of Lease STATE <input checked="" type="checkbox"/> FEE <input type="checkbox"/>
6. State Oil & Gas Lease No. VO-4510
7. Lease Name or Unit Agreement Name Sand Spring ASU State
8. Well No. 1
9. Pool name or Wildcat Sand Springs <i>monow test</i> Atoka (gas)
10. Elevation (Show whether DF, RKB, RT, GR, etc.) 4145' GR

SUNDRY NOTICES AND REPORTS ON WELLS
(DO NOT USE THIS FORM FOR PROPOSALS TO DRILL OR TO DEEPEN OR PLUG BACK TO A
DIFFERENT RESERVOIR. USE "APPLICATION FOR PERMIT"
(FORM C-101) FOR SUCH PROPOSALS.)

1. Type of Well: OIL WELL <input type="checkbox"/> GAS WELL <input checked="" type="checkbox"/> OTHER
2. Name of Operator YATES PETROLEUM CORPORATION
3. Address of Operator 105 South 4th St., Artesia, NM 88210
4. Well Location Unit Letter C : 330 Feet From The North Line and 1650 Feet From The West Line Section 11 Township 11S Range 34E NMPM Lea County

11. Check Appropriate Box to Indicate Nature of Notice, Report, or Other Data	
NOTICE OF INTENTION TO:	SUBSEQUENT REPORT OF:
PERFORM REMEDIAL WORK <input type="checkbox"/>	REMEDIAL WORK <input type="checkbox"/>
TEMPORARILY ABANDON <input type="checkbox"/>	ALTERING CASING <input type="checkbox"/>
PULL OR ALTER CASING <input type="checkbox"/>	COMMENCE DRILLING OPNS. <input type="checkbox"/>
OTHER: <input type="checkbox"/>	PLUG AND ABANDONMENT <input type="checkbox"/>
	CASING TEST AND CEMENT JOB <input type="checkbox"/>
	OTHER: Perforate & frac <input checked="" type="checkbox"/>

12. Describe Proposed or Completed Operations (Clearly state all pertinent details, and give pertinent dates, including estimated date of starting any proposed work) SEE RULE 1103.

11-17-98 - Cleaned location, set and tested anchors. Moved in and rigged up pulling unit.
11-18-98 - TIH with bit, stabilizer, drill collars and 2-7/8" tubing. Tagged DV tool at 12609'. Rigged up power swivel and drilled out DV tool. Tested casing to 1400 psi. TIH and tagged cement at 12943'. Drilled out 272' of cement to float collar at 13215'. Circulate casing clean. Shut down.
11-19-98 - TOOH with tubing, drill collars, stabilizer and bit. TIH with bit, scraper and 2-7/8" tubing to 13215'. Displaced casing with 2% KCL water. TOOH. Rigged up wireline. TIH with logging tools and ran USET, CBL/CCL/GR log.
11-20-98 - TOOH with logs. Waiting on orders.
11-21-23-98 - Prep to perforate.
11-24-98 - Made up TCP guns and TIH with guns, packer and 2-7/8" tubing. Rigged up wireline. TIH with 1-11/16" gamma ray and correlated packer into place. Rigged down wireline. Set packer at 12034'. Removed BOP and nipped up wellhead. Dropped bar and opened vent. Dropped bar and fired guns - perforating 12110-12188' w/228 .38" holes (6 SPF - Morrow).

I hereby certify that the information above is true and complete to the best of my knowledge and belief.

CONTINUED ON NEXT PAGE:

SIGNATURE Rusty Klein TITLE Operations Technician DATE Dec. 7, 1998
TYPE OR PRINT NAME Rusty Klein TELEPHONE NO. 505/748-1471

(This space for State Use)

APPROVED BY Chris Williams TITLE DISTRICT 1 SUPERVISOR DATE DEC 21 1998

CONDITIONS OF APPROVAL, IF ANY:

YATES PETROLEUM CORPORATION
Sand Spring ASU State #1
Section 11-T11S-R34E
Lea County, New Mexico

SUNDRY NOTICE CONTINUED FROM PREVIOUS PAGE:

Flow tested. Shut well in.

11-25-98 - Blowed well down. Swabbed & flared well to pit. Shut well in.

11-26-29-98 - Blowed well down. Loaded tubing with 2% KCL water. Nippled down wellhead and installed BOP. TOOH. Rigged up wireline. TIH with gauge ring to 12340'. TOOH. TIH with CIBP and set CIBP at 12288'. TOOH and rigged down wireline. TIH with arrowset packer with on/off tool (1.875") and 2-7/8" tubing. Tested CIBP to 4000 psi. Pulled up and set packer at 12041'. Removed BOP and nipped up wellhead. Tested annulus to 1800 psi. Swabbed well down to 10800'. Could not get past 10800'. Suspect half of swab cup in the tubing. Shut down.

11-30-98 - Blowed well down. TIH with taper tap on sand line. Did not get swab cup. TIH with rod with wires on sandline. Did not get swab cup. Nippled down wellhead and installed BOP. Get off on/off tool and TOOH. Removed swab cup from tubing. TIH and latched onto packer at 12041'. Removed BOP and nipped up wellhead. Tested annulus to 1600 psi. Swabbed.

12-1-98 - Installed treesaver. Frac'd perforations 12110-12188' (Morrow) with 18,228 gallons 3% KCL water, 140 tons CO2 (total of 51500 gallons CO2 foam) and 59500# 20-40 interprop. Shut well in for 3 hours. Opened well and flowing back frac.

12-2-98 - Flowed back frac and flow tested. Shut well in.

12-3-98 - Opened well and flare well to pit - flow testing. Shut well in. Released well to production department.



Rusty Klein
Operations Technician
December 7, 1998

DISTRICT I
P.O. Box 1980, Hobbs, NM 88240

DISTRICT II
P.O. Drawer DD, Artesia, NM 88210

DISTRICT III
1000 Rio Brazos Rd., Aztec, NM 87410

OIL CONSERVATION DIVISION
P.O. Box 2088
Santa Fe, New Mexico 87504-2088

WELL API NO. 30-025-29843
5. Indicate Type of Lease STATE <input checked="" type="checkbox"/> FEE <input type="checkbox"/>
6. State Oil & Gas Lease No. VO-4510
7. Lease Name or Unit Agreement Name Sand Spring ASU State
8. Well No. 1
9. Pool name or Wildcat Sand Springs Atoka (gas)
10. Elevation (Show whether DF, RKB, RT, GR, etc.) 4145' GR

SUNDRY NOTICES AND REPORTS ON WELLS
(DO NOT USE THIS FORM FOR PROPOSALS TO DRILL OR TO DEEPEN OR PLUG BACK TO A
DIFFERENT RESERVOIR. USE "APPLICATION FOR PERMIT"
(FORM C-101) FOR SUCH PROPOSALS.)

1. Type of Well: OIL WELL <input type="checkbox"/> GAS WELL <input checked="" type="checkbox"/> OTHER
2. Name of Operator YATES PETROLEUM CORPORATION
3. Address of Operator 105 South 4th St., Artesia, NM 88210
4. Well Location Unit Letter <u>C</u> : <u>330</u> Feet From The <u>North</u> Line and <u>1650</u> Feet From The <u>West</u> Line Section <u>11</u> Township <u>11S</u> Range <u>34E</u> NMPM Lea County
10. Elevation (Show whether DF, RKB, RT, GR, etc.) 4145' GR

11. Check Appropriate Box to Indicate Nature of Notice, Report, or Other Data

NOTICE OF INTENTION TO:

PERFORM REMEDIAL WORK <input type="checkbox"/>	PLUG AND ABANDON <input type="checkbox"/>
TEMPORARILY ABANDON <input type="checkbox"/>	CHANGE PLANS <input type="checkbox"/>
PULL OR ALTER CASING <input type="checkbox"/>	
OTHER: <input type="checkbox"/>	

SUBSEQUENT REPORT OF:

REMEDIAL WORK <input type="checkbox"/>	ALTERING CASING <input type="checkbox"/>
COMMENCE DRILLING OPNS. <input type="checkbox"/>	PLUG AND ABANDONMENT <input type="checkbox"/>
CASING TEST AND CEMENT JOB <input type="checkbox"/>	
OTHER: <u>Re-entry</u> <input checked="" type="checkbox"/>	

12. Describe Proposed or Completed Operations (Clearly state all pertinent details, and give pertinent dates, including estimated date of starting any proposed work) SEE RULE 1103.

10-1-98 - TD 9762'. Reaming. Picked up drillpipe and TIH. Tagged up at 6355'. Drilled cement from 6355-6401'. Picked up drillpipe and TIH. Tagged up at 6710'. Reamed from 6710-6854'. Circulate bottoms up. Picked up drillpipe and TIH. Tagged up at 7371'. Washed through Abo from 7371-7822'. Picked up drillpipe and TIH. Tagged up at 8160'. Washed from 8160-8340'. Circulate bottoms up. Picked up drillpipe and TIH. Tagged up at 8774'. Drilled cement from 8774-8868'. Picked up drillpipe and TIH. Tagged up at 8931'. Reamed from 8931-8970'. Picked up drillpipe and TIH. Tagged up at 9199'. Reamed from 9199-9730'. Circulate hole clean. Ream from 9730-9762'.
10-2-98 - TD 10594'. Circulating. Reamed from 9762-9793'. Circulate and condition mud. Ream from 9793-10094'. Drilled cement from 10094-10120'. Reamed from 10120-10594'.

Resumed drilling new formation at 6:30 AM 10-3-98.

I hereby certify that the information above is true and complete to the best of my knowledge and belief.

SIGNATURE Rusty Klein TITLE Operations Technician DATE Oct. 9, 1998
TYPE OR PRINT NAME Rusty Klein TELEPHONE NO. 505/748-1471

(This space for State Use)

APPROVED BY Chris Williams TITLE DISTRICT 1 SUPERVISOR DATE NOV 06 1998

CONDITIONS OF APPROVAL, IF ANY:

DISTRICT I
P.O. Box 1980, Hobbs, NM 88240

DISTRICT II
P.O. Drawer DD, Artesia, NM 88210

DISTRICT III
1000 Rio Brazos Rd., Aztec, NM 87410

OIL CONSERVATION DIVISION
P.O. Box 2088
Santa Fe, New Mexico 87504-2088

WELL API NO. 30-025-29843
5. Indicate Type of Lease STATE <input checked="" type="checkbox"/> FEE <input type="checkbox"/>
6. State Oil & Gas Lease No. VO-4510
7. Lease Name or Unit Agreement Name Sand Spring ASU State
8. Well No. 1
9. Pool name or Wildcat Sand Springs Atoka (gas)

SUNDRY NOTICES AND REPORTS ON WELLS
(DO NOT USE THIS FORM FOR PROPOSALS TO DRILL OR TO DEEPEN OR PLUG BACK TO A DIFFERENT RESERVOIR. USE "APPLICATION FOR PERMIT" (FORM C-101) FOR SUCH PROPOSALS.)

1. Type of Well: OIL WELL <input type="checkbox"/> GAS WELL <input checked="" type="checkbox"/> OTHER	2. Name of Operator YATES PETROLEUM CORPORATION
3. Address of Operator 105 South 4th St., Artesia, NM 88210	4. Well Location Unit Letter C : 330 Feet From The North Line and 1650 Feet From The West Line Section 11 Township 11S Range 34E NMPM Lea County
10. Elevation (Show whether DF, RKB, RT, GR, etc.) 4145' GR	

11. Check Appropriate Box to Indicate Nature of Notice, Report, or Other Data

NOTICE OF INTENTION TO:

PERFORM REMEDIAL WORK ☐ PLUG AND ABANDON ☐
TEMPORARILY ABANDON ☐ CHANGE PLANS ☐
PULL OR ALTER CASING ☐
OTHER: ☐

SUBSEQUENT REPORT OF:

REMEDIAL WORK ☐ ALTERING CASING ☐
COMMENCE DRILLING OPNS. ☐ PLUG AND ABANDONMENT ☐
CASING TEST AND CEMENT JOB ☐
OTHER: Re-entry ☒

12. Describe Proposed or Completed Operations (Clearly state all pertinent details, and give pertinent dates, including estimated date of starting any proposed work) SEE RULE 1103.

9-19-98 - Building location.
9-22-98 - Building location. Welded on 8-5/8" SOW X 11" 5K ER-BP casing head.
9-23-98 - Building location.
9-25-98 - Drilled rat and mouse holes.
9-26-98 - Waiting on rotary tools.
9-27-98 - Moving in rotary tools.
9-28-98 - Rigging up rotary tools.
9-29-98 - Finished rigging up. Nippled up BOP and tested. TIH and wash to next plug.
Test BOP equipment, pipe rams, blind rams, choke manifold and kelly valves to 5000# and hydril to 2500#. TIH with drill collars and drill pipe. Tagged up at 1593' (wall cake).
Reamed from 1593-1900'. Drilled cement plug from 1900-1980'. Reamed from 1980-2070' (wall cake). TIH and tagged at 3110'. Reamed from 3110-4785'. Drilled cement plug from 4785-4870'. Reamed from 4870-5446'. No surface plug and no plug at bottom of casing.
NOTE: Spudded in at 8:45 AM 9-30-98.

I hereby certify that the information above is true and complete to the best of my knowledge and belief.

SIGNATURE Rusty Klein TITLE Operations Technician DATE Oct. 2, 1998
TYPE OR PRINT NAME Rusty Klein TELEPHONE NO. 505/748-1471

(This space for State Use)

APPROVED BY Chris Williams TITLE DISTRICT 1 SUPERVISOR DATE NOV 6 1998
CONDITIONS OF APPROVAL, IF ANY:

DISTRICT I
P.O. Box 1980, Hobbs, NM 88240

DISTRICT II
P.O. Drawer DD, Artesia, NM 88210

DISTRICT III
1000 Rio Brazos Rd., Aztec, NM 87410

OIL CONSERVATION DIVISION
P.O. Box 2088
Santa Fe, New Mexico 87504-2088

WELL API NO. 30-025-29843
5. Indicate Type of Lease STATE <input checked="" type="checkbox"/> FEE <input type="checkbox"/>
6. State Oil & Gas Lease No. VO-4510
7. Lease Name or Unit Agreement Name Sand Spring ASU State
8. Well No. 1
9. Pool name or Wildcat Sand Springs Atoka (gas)
10. Elevation (Show whether DF, RKB, RT, GR, etc.) 4145' GR

SUNDRY NOTICES AND REPORTS ON WELLS (DO NOT USE THIS FORM FOR PROPOSALS TO DRILL OR TO DEEPEN OR PLUG BACK TO A DIFFERENT RESERVOIR. USE "APPLICATION FOR PERMIT" (FORM C-101) FOR SUCH PROPOSALS.)	
1. Type of Well: OIL WELL <input type="checkbox"/> GAS WELL <input checked="" type="checkbox"/> OTHER	2. Name of Operator YATES PETROLEUM CORPORATION
3. Address of Operator 105 South 4th St., Artesia, NM 88210	4. Well Location Unit Letter <u>C</u> : <u>330</u> Feet From The <u>North</u> Line and <u>1650</u> Feet From The <u>West</u> Line Section <u>11</u> Township <u>11S</u> Range <u>34E</u> NMPM Lea County
10. Elevation (Show whether DF, RKB, RT, GR, etc.) 4145' GR	

11. Check Appropriate Box to Indicate Nature of Notice, Report, or Other Data	
NOTICE OF INTENTION TO:	SUBSEQUENT REPORT OF:
PERFORM REMEDIAL WORK <input type="checkbox"/>	REMEDIAL WORK <input type="checkbox"/>
TEMPORARILY ABANDON <input type="checkbox"/>	ALTERING CASING <input type="checkbox"/>
PULL OR ALTER CASING <input type="checkbox"/>	COMMENCE DRILLING OPNS. <input type="checkbox"/>
OTHER: <input type="checkbox"/>	PLUG AND ABANDONMENT <input type="checkbox"/>
	CASING TEST AND CEMENT JOB <input type="checkbox"/>
	OTHER: <input type="checkbox"/>

12. Describe Proposed or Completed Operations (Clearly state all pertinent details, and give pertinent dates, including estimated date of starting any proposed work) SEE RULE 1103.

Yates Petroleum Corporation respectfully requests permission to drill to a depth of 13,500' to test the Devonian and intermediate formations. Application for Permit to Drill, Re-Enter originally requested permission to drill to 12200' Atoka.

I hereby certify that the information above is true and complete to the best of my knowledge and belief.

SIGNATURE Rusty Klein TITLE Operations Technician DATE October 29, 1998
TYPE OR PRINT NAME Rusty Klein TELEPHONE NO. 505/748-1471

(This space for State Use)

APPROVED BY Chris Williams DISTRICT 1 SUPERVISOR DATE NOV 06 1998
CONDITIONS OF APPROVAL, IF ANY:

District I
PC Box 1980, Hobbs, NM 88241-1980
District II
PO Drawer DD, Artesia, NM 88211-0719
District III
1000 Rio Brazos Rd., Aztec, NM 87410
District IV
PO Box 2088, Santa Fe, NM 87504-2088

State of New Mexico
Energy, Minerals & Natural Resources Department

OIL CONSERVATION DIVISION
PO Box 2088
Santa Fe, NM 87504-2088

Form C-102
Revised February 10, 1994
Instructions on back
Submit to Appropriate District Office
State Lease - 4 Copies
Fee Lease - 3 Copies

☐ AMENDED REPORT

WELL LOCATION AND ACREAGE DEDICATION PLAT

API Number 30-025-29843		Pool Code	Pool Name Undesignated Devonian
Property Code 23599	Property Name Sand Spring ASU State		Well Number 1
OGRID No. 025575	Operator Name Yates Petroleum Corporation		Elevation 4145'

¹⁰ Surface Location

UL or lot no.	Section	Township	Range	Lot Idn	Feet from the	North/South line	Feet from the	East/West line	County
C	11	11S	34E		330	North	1650	West	Lea

¹¹ Bottom Hole Location If Different From Surface

UL or lot no.	Section	Township	Range	Lot Idn	Feet from the	North/South line	Feet from the	East/West line	County

¹² Dedicated Acres 40	¹³ Joint or Infill	¹⁴ Consolidation Code	¹⁵ Order No.
-------------------------------------	-------------------------------	----------------------------------	-------------------------

NO ALLOWABLE WILL BE ASSIGNED TO THIS COMPLETION UNTIL ALL INTERESTS HAVE BEEN CONSOLIDATED
OR A NON-STANDARD UNIT HAS BEEN APPROVED BY THE DIVISION

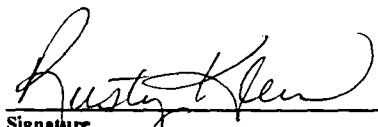
¹⁶ 1650' 330'				¹⁷ OPERATOR CERTIFICATION <i>I hereby certify that the information contained herein is true and complete to the best of my knowledge and belief</i>  Signature Rusty Klein Printed Name Operations Technician Title October 29, 1998 Date
				¹⁸ SURVEYOR CERTIFICATION <i>I hereby certify that the well location shown on this plat was plotted from field notes of actual surveys made by me or under my supervision, and that the same is true and correct to the best of my belief.</i> REFER TO ORIGINAL PLAT Date of Survey Signature and Seal of Professional Surveyor: Certificate Number

District I :
PO Box 1980, Hobbs, NM 88241-1980
District II
811 South First, Artesia, NM 88210
District III
1000 Rio Brazos Rd., Aztec, NM 87410
District IV
2040 South Pacheco, Santa Fe, NM 87505

State of New Mexico
Energy, Minerals & Natural Resources Department

OIL CONSERVATION DIVISION
2040 South Pacheco
Santa Fe, NM 87505

Form C-101
Revised October 18, 1994
Instructions on back
Submit to Appropriate District Office
State Lease - 6 Copies
Fee Lease - 5 Copies

☐ AMENDED REPORT

APPLICATION FOR PERMIT TO DRILL, RE-ENTER, DEEPEN, PLUGBACK, OR ADD A ZONE

¹ Operator Name and Address. Yates Petroleum Corporation 105 S. 4th Street Artesia, New Mexico 88210		² OGRID Number 025575
		³ API Number 30 - 025 - 29843
⁴ Property Code 23599	⁵ Property Name Sand Spring ASU State	⁶ Well No. 1

⁷ Surface Location

UL or lot no.	Section	Township	Range	Lot Ida	Feet from the	North/South line	Feet from the	East/West line	County
C	11	11S	34E		330'	North	1650'	West	Lea

⁸ Proposed Bottom Hole Location If Different From Surface

UL or lot no.	Section	Township	Range	Lot Ida	Feet from the	North/South line	Feet from the	East/West line	County
⁹ Proposed Pool 1 Sand Springs Atoka Gas					¹⁰ Proposed Pool 2				

¹¹ Work Type Code E	¹² Well Type Code G	¹³ Cable/Rotary R	¹⁴ Lease Type Code S	¹⁵ Ground Level Elevation 4145'
¹⁶ Multiple No	¹⁷ Proposed Depth 12,200'	¹⁸ Formation Atoka	¹⁹ Contractor Undesignated	²⁰ Spud Date ASAP

²¹ Proposed Casing and Cement Program

Hole Size	Casing Size	Casing weight/foot	Setting Depth	Sacks of Cement	Estimated TOC
17 1/2"	13 3/8"	54.5# J-55	410' In Place		
11"	8 5/8"	32# J-55	4208' In Place		
7 7/8"	4 1/2"	13.5# P-110	TD	350 sacks	10,900'

²² Describe the proposed program. If this application is to DEEPEN or PLUG BACK give the data on the present productive zone and proposed new productive zone. Describe the blowout prevention program, if any. Use additional sheets if necessary.

Yates Petroleum Corporation proposes to drill out the plugs to the old TD of 10,575' and deepen the hole to a depth of 12,200'. Run 4 1/2" casing to TD and cement back to 10,900' or 500' above the Atoka. Perforate and stimulate as needed to gain production.

MUD PROGRAM: 0-10,575' existing mud (Salt Gel/Starch) in hole; 10,575'-TD Salt Gel/Starch.

BOPE PROGRAM: 5000# system will be nipped up on the 8 5/8" casing and tested daily.

²³ I hereby certify that the information given above is true and complete to the best of my knowledge and belief.

Signature:

Clifton R. May

Printed name:

CLIFTON R. MAY

Title:

REGULATORY AGENT

Date:

August 7, 1998

Phone:

505-748-4347

OIL CONSERVATION DIVISION

Approved by:

Chris Williams

Title:

DISTRICT 1 SUPERVISOR

Approval Date:

SEP 09 1998

Expiration Date:

Conditions of Approval:

Attached ☐

Date Unless Drilling Underway

Re. 844

District I
PO Box 1980, Hobbs, NM 88241-1980
District II
PO Drawer DD, Artesia, NM 88211-0719
District III
1000 Rio Brazos Rd., Aztec, NM 87410
District IV
PO Box 2088, Santa Fe, NM 87504-2088

State of New Mexico
Energy, Minerals & Natural Resources Department

OIL CONSERVATION DIVISION
PO Box 2088
Santa Fe, NM 87504-2088

Form C-102
Revised February 10, 1994
Instructions on back
Submit to Appropriate District Office
State Lease - 4 Copies
Fee Lease - 3 Copies

☐ AMENDED REPORT

WELL LOCATION AND ACREAGE DEDICATION PLAT

1 API Number 30-025-29843		2 Pool Code 84871		3 Pool Name Sand Springs Atoka Gas	
4 Property Code 23599		5 Property Name Sand Spring "ASU" State			6 Well Number 1
7 OGRID No. 025575		8 Operator Name YATES PETROLEUM CORPORATION			9 Elevation 4145'

10 Surface Location

UL or lot no.	Section	Township	Range	Lot Idn	Feet from the	North/South line	Feet from the	East/West line	County
C	11	11S	34E		330'	North	1650'	West	Lea

11 Bottom Hole Location If Different From Surface

UL or lot no.	Section	Township	Range	Lot Idn	Feet from the	North/South line	Feet from the	East/West line	County
12 Dedicated Acres 320		13 Joint or Infill		14 Consolidation Code		15 Order No.			

NO ALLOWABLE WILL BE ASSIGNED TO THIS COMPLETION UNTIL ALL INTERESTS HAVE BEEN CONSOLIDATED
OR A NON-STANDARD UNIT HAS BEEN APPROVED BY THE DIVISION

	17 OPERATOR CERTIFICATION I hereby certify that the information contained herein is true and complete to the best of my knowledge and belief. Signature: <u>Clifton R. May</u> Printed Name: <u>Clifton R. May</u> Title: <u>Regulatory Agent</u> Date: <u>August 7, 1998</u>	
	18 SURVEYOR CERTIFICATION I hereby certify that the well location shown on this plat was plotted from field notes of actual surveys made by me or under my supervision, and that the same is true and correct to the best of my belief. Refer To Original Plat Date of Survey: _____ Signature and Seal of Professional Surveyor: _____	
	Certificate Number: _____	

NEW MEXICO OIL CONSERVATION COMMISSION
WELL LOCATION AND ACREAGE DEDICATION PLAT

Form C-102
Supersedes C-128
Effective 1-4-65

All distances must be from the outer boundaries of the Section.

Operator YATES PETROLEUM CORPORATION			Lease SAND SPRING "AEM" State		Well No. 1
Unit Letter "C"	Section 11	Township 11 South	Range 34 East	County Lea	
Actual Footage Location of Well: 330 feet from the North line and 1650 feet from the West line					
Ground Level Elev. 4145	Producing Formation		Depth		Dedicated Acreage: Acres

1. Outline the acreage dedicated to the subject well by colored pencil or hachure marks on the plat below.
2. If more than one lease is dedicated to the well, outline each and identify the ownership thereof (both as to working interest and royalty).
3. If more than one lease of different ownership is dedicated to the well, have the interests of all owners been consolidated by communitization, unitization, force-pooling, etc?

☐ Yes ☐ No If answer is "yes," type of consolidation _____

If answer is "no," list the owners and tract descriptions which have actually been consolidated. (Use reverse side of this form if necessary.) _____

No allowable will be assigned to the well until all interests have been consolidated (by communitization, unitization, forced-pooling, or otherwise) or until a non-standard unit, eliminating such interests, has been approved by the Commission.

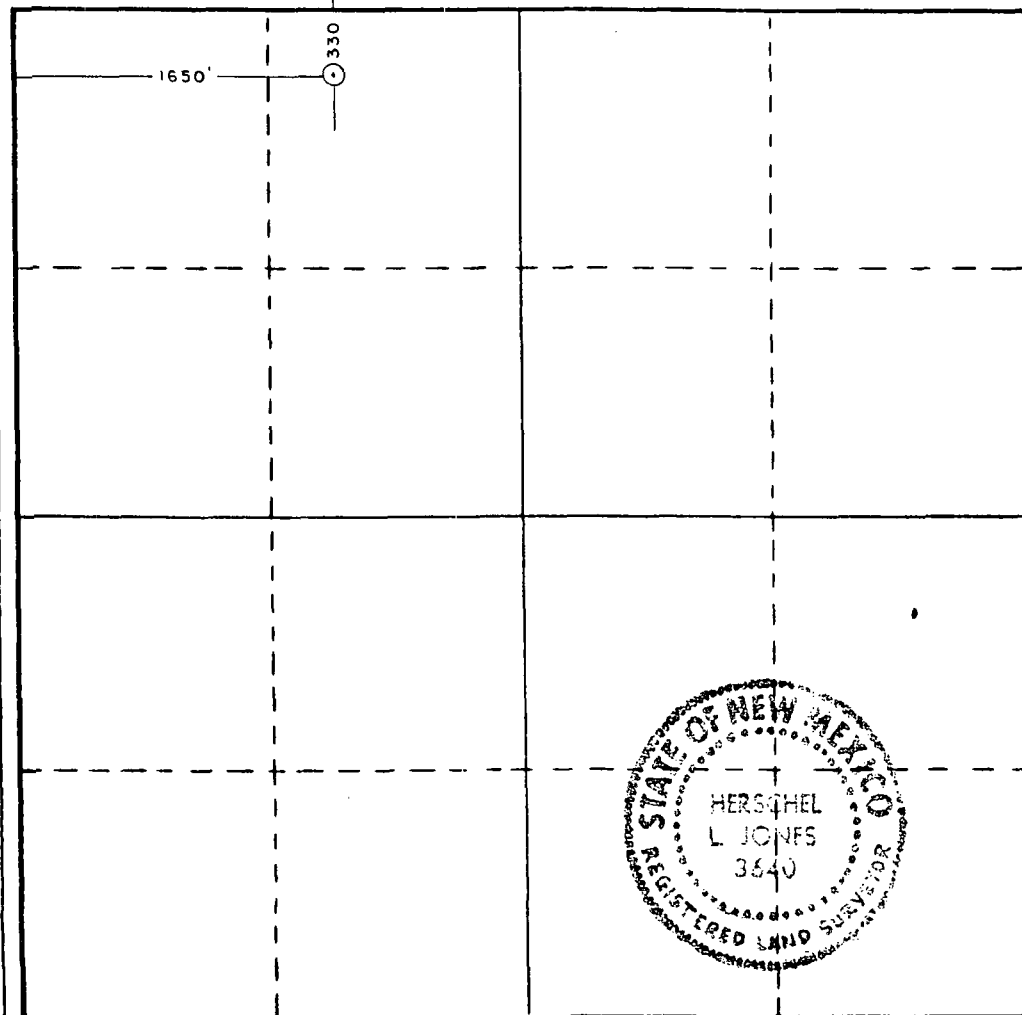

CERTIFICATION

I hereby certify that the information contained herein is true and complete to the best of my knowledge and belief.

Name

Position

Company

Date

I hereby certify that the well location shown on this plat was plotted from field notes of actual surveys made by me or under my supervision, and that the same is true and correct to the best of my knowledge and belief.

Date Surveyed

January 19, 1937

Registered Professional Engineer
and/or Land Surveyor

Certificate No.

3640

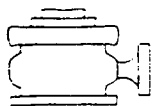

Yates Petroleum Corporation

BOP-4

Typical 5,000 psi Pressure System Schematic Annular with Double Ram Preventer Stack

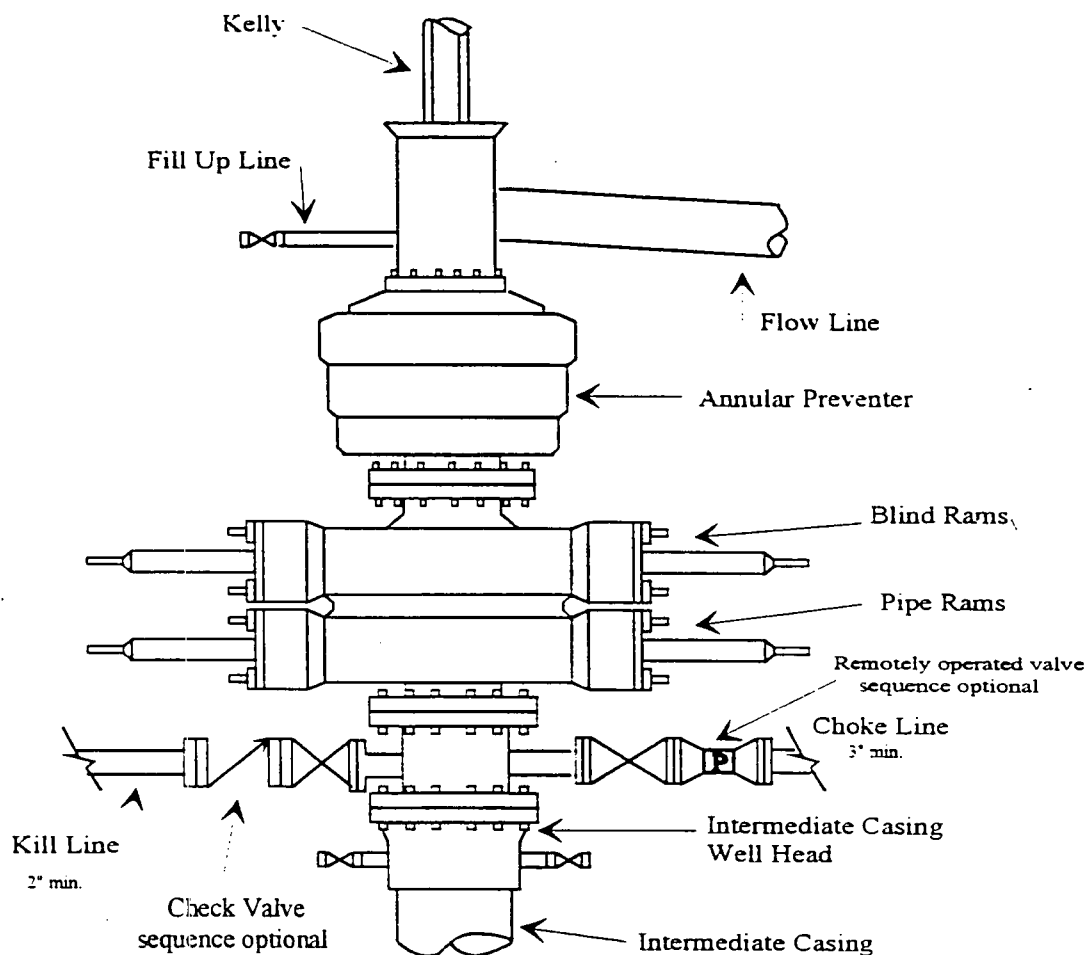

Typical 5,000 psi choke manifold assembly with at least these minimum features

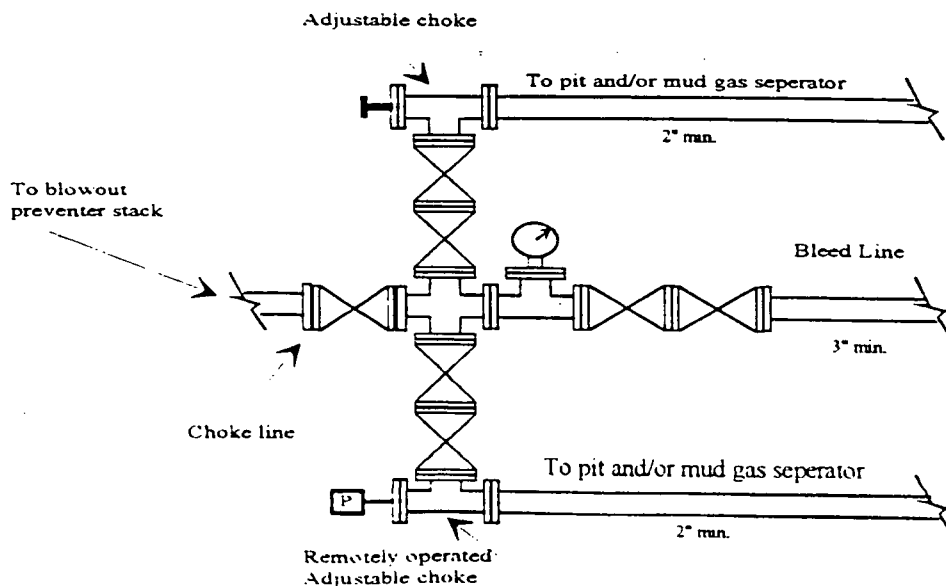

API: 30-025-29843-00
ISSUE: R02/89
CARD: 3

[illegible]

API: 30-025-28843-00
ISSUE: R02/88
CARD: 2+

[REDACTED]

[REDACTED]

[REDACTED]

[REDACTED]

[REDACTED] [REDACTED]

[REDACTED]

[REDACTED]

[REDACTED]

APR 30-025-29843-00
ISSUE R02/89
CARD 1+

[illegible]