

DATE IN 3/23/09	SUSPENSE	ENGINEER W. Jones	LOGGED 3/23/09	TYPE DHC 4189	PKA0908357349
--------------------	----------	----------------------	-------------------	---------------------	---------------

RECEIVED
NEW MEXICO OIL CONSERVATION DIVISION
 2009 MAR 23 PM 1 33 - Engineering Bureau -

30-025-37179
 W.T. McComack #23
 Chevron 4323

ADMINISTRATIVE APPLICATION COVERSHEET

THIS COVERSHEET IS MANDATORY FOR ALL ADMINISTRATIVE APPLICATIONS FOR EXCEPTIONS TO DIVISION RULES AND REGULATIONS

Application Acronyms:

[NSP-Non-Standard Proration Unit] [NSL-Non-Standard Location]
 [DD-Directional Drilling] [SD-Simultaneous Dedication]
 [DHC-Downhole Commingling] [CTB-Lease Commingling] [PLC-Pool/Lease Commingling]
 [PC-Pool Commingling] [OLS - Off-Lease Storage] [OLM-Off-Lease Measurement]
 [WFX-Waterflood Expansion] [PMX-Pressure Maintenance Expansion]
 [SWD-Salt Water Disposal] [IPI-Injection Pressure Increase]
 [EOR-Qualified Enhanced Oil Recovery Certification] [PPR-Positive Production Response]

[1] TYPE OF APPLICATION - Check Those Which Apply for [A]

[A] Location - Spacing Unit - Directional Drilling
☐ NSL ☐ NSP ☐ DD ☐ SD

Check One Only for [B] and [C]

[B] Commingling - Storage - Measurement
☒ DHC ☐ CTB ☐ PLC ☐ PC ☐ OLS ☐ OLM

[C] Injection - Disposal - Pressure Increase - Enhanced Oil Recovery
☐ WFX ☐ PMX ☐ SWD ☐ IPI ☐ EOR ☐ PPR

[2] NOTIFICATION REQUIRED TO: - Check Those Which Apply, or ☒ Does Not Apply

[A] ☐ Working, Royalty or Overriding Royalty Interest Owners

[B] ☐ Offset Operators, Leaseholders or Surface Owner

[C] ☐ Application is One Which Requires Published Legal Notice

[D] ☐ Notification and/or Concurrent Approval by BLM or SLO
U.S. Bureau of Land Management - Commissioner of Public Lands, State Land Office

[E] ☐ For all of the above, Proof of Notification or Publication is Attached, and/or,

[F] ☐ Waivers are Attached

[3] INFORMATION / DATA SUBMITTED IS COMPLETE - Statement of Understanding

I hereby certify that I, or personnel under my supervision, have read and complied with all applicable Rules and Regulations of the Oil Conservation Division. Further, I assert that the attached application for administrative approval is accurate and complete to the best of my knowledge and where applicable, verify that all interest (WI, RI, ORRI) is common. I understand that any omission of data, information or notification is cause to have the application package returned with no action taken.

Note: Statement must be completed by an individual with supervisory capacity.

Carolyn Haynie

Print or Type Name

Signature

Carolyn Haynie

PE Technical Assistant

Title

3/18/2009

Date



Carolyn Haynie
Petroleum Engineering
Technical Assistant

Permian Business Unit
Chevron U.S.A Inc.
15 Smith Road
Midland, TX 79705
Tel 432-687-7261
Fax 432-687-7558
chay@chevron.com

March 18, 2009

New Mexico Oil Conservations Division
1220 South St. Francis Drive
Santa Fe, New Mexico 87504

Re: Request to DHC the W.T. McComack #23
Oil and Gas Department

Chevron U.S.A. Inc. respectfully requests Administrative approval to Downhole Commingle the Grayburg and the San Andres formations in the W.T. McComack #23, API 30-025-37179, 2300' FNL & 1400' FEL, Unit Letter G, Sec. 32, T21S, R37E, Lea County, NM.

Chevron plans to recomplete the W.T. McComack #23, by drilling out the CIBP @ 3985' to the plugged back total depth of 4216'. Eunice San Andres perforations will be added from 4006' to 4194', with 300 total holes and a distance of 75'. The new perfs will be acidized as indicated on the OCD C-103, included in the attachments, and downhole commingled with the existing Penrose Skelly Grayburg perfs.

Attached in support with this request is a table with production volumes for each of the pools proposed for commingling. Also, included is a current and proposed wellbore schematic diagram for the McComack # 23, well test information, C107A, C102 and a lease plat.

Chevron has a 100% working interest in this wells and the royalty and over-riding royalty owners are the same for both formations. For your convenience, I have enclosed an envelope with my return address, so the decision for this application can be sent directly to me. If you require additional information, please contact me by telephone at 432-687-7261, or by email at chay@chevron.com.

Sincerely,

A handwritten signature in cursive script that reads "Carolyn Haynie".

Carolyn Haynie
NM PE Technical Assistant

Enclosure

cc: NMOCD – District I; Hobbs
Lease File
Lonnie Grohman
Danny Lovell
Denise Pinkerton

District I
1625 N. French Drive, Hobbs, NM 88249

District II
1301 W. Grand Avenue, Artesia, NM 88210

District III
1000 Rio Brazos Road, Aztec, NM 87410

Pools
District IV
1220 S. St. Francis Dr., Santa Fe, NM 87505

State of New Mexico
Energy, Minerals and Natural Resources Department

Form C-107A
Revised June 10, 2003

Oil Conservation Division
1220 South St. Francis Dr.
Santa Fe, New Mexico 87505

APPLICATION TYPE
☒ Single Well
☒ Establish Pre-Approved

EXISTING WELLBORE
☐ Yes ☒ No

APPLICATION FOR DOWNHOLE COMMINGLING

CHEVRON U.S.A. INC.

15 SMITH ROAD, MIDLAND, TX 79705

Operator

Address

W.T. McCOMACK

#23

G-32-21S-37E

Lea

Lease

Well No.

Unit Letter-Section-Township-Range

County

OGRID No. 4323 Property Code 2566 API No. 30-025-37179 Lease Type: Federal State ☒ Fee

DATA ELEMENT	UPPER ZONE	INTERMEDIATE ZONE	LOWER ZONE
Pool Name	Penrose Skelly Grayburg	n/a	Eunice San Andres
Pool Code	50350	n/a	24150
Top and Bottom of Pay Section (Perforated or Open-Hole Interval)	3677' - 3946' Perforated	n/a	3926' - 4194' Perforated
Method of Production (Flowing or Artificial Lift)	Artificial Lift	n/a	Artificial Lift
Bottomhole Pressure (Note: Pressure data will not be required if the bottom perforation in the lower zone is within 150% of the depth of the top perforation in the upper zone)	n/a	n/a	n/a
Oil Gravity or Gas BTU (Degree API or Gas BTU)	36°	n/a	36°
Producing, Shut-In or New Zone	Producing	n/a	New Zone
Date and Oil/Gas/Water Rates of Last Production. (Note: For new zones with no production history, applicant shall be required to attach production estimates and supporting data.)	Date: Proposed Oil Gas 11 BBL 252 MCF	Date: Proposed Oil Gas -	Date: Proposed Oil Gas 9 BBL 148 MCF
Fixed Allocation Percentage (Note: If allocation is based upon something other than current or past production, supporting data or explanation will be required.)	Oil Gas 56% 63%	Oil Gas	Oil Gas 44% 37%

ADDITIONAL DATA

Are all working, royalty and overriding royalty interests identical in all commingled zones? Yes ☒ No ☐
If not, have all working, royalty and overriding royalty interest owners been notified by certified mail? Yes ☐ No ☐
Are all produced fluids from all commingled zones compatible with each other? Yes ☒ No ☐
Will commingling decrease the value of production? Yes ☐ No ☒
If this well is on, or communitized with, state or federal lands, has either the Commissioner of Public Lands
or the United States Bureau of Land Management been notified in writing of this application? Yes ☐ No ☐

NMOCD Reference Case No. applicable to this well: R-11363

Attachments:

- C-102 for each zone to be commingled showing its spacing unit and acreage dedication.
- Production curve for each zone for at least one year. (If not available, attach explanation.)
- For zones with no production history, estimated production rates and supporting data.
- Data to support allocation method or formula.
- Notification list of working, royalty and overriding royalty interests for uncommon interest cases.
- Any additional statements, data or documents required to support commingling.

PRE-APPROVED POOLS

If application is to establish Pre-Approved Pools, the following additional information will be required:

- List of other orders approving downhole commingling within the proposed Pre-Approved Pools
- List of all operators within the proposed Pre-Approved Pools
- Proof that all operators within the proposed Pre-Approved Pools were provided notice of this application.
- Bottomhole pressure data.

I hereby certify that the information above is true and complete to the best of my knowledge and belief.

SIGNATURE Carolyn Haynie TITLE PE Technical Assistant DATE 3/18/2009

TYPE OR PRINT NAME Carolyn Haynie TELEPHONE NO. (432) 687-7261

E-MAIL ADDRESS chay@chevron.com

Request for exemption to rule 303-A
FOR WELLS LOCATED IN PRE-APPROVED POOLS OR AREAS

Operator

Chevron U.S.A., Inc.
15 Smith Road
Midland, TX 79705

Lease Name and Well Number

W.T McComack #23
API #30-025-37179
2300 FNL & 1400 FEL, Unit Letter G
Section 32, T21S, R37E
Lea County, New Mexico

Division Order

Pre-approved Pools or Areas established by division order # R-11363

Pools To Be Commingled In W.T. McComack #23

(50350) Penrose Skelly Grayburg
(24150) Eunice San Andres

Perforated Intervals

Grayburg existing perms: 3946' - 3677'
San Andres Perfs: 4194' - 3926' (to be added)

Location Plat

Attached

Well Test Report & Production Plots

Attached.

Product Characteristics And Value

Previous commingling of these zones by Chevron and other operators in the area have shown that the produced fluids are compatible and commingling will not cause formation damage or producing problems. Also, the price received by Chevron for products from these zones is very similar, so value will not be adversely affected.

Production Allocation

<u>Pool</u>	<u>BOPD</u>	<u>BWPD</u>	<u>MCFPD</u>	<u>Remarks</u>
(50350) Grayburg	11	200	250	Calculated From Allocations %
(24150) San Andres	9	300	150	Calculated From Allocations %
Totals	20	500	400	

<u>Allocated %</u>	<u>Oil %</u>	<u>Water %</u>	<u>Gas %</u>	<u>Remarks</u>
(50350) Grayburg	56	40	63	From offset EUR
(24150) San Andres	44	60	37	From offset EUR
Totals	100	100	100	

Ownership

Ownership of all zones is identical so correlative rights will not be compromised.

State / Federal Land Notification

This is a FEE lease

Supporting Data

Eunice San Andres	BBL	MCF
E O Carson #25	8,753	601,266
Owen B #8	7,267	54,752
Owen B #9	6,885	123,853
Owen B #5	11,734	29,651
	8,660	202,381

Grayburg	BBL	MCF
W. T. McComack #17	14,322	635,294
W. T. McComack #20	13,782	294,054
W. T. McComack #21	7,070	319,956
W.T. McComack #22	10,741	277,043
W.T. McComack #25	10,248	164,108
	11,233	338,091

Totals: 19,892 540,472

	% Oil	% Gas
San Andres	0.44	0.37
Grayburg	0.56	0.63

Production	Oil	Gas
San Andres	9	150
Grayburg	11	250
	20	400

District I
1625 N. French Dr., Hobbs, NM 88240

District II
811 South First, Artesia, NM 88210

District III
1000 Rio Brazos Rd., Aztec, NM 87410

District IV
2040 South Pacheco, Santa Fe, NM 87505

State of New Mexico
Energy, Minerals & Natural Resources Department

Form C-102
Revised March 17, 1999

OIL CONSERVATION DIVISION Submit to Appropriate District Office
State Lease - 4 Copies
Fee Lease - 3 Copies
2040 South Pacheco
Santa Fe, NM 87505

☐ AMENDED REPORT

WELL LOCATION AND ACREAGE DEDICATION PLAT

¹ API Number 30-025-37179	² Pool Code 24150	³ Pool Name Eunice San Andres
⁴ Property Code 2690	⁵ Property Name W.T. McComack	⁶ Well Number 23
⁷ OGRID No. 4323	⁸ Operator Name Chevron U.S.A., Inc.	⁹ Elevation 3459' (GL)

¹⁰ Surface Location

UL or Lot No.	Section	Township	Range	Lot Idn	Feet from the	North/South line	Feet from the	East/West line	County
G	32	21S	37E		2300	North	1400	East	Lea

¹¹ Bottom Hole Location If Different From Surface

UL or Lot No.	Section	Township	Range	Lot Idn	Feet from the	North/South line	Feet from the	East/West line	County
¹² Dedicated Acres 40	¹³ Joint or Infill	¹⁴ Consolidation Code	¹⁵ Order No.						

NO ALLOWABLE WILL BE ASSIGNED TO THIS COMPLETION UNTIL ALL INTERESTS HAVE BEEN CONSOLIDATED OR A NON-STANDARD UNIT HAS BEEN APPROVED BY THE DIVISION

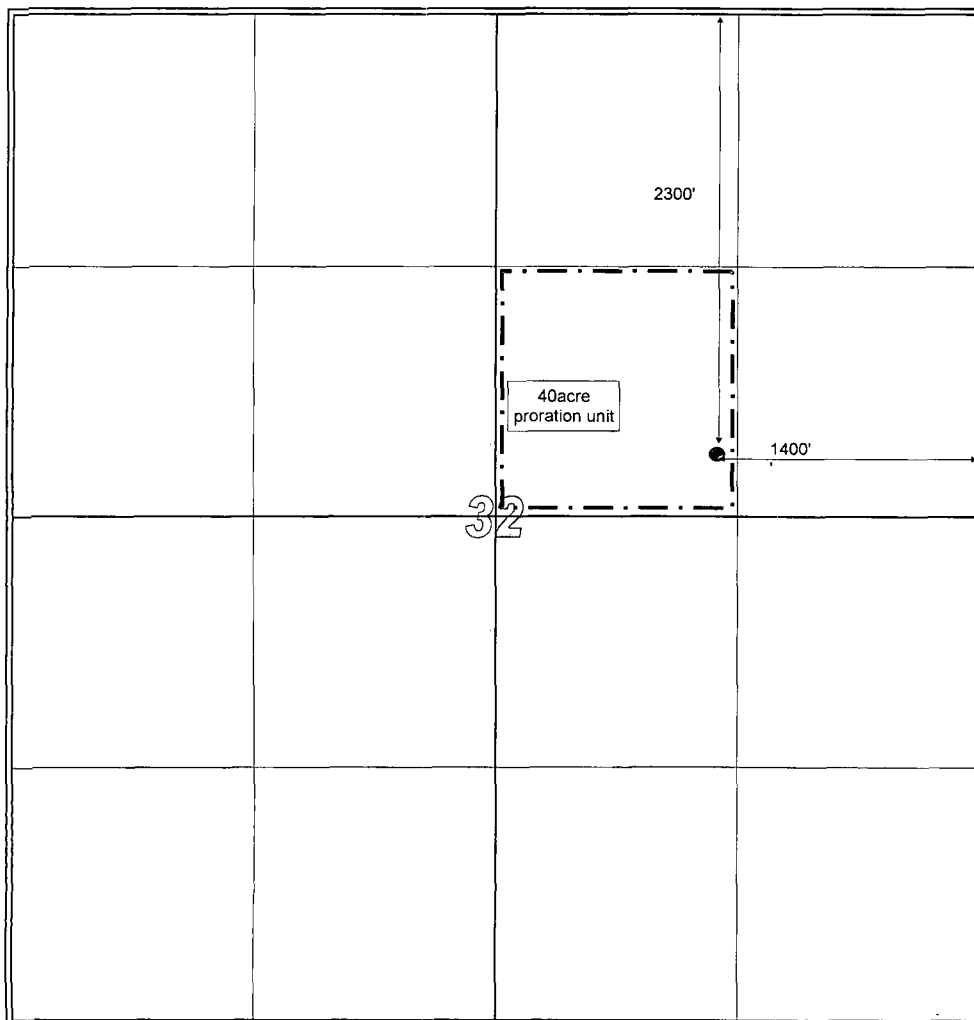
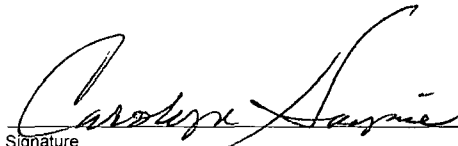
	<p>¹ OPERATOR CERTIFICATION</p> <p>I hereby certify that the information contained herein is true and complete to the best of my knowledge and belief.</p> <p> Signature Carolyn Haynie</p> <p>Printed Name Chevron PE Technical Assistant</p> <p>Date 3/18/2009</p>
	<p>¹ SURVEYOR CERTIFICATION</p> <p>I hereby certify that the well location shown on this plat was plotted from field notes of actual surveys made by me or under my supervision, and that the same is true and correct to the best of my belief.</p> <p>Signature and Seal of Professional Surveyor:</p>
	<p>Certificate Number</p>

District I
1625 N. French Dr., Hobbs, NM 88240

District II
811 South First, Artesia, NM 88210

District III
1000 Rio Brazos Rd., Aztec, NM 87410

District IV
2040 South Pacheco, Santa Fe, NM 87505

State of New Mexico
Energy, Minerals & Natural Resources Department

Form C-102
Revised March 17, 1999

OIL CONSERVATION DIVISION

2040 South Pacheco
Santa Fe, NM 87505

Submit to Appropriate District Office
State Lease - 4 Copies
Fee Lease - 3 Copies

☐ AMENDED REPORT

WELL LOCATION AND ACREAGE DEDICATION PLAT

¹ API Number 30-025-37179	² Pool Code 50350	³ Pool Name Penrose Skelly Grayburg
⁴ Property Code 2690	⁵ Property Name W.T. McComack	⁶ Well Number 23
⁷ OGRID No. 4323	⁸ Operator Name Chevron U.S.A., Inc.	⁹ Elevation 3459' (GL)

¹⁰ Surface Location

UL or Lot No.	Section	Township	Range	Lot Idn	Feet from the	North/South line	Feet from the	East/West line	County
G	32	21S	37E		2300	North	1400	East	Lea

¹¹ Bottom Hole Location If Different From Surface

UL or Lot No.	Section	Township	Range	Lot Idn	Feet from the	North/South line	Feet from the	East/West line	County
¹² Dedicated Acres 40	¹³ Joint or Infill	¹⁴ Consolidation Code	¹⁵ Order No.						

NO ALLOWABLE WILL BE ASSIGNED TO THIS COMPLETION UNTIL ALL INTERESTS HAVE BEEN CONSOLIDATED OR A NON-STANDARD UNIT HAS BEEN APPROVED BY THE DIVISION

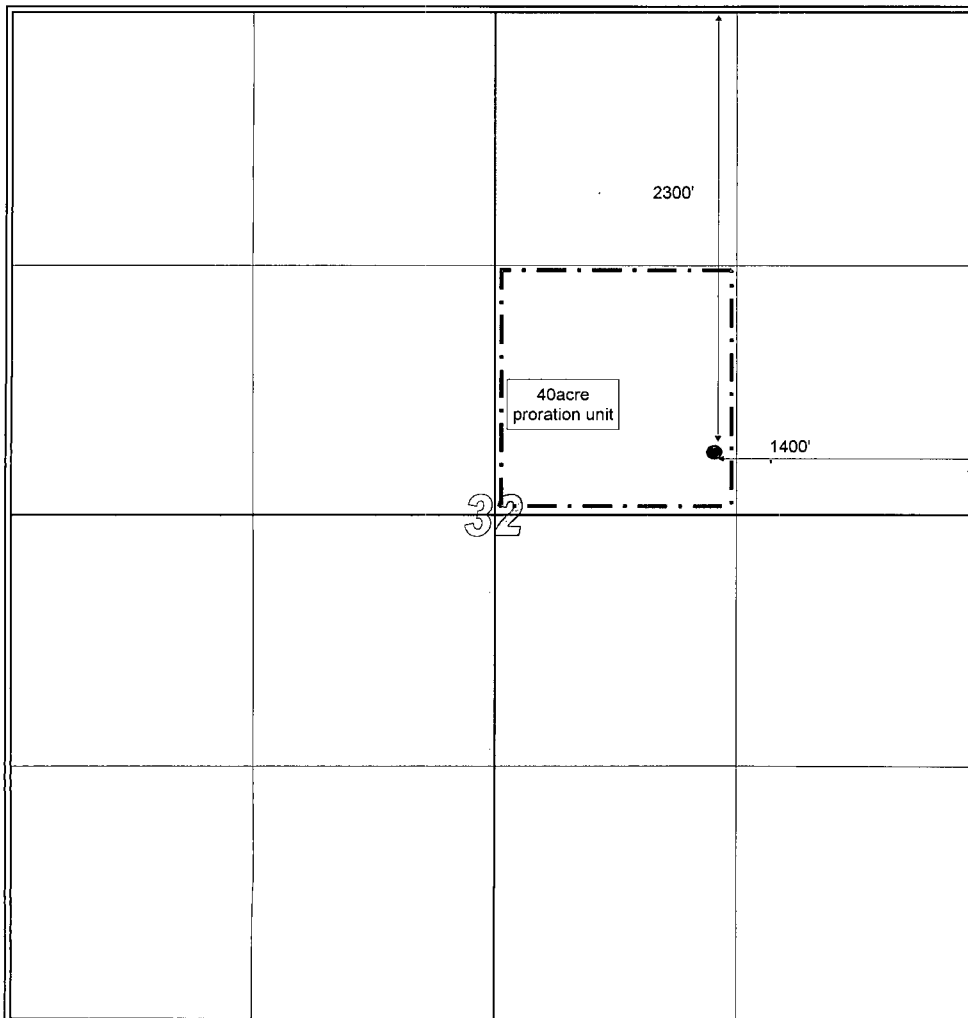
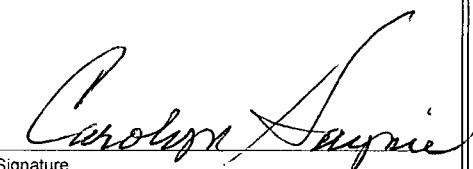
	<p>¹ OPERATOR CERTIFICATION</p> <p>I hereby certify that the information contained herein is true and complete to the best of my knowledge and belief.</p> <p> Signature Carolyn Haynie</p> <p>Printed Name PE Technical Assistant</p> <p>Date 3/18/2009</p>
	<p>¹ SURVEYOR CERTIFICATION</p> <p>I hereby certify that the well location shown on this plat was plotted from field notes of actual surveys made by me or under my supervision, and that the same is true and correct to the best of my belief.</p> <p>Signature and Seal of Professional Surveyor:</p> <p>Certificate Number</p>

Well: **W. T. McComack # 23**Field: **Penrose Skelly**Reservoir: **Grayburg****Location:**

2300' FNL & 1400' FEL
 Section: 32
 Township: 21S
 Range: 37E
 County: Lea State: NM

Elevations:

GL: 3459'
 KB: 3470'
 DF: 3469'

Current
Wellbore Diagram

Well ID Info:

Chevno: HS9876
 API No: 30-025-37179
 L5/L6: UCU491900
 Spud Date: 10/16/2005
 Compl. Date:

Surf. Csg: 8 5/8", 24#, J-55
Set: @ 407' w/ 700 sks
Hole Size: 12 1/4"
Circ: Yes **TOC:** Surface
TOC By: Circulated

This wellbore diagram is based on the most recent information regarding wellbore configuration and equipment that could be found in the Midland Office well files and computer databases as of the update date below. Verify what is in the hole with the well file in the Eunice Field Office. Discuss w/ WEO Engineer, WO Rep, OS, ALS, & FS prior to rigging up on well regarding any hazards or unknown issues pertaining to the well.

Tubing Detail:

#Jts:	Size:	Footage
	KB Correction	11.00
116	Jts. 2 7/8" EUE 8R J-55 Tbg	3596.00
	TAC	3.15
14	Jts. 2 7/8" EUE 8R J-55 Tbg	434.00
1	Jt. 2 7/8" EUE 8R J-55 IPC Tbg	31.00
	SN	1.10
	2 7/8" x 4" Perf Tbg Sub	4.00
1	Jt. 2 7/8" EUE 8R J-55 Tbg	31.00
	Bull Plug	0.50
132	Bottom Of String >>	4111.75

Perfs:

Status:
 3677-82' Open
 3688-93' Open
 3697-3704' Open
 3709-17' Open
 3719-25' Open
 3743-51' Open
 3753-55' Open
 3764-68' Open
 3777-83' Open
 3792-96' Open
 3804-08' Open
 3813-17' Open
 3819-26' Open
 3829-31' Open
 3834-39' Open
 3855-61' Open
 38750-80' Open
 3885-94' Open
 3900-09' Open
 3922-26' Open
 3937-46' Open

CIBP @ 3985'

Perfs:
 3992-3926'

Status:
 Below CIBP - Out of zone

COTD: 4216'
PBTD: 3985'
TD: 4320'

Prod. Csg: 5 1/2", 15.50#, J-55
Set: @ 4310' w/ 1000 sks
Hole Size: 7 7/8"
Circ: Yes **TOC:** Surface
TOC By: Circulated

Updated: 10/29/2008

By: LGEK

Well: **W. T. McComack # 23**Field: **Penrose Skelly**Reservoir: **Grayburg****Location:**

2300' FNL & 1400' FEL
 Section: 32
 Township: 21S
 Range: 37E
 County: Lea State: NM

Elevations:

GL: 3459'
 KB: 3470'
 DF: 3469'

Proposed
Wellbore Diagram

**Well ID Info:**

Chevron: HS9876
 API No: 30-025-37179
 L5/L6: UCU491900
 Spud Date: 10/16/2005
 Compl. Date:

Surf. Csg: 8 5/8", 24#, J-55

Set: @ 407' w/ 700 sks

Hole Size: 12 1/4"

Circ: Yes TOC: Surface

TOC By: Circulated

This wellbore diagram is based on the most recent information regarding wellbore configuration and equipment that could be found in the Midland Office well files and computer databases as of the update date below. Verify what is in the hole with the well file in the Eunice Field Office. Discuss w/ WED Engineer, WED Rep, OS, ALS, & J-S prior to rigging up on well regarding any hazards or unknown issues pertaining to the well.

Tubing Detail:

#Jts:	Size:	Footage
	KB Correction	11.00
116	Jts. 2 7/8" EUE 8R J-55 Tbg	3596.00
	TAC	3.15
14	Jts. 2 7/8" EUE 8R J-55 Tbg	434.00
1	Jt. 2 7/8" EUE 8R J-55 IPC Tbg	31.00
	SN	1.10
	2 7/8" x 4" Perf Tbg Sub	4.00
1	Jt. 2 7/8" EUE 8R J-55 Tbg	31.00
	Bull Plug	0.50
132	Bottom Of String >>	4111.75

Perfs:

Perfs:		Status:
3677-82'	Grayburg	Open
3688-93'	Grayburg	Open
3697-3704'	Grayburg	Open
3709-17'	Grayburg	Open
3719-25'	Grayburg	Open
3743-51'	Grayburg	Open
3753-55'	Grayburg	Open
3764-68'	Grayburg	Open
3777-83'	Grayburg	Open
3792-96'	Grayburg	Open
3804-08'	Grayburg	Open
3813-17'	Grayburg	Open
3819-26'	Grayburg	Open
3829-31'	Grayburg	Open
3834-39'	Grayburg	Open
3855-61'	Grayburg	Open
38750-80'	Grayburg	Open
3885-94'	Grayburg	Open
3900-09'	Grayburg	Open
3922-26'	Grayburg	Open
3937-46'	Grayburg	Open

Perfs:

Perfs:		Status:
3992-3926'	San Andres	Open
4002-06'	San Andres	Proposed
4016-26'	San Andres	Proposed
4038-48'	San Andres	Proposed
4070-80'	San Andres	Proposed
4095-00'	San Andres	Proposed
4114-22'	San Andres	Proposed
4155-61'	San Andres	Proposed
4164-70'	San Andres	Proposed
4188-94'	San Andres	Proposed

COTD: 4216'
 PBTD: 4216'
 TD: 4320'

Updated: 1/29/2009

By: LGEK

Prod. Csg: 5 1/2", 15.50#, J-55

Set: @ 4310' w/ 1000 sks

Hole Size: 7 7/8"

Circ: Yes TOC: Surface

TOC By: Circulated

Selected Well: WTMCCOMACK23G

Date	Oil rate	Water rate	Gas rate
11/28/2008	1	9	148
10/5/2008	15	50	128
9/25/2008	16	49	144
9/6/2008	4	32	153
8/10/2008	4	41	213
7/28/2008	3	33	215
5/8/2008	4	38	232
4/9/2008	6	40	210
3/17/2008	10	80	240
2/25/2008	11	83	245
1/21/2008	4	50	190
11/16/2007	6	50	222
10/22/2007	8	55	368
9/23/2007	9.39	77.22	454
9/8/2007	5	30	388
8/8/2007	10.15	76.62	365.54
7/8/2007	13	85	400
6/29/2007	8	57	336
5/9/2007	8	74	315
4/15/2007	10	62	260
3/14/2007	12.86	77.14	270
1/21/2007	1	15	200
12/10/2006	0	9	454
10/23/2006	14	70	395
9/5/2006	15	77	495
9/3/2006	15	82	490
9/2/2006	13	77	496
7/25/2006	16	85	480
6/13/2006	25.04	160.7	502.96
5/28/2006	16	125	505
4/22/2006	14.18	57.82	386.18
3/18/2006	22.86	97.14	470
2/23/2006	31	133	430
12/4/2005	55	208	390
12/3/2005	52	261	401
12/2/2005	42.55	133.09	383
12/1/2005	49	129	285
11/29/2005	42	171	289

11/28/2005	53	205	299
11/27/2005	36	201	283
11/26/2005	38	218	270
11/25/2005	38	218	222

[Back](#)

Submit 3 Copies To Appropriate District
Office
District I
1625 N. French Dr., Hobbs, NM 88240
District II
1301 W. Grand Ave., Artesia, NM 88210
District III
1000 Rio Brazos Rd., Aztec, NM 87410
District IV
1220 S. St. Francis Dr., Santa Fe, NM
87505

State of New Mexico
Energy, Minerals and Natural Resources

Form C-103
May 27, 2004

OIL CONSERVATION DIVISION
1220 South St. Francis Dr.
Santa Fe, NM 87505

WELL API NO.

30-025-37179

5. Indicate Type of Lease

STATE ☐ FEE ☒

6. State Oil & Gas Lease No.

7. Lease Name or Unit Agreement Name

W.T. McComack

8. Well Number **23**

9. OGRID Number

4323

10. Pool name or Wildcat

Grayburg/San Andres

SUNDRY NOTICES AND REPORTS ON WELLS

(DO NOT USE THIS FORM FOR PROPOSALS TO DRILL OR TO DEEPEN OR PLUG BACK TO A DIFFERENT RESERVOIR. USE "APPLICATION FOR PERMIT" (FORM C-101) FOR SUCH PROPOSALS.)

1. Type of Well: ☒ Oil Well ☐ Gas Well ☐ Other

2. Name of Operator

Chevron U.S.A. Inc.

3. Address of Operator

15 Smith Road Midland, TX 79705

4. Well Location

Unit Letter **G** : **2300** feet from the **North** line and **1400** feet from the **East** line

Section **32** Township **21S** Range **37E** NMPM County **LEA**

11. Elevation (Show whether DR, RKB, RT, GR, etc.)

3459' (GL)

Pit or Below-grade Tank Application ☐ or Closure ☐

Pit type _____ Depth to Groundwater _____ Distance from nearest fresh water well _____ Distance from nearest surface water _____

Pit Liner Thickness: _____ mil Below-Grade Tank: Volume _____ bbls; Construction Material _____

12. Check Appropriate Box to Indicate Nature of Notice, Report or Other Data

NOTICE OF INTENTION TO:

PERFORM REMEDIAL WORK ☐ PLUG AND ABANDON ☐

TEMPORARILY ABANDON ☐ CHANGE PLANS ☐

PULL OR ALTER CASING ☐ MULTIPLE COMPL ☐

OTHER: **DHC Grayburg/San Andres** ☒

SUBSEQUENT REPORT OF:

REMEDIAL WORK ☐ ALTERING CASING ☐

COMMENCE DRILLING OPNS. ☐ P AND A ☐

CASING/CEMENT JOB ☐

OTHER: ☐

13. Describe proposed or completed operations. (Clearly state all pertinent details, and give pertinent dates, including estimated date of starting any proposed work). SEE RULE 1103. For Multiple Completions: Attach wellbore diagram of proposed completion or recompletion.

ESTIMATED STARTING DATE OF THE PROPOSED WORK IS APRIL 30, 2009, AND THE APPROXIMATE DURATION OF THE WORKOVER PROJECT WILL BE 2 WEEKS. IT IS PROPOSED TO DOWNHOLE COMMINGLE PREAPPROVED POOLS, PENROSE SKELLY GRAYBURG (POOL-50350) EXISTING PERFS, 3946'-3677' AND THE EUNICE SAN ANDRES, (POOL-24150) PERFS TO BE ADDED DURING WORKOVER: (4194'-3926').

DRILL OUT THE CIBP @ 3985' TO PBD, 4216', ADD PERFS IN THE SAN ANDRES AS FOLLOWS: 4188' - 4194'; 4164' - 4170'; 4155' - 4161'; 4125' - 4135'; 4114' - 4122'; 4095' - 4100'; 4070' - 4080'; 4038' - 4048'; 4016' - 4026'; 4002' - 4006'; 75' TOTAL HOLES, 300'. ACIDIZE W/7750 GALS 15% NEFE HCL @ 3500 PSI. RIH W/2-7/8" TBG AND TURN WELL OVER TO PRODUCTION. PRODUCTION WILL BE ALLOCATED BACK TO THE TWO POOLS BASED ON THE PERCENTAGES SHOWN IN THE ATTACHED SUPPORT DATA.

I hereby certify that the information above is true and complete to the best of my knowledge and belief. I further certify that any pit or below-grade tank has been/will be constructed or closed according to NMOCD guidelines ☐, a general permit ☐ or an (attached) alternative OCD-approved plan ☐.

SIGNATURE Carolyn Haynie TITLE PE TECHNICAL ASSISTANT DATE 3/18/2009

Type or print name Carolyn Haynie E-mail address: chay@chevron.com Telephone No. 432-687-7261

For State Use Only

APPROVED BY: _____ TITLE _____ DATE _____

Conditions of Approval (if any): _____

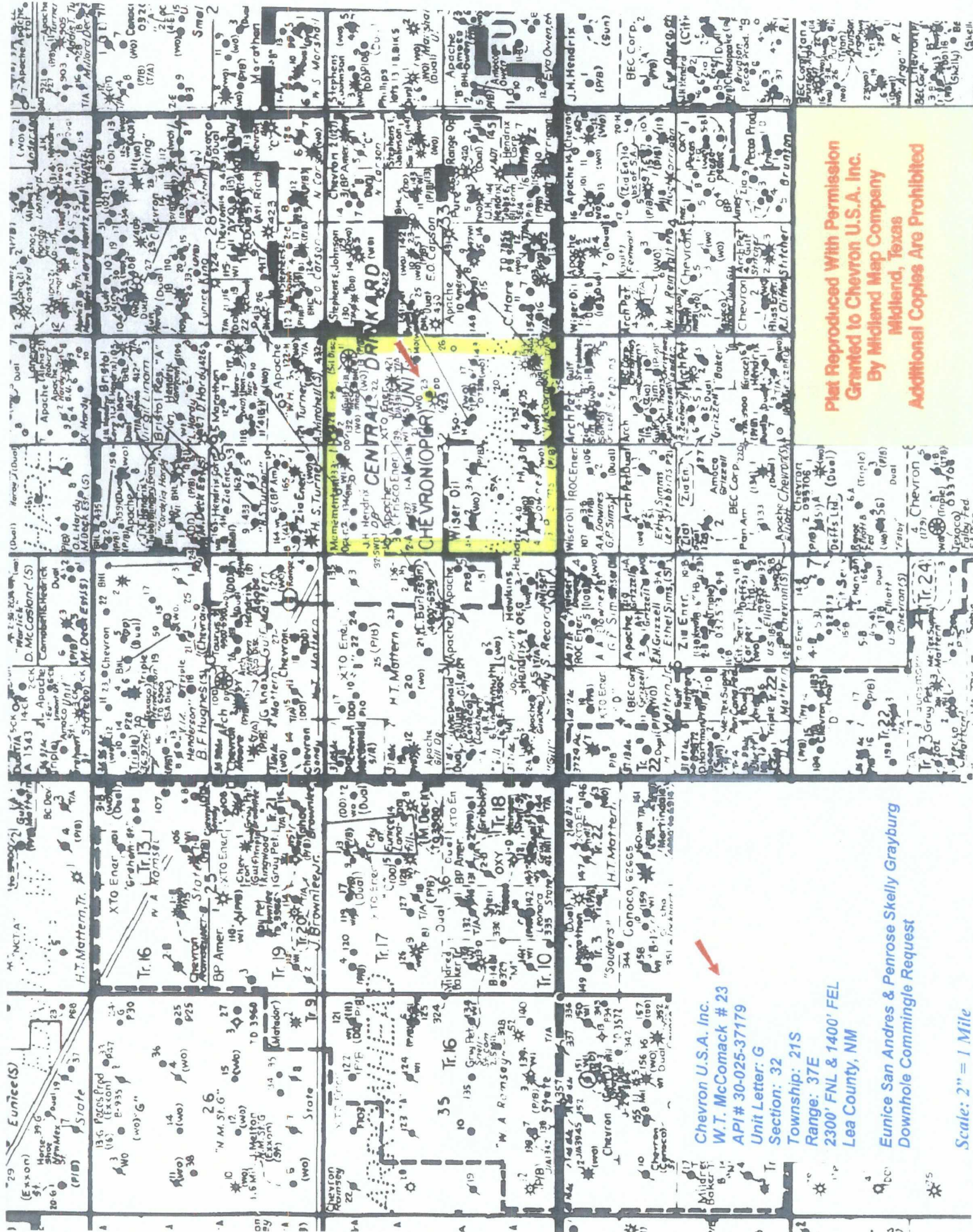

Chevron U.S.A. Inc.

W.T. McComack # 23

API # 30-025-37179

Unit Letter: G

Section: 32

Township: 21S

Range: 37E

2300' FNL & 1400' FEL

Lea County, NM

Eunice San Andres & Penrose Skelly Grayburg

Downhole Commingle Request

Scale: 2" = 1 Mile