

NSL 8/11/97

**devon**

**ENERGY CORPORATION**

20 North Broadway, Suite 1500  
Oklahoma City, Oklahoma 73102-8260

Telephone 405/235-3611  
FAX 405/552-4550

July 15, 1997

Certified Mail No. Z 447 031 474

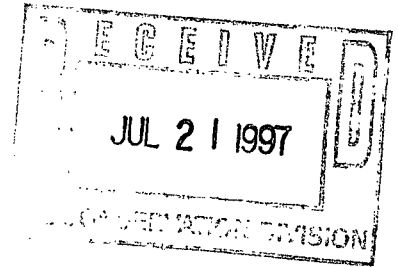

State of New Mexico  
Energy, Minerals and Natural Resources Department  
Oil Conservation Division  
2040 South Pacheco  
Santa Fe, New Mexico 87505

RE: Non-Standard Location Approval  
Eagle "34D" Federal #8  
Eddy County, New Mexico

Gentlemen:

Devon Energy Corporation (Nevada) requests "Non-Standard Location" approval for the referenced well located as listed below. This unorthodox location is necessary due to pipeline and topography problems.

<u>Well Name &amp; No.</u>	<u>Unit Ltr</u>	<u>Section-T-R</u>	<u>Footage Location</u>
Eagle "34D" Federal #8	D	34-17S-27E	990' FNL & 1065' FWL

Enclosed is a map of the West Red Lake Area showing the well's location and a copy of form C-102.

Operators having wells and/or lease holdings in the offsetting 40 acre tracts will be notified by certified mail. Copies of our letters of notification to the following operators are enclosed.

Altura Energy, Ltd.

Houston, Texas

Eagle "34D" Federal #8  
NSL Approval  
7/15/97  
Page Two

State of New Mexico  
Energy, Minerals and Natural Resources Dept.  
Oil Conservation Division

If you have any questions, please contact the undersigned at (405) 235-3611, X4509.

Sincerely yours,

DEVON ENERGY CORPORATION (NEVADA)

*E. L. Buttross Jr.*

Mr. E.L. Buttross, Jr.  
District Engineer

ELB\dk  
Enclosures

cc: Oil Conservation Division - Artesia, NM  
Bureau of Land Management - Carlsbad, NM

T  
18  
S

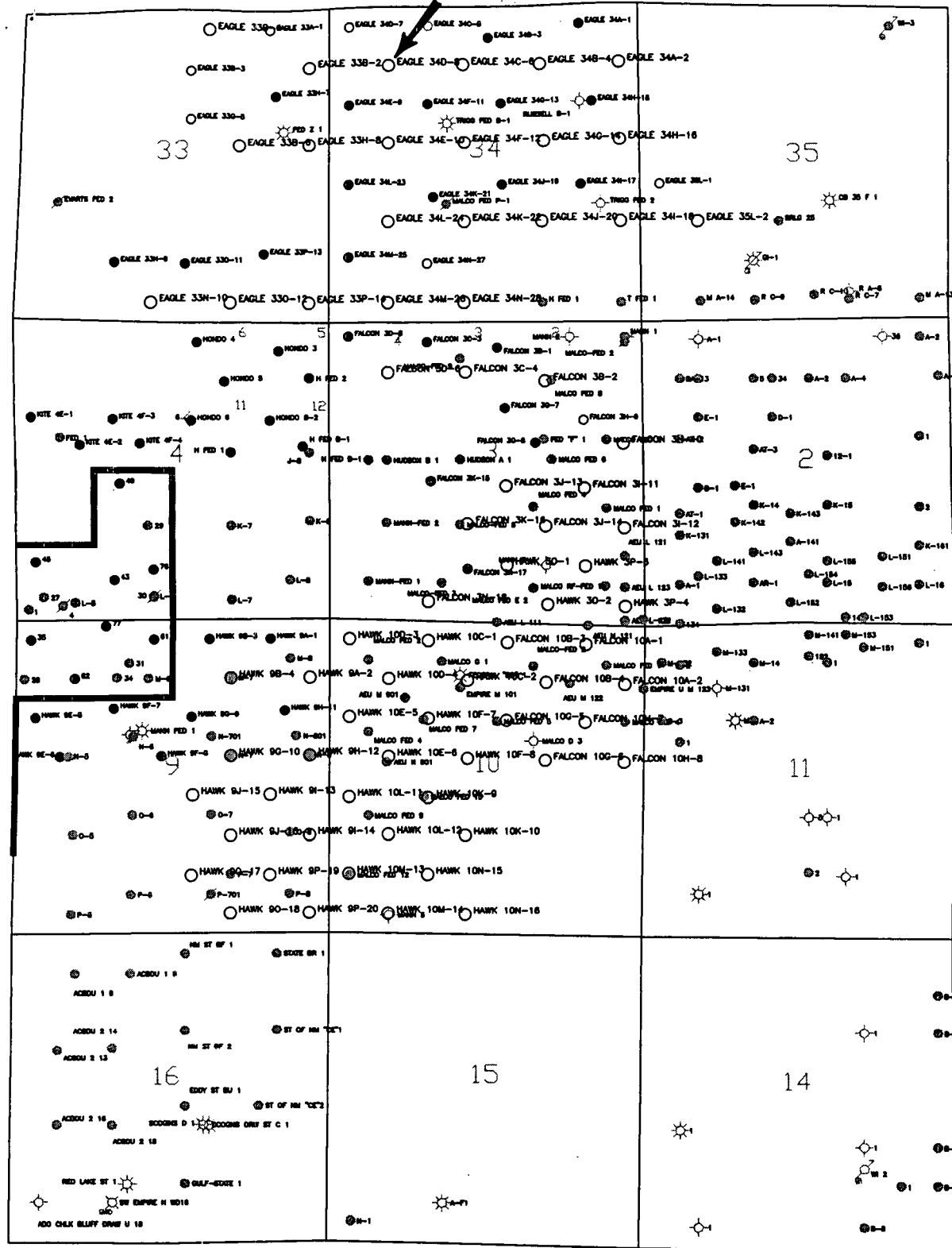

devon

**WEST RED LAKE UNIT**  
EDDY COUNTY, NEW MEXICO

Eagle "34D" #8

Scale in Feet

**NO 511**

DISTRICT I  
P.O. Box 1980, Hobbs, NM 88240

State of New Mexico  
Energy, Minerals and Natural Resources Department

Exhibit 2  
Form C-102  
Revised February 10, 1994  
Instruction on back  
Submit to Appropriate District Office  
State Lease - 4 Copies  
Fee Lease - 3 Copies

DISTRICT II  
P.O. Drawer DD, Artesia, NM 88210

OIL CONSERVATION DIVISION

DISTRICT III  
1000 Rio Brazos Rd., Aztec, NM 87410

P.O. Box 2088  
Santa Fe, New Mexico 87504-2088

☐ AMENDED REPORT

WELL LOCATION AND ACREAGE DEDICATION PLAT

API Number	Pool Code	Pool Name Red Lake (Q-GB-SA)
Property Code	Property Name Eagle 34 D Federal	Well Number 8
OGRID No.	Operator Name Devon Energy Corporation	Elevation 3531'

Surface Location

UL or lot No. D	Section 34	Township 17 S	Range 27 E	Lot Idn	Feet from the 990	North/South line North	Feet from the 1065	East/West line West	County Eddy
--------------------	---------------	------------------	---------------	---------	----------------------	---------------------------	-----------------------	------------------------	----------------

Bottom Hole Location If Different From Surface

UL or lot No.	Section	Township	Range	Lot Idn	Feet from the	North/South line	Feet from the	East/West line	County
Dedicated Acres	Joint or Infill	Consolidation Code	Order No.						

NO ALLOWABLE WILL BE ASSIGNED TO THIS COMPLETION UNTIL ALL INTERESTS HAVE BEEN CONSOLIDATED  
OR A NON-STANDARD UNIT HAS BEEN APPROVED BY THE DIVISION

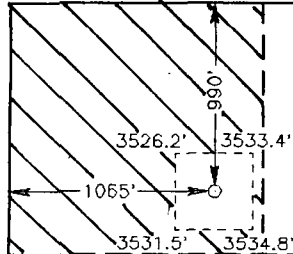
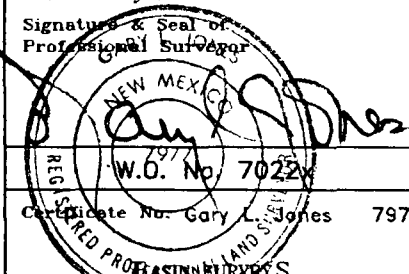
				<b>OPERATOR CERTIFICATION</b>  I hereby certify the the information contained herein is true and complete to the best of my knowledge and belief.  <u>E. L. Buttross Jr.</u> Signature  E. L. Buttross, Jr. Printed Name  District Engineer Title  April 29, 1997 Date		
				<b>SURVEYOR CERTIFICATION</b>  I hereby certify that the well location shown on this plat was plotted from field notes of actual surveys made by me or under my supervision and that the same is true and correct to the best of my belief.  April 16, 1997 Date Surveyed  Signature & Seal of Professional Surveyor  W.D. No. 70224 Certificate No. Gary L. Jones 7977		

**devon**  
**ENERGY CORPORATION**

20 North Broadway, Suite 1500  
Oklahoma City, Oklahoma 73102-8260

Telephone 405/235-3611  
FAX 405/552-4550

July 15, 1997

**Certified Mail No. Z 447 031 475**

Altura Energy, Ltd.  
P.O. Box 4294  
Houston, TX 77210-4294

RE: Non-Standard Location Approval  
Proposed 2800' San Andres Test  
Eagle "34D" Federal #8  
990' FNL & 1065' FWL  
Section D-34-T17S-R27E  
Eddy County, New Mexico

Gentlemen:

We have applied for a permit to drill the referenced well. This unorthodox location was due to pipeline and topography problems. The proposed well site is in the West Red Lake area in Eddy County, New Mexico, and offsets your lease hold in Section 27-T17S-R27E.

The NMOCD Non-Standard Location Approval process requires that we notify offset lease holders and submit Proof of Notice.

Eagle "34D" Federal #8  
Non-Standard Location Approval  
July 15, 1997  
Page Two

Altura Energy, Ltd.

Please accept this certified letter as notification. If you have any questions, please contact Ernie Buttross, Jr., at (405) 235-3611, X4509.

Sincerely yours,

DEVON ENERGY CORPORATION (NEVADA)

A handwritten signature in cursive script, reading "Diana Keys".

Diana Keys  
Engineering Tech.

/dk

cc: Oil Conservation Division - Santa Fe, NM  
Oil Conservation Division - Artesia, NM  
Bureau of Land Management - Carlsbad, NM

UNITED STATES  
DEPARTMENT OF THE INTERIOR  
BUREAU OF LAND MANAGEMENT

N.M. Oil Cons. Division  
311-1st  
3210-2834

FORM APPROVED  
Budget Bureau No. 1004-0135  
Expires March 31, 1993

SUNDRY NOTICES AND REPORTS ON WELLS

Do not use this form for proposals to drill or to deepen or reentry to a different reservoir.  
Use "APPLICATION FOR PERMIT—" for such proposals

SUBMIT IN TRIPLICATE

1. Type of Well

☒ Oil Well ☐ Gas Well ☐ Other

2. Name of Operator

DEVON ENERGY CORPORATION (NEVADA)

3. Address and Telephone No.

20 NORTH BROADWAY, SUITE 1500, OKLAHOMA CITY, OKLAHOMA 73102 (405) 235-3611

4. Location of Well (Footage, Sec., T., R., M., or Survey Description)

990' FNL & 1065' FWL of Section D34-T17S-R27E, Unit "D"

5. Lease Designation and Serial No.

LC-067849

6. If Indian, Allottee or Tribe Name

NA

7. If Unit or CA, Agreement Designation

NA

8. Well Name and No.

Eagle "34"D Federal #8

9. API Well No.

30-015

10. Field and Pool, or Exploratory Area

Red Lake (Q-GB-SA)

11. County or Parish, State

Eddy County, NM

CHECK APPROPRIATE BOX(s) TO INDICATE NATURE OF NOTICE, REPORT, OR OTHER DATA

TYPE OF SUBMISSION

- ☐ Notice of Intent  
☒ Subsequent Report  
☐ Final Abandonment Notice

TYPE OF ACTION

- ☐ Abandonment  
☐ Recompletion  
☐ Plugging Back  
☐ Casing Repair  
☐ Altering Casing  
☒ Other APD Extension

- ☐ Change of Plans  
☐ New Construction  
☐ Non-Routine Fracturing  
☐ Water Shut-Off  
☐ Conversion to Injection  
☐ Dispose Water

(Note: Report results of multiple completion on Well Completion or Recompletion Report and Log form.)

13. Describe Proposed or Completed Operations (Clearly state all pertinent details, and give pertinent dates, including estimated date of starting any proposed work. If well is directionally drilled, give subsurface locations and measured and true vertical depths for all markers and zones pertinent to this work.)\*

The Application for Permit to Drill this well was approved June 2, 1997.

At this time Devon Energy Corporation (Nevada) requests an extension of one year to drill this well.

APPROVED FOR 12 MONTH PERIOD  
ENDING JUN 02 1999

14. I hereby certify that the foregoing is true and correct

Signed Marie Ozment

Marie Ozment

Title Engineering Technician

Date February 23, 1998

(This space for Federal or State office use)

(ORIG. SCD) DAVID R. CLARK

Title PETROLEUM ENGINEER

Date MAR 09 1998

Approved by  
Conditions of approval, if any:

UNITED STATES  
DEPARTMENT OF THE INTERIOR  
BUREAU OF LAND MANAGEMENT

N.M. Oil Cons. Division

Oil C. 1st

210 2834

FORM APPROVED

Budget Bureau No. 1004-0135  
Expires March 31, 1993

**SUNDRY NOTICES AND REPORTS ON WELLS**

Do not use this form for proposals to drill or to deepen or reentry to a different reservoir.  
Use "APPLICATION FOR PERMIT—" for such proposals

**SUBMIT IN TRIPLICATE**

1. Type of Well

☒ Oil Well ☐ Gas Well ☐ Other

2. Name of Operator

DEVON ENERGY CORPORATION (NEVADA)

3. Address and Telephone No.

20 NORTH BROADWAY, SUITE 1500, OKLAHOMA CITY, OKLAHOMA 73102 (405) 235-3611

4. Location of Well (Footage, Sec., T., R., M., or Survey Description)

990' FNL & 1065' FWL of Section 34-T17S-R27E, Unit "D"

5. Lease Designation and Serial No.

LC-067849

6. If Indian, Allottee or Tribe Name

NA

7. If Unit or CA, Agreement Designation

NA

8. Well Name and No.

Eagle "34D" Federal #8

9. API Well No.

30-015-

10. Field and Pool, or Exploratory Area

Red Lake (Q-GB-SA)

11. County or Parish, State

Eddy County, NM

**CHECK APPROPRIATE BOX(S) TO INDICATE NATURE OF NOTICE, REPORT, OR OTHER DATA**

TYPE OF SUBMISSION

- ☒ Notice of Intent  
☐ Subsequent Report  
☐ Final Abandonment Notice

TYPE OF ACTION

- ☐ Abandonment  
☐ Recompletion  
☐ Plugging Back  
☐ Casing Repair  
☐ Altering Casing  
☐ Other \_\_\_\_\_

- ☒ Change of Plans  
☐ New Construction  
☐ Non-Routine Fracturing  
☐ Water Shut-Off  
☐ Conversion to Injection  
☐ Dispose Water

(Note: Report results of multiple completion on Well Completion or Recompletion Report and Log form.)

13. Describe Proposed or Completed Operations (Clearly state all pertinent details, and give pertinent dates, including estimated date of starting any proposed work. If well is directionally drilled, give subsurface locations and measured and true vertical depths for all markers and zones pertinent to this work.)\*

Please amend the APD to show that the BOP will be tested to 1000 psi with the rig pump. The maximum bottom hole pressure is anticipated to be only 800 psi.

ACCEPTED FOR RECORD

DEC 31 1997

(COPIG. SGD.) GARY GOURLEY

14. I hereby certify that the foregoing is true and correct

Signed E. L. Buttross, Jr.

E.L. Buttross, Jr.

Title District Engineer

Date December 17, 1997

(This space for Federal or State office use)

Approved by \_\_\_\_\_

Title \_\_\_\_\_

Date \_\_\_\_\_

Conditions of approval, if any:

Title 18 U.S.C. Section 1001, makes it a crime for any person knowingly and willfully to make to any department or agency of the United States any false, fictitious or fraudulent statements or representations to any matter within its jurisdiction.

**\*See Instruction on Reverse Side**



UNITED STATES  
DEPARTMENT OF THE INTERIOR  
BUREAU OF LAND MANAGEMENT  
N.M. Oil Cons. Division  
811 S. 1ST ST.  
ARTESIA, NM 88210-2834

Form approved.

APPLICATION FOR PERMIT TO DRILL OR DEEPEN

1a. TYPE OF WORK: DRILL ☒ DEEPEN ☐

b. TYPE OF WELL:

OIL WELL ☒ GAS WELL ☐ Other ☐ SINGLE ZONE ☐ MULTIPLE ZONE ☐

2. NAME OF OPERATOR

DEVON ENERGY CORPORATION (NEVADA)

3. ADDRESS AND TELEPHONE NO.

20 N. BROADWAY, SUITE 1500, OKC, OK 73102 (405) 235-3611

4. LOCATION OF WELL (Report location clearly and in accordance with any State requirements)\*

At surface 990' FNL & 1065' FWL

At top proposed prod. zone (SAME)

14. DISTANCE IN MILES AND DIRECTION FROM NEAREST TOWN OR POST OFFICE\*

Approximately 5 miles southeast of Artesia, NM

15. DISTANCE FROM PROPOSED LOCATION TO NEAREST

PROPERTY OR LEASE LINE, FT. 990

(Also to nearest drive unit line if any)

18. DISTANCE FROM PROPOSED LOCATION\*

TO NEAREST WELL, DRILLING, COMPLETED, OR APPLIED FOR, ON THIS LEASE, FT. 900

21. ELEVATIONS (Show whether DF, RT, GR, etc.)

GL 3531'

16. NO. OF ACRES IN LEASE

800

19. PROPOSED DEPTH

2800'

5. LEASE DESIGNATION AND SERIAL NO.

LC-067849

6. IF INDIAN, ALLOTTEE OR TRIBE NAME

NA

7. UNIT AGREEMENT NAME

NA

8. FARM OR LEASE NAME, WELL NO.

Eagle "34D" Federal #8

9. API WELL NO.  
30-015-

10. FIELD AND POOL, OR WILDCAT

Red Lake (Q-GB-SA)

11. SEC., T., R., M., OR BLOCK AND SURVEY OR AREA  
Section D-34-17S-27E

12. COUNTY OR PARISH

Eddy County

13. STATE

NM

17. NO. OF ACRES ASSIGNED TO THIS WELL

40

20. ROTARY OR CABLE TOOLS\*

Rotary

22. APPROX. DATE WORK WILL START\*  
July 1, 1997

23.

PROPOSED CASING AND CEMENT PROGRAM

SIZE OF HOLE	GRADE, SIZE OF CASING	WEIGHT PER FOOT	SETTING DEPTH	QUANTITY OF CEMENT
17 1/2"	14"	Conductor	40'	Redimix
12 1/4"	8 5/8", J-55	24 ppf	1050'	150 sx Lite + 300 sx Class C
7 7/8"	5 1/2", J-55	15.5 ppf	2800'	150 sx Lite + 350 sx Class C

\* Cement will be circulated to surface on all casing strings.

Devon Energy plans to drill to 2800'+/- to test the San Andres Formation for commercial quantities of oil. If the San Andres is deemed non-commercial, the wellbore will be plugged and abandoned per Federal regulations. Programs to adhere to onshore oil and gas regulations are outlined in the following exhibits and attachments.

Drilling Program concerning

Surface Use and Operating Plan

Exhibit #1 - Blowout Prevention Equipment

Exhibit #1-A - Choke Manifold

Exhibit #2 - Location and Elevation Plat

Exhibit #3 - Planned Access Roads

Exhibit #4 - Wells Within a One Mile Radius

Exhibit #5 - Production Facilities Plan

Exhibit #6 - Rotary Rig Layout

Exhibit #7 - Casing Design Parameters and Factors

H<sub>2</sub>S Operating Plan

The undersigned accepts all applicable terms, conditions, stipulation, and restrictions

operations conducted on the leased land or portion thereof, as described above.

Bond Coverage: Nationwide

BLM Bond File No.: CO-1104

APPROVAL SUBJECT TO  
GENERAL REQUIREMENTS AND  
SPECIAL STIPULATIONS  
ATTACHED

SUBJECT TO  
LIKE APPROVAL  
BY STATE FOR  
UNOR THODOX  
LOCATION

IN ABOVE SPACE DESCRIBE PROPOSED PROGRAM: If proposal is to deepen, give data on present productive zone and proposed new productive zone. If proposal is to drill or deepen directionally, give pertinent data on subsurface locations and measured and true vertical depths. Give blowout preventer program, if any.

24.

SIGNED

E. L. Buttross, Jr.

TITLE

E. L. BUTTROSS, JR.  
DISTRICT ENGINEER

DATE

4/29/97

\*(This space for Federal or State office use)

PERMIT NO.

APPROVAL DATE

Application approval does not warrant or certify that the applicant holds legal or equitable title to those rights in the subject lease which would entitle the applicant to conduct operations thereon.

CONDITIONS OF APPROVAL, IF ANY:

APPROVED BY

(ORIG. SGD.) JAMES G. PETTENGILL

TITLE

Acting ADM. MINERALS

DATE

6-2-97

See Instructions On Reverse Side

DISTRICT I  
P.O. Box 1980, Hobbs, NM 88240

State of New Mexico

Energy, Minerals and Natural Resources Department

Exhibit 2

Form C-102

Revised February 10, 1994

Instruction on back

Submit to Appropriate District Office

State Lease - 4 Copies

Fee Lease - 3 Copies

DISTRICT II  
P.O. Drawer DD, Artesia, NM 88210

OIL CONSERVATION DIVISION

P.O. Box 2088

Santa Fe, New Mexico 87504-2088

DISTRICT III  
1000 Rio Brazos Rd., Aztec, NM 87410

☐ AMENDED REPORT

WELL LOCATION AND ACREAGE DEDICATION PLAT

API Number	Pool Code	Pool Name Red Lake (Q-GB-SA)
Property Code	Property Name Eagle 34 D Federal	Well Number B
OGRID No.	Operator Name Devon Energy Corporation	Elevation 3531'

Surface Location

UL or lot No. D	Section 34	Township 17 S	Range 27 E	Lot Idn	Feet from the 990	North/South line North	Feet from the 1065	East/West line West	County Eddy
--------------------	---------------	------------------	---------------	---------	----------------------	---------------------------	-----------------------	------------------------	----------------

Bottom Hole Location If Different From Surface

UL or lot No.	Section	Township	Range	Lot Idn	Feet from the	North/South line	Feet from the	East/West line	County
Dedicated Acres					Joint or Infill	Consolidation Code	Order No.		

NO ALLOWABLE WILL BE ASSIGNED TO THIS COMPLETION UNTIL ALL INTERESTS HAVE BEEN CONSOLIDATED  
OR A NON-STANDARD UNIT HAS BEEN APPROVED BY THE DIVISION

	<p>OPERATOR CERTIFICATION</p> <p>I hereby certify the the information contained herein is true and complete to the best of my knowledge and belief.</p> <p><u>E. L. Buttross Jr.</u> Signature</p> <p>E. L. Buttross, Jr. Printed Name</p> <p>District Engineer Title</p> <p>April 29, 1997 Date</p>
	<p>SURVEYOR CERTIFICATION</p> <p>I hereby certify that the well location shown on this plat was plotted from field notes of actual surveys made by me or under my supervision and that the same is true and correct to the best of my belief.</p> <p>April 16, 1997 Date Surveyed</p> <p><u>[Signature]</u> Signature &amp; Seal of Professional Surveyor</p> <p>NEW MEXICO W.O. No 7022x Certificate No. Gary L. Jones 7977</p>

# MINIMUM BLOWOUT PREVENTER REQ

3,000 psi Working Pressure

3 MWP

EXHIBIT 1

## STACK REQUIREMENTS

No	Item	Min I.D.	Min. Nominal
1	Flowline		
2	Fill up line		2"
3	Drilling nipple		
4	Annular preventer		
5	Two single or one dual hydraulically operated rams		
6a	Drilling spool with 2" min. kill line and 3" min choke line outlets		
6b	2" min. kill line and 3" min. choke line outlets in ram. (Alternate to 6a above.)		
7	Valve <input type="checkbox"/> Gate <input type="checkbox"/> Plug <input type="checkbox"/>	3-1/8"	
8	Gate valve—power operated	3-1/8"	
9	Line to choke manifold		3"
10	Valves <input type="checkbox"/> Gate <input type="checkbox"/> Plug <input type="checkbox"/>	2-1/16"	
11	Check valve	2-1/16"	
12	Casing head		
13	Valve <input type="checkbox"/> Gate <input type="checkbox"/> Plug <input type="checkbox"/>	1-13/16"	
14	Pressure gauge with needle valve		
15	Kill line to rig mud pump manifold		2"

## OPTIONAL

16	Flanged valve	1-13/16"	
----	---------------	----------	--

CONFIGURATION A

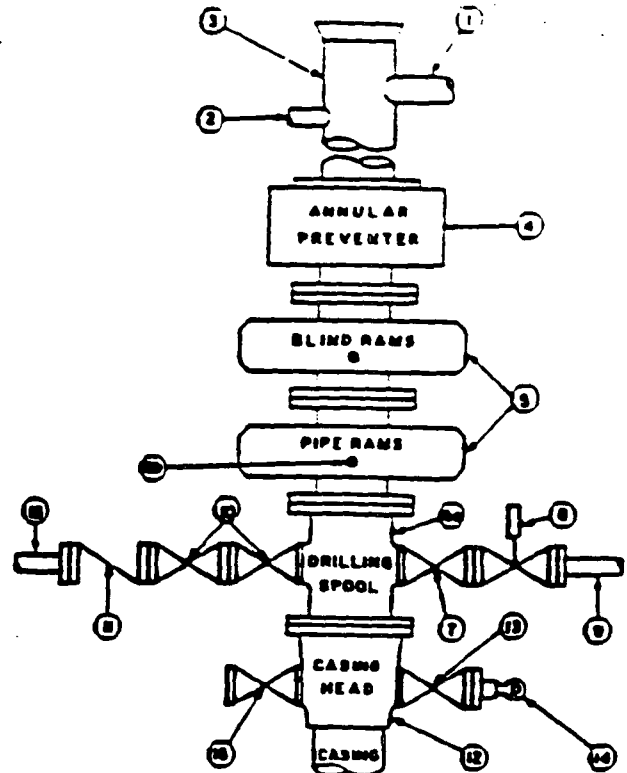

## CONTRACTOR'S OPTION TO FURNISH:

1. All equipment and connections above bradenhead or casinghead. Working pressure of preventers to be 3,000 psi, minimum.
2. Automatic accumulator (80 gallon, minimum) capable of closing BOP in 30 seconds or less and, holding them closed against full rated working pressure.
3. BOP controls, to be located near drillers position.
4. Kelly equipped with Kelly cock.
5. Inside blowout preventer or its equivalent on derrick floor at all times with proper threads to fit pipe being used.
6. Kelly saver-sub equipped with rubber casing protector at all times.
7. Plug type blowout preventer tester.
8. Extra set pipe rams to fit drill pipe in use on location at all times.
9. Type RX ring gaskets in place of Type R.

## MEC TO FURNISH:

1. Bradenhead or casinghead and side valves.
2. Wear bushing, if required.

## GENERAL NOTES:

1. Deviations from this drawing may be made only with the express permission of MEC's Drilling Manager.
2. All connections, valves, fittings, piping, etc., subject to well or pump pressure must be flanged (suitable clamp connections acceptable) and have minimum working pressure equal to rated working pressure of preventers up through choke. Valves must be full opening and suitable for high pressure mud service.
3. Controls to be of standard design and each marked, showing opening and closing position.
4. Chokes will be positioned so as not to hamper or delay changing of choke beans. Replaceable parts for adjustable chokes, other bean sizes, retainers, and choke wrenches to be conveniently located for immediate use.
5. All valves to be equipped with handwheels or handles ready for immediate use.
6. Choke lines must be suitably anchored.

7. Handwheels and extensions to be connected and ready for use.
8. Valves adjacent to drilling spool to be kept open. Use outside valves except for emergency.
9. All seamless steel control piping (3000 psi working pressure) to have flexible joints to avoid stress. Hoses will be permitted.
10. Casinghead connections shall not be used except in case of emergency.
11. Do not use kill line for routine fill-up operations.

Attachment to Exhibit #1  
NOTES REGARDING BLOWOUT PREVENTORS  
Devon Energy Corporation (Nevada)  
Eagle "34D" Federal #8  
990' FNL & 1065' FWL  
Section D-34-T17S-R27E  
Eddy County, New Mexico

1. Drilling nipple will be constructed so it can be removed mechanically without the aid of a welder. The minimum internal diameter will equal BOP bore.
2. Wear ring will be properly installed in head.
3. Blowout preventor and all associated fittings will be in operable condition to withstand a minimum 3000 psi working pressure.
4. All fittings will be flanged.
5. A full bore safety valve tested to a minimum 3000 psi WP with proper thread connections will be available on the rotary rig floor at all times.
6. All choke lines will be anchored to prevent movement.
7. All BOP equipment will be equal to or larger in bore than the internal diameter of the last casing string.
8. Will maintain a kelly cock attached to the kelly.
9. Hand wheels and wrenches will be properly installed and tested for safe operation.
10. Hydraulic floor control for blowout preventor will be located as near in proximity to driller's controls as possible.
11. All BOP equipment will meet API standards and include a minimum 40 gallon accumulator having two independent means of power to initiate closing operation.

**MINIMUM CHOKE MANIFOLD**  
3,000, 5,000 and 10,000 PSI Working Press

3 MWP - 5 MWP - 10 MWP

EXHIBIT 1A

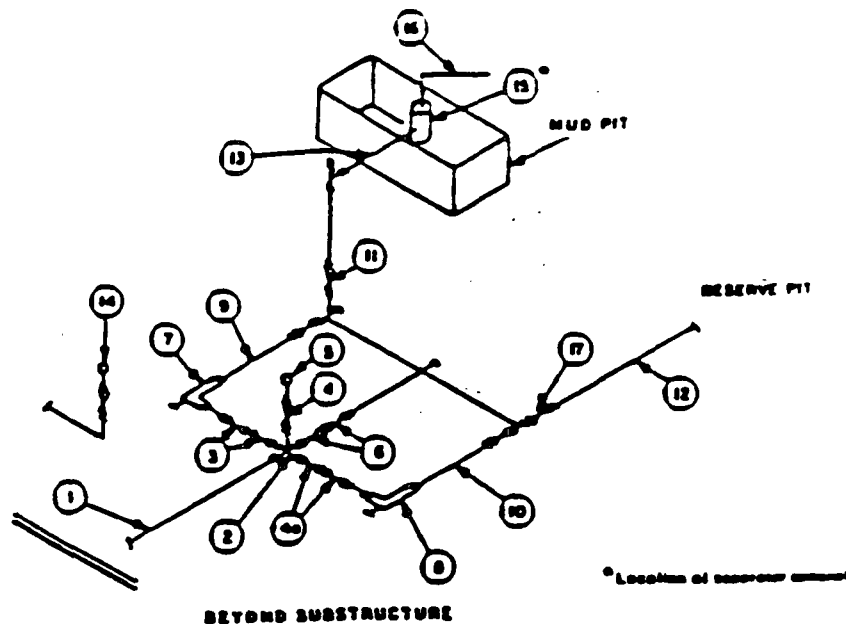

MINIMUM REQUIREMENTS										
No		3,000 MWP			5,000 MWP			10,000 MWP		
		I.D.	NOMINAL	RATING	I.D.	NOMINAL	RATING	I.D.	NOMINAL	RATING
1	Line from ending spool		3"	3,000		3"	5,000		3"	10,000
2	Cross 3"x3"x3"x2"			3,000			5,000			
	Cross 3"x3"x3"x3"									10,000
3	Valves(1) Gate <input type="checkbox"/> Plug <input type="checkbox"/>	3-1/8"		3,000	3-1/8"		5,000	3-1/8"		10,000
4	Valve Gate <input type="checkbox"/> Plug <input type="checkbox"/>	1-13/16"		3,000	1-13/16"		5,000	1-13/16"		10,000
4a	Valves(1)	2-1/16"		3,000	2-1/16"		5,000	2-1/8"		10,000
5	Pressure Gauge			3,000			5,000			10,000
6	Valves Gate <input type="checkbox"/> Plug <input type="checkbox"/>	3-1/8"		3,000	3-1/8"		5,000	3-1/8"		10,000
7	Adjustable Choke(2)	2"		3,000	2"		5,000	2"		10,000
8	Adjustable Choke	1"		3,000	1"		5,000	2"		10,000
9	Line		3"	3,000		3"	5,000		3"	10,000
10	Line		2"	3,000		2"	5,000		3"	10,000
11	Valves Gate <input type="checkbox"/> Plug <input type="checkbox"/>	3-1/8"		3,000	3-1/8"		5,000	3-1/8"		10,000
12	Lines		3"	1,000		3"	1,000		3"	2,000
13	Lines		3"	1,000		3"	1,000		3"	2,000
14	Remote reading compound manifold pressure gauge			3,000			5,000			10,000
15	Gas Separator		2'x5'			2'x5'			2'x5'	
16	Line		4"	1,000		4"	1,000		4"	2,000
17	Valves Gate <input type="checkbox"/> Plug <input type="checkbox"/>	3-1/8"		3,000	3-1/8"		5,000	3-1/8"		10,000

(1) Only one required in Class 3M.

(2) Gate valves only shall be used for Class 10M.

(3) Remote operated hydraulic chokes required on 5,000 psi and 10,000 psi for drilling.

**EQUIPMENT SPECIFICATIONS AND INSTALLATION INSTRUCTIONS**

- All connections in choke manifold shall be welded, studded, flanged or Cameron clamp of comparable rating.
- All flanges shall be API 6B or 6BX and ring gaskets shall be API RX or BX. Use only BX for 10 MWP.
- All lines shall be securely anchored.
- Chokes shall be equipped with tungsten carbide seats and needles, and replacements shall be available.
- Choke manifold pressure and standpipe pressure gauges shall be available at the choke manifold to assist in regulating chokes. As an alternate with automatic chokes, a choke manifold pressure gauge shall be located on the rig floor in conjunction with the standpipe pressure gauge.
- Line from drilling spool to choke manifold should be as straight as possible. Lines downstream from chokes shall make turns by large bends or 90° bends using bull plugged tees.
- Discharge lines from chokes, choke bypass and from top of gas separator should vent as far as practical from the well

**WRS COMPLETION REPORT**

COMPLETIONS SEC 34 TWP 17S RGE 27E  
30-T-0047 07/02/98 30-015-29631-0000 PAGE 1

NMEX EDDY \* 990FNL 1065FWL SEC

STATE COUNTY FOOTAGE SPOT

DEVON ENERGY

D

OPERATOR

WELL CLASS INIT FIN

8

EAGLE '34D' FEDERAL

WELL NO.

LEASE NAME

3531GR

RED LAKE

OPER ELEV

FIELD/POOL/AREA

API 30-015-29631-0000

LEASE NO.

PERMIT OR WELL I.D. NO.

06/29/1998 ROTARY

VERT

AB-LOC

SPUD DATE

COMP. DATE

TYPE TOOL

HOLE TYPE

STATUS

2800 SN ANDRS

PROJ. DEPTH

PROJ. FORM

CONTRACTOR

DRILLERS T.D.

LOG T.D.

PLUG BACK TD

OLD T.D.

FORM T.D.

LOCATION DESCRIPTION

17 MI W LOCO HILLS, NM

DRILLING PROGRESS DETAILS

DEVON ENERGY

20 N BROADWAY

STE 1500

OKLAHOMA CITY, OK 73102

405-235-3611

05/05

LOC/1997/

06/29

ABND LOC

IC# 300157034797

COPYRIGHT 1998



Petroleum Information/  
Dwights LLC

PI/D-WRS-GET  
Form No 187

CMD : ONGARD 04/09/99 10:32:46  
OG6C101 C101-APPLICATION FOR PERMIT TO DRILL OGOMES -TPV2

OGRID Idn : 6137 API Well No: 30 15 29631 APD Status(A/C/P): A  
Opr Name, Addr: DEVON ENERGY CORP (NEVADA) Aprvl/Cncl Date : 06-02-1997  
20 N BROADWAY  
STE 1500  
OKLAHOMA CITY,OK 73102  
Prop Idn: 19399 EAGLE 34 D FEDERAL Well No: 8

	U/L	Sec	Township	Range	Lot	Idn	North/South	East/West
	---	---	-----	-----	-----	-----	-----	-----
Surface Locn : D	34	17S		27E			FTG 990 F N	FTG 1065 F W
OCD U/L : D		API	County	: 15				

Work typ(N/E/D/P/A) : N Well typ(O/G/M/I/S/W/C): O Cable/Rotary (C/R) : F  
Lease typ(F/S/P/N/J/U/I): F Ground Level Elevation : 3531

State Lease No: Multiple Comp (Y/N) : N  
Prpsd Depth : 2800 Prpsd Frmtn : SAN ANDRES

E0009: Enter data to modify record

PF01 HELP	PF02	PF03 EXIT	PF04 GoTo	PF05	PF06 CONFIRM
PF07	PF08	PF09 PRINT	PF10 C102	PF11 HISTORY	PF12

CMD :  
OG5SECT

ONGARD  
INQUIRE LAND BY SECTION

04/09/99 10:32:26  
OGOMES -TPV2  
PAGE NO: 1

Sec : 34 Twp : 17S Rng : 27E Section Type : NORMAL

D 40.00  Federal owned A A	C 40.00  Federal owned A A	B 40.00  Federal owned A A	A 40.00  Federal owned A A
E 40.00  Federal owned A A	F 40.00  Federal owned A A A	G 40.00  Federal owned A A	H 40.00  Federal owned A A

PF01 HELP	PF02	PF03 EXIT	PF04 GoTo	PF05	PF06
PF07 BKWD	PF08 FWD	PF09 PRINT	PF10 SDIV	PF11	PF12



CMD :  
OG5SECT

ONGARD  
INQUIRE LAND BY SECTION

04/09/99 10:32:56  
OGOMES -TPV2  
PAGE NO: 2

Sec : 34 Twp : 17S Rng : 27E Section Type : NORMAL

L 40.00	K 40.00	J 40.00	I 40.00
Federal owned	Federal owned	Federal owned	Federal owned
A A	A A	A A	A A
M 40.00	N 40.00	O 40.00	P 40.00
Federal owned	Federal owned	Federal owned U	Federal owned U
A A	A A		A

PF01 HELP  
PF07 BKWD

PF02  
PF08 FWD

PF03 EXIT  
PF09 PRINT

PF04 GoTo  
PF10 SDIV

PF05  
PF11

PF06  
PF12

STATE OF NEW MEXICO  
ENERGY, MINERALS AND NATURAL RESOURCES DEPARTMENT  
OIL CONSERVATION DIVISION

IN THE MATTER OF THE HEARING  
CALLED BY THE OIL CONSERVATION  
DIVISION FOR THE PURPOSE OF  
CONSIDERING:

CASE NO. 11966  
ORDER NO. R-11162

APPLICATION OF DEVON ENERGY CORPORATION (NEVADA) FOR 23  
UNORTHODOX OIL WELL LOCATIONS, EDDY COUNTY, NEW MEXICO.

ORDER OF THE DIVISION

BY THE DIVISION:

This case came on for hearing at 8:15 a.m. on April 16, 1998 at Santa Fe, New Mexico, before Examiner Michael E. Stogner.

NOW, on this 13th day of April, 1999, the Division Director, having considered the testimony, the record and the recommendations of the Examiner,

FINDS THAT:

(1) Due public notice has been given and the Division has jurisdiction of this case and its subject matter.

(2) The applicant, Devon Energy Corporation (Nevada) ["Devon"], seeks authority to drill and produce the following wells at unorthodox oil well locations in Township 17 South, Range 27 East, NMPM, Eddy County, New Mexico:

<u>Well Name and Number</u>	<u>API Number</u>	<u>Section</u>	<u>Footage Location</u>	<u>Unit</u>
Eagle "27-H" Federal No. 15	30-015-29942	27	1450' FNL & 990' FEL	H
Evarts "31" Federal No. 3	30-015-30171	31	1330' FSL & 1630' FEL	J
Eagle "33-G" Federal No. 6	30-015-29595	33	2460' FNL & 1350' FEL	G
Eagle "33-H" Federal No. 8	30-015-29596	33	2435' FNL & 531' FEL	H
Eagle "33-N" Federal No. 10	30-015-29598	33	230' FSL & 2140' FWL	N
Eagle "34-E" Federal No. 10	30-015-29632	34	2310' FNL & 1240' FWL	E
Eagle "34-F" Federal No. 12	30-015-29635	34	2310' FNL & 2420' FWL	F
Eagle "34-G" Federal No. 14	30-015-29636	34	2310' FNL & 1600' FEL	G
Eagle "34-I" Federal No. 18	30-015-29655	34	1740' FSL & 280' FEL	I
Eagle "34-L" Federal No. 24	30-015-29643	34	1740' FSL & 1065' FWL	L

In addition, Devon seeks authority to drill and produce the following wells at unorthodox oil well locations in Township 18 South, Range 27 East, NMPM, Eddy County, New Mexico:

<u>Well Name and Number</u>	<u>API Number</u>	<u>Section</u>	<u>Footage Location</u>	<u>Unit</u>
Falcon "3-N" Federal No. 18	30-015-29575	3	680' FSL & 1350' FWL	N
Carter Collier "5" Federal No. 9	30-015-29995	5	330' FNL & 2360' FEL	B
Evarts "6" Federal No. 4	30-015-30109	6	330' FNL & 1190' FEL	A
Fred "6" Federal No. 5	30-015-30155	6	1260' FNL & 990' FWL	D
Patton "6" Federal No. 6	30-015-30085	6	2460' FNL & 2310' FWL	F
Patton "6" Federal No. 4	30-015-30079	6	1593' FSL & 1469' FWL	K
Patton "6" Federal No. 3	30-015-29980	6	930' FSL & 1450' FWL	N
Hawk "9-B" Federal No. 4	30-015-29480	9	990' FNL & 1360' FEL	B
Hawk "9-J" Federal No. 16	30-015-29483	9	1630' FSL & 1650' FEL	J
Hawk "9-O" Federal No. 17	30-015-29484	9	1170' FSL & 2310' FEL	O
Hawk "17-C" Federal No. 1	30-015-29515	17	380' FNL & 1450' FWL	C
Hawk "17-C" Federal No. 2	30-015-29726	17	890' FNL & 2585' FWL	C
Kaiser No. 1	NA	18	330' FNL & 1110' FEL	A

(3) Prior to the hearing the Division issued the following Administrative Orders for four of the above-described wells:

- (a) NSL-3969 (SD), dated March 11, 1998, granted Devon approval to drill its Hawk "17-C" Federal Wells No. 1 and 2 at the above-described unorthodox oil well locations;
- (b) NSL-3982, dated March 23, 1998, granted Devon approval to drill its Carter Collier "5" Federal Well No. 9 at the above-described unorthodox oil well location; and
- (c) NSL-3983, dated March 23, 1998, granted Devon approval to drill its Evarts "6" Federal Well No. 4 at the above-described unorthodox oil well location.

Since it is unnecessary at this time to include these four wells in this application, they should be dismissed.

(4) The Red Lake (Queen-Grayburg-San Andres) Pool, as currently designated, includes the following lands in Eddy County, New Mexico:

**TOWNSHIP 16 SOUTH, RANGE 28 EAST,**  
**NMPM**

Section 24: SE/4  
Section 25: All  
Section 26: S/2 S/2  
Section 27: SE/4 SE/4  
Section 34: All  
Section 35: All  
Section 36: All

**TOWNSHIP 17 SOUTH, RANGE 27 EAST,**  
**NMPM**

Section 12: SE/4  
Section 13: N/2 and SE/4  
Section 22: S/2 NE/4  
Section 23: S/2 NW/4, NE/4 SW/4, and SE/4  
Section 24: NE/4, S/2 NW/4, N/2 SW/4, and SE/4  
Section 25: NE/4 and S/2  
Section 26: S/2 S/2  
Section 27: All  
Section 32: SE/4  
Section 33: NE/4 and S/2  
Section 34: All  
Section 35: All  
Section 36: All

**TOWNSHIP 17 SOUTH, RANGE 28 EAST,**  
**NMPM**

Section 7: All  
Section 8: SW/4  
Section 9: NE/4 NE/4, S/2 NE/4, and SE/4  
Section 10: SW/4  
Section 11: S/2  
Section 12: SW/4 SW/4  
Section 14: W/2

**TOWNSHIP 17 SOUTH, RANGE 28 EAST,**  
**NMPM**

(Continued)

Section 15: All  
Section 16: NE/4 and S/2  
Section 18: W/2  
Section 19: S/2  
Section 20: All  
Section 22: All  
Section 23: S/2 NW/4 and S/2  
Section 25: N/2  
Section 26: N/2  
Section 27: N/2 N/2 and SW/4  
Section 28: All  
Section 29: N/2, SW/4, and N/2 SE/4  
Section 30: All  
Section 31: NE/4 NE/4, W/2 E/2, and W/2

**TOWNSHIP 18 SOUTH, RANGE 26 EAST,**  
**NMPM**

Section 1: E/2

**TOWNSHIP 18 SOUTH, RANGE 27 EAST,**  
**NMPM**

Section 1: S/2  
Section 2: S/2  
Section 3: All  
Section 4: All  
Section 5: All  
Section 6: All  
Section 7: All  
Section 8: All  
Section 9: All  
Section 17: N/2  
Section 18: NE/4, N/2 NW/4, and SE/4 NW/4.

(5) Currently the Red Lake (Queen-Grayburg-San Andres) Pool is governed by the Division's statewide rules, which require development on standard 40-acre spacing and proration units, each having a top unit depth bracket allowable of 80 barrels of oil per day and a limiting gas/oil ratio of 2,000 cubic feet of gas per barrel of oil, and allow infill drilling on each 40-acre unit.

(6) Within a 1236.85-acre area, more or less, comprising the following described

acreage in Eddy County, New Mexico, Devon is the operator of the West Red Lake Unit Area (approved by Division Order No. R-3453 dated July 12, 1968) in which waterflood operations are being conducted with injection into the Red Lake (Queen-Grayburg-San Andres) Pool (approved by Division Order No. R-3469, issued in Case No. 3824, dated August 13, 1968, and designated the West Red Lake Waterflood Project).

(7) The remaining 19 wells listed in Paragraph No. (2) above are either completed in or proposed to be completed in the Red Lake (Queen-Grayburg-San Andres) Pool, and each well will have a standard 40-acre, more or less, unit dedicated thereto. Eleven wells will be infill wells within existing 40-acre oil proration units while the remaining eight wells will be considered new designations.

(8) The applicant presented evidence that indicates the following:

- (a) All of the wells are located on federal land, except the Kaiser No. 1, which is located on fee land.
- (b) The subject pool is continuous across the area, trending in a northeast-southwest direction.
- (c) The original locations for all of the subject wells were orthodox, but were moved due to topographic and engineering reasons.
- (d) The subject area is near the Pecos River, with numerous draws and elevation changes of 100-200 feet. The Bureau of Land Management requested that numerous well locations be moved to prevent extreme cut and fill of slopes and prevent erosion of the highly erodible soil in this area. In addition, there are numerous gas transmission and gathering pipelines, roads, existing wells, and a gas plant. All of these factors limit well locations.
- (e) Average reserves in wells completed in the subject pool are about 50,000 barrels of oil, which equate to approximately 24 acres of drainage. The drainage radius of such a well is much less than a well that is capable of draining 40 acres. The applicant has drilled wells within 400-450 feet of older, above-average wells in the pool, and has seen no evidence of drainage from those older wells.
- (f) Directional drilling is not feasible because the small reserves in these wells do not justify the additional drilling and operating costs.

- (g) Applicant is drilling two wells per 40-acre unit to: (i) adequately drain each unit, and (ii) prepare for a possible future waterflood project. Injection in the West Red Lake Unit has shown a favorable production response. Drilling two wells per 40-acre unit could allow the Unit's waterflood project to be expanded in the future.

(9) Each of the above-described unorthodox oil well locations should be approved for one or more of the following reasons:

- (a) The location is a move toward the interior of a lease;
- (b) The location encroaches on a lease not owned or operated by the applicant, but notice was given to the offset and the Division received no objection;
- (c) The location will not drain the offset well unit due to the limited drainage areas in the subject pool;
- (d) A well will be drilled offsetting the proposed unorthodox well, or the offsetting well unit has existing wells producing from the same pool; and/or
- (e) There are no overriding royalty interest owners in the tract offsetting the subject well, or the applicant is the only overriding royalty interest owner in the offsetting tract.

(10) Approval of the proposed unorthodox oil well locations will afford the applicant the opportunity to produce its just and equitable share of oil and gas from the subject pool and will prevent waste and protect correlative rights.

**IT IS THEREFORE ORDERED THAT:**

(1) The applicant, Devon Energy Corporation (Nevada), is hereby authorized to drill the wells described below at unorthodox oil well locations in the Red Lake (Queen-Grayburg-San Andres) Pool in Township 17 South, Range 27 East, NMPM, Eddy County, New Mexico:

<b><u>Well Name and Number</u></b>	<b><u>API Number</u></b>	<b><u>Section</u></b>	<b><u>Footage Location</u></b>	<b><u>Unit</u></b>
Eagle "27-H" Federal No. 15	30-015-29942	27	1450' FNL & 990' FEL	H
Evarts "31" Federal No. 3	30-015-30171	31	1330' FSL & 1630' FEL	J

Eagle "33-G" Federal No. 6	30-015-29595	33	2460' FNL & 1350' FEL	G
Eagle "33-H" Federal No. 8	30-015-29596	33	2435' FNL & 531' FEL	H
Eagle "33-N" Federal No. 10	30-015-29598	33	230' FSL & 2140' FWL	N
Eagle "34-E" Federal No. 10	30-015-29632	34	2310' FNL & 1240' FWL	E
Eagle "34-F" Federal No. 12	30-015-29635	34	2310' FNL & 2420' FWL	F
Eagle "34-G" Federal No. 14	30-015-29636	34	2310' FNL & 1600' FEL	G
Eagle "34-I" Federal No. 18	30-015-29655	34	1740' FSL & 280' FEL	I
Eagle "34-L" Federal No. 24	30-015-29643	34	1740' FSL & 1065' FWL	L

And in Township 18 South, Range 27 East, NMPM, Eddy County, New Mexico:

<u>Well Name and Number</u>	<u>API Number</u>	<u>Section</u>	<u>Footage Location</u>	<u>Unit</u>
Falcon "3-N" Federal No. 18	30-015-29575	3	680' FSL & 1350' FWL	N
Fred "6" Federal. No. 5	30-015-30155	6	1260' FNL & 990' FWL	D
Patton "6" Federal No. 6	30-015-30085	6	2460' FNL & 2310' FWL	F
Patton "6" Federal No. 4	30-015-30079	6	1593' FSL & 1469' FWL	K
Patton "6" Federal No. 3	30-015-29980	6	930' FSL & 1450' FWL	N
Hawk "9-B" Federal No. 4	30-015-29480	9	990' FNL & 1360' FEL	B
Hawk "9-J" Federal No. 16	30-015-29483	9	1630' FSL & 1650' FEL	J
Hawk "9-O" Federal No. 17	30-015-29484	9	1170' FSL & 2310' FEL	O
Kaiser No. 1	NA	18	330' FNL & 1110' FEL	A

(2) Each well shall have a standard 40-acre oil spacing and proration unit dedicated thereto.

(3) Jurisdiction of this case is retained for the entry of such further orders as the Division may deem necessary.

DONE at Santa Fe, New Mexico, on the day and year hereinabove designated.

STATE OF NEW MEXICO  
OIL CONSERVATION DIVISION

  
LORI WROTENBERY  
Director

S E A L