

4/5/09
3/4/09
SUBPENSE
11 Jones
3/4/09
TYPE SWD
PRATA 0906360435

ABOVE THIS LINE FOR DIVISION USE ONLY

NEW MEXICO OIL CONSERVATION DIVISION

- Engineering Bureau -

1220 South St. Francis Drive, Santa Fe, NM 87505



Loco Hills 4-33

30-015

COG Operating
229137

ADMINISTRATIVE APPLICATION CHECKLIST

THIS CHECKLIST IS MANDATORY FOR ALL ADMINISTRATIVE APPLICATIONS FOR EXCEPTIONS TO DIVISION RULES AND REGULATIONS WHICH REQUIRE PROCESSING AT THE DIVISION LEVEL IN SANTA FE

Application Acronyms:

[NSL-Non-Standard Location] [NSP-Non-Standard Proration Unit] [SD-Simultaneous Dedication]
[DHC-Downhole Commingling] [CTB-Lease Commingling] [PLC-Pool/Lease Commingling]
[PC-Pool Commingling] [OLS - Off-Lease Storage] [OLM-Off-Lease Measurement]
[WFX-Waterflood Expansion] [PMX-Pressure Maintenance Expansion]
[SWD-Salt Water Disposal] [IPI-Injection Pressure Increase]
[EOR-Qualified Enhanced Oil Recovery Certification] [PPR-Positive Production Response]

[1] TYPE OF APPLICATION - Check Those Which Apply for [A]

- [A] Location - Spacing Unit - Simultaneous Dedication
☐ NSL ☐ NSP ☐ SD

Check One Only for [B] or [C]

- [B] Commingling - Storage - Measurement
☐ DHC ☐ CTB ☐ PLC ☐ PC ☐ OLS ☐ OLM

- [C] Injection - Disposal - Pressure Increase - Enhanced Oil Recovery
☐ WFX ☐ PMX ☒ SWD ☐ IPI ☐ EOR ☐ PPR

- [D] Other: Specify _____

[2] NOTIFICATION REQUIRED TO: - Check Those Which Apply, or Does Not Apply

- [A] ☐ Working, Royalty or Overriding Royalty Interest Owners
[B] ☒ Offset Operators, Leaseholders or Surface Owner
[C] ☐ Application is One Which Requires Published Legal Notice
[D] ☒ Notification and/or Concurrent Approval by BLM or SLO
U.S. Bureau of Land Management - Commissioner of Public Lands, State Land Office
[E] ☒ For all of the above, Proof of Notification or Publication is Attached, and/or,
[F] ☐ Waivers are Attached

[3] SUBMIT ACCURATE AND COMPLETE INFORMATION REQUIRED TO PROCESS THE TYPE OF APPLICATION INDICATED ABOVE.

[4] CERTIFICATION: I hereby certify that the information submitted with this application for administrative approval is accurate and complete to the best of my knowledge. I also understand that no action will be taken on this application until the required information and notifications are submitted to the Division.

Note: Statement must be completed by an individual with managerial and/or supervisory capacity.

Print or Type Name

Signature

Title

Date

MARK A. FAIRCHILD

[Signature]

SR. OPS ENGR

3/4/09

MFairchild@

e-mail Address conchorasources.com

RECEIVED

APPLICATION FOR AUTHORIZATION TO INJECT

- I. PURPOSE: Secondary Recovery _____ Pressure Maintenance YES Disposal _____ Storage _____
Application qualifies for administrative approval? XXX Yes _____ No _____
- II. OPERATOR: COG OPERATING LLC
ADDRESS: 550 WEST TEXAS AVE., SUITE 1300, MIDLAND, TX 79701
CONTACT PARTY: TYE ORR (VERITAS 321 ENERGY PARTNERS, LP) PHONE: 432-683-7443 (432) 682-4002
- III. WELL DATA: Complete the data required on the reverse side of this form for each well proposed for injection.
Additional sheets may be attached if necessary.
- IV. Is this an expansion of an existing project? _____ Yes XXX No _____
If yes, give the Division order number authorizing the project: _____
- V. Attach a map that identifies all wells and leases within two miles of any proposed injection well with a one-half mile radius circle drawn around each proposed injection well. This circle identifies the well's area of review.
- VI. Attach a tabulation of data on all wells of public record within the area of review which penetrate the proposed injection zone. Such data shall include a description of each well's type, construction, date drilled, location, depth, record of completion, and a schematic of any plugged well illustrating all plugging detail.
- VII. Attach data on the proposed operation, including:
1. Proposed average and maximum daily rate and volume of fluids to be injected;
 2. Whether the system is open or closed;
 3. Proposed average and maximum injection pressure;
 4. Sources and an appropriate analysis of injection fluid and compatibility with the receiving formation if other than reinjected produced water; and,
 5. If injection is for disposal purposes into a zone not productive of oil or gas at or within one mile of the proposed well, attach a chemical analysis of the disposal zone formation water (may be measured or inferred from existing literature, studies, nearby wells, etc.).
- *VIII. Attach appropriate geologic data on the injection zone including appropriate lithologic detail, geologic name, thickness, and depth. Give the geologic name, and depth to bottom of all underground sources of drinking water (aquifers containing waters with total dissolved solids concentrations of 10,000 mg/l or less) overlying the proposed injection zone as well as any such sources known to be immediately underlying the injection interval.
- IX. Describe the proposed stimulation program, if any.
- *X. Attach appropriate logging and test data on the well. (If well logs have been filed with the Division, they need not be resubmitted).
- *XI. Attach a chemical analysis of fresh water from two or more fresh water wells (if available and producing) within one mile of any injection or disposal well showing location of wells and dates samples were taken.
- XII. Applicants for disposal wells must make an affirmative statement that they have examined available geologic and engineering data and find no evidence of open faults or any other hydrologic connection between the disposal zone and any underground sources of drinking water.
- XIII. Applicants must complete the "Proof of Notice" section on the reverse side of this form.
- XIV. Certification: I hereby certify that the information submitted with this application is true and correct to the best of my knowledge and belief.
- NAME: MARK A. FAIRCHILD TITLE: SR. OPS ENGR
SIGNATURE: [Signature] DATE: 3/2/09
E-MAIL ADDRESS: _____
- * If the information required under Sections VI, VIII, X, and XI above has been previously submitted, it need not be resubmitted. Please show the date and circumstances of the earlier submittal: _____

III. WELL DATA

A. The following well data must be submitted for each injection well covered by this application. The data must be both in tabular and schematic form and shall include:

- (1) Lease name; Well No.; Location by Section, Township and Range; and footage location within the section.
- (2) Each casing string used with its size, setting depth, sacks of cement used, hole size, top of cement, and how such top was determined.
- (3) A description of the tubing to be used including its size, lining material, and setting depth.
- (4) The name, model, and setting depth of the packer used or a description of any other seal system or assembly used.

Division District Offices have supplies of Well Data Sheets which may be used or which may be used as models for this purpose. Applicants for several identical wells may submit a "typical data sheet" rather than submitting the data for each well.

B. The following must be submitted for each injection well covered by this application. All items must be addressed for the initial well. Responses for additional wells need be shown only when different. Information shown on schematics need not be repeated.

- (1) The name of the injection formation and, if applicable, the field or pool name.
- (2) The injection interval and whether it is perforated or open-hole.
- (3) State if the well was drilled for injection or, if not, the original purpose of the well.
- (4) Give the depths of any other perforated intervals and detail on the sacks of cement or bridge plugs used to seal off such perforations.
- (5) Give the depth to and the name of the next higher and next lower oil or gas zone in the area of the well, if any.

XIV. PROOF OF NOTICE

All applicants must furnish proof that a copy of the application has been furnished, by certified or registered mail, to the owner of the surface of the land on which the well is to be located and to each leasehold operator within one-half mile of the well location.

Where an application is subject to administrative approval, a proof of publication must be submitted. Such proof shall consist of a copy of the legal advertisement which was published in the county in which the well is located. The contents of such advertisement must include:

- (1) The name, address, phone number, and contact party for the applicant;
- (2) The intended purpose of the injection well; with the exact location of single wells or the Section, Township, and Range location of multiple wells;
- (3) The formation name and depth with expected maximum injection rates and pressures; and,
- (4) A notation that interested parties must file objections or requests for hearing with the Oil Conservation Division, 1220 South St. Francis Dr., Santa Fe, New Mexico 87505, within 15 days.

NO ACTION WILL BE TAKEN ON THE APPLICATION UNTIL PROPER PROOF OF NOTICE HAS BEEN SUBMITTED.

NOTICE: Surface owners or offset operators must file any objections or requests for hearing of administrative applications within 15 days from the date this application was mailed to them.

WELL BORE DIAGRAM - As Proposed

COG SENM Loco Hills SWD 4-33

LEGAL: 840 FSL; 660 FEL, Sec 33, T17S; R30E, Eddy Co. NM

API#: Not Assigned

State Lease #: Not Assigned

ELEV: 3,594' Est'd

Property Code: Not Assigned

SPUD DATE: 9/1/09, Est'd

COMPL. DATE: 9/20/09, Est'd

Drilled hole, Casing and Cementing details are on page two.

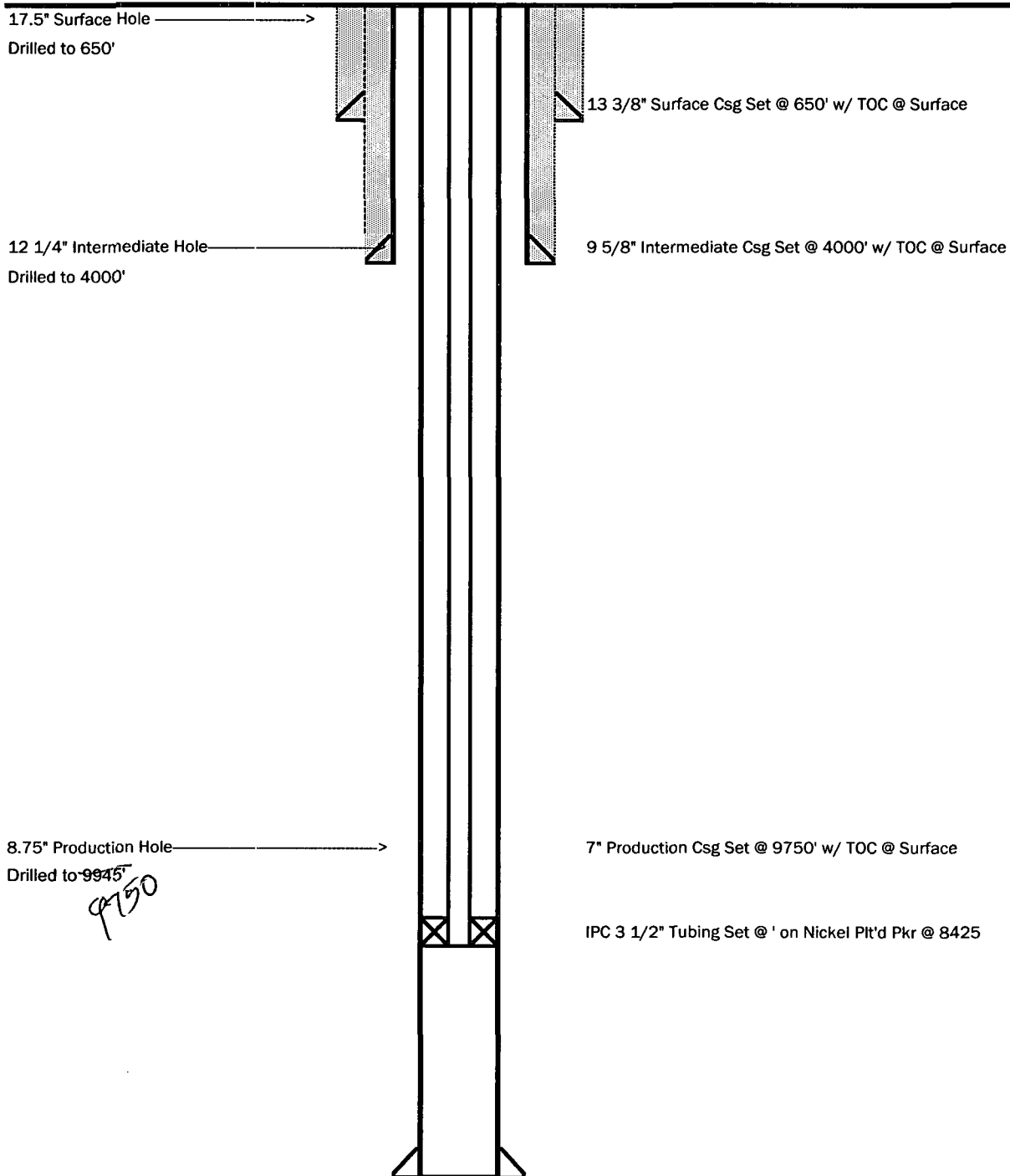

Hole Detail	Size, in	Depth
Surface	17 1/2	650
Intermediate	12 1/4	4000
Liner		
Production	8 3/4	9945

9750

Casing Detail

Name	Size, OD in.	Wt	Grd	CPLG	Thd	Ftg	Set
Surface	13 3/8						650
Intermediate	9 5/8						4000
Production	7						9750
Tubing	IPC 3 1/2						8425

Cementing Detail

Name	Cement Data	TOC
Surface	All Casing strings cemented to surface	Surface
Intermediate	All Casing strings cemented to surface	Surface
Production	All Casing strings cemented to surface	Surface

Well Name: LOCO HILLS SWD 4-33

SEC. 33, T17S, R30E
660 FSL & 660' FEL
TD. 9750'

SEVEN RIVERS	1825'
QUEEN	2475'
GRAYBURG	2875'
SAN ANDRES	3375'
GLRT (BSIG)	6475'
TUBB	8000'
WOLFCAMP	8175'
DISPOSAL INTERVAL	8525-8950' (425')
CISCO	9150'
DISPOSAL INTERVAL	9400-9550' (150')

**Casing Program:**

String	Hole Size	Casing Sz	TD	Cmt*	Note
Conductor	24"	20	+/-40'	Surface	Pre set prior to MORT
Surface	17 1/2"	13 3/8"	+/- 650	Surface	
Intermediate	12 1/4"	9 5/8"	+/- 4000	Surface	
Long String	8 3/4"	7"	TD is shown above for each well	Surface	2 stage, DV Tool at +/- 7,000
*Cmt equipment by Weatherford					

INJECTION WELL DATA SHEET

OPERATOR: COG OPERATING LLCWELL NAME & NUMBER: LOCO HILLS SWD 4-33WELL LOCATION: 840' FSL; 660' FWL, Eddy Co., NM
FOOTAGE LOCATIONUNIT LETTER
SECTION T17S TOWNSHIP R30E RANGEWELLBORE SCHEMATICWELL CONSTRUCTION DATA
Surface Casing

COG SENM SWD Candidate

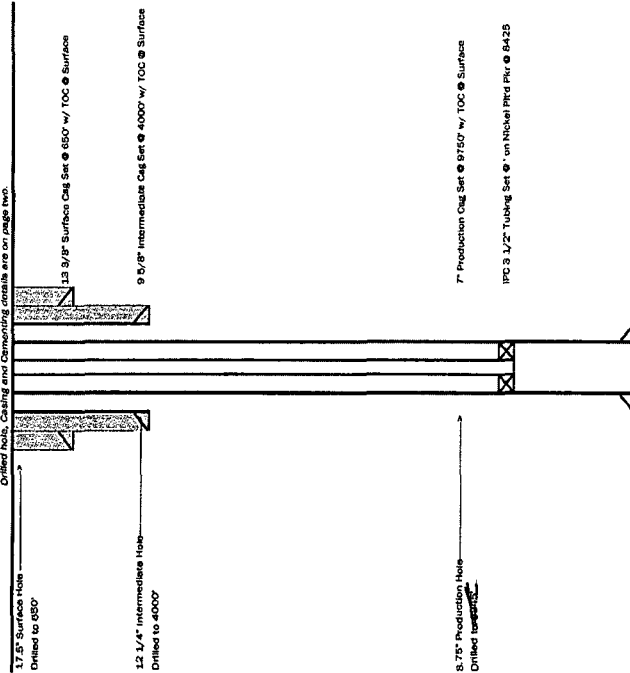
WELL BORE DIAGRAM - As Proposed
COG SENM Loco Hills SWD 4-33LEGAL: 840 FSL, 660 FWL, Sec. 33, T17S, R30E, Eddy Co., NM
API#: Not Assigned
ELEV: 3,594' Est'd
SPUD DATE: 9/1/09, Est'd
COMPL. DATE: 9/20/09, Est'd
Property Code: Not Assigned
Dashed hole, casing and cementing details are on page two.Hole Size: 17 1/2"Cemented with: 700 sacksTop of Cement: SURFACECasing Size: 13 3/8"or ft³Method Determined: VISUALIntermediate CasingHole Size: 12 1/4"Cemented with: 1,475 sacksTop of Cement: SURFACECasing Size: 9 5/8"or ft³Method Determined: VISUALProduction CasingHole Size: 8 3/4"Cemented with: 2,200 sacksTop of Cement: SURFACECasing Size: 7"or ft³Method Determined: LOG

WOLF CAMP Injection Interval ✓
Ref From 8,525' feet To 8,950 feet

(Perforated or Open Hole; indicate which)

INJECTION WELL DATA SHEETTubing Size: 3 1/2", 8rd, EUELining Material: PLASTIC, IPC 1850 PERMIAN COATINGType of Packer: 10K DOUBLE SET PACKER W/ PROFILES WILL BE SETPacker Setting Depth: WITHIN 100' OF TOP PERFORATIONOther Type of Tubing/Casing Seal (if applicable): No other seal than a packer. At the surface, the wellhead equipment will form the casing/tubing seal.Additional Data

1. Is this a new well drilled for injection? XXX Yes No

If no, for what purpose was the well originally drilled? _____

2. Name of the Injection Formation: WOLFCAMP REEF

3. Name of Field or Pool (if applicable): _____

4. Has the well ever been perforated in any other zone(s)? List all such perforated intervals and give plugging detail, i.e. sacks of cement or plug(s) used. _____

5. Give the name and depths of any oil or gas zones underlying or overlying the proposed injection zone in this area: ATTACHED



ATTACHMENT TO APPLICATION C-108

COG Operating Inc.
Loco Hills SWD 2-35
Sec, 35, T-17-S, R-30-E
Eddy County, NM

III. WELL DATA – See attached on reverse side of form as requested.

V. MAP ATTACHED

VI. LIST OF WELLS AND DATA ATTACHED.

VII. PROPOSED OPERATIONS

1. The injection volume will average 10,000 BWPD while the maximum injection volumes are expected to be 15,000 BWPD.
2. This will be a closed loop system.
3. The average injection pressure should be 500 psig or less while the maximum injection pressure should not exceed 1,730 psig.
4. Analysis attached, only produced water.
5. This well is not yet drilled. COG will swab the formation and recover fluid samples for analysis and reporting to NMOCD. Research disposal zone formation water and attach and chemical analysis.

VIII. WORLFCAMP REEF FORMATION

The Wolfcamp reef section is a thick interval of carbonate reef buildup that has been diagenetically altered to dolomite, thus yielding intervals of significant secondary porosity with high permeability. Natural fracturing may also be present. Formation tops in this well are:

See attachment

~~Quaternary: 0'~~
~~Rustler: 907'~~
~~Salado: 1,000'~~
~~Yates: 2,220'~~
~~Seven Rivers: 2,500'~~
~~Queen: 3,197'~~
~~Grayburg: 3,566'~~
~~San Andres: 3,940'~~
~~Glorieta: 5,796'~~
~~Paddock: 5,850'~~
~~Bone Springs: 6,220'~~
~~Tubb: 7,430'~~
~~Drinkard: 7,489'~~
~~Abo: 7,740'~~
~~Upper Wolfcamp: 9,329'~~
Total Depth: 9,700'
~~Lower Wolfcamp: 10,094'~~

[Signature]

- IX. The zone will be acidized with 15% NE FE acid with rock salt diversion.
- X. Logging and test data will be run on the well when drilled.
- XI. No fresh water found or recorded by state engineer or OCD.
- XII. The disposal formation will have several thousand feet of overburden on top of it.

In these several thousands of feet of impermeable shale and evaporate zones of various thickness exists. These zones will stop any hydraulic communication between geologic strata.
- XIII. Notice (this application) has been sent to the surface owner (BLM), operators of all wells, and lessees, working interest, or lease operating right holders, and lessors within a half mile.

Estimated tops of Important Geological Markers

Well Name

Formation	Loco Hills SWD 2-35	Loco Hills SWD 3-34	Loco Hills SWD 4-33	Skelly SWD 28-1	Maljamar SWD 29-1
Rustler	600	550	500	650	800
Yates	1,700	1,650	1,600	1,860	2,035
SEVEN RIVERS	1,925	1,850	1,825	2,750	2,800
QUEEN	2,550	2,500	2,475	2,900	3,010
GRAYBURG	2,950	2,900	2,875	3,440	3,380
SAN ANDRES	3,400	3,375	3,375	3,775	3,750
GLORIETA	6,575	6,550	6,475	5,380	5,795
TUBB	8,100	8,050	8,000	7,370	7,250
WOLFCAMP	8,500	8,300	8,175	8,519	9,045
REEF DISPOSAL INTERVAL	8650-9150' (500')	8675-9130' (455')	8525-8950' (425')	9306-9591 (285')	9667-9871 (204')
CISCO	9,300	9,275	9,150	8,500	9,050
REEF DISPOSAL INTERVAL	9400-9500' (100')	9350-9450' (100')	9400-9550' (150')	9755-9825 (70')	10,328-10,500(172')

1625 N. French Dr., Hobbs, NM 88240

DISTRICT II

1301 W. Grand Avenue, Artesia, NM 88210

DISTRICT III

1000 Rio Brazos Rd., Aztec, NM 87410

DISTRICT IV

1220 S. St. Francis Dr., Santa Fe, NM 87505

State of New Mexico
Energy, Minerals and Natural Resources Department

OIL CONSERVATION DIVISION

1220 South St. Francis Dr.
Santa Fe, New Mexico 87505

Form C-102
Revised October 12, 2005

Submit to Appropriate District Office

State Lease - 4 Copies

Fee Lease - 3 Copies

WELL LOCATION AND ACREAGE DEDICATION PLAT

☐ AMENDED REPORT

API Number	Pool Code	Pool Name
Property Code	Property Name	Well Number
	LOCO HILLS SWD	4-33
OGRID No.	Operator Name	Elevation
	C.O.G. OPERATING L.L.C.	3580'

Surface Location

UL or lot No.	Section	Township	Range	Lot Idn	Feet from the	North/South line	Feet from the	East/West line	County
P	33	17 S	30 E		840	SOUTH	660	EAST	EDDY

Bottom Hole Location If Different From Surface

UL or lot No.	Section	Township	Range	Lot Idn	Feet from the	North/South line	Feet from the	East/West line	County
---------------	---------	----------	-------	---------	---------------	------------------	---------------	----------------	--------

Dedicated Acres	Joint or Infill	Consolidation Code	Order No.
-----------------	-----------------	--------------------	-----------

NO ALLOWABLE WILL BE ASSIGNED TO THIS COMPLETION UNTIL ALL INTERESTS HAVE BEEN CONSOLIDATED
OR A NON-STANDARD UNIT HAS BEEN APPROVED BY THE DIVISION

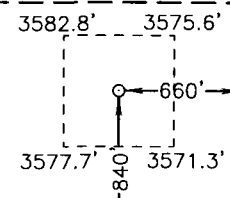
<div style="border: 1px dashed black; height: 200px; margin-bottom: 10px;"></div> <div style="border: 1px dashed black; height: 200px; margin-bottom: 10px;"></div> <div style="border: 1px dashed black; height: 200px;"></div>	<div style="border: 1px dashed black; height: 200px; margin-bottom: 10px;"></div> <div style="border: 1px dashed black; height: 200px; margin-bottom: 10px;"></div> <div style="border: 1px dashed black; height: 200px;"></div>
<p><u>SURFACE LOCATION</u> LAT.: N 32°47'09.79" LONG.: W103°58'13.87" N.: 649889.1 SPC- E.: 652835.7 (NAD-83)</p>	

OPERATOR CERTIFICATION

I hereby certify that the information contained herein is true and complete to the best of my knowledge and belief, and that this organization either owns a working interest or unleased mineral interest in the land including the proposed bottom hole location pursuant to a contract with an owner of such a mineral or working interest, or to a voluntary pooling agreement or a compulsory pooling order heretofore entered by the division.

Signature _____ Date _____

Printed Name _____

SURVEYOR CERTIFICATION

I hereby certify that the well location shown on this plat was plotted from field notes of actual surveys made by me or under my supervision, and that the same is true and correct to the best of my belief.

FEBRUARY 19, 2009

Date Surveyed _____

Signature & Seal of Professional Surveyor _____

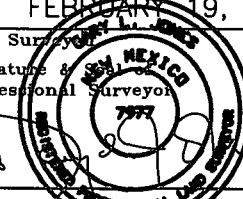

W.C. 1126

Certificate No. Gary L. Jones 7977

BASIN SURVEYS

SECTION 33, TOWNSHIP 17 SOUTH, RANGE 30 EAST, N.M.P.M.,
EDDY COUNTY, NEW MEXICO.

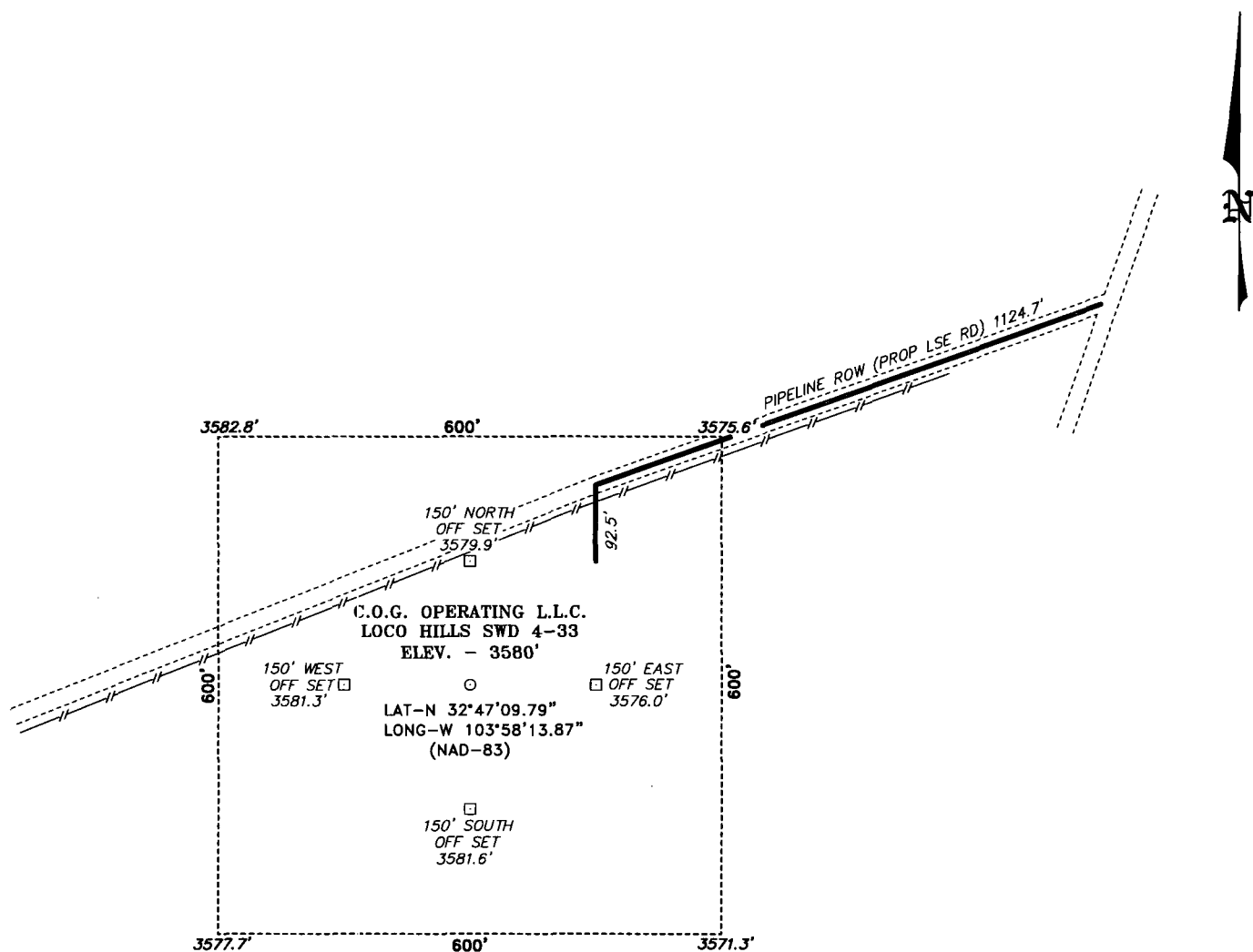

SCALE: 1" = 200'

DIRECTIONS TO LOCATION:

FROM THE JUNCTION OF US HWY 82 AND CO. RD. 217, GO SOUTH 0.4 MILES TO LEASE ROAD, ON LEASE ROAD GO SOUTHEAST 2.0 MILES TO LEASE ROAD, ON LEASE ROAD GO SOUTHWESTERLY 0.2 MILES TO PIPELINE ROW AND PROPOSED LEASE ROAD.

C.O.G. OPERATING L.L.C.

REF: LOCO HILLS SWD 4-33 / Well Pad Topo

THE LOCO HILLS SWD 4-33 LOCATED 840' FROM
THE SOUTH LINE AND 660' FROM THE EAST LINE OF
SECTION 33, TOWNSHIP 17 SOUTH, RANGE 30 EAST,
N.M.P.M., EDDY COUNTY, NEW MEXICO.

BASIN SURVEYS P.O. BOX 1786-HOBBS, NEW MEXICO

W.O. Number: 21126

Drawn By: J. M. SMALL

Date: 02-23-2009

Disk: JMS 21126

Survey Date: 02-19-2009

Sheet 1 of 1 Sheets



LOCO HILLS SWD 4-33

Located at 840' FSL and 660' FEL
 Section 33, Township 17 South, Range 30 East,
 N.M.P.M., Eddy County, New Mexico.



P.O. Box 1786
 1120 N. West County Rd.
 Hobbs, New Mexico 88241
 (575) 393-7316 - Office
 (575) 392-2206 - Fax
 basinsurveys.com

W.O. Number: JMS 21126

Survey Date: 02-19-2009

Scale: 1" = 2000'

Date: 02-23-2009

C.O.G.
 OPERATING
 L.L.C.

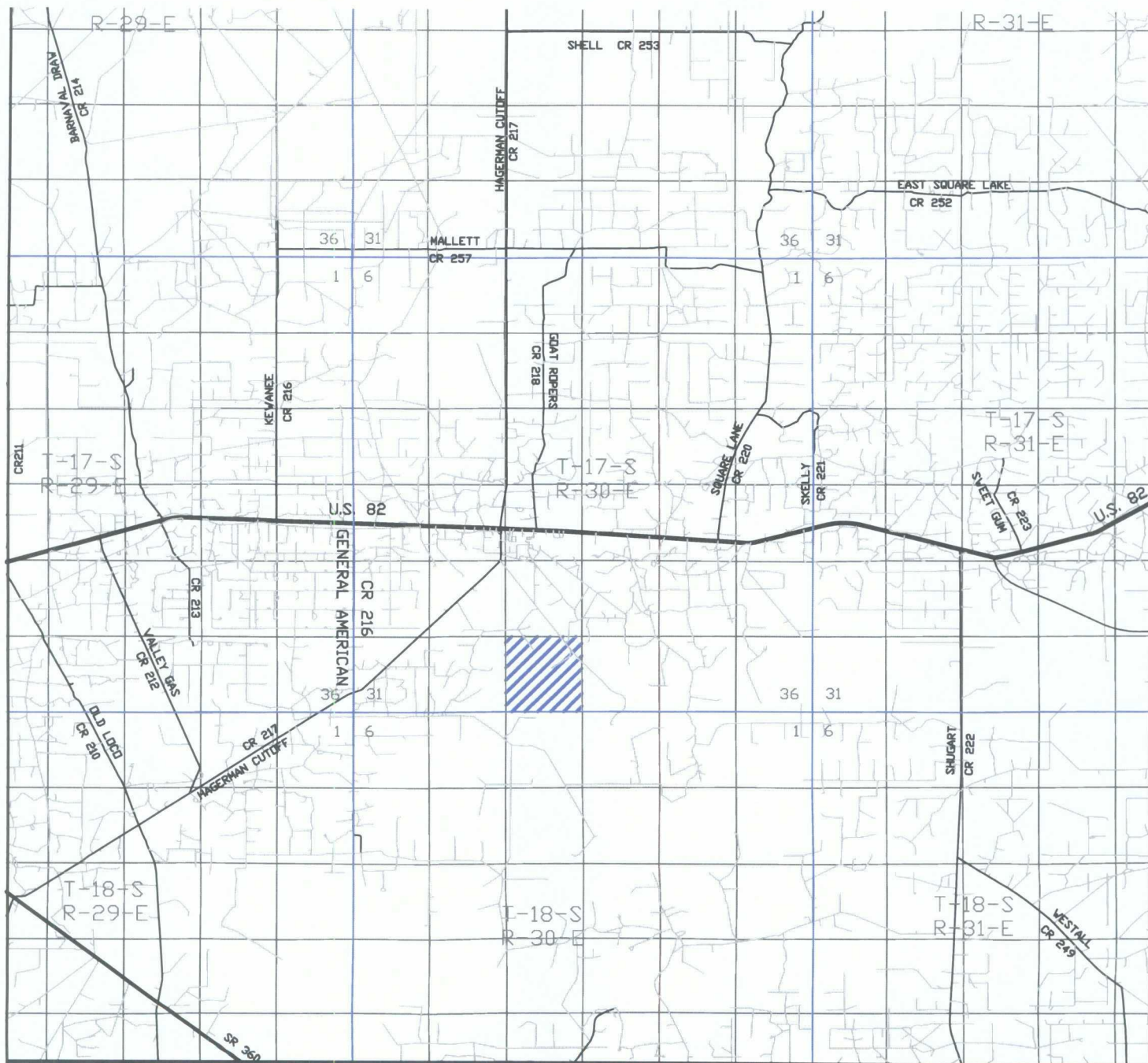

LOCO HILLS SWD 4-33

Located at 840' FSL and 660' FEL
 Section 33, Township 17 South, Range 30 East,
 N.M.P.M., Eddy County, New Mexico.



focused on excellence
 in the oilfield

P.O. Box 1786
 1120 N. West County Rd.
 Hobbs, New Mexico 88241
 (575) 393-7316 - Office
 (575) 392-2206 - Fax
 basinsurveys.com

W.O. Number: JMS 21126

Survey Date: 02-20-2009

Scale: 1" = 2000'

Date: 02-23-2009

C.O.G.
 OPERATING
 L.L.C.

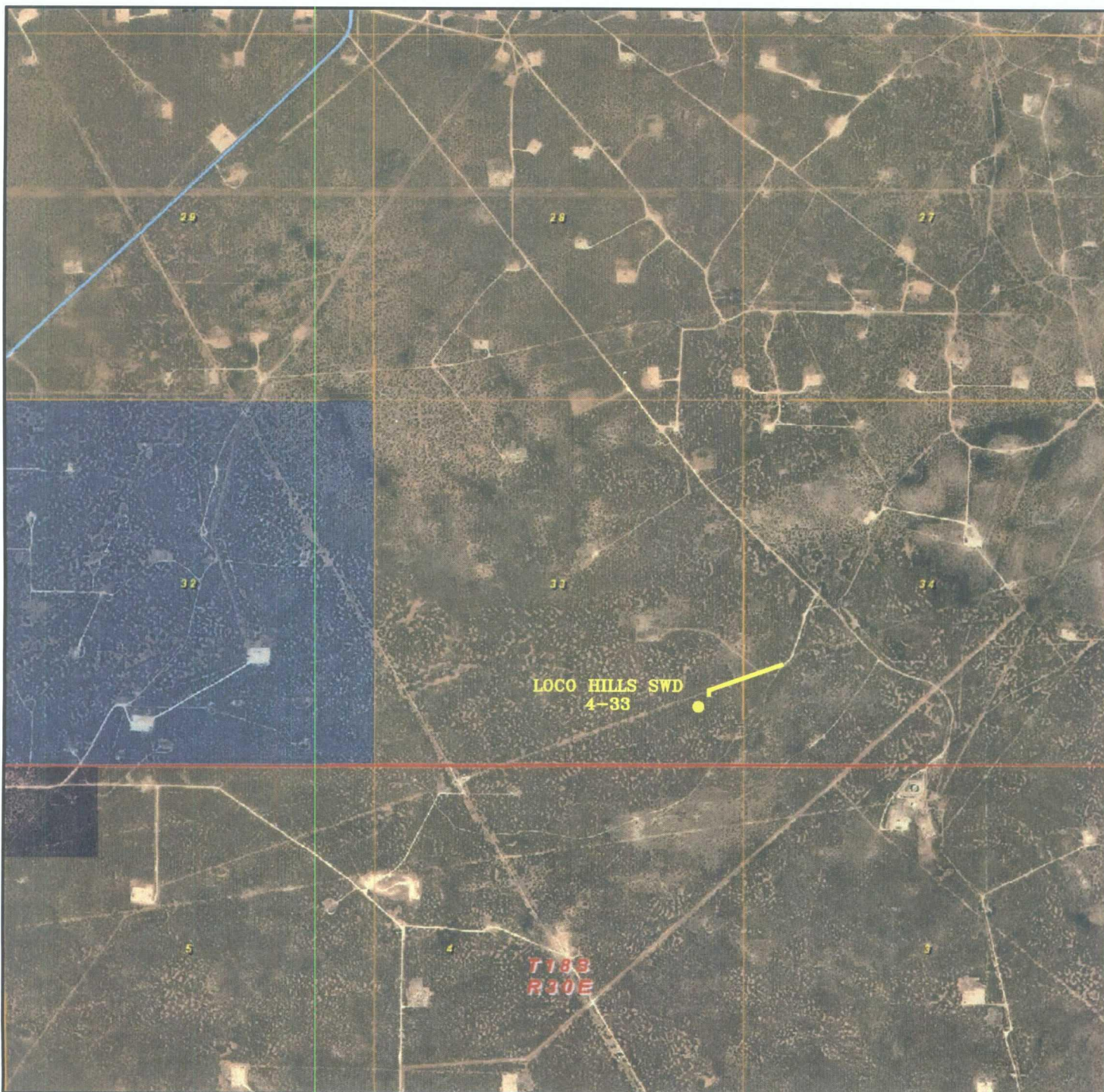

LOCO HILLS SWD 4-33

Located at 840' FSL and 660' FEL
 Section 33, Township 17 South, Range 30 East,
 N.M.P.M., Eddy County, New Mexico.



P.O. Box 1786
 1120 N. West County Rd.
 Hobbs, New Mexico 88241
 (575) 393-7316 - Office
 (575) 392-2206 - Fax
 basinsurveys.com

W.O. Number: JMS 21126

Scale: 1" = 2000'

YELLOW TINT - USA LAND
 BLUE TINT - STATE LAND
 NATURAL COLOR - FEE LAND

C.O.G.
 OPERATING
 L.L.C.

CISF

N.M. Oil Cons. Dist. 2

1501 N. 1st St. Suite 100

Artesia, N.M. 87003

Form 3160-3
(August 1999)

UNITED STATES
DEPARTMENT OF THE INTERIOR
BUREAU OF LAND MANAGEMENT

APPLICATION FOR PERMIT TO DRILL OR REENTER

FORM APPROVED
OMB No. 1004-0136
Expires November 30, 2000

Lease Serial No.

BC-028936D

If Indian, Allottee or Tribe Name

If Unit or CA Agreement, Name and No.

28859

8. Lease Name and Well No.

Big Tank "33" Federal #1

9. API Well No.

30-015-31995

10. Field and Pool, or Exploratory

Exploratory Und Morrow

11. Sec., T., R., M., or Blk. and Survey or Area

Sec. 33, T17S-R30E

12. County or Parish

Eddy

13. State

NM

1a. Type of Work: ☒ DRILL ☐ REENTER

1b. Type of Well: ☐ Oil Well ☒ Gas Well ☐ Other

☒ Single Zone ☐ Multiple Zone

2. Name of Operator

Southwestern Energy Prod. Co.

148111

3a. Address

2350 N. Sam Houston Pkwy. East, Ste. 300

3b. Phone No. (include area code)

(281) 618-4733

Houston, TX 77032

4. Location of Well (Report location clearly and in accordance with any State requirements.)*

At surface 1980' FSL, 1380' FEL

At proposed prod. zone

Unit J

14. Distance in miles and direction from nearest town or post office*

Reservoir Controlled Water Basin

15. Distance from proposed* location to nearest property or lease line, ft. (Also to nearest drig. unit line, if any)

1380' FEL

16. No. of Acres in lease

320

17. Spacing Unit dedicated to this well

320

18. Distance from proposed location* to nearest well, drilling, completed, applied for, on this lease, ft.

19. Proposed Depth

11,900'

20. BLM/BIA Bond No. on file

ES0051

21. Elevations (Show whether DF, KDB, RT, GL, etc.)

3600' GL

22. Approximate date work will start*

early September

23. Estimated duration

40 days

24. Attachments

The following, completed in accordance with the requirements of Onshore Oil and Gas Order No. 1, shall be attached to this form:

1. Well plat certified by a registered surveyor.

2. A Drilling Plan.

3. A Surface Use Plan (if the location is on National Forest System Lands, the SUPO shall be filed with the appropriate Forest Service Office).

4. Bond to cover the operations unless covered by an existing bond on file (see Item 20 above).

5. Operator certification.

6. Such other site specific information and/or plans as may be required by the authorized officer.

25. Signature

Cathy Rowan

Name (Printed/Typed)

Cathy Rowan

Date

08/16/01

Title

Sr. Engineering Tech.

Approved by (Signature)

/s/ LESLIE A. THEISS

Name (Printed/Typed)

/s/ LESLIE A. THEISS

SEP 12 2001

Title

FIELD MANAGER

Office

CARLSBAD FIELD OFFICE

Application approval does not warrant or certify the the applicant holds legal or equitable title to those rights in the subject lease which would entitle the applicant to conduct operations thereon.

Conditions of approval, if any, are attached.

Title 18 U.S.C. Section 1001 and Title 43 U.S.C. Section 1212, make it a crime for any person knowingly and willfully to make to any department or agency of the United States any false, fictitious or fraudulent statements or representations as to any matter within its jurisdiction.

*(Instructions on reverse)

APPROVAL SUBJECT TO
GENERAL REQUIREMENTS AND
SPECIAL STIPULATIONS
ATTACHED

APPROVAL FOR 1 YEAR

PROPERTY I
1625 N. French Dr., Hobbs, NM 88240

State of New Mexico
Energy, Minerals & Natural Resources Department

Form C-102
Revised August 14, 2000
Submit to Appropriate District Office
State Lease - 4 Copies
Fee Lease - 3 Copies

PROPERTY II
P.O. Drawer 80, Artesia, NM 88211-0710

OIL CONSERVATION DIVISION
2040 South Pacheco
Santa Fe, NM 87505

PROPERTY III
1600 E. Truman Rd., Aztec, NM 87410

PROPERTY IV
2040 South Pacheco, Santa Fe, NM 87505

☐ AMENDED REPORT

WELL LOCATION AND ACREAGE DEDICATION PLAT

API Number	Pool Code	Pool Name
Property Code	Property Name BIG TANK "33" FEDERAL	Well Number 1
OGED No. 148111	Operator Name SOUTHWESTERN ENERGY PRODUCTION CO.	Elevation 3600



Surface Location

UL or lot No.	Section	Township	Range	Lot 14n	Feet from the	North/South line	Feet from the	East/West line	County
J	33	17 S	30 E		1980	SOUTH	1380	EAST	EDDY

Bottom Hole Location If Different From Surface

UL or lot No.	Section	Township	Range	Lot 14n	Feet from the	North/South line	Feet from the	East/West line	County
Dedicated Acres 320	Joint or Infill	Consolidation Code	Order No.						

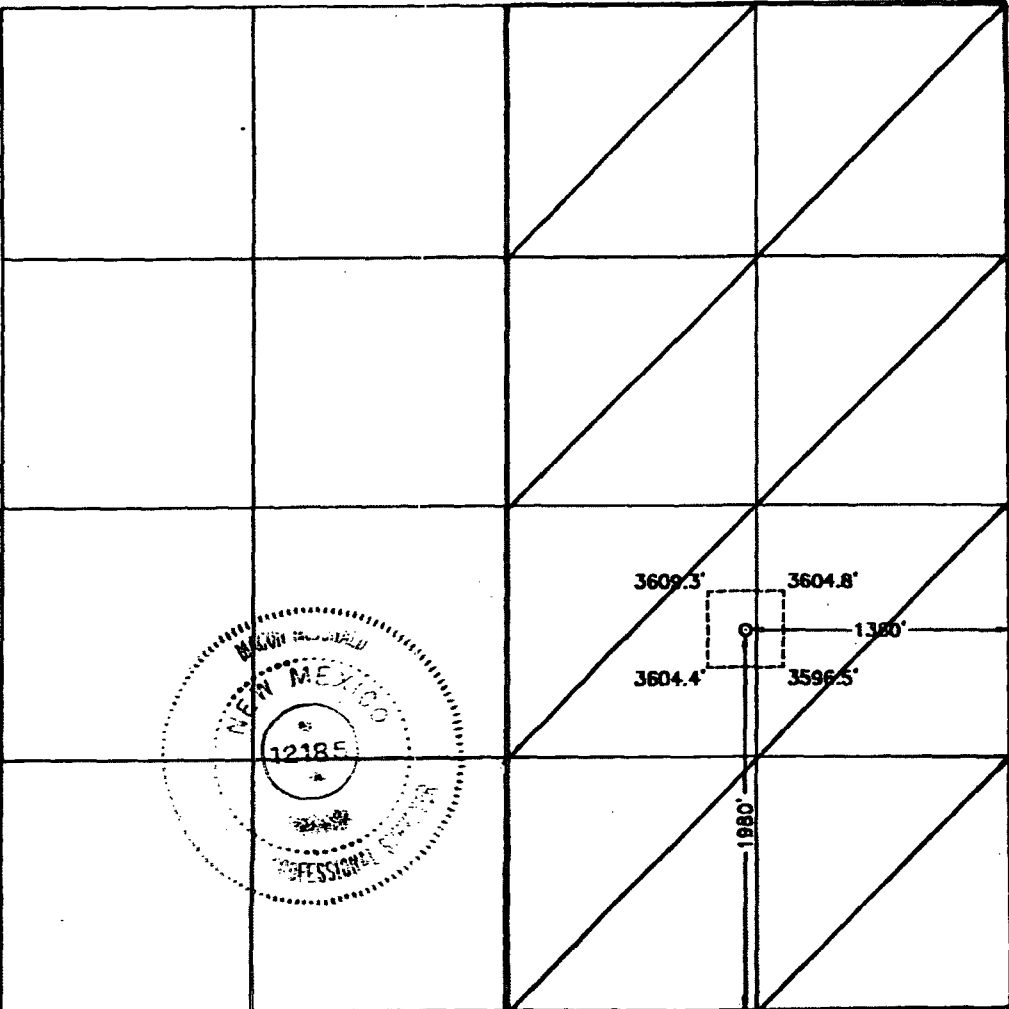
NO ALLOWABLE WILL BE ASSIGNED TO THIS COMPLETION UNTIL ALL INTERESTS HAVE BEEN CONSOLIDATED OR A NON-STANDARD UNIT HAS BEEN APPROVED BY THE DIVISION

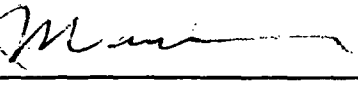
	<p>OPERATOR CERTIFICATION</p> <p>I hereby certify the the information contained herein is true and complete to the best of my knowledge and belief.</p> <p> Signature Cathy Kowan Printed Name Sr. Engineering Tech. Date 07/25/01</p> <p>SURVEYOR CERTIFICATION</p> <p>I hereby certify that the well location shown on this plat was plotted from field notes of actual surveys made by me or under my supervision and that the same is true and correct to the best of my belief.</p> <p>July 11, 2001</p> <p>Date Surveyed Signature & Seal of Professional Surveyor  W.O. Num. 2001-0735 Certificate No. MACON McDONALD 12185</p>
---	--

UNITED STATES
DEPARTMENT OF THE INTERIOR
BUREAU OF LAND MANAGEMENTFORM APPROVED
OMB No. 1004-0135
Expires November 30, 2000

CISF

SUNDRY NOTICES AND REPORTS ON WELLS
*Do not use this form for proposals to drill or to recomplete an abandoned well. Use Form 3160-3 (APD) for such proposals.***SUBMIT IN TRIPLICATE - Other Instructions on reverse side**

1. Type of Well

☐ Oil Well ☒ Gas Well ☐ Other

2. Name of Operator

Southwestern Energy Prod. Co.

3a. Address 2350 N Sam Houston Pkwy. Ste 300 Phone No. (include area code)

Houston TX, 77032

(281) 618-4775

4. Location of Well (Footage, Sec., T., R., M., or Survey Description)

1980' FSL 1380' FEL

Sec. 33, T17S R30E

5. Lease Serial No.

LC-028936D

6. If Indian, Allottee or Tribe Name

7. If Unit or CA/Agreement, Name and/or No.

8. Well Name and No.

Big Tank "33" Federal #1

9. API Well No.

30-015-31995

10. Field and Pool, or Exploratory Area

Exploratory

11. County or Parish, State

Eddy, NM

12. CHECK APPROPRIATE BOX(ES) TO INDICATE NATURE OF NOTICE, REPORT, OR OTHER DATA

TYPE OF SUBMISSION	TYPE OF ACTION			
<input type="checkbox"/> Notice of Intent	<input type="checkbox"/> Acidize	<input type="checkbox"/> Deepen	<input type="checkbox"/> Production (Start/Resume)	<input type="checkbox"/> Water Shut-Off
<input checked="" type="checkbox"/> Subsequent Report	<input checked="" type="checkbox"/> Alter Casing	<input type="checkbox"/> Fracture Treat	<input type="checkbox"/> Reclamation	<input type="checkbox"/> Well Integrity
<input type="checkbox"/> Final Abandonment Notice	<input type="checkbox"/> Casing Repair	<input type="checkbox"/> New Construction	<input type="checkbox"/> Recomplete	<input type="checkbox"/> Other
	<input type="checkbox"/> Change Plans	<input type="checkbox"/> Plug and Abandon	<input type="checkbox"/> Temporarily Abandon	
	<input type="checkbox"/> Convert to Injection	<input type="checkbox"/> Plug Back	<input type="checkbox"/> Water Disposal	

13. Describe Proposed or Completed Operation (clearly state all pertinent details, including estimated starting date of any proposed work and approximate duration thereof. If the proposal is to deepen directionally or recompleat horizontally, give subsurface locations and measured and true vertical depths of all pertinent markers and zones. Attach the Bond under which the work will be performed or provide the Bond No. on file with BLM/BIA. Required subsequent reports shall be filed within 30 days following completion of the involved operations. If the operation results in a multiple completion or recompleat in a new interval, a Form 3160-4 shall be filed once testing has been completed. Final Abandonment Notices shall be filed only after all requirements, including reclamation, have been completed, and the operator has determined that the site is ready for final inspection.)

While drilling at 8819', total loss of circulation was encountered in the top of the Cisco formation. We contacted Mr. Armando Lopez with the BLM in Roswell and discussed our plans to set an unplanned 7" string of casing. We have since regained partial circulation and intermittently lose total returns.

Our plan is to dry drill if necessary to $\pm 9400'$ (est. 150'-200' below lowest zone of loss). Set 7", 26 lb/ft, P-110, LTC casing at 9400' with an Annular Casing Packer to be run in casing string at $\pm 8600'$ and a Cementing Stage Tool to be run immediately above the ACP. Cementing is to be performed in two stages with the first stage pumped as follows: 100 sx (35:65) Poz: Class C + 6% gel + .25 lb/sk cello flake + 5 lb/sk LCM + .5% fluid loss additive, placing cement from 9400' to $\pm 8600'$. After the first stage is pumped, the ACP will be inflated and circulation will be established after opening the stage tool at $\pm 8600'$. The second cement stage will then be pumped as follows: lead slurry of 420 sx (50:50) Poz: Class C + 10% gel + .25 lb/sk cello flake + 5 lb/sk LCM + .3% extender + 3% NaCl + .4% fluid loss additive and tail slurry of 100 sx Class C + .7% fluid loss additive, placing cement from $\pm 8600'$ to 3900' (100' up inside of 9-5/8" casing). We will then drill to PTD of 11,900'. Subsequent to this, if potential productive zones are encountered, the production string of casing will change to a 4-1/2", 11.6 lb/ft, P-110, LTC liner to be run from 9100' to 11,900' and cemented for the entire length with 250 sx (15:61:11) Poz: Class C: CSE + 5 lb/sk LCM + 3% KCl + .6% salt tolerant fluid loss additive + .6% high mol. wt. fluid loss additive.

14. I hereby certify that the foregoing is true and correct
Name (Printed/Typed)

Jill Hegemier

Title Production Analyst

Signature

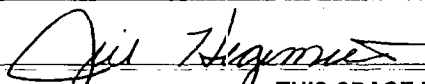

Date

10-26-01

THIS SPACE FOR FEDERAL OR STATE OFFICE USE

Approved by

Title

Date

Conditions of approval, if any, are attached. Approval of this notice does not warrant or certify that the applicant holds legal or equitable title to those rights in the subject lease which would entitle the applicant to conduct operations thereon.

Office

Submit 3 Copies To Appropriate District
Office
District I
1625 N. French Dr., Hobbs, NM 88240
District II
811 South First, Artesia, NM 88210
District III
1000 Rio Brazos Rd., Aztec, NM 87410
District IV
2040 South Pacheco, Santa Fe, NM 87505

State of New Mexico
Energy, Minerals and Natural Resources

OIL CONSERVATION DIVISION
2040 South Pacheco
Santa Fe, NM 87505

Form C-103
Revised March 25, 1999

WELL API NO.
30-01531995

5. Indicate Type of Lease
STATE ☐ FEE ☐

6. State Oil & Gas Lease No.

7. Lease Name or Unit Agreement
Name:
Big Tank "33" Federal Com

SUNDRY NOTICES AND REPORTS ON WELLS
(DO NOT USE THIS FORM FOR PROPOSALS TO DRILL OR TO DEEPEN OR PLUG BACK TO A
DIFFERENT RESERVOIR. USE "APPLICATION FOR PERMIT" (FORM C-101) FOR SUCH
PROPOSALS.)

1. Type of Well:
☐ Oil Well ☒ Gas Well ☐ Other

2. Name of Operator
Southwestern Energy Production Company

8. Well No.
1

3. Address of Operator
2350 N. Sam Houston Parkway East, Suite 300 - Houston, TX 77032

9. Pool name or Wildcat
Exploratory

4. Well Location
Unit Letter _____ : 1980 feet from the _____ S line and 1380 feet from the _____ E line
Section 33 Township 17S Range 30E NMPM Eddy County

10. Elevation (Show whether DR, RKB, RT, GR, etc.)
3600' GL

11. Check Appropriate Box to Indicate Nature of Notice, Report or Other Data

NOTICE OF INTENTION TO:	SUBSEQUENT REPORT OF:
PERFORM REMEDIAL WORK <input type="checkbox"/> PLUG AND ABANDON <input type="checkbox"/>	REMEDIAL WORK <input type="checkbox"/> ALTERING CASING <input type="checkbox"/>
TEMPORARILY ABANDON <input type="checkbox"/> CHANGE PLANS <input type="checkbox"/>	COMMENCE DRILLING OPNS. <input type="checkbox"/> PLUG AND ABANDONMENT <input type="checkbox"/>
PULL OR ALTER CASING <input type="checkbox"/> MULTIPLE COMPLETION <input type="checkbox"/>	CASING TEST AND CEMENT JOB <input checked="" type="checkbox"/>
OTHER: <input type="checkbox"/>	OTHER: <input type="checkbox"/>

12. Describe proposed or completed operations. (Clearly state all pertinent details, and give pertinent dates, including estimated date of starting any proposed work). SEE RULE 1103. For Multiple Completions: Attach wellbore diagram of proposed completion or recompilation.

10/14/01 thru 10/27/01

Drl to 9400'. Run 218 jts 7" 26#, P-110 LT&C csg to 9400'. Cmt w/535 sx Class C. Tail w/100 sx Class C. Circ to surf. WOC 18 hrs. Tst csg. OK.

No well logs in old Records



I hereby certify that the information above is true and complete to the best of my knowledge and belief.

SIGNATURE Vonnie J. Cermin TITLE Production Analyst DATE 11/01/01
Type or print name Vonnie J. Cermin Telephone No. 281-618-4739
(This space for State use)

APPROVED BY _____ TITLE _____ DATE _____
Conditions of approval, if any:

P&A SCHEMATIC

WELL NAME: Big Tank "33" Fed. Com. #1

LOCATION: Section 33-17S-30E
1980' FSL & 1380' FEL
Eddy County, New Mexico

PROSPECT: Big Tank

OBJECTIVE: Morrow

EST. ELEVATION: 3600' GL

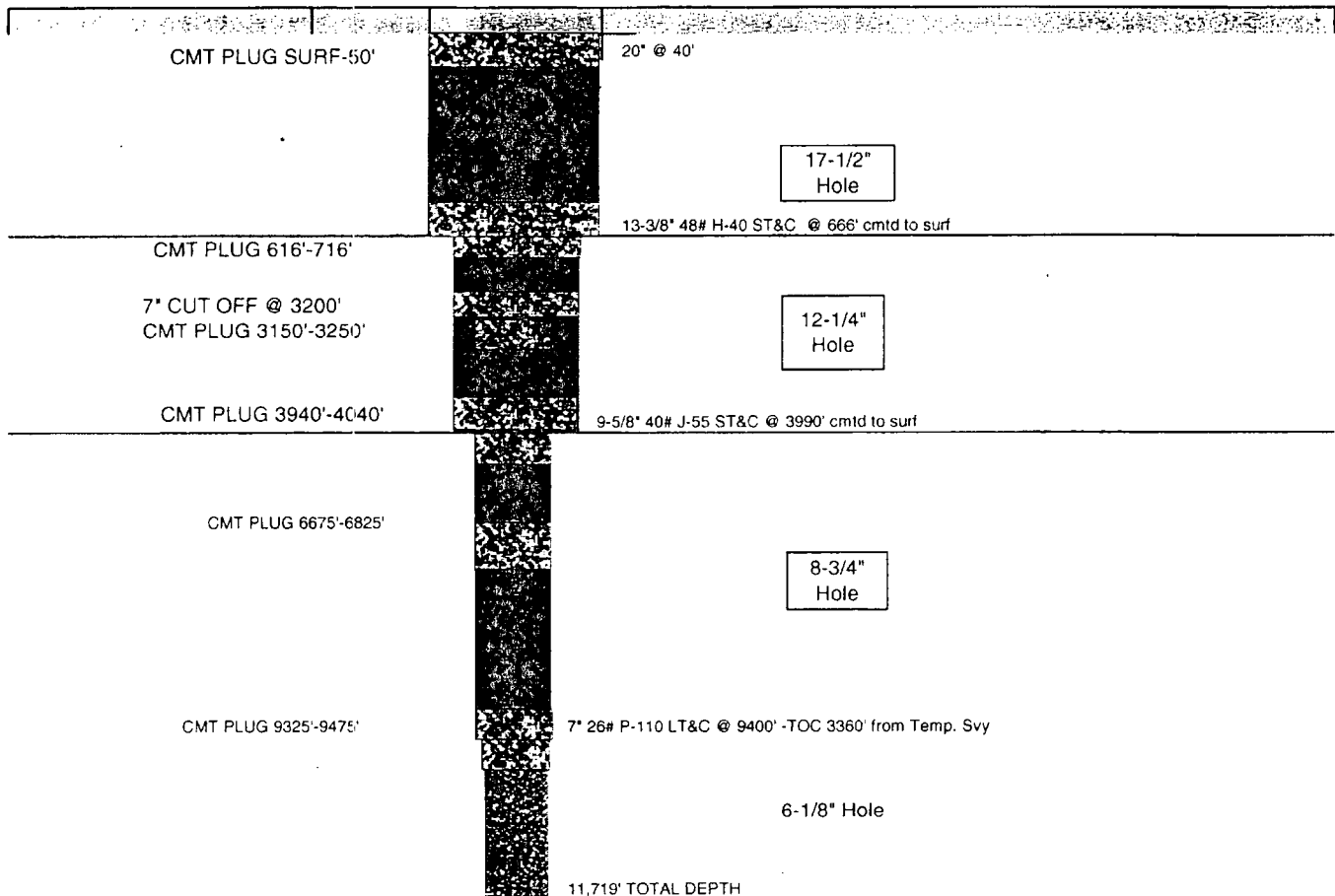

EXHIBIT F

Southwestern Energy Production Company Big Tank "33" Fed. #1 1980' FSL & 1380' FEL Sec. 33, T17S-R30E

Drilling, Drill Stem Tests, Casing and Cementing Program

1. Drill 17-1/2" hole to \pm 660'.
2. Cement 13-3/8", 54.5#, J-55 casing with 700 sx Class C + 2% calcium chloride. Run Texas Pattern Guide Shoe, with an insert float valve in top of shoe joint.
3. Nipple up and install BOP's. Test casing to 600 psi after 18 hours and drill out cement.
4. Drill 12-1/4" hole to 4,000'. Anticipate possible lost circulation zone with possibility of dry drilling. This interval to be drilled with 9.9 – 10.0 ppg saturated brine.
5. Cement 9-5/8", 40#, J-55 casing with lead, 770 sx 35:65 Poz:Class C + 5 lb/sk sodium chloride + 0.25% cello flake + 5 lb/sk LCM + 6% bentonite. Tail with 190 sx Class C + 1% calcium chloride. Run guide shoe and insert float on bottom joint, and 6 centralizers. Weld first few joints of casing.
6. Nipple up and install BOP's. Test casing to 1500 psi for 30 minutes after WOC 18 hours and drill out cement after 24 hours.
7. Drill 8-3/4" hole to TD at 11,900'. A fresh water mud system will be used to \pm 8,500'. At that point the system will be mudded up to 9.3 – 9.6 ppg to obtain good samples. See attached Mud Program for details. Pit levelers and flowline sensors will be utilized on the pits. Drill stem tests are possible in the following zones: Cisco-Canyon – 8,835'; Atoka – 10,785'; Morrow – 11,635'. DST flow periods and shut-in time will be determined on location. A mud logging unit will be on location at 1,500' to assist in evaluating samples and shows for exact drill stem test intervals. Run Formation Density-Compensated Neutron – Gamma Ray log, Dual Induction-Laterlog, and possibly Rotary Sidewall Cores.
8. Run 5-1/2", 17#, N-80 casing and cement with 1315 sx Poz:Class C:CSE + 1% potassium chloride + 8 lb/sk LCM + .6% salt tolerant fluid loss additive + 0.64% water soluble fluid loss additive. Use guide shoe and float collar, and 12-15 centralizers where necessary. Use top and bottom rubber plugs, displace cement with clean, fresh water treated with 2% KCL.
9. Perforations, acid job, and additional stimulation to be determined after completion.

EXHIBIT G

**Southwestern Energy Production Company
Big Tank "33" Fed. #1
1980' FSL & 1380' FEL
Sec. 33, T17S-R30E**

Surface: Spud with a conventional gel/lime "spud mud". Utilize native solids to maintain sufficient viscosity to clean the hole. Mix paper as needed to control seepage loss. Severe loss may require dry drilling to casing point.

Intermediate: Drill out below surface casing with brine. Circulate through the inside portion of the reserve pit for maximum gravitational solids removal. Use sweeps of paper as needed to control seepage loss and for additional hole cleaning. Maintain pH using lime.

Production: Drill out below intermediate casing with fresh water. Circulate through the remaining portion of the reserve pit for gravitational solids removal. Continue to maintain pH using lime and paper sweeps to control seepage loss and prevent excessive cuttings build-up.

Prior to the top of the Cisco, around 8,500', displace the hole with brine and use additions of fresh water to adjust weight as hole conditions dictate. (Wells in this vicinity have used mud weights from 8.9 – 9.7 ppg down to 10,800'.)

Confine circulation to the steel pits. Discontinue lime and begin using caustic soda to maintain pH. Mix XCD Polymer for viscosity and Starlose for filtration control. Add Xcide-102 to the system to preserve the XCD Polymer. Small quantities of S-10 (defoamer) may be needed while mixing through the hopper. Begin at mud-up with a filtrate of 10-12 cc and lower to 6-8 cc prior to penetrating the Morrow

DRILLING PROGNOSIS

WELL NAME: Big Tank "33" Fed. Com. #1

LOCATION: Section 33-17S-30E
1980' FSL & 1380' FEL
Eddy County, New Mexico

PROSPECT: Big Tank

OBJECTIVE: Morrow

EST. ELEVATION: 3600' GL

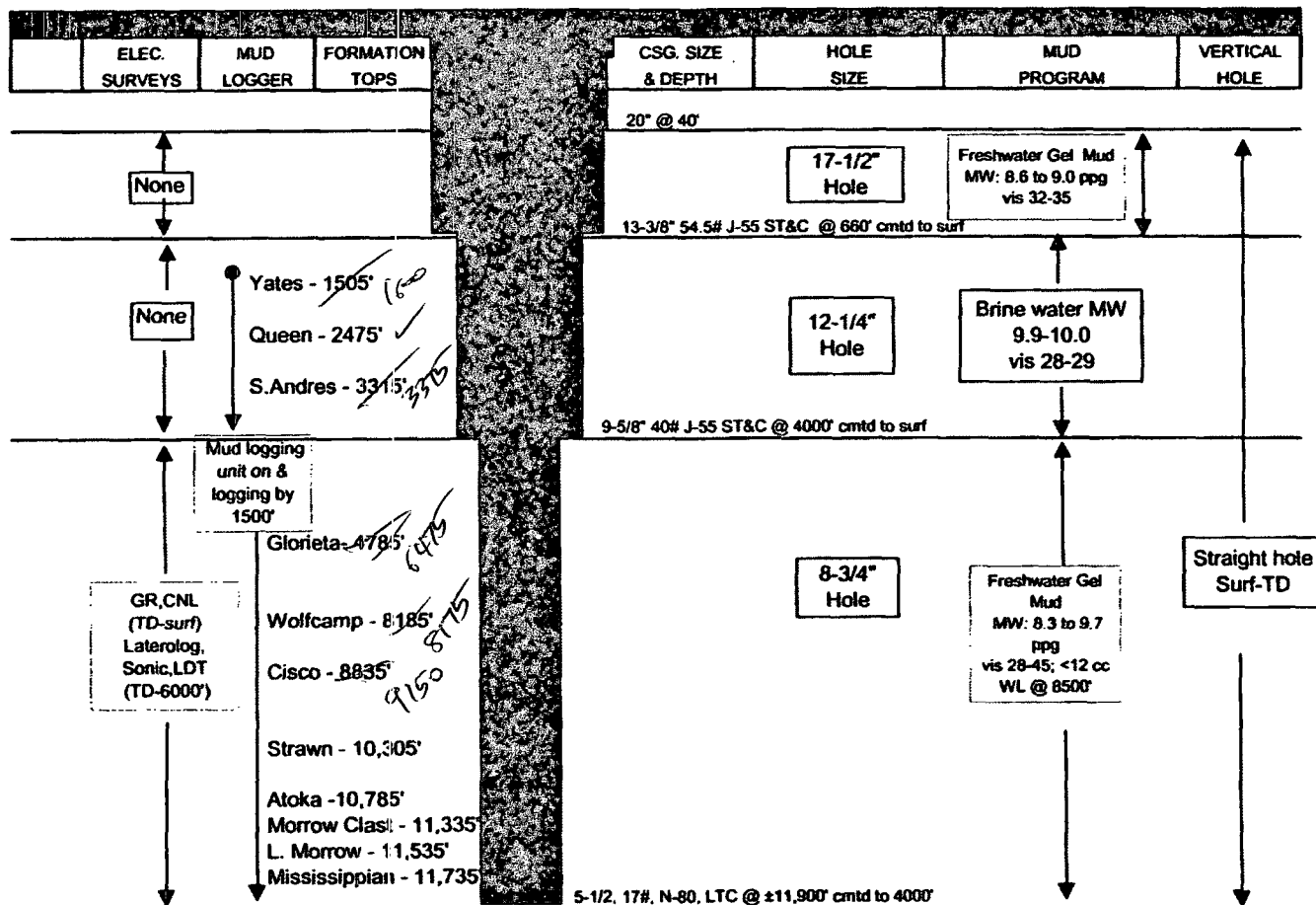

UNITED STATES
DEPARTMENT OF THE INTERIOR
BUREAU OF LAND MANAGEMENT

OIL CONSERVATION DIV
811 S. 1st St.
ARTESIA, NM 88210-2834

FORM APPROVED
OMB NO. 1004-0136
Expires: February 28, 1995

APPLICATION FOR PERMIT TO DRILL OR DEEPEN

13. TYPE OF WORK

DRILL ☒

DEEPEN ☐

14. TYPE OF WELL

OIL
WELL ☐

GAS
WELL ☒

OTHER ☐

SINGLE
ZONE ☒

MULTIPLE
ZONE ☐

2. NAME OF OPERATOR

Naumann Oil & Gas, Inc.

3. ADDRESS AND TELEPHONE NO.

P. O. Box 10159, Midland, Texas 79702

4. LOCATION OF WELL (Report location clearly and in accordance with BLM Form 3160-1)

At surface
1650' FSL & 2100' FWL

At proposed prod. zone

1650' FSL & 2100' FWL

14. DISTANCE IN MILES AND DIRECTION FROM NEAREST TOWN OR POST OFFICE

23 miles west to Artesia, NM

15. DISTANCE FROM PROPOSED

LOCATION TO NEAREST

PROPERTY OR LEASE LINE, FT.

(Also to nearest drlg. unit lds. if any)

990

330

16. DISTANCE FROM PROPOSED LOCATION

TO NEAREST WELL, DRILLING, COMPLETED,

OR APPLIED FOR, ON THIS LEASE, FT.

None

18. NO. OF ACRES IN LEASE

320

19. PROPOSED DEPTH

11,800

17. NO. OF ACRES ASSIGNED

TO THIS WELL

320

20. ROTARY OR CABLE TOOLS

Rotary

21. ELEVATIONS (Show whether DF, RT, GR, etc.)

3588' GR

22. APPROX. DATE WORK WILL START

September 15, 1996

23. PROPOSED CASING AND CEMENTING PROGRAM

SIZE OF HOLE	GRADE SIZE OF CASING	WEIGHT PER FOOT	SETTING DEPTH	QUANTITY OF CEMENT
14-3/4	11-3/4 ST&C	42	650	250 sx Circulated
11	8-5/8 LT&C	32	4000	1100 sx Circulated
7-7/8	5-1/2 LT&C	17	11800	735 sx Est TOC 7500'

The Undersigned accepts all applicable terms, conditions, stipulations, and restrictions concerning operations conducted on leased land or portions thereof as shown below:

NM 0558579

Sec 33, T17S, R30E

Federal Bond # is MT 0748 with endorsement to New Mexico

Approved: [Signature]
Special Agent in Charge
Bureau of Land Management
U.S. Department of the Interior
Washed DC

IN ABOVE SPACE DESCRIBE PROPOSED PROGRAM: If proposal is to deepen, give data on present productive zone and proposed new productive zone. If proposal is to drill or deepen directionally, give pertinent data on subsurface locations and measured and true vertical depths. Give blowout preventer program, if any.

24.

SIGNED

[Signature]

TITLE

President

DATE

8-22-96

(This space for Federal or State office use)

PERMIT NO.

APPROVAL DATE

Application approval does not warrant or certify that the applicant holds legal or equitable title to those rights in the subject lease which would entitle the applicant to conduct operations thereon.
CONDITIONS OF APPROVAL, IF ANY:

Timothy P. O'Brien

APPROVED BY

TITLE

Acting Director

DATE

SEP 25 1996

*See Instructions On Reverse Side

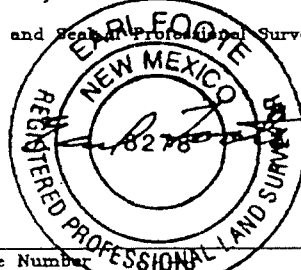
<div data-bbox="66 1006 315 1263" data-label="Text"><p>16</p></div>		<div data-bbox="1049 1006 1536 1263" data-label="Text"><p>17 OPERATOR CERTIFICATION</p><p>I hereby certify that the information contained herein is true and complete to the best of my knowledge and belief.</p></div>
		<div data-bbox="1049 1263 1536 1504" data-label="Text"><p><i>[Signature]</i> Signature <i>N. Jack Naumann, Jr.</i> Printed Name <i>President</i> Title <i>8-22-96</i> Date</p></div>
<div data-bbox="66 1504 315 1991" data-label="Text"><p>2100'</p></div>	<div data-bbox="315 1504 1049 1991" data-label="Text"><p>X = 609126 Y = 650614</p><p>1650'</p></div>	<div data-bbox="1049 1504 1536 1991" data-label="Text"><p>18 SURVEYOR CERTIFICATION</p><p>I hereby certify that the well location shown on this plat was plotted from field notes of actual surveys made by me or under my supervision, and that the same is true and correct to best of my belief.</p><p>AUG. 8, 1996</p><p>Date of Survey</p><p>Signature and Seal of Professional Surveyor:</p><div data-bbox="1161 1711 1461 1980"></div><p>Certificate Number <i>8278</i></p></div>

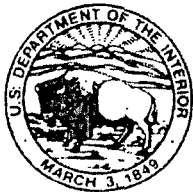

United States Department of the Interior

BUREAU OF LAND MANAGEMENT

Roswell District Office
2909 West Second Street
Roswell, New Mexico 88202

IN REPLY REFER TO
3162.4
NM-0558579

APR 18 1998

30-015-29/E6

Naumann Oil & Gas, Inc.
P. O. Box 10159
Midland, TX 79702

Gentlemen:

Your Application for Permit to Drill (APD), approved September 25, 1996, for the Sand Tank 33 Fed Com Well #1 located 1650'S & 2100'W, Section 33, T. 17 S., R. 30 E. Eddy County, New Mexico, Lease No. NM-0558579, has expired because drilling has not commenced within one year of the approval date as stated in the General Requirements for Oil and Gas Operations on Federal Leases.

If drilling operations have commenced on the referenced well, please contact this office at (505) 627-0272 and send all necessary reports (spud, casing/cementing, etc., 1 original and 5 copies) so we may correct our records.

If the well has not been spudded, but site construction activities have occurred, please contact this office at the above telephone number for surface reclamation instructions.

If you wish to drill this well at a later date, please submit a complete application (1 original and 6 copies). Since the original APD has expired, the resubmitted APD will be subject to all the processing requirements including the 30-day posting requirement. Please note on the resubmitted APD that it was previously approved and we will review the expired file for information which will help expedite the processing.

Sincerely,

(C/REG. SEC.) ARMANDO A. LOPEZ

Armando A. Lopez
Acting Assistant District Manager,
Mineral Support Team

Post ID-2
1-22-99
Exp FNL

cc: BLM-I&E (CRA)
NMOCD (Artesia)
CRA (L Denniston)

RECEIVED
OCD - ARTESIA

Form 3160-3
(August 1999)

UNITED STATES
DEPARTMENT OF THE INTERIOR
BUREAU OF LAND MANAGEMENT

N. M. Oil and Gas Division

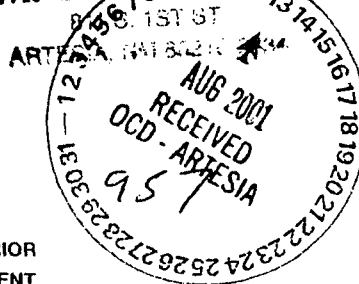

FORM APPROVED
OMB No. 1004-0136
Expires November 30, 2000

APPLICATION FOR PERMIT TO DRILL OR REENTER

1a. Type of Work: <input checked="" type="checkbox"/> DRILL <input type="checkbox"/> REENTER		5. Lease Serial No. NM0555581 LC028936-D (drill site) NM0467934	
1b. Type of Well: <input type="checkbox"/> Oil Well <input type="checkbox"/> Gas Well <input checked="" type="checkbox"/> Other <input type="checkbox"/> Single Zone <input type="checkbox"/> Multiple Zone		6. If Indian, Allottee or Tribe Name	
2. Name of Operator EOG Resources, Inc. 7377		7. If Unit or CA Agreement, Name and No. 20357	
3a. Address P.O. Box 2267, Midland, TX 79702		8. Lease Name and Well No. SAND TANK "33" FED. COM NO. 1	
3b. Phone No. (include area code) 915 686-3689		9. API Well No. 30-015-31959	
4. Location of Well (Report location clearly and in accordance with any State requirements.) At surface 860 FSL & 1750 FEL (UNIT O) At proposed prod. Zone Same as surface		10. Field and Pool, or Exploratory SAND TANK	
14. Distance in miles and direction from nearest town or post office* 2.5 MILES SOUTH FROM LOCO HILLS		11. Sec., T., R., M., or Blk. And Survey or Area SEC. 33 T-17S R30E	
15. Distance from proposed* location to nearest property or lease line, ft. 860' (Also to nearest drlg. Unit line, if any) same	16. No. of Acres in lease 835.32	17. Spacing Unit dedicated to this well E/2	
18. Distance from proposed location* to nearest well, drilling, completed applied for, on this lease, ft.	19. Proposed Depth 12,100	20. BLM/BIA Bond No. on file NM2308	
21. Elevations (Show whether DF, KDB, RT, GL, etc) GL 3582	22. Approximate date work will start* 8/1/2001	23. Estimated duration 30 days	
24. Attachments			

The following completed in accordance with the requirements of Onshore Oil and Gas Order No. 1, shall be attached to this form:

- | | |
|--|--|
| 1. Well plat certified by a registered surveyor. | 4. Bond to cover the operations unless covered by an existing bond on file (see Item 20 above) |
| 2. A Drilling Plan. | 5. Operator certification. |
| 3. A Surface Use Plan (if the location is on National Forest System Lands, the SUPO shall be filed with the appropriate Forest Service Office) | 6. Such other site specific information and/or plans as may be required by the authorized officer. |

25. Signature 	Name (Printed/Typed) Bev Hatfield	Date 6/22/2001
Title Agent		
Approved by (Signature) /s/ JOE G. LARA	Name (Printed/Typed) /s/ JOE G. LARA	Date AUG 10 2001
Title Acting FIELD MANAGER		
Office CARLSBAD FIELD OFFICE		

Application approval does not warrant or certify the applicant holds legal or equitable title to those rights in the subject lease which would entitle the applicant to conduct operations thereon.

Conditions of approval, if any, are attached

Title 18 U.S.C. Section 1001 and Title 43 U.S.C. Section 1212, make it a crime for any person knowingly and willfully to make to any department or agency of the United States any false, fictitious or fraudulent statements or representations as to any matter within its jurisdiction.

*(Instructions on reverse)

**APPROVAL SUBJECT TO
GENERAL REQUIREMENTS AND
SPECIAL STIPULATIONS
ATTACHED**

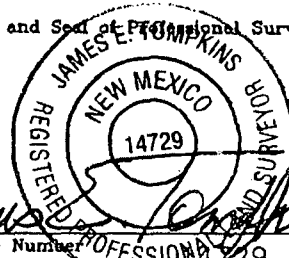
16						17 OPERATOR CERTIFICATION <i>I hereby certify that the information contained herein is true and complete to the best of my knowledge and belief.</i> <u>Dev Hatfield</u> Signature <u>Dev Hatfield</u> Printed Name <u>Sr. Regulatory Admin.</u> Title <u>6-22-01</u> Date
						18 SURVEYOR CERTIFICATION <i>I hereby certify that the well location shown on this plat was plotted from field notes of actual surveys made by me or under my supervision, and that the same is true and correct to best of my belief.</i> <u>MAY 18, 2001</u> Date of Survey Signature and Seal of Professional Surveyor:  Certificate Number <u>14729</u>

EOG RESOURCES, INC.
SAND TANK "33" FED. COM No. 1
ELEV.=3582'
Y=649838.527
X=610571.839
LAT.=32°47'09.53"
LONG.=103°58'24.75"

860'

1750'

DRILLING PROGRAM

EOG RESOURCES, INC.
SAND TANK "33" FED. COM. NO. 1
860' FSL & 1,750' FEL
SEC. 33, T17S, R30E
EDDY COUNTY, NM

1. GEOLOGIC NAME OF SURFACE FORMATION:

Permian

2. ESTIMATED TOPS OF IMPORTANT GEOLOGICAL MARKERS:

Rustler	500'
San Andres	3400' ³³⁷⁵
Wolfcamp	8200' ⁸¹⁷⁵ <i>C150 @ 9,150'</i>
Lower Strawn	10375'
Morrow Clastics	11200'
TD	12100'

3. ESTIMATED DEPTHS OF ANTICIPATED FRESH WATER, OIL OR GAS:

Upper Permian Sands	Above 250'	Fresh Water
Grayburg/San Andres	3000'	Oil
Strawn	10375'	Oil
Morrow	11100'	Gas

4. CASING PROGRAM

Hole Size	Interval	OD Casing	Weight Grade Jt. Cond. Type
14 3/4"	0-500'	11 3/4"	42# H-40 ST&C
11"	0-4000'	8 5/8"	32# J-55 LT&C
7 7/8"	0-11,900'	5 1/2"	17# N80/S95 L&TC

Cementing Program:

11 3/4" Surface Casing: Cement to surface with 200 sx Prem Plus, 3% Econolite, 25 Calcium Chloride, 0.25#/sx Flocele, 150 sx Prem Plus, 2% Calcium Chloride

8 5/8" Intermediate: Cement to surface with 800 sx Interfill C, .25#/sx flocele, 250 sx Premium Plus, 2% Calcium Chloride

5 1/2" Production: Cement w/930 sx Premium, 3% Econolite, 5#/sx Salt (3%), 0.2% HR5, .25#/sk Flocele, 250 sx Prem 50/50 Poz mix 'A', 2% Halliburton-Gel First 2%, 0.5% Halad-322. This is designed to bring TOC to 4500'.

5. MINIMUM SPECIFICATIONS FOR PRESSURE CONTROL:

(SEE EXHIBIT #1)

DRILLING PROGRAM

EOG RESOURCES, INC.
SAND TANK "33" FED. COM. NO. 1
860' FSL & 1,750' FEL
SEC. 33, T17S, R30E
EDDY COUNTY, NM

The blowout preventer equipment (BOP) shown in Exhibit #1 will consist of a double ram-type (5000 psi WP) preventer and an annular preventer (5000-psi WP). Units will be hydraulically operated and the ram-type will be equipped with blind rams on top and drill pipe rams on bottom. All BOP's and accessory equipment will be tested in accordance with Onshore Oil & Gas order No. 2. EOG request authorization to use a 2M system, providing for an annular preventer to be used prior to drilling the surface casing shoe before drilling out of surface casing. Before drilling out of 1st intermediate casing, the ram-type BOP and accessory equipment will be tested to 5000/1000 psi and the annular to 3500/5000-psig pressure.

Pipe rams will be operationally checked each 24-hour period. Blind rams will be operationally checked on each trip out of the hole. These checks will be noted on the daily tour sheets.

6. TYPES AND CHARACTERISTICS OF THE PROPOSED MUD SYSTEM:

The well will be drilled to TD with a combination of brine, cut brine, and polymer/KCL mud system. The applicable depths and properties of this system are as follows:

<u>Depth</u>	<u>Type</u>	<u>Wt (PPG)</u>	<u>Viscosity (sec)</u>	<u>Waterloss (cc)</u>
0-500'	Fresh Water	8.5	40-45	N.C.
500'-4000'	Brine Water	10.0	30	N.C.
4000'- TD	Cut Brine + Polymer/KCL	8.8 - 9.2	32	10

Sufficient mud materials to maintain mud properties and meet minimum lost circulation and weight increase requirements will be kept at the wellsite at all times.

7. AUXILIARY WELL CONTROL AND MONITORING EQUIPMENT:

- (A) A kelly cock will be kept in the drill string at all times.
- (B) A full opening drill pipe-stabbing valve (inside BOP) with proper drill pipe connections will be on the rig floor at all times.
- (C) A mud logging unit complete with H₂S detector will be continuously monitoring drilling penetration rate and hydrocarbon shows from 5000' to TD.

DRILLING PROGRAM

**EOG RESOURCES, INC.
SAND TANK "33" FED. COM. NO. 1
860' FSL & 1,750' FEL
SEC. 33, T17S, R30E
EDDY COUNTY, NM**

8. LOGGING, TESTING AND CORING PROGRAM:

Electric logging will consist of GR-Dual Induction Focused and GR-Compensated Density-Neutron from TD to intermediate casing with a GR-Compensated Neutron run from intermediate casing to surface and optional Sonic from TD to Intermediate casing.

Possible sidewall cores based on shows.

9. ABNORMAL CONDITIONS, PRESSURES, TEMPERATURES AND POTENTIAL HAZARDS:

The estimated bottom hole temperature (BHT) at TD is 175 degrees F with an estimated maximum bottom-hole pressure (BHP) at TD of 5000 psig. No hydrogen sulfide or other hazardous gases or fluids have been encountered, reported or are known to exist at this depth in this area. No major loss circulation zones have been reported in offsetting wells.

10. ANTICIPATED STARTING DATE AND DURATION OF OPERATIONS:

The drilling operation should be finished in approximately one month. If the well is productive, an additional 30-60 days will be required for completion and testing before a decision is made to install permanent facilities.

DRILLING PROGRAM

**EOG RESOURCES, INC.
SAND TANK "33" FED. COM. NO. 1
860' FSL & 1,750' FEL
SEC. 33, T17S, R30E
EDDY COUNTY, NM**

SURFACE USE AND OPERATIONS PLAN

1. EXISTING ROADS:

Access to location will be made as shown on Exhibit #2

Routine grading and maintenance of existing roads will be conducted as necessary to maintain their condition as long as any operations continue on this lease.

2. PROPOSED ACCESS ROAD:

2,360.6' of new road is required. Exhibit #2A(1) 2 A(2)

No turnouts necessary.

No culverts, cattleguards, gates, low-water crossings are necessary.

Surfacing material consists of native caliche to be obtained from the nearest BLM-approved caliche pit. Any additional materials required will be purchased from the dirt contractor.

3. LOCATION OF EXISTING WELLS:

Exhibit #3 shows all existing wells within a one-mile radius of this well.

4. LOCATION OF EXISTING AND/OR PROPOSED FACILITIES:

There are no existing production facilities. If production is encountered, a temporary facility will be established on the drill pad, and if warranted, a production facility would be built at a later date in the immediate area of the drill pad location. If the well is productive, the flowline would also be located on the drill-pad site and no additional disturbance will occur.

5. LOCATION AND TYPE OF WATER SUPPLY:

Fresh water and brine water for drilling will come from commercial sources and transported to the well site over the roads as shown on Exhibit #2.

DRILLING PROGRAM

**EOG RESOURCES, INC.
SAND TANK "33" FED. COM. NO. 1
860' FSL & 1,750' FEL
SEC. 33, T17S, R30E
EDDY COUNTY, NM**

6. PLANS FOR RESTORATION OF THE SURFACE:

After completion of drilling and/or completion operations, all equipment and other material not needed for operations will be removed. Location will be cleaned of all trash and junk to leave the well in an aesthetically pleasing condition as possible.

Any unguarded pits containing fluid will be fenced until they are dry and back filled.

After abandonment of the well, surface restoration will be in accordance with current federal laws and regulations. Location will be cleaned, and the wellpad removed to promote vegetation and disposal of human waste will be complied with. Trash, waste paper, garbage and junk will be hauled to an approved disposal site in an enclosed trash trailer.

All trash and debris will be removed from the well site within 30 days after finishing drilling and/or completion operations.

ANCILLARY FACILITIES:

No airstrip, campsite, or other facilities will be built.

WELL SITE LAYOUT:

Exhibit #4 shows the relative location and dimensions of the well pad.

DRILLING PROGRAM

**EOG RESOURCES, INC.
SAND TANK "33" FED. COM. NO. 1
860' FSL & 1,750' FEL
SEC. 33, T17S, R30E
EDDY COUNTY, NM**

OTHER INFORMATION:

The area around the well site is grassland and the topsoil is duned and sandy. The vegetation is native scrub grasses with abundant oakbrush, sagebrush, yucca, and prickly pear.

CERTIFICATION:

I HEREBY CERTIFY that I, or persons under my direct supervision, have inspected the proposed drill site and access route; that I am familiar with the conditions which presently exist; that the statements made in this plan are, to the best of my knowledge, true and correct; and that the work associated with the operations proposed herein will be performed by EOG Resources, Inc. and its contractors and sub-contractors in conformity with this plan and the terms and conditions under which it is approved.

Gary West.
Drilling Superintendent



Date: 06/22/01

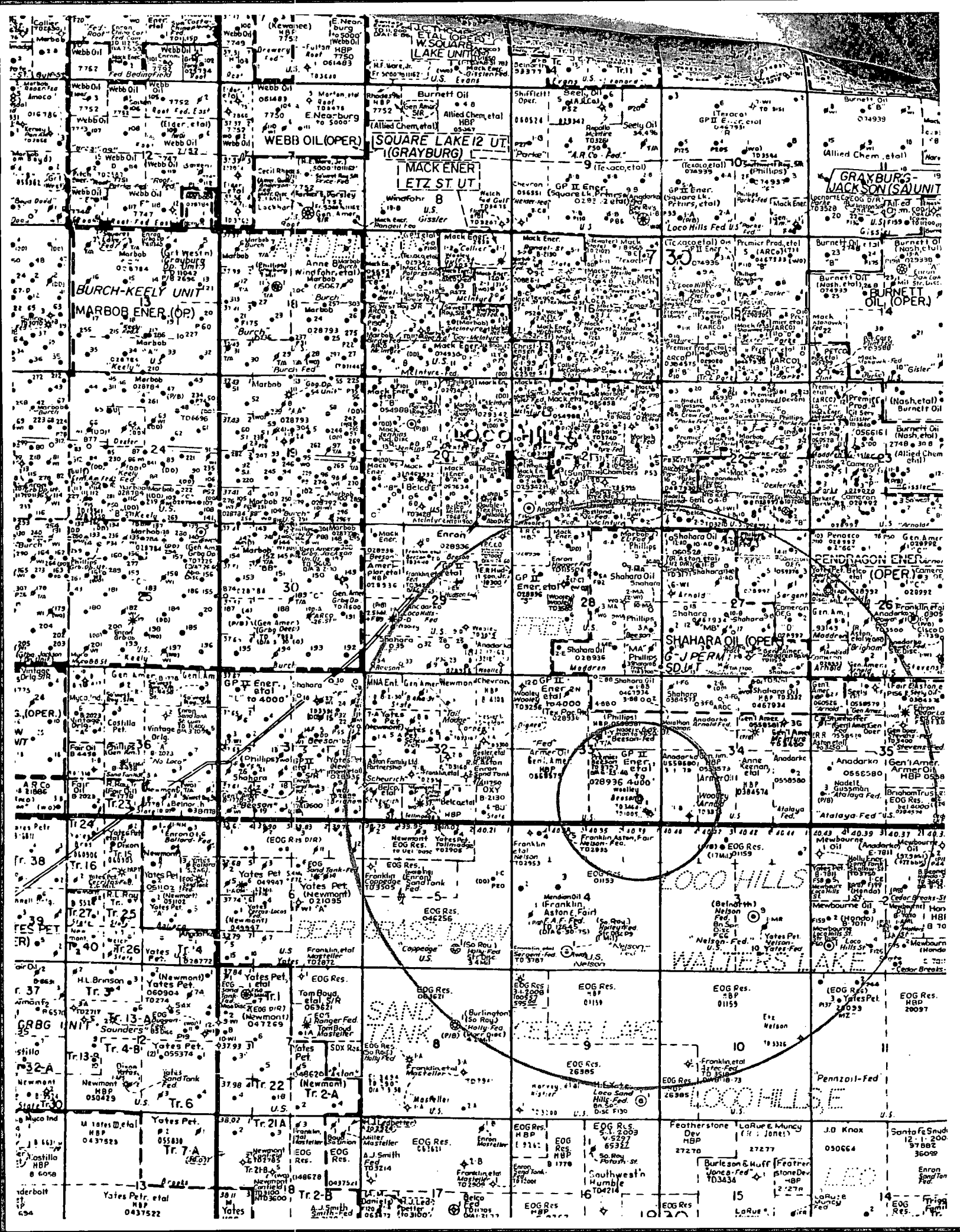

Disposal Well

API #	PROPERTY NAME	#	OPERATOR	TD	TYPE	STATE	CO	LAND	U/L	SEC	TWN	RNG	N/S	E/W
	Loco Hills SWD 33	4	COG OPERATING LLC	9700'	SWD	NM	EDDY	Fed		33	17S	30E	840'S	660'W

Wells within 1/2 mile which do not penetrate proposed disposal interval

API #	PROPERTY NAME	#	OPERATOR	TD	TYPE	STATE	CO	LAND	U/L	SEC	TWN	RNG	N/S	E/W
30-015-04444	Pre-Ongard Well	1	Pre-Ongard Well Operator	3,797'	Oil	NM	Eddy	Fed	G	33	17S	30E	2,310'N	2,310'E
30-015-25764	Beeson Fed.	1Y	Nadel & Gussman Permian, LLC	3,650'	Oil	NM	Eddy	Fed	G	33	17S	30E	2,160'N	2,160'E
30-015-04448	Pre-Ongard Well	11	Pre-Ongard Well Operator	3,700'	Oil	NM	Eddy	Fed	M	34	17S	30E	330'S	990'W
30-015-21646	Pre-Ongard Well	5	Pre-Ongard Well Operator	3,500'	Oil	NM	Eddy	Fed	C	4	18S	30E	330'N	1,980'W

Wells within 1/2 mile which penetrate proposed disposal interval

API #	PROPERTY NAME	#	OPERATOR	TD	TYPE	STATE	CO	LAND	U/L	SEC	TWN	RNG	N/S	E/W
30-015-31995	Big Tank 33 Fed	1	Southwestern Energy Production Co.	11,900'	Gas	NM	Eddy	Fed	J	33	17S	30E	1,980'S	1,380'E
30-015-29186	Sand Tank 33 Fed Com	1	Naumann Oil & Gas Inc.	11,800'	Gas	NM	Eddy	Fed	K	33	17S	30E	1,650'S	2,100'W
30-015-31959	Sand Tank 33 Fed Com	1	EOG Resources	12,800'	Gas	NM	Eddy	Fed	O	33	17S	30E	860'S	1,750'E

Handwritten signature and initials:
 [Signature]
 [Initials]

Jones, William V., EMNRD

From: Jones, William V., EMNRD
Sent: Wednesday, March 18, 2009 1:14 PM
To: Mark Fairchild
Cc: Ezeanyim, Richard, EMNRD; Reeves, Jacqueta, EMNRD; 'Wesley_Ingram@blm.gov'
Subject: Disposal Application from COG: Proposed Loco Hills SWD 4-33 Unit P, Sec 33, T30E, R30E, Eddy County

Hello Mark:

After evaluating your application:

- ✓ 1) Please do a field check to ensure there are no windmills or other wells within 1 mile of this well. If so, send a water analysis.
- ✓ 2) Please send a copy of the actual Newspaper Notice as posted in the paper.
- ✓ 3) Ask your geologist to pick formation tops from the top of the Wolfcamp through the tops in the Pennsylvanian. The tops shown in the application are not consistent with each other – especially the Cisco.
- only 4) Is the intended injection interval down into the Cisco? The application was not totally clear and some places contradictory as to whether ONLY the Wolfcamp is targeted for injection. Why is the casing to be set to 9750 feet when injection is only intended down to 8950 feet? Are you testing the upper Penn here with this well?
- 5) Please address the productivity of the Cisco in this area and whether it is Oil or Gas. Where is the nearest production? What are the results of tests in the Cisco (see the Big Tank 33 Fed #1)?
- 6) This is a new proposed federal well. Please plan on mudlogging the well and running open hole logs and sending copies of both of these (over the injection interval) to the Division.
- 7) What is the status of your APD with the Feds? We like to have an API number if possible, but can add it later to our records if we have to.
- 8) Let us know asap if the footage location of the well changes.

Please reply to these questions with answers or an estimate of when you can answer – by next Friday, March 27.

Thanks for this,

William V. Jones PE
New Mexico Oil Conservation Division
1220 South St. Francis
Santa Fe, NM 87505
505-476-3448

Jones, William V., EMNRD

From: Jones, William V., EMNRD
Sent: Tuesday, March 31, 2009 3:49 PM
To: 'Mark Fairchild'
Cc: Ezeanyim, Richard, EMNRD; Kautz, Paul, EMNRD
Subject: RE: Disposal applications from COG into the Wolfcamp Reef near Maljamar, Five Proposed New Wells
Attachments: KeenanProtestofCOGApplication.tif

Mark:

Per our conversation earlier today, here attached is the letter of protest for two of your five recent applications for disposal wells.

Loco Hills 34 SWD Well No. 3

Loco Hills 35 SWD Well No. 2

This letter was attached from an email from: Ms. Joyce Yamagiwa Joyce@keenaland.com

If you think the protests will take long to resolve, you have the option of having your attorney file cases for examiner hearing. These cases could be dismissed if you reach settlement. Pending a retraction letter from Ms. Yamagiwa, we cannot proceed to evaluate these two applications.

Understand due to the AOR problems, you are looking to move the proposed Skelly SWD 28 #1 to an alternate location and will be re-submitting a new C-108 for the new location (with wellbore diagrams on all AOR wells).

Since all other concerns will be quickly addressed on the other two wells (Maljamar 29-1 and Loco Hills 33-4), we will keep these two applications on file. I will wait for the requested data (Newspaper Notice, etc) and the compilation of tops from your geologists before proceeding.

Regards,

William V. Jones PE
New Mexico Oil Conservation Division
1220 South St. Francis
Santa Fe, NM 87505
505-476-3448

From: Mark Fairchild [mailto:MFairchild@conchoresources.com]
Sent: Monday, March 30, 2009 12:37 PM
To: Jones, William V., EMNRD
Subject: Appointment to call

Will, need to make an appointment with you so my Geologist and I can call to discuss tops.

Thanks and G'ig'em

Mark A. Fairchild

Office: 432-686-3021
Cell: 432-230-7170

Affidavit of Publication

State of New Mexico,
County of Eddy, ss.

Kathy McCarroll, being first duly sworn,
on oath says:

That she is the Classified Supervisor of the
Carlsbad Current-Argus, a newspaper
published daily at the City of Carlsbad, in
said county of Eddy, state of New Mexico
and of general paid circulation in said county;
that the same is a duly qualified newspaper
under the laws of the State wherein legal
notices and advertisements may be
published; that the printed notice attached
hereto was published in the regular and
entire edition of said newspaper and not in
supplement thereof on the date as follows, to wit:

April 5 _____ 2009

That the cost of publication is **\$38.87** and that
payment thereof has been made and will be
assessed as court costs.

Kathy McCarroll

Subscribed and sworn to before me this

6th day of April, 2009

Stephanie Dobson

My commission Expires on 11/25/2010

Notary Public

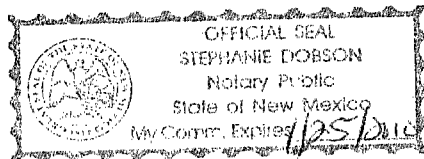

April 5, 2009
Legal Notice
March 30, 2009
COG Operating, LLC
is applying to drill the
Loco Hills SWD 4-33
as a water disposal
well. The Loco Hills
SWD 4-33 well is locat-
ed at 840' FSL & 660'
FWL, Sec. 33, T. 17 S.,
R. 30 E., Eddy County,
NM. The well will dis-
pose of water produced
from oil and gas wells
into the Wolfcamp zone
at a depth of 8525' to
8950' at a maximum
rate of 15,000 barrels of
water per day and of a
maximum pressure of
1,730 psi. Interested
parties must file objec-
tions or requests for
hearing with the NM Oil
Conservation Division,
1220 South Saint Francis
Dr., Santa Fe, NM
87505, within 15 days.
Additional information
can be obtained by con-
tacting Brian Wood, Per-
mits West, Inc., 37 Vera-
no Loop, Santa Fe, NM
87508, phone number is
(505) 466-8120.



VERITAS 321

ENERGY PARTNERS, LP

February 27, 2009

CERTIFIED MAIL
RETURN RECEIPT REQUESTED

Les Babyyak
BLM
320 East Greene St.
Carlsbad, NM 88220

RE: COG Operating, LLC.
Form C-108 (Application for Authorization to Inject)
Loco Hills SWD 4-33
840' FSL & 660' FWL, Section 33, T-17S, R-30E, N.M.P.M.,
Eddy Co., New Mexico

Dear Les:

Enclosed is a copy of Oil Conservation Division Form C-108 (Application for Authorization to Inject) for COG Operating, LLC Loco Hill 2-35 well. You are being provided a copy of the application as an offset operator, offset leaseholder or surface owner. COG Operating, LLC purposes to drill the subject well as a disposal well, injection to occur into the Wolfcamp formation through perforations from 8525'-8550'. This is a notice only. No action is needed unless you have questions or objections.

Objections must be filed with the Oil Conservation Division, 1220 South St. Francis Drive, Santa Fe, New Mexico 87505, within 15 days.

Thank you for your cooperation in this matter.

Sincerely,

Dye Orr
Consulting Landman
Ext. 110

7007 2560 0003 3681 8464

U.S. Postal Service™	
CERTIFIED MAIL™ RECEIPT	
(Domestic Mail Only; No Insurance Coverage Provided)	
For delivery information visit our website at www.usps.com	
OFFICIAL USE	
Postage	\$.57
Certified Fee	2.20
Return Receipt Fee (Endorsement Required)	2.20
Restricted Delivery Fee (Endorsement Required)	
Total Postage & Fees	\$ 5.49
Sent To	
BLM	
Street, Apt. No., or PO Box No.	
320 E. Greene St.	
City, State, ZIP+4	
Carlsbad, NM 88220	

Postmark Here

See Reverse for Instructions



VERITAS 321

ENERGY PARTNERS, LP

February 27, 2009

CERTIFIED MAIL
RETURN RECEIPT REQUESTED

EOG Resources, Inc.
P.O. Box 2267
Midland, TX 79702

RE: COG Operating, LLC.
Form C-108 (Application for Authorization to Inject)
Loco Hills SWD 4-33
840' FSL & 660' FWL, Section 33, T-17S, R-30E, N.M.P.M.,
Eddy Co., New Mexico

EOG Resources, Inc:

Enclosed is a copy of Oil Conservation Division Form C-108 (Application for Authorization to Inject) for COG Operating, LLC Loco Hill 4-33 well. You are being provided a copy of the application as an offset operator, offset leaseholder or surface owner. COG Operating, LLC purposes to drill the subject well as a disposal well, injection to occur into the Wolfcamp formation through perforations from 8525'-8950'.

Objections must be filed with the Oil Conservation Division, 1220 South St. Francis Drive, Santa Fe, New Mexico 87505, within 15 days.

Thank you for your cooperation in this matter.

Sincerely,

Tye Orr
Consulting Landman
Ext. 110

7002 0952 E000 2993 E090

U.S. Postal Service™	
CERTIFIED MAIL™ RECEIPT	
(Domestic Mail Only; No Insurance Coverage Provided)	
For delivery information visit our website at www.usps.com	
OFFICIAL USE	
Postage	\$.59
Certified Fee	2.00
Return Receipt Fee (Endorsement Required)	2.00
Restricted Delivery Fee (Endorsement Required)	
Total Postage & Fees	\$ 5.49
Postmark Here	
Sent To EOG Resources, Inc	
Street, Apt. No. or PO Box No. P.O. Box 2267	
City, State, ZIP+4 Midland, TX 79702	
PS Form 3800, August 2006 See Reverse for Instructions	



VERITAS 321
ENERGY PARTNERS, LP

February 27, 2009

CERTIFIED MAIL
RETURN RECEIPT REQUESTED

Lerwick I, Ltd.
508 W. Wall, Ste. 1250
Midland, TX 79702

RE: COG Operating, LLC.
Form C-108 (Application for Authorization to Inject)
Loco Hills SWD 4-33
840' FSL & 660' FWL, Section 33, T-17S, R-30E, N.M.P.M.,
Eddy Co., New Mexico

Lerwick I, Ltd:

Enclosed is a copy of Oil Conservation Division Form C-108 (Application for Authorization to Inject) for COG Operating, LLC Loco Hill 4-33 well. You are being provided a copy of the application as an offset operator, offset leaseholder or surface owner. COG Operating, LLC purposes to drill the subject well as a disposal well, injection to occur into the Wolfcamp formation through perforations from 8525'-8950'.

Objections must be filed with the Oil Conservation Division, 1220 South St. Francis Drive, Santa Fe, New Mexico 87505, within 15 days.

Thank you for your cooperation in this matter.

Sincerely,

Tye Orr
Consulting Landman
Ext. 110

U.S. Postal Service™	
CERTIFIED MAIL™ RECEIPT	
(Domestic Mail Only; No Insurance Coverage Provided)	
For delivery information visit our website at www.usps.com	
OFFICIAL USE	
Postage	\$.59
Certified Fee	2.00
Return Receipt Fee (Endorsement Required)	2.20
Restricted Delivery Fee (Endorsement Required)	
Total Postage & Fees	\$ 5.49
Postmark Here	
Sent To	
Lerwick I Ltd	
Street, Apt. No., or PO Box No. 508 W. Wall, Ste 1250	
City, State, ZIP+4	
Midland, TX 79702	
PS Form 3800, August 2006	
See Reverse for Instructions	

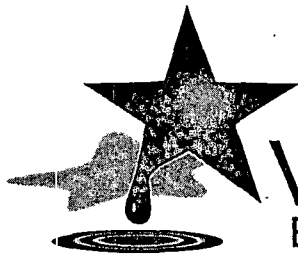

VERITAS 321

ENERGY PARTNERS, LP

February 27, 2009

CERTIFIED MAIL
RETURN RECEIPT REQUESTED

Rialto Production Company
P.O. Box 61206
Houston, TX 77208

RE: COG Operating, LLC.
Form C-108 (Application for Authorization to Inject)
Loco Hills SWD 4-33
840' FSL & 660' FWL, Section 33, T-17S, R-30E, N.M.P.M.,
Eddy Co., New Mexico

Rialto Production Company:

Enclosed is a copy of Oil Conservation Division Form C-108 (Application for Authorization to Inject) for COG Operating, LLC Loco Hill 4-33 well. You are being provided a copy of the application as an offset operator, offset leaseholder or surface owner. COG Operating, LLC purposes to drill the subject well as a disposal well, injection to occur into the Wolfcamp formation through perforations from 8525'-8950'.

Objections must be filed with the Oil Conservation Division, 1220 South St. Francis Drive, Santa Fe, New Mexico 87505, within 15 days.

Thank you for your cooperation in this matter.

Sincerely,

Tye Orr
Consulting Landman
Ext. 110

U.S. Postal Service™ CERTIFIED MAIL™ RECEIPT (Domestic Mail Only; No Insurance Coverage Provided)	
For delivery information visit our website at www.usps.com	
OFFICIAL USE	
Postage	\$.59
Certified Fee	2.70
Return Receipt Fee (Endorsement Required)	2.20
Restricted Delivery Fee (Endorsement Required)	
Total Postage & Fees	\$ 5.49
Postmark Here	
Sent To Rialto Production Company Street, Apt. No., or PO Box No. P.O. Box 61206 City, State, ZIP+4 Houston, TX 77208	
PS Form 3800, August 2006 See Reverse for Instructions	



VERITAS 321
ENERGY PARTNERS, LP

February 27, 2009

CERTIFIED MAIL
RETURN RECEIPT REQUESTED

Read & Stevens Inc.
P.O. Box 1518
Roswell, NM 88202

RE: COG Operating, LLC.
Form C-108 (Application for Authorization to Inject)
Loco Hills SWD 4-33
840' FSL & 660' FWL, Section 33, T-17S, R-30E, N.M.P.M.,
Eddy Co., New Mexico

Read & Stevens Inc:

Enclosed is a copy of Oil Conservation Division Form C-108 (Application for Authorization to Inject) for COG Operating, LLC Loco Hill 4-33 well. You are being provided a copy of the application as an offset operator, offset leaseholder or surface owner. COG Operating, LLC purposes to drill the subject well as a disposal well, injection to occur into the Wolfcamp formation through perforations from 8525'-8950'.

Objections must be filed with the Oil Conservation Division, 1220 South St. Francis Drive, Santa Fe, New Mexico 87505, within 15 days.

Thank you for your cooperation in this matter.

Sincerely,

Tye Orr
Consulting Landman
Ext. 110

U.S. Postal Service™	
CERTIFIED MAIL™ RECEIPT	
(Domestic Mail Only; No Insurance Coverage Provided)	
For delivery information visit our website at www.usps.com	
OFFICIAL USE	
Postage	\$.59
Certified Fee	2.70
Return Receipt Fee (Endorsement Required)	2.20
Restricted Delivery Fee (Endorsement Required)	
Total Postage & Fees	\$ 5.49
Postmark Here	
Sent To	
Read & Stevens Inc.	
Street, Apt. No., or PO Box No.	
P.O. Box 1518	
City, State, ZIP+4	
Roswell, NM 88202	
PS Form 3800, August 2006	
See Reverse for Instructions	

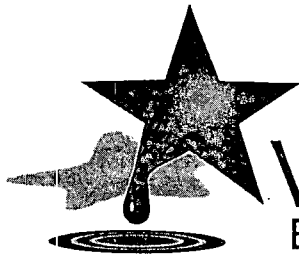

VERITAS 321
ENERGY PARTNERS, LP

February 27, 2009

CERTIFIED MAIL
RETURN RECEIPT REQUESTED

Paula Dooley, Personal Representative
Estate of William Patrick Dooley
1006 South 2nd Street

RE: COG Operating, LLC.
Form C-108 (Application for Authorization to Inject)
Loco Hills SWD 4-33
840' FSL & 660' FWL, Section 33, T-17S, R-30E, N.M.P.M.,
Eddy Co., New Mexico

Paula Dooley, Personal Representative Estate of William Patrick Dooley:

Enclosed is a copy of Oil Conservation Division Form C-108 (Application for Authorization to Inject) for COG Operating, LLC Loco Hill 4-33 well. You are being provided a copy of the application as an offset operator, offset leaseholder or surface owner. COG Operating, LLC purposes to drill the subject well as a disposal well, injection to occur into the Wolfcamp formation through perforations from 8525'-8950'.

Objections must be filed with the Oil Conservation Division, 1220 South St. Francis Drive, Santa Fe, New Mexico 87505, within 15 days.

Thank you for your cooperation in this matter.

Sincerely,

Tye Orr
Consulting Landman
Ext. 110

U.S. Postal Service™ CERTIFIED MAIL™ RECEIPT (Domestic Mail Only; No Insurance Coverage Provided)	
For delivery information visit our website at www.usps.com	
OFFICIAL USE	
Postage	\$.59
Certified Fee	2.70
Return Receipt Fee (Endorsement Required)	2.20
Restricted Delivery Fee (Endorsement Required)	
Total Postage & Fees	\$ 5.49
Sent To Paula Dooley	
Street, Apt. No., or PO Box No. 1006 South 2nd Street	
City, State, ZIP+4 Artesia, NM 88-210	
PS Form 3800, August 2006 See Reverse for Instructions	

7007 2560 0003 3682 0641



VERITAS 321
ENERGY PARTNERS, LP

February 27, 2009

CERTIFIED MAIL
RETURN RECEIPT REQUESTED

Paul Slayton
P.O. Box 2035
Roswell, NM 88210

RE: COG Operating, LLC.
Form C-108 (Application for Authorization to Inject)
Loco Hills SWD 4-33
840' FSL & 660' FWL, Section 33, T-17S, R-30E, N.M.P.M.,
Eddy Co., New Mexico

Paul Slayton:

Enclosed is a copy of Oil Conservation Division Form C-108 (Application for Authorization to Inject) for COG Operating, LLC Loco Hill 4-33 well. You are being provided a copy of the application as an offset operator, offset leaseholder or surface owner. COG Operating, LLC purposes to drill the subject well as a disposal well, injection to occur into the Wolfcamp formation through perforations from 8525'-8950'.

Objections must be filed with the Oil Conservation Division, 1220 South St. Francis Drive, Santa Fe, New Mexico 87505, within 15 days.

Thank you for your cooperation in this matter.

Sincerely,

Tye Orr
Consulting Landman
Ext. 110

U.S. Postal Service™	
CERTIFIED MAIL™ RECEIPT	
(Domestic Mail Only; No Insurance Coverage Provided)	
For delivery information visit our website at www.usps.com	
OFFICIAL USE	
Postage	\$.59
Certified Fee	2.70
Return Receipt Fee (Endorsement Required)	2.20
Restricted Delivery Fee (Endorsement Required)	
Total Postage & Fees	\$ 5.49
Sent To: Paul Slayton	
Street, Apt. No., or PO Box No. P.O. Box 2035	
City, State, ZIP+4 Roswell, NM 88210	
PS Form 3800, August 2008 See Reverse for Instructions	

7007 2560 0003 3682 0658

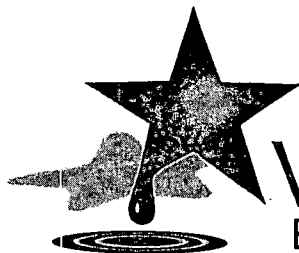

VERITAS 321
ENERGY PARTNERS, LP

February 27, 2009

CERTIFIED MAIL
RETURN RECEIPT REQUESTED

James D. Brown
16105 Red Cedar Trail
Dallas, TX 75248

RE: COG Operating, LLC.
Form C-108 (Application for Authorization to Inject)
Loco Hills SWD 4-33
840' FSL & 660' FWL, Section 33, T-17S, R-30E, N.M.P.M.,
Eddy Co., New Mexico

James D. Brown:

Enclosed is a copy of Oil Conservation Division Form C-108 (Application for Authorization to Inject) for COG Operating, LLC Loco Hill 4-33 well. You are being provided a copy of the application as an offset operator, offset leaseholder or surface owner. COG Operating, LLC purposes to drill the subject well as a disposal well, injection to occur into the Wolfcamp formation through perforations from 8525'-8950'.

Objections must be filed with the Oil Conservation Division, 1220 South St. Francis Drive, Santa Fe, New Mexico 87505, within 15 days.

Thank you for your cooperation in this matter.

Sincerely,

Tye Orr
Consulting Landman
Ext. 110

U.S. Postal Service™ CERTIFIED MAIL™ RECEIPT (Domestic Mail Only; No Insurance Coverage Provided)	
For delivery information visit our website at www.usps.com	
OFFICIAL USE	
Postage	\$.59
Certified Fee	2.70
Return Receipt Fee (Endorsement Required)	2.20
Restricted Delivery Fee (Endorsement Required)	
Total Postage & Fees	\$ 5.49
Sent To: James D. Brown	
Street, Apt. No. or PO Box No.: 16105 Red Cedar Trail	
City, State, ZIP+4: Dallas, TX 75248	
PS Form 3800, August 2006 See Reverse for Instructions	



VERITAS 321
ENERGY PARTNERS, LP

February 27, 2009

CERTIFIED MAIL
RETURN RECEIPT REQUESTED

Chase Oil Corporation
P.O. Box 1767
Artesia, NM 88211

RE: COG Operating, LLC.
Form C-108 (Application for Authorization to Inject)
Loco Hills SWD 4-33
840' FSL & 660' FWL, Section 33, T-17S, R-30E, N.M.P.M.,
Eddy Co., New Mexico

Chase Oil Corporation:

Enclosed is a copy of Oil Conservation Division Form C-108 (Application for Authorization to Inject) for COG Operating, LLC Loco Hill 4-33 well. You are being provided a copy of the application as an offset operator, offset leaseholder or surface owner. COG Operating, LLC purposes to drill the subject well as a disposal well, injection to occur into the Wolfcamp formation through perforations from 8525'-8950'.

Objections must be filed with the Oil Conservation Division, 1220 South St. Francis Drive, Santa Fe, New Mexico 87505, within 15 days.

Thank you for your cooperation in this matter.

Sincerely,

Tye Orr
Consulting Landman
Ext. 110

U.S. Postal Service™	
CERTIFIED MAIL™ RECEIPT	
(Domestic Mail Only; No Insurance Coverage Provided)	
For delivery information visit our website at www.usps.com	
OFFICIAL USE	
Postage	\$.59
Certified Fee	2.70
Return Receipt Fee (Endorsement Required)	2.20
Restricted Delivery Fee (Endorsement Required)	
Total Postage & Fees	\$ 5.49
Sent To Chase Oil Corporation	
Street, Apt. No., or PO Box No. P.O. Box 1767	
City, State, ZIP+4 Artesia, NM 88211	
PS Form 3800, August 2006 See Reverse for Instructions	



VERITAS 321

ENERGY PARTNERS, LP

February 27, 2009

CERTIFIED MAIL
RETURN RECEIPT REQUESTED

Mesa Oil Company
P.O. Box 1330
Artesia, NM 88211

RE: COG Operating, LLC.
Form C-108 (Application for Authorization to Inject)
Loco Hills SWD 4-33
840' FSL & 660' FWL, Section 33, T-17S, R-30E, N.M.P.M.,
Eddy Co., New Mexico

Mesa Oil Company:

Enclosed is a copy of Oil Conservation Division Form C-108 (Application for Authorization to Inject) for COG Operating, LLC Loco Hill 4-33 well. You are being provided a copy of the application as an offset operator, offset leaseholder or surface owner. COG Operating, LLC purposes to drill the subject well as a disposal well, injection to occur into the Wolfcamp formation through perforations from 8525'-8950'.

Objections must be filed with the Oil Conservation Division, 1220 South St. Francis Drive, Santa Fe, New Mexico 87505, within 15 days.

Thank you for your cooperation in this matter.

Sincerely,

Tye Orr
Consulting Landman
Ext. 110

6990 299E E000 0952 2002

U.S. Postal Service TM	
CERTIFIED MAIL TM RECEIPT	
(Domestic Mail Only; No Insurance Coverage Provided)	
For delivery information visit our website at www.usps.com	
OFFICIAL USE	
Postage	\$.59
Certified Fee	2.70
Return Receipt Fee (Endorsement Required)	2.20
Restricted Delivery Fee (Endorsement Required)	
Total Postage & Fees	\$ 5.49
Postmark Here	
Sent To mesa oil company	
Street, Apt. No., or PO Box No. P.O. Box 1330	
City, State, ZIP+4 Artesia, NM 88211	
PS Form 3800, August 2006	
See Reverse for Instructions	



VERITAS 321
ENERGY PARTNERS, LP

February 27, 2009

CERTIFIED MAIL
RETURN RECEIPT REQUESTED

Rio Pecos Corporation
4501 Green Tree Blvd
Midland, TX 79707

RE: COG Operating, LLC.
Form C-108 (Application for Authorization to Inject)
Loco Hills SWD 4-33
840' FSL & 660' FWL, Section 33, T-17S, R-30E, N.M.P.M.,
Eddy Co., New Mexico

Rio Pecos Corporation:

Enclosed is a copy of Oil Conservation Division Form C-108 (Application for Authorization to Inject) for COG Operating, LLC Loco Hill 4-33 well. You are being provided a copy of the application as an offset operator, offset leaseholder or surface owner. COG Operating, LLC purposes to drill the subject well as a disposal well, injection to occur into the Wolfcamp formation through perforations from 8525'-8950'.

Objections must be filed with the Oil Conservation Division, 1220 South St. Francis Drive, Santa Fe, New Mexico 87505, within 15 days.

Thank you for your cooperation in this matter.

Sincerely,

Ely Orr
Consulting Landman
Ext. 110

U.S. Postal Service™
CERTIFIED MAIL™ RECEIPT
(Domestic Mail Only; No Insurance Coverage Provided)
For delivery information visit our website at www.usps.com

OFFICIAL USE	
Postage	\$ 1.59
Certified Fee	2.70
Return Receipt Fee (Endorsement Required)	2.70
Restricted Delivery Fee (Endorsement Required)	
Total Postage & Fees	\$ 5.49

Postmark Here

Sent To
Street, Apt. No.,
or PO Box No.
City, State, ZIP+4

Rio Pecos Corporation
4501 Green Tree Blvd
Midland, TX 79707

PS Form 3800, August 2005 See Reverse for Instructions



VERITAS 321

ENERGY PARTNERS, LP

February 27, 2009

CERTIFIED MAIL
RETURN RECEIPT REQUESTED

Tara Jon Corporation
6003 Meadow View Lane
Midland, TX 79707

RE: COG Operating, LLC.
Form C-108 (Application for Authorization to Inject)
Loco Hills SWD 4-33
840' FSL & 660' FWL, Section 33, T-17S, R-30E, N.M.P.M.,
Eddy Co., New Mexico

Tara Jon Corporation:

Enclosed is a copy of Oil Conservation Division Form C-108 (Application for Authorization to Inject) for COG Operating, LLC Loco Hill 4-33 well. You are being provided a copy of the application as an offset operator, offset leaseholder or surface owner. COG Operating, LLC purposes to drill the subject well as a disposal well, injection to occur into the Wolfcamp formation through perforations from 8525'-8950'.

Objections must be filed with the Oil Conservation Division, 1220 South St. Francis Drive, Santa Fe, New Mexico 87505, within 15 days.

Thank you for your cooperation in this matter.

Sincerely,

Pye Orr
Consulting Landman
Ext. 110

U.S. Postal Service™	
CERTIFIED MAIL™ RECEIPT	
(Domestic Mail Only; No Insurance Coverage Provided)	
For delivery information visit our website at www.usps.com	
OFFICIAL USE	
Postage	\$.59
Certified Fee	2.70
Return Receipt Fee (Endorsement Required)	2.20
Restricted Delivery Fee (Endorsement Required)	
Total Postage & Fees	\$ 5.49
Postmark Here	
Sent To	
Tara Jon Corporation	
Street, Apt. No., or PO Box No.	
6003 Meadow View Lane	
City, State, ZIP+4	
Midland, TX 79707	
PS Form 3800, August 2006	
See Reverse for Instructions	



VERITAS 321
ENERGY PARTNERS, LP

February 27, 2009

CERTIFIED MAIL
RETURN RECEIPT REQUESTED

Mark D. Wilson
1705 Briscoe Ave.
Artesia, NM 88210

RE: COG Operating, LLC.
Form C-108 (Application for Authorization to Inject)
Loco Hills SWD 4-33
840' FSL & 660' FWL, Section 33, T-17S, R-30E, N.M.P.M.,
Eddy Co., New Mexico

Mark D. Wilson:

Enclosed is a copy of Oil Conservation Division Form C-108 (Application for Authorization to Inject) for COG Operating, LLC Loco Hill 4-33 well. You are being provided a copy of the application as an offset operator, offset leaseholder or surface owner. COG Operating, LLC purposes to drill the subject well as a disposal well, injection to occur into the Wolfcamp formation through perforations from 8525'-8950'.

Objections must be filed with the Oil Conservation Division, 1220 South St. Francis Drive, Santa Fe, New Mexico 87505, within 15 days.

Thank you for your cooperation in this matter.

Sincerely,

Tye Orr
Consulting Landman
Ext. 110

U.S. Postal Service TM	
CERTIFIED MAIL TM RECEIPT	
(Domestic Mail Only; No Insurance Coverage Provided)	
For delivery information visit our website at www.usps.com	
OFFICIAL USE	
Postage	\$.59
Certified Fee	2.70
Return Receipt Fee (Endorsement Required)	2.20
Restricted Delivery Fee (Endorsement Required)	
Total Postage & Fees	\$ 5.49
Sent To Mark D. Wilson	
Street, Apt. No., or PO Box No. 1705 Briscoe Ave	
City, State, ZIP+4 Artesia, NM 88210	
PS Form 3800, August 2006	
See Reverse for Instructions	

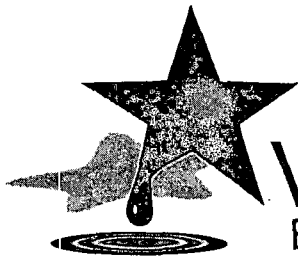

VERITAS 321

ENERGY PARTNERS, LP

February 27, 2009

CERTIFIED MAIL
RETURN RECEIPT REQUESTED

Roy L. Crow
P.O. Box 5527
Granbury, TX 76049

RE: COG Operating, LLC.
Form C-108 (Application for Authorization to Inject)
Loco Hills SWD 4-33
840' FSL & 660' FWL, Section 33, T-17S, R-30E, N.M.P.M.,
Eddy Co., New Mexico

Roy L. Crow:

Enclosed is a copy of Oil Conservation Division Form C-108 (Application for Authorization to Inject) for COG Operating, LLC Loco Hill 4-33 well. You are being provided a copy of the application as an offset operator, offset leaseholder or surface owner. COG Operating, LLC purposes to drill the subject well as a disposal well, injection to occur into the Wolfcamp formation through perforations from 8525'-8950'.

Objections must be filed with the Oil Conservation Division, 1220 South St. Francis Drive, Santa Fe, New Mexico 87505, within 15 days.

Thank you for your cooperation in this matter.

Sincerely,

Tye Orr
Consulting Landman
Ext. 110

U.S. Postal ServiceTM
CERTIFIED MAIL[®] RECEIPT
(Domestic Mail Only; No Insurance Coverage Provided)
For delivery information visit our website at www.usps.com
OFFICIAL USE

Postage	\$.59
Certified Fee	0.70
Return Receipt Fee (Endorsement Required)	2.20
Restricted Delivery Fee (Endorsement Required)	
Total Postage & Fees	\$ 5.49

Postmark
Here

Sent To
Roy L. Crow
Street, Apt. No.,
or PO Box No. P.O. Box 5527
City, State, ZIP+4 Granbury, TX 76049
PS Form 3800, August 2006 See Reverse for Instructions

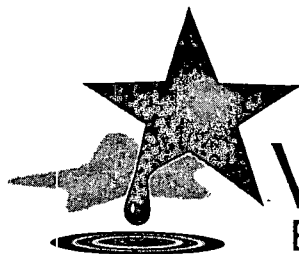

VERITAS 321

ENERGY PARTNERS, LP

February 27, 2009

CERTIFIED MAIL
RETURN RECEIPT REQUESTED

Mewbourne Oil Company
P.O. Box 7698
Tyler, TX 75711

RE: COG Operating, LLC.
Form C-108 (Application for Authorization to Inject)
Loco Hills SWD 4-33
840' FSL & 660' FWL, Section 33, T-17S, R-30E, N.M.P.M.,
Eddy Co., New Mexico

Mewbourne Oil Company:

Enclosed is a copy of Oil Conservation Division Form C-108 (Application for Authorization to Inject) for COG Operating, LLC Loco Hill 4-33 well. You are being provided a copy of the application as an offset operator, offset leaseholder or surface owner. COG Operating, LLC purposes to drill the subject well as a disposal well, injection to occur into the Wolfcamp formation through perforations from 8525'-8950'.

Objections must be filed with the Oil Conservation Division, 1220 South St. Francis Drive, Santa Fe, New Mexico 87505, within 15 days.

Thank you for your cooperation in this matter.

Sincerely,

Tye Orr
Consulting Landman
Ext. 110

U.S. Postal Service™	
CERTIFIED MAIL™ RECEIPT	
(Domestic Mail Only; No Insurance Coverage Provided)	
For delivery information visit our website at www.usps.com	
OFFICIAL USE	
Postage	\$.59
Certified Fee	2.76
Return Receipt Fee (Endorsement Required)	2.20
Restricted Delivery Fee (Endorsement Required)	
Total Postage & Fees	\$ 5.49
Postmark Here	
Sent To	
mewbourne oil company	
Street, Apt. No., or PO Box No. P.O. Box 7698	
City, State, ZIP+4 Tyler, TX 75711	
PS Form 3800, August 2006	
See Reverse for Instructions	



VERITAS 321

ENERGY PARTNERS, LP

February 27, 2009

CERTIFIED MAIL
RETURN RECEIPT REQUESTED

Unit Petroleum Company
7130 South Lewis, Ste. 1000
Tulsa, OK 74136

RE: COG Operating, LLC.
Form C-108 (Application for Authorization to Inject)
Loco Hills SWD 4-33
840' FSL & 660' FWL, Section 33, T-17S, R-30E, N.M.P.M.,
Eddy Co., New Mexico

Unit Petroleum Company:

Enclosed is a copy of Oil Conservation Division Form C-108 (Application for Authorization to Inject) for COG Operating, LLC Loco Hill 4-33 well. You are being provided a copy of the application as an offset operator, offset leaseholder or surface owner. COG Operating, LLC purposes to drill the subject well as a disposal well, injection to occur into the Wolfcamp formation through perforations from 8525'-8950'.

Objections must be filed with the Oil Conservation Division, 1220 South St. Francis Drive, Santa Fe, New Mexico 87505, within 15 days.

Thank you for your cooperation in this matter.

Sincerely,

Tye Orr
Consulting Landman
Ext. 110

U.S. Postal Service™	
CERTIFIED MAIL™ RECEIPT	
(Domestic Mail Only; No Insurance Coverage Provided)	
For delivery information visit our website at www.usps.com	
OFFICIAL USE	
Postage	\$.59
Certified Fee	2.70
Return Receipt Fee (Endorsement Required)	2.30
Restricted Delivery Fee (Endorsement Required)	
Total Postage & Fees	\$ 5.49
Postmark Here	
Sent To	
Unit Petroleum Company	
Street, Apt. No., or PO Box No. 7130 South Lewis, Ste 1000	
City, State, ZIP+4 Tulsa, OK 74136	
PS Form 3800, August 2006	
See Reverse for Instructions	



VERITAS 321
ENERGY PARTNERS, LP

February 27, 2009

CERTIFIED MAIL
RETURN RECEIPT REQUESTED

CWM 2000-C, Ltd
P.O. Box 7698
Tyler, TX 75711

RE: COG Operating, LLC.
Form C-108 (Application for Authorization to Inject)
Loco Hills SWD 4-33
840' FSL & 660' FWL, Section 33, T-17S, R-30E, N.M.P.M.,
Eddy Co., New Mexico

CWM 2000-C, Ltd:

Enclosed is a copy of Oil Conservation Division Form C-108 (Application for Authorization to Inject) for COG Operating, LLC Loco Hill 4-33 well. You are being provided a copy of the application as an offset operator, offset leaseholder or surface owner. COG Operating, LLC purposes to drill the subject well as a disposal well, injection to occur into the Wolfcamp formation through perforations from 8525'-8950'.

Objections must be filed with the Oil Conservation Division, 1220 South St. Francis Drive, Santa Fe, New Mexico 87505, within 15 days.

Thank you for your cooperation in this matter.

Sincerely,

Tye Orr
Consulting Landman
Ext. 110

7007 2560 0003 3682 0757

U.S. Postal Service™ CERTIFIED MAIL™ RECEIPT (Domestic Mail Only; No Insurance Coverage Provided)	
For delivery information visit our website at www.usps.com	
OFFICIAL USE	
Postage	\$.59
Certified Fee	2.70
Return Receipt Fee (Endorsement Required)	2.20
Restricted Delivery Fee (Endorsement Required)	
Total Postage & Fees	\$ 5.49

Postmark Here

Sent To: CWN 2000-C Ltd
Street, Apt. No., or PO Box No. P.O. Box 7698
City, State, ZIP+4 Tyler, TX 75711

PS Form 3800, August 2006 See Reverse for Instructions

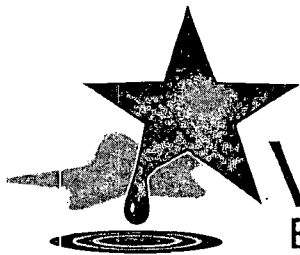

VERITAS 321

ENERGY PARTNERS, LP

February 27, 2009

CERTIFIED MAIL
RETURN RECEIPT REQUESTED

Michael K. Boyd Trust
11 W. 5th, Ste. 700
Tulsa, OK 74013

RE: COG Operating, LLC.
Form C-108 (Application for Authorization to Inject)
Loco Hills SWD 4-33
840' FSL & 660' FWL, Section 33, T-17S, R-30E, N.M.P.M.,
Eddy Co., New Mexico

Michael K. Boyd Trust:

Enclosed is a copy of Oil Conservation Division Form C-108 (Application for Authorization to Inject) for COG Operating, LLC Loco Hill 4-33 well. You are being provided a copy of the application as an offset operator, offset leaseholder or surface owner. COG Operating, LLC purposes to drill the subject well as a disposal well, injection to occur into the Wolfcamp formation through perforations from 8525'-8950'.

Objections must be filed with the Oil Conservation Division, 1220 South St. Francis Drive, Santa Fe, New Mexico 87505, within 15 days.

Thank you for your cooperation in this matter.

Sincerely,

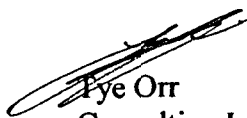
P. Orr

Consulting Landman
Ext. 110

U.S. Postal Service TM	
CERTIFIED MAIL TM RECEIPT	
(Domestic Mail Only; No Insurance Coverage Provided)	
For delivery information visit our website at www.usps.com	
OFFICIAL USE	
Postage	\$.59
Certified Fee	2.70
Return Receipt Fee (Endorsement Required)	2.20
Restricted Delivery Fee (Endorsement Required)	
Total Postage & Fees	\$ 5.49
Postmark Here	
Sent To	
Michael K. Boyd Trust	
Street, Apt. No., or PO Box No. 11 W. 5 th Ste 700	
City, State, ZIP+4	
Tulsa, OK 74013	
PS Form 3800, August 2006	
See Reverse for Instructions	



VERITAS 321

ENERGY PARTNERS, LP

February 27, 2009

CERTIFIED MAIL
RETURN RECEIPT REQUESTED

A&S Operating, Inc.
233 South Detroit, Ste. 200
Tulsa, OK 74120

RE: COG Operating, LLC.
Form C-108 (Application for Authorization to Inject)
Loco Hills SWD 4-33
840' FSL & 660' FWL, Section 33, T-17S, R-30E, N.M.P.M.,
Eddy Co., New Mexico

A&S Operating, Inc:

Enclosed is a copy of Oil Conservation Division Form C-108 (Application for Authorization to Inject) for COG Operating, LLC Loco Hill 4-33 well. You are being provided a copy of the application as an offset operator, offset leaseholder or surface owner. COG Operating, LLC purposes to drill the subject well as a disposal well, injection to occur into the Wolfcamp formation through perforations from 8525'-8950'.

Objections must be filed with the Oil Conservation Division, 1220 South St. Francis Drive, Santa Fe, New Mexico 87505, within 15 days.

Thank you for your cooperation in this matter.

Sincerely,

Tye Orr
Consulting Landman
Ext. 110

7007 2560 0000 3682 0771

U.S. Postal Service™	
CERTIFIED MAIL™ RECEIPT	
(Domestic Mail Only; No Insurance Coverage Provided)	
For delivery information visit our website at www.usps.com	
OFFICIAL USE	
Postage	\$.59
Certified Fee	2.70
Return Receipt Fee (Endorsement Required)	2.00
Restricted Delivery Fee (Endorsement Required)	
Total Postage & Fees	\$ 5.49
Postmark Here	
Sent To	
A&S Operating, Inc.	
Street, Apt. No., or PO Box No. 233 South Detroit, Ste. 200	
City, State, ZIP+4 Tulsa, OK 74120	
PS Form 3800, August 2006 See Reverse for Instructions	



VERITAS 321
ENERGY PARTNERS, LP

February 27, 2009

CERTIFIED MAIL
RETURN RECEIPT REQUESTED

Todd Memorial Trust
P.O. Box 1973
Roswell, NM 88201

RE: COG Operating, LLC.
Form C-108 (Application for Authorization to Inject)
Loco Hills SWD 4-33
840' FSL & 660' FWL, Section 33, T-17S, R-30E, N.M.P.M.,
Eddy Co., New Mexico

Todd Memorial Trust:

Enclosed is a copy of Oil Conservation Division Form C-108 (Application for Authorization to Inject) for COG Operating, LLC Loco Hill 4-33 well. You are being provided a copy of the application as an offset operator, offset leaseholder or surface owner. COG Operating, LLC purposes to drill the subject well as a disposal well, injection to occur into the Wolfcamp formation through perforations from 8525'-8950'.

Objections must be filed with the Oil Conservation Division, 1220 South St. Francis Drive, Santa Fe, New Mexico 87505, within 15 days.

Thank you for your cooperation in this matter.

Sincerely,

Tye Orr
Consulting Landman
Ext. 110

U.S. Postal Service™	
CERTIFIED MAIL™ RECEIPT	
(Domestic Mail Only; No Insurance Coverage Provided)	
For delivery information visit our website at www.usps.com	
OFFICIAL USE	
Postage	\$.59
Certified Fee	2.70
Return Receipt Fee (Endorsement Required)	7.20
Restricted Delivery Fee (Endorsement Required)	
Total Postage & Fees	\$ 5.49
Postmark Here	
Sent To	
Todd Memorial Trust	
Street, Apt. No., or PO Box No.	
P.O. Box 1973	
City, State, ZIP+4	
Roswell, NM 88201	
PS Form 3800, August 2006	
See Reverse for Instructions	

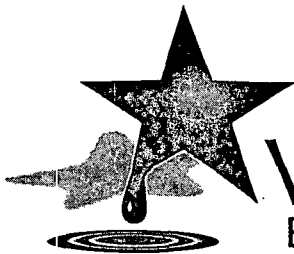

VERITAS 321

ENERGY PARTNERS, LP

February 27, 2009

CERTIFIED MAIL
RETURN RECEIPT REQUESTED

Pathfinder Exploration Company
4601 Mirador Dr.
Austin, TX 79735

RE: COG Operating, LLC.
Form C-108 (Application for Authorization to Inject)
Loco Hills SWD 4-33
840' FSL & 660' FWL, Section 33, T-17S, R-30E, N.M.P.M.,
Eddy Co., New Mexico

Pathfinder Exploration Company:

Enclosed is a copy of Oil Conservation Division Form C-108 (Application for Authorization to Inject) for COG Operating, LLC Loco Hill 4-33 well. You are being provided a copy of the application as an offset operator, offset leaseholder or surface owner. COG Operating, LLC purposes to drill the subject well as a disposal well, injection to occur into the Wolfcamp formation through perforations from 8525'-8950'.

Objections must be filed with the Oil Conservation Division, 1220 South St. Francis Drive, Santa Fe, New Mexico 87505, within 15 days.

Thank you for your cooperation in this matter.

Sincerely,

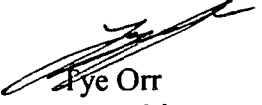
Lye Orr
Consulting Landman
Ext. 110

U.S. Postal Service™	
CERTIFIED MAIL™ RECEIPT	
(Domestic Mail Only; No Insurance Coverage Provided)	
For delivery information visit our website at www.usps.com	
OFFICIAL USE	
Postage	\$.59
Certified Fee	2.70
Return Receipt Fee (Endorsement Required)	2.20
Restricted Delivery Fee (Endorsement Required)	
Total Postage & Fees	\$ 5.49
Postmark Here	
Sent To Pathfinder Exploration Company	
Street, Apt. No., or PO Box No. 4601 Mirador Dr	
City, State, ZIP+4 Austin, Tx 79735	
PS Form 3800, August 2006 See Reverse for Instructions	



VERITAS 321

ENERGY PARTNERS, LP

February 27, 2009

CERTIFIED MAIL
RETURN RECEIPT REQUESTED

Cannon Exploration Company
3608 SCR 1184
Midland, TX 79706

RE: COG Operating, LLC.
Form C-108 (Application for Authorization to Inject)
Loco Hills SWD 4-33
840' FSL & 660' FWL, Section 33, T-17S, R-30E, N.M.P.M.,
Eddy Co., New Mexico

Cannon Exploration Company:

Enclosed is a copy of Oil Conservation Division Form C-108 (Application for Authorization to Inject) for COG Operating, LLC Loco Hill 4-33 well. You are being provided a copy of the application as an offset operator, offset leaseholder or surface owner. COG Operating, LLC purposes to drill the subject well as a disposal well, injection to occur into the Wolfcamp formation through perforations from 8525'-8950'.

Objections must be filed with the Oil Conservation Division, 1220 South St. Francis Drive, Santa Fe, New Mexico 87505, within 15 days.

Thank you for your cooperation in this matter.

Sincerely,

Ely Orr
Consulting Landman
Ext. 110

U.S. Postal Service™	
CERTIFIED MAIL™ RECEIPT	
(Domestic Mail Only; No Insurance Coverage Provided)	
For delivery information visit our website at www.usps.com	
OFFICIAL USE	

7007 2560 0003 3682 0800

Postage	\$.59
Certified Fee	2.70
Return Receipt Fee (Endorsement Required)	2.20
Restricted Delivery Fee (Endorsement Required)	
Total Postage & Fees	\$ 5.49

Postmark
Here

Sent To	
Cannon Exploration Co.	
Street, Apt. No., or PO Box No. 3608 SCR 1184	
City, State, ZIP+4 Midland, TX 79706	
PS Form 3800, August 2006	
See Reverse for Instructions	

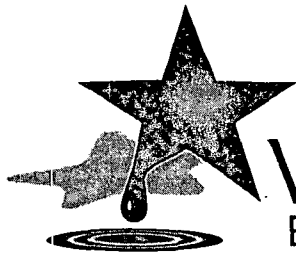

VERITAS 321

ENERGY PARTNERS, LP

February 27, 2009

CERTIFIED MAIL
RETURN RECEIPT REQUESTED

Hollyhock Corporation
4105 Baybrook Dr.
Midland, TX 79707

RE: COG Operating, LLC.
Form C-108 (Application for Authorization to Inject)
Loco Hills SWD 4-33
840' FSL & 660' FWL, Section 33, T-17S, R-30E, N.M.P.M.,
Eddy Co., New Mexico

Hollyhock Corporation:

Enclosed is a copy of Oil Conservation Division Form C-108 (Application for Authorization to Inject) for COG Operating, LLC Loco Hill 4-33 well. You are being provided a copy of the application as an offset operator, offset leaseholder or surface owner. COG Operating, LLC purposes to drill the subject well as a disposal well, injection to occur into the Wolfcamp formation through perforations from 8525'-8950'.

Objections must be filed with the Oil Conservation Division, 1220 South St. Francis Drive, Santa Fe, New Mexico 87505, within 15 days.

Thank you for your cooperation in this matter.

Sincerely,

Eye Orr
Consulting Landman
Ext. 110

2007 0952 0000 3693 8180

U.S. Postal Service™	
CERTIFIED MAIL™ RECEIPT	
(Domestic Mail Only; No Insurance Coverage Provided)	
For delivery information visit our website at www.usps.com	
OFFICIAL USE	
Postage	\$.59
Certified Fee	2.78
Return Receipt Fee (Endorsement Required)	2.20
Restricted Delivery Fee (Endorsement Required)	
Total Postage & Fees	\$ 5.49
Sent To Hollyhock Corp.	
Street, Apt. No., or PO Box No. 4105 Baybrook Dr	
City, State, ZIP+4 Midland, TX 79705	
PS Form 3800, August 2006 See Reverse for Instructions	

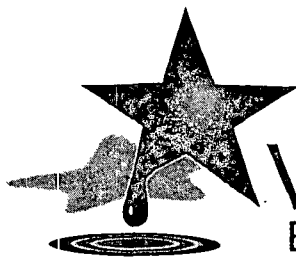

VERITAS 321
ENERGY PARTNERS, LP

February 27, 2009

CERTIFIED MAIL
RETURN RECEIPT REQUESTED

Chesapeake Exploration Ltd.
P.O. Box 18496
Oklahoma City, OK 73154

RE: COG Operating, LLC.
Form C-108 (Application for Authorization to Inject)
Loco Hills SWD 4-33
840' FSL & 660' FWL, Section 33, T-17S, R-30E, N.M.P.M.,
Eddy Co., New Mexico

Chesapeake Exploration Ltd:

Enclosed is a copy of Oil Conservation Division Form C-108 (Application for Authorization to Inject) for COG Operating, LLC Loco Hill 4-33 well. You are being provided a copy of the application as an offset operator, offset leaseholder or surface owner. COG Operating, LLC purposes to drill the subject well as a disposal well, injection to occur into the Wolfcamp formation through perforations from 8525'-8950'.

Objections must be filed with the Oil Conservation Division, 1220 South St. Francis Drive, Santa Fe, New Mexico 87505, within 15 days.

Thank you for your cooperation in this matter.

Sincerely,

Tye Orr
Consulting Landman
Ext. 110

U.S. Postal Service™	
CERTIFIED MAIL™ RECEIPT	
(Domestic Mail Only; No Insurance Coverage Provided)	
For delivery information visit our website at www.usps.com	
OFFICIAL USE	
Postage	\$.59
Certified Fee	2.70
Return Receipt Fee (Endorsement Required)	2.20
Restricted Delivery Fee (Endorsement Required)	-
Total Postage & Fees	\$ 5.49
Postmark Here	
Sent To Chesapeake Exploration Ltd	
Street, Apt. No., or PO Box No. P.O. Box 18496	
City, State, ZIP+4 Oklahoma City, OK 73154	
PS Form 3800, August 2006 See Reverse for Instructions	



VERITAS 321

ENERGY PARTNERS, LP

February 27, 2009

CERTIFIED MAIL
RETURN RECEIPT REQUESTED

Weller Energy Inc.
132 Green Ave
Madison, NJ 07940

RE: COG Operating, LLC.
Form C-108 (Application for Authorization to Inject)
Loco Hills SWD 4-33
840' FSL & 660' FWL, Section 33, T-17S, R-30E, N.M.P.M.,
Eddy Co., New Mexico

Weller Energy Inc.:

Enclosed is a copy of Oil Conservation Division Form C-108 (Application for Authorization to Inject) for COG Operating, LLC Loco Hill 4-33 well. You are being provided a copy of the application as an offset operator, offset leaseholder or surface owner. COG Operating, LLC purposes to drill the subject well as a disposal well, injection to occur into the Wolfcamp formation through perforations from 8525'-8950'.

Objections must be filed with the Oil Conservation Division, 1220 South St. Francis Drive, Santa Fe, New Mexico 87505, within 15 days.

Thank you for your cooperation in this matter.

Sincerely,

Ely Orr
Consulting Landman
Ext. 110

U.S. Postal Service™	
CERTIFIED MAIL™ RECEIPT	
(Domestic Mail Only; No Insurance Coverage Provided)	
For delivery information visit our website at www.usps.com	
OFFICIAL USE	
Postage	\$.59
Certified Fee	2.10
Return Receipt Fee (Endorsement Required)	2.20
Restricted Delivery Fee (Endorsement Required)	
Total Postage & Fees	\$ 5.49
Sent To: Weller Energy Inc.	
Street, Apt. No., or PO Box No. 132 Green Ave	
City, State, ZIP+4 Madison, NJ 07940	
PS Form 3800, August 2006 See Reverse for Instructions	

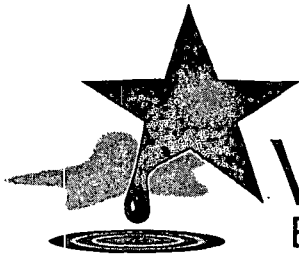

VERITAS 321
ENERGY PARTNERS, LP

February 27, 2009

CERTIFIED MAIL
RETURN RECEIPT REQUESTED

Nadel & Gussman Permian, LLC
601 N. Marienfeld, Ste. 508
Midland, TX 79701

RE: COG Operating, LLC.
Form C-108 (Application for Authorization to Inject)
Loco Hills SWD 4-33
840' FSL & 660' FWL, Section 33, T-17S, R-30E, N.M.P.M.,
Eddy Co., New Mexico

Nadel & Gussman Permian, LLC:

Enclosed is a copy of Oil Conservation Division Form C-108 (Application for Authorization to Inject) for COG Operating, LLC Loco Hill 4-33 well. You are being provided a copy of the application as an offset operator, offset leaseholder or surface owner. COG Operating, LLC purposes to drill the subject well as a disposal well, injection to occur into the Wolfcamp formation through perforations from 8525'-8950'.

Objections must be filed with the Oil Conservation Division, 1220 South St. Francis Drive, Santa Fe, New Mexico 87505, within 15 days.

Thank you for your cooperation in this matter.

Sincerely,

Lye Orr
Consulting Landman
Ext. 110

U.S. Postal Service™	
CERTIFIED MAIL™ RECEIPT	
(Domestic Mail Only; No Insurance Coverage Provided)	
For delivery information visit our website at www.usps.com®	
OFFICIAL USE	
Postage	\$ <u>0.59</u>
Certified Fee	<u>2.70</u>
Return Receipt Fee (Endorsement Required)	<u>2.20</u>
Restricted Delivery Fee (Endorsement Required)	
Total Postage & Fees	\$ <u>5.49</u>
Sent To	
Nadel & Gussman Permian LLC	
Street, Apt. No., or PO Box No.	
601 N. Marienfeld, Ste 508	
City, State, ZIP+4	
Midland, TX 79701	
PS Form 3800, August 2006	
See Reverse for Instructions	



VERITAS 321
ENERGY PARTNERS, LP

February 27, 2009

CERTIFIED MAIL
RETURN RECEIPT REQUESTED

ConocoPhillips Company
P.O. Box 2197
Houston, TX 77252

RE: COG Operating, LLC.
Form C-108 (Application for Authorization to Inject)
Loco Hills SWD 4-33
840' FSL & 660' FWL, Section 33, T-17S, R-30E, N.M.P.M.,
Eddy Co., New Mexico

ConocoPhillips Company:

Enclosed is a copy of Oil Conservation Division Form C-108 (Application for Authorization to Inject) for COG Operating, LLC Loco Hill 4-33 well. You are being provided a copy of the application as an offset operator, offset leaseholder or surface owner. COG Operating, LLC purposes to drill the subject well as a disposal well, injection to occur into the Wolfcamp formation through perforations from 8525'-8950'.

Objections must be filed with the Oil Conservation Division, 1220 South St. Francis Drive, Santa Fe, New Mexico 87505, within 15 days.

Thank you for your cooperation in this matter.

Sincerely,

Tye Orr
Consulting Landman
Ext. 110

U.S. Postal Service TM	
CERTIFIED MAIL TM RECEIPT	
(Domestic Mail Only; No Insurance Coverage Provided)	
For delivery information visit our website at www.usps.com	
OFFICIAL USE	
Postage	\$.39
Certified Fee	2.70
Return Receipt Fee (Endorsement Required)	2.20
Restricted Delivery Fee (Endorsement Required)	
Total Postage & Fees	\$ 5.49
Postmark Here	
Sent To Conoco Phillips Company	
Street, Apt. No., or PO Box No. P.O. Box 2197	
City, State, ZIP+4 Houston, TX 77252	
PS Form 3800, August 2005 See Reverse for Instructions	

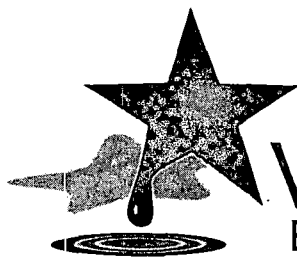

VERITAS 321
ENERGY PARTNERS, LP

February 27, 2009

CERTIFIED MAIL
RETURN RECEIPT REQUESTED

CBS Partners, Ltd.
P.O. Box 2236
Midland, TX 77702

RE: COG Operating, LLC.
Form C-108 (Application for Authorization to Inject)
Loco Hills SWD 4-33
840' FSL & 660' FWL, Section 33, T-17S, R-30E, N.M.P.M.,
Eddy Co., New Mexico

CBS Partnership, Ltd.:

Enclosed is a copy of Oil Conservation Division Form C-108 (Application for Authorization to Inject) for COG Operating, LLC Loco Hill 4-33 well. You are being provided a copy of the application as an offset operator, offset leaseholder or surface owner. COG Operating, LLC purposes to drill the subject well as a disposal well, injection to occur into the Wolfcamp formation through perforations from 8525'-8950'.

Objections must be filed with the Oil Conservation Division, 1220 South St. Francis Drive, Santa Fe, New Mexico 87505, within 15 days.

Thank you for your cooperation in this matter.

Sincerely,

Tye Orr
Consulting Landman
Ext. 110

U.S. Postal Service™	
CERTIFIED MAIL™ RECEIPT	
(Domestic Mail Only; No Insurance Coverage Provided)	
For delivery information visit our website at www.usps.com	
OFFICIAL USE	
Postage	\$.59
Certified Fee	2.70
Return Receipt Fee (Endorsement Required)	2.20
Restricted Delivery Fee (Endorsement Required)	
Total Postage & Fees	\$ 5.49
Sent To CBS Partners Ltd	
Street, Apt. No., or PO Box No. P.O. Box 2236	
City, State, ZIP+4 Midland, Tx 77702	
PS Form 3800, August 2006 See Reverse for Instructions	

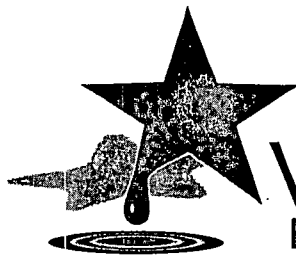

VERITAS 321

ENERGY PARTNERS, LP

February 27, 2009

CERTIFIED MAIL
RETURN RECEIPT REQUESTED

Cimarex Energy Company
600 N. Marienfeld St., Ste 600
Midland, TX 79701

RE: COG Operating, LLC.
Form C-108 (Application for Authorization to Inject)
Loco Hills SWD 4-33
840' FSL & 660' FWL, Section 33, T-17S, R-30E, N.M.P.M.,
Eddy Co., New Mexico

Cimarex Energy Company:

Enclosed is a copy of Oil Conservation Division Form C-108 (Application for Authorization to Inject) for COG Operating, LLC Loco Hill 4-33 well. You are being provided a copy of the application as an offset operator, offset leaseholder or surface owner. COG Operating, LLC purposes to drill the subject well as a disposal well, injection to occur into the Wolfcamp formation through perforations from 8525'-8950'.

Objections must be filed with the Oil Conservation Division, 1220 South St. Francis Drive, Santa Fe, New Mexico 87505, within 15 days.

Thank you for your cooperation in this matter.

Sincerely,

Tye Orr
Consulting Landman
Ext. 110

U.S. Postal Service™	
CERTIFIED MAIL™ RECEIPT	
(Domestic Mail Only; No Insurance Coverage Provided)	
For delivery information visit our website at www.usps.com	
OFFICIAL USE	
Postage	\$.59
Certified Fee	2-70
Return Receipt Fee (Endorsement Required)	2-20
Restricted Delivery Fee (Endorsement Required)	
Total Postage & Fees	\$ 5.49
Postmark Here	
Sent To Cimarex Energy Company	
Street, Apt. No., or PO Box No. 600 N. Marienfeld St.	
City, State, ZIP+4 Midland, TX 79701	
PS Form 3800, August 2005 See Reverse for Instructions	



VERITAS 321

ENERGY PARTNERS, LP

February 27, 2009

CERTIFIED MAIL
RETURN RECEIPT REQUESTED

Yates Petroleum Corporation
105 S. Fourth Street
Artesia, NM 88210

RE: COG Operating, LLC.
Form C-108 (Application for Authorization to Inject)
Loco Hills SWD 4-33
840' FSL & 660' FWL, Section 33, T-17S, R-30E, N.M.P.M.,
Eddy Co., New Mexico

Yates Petroleum Corporation:

Enclosed is a copy of Oil Conservation Division Form C-108 (Application for Authorization to Inject) for COG Operating, LLC Loco Hill 4-33 well. You are being provided a copy of the application as an offset operator, offset leaseholder or surface owner. COG Operating, LLC purposes to drill the subject well as a disposal well, injection to occur into the Wolfcamp formation through perforations from 8525'-8950'.

Objections must be filed with the Oil Conservation Division, 1220 South St. Francis Drive, Santa Fe, New Mexico 87505, within 15 days.

Thank you for your cooperation in this matter.

Sincerely,

Tye Orr
Consulting Landman
Ext. 110

U.S. Postal Service™	
CERTIFIED MAIL™ RECEIPT	
(Domestic Mail Only; No Insurance Coverage Provided)	
For delivery information visit our website at www.usps.com	
OFFICIAL USE	
Postage	\$.59
Certified Fee	2.70
Return Receipt Fee (Endorsement Required)	2.20
Restricted Delivery Fee (Endorsement Required)	
Total Postage & Fees	\$ 5.49
Sent To Yates Petroleum Corporation	
Street, Apt. No., or PO Box No. 105 S. Fourth St.	
City, State, ZIP+4 Artesia, NM 88210	
PS Form 3800, August 2006 See Reverse for Instructions	

Injection Permit Checklist (7/8/08)

Case SWD 1178 WFX PMX IPT Permit Date 4/30/09 UIC Qtr AMJ
 # Wells 1 Well Name: Loco Hills SWD 4-33
 API Num: (30-) 015-NA Spud Date: NEW New/Old: N (UIC primacy March 7, 1982)
 Footages 840 FSL/660 FEL Unit P Sec 33 Tsp 175 Rge 30E County EDDY
 Operator: COG OPERATING LLC Contact Mark A. Fairchild or
 OGRID: 229137 RULE 40 Compliance (Wells) 7/1315 (Finan Assur) OK TYE OKR
 Operator Address: 550 West TEXAS AVE, SUITE 1300, MIDLAND, TX, 79701

Current Status of Well:

Planned Work to Well:

Planned Tubing Size/Depth:

3 1/2 @ 8425'

	Sizes Hole.....Pipe	Setting Depths	Cement Sx or Cf	Cement Top and Determination Method
Existing Surface	17 1/2 13 3/8	650	700	CIRC
Existing Intermediate	12 1/4 9 5/8	4000	1475	CIRC
Existing Long String	8 3/4 7"	9750	2200	CIRC (run CBL)

DV Tool 7000' Liner Open Hole Total Depth 9750 PBTB

Well File Reviewed

Diagrams: Before Conversion After Conversion Elogs in Imaging File

Intervals:	Depths	Formation	Producing (Yes/No)
Above (Name and Top)			
Above (Name and Top)	8175	W.C.	
Injection.....			
Interval TOP:	8525	W.C. Reef	
Injection.....	8950	W.C. Reef	
Interval BOTTOM:	9150	W.C. Reef	
Below (Name and Top)			

2 miles S. of Loco Hills

1705 PSI Max. WHIP

Open Hole (Y/N)

Deviated Hole?

Sensitive Areas: Capitan Reef Gliff House Salt Depths 907 1825..... Rotash Area (R-11-R) Rotash Lessee Noticed?Fresh Water: Depths: Wells (Y/N) Analysis Included (Y/N): Affirmative Statement: ✓

Salt Water: Injection Water Types: Analysis?

Injection Interval: Water Analysis: Hydrocarbon Potential

Notice: Newspaper (Y/N) ✓ Surface Owner BLM Mineral Owner(s) ✓RULE 701B(2) Affected Parties: EOG, Leitch, Rio, Red Seven, Doolay, Brown, Chase, Man, Rio, Tontion, Wynn, Crow, Newby, UNIT, CUB, BOD, AFS, PDBArea of Review: Adequate Map (Y/N) ✓ and Well List (Y/N) ✓Active Wells 1 Num Repairs 0 Producing in Injection Interval in AOR —..P&A Wells 0 Num Repairs 0 All Wellbore Diagrams Included? —

Questions to be Answered:

will Swab fm 5 sample

Send TOPS

CISCO PST in BIG TUB 33 FSL

8835 was Target Zone

Required Work on this Well:

Request Sent — Reply: —

AOR Repairs Needed:

Request Sent — Reply: —Request Sent — Reply: —

Run OPEN HOLE LOSS / MUDLOSS