

District I
1625 N. French Dr., Hobbs, NM 88240
District II
1301 W Grand Avenue, Artesia, NM 88210
District III
1000 Rio Brazos Road, Aztec, NM 87410
District IV
1220 S. St. Francis Dr., Santa Fe, NM 87505

RECEIVED

MAR 17 2009
HOBBSOCD

State of New Mexico
Energy Minerals and Natural Resources
Oil Conservation Division
1220 South St. Francis Dr.
Santa Fe, NM 87505

Form C-141
Revised October 10, 2003

Submit 2 Copies to appropriate
District Office in accordance
with Rule 116 on back
side of form

Release Notification and Corrective Action

OPERATOR

☐ Initial Report ☒ Final Report

Name of Company Occidental Permian Limited Partnership	Contact Steven M. Bishop	
Address 1017 West Stanolind Road, Hobbs, N.M. 88240	Telephone No. (575) 397-8251	
Facility Name South Hobbs Unit Injection System	Facility Type Production	
Surface Owner Malcolm Coombes	Mineral Owner Occidental Permian Limited Partnership	Lease No. <u>1RP-2019</u> API No. 30-025-07612

LOCATION OF RELEASE

Unit Letter	Section	Township	Range	Feet from the	North/South Line	Feet from the	East/West Line	County
'L'	4	19-S	38-E					LEA

Latitude North 32°41'16.90" Longitude West 103°09'40.90"

NATURE OF RELEASE

Type of Release Produced and Injection Water	Volume of Release Estimated 250 BW	Volume Recovered 200 Bbls
Source of Release 8" fiberglass injection trunk line	Date and Hour of Occurrence 11/11/2008 10:30 AM	Date and Hour of Discovery 11/11/2008 10:30 AM
Was Immediate Notice Given? <input type="checkbox"/> Yes <input checked="" type="checkbox"/> No <input type="checkbox"/> Not Required	If YES, To Whom?	
By Whom?	Date and Hour	
Was a Watercourse Reached? <input type="checkbox"/> Yes <input checked="" type="checkbox"/> No	If YES, Volume Impacting the Watercourse. N/A	
If a Watercourse was Impacted, Describe Fully.* N/A		
Describe Cause of Problem and Remedial Action Taken.* An 8" fiberglass injection trunk line from South Hobbs Unit Central T/B to South Hobbs Unit Injection Building #7 was struck by a backhoe shortly after the line was repaired. Isolated the trunk line by shutting valves at both ends. South Hobbs Unit #53 is the closest injector and the API number for this well was used for this report.		
Describe Area Affected and Cleanup Action Taken.* Area affected is approximately 200' X 200' to the north of leak site in the pasture. An estimated 250 bbls of produced water was spilled and 200 bbls was recovered via vacuum trucks. Piping was repaired, and samples were taken in affected area to insure area is in compliance with NMOCD guidelines for spills. Spill cleanup will take place along with original spill that occurred on 11/03/2008.		
I hereby certify that the information given above is true and complete to the best of my knowledge and understand that pursuant to NMOCD rules and regulations all operators are required to report and/or file certain release notifications and perform corrective actions for releases which may endanger public health or the environment. The acceptance of a C-141 report by the NMOCD marked as "Final Report" does not relieve the operator of liability should their operations have failed to adequately investigate and remediate contamination that pose a threat to ground water, surface water, human health or the environment. In addition, NMOCD acceptance of a C-141 report does not relieve the operator of responsibility for compliance with any other federal, state, or local laws and/or regulations.		
Signature. <i>Steven M. Bishop</i>	OIL CONSERVATION DIVISION	
Printed Name: Steven M. Bishop	Approved by <i>[Signature]</i> ENVIRONMENTAL ENGINEER	
Title: HES Specialist	Approval Date <u>6.26.09</u>	Expiration Date <u> </u>
E-mail Address: Steven_Bishop@oxy.com	Conditions of Approval:	Attached <input type="checkbox"/>
Date: 03/10/2009 Phone: (575) 397-8251		

* Attach Additional Sheets If Necessary

SPILL MAP

PLEASE DRAW SKETCH OF SPILL AND INDICATE WHERE SPILL ORIGINATED.

11/03/2008 8" Fiberglass, H-Pump 7 LINE, 50 PSI, 12,000 bbls/day RATE
LEAK DISCOVERED 2:30 PM, ESTIMATED 300-400 Bbls Prod. Water
LEAK SITE UL 'L' SEC. 4, T-19-S, R-38-E - N 32° 41' 16.90" - W 103° 09' 40.90"
LEAK RAN SOUTH INTO UL 'M' SEC. 4, T-19-S, R-38-E - MALCOLM COOMBS, LANDOWNER

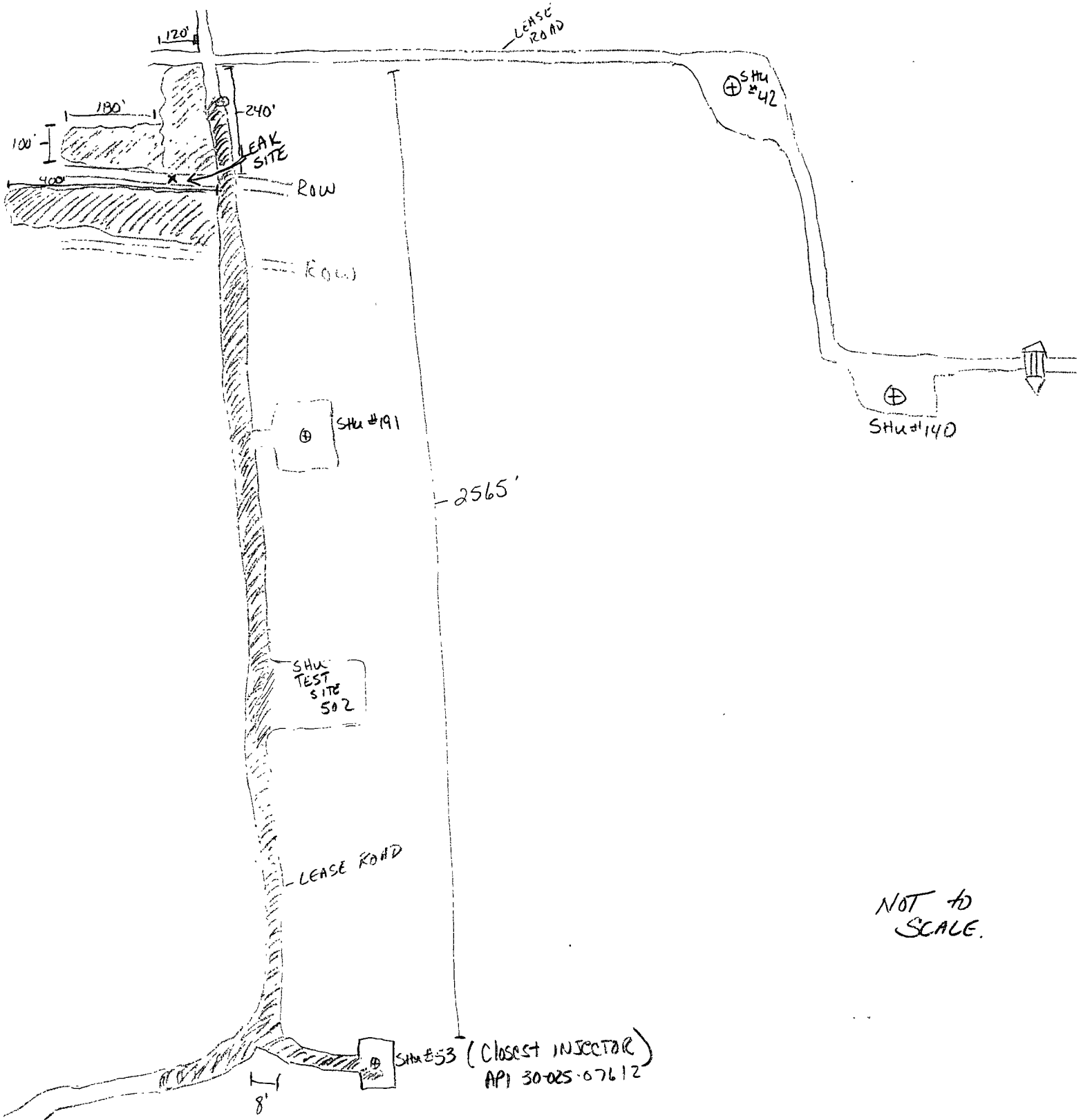

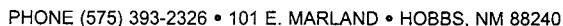

Analysis Date: 11/18/08
Sampling Date: 11/17/08
Sample Type: SOIL
Sample Condition: INTACT
Sample Received By: CK
Analyzed By: HM

METHOD: Standard Methods **4500-ClB**
Note: Analyses performed on 1:4 w/v aqueous extracts.

11-19-88
Date

PLEASE NOTE Liability and Damages. Cardinal's liability and client's exclusive remedy for any claim arising, whether based in contract or tort, shall be limited to the amount paid by client for analyses. All claims, including those for negligence and any other cause whatsoever shall be deemed waived unless made in writing and received by **Cardinal** within thirty (30) days after completion of the applicable service. In no event shall **Cardinal** be liable for incidental or consequential damages, including, without limitation, business interruptions, loss of use, or loss of profits incurred by client, its subsidiaries, affiliates or successors arising out of or related to the performance of services hereunder by **Cardinal**, regardless of whether such claim is based upon any of the above-stated reasons or otherwise. Results relate only to the samples identified above. This report shall not be reproduced except in full with written approval of Cardinal Laboratories.



CARDINAL LABORATORIES, INC.

2111 Beechwood, Abilene, TX 79603 101 East Marland, Hobbs, NM 88240
(915) 673-7001 Fax (915) 673-7020 (505) 393-2326 Fax (505) 393-2476

CHAIN-OF-CUSTODY AND ANALYSIS REQUEST

Page 1 of 1

Company Name: <u>Occidental Permian Ltd. Partnership</u>		BILL TO		ANALYSIS REQUEST																							
Project Manager: <u>STEVE BISHOP</u>		P.O. #:																									
Address: <u>1017 W. STANOLIND ROAD</u>		Company: <u>Occidental Permian LTD.</u>																									
City: <u>HOBBS</u> State: <u>NM</u> Zip: <u>88240</u>		Attn: <u>ACCOUNTS PAYABLE</u>																									
Phone #: <u>(505) 397-8251</u> Fax #: <u>(505) 397-8204</u>		Address: <u>P.O. Box 1747</u>																									
Project #: <u>#0804</u> Project Owner: <u>OXY</u>		City: <u>ADDISON</u>																									
Project Name: <u>8" H-Pump line Sec 4</u>		State: <u>TX</u> , Zip: <u>75001-1747</u>																									
Project Location: <u>Sec 4, T-19-S, R-38-E</u>		Phone #:																									
Sampler Name: <u>STEVE BISHOP</u>		Fax #:																									
FOR LAB USE ONLY																											
Lab I.D.	Sample I.D.	(GRAB OR COMPOUND)	# CONTAINERS	MATRIX					PRESERV.			SAMPLING															
				GROUNDWATER	WASTEWATER	SOIL	CRUDE OIL	SLUDGE	OTHER:	ACID/BASE:	ICE / COOL	OTHER:	DATE	TIME													
<u>H110342-1</u>	<u>#1 West End ditch 5' depth</u>	<u>G</u>				<u>X</u>							<u>11/17/08</u>	<u>1:48pm</u>	<u>✓</u>												
<u>-2</u>	<u>#2 UNDER PIPE 8' depth</u>	<u>G</u>				<u>X</u>							<u>11/17/08</u>	<u>1:54pm</u>	<u>✓</u>												
<u>-3</u>	<u>#3 East End ditch 5' depth</u>	<u>G</u>				<u>X</u>							<u>11/17/08</u>	<u>1:57pm</u>	<u>✓</u>												
<u>-4</u>	<u>#4 North Side ditch 5' depth</u>	<u>G</u>				<u>X</u>							<u>11/17/08</u>	<u>2:01pm</u>	<u>✓</u>												
<u>-5</u>	<u>#5 South Side ditch 5' depth</u>	<u>G</u>				<u>X</u>							<u>11/17/08</u>	<u>2:05pm</u>	<u>✓</u>												

PLEASE NOTE: Liability and Damages. Cardinal's liability and client's exclusive remedy for any claim arising whether based in contract or tort, shall be limited to the amount paid by the client for the analyses. All claims including those for negligence and any other cause whatsoever shall be deemed waived unless made in writing and received by Cardinal within 30 days after completion of the applicable service. In no event shall Cardinal be liable for incidental or consequential damages, including without limitation, business interruptions, loss of use, or loss of profits incurred by client, its subsidiaries, affiliates or successors arising out of or related to the performance of services hereunder by Cardinal, regardless of whether such claim is based upon any of the above stated reasons or otherwise.

Terms and Conditions: Interest will be charged on all accounts more than 30 days past due at the rate of 24% per annum from the original date of invoice, and all costs of collections, including attorney's fees.

Sampler Relinquished:		Date: <u>11/17/08</u>	Received By:		Phone Result: <input checked="" type="checkbox"/> Yes <input type="checkbox"/> No	Add'l Phone #:
<u>STEVE BISHOP</u>		Time: <u>2:20</u>			Fax Result: <input checked="" type="checkbox"/> Yes <input type="checkbox"/> No	Add'l Fax #:
Relinquished By:		Date: <u>11/17/08</u>	Received By: (Lab Staff)		REMARKS: <u>PAY KEY WASSON 2-11753</u> <u>WORK ORDER CN 08859252</u>	
		Time: <u>2:20</u>	<u>Cheryl Keene</u>			
Delivered By: (Circle One)			Sample Condition		CHECKED BY:	
<input checked="" type="radio"/> Sampler <input type="radio"/> UPS <input type="radio"/> Bus <input type="radio"/> Other:			Cool Intact <input type="checkbox"/> Yes <input checked="" type="checkbox"/> No		(Initials) <u>CDK</u>	

† Cardinal cannot accept verbal changes. Please fax written changes to 505-393-2476.



PHONE (575) 393-2326 • 101 E. MARLAND • HOBBS, NM 88240

ANALYTICAL RESULTS FOR
BBC INTERNATIONAL, INC.
ATTN: CLIFF BRUNSON
P.O. BOX 805
HOBBS, NM 88241
FAX TO: (575) 397-0397

Receiving Date: 03/06/09
Reporting Date: 03/09/09
Project Owner: OXY
Project Name: 8" FIBER GLASS LINE
Project Location: SOUTH HOBBS

Analysis Date: 03/09/09
Sampling Date: 03/06/09
Sample Type: SOIL
Sample Condition: INTACT
Sample Received By: CK
Analyzed By: TR

LAB NUMBER	SAMPLE ID	Cl ⁻ (mg/kg)
H17023-1	SP 1	464
H17023-2	SP 2	496
H17023-3	SP 3	480
H17023-4	SP 4	400
H17023-5	SP 5	464
H17023-6	SP 6	496
H17023-7	SP 7	528
H17023-8	SP 8	< 16
H17023-9	SP 9	1,840
Quality Control		500
True Value QC		500
% Recovery		100
Relative Percent Difference		< 0.1

METHOD: Standard Methods 4500-ClB

Note: Analyses performed on 1:4 w:v aqueous extracts.

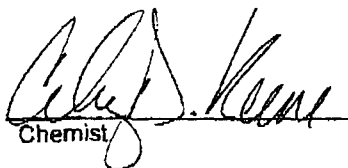
Chemist

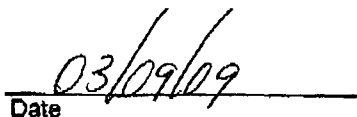
Date

H17023 BBC

PLEASE NOTE: Liability and Damages. Cardinal's liability and client's exclusive remedy for any claim arising, whether based in contract or tort, shall be limited to the amount paid by client for analyses. All claims, including those for negligence and any other cause whatsoever shall be deemed waived unless made in writing and received by Cardinal within thirty (30) days after completion of the applicable service. In no event shall Cardinal be liable for incidental or consequential damages, including, without limitation, business interruptions, loss of use, or loss of profits incurred by client, its subsidiaries, affiliates or successors arising out of or related to the performance or services hereunder by Cardinal, regardless of whether such claim is based upon any of the above-stated reasons or otherwise. Results relate only to the samples identified above. This report shall not be reproduced except in full with written approval of Cardinal Laboratories.



CARDINAL LABORATORIES

101 East Marland, Hobbs, NM 88240

(505) 393-2326 FAX (505) 393-2476

CHAIN-OF-CUSTODY AND ANALYSIS REQUEST

Company Name: BBC International, Inc.				BILL TO				ANALYSIS REQUEST			
Project Manager: Cliff Brunson				P.O. #:							
Address: P.O. Box 805				Company:							
City: Hobbs		State: NM Zip: 88241		Attn: SAME							
Phone #: 575-397-6388		Fax #: 575-397-0397		Address:							
Project #:		Project Owner: ORY		City:							
Project Name: 8" Fiber Glass line				State:				Zip:			
Project Location: South Hobbs				Phone #:							
Sampler Name: ROGER BERNANDEZ				Fax #:							

Lab I.D.	Sample I.D.	GRAB OR (COMP)	# CONTAINERS	MATRIX					PRESERV		SAMPLING		DATE	TIME	CHLORIDE	
				GROUNDWATER	WASTEWATER	SOIL	OIL	SLUDGE	OTHER	ACID/BASE	ICE/COOL	OTHER				
417023-																
1	SP. 1	✓	1			✓				✓			3/6/09	8:50	✓	
2	SP. 2	✓	1			✓				✓			3/6/09	8:40	✓	
3	SP. 3	✓	1			✓				✓			3/6/09	8:50	✓	
4	SP. 4	✓	1			✓				✓			3/6/09	9:00	✓	
5	SP. 5	✓	1			✓				✓			3/6/09	9:05	✓	
6	SP. 6	✓	1			✓				✓			3/6/09	9:10	✓	
7	SP. 7	✓	1			✓				✓			3/6/09	9:15	✓	
8	SP. 8	✓	1			✓				✓			3/6/09	9:20	✓	
9	SP. 9	✓	1			✓				✓			3/6/09	9:30	✓	

PLEASE NOTE: Liability and Damages. Cardinal's liability and clients' exclusive remedy for any claim arising whether based in contract or tort, shall be limited to the amount paid by the client for the analyses. All claims, including those for negligence and any other causes whatsoever shall be deemed waived unless made in writing and received by Cardinal within 30 days after completion of the applicable service. In no event shall Cardinal be liable for incidental or consequential damages, including without limitation, business interruption, loss of use, or loss of profits incurred by client, its subsidiaries, affiliates or successors arising out of or related to the performance of services hereunder by Cardinal, regardless of whether such claim is based upon any of the above stated persons or otherwise.

Relinquished By: <i>Roger Hernandez</i>	Date: 3/6/09 Time: 12:13	Received By: <i>Cheryl Keene</i>	Phone Result: <input type="checkbox"/> Yes <input type="checkbox"/> No Add'l Phone #:
Relinquished By:	Date: 3/6/09 Time: 12:13	Received By:	Fax Result: <input type="checkbox"/> Yes <input type="checkbox"/> No Add'l Fax #:
Delivered By: (Circle One) Sampler - UPS - Bus - Other:		Sample Condition Collected: <input checked="" type="checkbox"/> Intact <input type="checkbox"/> Yes <input type="checkbox"/> No No <input checked="" type="checkbox"/> Yes <input type="checkbox"/> No	CHECKED BY: <i>Cheryl Keene</i>
REMARKS:			

† Cardinal cannot accept verbal changes. Please fax written changes to 505-393-2476

BBC INTERNATIONAL

5053970397

03/09/2009 02:59

RECEIVED

Oxy · 8" Fiberglass line 3/6/09

↑ N

Sample point
map

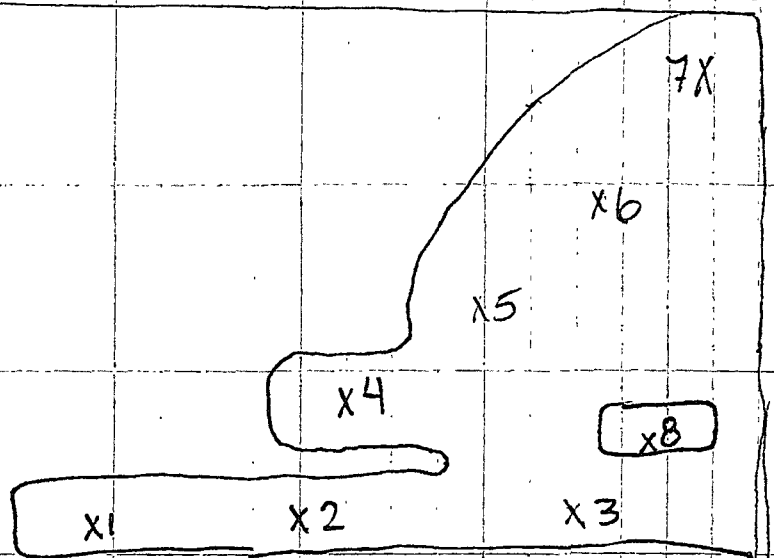

SP 1
SP 2
SP 3
SP 4
SP 5
SP 6
SP 7
SP 8 taken from bottom of hole
SP 9 1' depth

} Approximately 1' depth

TIME
8:30
8:40
8:50
9:00
9:05
9:10
9:15
9:20 5' depth
9:30