

cc - ocl Hobbs
9/16/55
CONTINENTAL OIL COMPANY

NSP-198

Eunice, New Mexico
September 16, 1955
due 10/24/55

only 3 copies rec'd
Main Office
Now for NM 0465 cc
1 to Hobbs for E & NSP
Hobbs, New Mexico

Aztec Oil & Gas Company
Box 847
Hobbs, New Mexico

Tidewater Associated Oil Co.
Box 547
Hobbs, New Mexico

Humble Oil & Refining Company
Box 2347
Hobbs, New Mexico

E. F. Moran, Inc.
Box 1718
Hobbs, New Mexico

Gentlemen:

Attached is Continental Oil Company's application to the Oil Conservation Commission of New Mexico for permission to dually complete and form a non-standard proration unit for its Nolan No. 2 well which is self explanatory.

This application is submitted to you as offset operators in compliance with Commission rules and regulations.

Yours very truly,

W. E. Allen

W. E. Allen
District Superintendent
Eunice District
New Mexico Division
Production Department

WEA-PGM

BEFORE THE OIL CONSERVATION COMMISSION
OF THE
STATE OF NEW MEXICO

IN THE MATTER OF THE APPLICATION OF
CONTINENTAL OIL COMPANY FOR AN ORDER
GRANTING IT PERMISSION TO DUAL COMPLETE
ITS NOLAN NO. 2 SE/4 SW/4 SECTION 11,
T. 21S, R. 37E, N.M.P.M. LEA COUNTY, NEW
MEXICO

A P P L I C A T I O N

Comes now CONTINENTAL OIL COMPANY, a Delaware Corporation,
hereinafter called "Applicant" and respectfully requests the Oil
Conservation Commission of the State of New Mexico to issue an order
authorizing Applicant to dually complete its Nolan No. 2 well, located
660 feet from the south line and 1980 feet from the west line of
Section 11, T. 21S, R. 37E. N.M.P.M., Lea County, New Mexico, in the
Drinkard Oil Pool and the Tubb Gas Pool, and in support thereof would
show the following:

A non-standard proration unit of 120 acres consisting of
contiguous quarter quarter sections, S/2 and NE/4 of SW/4, Section
11, T. 21S, R. 37E, is requested.

In support of this request we should like to point out that
the proposed unit conforms with Commission requirements in all re-
spects as follows:

1. Said unit consists of contiguous quarter quarter
sections (and/or lots).
2. Said unit lies wholly within a single governmental
section.
3. The entire proposed unit may be reasonably presumed
to be productive of gas.
4. The length or width of said unit does not exceed 5280
feet.
5. Copies of this application have been furnished by
registered mail to all offset operators and all
operators within 1500' of said well.

The dual completion of said well in the Drinkard for oil
and the Tubb for gas is in the interest of conservation and the pro-
tection of correlative rights.

Segregation of the producing intervals will be made by appropriate packer installation and said well will be equipped so there can be no comingling of well fluids in producing the gas through the annulus between the tubing and casing, and the oil through the tubing. Said well will be equipped in such a manner that reservoir pressures may be determined separately for each of the two specified pools and the well head equipment to be equipped with all necessary connections to permit accurate measurement of any natural gas, oil, or oil and gas produced from each separate pool as may be required by the Commission.

Attached to this application is a plat showing the location of said well and surrounding wells and leaseholds with the acreage to be assigned the proposed gas unit outlined in red, a plat showing the mechanical condition of said well at present and after the proposed dual completion.

All offset operators have been duly notified by copy of this application.

WHEREFORE, Applicant respectfully requests the Oil Conservation Commission of the State of New Mexico enter its order authorizing Applicant to dually complete said well and permit the assignment of a non-standard proration unit in accordance with the foregoing application and rules and regulations of the Commission.

CONTINENTAL OIL COMPANY

By W. B. Allen

Subscribed and sworn to before me this 22nd day of September, 1955

Thomas E. Fay Notary Public

in and for Lea County, New Mexico.

My Commission Expires MY COMMISSION EXPIRES JULY 20, 1958

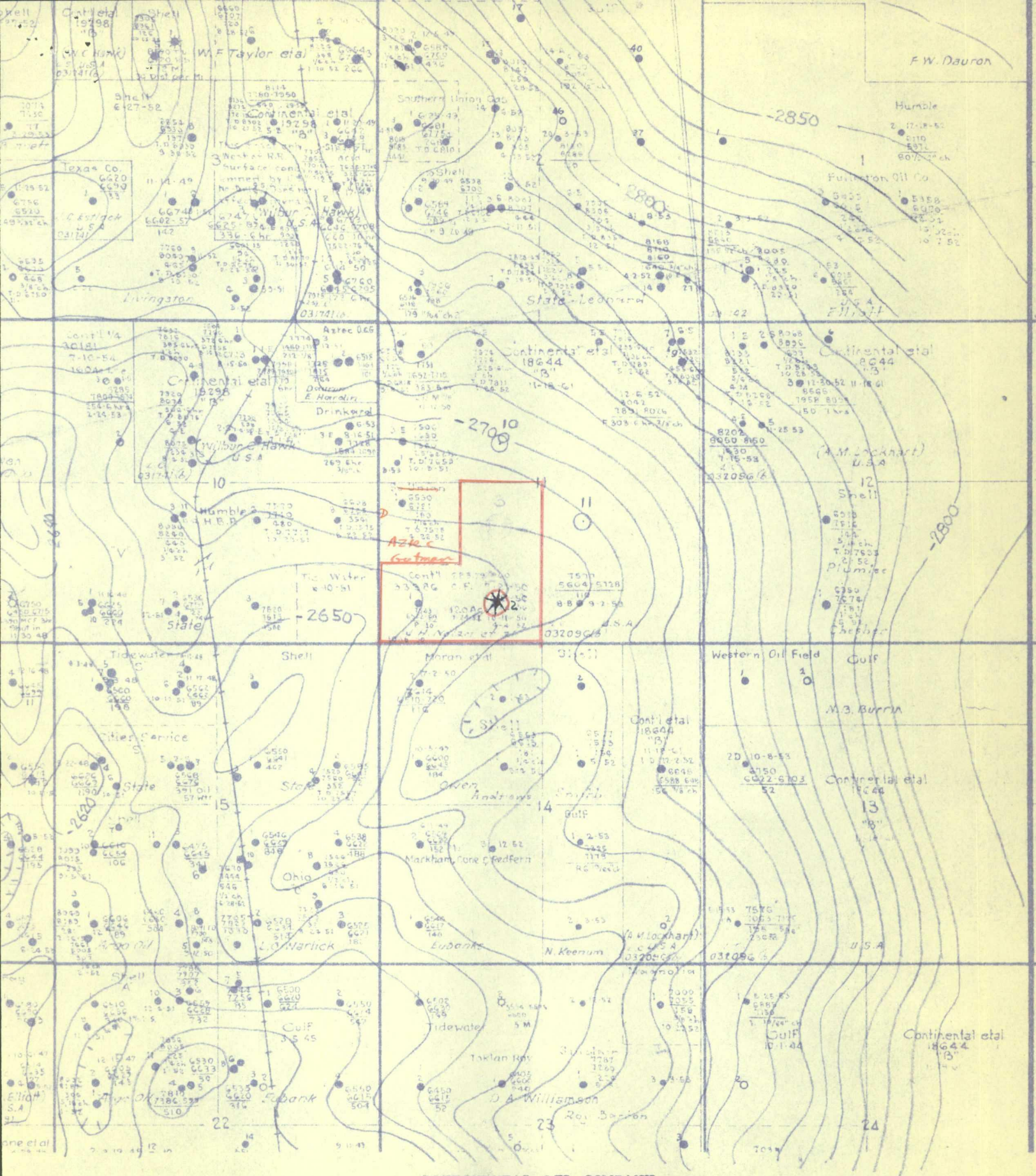

CONTINENTAL OIL COMPANY
 CONTOURED ON TOP OF THE TUBB
 C. I. 10' Scale 1" = 2000'
 T21S - R37E, Lea County, New Mexico
 Geological Section - Hobbs, N. Mex.
 Aug. 31, 1954

CONTINENTAL OIL COMPANY

NOLAN NO. 2

